

Parc, Talwrn, Ynys Môn

Cofnod Adeilad Lefel 2/3 Archaeolegol
Archaeological Level 2/3 Building Record



Archaeoleg Gwynedd
Heneb
Gwynedd Archaeology

Parc, Talwrn, Ynys Môn

Cofnod Adeilad Lefel 2/3 Archaeolegol Archaeological Level 2/3 Building Record

Yr Amgylchedd Hanesyddol yn Cofnodi Prif Gyfeirnod /
Historic Environment Record Event Primary Reference Number: 49216

Rhif Prosiect Heneb Archaeoleg Gwynedd / Heneb Gwynedd Archaeology Project No. HD24-116

Rhif Adroddiad / Report No. 1817

Wedi'i baratoi ar gyfer / Prepared for: Mr and Mrs Parry

Ebrill / April 2025

Ysgrifenydd gan / Written by: Stuart Murphy

Delwedd clawr blaen / Front Cover image: Location shot showing E facing elevation of Parc, view from E (archive reference: E49216_124).





Ymddiriedolaeth Archaeoleg Cymru
The Trust for Welsh Archaeology

Cadeirydd / Chair: Dr Carol Bell PSG / CEO: Richard Nicholls

Heneb yw'r enw masnachu Ymddiriedolaeth Archaeolegol Cymru. Cwmni Cyfyngedig (1198990) ynghyd ag Elusen Gofrestredig (504616) yw'r Ymddiriedolaeth
Heneb is the trading name of The Trust for Welsh Archaeology. The Trust is both a Limited Company (1198990) and a Registered Charity (504616)

Ty Cornel, 6 Stryd Caerfyrddin, Llandeilo, Sir Gaerfyrddin, SA19 6AE
Corner House, 6 Carmarthen Street, Llandeilo, Carmarthenshire, SA19 6AE

Approvals Table				
	Role	Printed Name	Signature	Date
Originated by	Document Author	Stuart Murphy	Stuart Murphy	23/05/2025
Reviewed by	Document Reviewer	M.S.Lynes		23/05/2025
Approved by	Principal Archaeologist	John Roberts		23/05/2025

Revision History			
Rev No.	Summary of Changes	Ref Section	Purpose of Issue

CONTENTS

CRYNHODEB ANHECHNEGOL	5
NON-TECHNICAL SUMMARY	5
1 INTRODUCTION	6
1.1 Aims and Objectives	9
1.2 Acknowledgements.....	10
2 HISTORIC BACKGROUND	11
2.1 Cartographic Evidence and Historic Land Use	13
3 METHOD STATEMENT	14
3.1 Level 2/3 Building Record	14
3.1.1 Introduction.....	14
3.1.2 Photographic Record	15
3.1.3 Written Record.....	16
3.1.4 Drawn Record.....	17
4 RESULTS.....	18
4.1 Introduction	18
4.2 Parc Talwrn Farmhouse: LBC/2024/4	19
4.2.1 Exterior	19
4.2.2 Interior	20
4.3 Grain store and Kitchen	23
4.3.1 Exterior	23
4.3.2 Interior	24
4.4 Cow & Calving Shed	26
4.4.1 Exterior	26
4.4.2 Interior	27
4.5 Outbuilding No.1 & 2: LBC/2024/4	29
4.5.1 Exterior	29
4.5.2 Interior	29
4.6 Outbuilding No.3: LBC/2024/4	31
4.6.1 Exterior	31

4.6.2	Interior	31
4.7	Outbuilding No.4: LBC/2024/4	32
4.7.1	Exterior	32
4.7.2	Interior	32
4.8	Outbuilding No.5: LBC/2024/4	33
4.8.1	Exterior	33
4.8.2	Interior	33
4.9	Outbuilding No.6: LBC/2024/4	34
4.9.1	Exterior	34
4.9.2	Interior	34
4.10	Outbuilding No.7: LBC/2024/4	35
4.10.1	Exterior	35
4.10.2	Interior	35
4.11	Outbuilding No.8: LBC/2024/4	36
4.11.1	Exterior	36
4.11.2	Interior	36
CONCLUSION		37
5	SOURCES CONSULTED	39
	Websites	40
FIGURE 01		41
Reproduction of client location plan. Parc Talwrn - Drawing 07032024. Scale: as shown.		41
FIGURE 02		42
Reproduction Of Client Existing Block Plan. <i>Parc Talwrn</i> - Drawing 07032024. Scale: as shown.		42
FIGURE 03		43
Reproduction Of Outbuildings Plan: Identification and Purpose. <i>Parc Talwrn</i> - Drawing 14052024. Scale: as shown.		43
FIGURE 04		44
Reproduction of the Llanddyfan parish tithe map 1840's, showing Parc / Bryn Ffynnon farm building and associated fields.		44
FIGURE 05		45

Reproduction of First to Third Edition Ordnance Survey maps of Parc, Talwrn. Scale 1:500@A4.....	45
APPENDIX I.....	47
Heneb Field Services Written Scheme of Investigation Final.	47
APPENDIX II.....	48
Heneb Field Services Photographic Metadata	48
APPENDIX III.....	49
Heneb Field Services Selection Strategy v2.0 Final.	49

CRYNHODEB ANHECHNEGOL

Comisiynwyd Heneb: Adran Contractau Archaeoleg Gwynedd (Heneb: GA) gan Mr a Mrs Parry i gynnal lliniaru archaeolegol ar ffurf Cofnod Adeilad Lefel 2/3 cyn gwaith datblygu eiddo ym Mharc, Talwrn, Ynys Môn.

Mae Parc yn enghraifft dda o ffermdy o'r 19eg ganrif sy'n cadw ei gymeriad hanesyddol ochr yn ochr ag ychwanegiadau diweddarach megis adeiladau ategol a newidiadau mewnol, wrth i arddull, anghenion a dylanwadau newid dros y blynyddoedd. Mae gan Parc ei wreiddiau fel ffermdy cryno llinellol bychan, sydd wedi datblygu ac ehangu dros y blynyddoedd, yn ôl pob tebyg oherwydd anghenion amaethyddol. Mae'r ffaith fod Parc wedi aros yn nwylo'r un teulu am lawer cenhedlaeth hefyd yn esbonio pam ei fod wedi cadw ei gymeriad hanesyddol. Cynhaliwyd y Cofnod Adeilad Lefel 2/3 ar y prif dŷ gyda'r llaethdy cysylltiedig, storfa rawn a chegin a'r holl adeiladau ategol eraill ar yr 8fed o Ebrill 2025.

NON-TECHNICAL SUMMARY

Heneb: Gwynedd Archaeology Contracts Department (Heneb: GA) was commissioned by Mr & Mrs Parry to undertake archaeological mitigation in the form of a Level 2/3 Building Record prior to property development works at Parc, Talwrn, Ynys Môn.

Parc is a good example of a 19th century farmstead which retains its historical character alongside later additions such as auxiliary buildings and internal modifications, as style, needs and influence change over the years. Parc has its origins being a small compact linear plan farmstead, which develops and expands over the years, likely due to agricultural needs. The addition that Parc has stayed in the same family for many generations also explains why it has kept its historical character. The Level 2/3 Building Record was undertaken on the main house with attached dairy, grain store and kitchen and all other auxiliary outbuildings during the 8th of April 2025.

1 INTRODUCTION

Heneb Field Services was commissioned by Mr & Mrs Parry to undertake archaeological mitigation in the form of a Level 2/3 Building Record prior to property development works at Parc, Talwrn, Ynys Môn, LL77 7SS (centred on NGR: SH 48853 77014; [Figure 01](#)).

Parc is a Grade II listed (ID 80974) small farmstead located within the village of Talwrn. The small farmstead is recorded in the regional Historic Environment Record (HER) as PRN 66421. Parc comprises of a long range a cottage with garden to the front, flanked by cow-house range to the right, and an out-kitchen and store with granary over to the left (Source: CADW, 2025). The former small farmstead was designated as a Grade II listed site on March 12, 2003, in recognition of its historical significance and well-preserved character. It remains an intact example of a traditional small farmstead, consisting of a dwelling and associated agricultural outbuildings that form a cohesive unit. This designation is recorded under reference ID 80974.

The archaeological Level 2/3 record conformed with conditions 5a and 5b, set out under Anglesey County Council reference number FPL/2024/53. Furthermore, Listed Building Consent (LBC) was obtained for the works, under reference LBC/2024/4. The proposed developments which are regulated under the Anglesey County Council authority are outlined in Document Ref No. 07052024 and include the following:

1. Parc Talwrn Smallholding Residence Farmhouse, for internal and external works, including demolition and rebuilding of single storey side offshoot.
 2. Building No.1: Conversion of dairy into a workshop, including internal and external alterations by replacing the roof, rebuilding stonework and repoint and stabilise all walls.
 3. Building No. 2: Conversion of pigsty into an animal enclosure, including removal of tree, stabilisation of walls, reinstating roof capping wall and timber door, demolition of a wall, and clearance around base of walls.
- Building No. 3: Conversion of outbuilding into a shed for storage, including replacing asbestos roof with similar roof system to match dairy, repair window frames and

reinstate glass panes, removal of existing cementitious mortar repairs, repoint with lime mortar where necessary and clearance around base of walls.

- Building No. 4: Conversion of outbuilding into a shed for storage, including repoint brickwork, replace timber wall plate, replace timber roof joists, replace roof with new to match dairy, and clearance around base of walls.
- Outbuilding 5: Conversion of outbuilding into a shed for storage, including repoint and stabilise walls internally and externally, replace timber wall plate, roof joists and lintel, rebuild lintels above doorways, replace roof with new to match grain store, and installation of gutter.
- Building No.6: Conversion of outbuilding into a shed for storage, including removal of existing roof, removal of cementitious mortar and replace with lime mortar, replace timber wall plate, joists and lintel, reinstate door and window, existing floor, installation of gutter and clearance around base of walls.
- Building No. 7: Conversion of outbuilding to housing of utilities, including repointing internally and externally, reinstating wall plates and joists, replaced roof to match dairy, reinstate door and window, installation of gutter and clearance around base of walls.
- Building No. 8: Restoration of existing barn, including repointing and stabilisation of all walls internally and externally, replace roof and timber roof joists, and alterations to existing ground level to north end, clearance around base of walls and reinstating guttering.

The archaeological mitigation comprised of a Level 2/3 building record prior to development. The building record was completed during the 8th of April 2025 and monitored by Heneb: GA in accordance with an approved written scheme of investigation ([Appendix I](#)). In line with the regional Historic Environment Record (HER) requirements, the HER was contacted at the onset of the project to ensure that any data arising was formatted in a manner suitable for accession; the HER Event Primary Reference Number for this project is **49216**.

All work was planned, managed and undertaken by Heneb: GA Field Services in accordance with the following standards and guidance:

- Guidance for the Submission of Data to the Heneb Historic Environment Record (HER) Version 4.1 (Heneb: The Trust for Welsh Archaeology, 2024);
- Guidelines for digital archives (Royal Commission on Ancient and Historical Monuments of Wales, 2015);
- Management of Archaeological Projects (English Heritage, 1991);
- Management of Research Projects in the Historic Environment: The MoRPHE Project Managers' Guide (Historic England, 2015);
- Standard and Guidance for the Archaeological Investigation and Recording of Standing Buildings or Structures (Chartered Institute for Archaeologists, 2020);
- Standard for archaeological monitoring & recording (Chartered Institute for Archaeologists, 2023);
- Standard and guidance for the creation, compilation, transfer and deposition of archaeological archives (Chartered Institute for Archaeologists, 2020); and
- Understanding Historic Buildings: A Guide to Good Recording Practice (Historic England, 2016).

Heneb: the Trust for Welsh Archaeology is a Registered Organisation with the Chartered Institute for Archaeologists (CIfA).

1.1 Aims and Objectives

The key aims and objectives of the project were to:

- Complete a descriptive and photographic record of Parc farmstead / smallholding sufficient to document its development, use and phasing. This includes the dwelling, agricultural buildings and any other auxiliary structures found to be of historical value;
- to observe how the buildings were originally used;
- to conduct archival research on the farmstead to develop a comprehensive historical account.;
- to place the results in context (if applicable), with reference made to *A Research Framework for the Archaeology of Wales Version 03, Final Refresh Document* (March 2017).

1.2 Acknowledgements

Heneb Field Services would like to thank the following for their contribution and support:

- Heneb Field Services project team: Stuart Murphy;
- Client: Mr & Mrs Parry; and
- Heneb: Planning Services: Jenny Emmett.

2 HISTORIC BACKGROUND

The historical background for the small farmstead has had some researched with a full report and description provided by CADW during the Grade II listing survey of 2003 (Source: Cadw, 2025). A brief summary describes Parc's history, interior and exterior as:

"Traditional small holding, latterly of 14 acres (5.7 hectares), and with buildings consistent with this acreage. Probably early nineteenth century. Apparently, a small-scale farm, growing a range of green crops and maintaining a small dairy herd (the dairy survives as a semi-ruinous building in front of the main range)".

"The cottage retains its original layout intact, divided as a principal room with main fireplace, and a secondary heated room. High ceiling over main room may suggest former existence of a crogloft over the secondary room only - the previous existence of a loft is recalled. The secondary room has a fine carved slate fireplace, with simple concentric circles in the lintel, floral motifs in simple lined panels in the sidepieces. The boarded ceiling may also be original. The kitchen retains the remnants of a painted calico ceiling, nailed between the rafters".

"Long-range comprising single storeyed cottage with separate enclosed garden to front, flanked by cow-house range to the right, and out-kitchen and store with granary over to the left. Immediately to the rear of the cowhouse range is a substantial haybarn. A stable behind the granary range is a twentieth century addition. Rubble masonry, limewashed throughout; bedded and grouted slate roof to cottage, regular (and later) slates to cowhouse. Cottage has central doorway flanked by 4-pane sash windows (boarded at time of inspection); gable end stacks, equally sized. Cowhouse range to right has two doorways, flanking a central window. Out-kitchen and store to left are a low two storeys: the kitchen has doorway to right, and 4-pane sash window to left, under a single long timber lintel; outbuilding has single doorway in front elevation, and access to the upper granary by external staircase against the gable end; 2 upper windows have glazed upper panes, and slatted lower sections to provide ventilation to granary. Haybarn at rear of cowhouse was formerly of open type, and 3 bays; now the two outer open bays in its front elevation have been blocked with rubble, to form a semi-enclosed barn".

As part of the pre-planning application, and to support a listed building consent, Frances Littlewood Chartered Engineer undertook a work scope and outbuilding survey with the report published in May 2024 (Littlewood, 2024). In addition, a detailed Heritage Impact Assessment (HIA) was also undertaken in May 2024 by *Henderson Heritage* which gives a detailed historic

account of the small farmstead / smallholding. This includes map regression, which identified that as Parc was not visible on the 1841 tithe map, hence it must have been built at a later date. Furthermore, the HIA describes the building as being built of local stone, and its type, as a smallholding, being a popular occurrence during the 19th century with similar ones found within the local. In addition to the HIA, existing plans and elevations were produced, including a 3D model *Parc Talwrn* drawing 07032024(1).

A black and white photograph from the 1890s was recovered showing part of the main house and dairy / cowshed with a gentleman astride a horse and cart with two ladies present. It shows the calving shed / cowshed's roof line much lower compared to the house, therefore the roof has been replaced at some point up to modern day (Figure 06).

2.1 Cartographic Evidence and Historic Land Use

An examination of the Llanddyfnan parish Tithe map of 1845 shows that the map is slightly miss aligned. Therefore, Parc could be present on the map as a small rectangular structure located within Plot 420, and under ownership of the farm Bryn Ffynnon (*sic*), which the land is noted as being farmed by a Huw Jones and owned by Jones Hugh, presumed to be the same person ([Figure 04](#)). Another suggestion is that Bryn Ffynnon (*sic*) is another name for Parc, as interpreted by Meilyr Powels of the RCAHMW within a letter regarding the LBC planning conditions at Parc (Powel. M, 2024). Furthermore, a brief examination of the census records also causes confusion, as Park (*sic*) is marked down in 1841, then changes to Parc in 1851 then the same inhabitants are marked down as living in a dwelling called Bryn y Ffynon in 1861. Thereafter in 1871, 1891, as Parc and Bryn Ffynon in 1901 then back to Park in 1911 (Source: National Archives, 2025).

An examination of the County Series Ordnance Survey 25-inch to 1-mile maps of Anglesey (Sheet XIII.16 maps published 1889, 1899 and 1920) shows a vast change within field systems being made smaller and the first marked appearance of Parc ([Figure 05](#)). The First Edition shows a rectangular structure orientated north-northeast to south-southwest, with mature trees lining the entrance road and one to the south and west of the building ([Figure 05](#)). By the time the Second Edition is published 10 years later the trees are not plotted, and the property has gained two auxiliary buildings on the southern side of the property. By the Third Edition just over 20 years later, the outlines and shape of the structure are significantly more detailed, however, no additional buildings compared to the Second Edition ([Figure 05](#)).

3 METHOD STATEMENT

3.1 Level 2/3 Building Record

3.1.1 Introduction

The archaeological mitigation was undertaken as a Level 2/3 Record, as defined by *Understanding Historic Buildings: A Guide to Good Recording Practice* (Historic England, 2016). The Level 2/3 record was limited to accessible areas and was undertaken in accordance with a suitable risk assessment and health & safety parameters. *The client was responsible for access and for removing any obstructing vegetation or materials.*

A Level 2/3 record is characterised in *Understanding Historic Buildings* as a descriptive record (Historic England, 2016: 26) and incorporates the exterior and interior of the building, for which a photographic record, written record and drawn record was be completed on an annotated floor plan published by *Parc Talwrn* ([Figure 02](#) and [03](#)).

3.1.2 Photographic Record

The photographic record included *Understanding Historic Buildings* photographic elements 1 to 7 (Historic England, 2016: 26) and included general views of the building within the local landscape, along with exterior and interior elevations – both oblique and face-on (where practical) and a record of the overall appearance of the principal rooms and circulation areas within the interior. Camera tripods and measuring poles were used for the elevations and where practical elsewhere; artificial lighting was used for the interior if there was insufficient natural lighting/existing lighting.

Photographic images were taken using a digital SLR (Nikon D3100) camera set to maximum resolution (4928 × 3264; 16.2 effective megapixels) in RAW format. A photographic record was maintained on site using Heneb Field Services pro-formas ([Appendix II](#)) and digitised in Microsoft Excel and Access as part of the fieldwork archive and dissemination process (**E49216_001 to E49216_126**). The location and orientation of photographs taken were recorded on the site plan, (*Parc Talwrn* Drawings No. 07032024 and 14052024; [Figures 02](#) and [03](#)) and then digitised for final reporting. The photographic images were then converted to TIFF for final archiving using Canon digital photo professional software.

3.1.3 Written Record

The written record included *Understanding Historic Buildings* report elements 5, 7, 8 and 23 (Historic England, 2016: 26) and comprised of:

- the precise location of the building (NGR format) and an address;
- a note of any statutory or non-statutory designations;
- the date of when the record was made as well as the name of the recorder and location of the project archive; and
- a description of the building's form, function, date and sequence of development. The names of architects, builder, patrons and owners should be included if known.

The Level 2/3 written record was completed using a Heneb basic record pro-forma and a room record pro-forma. The basic record pro-forma as used to record the exterior and interior elevations, as well as key structural details. Key dimensions and detailed measurements were completed using hand tapes and a laser Disto device.

3.1.4 Drawn Record

Measured drawings were prepared in accordance with *Understanding Historic Buildings* drawing elements 7 and 8 (Historic England, 2016: 26). This included:

- a sketched or measured plan as existing. In this instance, the scaled plans detailed in *Parc Talwrn* Drawings 07032024 and 14052024 ([Figure 02](#) and [Figure 03](#) respectively) were used for reference and as a base plan. The plans have been annotated to show the form and location of any structural features of historic significance, e.g., blocked doorways, windows and fireplaces and any other fixtures of significance (if present).
- If the buildings showed any complex phasing and change of use, a plan was prepared for the report detailing the phasing and any layout changes; and
- A site plan relating the building to other structures within the local area.

4 RESULTS

4.1 Introduction

The level/ 2/3 building record at Parc Talwrn was completed during the 8th of April 2025 and comprised the Smallholding Residence and Buildings 1 – 8 ([Figure 02](#) and [03](#)). The objective of the survey was both to supplement previous research conducted by Frances Littlewood Chartered Engineer and to fulfil planning conditions imposed due to proposed alterations to the listed and non-listed buildings.

The smallholding is located in the village of Talwrn, set back from the main road through the village, and within the county of Ynys Môn. The following details the building record separated into their relevant sub-headings, with the photo directions available in c.f. [Figures 02](#) and [03](#).

4.2 Parc Talwrn Farmhouse: LBC/2024/4

4.2.1 Exterior

Length: 7.25m

Width: 5.40m

Height: 4.60m

Plates: 1, 2, 4, 5 and 49)

The main house consists of Rooms 1 and 2 and a croglift on the first floor above Room 2 and is of a rubble stone construction which has been rendered over (Plate 1). The southeast facing elevation forms the front of the house and has a central doorway, and two wooden framed windows positioned each side. The front door is a blue, constructed of wood and presumably had a frosted glass top half which is now boarded over. On further examination, the door is not original as it does not align with the frame, therefore a later addition, presumably to deter access whilst the house was in a poor state of repair. The window frame is completely missing from the window to the left of the front door; however, the worked slate windowsill still remains. The window to the right of the front door is still in place and has a wooden frame in place that appears to be original in addition to a worked slate windowsill (Plate 1). The external walls have been rendered with stonework visible where the mortar has fallen off. A small garden wall standing approximately a 1m high forms a small, enclosed yard in front of the house.

Two Chimneys remain standing, one in the southwest gable end and the other in the northeast gable end. The chimney pots and stacks do not match each other, suggesting they have been replaced at some time (Plate 1, 2, 5 and 49).

The roof is in poor condition with a hole near the southwest gable end and having completely collapsed near the northeast gable end, the middle section of the roof is still intact and shows the slates with what appears to be a mortar covering, the ridge tiles are still in place.

A metal water tank can be seen standing on brick-built columns to the left of window 1. This is a modern instalment (Plate 1 and 4).

4.2.2 Interior

Ground Floor

Room 1

Dimensions:

Length: 4.97m

Width: 3.95m

Height: 3.30

Plates: 34-37 & 39

Marked on the c.f. [Figure 2](#) as the principal room.

Located on the southeast wall is the main doorway and a small boarded up window, with the addition of a small partition wall with shelves separates the living space from the main doorway (Plate 34). A fireplace is located centrally on the southwest wall and is likely to date from the 1930's. The fire place composes of a white marble effect small square tile fire surround with a darker tile hearth and mantel. Located within the southern corner and next to the fireplace a small cupboard is present filling the alcove. In the western corner and on the adjacent side of the fireplace, a wooden door is present which leads into the kitchen (Room 3) (Plate 35 and 36).

A doorway is located in the northeast wall which leads through to Room 2, to the left of this doorway is the faint outline of the stairs that would have led up to the crogloft situated above Room 2, to the right of the doorway are a row of coat hooks mounted on a wooden board (Plate 37). A window is located in the northwest wall; the window looks out to Outbuilding 7 and has an exterior stone arch lintel (Plate 39). The flooring is made up of woodgrain effect linoleum tiles, and the ceiling has been removed and damaged.

Room 2

Length: 4.97m

Width: 2.07m

Height: 1.86m

Plates: 38-40

Marked on the plan as the secondary room.

This room was inaccessible due to the ceiling being partially collapsed.

Positioned on the southeast wall and visible through the doorway is a wooden four paned window frame, two of the glass panes are broken and two are missing (Plate 39).

Positioned on the northeast wall is an ornate black cast iron fireplace with a slate ornate painted fire surround with a wooden mantel and surround. Some decorations can still be seen in the form of circles, lines and flowers and the former colours having been painted (Plate 38 and 40).

The floor was not visible due to the collapsed remains of the roof and ceiling.

First Floor

Croglift

Length: N/A

Width: N/A

Height: N/A

The croglift was inaccessible but would have originally been accessed by a set of stairs leading from Room 1 up to a doorway leading into the croglift which would have been above Room 2, the stairway has been removed and the floor of the croglift has partially collapsed.

4.3 Grain store and Kitchen

4.3.1 Exterior

Length: 8m

Width: 5.4m

Height: 5m

Plates: 3-4 & 18-22

This building is of stone construction with quoin stone corners and are of random coursed construction, it is in very poor condition with the roof totally collapsed (Plate 3). The southeast elevation contains two doorways, one leading into Room 6 (Store room) and one with a window next to it leading into Room 3 (Kitchen). The doorway leading into the store room has a wooden lintel and part of the wooden door frame still present, while the wooden lintel only survives leading into the kitchen (Plate 4). The southeast wall of the storeroom has almost completely collapsed.

On the southwest elevation of the Store room (Room 6) is a stone staircase that leads up to a centrally located doorway that opens into the first-floor grain store, the staircase is constructed with course layers of stone and the south-southeast corner is of a quoin construction, the steps are large stone slabs, there is a recess built-in under the stairs this could possible of been a dog kennel (Plates 18, 19, 20 and 22).

A modern buttress has been built on the south-southeast corner of the southwest gable end to prevent the collapse of this wall (Plate 21).

At first floor level an unusual window is located in the north-northwest wall, this window has three panes of glass which sit above a bottom opening that is divided into two and has wooden shutters instead of glass this would appear to be an original window, this window looks in on the kitchen.

Outbuilding 5 abuts to the NW elevation of this building but is not keyed into it suggesting it was a later addition.

4.3.2 Interior

Ground Floor

Room 3

Length: 4.57m

Width: 2.92m

Height: 5.17m

Plates: 42-51

Marked as a kitchen on the plan.

Located on the northeast wall is the doorway leading into Room 1, the door is made of wooden planks and has three horizontal planks to stabilise the door (Plates 44, 45 and 48). A cooking range is located centrally in this wall (Plates 45 and 48). A large wooden beam runs the length of this wall and has been cut where it goes over the doorway (Plate 48). On the upper section of the southwest gable end of the main house the remains of the roof line for Room 3 can still be seen.

A doorway, window and a Belfast sink are positioned on the southeast wall (Plate 42 and 43). The floor consists of terracotta quarry tiles leading up to a slate threshold positioned on the exterior door (Plates 50 and 51). The Belfast sink is located under the window and is mounted on a red brick plinth with taps still present (Plate 43).

An unusual window is present within the northwest wall; this window has three panes of glass which sit above a bottom opening that is divided into two and has wooden shutters instead of glass this would appear to be an original window (Plate 46). The window would have originally been situated above the kitchen in the Grain Store (Room 7)

Visible on the southwest wall are the joist slots but only two of the joists still remain (Plate 46 and 47), furthermore, there is no roof present on the building (Plate 49).

Room 6

Length: N/A

Width: N/A

Height: N/A

Plates: 3, 21, 28 and 29

Room 6 is marked as a Storeroom on the plans.

This room was inaccessible due to the collapse of the roof. The former Grain store (Room 7), which was situated above has collapsed into the Storeroom. The former storeroom is a narrow rectangular room located next to the kitchen and built with local rubble stone. Located on the southwest facing external gable end are the stone steps up to the former Grain store (Room 7) (Plates 28 and 29) in addition to a modern buttress built to support the wall (Plate 21).

First Floor

Room 7

Length: N/A

Width: N/A

Height: N/A

Plates: 3 & 18-19

Room 7 is marked as a Grain store on the plans.

The room was a crog loft which covered the span of the Store Room (Room 6) and Kitchen (Room 3) below. The room was accessed by a series of stone steps present along the exterior of the southwest facing wall (Plates 18 and 19). Unfortunately, only the gable wall survives along with the stone steps and a wooden entrance door as the main roof has completely collapsed down into the rooms below (Plate 3).

4.4 Cow & Calving Shed

4.4.1 Exterior

Length: 9m

Width: 5.4m

Height: 4.3m

Plates: 2, 5, 12, 70 & 84

The southeast elevation has two doorways and one window (Plate 2). The window is positioned with views into the Cowshed with only the wooden frame remaining, and two entrance doors, one positioned either side (Plate 2). Furthermore, an additional two doors are positioned on the northwestern elevation wall, one into the Calving Shed and to the exterior into a narrow corridor besides the barn, house and outbuildings and one into the Cowshed from the Barn (Plates 12, 70 and 84), both doors positioned almost adjacent to the ones found on the south east elevation front wall.

The external walls may have one time been mortared, however, at present the stonework is visible, large quoin stones can be seen either side of both the doorways and on the northeast corner (Plate 2). The roof is made up of Welsh slate, however, at present it is slowly in decline with slates dislodged and missing (Plate 2). The slates on this roof are of a different colour to the main house and there is no evidence of mortar suggesting this roof was replaced at some point.

The northeast facing gable end of the cow shed has large quoin stones on both the northwest and southeast corners, and the wall is of a random coursed construction with some mortar remaining, the roof shows signs of previous repairs to the ridge of the wall (Plate 5).

The Calving Shed (Room 4) is separated from the Cowshed (Room 5) by an internal dividing wall, with an access door from one room to the other positioned against the southeastern wall (Plate 55). The internal doorway is unstable with only half the lintel remaining while the red wooden door and frame remains (Plate 55).

The structure as a whole is joined to the house on the southwestern side of the Calving Shed and forms a linear structure as a whole.

4.4.2 Interior

Ground Floor

Room 4

Length: 4.78m

Width: 2.63m

Height: 3.98m

Plates: 54-55 and 57-63

This room is marked on the plan as the Calving Shed.

As previously mentioned, a doorway is located on the northeast internal wall and leads through into the Cow Shed (Room 5) with half wooden lintel remaining and collapse on the other half, the wooden frame and door still remain (Plate 55 and 58). An interesting wooden partition that partially separates the room extends out from this wall, it is constructed from wooden planks and has a bench on one side that was possible used during calving or milking activities (Plate 61 and 62). The walls are of a white wash finish (Plate 59 and 60). An exterior door is located in the northwest wall and leads out into a narrow alleyway between Outbuildings 7 & 8 and the main farm buildings (Plate 54).

A beam extends from the northeast wall across the room and into the southwest wall this could possible been to support a floor for a small loft space (Plate 57). The roof remains intact on the southeast side of the building but has collapsed on the north-northwest side, the roof is slated and has evidence of once having been mortared on the inside possible to prevent drafts (Plate 63).

Room 5

Length: 5.37m

Width: 4.68m

Height: 4.19m

Plates: 2, 65-75

Marked on the plans as a Cow Shed.

The Cow Shed has a doorway positioned on the southeast elevation along with a single window (Plate 2 and 71 and 72). On the adjacent northwest elevation wall an additional door is present leading into a narrow alleyway between the building and outbuilding 8, the wooden lintel and frame are in-situ, but the door is missing (Plate 65 to 69).

This room has two cattle stalls located in the centre of the room, these are of concrete construction, with a feed trough and three metal bars running across the rear of the stalls, a sunken channel runs in front of the cattle stalls and would have been used to clean away the waste (Plate 66 and 67). A small alleyway runs between the back of the cattle stalls and the northwest wall of the building which would have been used to hold hay whilst milking (Plate 70).

The slate roof is partly intact, although there is a fairly substantial hole on the northwest side of the roof. The slates have been rendered in mortar on the inside similar to Room 4 (Plate 65 and 73-75). An A frame is located centrally in the room running from the Southeast to the Northwest wall to support the roof, the A frame is pinned together with metal fittings (Plate 75).

4.5 Outbuilding No.1 & 2: LBC/2024/4

4.5.1 Exterior

Length: 11.8m

Width: 3.14m

Height: 3.2m

Plates: 31-33

A long narrow rectangular rubble stone-built building that is marked on the plans as a Dairy and a Pigsty. The roof of the Dairy has been blown off in recent storms and was constructed with corrugated iron sheets. While the roof of the pigsty has collapsed and appears to of been a slate roof (Plates 31 to 33).

There are no doors or windows remaining intact in this building. And the floors are buried beneath accumulated soil and debris.

4.5.2 Interior

Room 13

Length: 6.18m

Width: 2.47m

Height: 3.2m

Plates: 99-103

This room is long and narrow and is marked on the plans as a former Dairy, however the outbuilding was likely for other purposes, as the interior of the room is far too narrow for milking (Plate 103). The roof consisted of corrugated sheets which was likely a modern replacement for slates. The roof is no longer extant and according to the owner was damaged in a recent storm.

Positioned on the northwest wall, two stones which jut out (Plate 100) these are likely to support a possible former roof structure or partitions. In addition, metal fixings could also be seen attached to the wall (Plate 99 and 100). Furthermore, additional metal fixtures are present on the adjacent southwest wall (Plate 101 and 102). The walls have not been rendered

or painted and show the construction type of rough field stone bonded with mortar. The floor has been removed in the past and is now covered in debris.

Room 14 and 15

Length: 5.10m

Width: 2.03m

Height: N/A

Plates: 104

This room is marked as a pigsty on the plans.

Separated into two rooms by a stone wall with later brick addition a doorway would have separated the sleeping and feeding areas of the pigsty. The feeding area measures 2.06m wide and 2.77m long, built into the southwest wall are feeding troughs.

The sleeping area measures 2.06m wide and 2.77m long, it is a plain room with no special features. The roof would have been slated at one point but has now collapsed and the floor was not visible due to all the debris covering it.

4.6 Outbuilding No.3: LBC/2024/4

4.6.1 Exterior

Length: 4.25m

Width: 3.8m

Height: 3.48m

Plates: 23, 27-30,

A random coursed rubble stone with red brick inclusions building with quoin stone corners currently being used as a storeroom (Plate 23). The building has modern patches of cementitious mortar repairs. The doorway is positioned within the northwestern elevation wall and consists of a wooden lintel, frame and panelled door in-situ (Plate 28). A wooden window and frame with six lights are present within the southwest elevation wall, with accompanying slate lintel and sill (Plate 27). The northeast elevation has a small slate grate inclusion (Plate 29 and 30).

4.6.2 Interior

Length: 2.84m

Width: 2.73

Height: 3.22m

Plates: 96-98

The interior walls are limewashed and the building is currently being used as a storeroom (Plates 96 and 97). The roof is constructed with corrugated fibre cement / asbestos sheeting resting onto two sets of purlins, located on each side of the eaves. The floor is made up of concrete (Plate 98).

4.7 Outbuilding No.4: LBC/2024/4

4.7.1 Exterior

Length: 2.9m

Width: 2.48m

Height: 2m

Plates: 23-26

A crudely constructed square, red brick-built lean-to that has been added onto the southwest wall of Outbuilding 3 (Plate 23). The entranceway was situated in the southwest wall, however, has currently collapsed (Plate 24). Furthermore, there are no windows present, and the roof is made up of steel corrugated sheeting which has collapsed into the structure (Plate 24). The building as a whole is a modern addition added in recent times (Plate 25 and 26).

4.7.2 Interior

Length: 2.13m

Width: 1.76m

Height: 2m

Plates: 23-24 & 94

The interior was at the time full of the occupants affects (Plates 23-24 and 94)

4.8 Outbuilding No.5: LBC/2024/4

4.8.1 Exterior

Length: 5.10m

Width: 4.88m

Height: 1.82m

Plates: 11,17,19

A random coursed rubble stone-built building, situated between the Grain Store and Outbuilding 6. There are two doorways one situated in the northeast wall and one in the southwest wall, with no windows present in this building (Plate 11 and 17). The roof is constructed with corrugated iron sheets and has completely collapsed into the room below. Visible on the southwest wall are three metal bars fixed into the wall, these are believed to be for securing the roof against heavy wind and could be original fixtures.

On closer examination, the building is a later addition as it is not tied into the Grain Store and Outbuilding 6 despite being constructed with similar materials (Plate 17).

4.8.2 Interior

Length: 4.94m

Width: 4.14

Height: N/A

Plates: 93

This room was inaccessible at the time due to the collapsed roof, the interior was very overgrown, and the floor was obscured by this overgrowth and the remains of the roof (Plate 93).

4.9 Outbuilding No.6: LBC/2024/4

4.9.1 Exterior

Length: 5m

Width: 4.5m

Height: 2.92m

Plates: 10,16, 19 and 85

A random coursed square rubble stone-built building marked as Storeroom on the plans (Plate 16). The building has large quoin stones on the corners, a single door and window (Plate 10). The entrance is via the door located on the northeast elevation wall with the wooden lintel and frame still in place, with a wooden latch on the located on the inside (Plate 85). The window is present next to the door, of which only the frame survives (Plate 10). The roof consists of Welsh slate and is currently in poor condition, with many slates missing and roof collapse present in patches. The building has a single slanting roof design (Plate 19).

4.9.2 Interior

Length: 4.14m

Width: 3.72m

Height: 2.68m

Plates: 86-92

A square storeroom, the walls show evidence of once being limewashed, the roof beams are in poor condition but are probably original with the addition of an old plough that is positioned against the southwest facing elevation wall (Plates 86-92).

4.10 Outbuilding No.7: LBC/2024/4

4.10.1 Exterior

Length: 4.6m

Width: 4.7m

Height: 1.9m

Plates: 9, 12

A brick-built lean-to abutting to the southwest elevation of Outbuilding 8, it forms a small square storeroom with a low ceiling level (Plate 9). The access is via a door positioned on the southwest elevation wall with the addition of a window positioned in the northeast wall elevation wall towards the northeast corner. The window has a wooden frame but there is no pane of glass only a mesh grill over the window (Plate 12).

4.10.2 Interior

Length: 4.78m

Width: 3.24m

Height: N/A

Plates: 83

This room was not entered due to the roof being partially collapsed and the room being used as storage. The room is divided into two sections by a small 1m high wall with a gateway within (Plates 83). The roof comprises of steel corrugated sheeting and the floor is comprised of concrete.

4.11 Outbuilding No.8: LBC/2024/4

4.11.1 Exterior

Length: 13.2m

Width: 5.15m

Height: 5.22m

Plates: 6-9 & 79 and 80

A large rectangular shaped barn situated at the rear of the house and cowshed. The barn is constructed with bonded rubble stone, with large quoin stones on each corner. There are three large openings in the northwest wall, the central one remains open with stones lining the threshold, while the opening situated in the northern corner is partially blocked, and the northwest corner entrance has been completely blocked up using rubble stone and mortar (Plate 8, 9, 79 and 80). The openings both present and previous are mirrored in the southeast wall. The openings measure 2.09m wide by 3.09m high. An additional opening is present on the northeast gable end of the barn (Plate 6). The roof is constructed using corrugated iron sheets.

4.11.2 Interior

Length: 13.75m

Width: 4.57m

Height: 5m

Plates: 76-78 & 81-82

An opening is situated in the northeastern facing elevation wall which is currently blocked up with corrugated iron sheets (Plate 6 and 76). The entrance hatch at the top of a barn is where they would load hay from. Positioned on the southwest wall there are nine round holes some containing clay pipe likely used for ventilation for the hay and straw.

The roof is made up of corrugated iron sheets supported on the walls and by a central wooden 'A' frame that supports four large wooden purlin beams that span the length of the barn (Plates 81 and 82). The floor of the barn consists of beaten earth.

CONCLUSION

Heneb Field Services was commissioned by Mr & Mrs Parry to undertake archaeological mitigation in the form of a Level 2/3 Building Record prior to property development works at Parc, Talwrn, Ynys Môn. The building record was undertaken during the 8th of April 2025.

Parc Farm is a mid-19th-century farmstead consisting of the main farmhouse with an attached calving and cow shed to the northeast, a grain store and kitchen and outbuildings to the southwest, pigsty and storeroom to the southeast and a hay barn to the northwest. Parc farm is first named on the 1889 Ordnance Survey 25-inch map. However, by examining the 1840 Llanddyfan parish tithe map, it appears to be miss aligned and a building believed to be Parc does appear on the tithe map 1840's. This is strengthened by an examination of the census records which shows the inhabitants interchanging between Bryn Ffynon and Parc, suggesting that Parc was also known by another name.

The Level 2/3 building recording shows that Parc Farm generally dates from this period and is a good example of a 19th century farmstead. The construction of the walls from rough fieldstones, rendering, limewashed walls and Welsh slate roofing are typical of farmsteads of this period elsewhere in the county.

The farmstead appears to have been altered throughout the years. This is shown particularly with the addition of outbuildings appearing from the Second to Third Edition Ordnance Survey maps published 1899 and 1920 (25-inch to 1-mile). The expansion of the farm throughout the years, from the linear plan small farmstead of the First Edition to the mix courtyard style of the Second into Third Editions, shows the development of agricultural practices, expansion and the introduction of machinery. Furthermore, a change from dairy to beef cattle or sheep could influence the need for further auxiliary buildings and the importance of being owned within the same family, constantly adapting to their needs over the years. Historical pictures of parc also shows alterations to the main linear plan with the raising of the calving shed / cowhouse roof in line with the main house.

The farmhouse has also been subject to many alterations over the years, with the addition of a 1930's style fireplace, airing cupboard and a laminate styled flooring in Room 1, and internal fixtures and fittings which have been replaced. Externally there is the addition of a later water tank supported on brick columns on the Southeast elevation and the chimney pots do not match suggesting these have been replaced at some point.

Many of the original features in the interior of the farmhouse have been lost, but there are some features such as the cast iron fireplace with decorated slate surround in Room 2. Externally on the Southwest facing elevation is a window opening that looks into Room 1 that has a stone arched lintel, and the slate windowsills still survive.

5 SOURCES CONSULTED

1. Benwell, A., Hughes, M. and Orme, O. (2000) Stori'r Talwrn. Talwrn archaeological group;
2. Chartered Institute for Archaeologists, 2020, Standard and Guidance for the Archaeological Investigation and Recording of Standing Buildings or Structures;
3. Chartered Institute for Archaeologists, 2020, Standard and Guidance for the Collection, Documentation, Conservation and Research of Archaeological Materials;
4. Chartered Institute for Archaeologists, 2023, Standard for Archaeological Monitoring & Recording;
5. English Heritage, 1991, Management of Archaeological Projects (MAP2);
6. Henderson, K. 2024. Heritage Impact Statement: Parc and associated outbuildings, Talwrn. Henderson Heritage;
7. Heneb: The Trust for Welsh Archaeology, 2024, Guidance for the Submission of Data to the Heneb Historic Environment Record (HER) Version 4.1;
8. Historic England, 2015, Management of Research Projects in the Historic Environment (MoRPHE);
9. Historic England, 2016. Understanding Historic Buildings: A Guide to Good Recording Practice;
10. Littlewood, F. 2024. Outbuildings Survey and Work Scope for Listed Building Consent. Frances Littlewood Chartered Engineer;
11. Royal Commission on Ancient and Historic Monuments of Wales, 2015, Guidelines for digital archives;
12. Unpublished Letter from Meilyr Powel to Keith Williams, 21st March 2024

Websites

1. [Listed Buildings - Full Report - HeritageBill Cadw Assets - Reports](#) (Accessed 06/05/2025); and
2. www.ancestry.co.uk (Accessed 06/05/2025).

PLATES

Plate 1: Exterior - View of main house WNW facing elevation (front); scale 1x1m; view from ESE (archive reference: E49216_01).

Plate 2: Exterior - View of cow and calving Shed (R4 & R5); scale 1x1m; view from ESE (archive reference: E49216_02).

Plate 3: Exterior - View of storeroom (R6); scale 1x1m; view from SE (archive reference: E49216_04).

Plate 4: Exterior - View of kitchen (R3); scale 1x1m; view from SE (archive reference: E49216_05).

Plate 5: Exterior - NE elevation of the cow shed (R5); scale 1x1m; view from NE (archive reference: E49216_06).

Plate 6: Exterior - NE elevation of the barn (OB8); scale 1x1m; view from NE (archive reference: E49216_07).

Plate 7: Exterior - NW elevation of the barn (OB8); scale 1x1m; view from NW (archive reference: E49216_08).

Plate 8: Exterior - NW elevation of the barn showing blocked up opening (OB8); scale 1x1m; view from NW (archive reference: E49216_09).

Plate 9: Exterior - NW elevation of storeroom (OB7); scale 1x1m; view from NW (archive reference: E49216_10).

Plate 10: Exterior - N elevation of storeroom (OB6); scale 1x1m; view from N (archive reference: E49216_11).

Plate 11: Exterior - View of N facing elevation storeroom showing doorway and wooden lintel (OB5); scale 1x1m; view from N (archive reference: E49216_13).

Plate 12: Exterior - View down narrow alley between the main house and the barn; scale 1x1m; view from SSW (archive reference: E49216_14).

Plate 13: Exterior - View of stone arch above window 4 looking into R1; scale not used; view from WSW (archive reference: E49216_15).

Plate 14: Exterior - View of an original window with wooden frame, 3 panes of glass above a shuttered bottom opening previously removed (rear); scale 1x1m; view from N (archive reference: E49216_20).

Plate 15: Exterior - View of an original window with wooden frame, 3 panes of glass above a shuttered bottom opening previously removed (front); scale 1x1m; view from N (archive reference: E49216_22).

Plate 16: Exterior - View of SSW facing elevation of OB 6; scale 1x1m; view from SSW (archive reference: E49216_23).

Plate 17: Exterior - View of SSW facing elevation of OB 5; scale 1x1m; view from SSW (archive reference: E49216_24).

Plate 18: Exterior - View of SSW elevation of storeroom (R6) and stairs lead up to storeroom (R7); scale 1x1m; view from SSW (archive reference: E49216_26).

Plate 19: Exterior - View showing entire SSW facing elevation; scale 1x1m; view from SSW (archive reference: E49216_27).

Plate 20: Exterior - Possible dog kennel built into the stairs leading up to (R7); scale 1x1m; view from SSW (archive reference: E49216_28).

Plate 21: Exterior - View of modern buttress built to support SSW gable end of R6 and R7; scale 1x1m; view from SSW (archive reference: E49216_30).

Plate 22: Exterior - Stone stairs leading up to R7; scale 1x1m; view from ESE (archive reference: E49216_31).

Plate 23: Exterior - View of W elevation of OB 3; scale 1x1m; view from W (archive reference: E49216_33).

Plate 24: Exterior - View of W elevation of OB 4; scale 1x1m; view from W (archive reference: E49216_34).

Plate 25: Exterior - S facing elevation of OB4; scale 1x1m; view from SW (archive reference: E49216_35).

Plate 26: Exterior - E facing elevation of OB4; scale 1x1m; view from SE (archive reference: E49216_36).

Plate 27: Exterior - Window in OB3 showing slate lintel and sill; scale not used; view from W (archive reference: E49216_37).

Plate 28: Exterior - N facing elevation OB3; scale 1x1m; view from N (archive reference: E49216_38).

Plate 29: Exterior - E facing elevation OB3; scale 1x1m; view from E (archive reference: E49216_39).

Plate 30: Exterior - Close-up shot of slate grate in E facing elevation of OB3; scale not used; view from E (archive reference: E49216_40).

Plate 31: Exterior - SW facing elevation of OB1; scale 1x1m; view from SW (archive reference: E49216_41).

Plate 32: Exterior - View Showing E facing elevation of OB1 and OB2; scale 1x1m; view from SE (archive reference: E49216_42).

Plate 33: Exterior - View of N facing elevation of OB1; scale 1x1m; view from N (archive reference: E49216_43).

Plate 34: Interior - View of ESE interior wall of R1; scale 1x1m; view from WNW (archive reference: E49216_45).

Plate 35: Interior - View of WNW interior wall of R1; scale 1x1m; view from ESE (archive reference: E49216_46).

Plate 36: Interior - View of SSW interior wall of R1; scale 1x1m; view from NNE (archive reference: E49216_47).

Plate 37: Interior - View of NNE interior wall of R1; scale 1x1m; view from SSW (archive reference: E49216_48).

Plate 38: Interior - Original fireplace in NNE wall of R2; scale 1x1m; view from SW (archive reference: E49216_50).

Plate 39: Interior - View of window in ESE wall of R2; scale not used; view from W (archive reference: E49216_54).

Plate 40: Interior - View showing collapsed ceiling in R2; scale not used; view from SW (archive reference: E49216_55).

Plate 41: Interior - Cast iron sky light; scale 1x1m; view from SW (archive reference: E49216_56).

Plate 42: Interior - View showing D10 and W5 in the ESE wall of R3; scale 1x1m; view from WNW (archive reference: E49216_57).

Plate 43: Interior - View of stone sink and W5 in ESE wall of R3; scale 1x1m; view from W (archive reference: E49216_58).

Plate 44: Interior - NE wall of R3 showing cooking range; scale not used; view from W (archive reference: E49216_59).

Plate 45: Interior - View showing wooden beam running across the NE wall of R3; scale not used; view from S (archive reference: E49216_60).

Plate 46: Interior - Wooden joists and WNW wall of R3; scale not used; view from SE (archive reference: E49216_61).

Plate 47: Interior - View of SSW wall of R3 showing joist slots; scale 1x1m; view from N (archive reference: E49216_63).

Plate 48: Interior - View of D3 leading from R3 to R2; scale 1x1m; view from SW (archive reference: E49216_64).

Plate 49: Interior - View of upper section of NE wall of R3; scale not used; view from S (archive reference: E49216_65).

Plate 50: Interior - View of quarry tiled floor in R3; scale 1x1m; view from WNW (archive reference: E49216_66).

Plate 51: Interior - Slate threshold in D10 of R3; scale not used; view from WNW (archive reference: E49216_67).

Plate 52: Exterior - View showing stable door (D2) leading into R4; scale 1x1m; view from SE (archive reference: E49216_68).

Plate 53: Interior - View of stable door (D2) and ESE wall of R4; scale 1x1m; view from WNW (archive reference: E49216_69).

Plate 54: Interior - View of WNW wall of R4 Showing D6; scale 1x1m; view from ESE (archive reference: E49216_70).

Plate 55: Interior - View of D11 leading from R4 into R5; scale 1x1m; view from SW (archive reference: E49216_71).

Plate 56: Interior - View of NE wall of R4; scale 1x1m; view from S (archive reference: E49216_72).

Plate 57: Interior - View of NE wall of R4 upper section; scale not used; view from SW (archive reference: E49216_73).

Plate 58: Interior - View of NE wall of R4 upper section; scale not used; view from SW (archive reference: E49216_74).

Plate 59: Interior - View of SW wall of R4; scale not used; view from NW (archive reference: E49216_75).

Plate 60: Interior - View of SW wall of R4; scale 1x1m; view from E (archive reference: E49216_76).

Plate 61: Interior - View of wooden partition in R4; scale 1x1m; view from SE (archive reference: E49216_77).

Plate 62: Interior - Other side of wooden partition in R4 showing a small bench; scale 1x1m; view from W (archive reference: E49216_78).

Plate 63: Exterior - Remains of the roof in R4; scale not used; view from WNW (archive reference: E49216_79).

Plate 64: Interior - View of D4 leading into R5; scale 1x1m; view from E (archive reference: E49216_80).

Plate 65: Interior - SW wall of R5; scale 1x1m; view from NE (archive reference: E49216_81).

Plate 66: Interior - WNW wall of R5 showing cattle stalls; scale 1x1m; view from SE (archive reference: E49216_82).

Plate 67: Interior - WNW wall of R5 showing cattle stalls; scale 1x1m; view from SE (archive reference: E49216_83).

Plate 68: Interior - WNW wall of R5 showing cattle stalls; scale 1x1m; view from SE (archive reference: E49216_84).

Plate 69: Interior - View NNE wall of R5; scale 1x1m; view from SW (archive reference: E49216_85).

Plate 70: Interior - View looking down alley behind cattle stalls in R5; scale not used; view from NE (archive reference: E49216_86).

Plate 71: Interior - View of ESE wall showing D4 and W3 in R5; scale 1x1m; view from NW (archive reference: E49216_87).

Plate 72: Interior - View of ESE wall showing W3; scale 1x1m; view from NW (archive reference: E49216_88).

Plate 73: Interior - View of roof in R5; scale not used; view from E (archive reference: E49216_89).

Plate 74: Interior - View of roof in R5; scale not used; view from WNW (archive reference: E49216_90).

Plate 75: Interior - View of wooden A frame in roof of R5; scale not used; view from SW (archive reference: E49216_91).

Plate 76: Interior - View of N wall of OB8 Showing window; scale not used; view from SSW (archive reference: E49216_92).

Plate 77: Interior - View of S wall of OB8; scale not used; view from NNE (archive reference: E49216_93).

Plate 78: Interior - View showing blocked up opening in W wall of OB8; scale not used; view from SE (archive reference: E49216_94).

Plate 79: Exterior - View down narrow alley between main house and OB8; scale 1x1m; view from SSW (archive reference: E49216_95).

Plate 80: Exterior - Stones across central opening to OB8; scale 1x1m; view from WNW (archive reference: E49216_96).

Plate 81: Interior - Roof of OB8; scale not used; view from SSW (archive reference: E49216_97).

Plate 82: Interior - Roof of OB8; scale not used; view from NNE (archive reference: E49216_98).

Plate 83: Interior - Shot through doorway looking into OB7; scale not used; view from SW (archive reference: E49216_99).

Plate 84: Exterior - View of wooden door of OB6 possible original; scale 1x1m; view from NW (archive reference: E49216_100).

Plate 85: Interior - Wooden latch on back of door of OB6; scale not used; view from SSW (archive reference: E49216_101).

Plate 86: Interior - S wall of OB6; scale 1x1m; view from NE (archive reference: E49216_102).

Plate 87: Interior - E wall of OB6; scale 1x1m; view from WNW (archive reference: E49216_103).

Plate 88: Interior - W wall of OB6; scale 1x1m; view from ESE (archive reference: E49216_104).

Plate 89: Interior - N wall of OB6 showing window and door; scale 1x1m; view from NNE (archive reference: E49216_105).

Plate 90: Interior - Roof of OB6; scale not used; view from NE (archive reference: E49216_106).

Plate 91: Interior - Plough in OB6; scale not used; view from WNW (archive reference: E49216_107).

Plate 92: Interior - Pulleys in OB6; scale 1x1m; view from E (archive reference: E49216_108).

Plate 93: Interior - View inside OB5; scale not used; view from SW (archive reference: E49216_109).

Plate 94: Interior - View of OB4; scale 1x1m; view from ESE (archive reference: E49216_111).

Plate 95: Interior - Collapsed wall of OB4 View through doorway looking into OB3; scale 1x1m; view from ESE (archive reference: E49216_112).

Plate 96: Interior - View through doorway looking into OB3; scale not used; view from NE (archive reference: E49216_113).

Plate 97: Interior - View through doorway looking into OB3; scale not used; view from NE (archive reference: E49216_114).

Plate 98: Interior - Roof of OB3; scale not used; view from NE (archive reference: E49216_115).

Plate 99: Interior - View of N wall of OB1; scale 1x1m; view from W (archive reference: E49216_116).

Plate 100: Interior - View of metal fittings and two stones jutting out of the N wall of OB1; scale not used; view from W (archive reference: E49216_117).

Plate 101: Interior - View of S wall of OB1; scale 1x1m; view from N (archive reference: E49216_118).

Plate 102: Interior - View of metal fittings on S wall of OB1; scale not used; view from N (archive reference: E49216_119).

Plate 103: Interior - View of E wall of OB1; scale not used; view from WNW (archive reference: E49216_120).

Plate 104: Interior - View of interior of OB2; scale not used; view from ESE (archive reference: E49216_121).

Plate 105: Exterior - Location shot showing W facing elevation of Parc; scale not used; view from NNW (archive reference: E49216_122).

Plate 106: Exterior - Location shot showing N facing elevation of Parc; scale not used; view from NNE (archive reference: E49216_123).

Plate 107: Exterior - Location shot showing E facing elevation of Parc; scale not used; view from E (archive reference: E49216_124).



Plate 1: Exterior - View of main house SE facing elevation (front); scale 1x1m;
view from SE (archive reference: E49216_01).



Plate 2: Exterior - View of cow and calving Shed (R4 & R5); scale 1x1m;
view from ESE (archive reference: E49216_02).



Plate 3: Exterior - View of storeroom (R6); scale 1x1m; view from SE (archive reference: E49216_04).



Plate 4: Exterior - View of kitchen (R3); scale 1x1m; view from SE (archive reference: E49216_05).



Plate 5: Exterior - NE elevation of the cow shed (R5); scale 1x1m;
view from NE (archive reference: E49216_06).



Plate 6: Exterior - NE elevation of the barn (OB8); scale 1x1m;
view from NE (archive reference: E49216_07).



Plate 7: Exterior - NW elevation of the barn (OB8); scale 1x1m;
view from NW (archive reference: E49216_08).



Plate 8: Exterior - NW elevation of the barn showing blocked up opening (OB8); scale 1x1m;
view from NW (archive reference: E49216_09).



Plate 9: Exterior - NW elevation of storeroom (OB7); scale 1x1m;
view from NW (archive reference: E49216_10).



Plate 10: Exterior - NE elevation of storeroom (OB6); scale 1x1m;
view from NE (archive reference: E49216_11).



Plate 11: Exterior - View of N facing elevation storeroom showing doorway and wooden lintel (OB5); scale 1x1m; view from NE (archive reference: E49216_13).



Plate 12: Exterior - View down narrow alley between the main house and the barn; scale 1x1m; view from SW (archive reference: E49216_14).



Plate 13: Exterior - View of stone arch above window 4 looking into R1; scale not used; view from NW (archive reference: E49216_15).



Plate 14: Exterior - View of an original window with wooden frame, 3 panes of glass above a shuttered bottom opening previously removed (rear); scale 1x1m; view from NE (archive reference: E49216_20).



Plate 15: Exterior - View of an original window with wooden frame, 3 panes of glass above a shuttered bottom opening previously removed (front); scale 1x1m; view from NE (archive reference: E49216_22).



Plate 16: Exterior - View of SSW facing elevation of OB 6; scale 1x1m; view from SW (archive reference: E49216_23).



Plate 17: Exterior - View of SSW facing elevation of OB 5; scale 1x1m; view from SW (archive reference: E49216_24).



Plate 18: Exterior - View of SW elevation of storeroom (R6) and stairs lead up to storeroom (R7); scale 1x1m; view from SW (archive reference: E49216_26).



Plate 19: Exterior - View showing entire south facing elevation of OB5, OB6, Store Room and Grain Store (archive reference: E49216_27).



Plate 20: Exterior - Possible dog kennel built into the stairs leading up to (R7); scale 1x1m; view from S (archive reference: E49216_28).



Plate 21: Exterior - View of modern buttress built to support SW gable end of R6 and R7; scale 1x1m; view from SW (archive reference: E49216_30).



Plate 22: Exterior - View of stone stairs leading up to Grain Store (R7); scale 1x1m; view from NW (archive reference: E49216_31).



Plate 23: Exterior - View of NW elevation of OB3; scale 1x1m; view from W (archive reference: E49216_33).



Plate 24: Exterior - View of NW elevation of OB 4 showing roof collapsed into R17; scale 1x1m; view from NW (archive reference: E49216_34).



Plate 25: Exterior - SW facing elevation of OB4; scale 1x1m; view from SW (archive reference: E49216_35).



Plate 26: Exterior - E facing elevation of OB4; scale 1x1m; view from SE (archive reference: E49216_36).



Plate 27: Exterior - Window in OB3 showing slate lintel and sill; scale not used; view from NW (archive reference: E49216_37).



Plate 28: Exterior - NE facing elevation OB3; scale 1x1m; view from NE (archive reference: E49216_38).



Plate 29: Exterior - E facing elevation OB3; scale 1x1m; view from E (archive reference: E49216_39).



Plate 30: Exterior - Close-up shot of slate grate in E facing elevation of OB3; scale not used; view from E (archive reference: E49216_40).



Plate 31: Exterior - SW facing elevation of OB1; scale 1x1m;
view from SW (archive reference: E49216_41).



Plate 32: Exterior - View Showing SE facing elevation of OB1 and OB2; scale 1x1m;
view from SE (archive reference: E49216_42).



Plate 33: Exterior - View of NE facing elevation of OB1; scale 1x1m;
view from NE (archive reference: E49216_43).



Plate 34: Interior - View of SE interior wall of R1; scale 1x1m;
view from NW (archive reference: E49216_45).



Plate 35: Interior - View of NW interior wall of R1; scale 1x1m;
view from SE (archive reference: E49216_46).



Plate 36: Interior - View of SW interior wall of R1; scale 1x1m;
view from NE (archive reference: E49216_47).



Plate 37: Interior - View of NE interior wall of R1; scale 1x1m;
view from SW (archive reference: E49216_48).



Plate 38: Interior - Original fireplace in NE wall of R2; scale 1x1m;
view from SW (archive reference: E49216_50).



Plate 39: Interior - View of window in SE wall of R2; scale not used; view from W (archive reference: E49216_54).



Plate 40: Interior - View showing collapsed ceiling in R2; scale not used; view from SW (archive reference: E49216_55).



Plate 41: Interior - Cast iron sky light; scale 1x1m;
view from SW (archive reference: E49216_56).



Plate 42: Interior - View showing door and window in the SE wall of R3; scale 1x1m;
view from NW (archive reference: E49216_57).

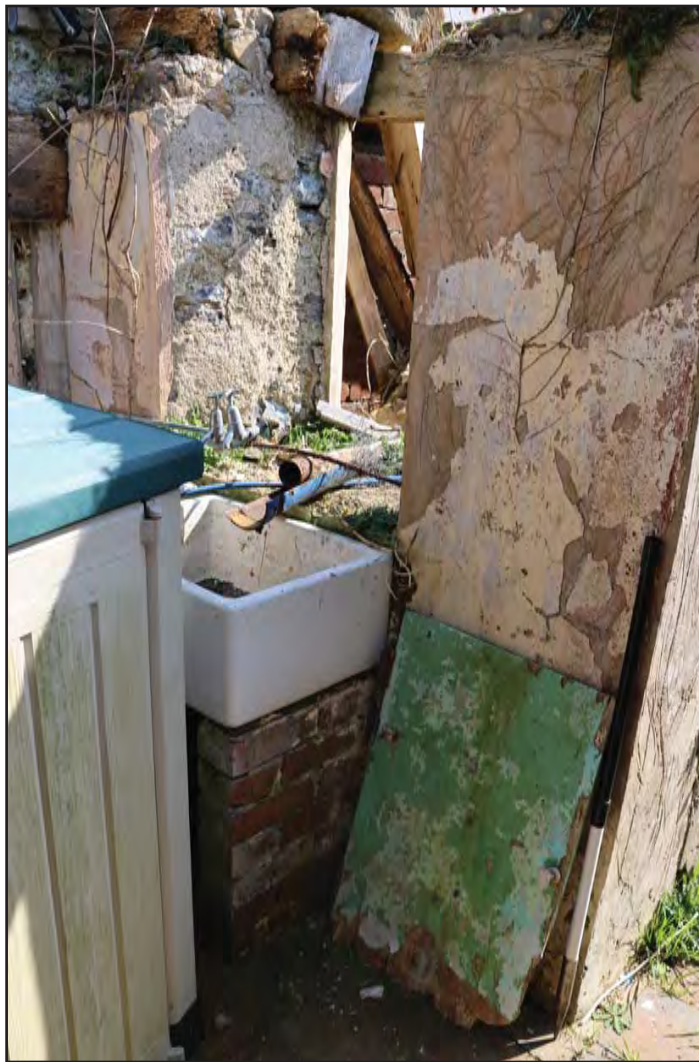

Plate 43: View of Belfast sink and window on SE wall of R3; scale 1x1m; view from W (archive reference: E49216_58).



Plate 44: Interior - View of NE wall of R3 showing cooking range; view from W (archive reference: E49216_59).



Plate 45: Interior - View showing wooden beam running across the NE wall of R3; scale not used; view from S (archive reference: E49216_60).



Plate 46: Interior - View of wooden joists and NW wall of R3, also showing window of Grain Store R7; scale not used; view from SE (archive reference: E49216_61).



Plate 47: Interior - View of SW wall of R3 showing joist slots; scale 1x1m; view from N (archive reference: E49216_63).



Plate 48: Interior - View of wooden door leading from R3 to R2; scale 1x1m; view from SW (archive reference: E49216_64).



Plate 49: Interior - View of upper section of NE wall of R3; scale not used; view from SW (archive reference: E49216_65).



Plate 50: Interior - View of quarry tiled floor in R3; scale 1x1m; view from NW (archive reference: E49216_66).



Plate 51: Interior - Slate threshold in entranceway of R3; scale not used; view from NW (archive reference: E49216_67).



Plate 52: Exterior - View showing stable door leading into R4; scale 1x1m; view from SE (archive reference: E49216_68).



Plate 53: Interior - View of stable door and SE wall of R4; scale 1x1m; view from NW (archive reference: E49216_69).



Plate 54: Interior - View of NW wall of R4 showing rear door; scale 1x1m; view from SE (archive reference: E49216_70).



Plate 55: Interior - View of internal door leading from R4 into R5; scale 1x1m; view from SW (archive reference: E49216_71).



Plate 56: Interior - View of NE internal wall of R4; scale 1x1m; view from S (archive reference: E49216_72).



Plate 57: Interior - View of NE wall of R4 upper section; scale not used; view from SW (archive reference: E49216_73).



Plate 58: Interior - View of NE wall of R4 upper section; scale not used; view from SW (archive reference: E49216_74).



Plate 59: Interior - View of SW wall of R4; scale not used; view from N (archive reference: E49216_75).



Plate 60: Interior - View of SW wall of R4; scale 1x1m; view from E (archive reference: E49216_76).



Plate 61: Interior - View of wooden partition in R4; scale 1x1m; view from SE (archive reference: E49216_77).



Plate 62: Interior - View of NW side of wooden partition in R4 showing a small bench; scale 1x1m; view from NW (archive reference: E49216_78).



Plate 63: Exterior - Remains of the roof in R4; scale not used; view from NW (archive reference: E49216_79).



Plate 64: Interior - View of front entrance door leading into R5; scale 1x1m; view from E (archive reference: E49216_80).



Plate 65: Interior - View of SW wall and milking stalls in R5; scale 1x1m; view from NE (archive reference: E49216_81).



Plate 66: Interior - WNW wall of R5 showing cattle stalls; scale 1x1m; view from SE (archive reference: E49216_82).



Plate 67: Interior - WNW wall of R5 showing cattle stall; scale 1x1 m; view from SE (archive reference: E49216_83).



Plate 68: Interior - WNW wall of R5 showing cattle stalls and rear exit door on NW wall; scale 1x1 m; view from SE (archive reference: E49216_84).



Plate 69: Interior - View of NE wall of R5; scale 1x1m; view from SW (archive reference: E49216_85).



Plate 70: Interior - View looking down alley behind cattle stalls in R5; scale not used; view from NE (archive reference: E49216_86).



Plate 71: Interior - View of SE wall showing front entrance door and window in R5; scale 1x1m; view from NW (archive reference: E49216_87).



Plate 72: Interior - View of SE wall showing window and internal door through to R4 from R5; scale 1x1m; view from NW (archive reference: E49216_88).



Plate 73: Interior - View of roof in R5; scale not used; view from E (archive reference: E49216_89).



Plate 74: Interior - View of roof in R5; scale not used; view from NW (archive reference: E49216_90).



Plate 75: Interior - View of wooden A frame in roof of R5; scale not used; view from SW (archive reference: E49216_91).



Plate 76: Interior - View of NE wall of OB8 Showing loading window; scale not used; view from SW (archive reference: E49216_92).



Plate 77: Interior - View of S wall of OB8; scale not used; view from NNE (archive reference: E49216_93).



Plate 78: Interior - View showing blocked up opening in NW wall of OB8; scale not used; view from SE (archive reference: E49216_94).



Plate 79: Exterior - View down narrow alley between main house and OB8; scale 1x1m; view from SW (archive reference: E49216_95).



Plate 80: Exterior - Stones across central opening to OB8; scale 1x1m; view from WNW (archive reference: E49216_96).



Plate 81: Interior - Roof of OB8; scale not used; view from SW (archive reference: E49216_97).



Plate 82: Interior - Roof of OB8; scale not used; view from NE (archive reference: E49216_98).



Plate 83: Interior - View through doorway looking into OB7; scale not used; view from SW (archive reference: E49216_99).



Plate 84: Exterior - View of wooden door of OB6 possible original; scale 1x1m; view from N (archive reference: E49216_100).



Plate 85: Interior - Wooden latch on back of door of OB6; scale not used; view from SW (archive reference: E49216_101).



Plate 86: Interior - View of SW wall of OB6; scale 1x1m; view from NE (archive reference: E49216_102).



Plate 87: Interior - View of SE wall of OB6; scale 1x1m; view from NW (archive reference: E49216_103).



Plate 88: Interior - View of NW wall of OB6; scale 1x1m; view from SE (archive reference: E49216_104).



Plate 89: Interior - View of NE wall of OB6 showing window and access door; scale 1x1m; view from SW (archive reference: E49216_105).



Plate 90: Interior - Roof collapse in OB6; scale not used; view from NE (archive reference: E49216_106).



Plate 91: Interior - View of vintage plough in OB6; scale not used; view from N (archive reference: E49216_107).



Plate 92: Interior - Pulleys in OB6; scale 1x1m; view from E (archive reference: E49216_108).



Plate 93: Interior - View inside OB5; scale not used; view from NE (archive reference: E49216_109).



Plate 94: Interior - View of OB4, collapsed roof and wall; scale 1x1m; view from NW (archive reference: E49216_111).



Plate 95: Interior - Collapsed wall of OB4 View through doorway looking into OB3; scale 1x1 m; view from NW (archive reference: E49216_112).



Plate 96: Interior - View through doorway looking into OB3; scale not used; view from NE (archive reference: E49216_113).



Plate 97: Interior - View through doorway looking into OB3; scale not used; view from NE (archive reference: E49216_114).

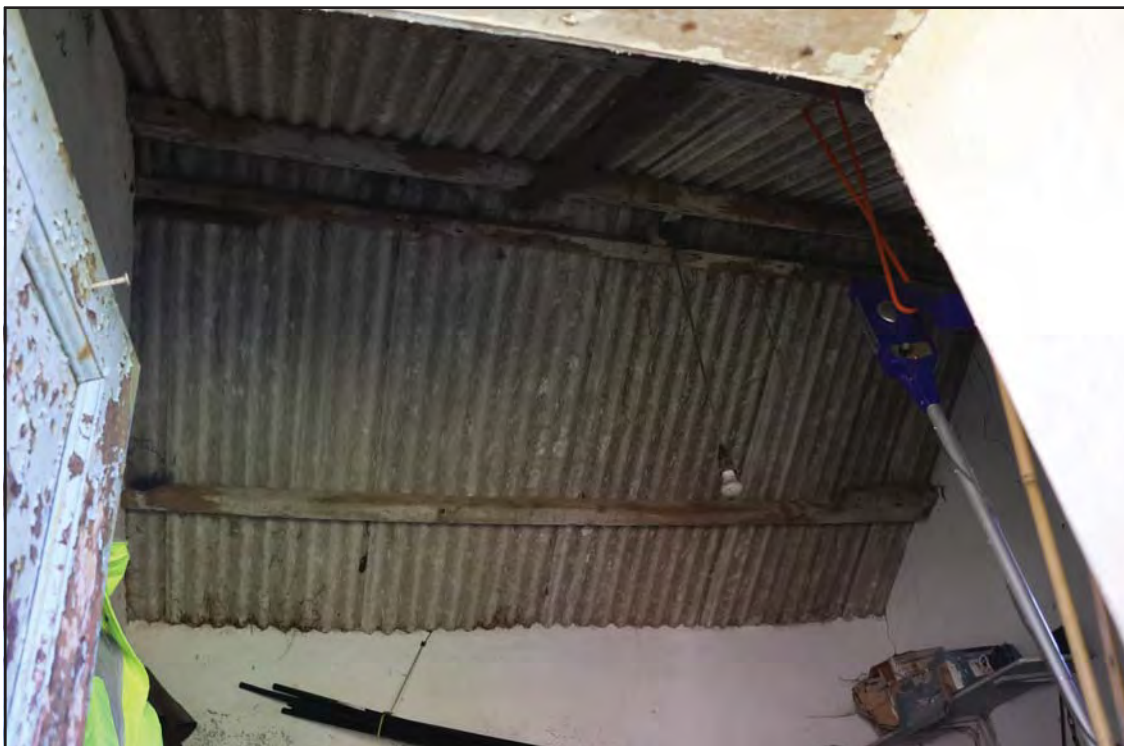

Plate 98: Interior - Roof of OB3; scale not used; view from NE (archive reference: E49216_115).



Plate 99: Interior - View of NE wall of OB1; scale 1x1m; view from W (archive reference: E49216_116).



Plate 100: Interior - View of metal fittings and two stones jutting out of the NE wall of OB1; scale not used; view from W (archive reference: E49216_117).



Plate 101: Interior - View of S wall of OB1; scale 1x1m; view from N (archive reference: E49216_118).



Plate 102: Interior - View of metal fittings on S wall of OB1; scale not used; view from N (archive reference: E49216_119).



Plate 103: Interior - View of SE wall of OB1; scale not used; view from NW (archive reference: E49216_120).



Plate 104: Interior - Interior view of OB2; scale not used; view from SE (archive reference: E49216_121).



Plate 105: Exterior - Location shot showing NW facing elevation of Parc; scale not used; view from NW (archive reference: E49216_122).



Plate 106: Exterior - Location shot showing NE facing elevation of Parc; scale not used; view from NE (archive reference: E49216_123).



Plate 107: Exterior - Location shot showing SE facing elevation of Parc; scale not used; view from E (archive reference: E49216_124).

FIGURES

Figure 01: Reproduction of client location plan. Parc Talwrn - Drawing 07032024. Scale: as shown.

Figure 02: Reproduction Of Client Existing Block Plan. Parc Talwrn - Drawing 07032024. Scale: as shown.

Figure 03: Reproduction Of Outbuildings Plan: Identification and Purpose. Parc Talwrn - Drawing 14052024. Scale: as shown.

Figure 04: Reproduction of the Llanddyfan parish tithe map 1840's, showing Parc / Bryn Ffynnon farm building and associated fields.

Figure 05: Reproduction of First to Third Edition Ordnance Survey maps of Parc, Talwrn. Scale 1:500@A4.

Figure 06: Reproduction of photograph from the Book Stori'r Talwrn, showing Parc photographed in the 1890's.

FIGURE 01

Reproduction of client location plan. Parc Talwrn - Drawing 07032024.

Scale: as shown.

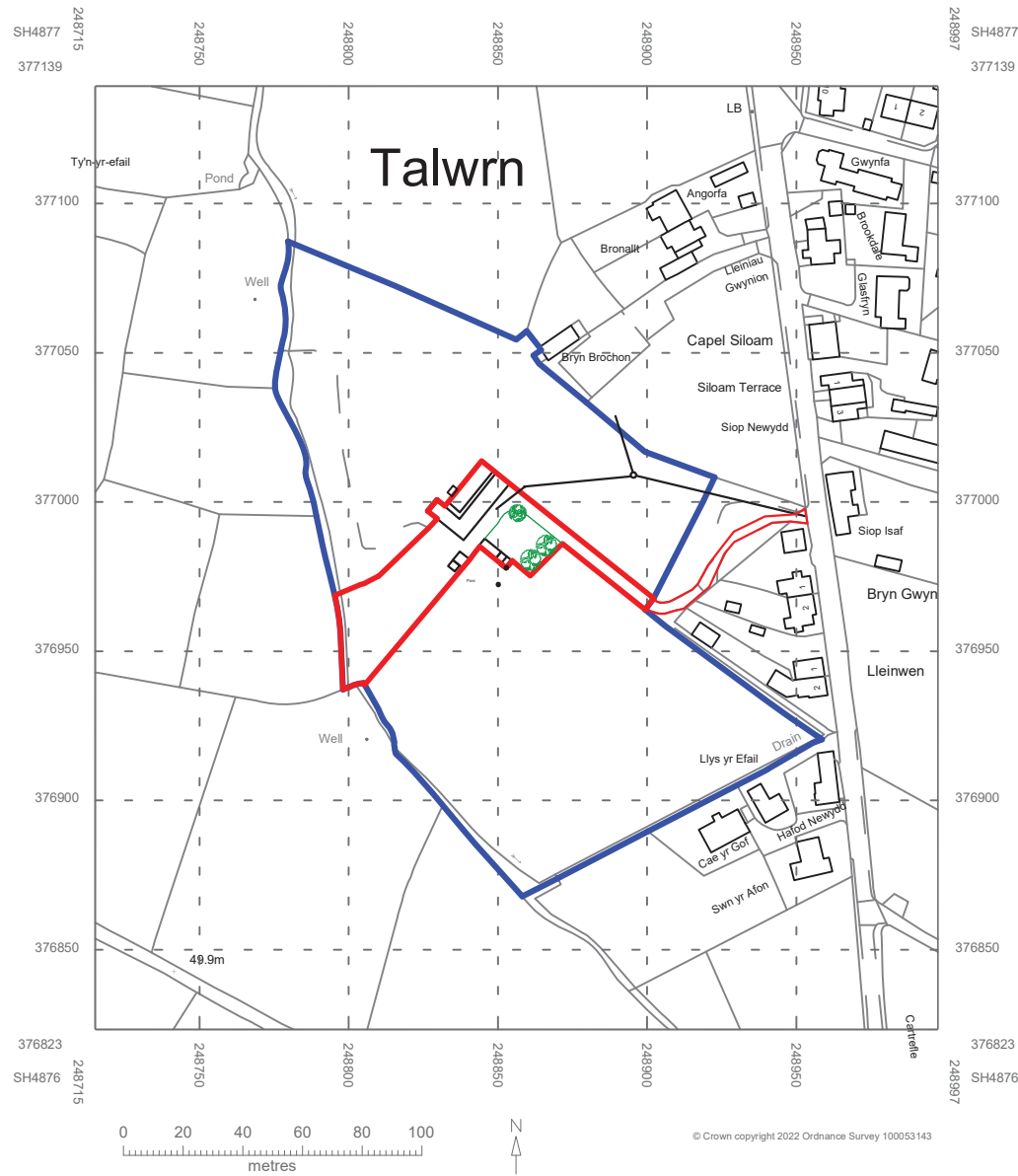

Site location plan
Scale 1:2500



Parc Talwrn
Restoration of existing
smallholding residence

Drawings
Mob: 07423 066533
parctalwrn@gmail.com

PARC	Site Location Plan		
	PARC/01/A4	Edrion PLANNING	Sheet 01

FIGURE 02

Reproduction Of Client Existing Block Plan. *Parc Talwrn* - Drawing 07032024. Scale: as shown.

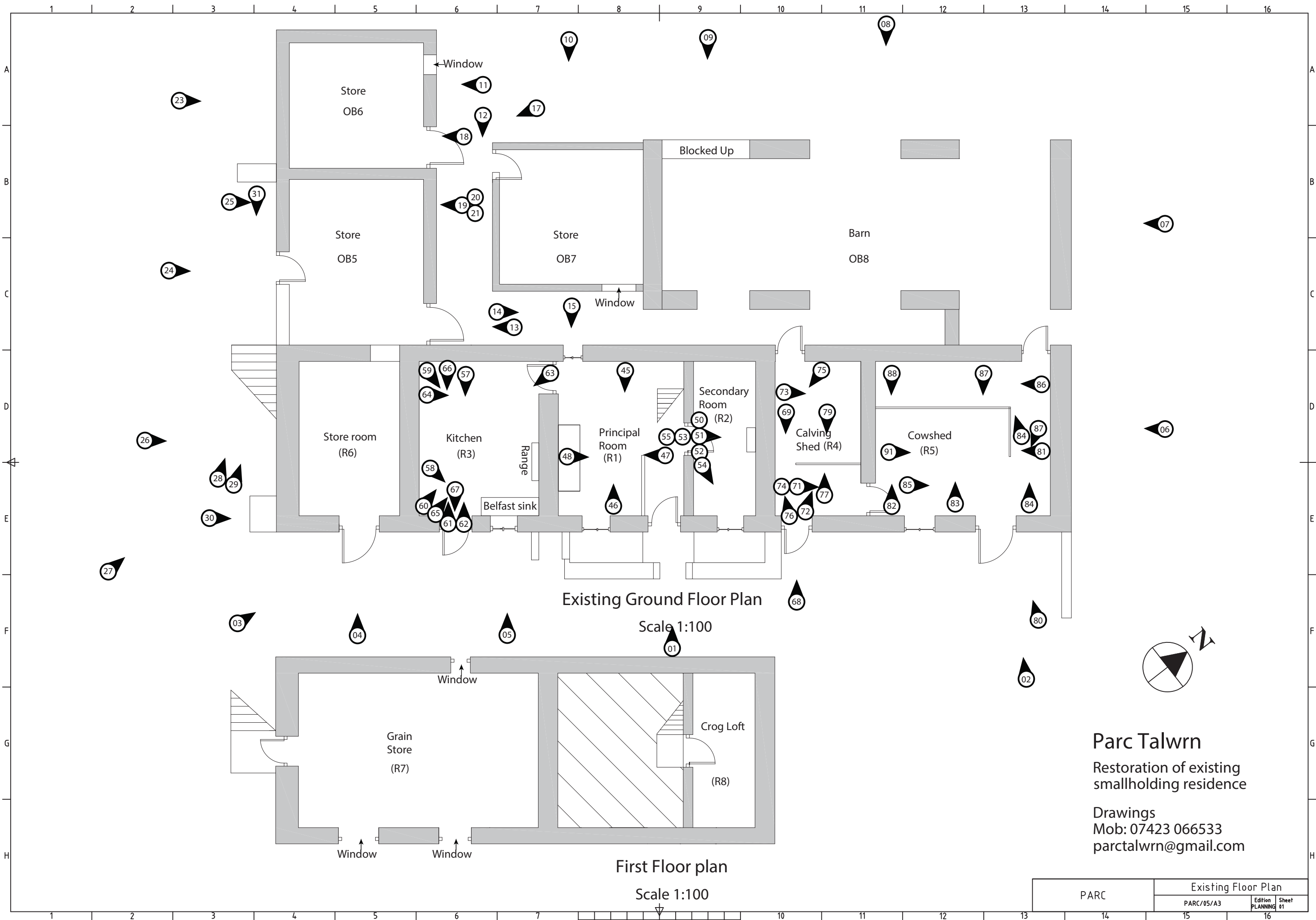

Parc Talwrn
Restoration of existing
smallholding residence

Drawings
Mob: 07423 066533
parctalwrn@gmail.com

PARC	Existing Floor Plan	
	PARC/05/A3	Edition PLANNING Sheet 01

FIGURE 03

Reproduction Of Outbuildings Plan: Identification and Purpose. *Parc Talwrn* - Drawing 14052024. Scale: as shown.

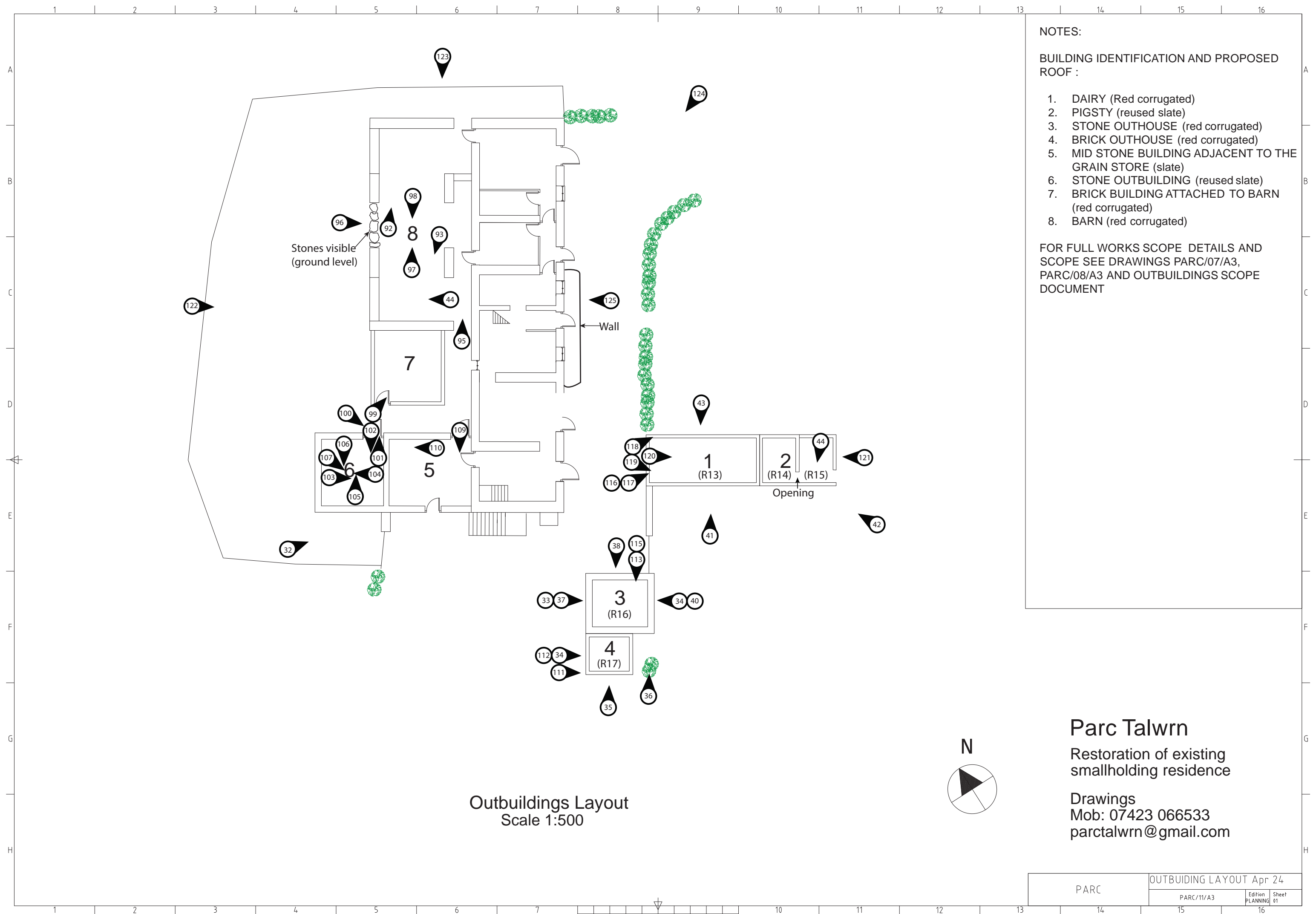

FIGURE 04

Reproduction of the Llanddyfan parish tithe map 1840's, showing Parc / Bryn Ffynnon farm building and associated fields. Scale: As shown. Source: NLW.

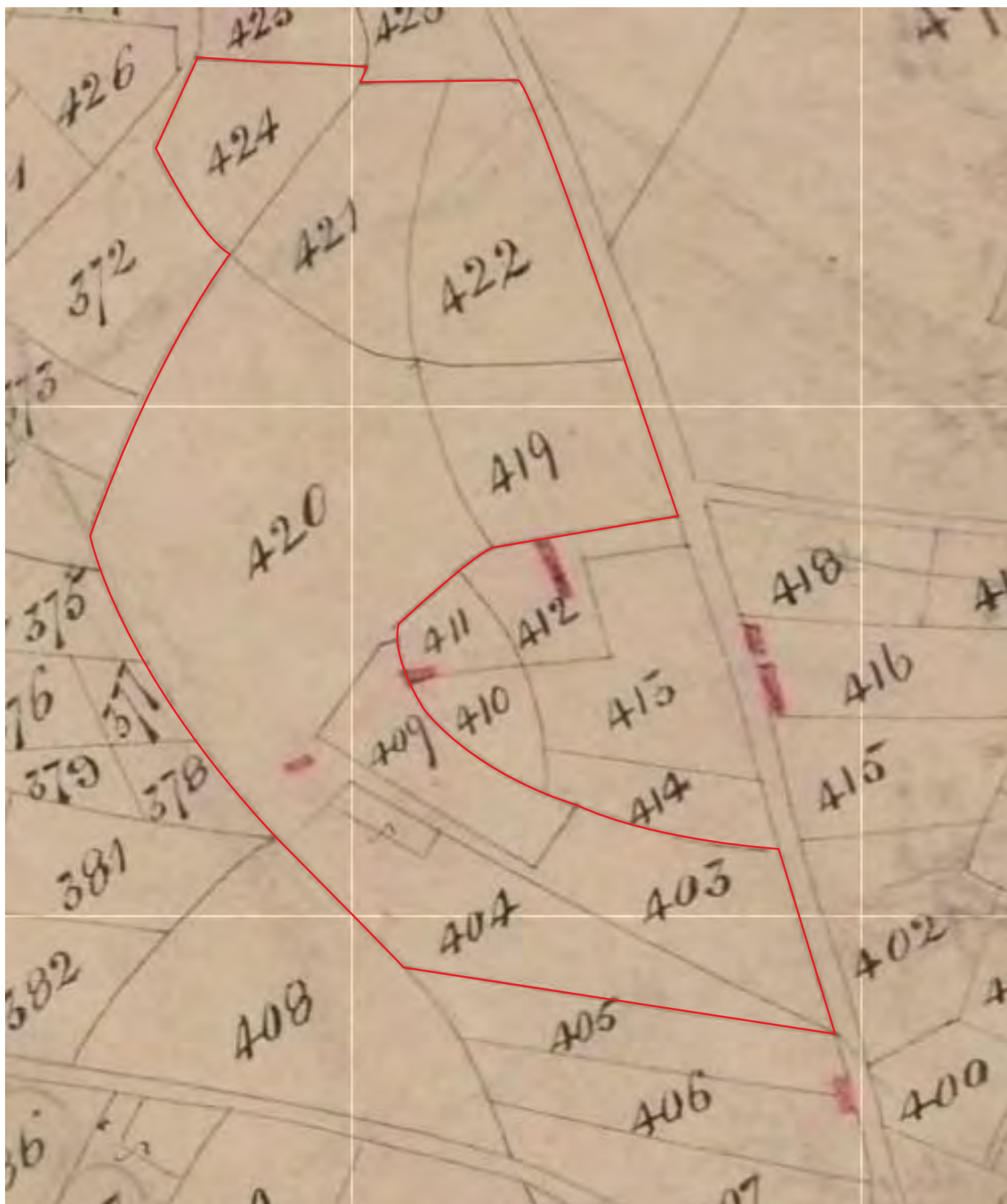
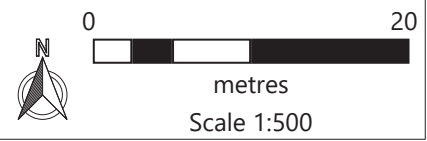
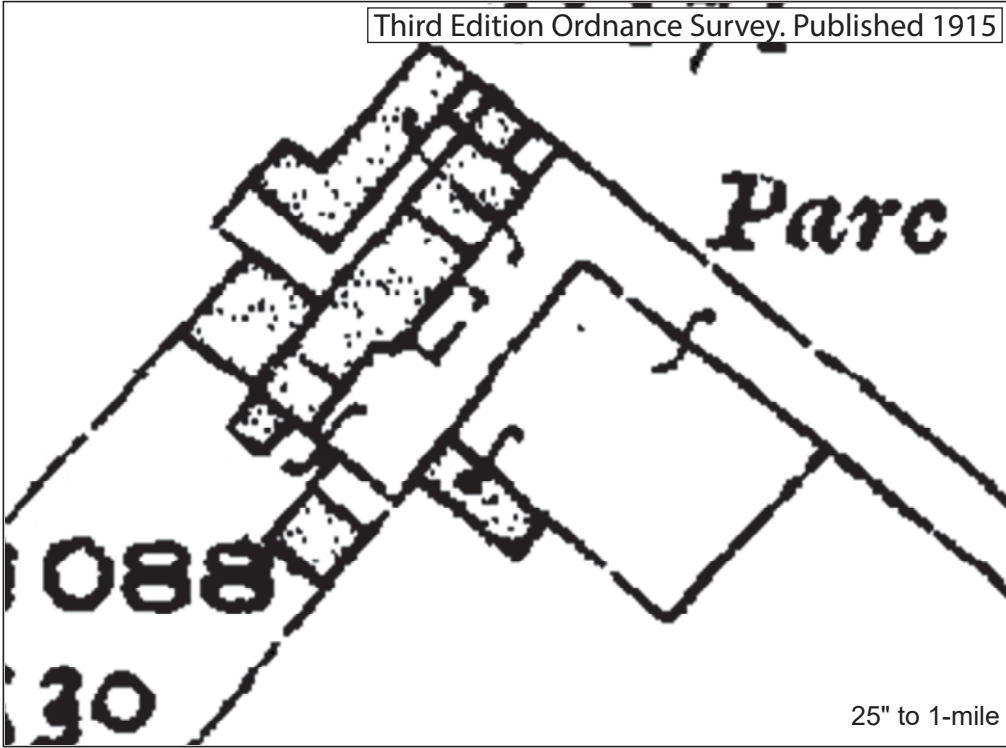
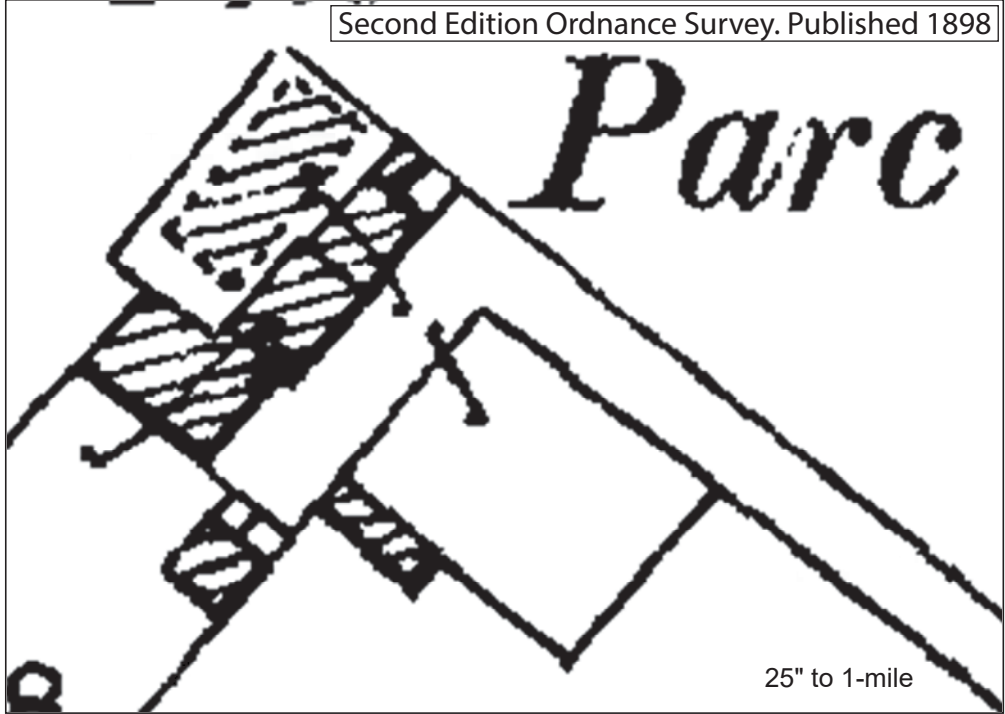
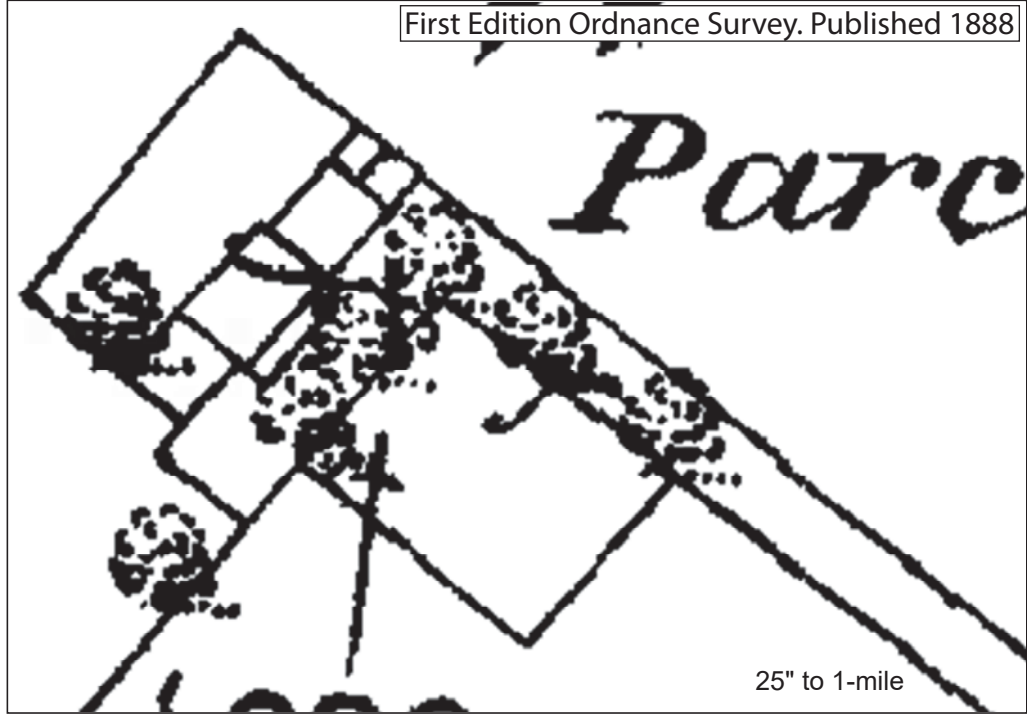

Figure: 04. Reproduction of the Llanddyfan parish tithe map 1840's, showing Parc / Bryn Ffynnon farm building and associated fields.

FIGURE 05

Reproduction of First to Third Edition Ordnance Survey maps 25" to 1-mile of Parc, Talwrn. Scale 1:500@A4.



Craig Beuno,
Ffordd y Garth,
Bangor, Gwynedd
LL57 2RT

Ffon / Phone: +44 (0) 1248 352535
Ffacs / Fax: +44 (0)1248 370925
e-bost / e-mail: fieldservices@heneb.org.uk

CLIENT:
Mr & Mrs Parry

SITE:
Parc Farm, Talwrn

SCALE AT A4: 1:500	DATE: 13/05/25	DRAWN: MSL	CHECKED: JR
PROJECT NO: HD24-116	DRAWING NO: PARC/01	REVISION: A	

Figure 05: Reproduction of First to Third Edition Ordnance Survey maps of Parc, Talwrn. Scale 1:500@ A4.

FIGURE 06

Reproduction of photograph from the Book Stori'r Talwrn, showing Parc photographed in the 1890's.



Figure: 06. Reproduction of photograph from the Book Stori'r Talwrn, showing Parc photographed in the 1890's

APPENDIX I

Heneb Field Services Written Scheme of Investigation Final.

TALWRN, YNYS MÔN (HD24-116)

WRITTEN SCHEME OF INVESTIGATION FOR
ARCHAEOLOGICAL MITIGATION:



Level 2/3 Building Record

Historic Environment Record Event Primary Reference
Number 49216

Prepared for *Mr & Mrs Parry*

April 2025



Approvals Table				
	Role	Printed Name	Signature	Date
Originated by	Document Author	Michael S Lynes		03/04/2025
Reviewed by	Document Reviewer	John Roberts		03/04/2025
Approved by	Principal Archaeologist	John Roberts		03/04/2025

Revision History			
Rev No.	Summary of Changes	Ref Section	Purpose of Issue

All Heneb staff should sign their copy to confirm the project specification is read and understood and retain a copy of the specification for the duration of their involvement with the project. On completion, the specification should be retained with the project archive:

Name

Signature

Date

TALWRN, YNYS MÔN (HD24-116)

WRITTEN SCHEME OF INVESTIGATION FOR ARCHAEOLOGICAL MITIGATION:

Level 2/3 Building Record

Mr & Mrs Parry, July 2025

CONTENTS

1	INTRODUCTION.....	6
1.1	Aims and Objectives	8
1.2	Monitoring Arrangements.....	9
1.3	Historic Environment Record	10
2	HISTORIC BACKGROUND.....	11
3	METHOD STATEMENT	13
3.1	Level 2/3 Building Record	13
3.1.1	Introduction.....	13
3.1.2	Photographic Record.....	14
3.1.3	Written Record.....	15
3.1.4	Drawn Record.....	16
3.1.5	Working Project Archive	17
3.1.6	Data Management Plan	18
3.1.7	Selection Strategy	19
4	PERSONNEL	20
5	HEALTH AND SAFETY	21
6	SOCIAL MEDIA.....	22
7	INSURANCE	23
7.1	Public/Products Liability	23
7.2	Employers Liability	23
7.3	Professional Indemnity.....	23
8	SOURCES CONSULTED	24
8.1	Websites.....	24
	FIGURE 01	25
	Reproduction of client location plan. Parc Talwrn - Drawing 07032024. Scale: as shown.	
	25	
	FIGURE 02	26
	Reproduction of client existing block plan. <i>Parc Talwrn</i> - Drawing 07032024. Scale: as shown.	
	26	
	FIGURE 03	27

Reproduction of Outbuildings plan: Identification and purpose. <i>Parc Talwrn</i> - Drawing 14052024. Scale: as shown.	27
APPENDIX I.....	28
Heneb: Gwynedd Archaeology Basic Record Pro-Forma.....	28
APPENDIX II.....	29
Heneb: Gwynedd Archaeology Room Recording Pro-Forma	29
APPENDIX III.....	30
Heneb: Gwynedd Archaeology Photographic Metadata Pro-Forma	30
APPENDIX IV	31
Heneb: Gwynedd Archaeology Selection Strategy v1.0.	31

1 INTRODUCTION

Heneb: Gwynedd Archaeology Contracts Department (Heneb: GA) has been commissioned by Mr & Mrs Parry to undertake archaeological mitigation in the form of a Level 2/3 Building Record prior to property development works at Parc, Talwrn, Ynys Môn, LL77 7SS (centred on NGR: SH 48800 76900; [Figure 01](#)).

Parc is a Grade II listed (ID 80974) small farmstead located within the village of Talwrn. The small farmstead is recorded in the regional Historic Environment Record (HER) as PRN 66421. Parc comprises of a long range a cottage with garden to the front, flanked by cow-house range to the right, and an out-kitchen and store with granary over to the left (Source: CADW, 2025). The former small farmstead was designated as a Grade II listed site on March 12, 2003, in recognition of its historical significance and well-preserved character. It remains an intact example of a traditional small farmstead, consisting of a dwelling and associated agricultural outbuildings that form a cohesive unit. This designation is recorded under reference ID 80974.

The archaeological Level 2/3 record will conform with conditions 5a and 5b, set out under Anglesey County Council reference number FPL/2024/53. In addition, conditions 5a and 5b set out within the Listed Building Consent (LBC), reference LBC/2024/4.

The archaeological mitigation will comprise a Level 2/3 building record prior to any development. The building record will be completed during the 8th of April 2025.

All work will be planned, managed and undertaken by Heneb: GA in accordance with the following standards and guidance:

- Guidance for the Submission of Data to the Welsh Historic Environment Records (HERs) Version 4.1 (The Welsh Archaeological Trusts, 2024);
- Guidelines for digital archives (Royal Commission on Ancient and Historical Monuments of Wales, 2015).
- Management of Archaeological Projects (English Heritage, 1991);
- Management of Research Projects in the Historic Environment: The MoRPHE Project Managers' Guide (Historic England, 2015);
- Standard and Guidance for the Archaeological Investigation and Recording of Standing Buildings or Structures (Chartered Institute for Archaeologists, 2020);

- Standard for archaeological monitoring & recording (Chartered Institute for Archaeologists, 2023);
- Standard and guidance for the creation, compilation, transfer and deposition of archaeological archives (Chartered Institute for Archaeologists, 2020); and
- Understanding Historic Buildings: A Guide to Good Recording Practice (Historic England, 2016).

Heneb: the Trust for Welsh Archaeology is a Registered Organisation with the Chartered Institute for Archaeologists (CIfA).

1.1 Aims and Objectives

The key aims and objectives are to:

- Complete a descriptive and photographic record of Parc farmstead / smallholding sufficient to document its development, use and phasing. This includes the dwelling, agricultural buildings and any other auxiliary structures found to be of historical value;
- to place the results in context (if applicable), with reference made to *A Research Framework for the Archaeology of Wales Version 03, Final Refresh Document* (March 2017);

1.2 Monitoring Arrangements

The archaeological mitigation will be monitored by the Heneb: Gwynedd Senior Development Control Archaeologist. The content of this written scheme of investigation (WSI) and all subsequent reporting by GA must be approved by the Senior Heneb: Gwynedd Development Control Archaeologist prior to final issue. The Senior Heneb: Gwynedd Development Control Archaeologist will be kept informed of the project timetable and of the subsequent progress and findings. This will allow time to arrange monitoring visits and attend site meetings (if required) and enable discussion about the need or otherwise for further works (if required) as features of potential archaeological significance are encountered.

Jenny Emmett | jenny.emmett@heneb.co.uk | 07824481052

1.3 Historic Environment Record

In line with Gwynedd Historic Environment Record (HER) requirements, the HER will be contacted at the onset of the project to ensure that any data arising is formatted in a manner suitable for accession to the HER and follows the guidance set out in Guidance for the Submission of Data to the Welsh Historic Environment Records (HERs) (The Welsh Archaeological Trusts, 2024). In line with this guidance, all submitted reporting will need to include the equivalent of a non-technical summary in Welsh and English at the front of the report combined with short bilingual summaries of the principal Historic Assets recorded during the event. These requirements are mandatory. The Gwynedd HER event primary reference number is **49216**.

Heneb: Gwynedd HER will also be responsible for supplying Primary Reference Numbers (PRN) for new assets identified and recorded.

2 HISTORIC BACKGROUND

The historical background for the small farmstead has had some researched with a full report and description provided by CADW during the Grade II listing survey of 2003 (Source: Cadw, 2025). A brief summary describes Parc's history, interior and exterior as:

"Traditional small holding, latterly of 14 acres(5.7 hectares), and with buildings consistent with this acreage. Probably early nineteenth century. Apparently, a small-scale farm, growing a range of green crops and maintaining a small dairy herd (the dairy survives as a semi-ruinous building in front of the main range)".

"The cottage retains its original layout intact, divided as a principal room with main fireplace, and a secondary heated room. High ceiling over main room may suggest former existence of a crogloft over the secondary room only - the previous existence of a loft is recalled. The secondary room has a fine carved slate fireplace, with simple concentric circles in the lintel, floral motifs in simple lined panels in the sidepieces. The boarded ceiling may also be original. The kitchen retains the remnants of a painted calico ceiling, nailed between the rafters".

"Long range comprising single storeyed cottage with separate enclosed garden to front, flanked by cow-house range to the right, and out-kitchen and store with granary over to the left. Immediately to the rear of the cowhouse range is a substantial haybarn. A stable behind the granary range is a twentieth century addition. Rubble masonry, limewashed throughout; bedded and grouted slate roof to cottage, regular (and later) slates to cowhouse. Cottage has central doorway flanked by 4-pane sash windows (boarded at time of inspection); gable end stacks, equally sized. Cowhouse range to right has two doorways, flanking a central window. Out-kitchen and store to left are a low two storeys: the kitchen has doorway to right, and 4-pane sash window to left, under a single long timber lintel; outbuilding has single doorway in front elevation, and access to the upper granary by external staircase against the gable end; 2 upper windows have glazed upper panes, and slatted lower sections to provide ventilation to granary. Haybarn at rear of cowhouse was formerly of open type, and 3 bays; now the two outer open bays in its front elevation have been blocked with rubble, to form a semi-enclosed barn".

As part of the pre-planning application, and to support a listed building consent, Frances Littlewood Chartered Engineer undertook a work scope and outbuilding survey with the report published in May 2024 (Littlewood, 2024). In addition, a detailed Heritage Impact Assessment (HIA) was also undertaken in May 2024 by *Henderson Heritage* which gives a detailed historic account of the small farmstead / smallholding. This includes map regression, which identified that as Parc was not visible on the 1841 tithe map, hence it must have been built at a later date. Furthermore, the HIA describes the building as being built of local stone, and its type, as

a smallholding, being a popular occurrence during the 19th century with similar ones found within the local. In addition to the HIA, existing plans and elevations were produced, including a 3D model *Parc Talwrn* drawing 07032024(1).

3 METHOD STATEMENT

3.1 Level 2/3 Building Record

3.1.1 Introduction

The archaeological mitigation will be undertaken as a Level 2/3 Record, as defined by *Understanding Historic Buildings: A Guide to Good Recording Practice* (Historic England, 2016). The Level 2/3 record is limited to accessible areas and will be undertaken in accordance with a suitable risk assessment and health & safety parameters. *The client will be responsible for access and for removing any obstructing vegetation or materials.*

A Level 2/3 record is characterised in *Understanding Historic Buildings* as a descriptive record, with elements of Level 3 which is defined as an analytical record (Historic England, 2016: 26) and will incorporate the exterior and interior of the buildings, for which a photographic record, written record and drawn record will be completed on an annotated floor plans published by *Parc Talwrn* ([Figure 02](#) and [03](#)).

3.1.2 *Photographic Record*

The photographic record will include *Understanding Historic Buildings* photographic elements 1 to 7 (Historic England, 2016: 26) and include general views of the buildings within the local landscape, along with exterior and interior elevations – both oblique and face-on (where practical) and a record of the overall appearance of the principal rooms and circulation areas within the interior. Camera tripods and measuring poles will be used for the elevations and where practical elsewhere; artificial lighting will be used for the interior if there is insufficient natural lighting/existing lighting.

Photographic images will be taken using a digital SLR (Nikon D3100) camera set to maximum resolution (4928 × 3264; 16.2 effective megapixels) in RAW format. A photographic record will be maintained on site using GA pro-formas ([Appendix III](#)) and digitised in Microsoft Excel and Access as part of the fieldwork archive and dissemination process; the archive numbering system will start from E49216_001. The location and orientation of photographs taken will be recorded on the site plan, (*Parc Talwrn* Drawings No. 07032024 and 14052024 cf. [Figures 02](#) and [03](#)) and then digitised for final reporting. The photographic images will then be converted to TIFF for final archiving using Affinity Software package.

3.1.3 *Written Record*

The written record will include *Understanding Historic Buildings* report elements 5, 7, 8 and 23 (Historic England, 2016: 26). This will include:

- the precise location of the buildings (NGR format) and an address;
- a note of any statutory or non-statutory designations;
- the date of when the record was made as well as the name of the recorder and location of the project archive; and
- a description of the building's form, function, date and sequence of development. The names of architects, builder, patrons and owners should be included if known.

The Level 2/3 written record will be completed using a building record pro-forma ([Appendix I](#)) and a room record pro-forma ([Appendix II](#)). The basic record pro-forma will be used to record the exterior and interior elevations, as well as key structural details. Key dimensions and detailed measurements will be completed using hand tapes and a laser distance measurer.

3.1.4 Drawn Record

Measured drawings will be prepared in accordance with *Understanding Historic Buildings* drawing elements 7 and 8 (Historic England, 2016: 26). This will include:

- a sketched or measured plan as existing. In this instance, the scaled plans detailed in *Parc Talwrn* Drawings 07032024 and 14052024 ([Figure 02](#) and [03](#) respectively) will be used for reference and as a base plan. The plans will be annotated to show the form and location of any structural features of historic significance, e.g., blocked doorways, windows and fireplaces and any other fixtures of significance (if present).
- If the buildings show any complex phasing and change of use, a plan will be prepared for the report detailing the phasing and any layout changes; and
- A site plan relating the building to other structures within the local area.

3.1.5 Working Project Archive

Following the completion of the fieldwork, a working project archive will be created based on following task list;

1. Pro-formas: all cross referenced and complete;
2. Photographic Metadata: completed in Microsoft Access and cross-referenced with all pro-formas;
3. Sections (if relevant): all cross referenced and complete;
4. Plans (if relevant): all cross referenced and complete;

All relevant site archive data will be added to a digital project register specific to this project, which will be prepared in Microsoft Excel.

The site archive data will then be processed, final illustrations will be compiled, and a report will be produced which will detail and synthesise the results.

3.1.6 *Data Management Plan*

The physical archive will be stored in a designated project folder and the location confirmed in the Heneb project database; the digital dataset will be stored on a dedicated Heneb server, with the location confirmed in the Heneb project database via a specific hyperlink. External datasets for the HER and RCAHMW are as defined in the dissemination strategy below. De-selected digital data will be confirmed in a supplementary Selection Strategy document appended to the final report.

A draft report will be submitted within one month of fieldwork completion and a final report will be submitted to the regional Historic Environment Record within six months of project completion. The report will include the following:

1. Non-technical summary (Welsh and English)
2. Introduction
3. Background
4. Methodology
5. Results
6. Conclusion
7. List of sources consulted.
8. Figures – to include:
 - a. Site location plan;
 - b. Scaled plan(s) (if relevant);
 - c. Scaled section(s) (if relevant);
9. Plates – to include selected photographic archive images illustrating the following:
 - a. Site location;
 - b. Ground conditions and general stratigraphy;
 - c. Detail of investigated features, including plan and section images (if relevant);
10. Appendix I – approved Heneb GA written scheme of investigation;
11. Appendix II – photographic metadata;

3.1.7 Selection Strategy

As defined in Standard and guidance for the creation, compilation, transfer and deposition of archaeological archives (Chartered Institute for Archaeologists, 2020) section 3.3.1, a project specific selection strategy and data management plan should be prepared. In support of this, the Chartered Institute for Archaeologist (CIfA), have stated that it is “widely accepted that not all the records and materials collected or created during the course of an Archaeological Project require preservation in perpetuity. These records and materials constitute the Working Project Archive which will be subject to Selection, in order to establish what will be retained for long-term curation”. The aim of selection is to ensure that all the elements retained from the Working Project Archive for inclusion in the Archaeological Archive are appropriate to establish the significance of the project and support “future research, outreach, engagement, display and learning activities”. Selection should be “focused on selecting what is to be retained to support these future needs, rather than deciding what can be dispersed” and can be qualified by a selection strategy, which details the project-specific selection process, agreed by all parties (including the Senior Heneb: Gwynedd Development Control Archaeologist, client and/or landowner), which will be applied to a Working Project Archive prior to its transfer into curatorial care as the Archaeological Archive.

The selection strategy is summarised in [Appendix IV](#) and will be finalised in the mitigation report; the strategy will take into account:

- The aims and objectives of the project.
- The brief and/or Written Scheme of Investigation (WSI)).
- The Collecting Institution’s collection policy and/or deposition guidelines.
- Regional & relevant thematic or period specific research frameworks.
- The projects Data Management Plan (DMP).
- Internal recording and reporting policies.
- Material-specific guidance documents.

4 PERSONNEL

The project will be managed by John Roberts, Heneb: Head of Archaeology and undertaken by a Project Archaeologist. The Project Archaeologist will be responsible for all field management duties, including Heneb: Planning Services liaison, client liaison, coordination and delegation of tasks. The Project Archaeologist will also be responsible for the completion of all on site pro-formas and the fieldwork archive itemised in [para. 3](#), as well as for submitting a draft final report (or interim report) for project manager review and approval. The report will then be submitted as per the arrangements defined in [para 3.1.6](#).

5 HEALTH AND SAFETY

A site-specific risk assessment will be prepared and will be reviewed by the Heneb: GA Project Archaeologist in advance of works, with any additional risks identified on site highlighted in the dynamic risks section and appropriate mitigation undertaken. The Heneb: GA attendee will be issued with required personal safety equipment, including high visibility jacket, steel toe-capped boots and safety helmet. All site work will be managed and undertaken in accordance with the Heneb: GA Health & Safety Policy.

If available, an asbestos survey will be consulted prior to and during site attendance.

6 SOCIAL MEDIA

One of the key aims in Heneb's mission statement is to improve the understanding, conservation and promotion of the historic environment in our area and inform and educate the wider public. To help achieve this, Heneb maintains an active social media presence and seeks all opportunities to promote our projects and results. With permission, Heneb: GA would like the opportunity to promote our work on this scheme through our social media platforms. This could include social media postings during our attendance on site as well as any postings to highlight results. In all instances, approval will be sought from client prior to any postings.

7 INSURANCE

7.1 Public/Products Liability

Insurer - Ecclesiastical Insurance Office Plc.

Policy Type - Public Liability

Limit of Indemnity - £10,000,000 any one occurrence and in the aggregate in respect of Product Liability

Policy Number - UN/001900

Not yet received (Available upon request)

7.2 Employers Liability

Insurer - Ecclesiastical Insurance Office Plc.

Policy Type - Employers Liability

Limit Of Indemnity - £10,000,000 Any One Occurrence.

Policy Number - UN/001900

Not yet received (Available upon request)

7.3 Professional Indemnity

Insurer - AXA Insurance UK Plc

Policy Type - Professional Indemnity

Limit Of Indemnity - £5,000,000 any one claim.

Policy Number – TG0397

Not yet received (Available upon request)

8 SOURCES CONSULTED

1. Chartered Institute for Archaeologists, 2020, *Standard and Guidance for the Archaeological Investigation and Recording of Standing Buildings or Structures*;
2. Chartered Institute for Archaeologists, 2020, *Standard and guidance for the collection, documentation, conservation and research of archaeological materials*;
3. Chartered Institute for Archaeologists, 2023, *Standard for archaeological monitoring & recording*;
4. English Heritage, 1991, *Management of Archaeological Projects (MAP2)*;
5. Historic England, 2015, *Management of Research Projects in the Historic Environment (MoRPHE)*;
6. Henderson, K. 2024. Heritage Impact Statement: Parc and associated outbuildings, Talwrn. Henderson Heritage;
7. Historic England, 2016. *Understanding Historic Buildings: A Guide to Good Recording Practice*;
8. Littlewood, F. 2024. Outbuildings Survey and Work Scope for Listed Building Consent. Frances Littlewood Chartered Engineer;
9. Royal Commission on Ancient and Historic Monuments of Wales, 2015, *Guidelines for digital archives*;
10. The Welsh Archaeological Trusts, 2024. *Guidance for the Submission of Data to the Welsh Historic Environment Records (HERs) Version 4.1*.

8.1 Websites

1. <https://cadwpublic-api.azurewebsites.net/reports/listedbuilding/FullReport?lang=en&id=80974>
(Accessed 03/04/2025).
2. <https://britishlistedbuildings.co.uk/300080974-parc-llanddyfnan>
(Accessed 03/04/2025).

FIGURE 01

Reproduction of client location plan. Parc Talwrn - Drawing 07032024.

Scale: as shown.

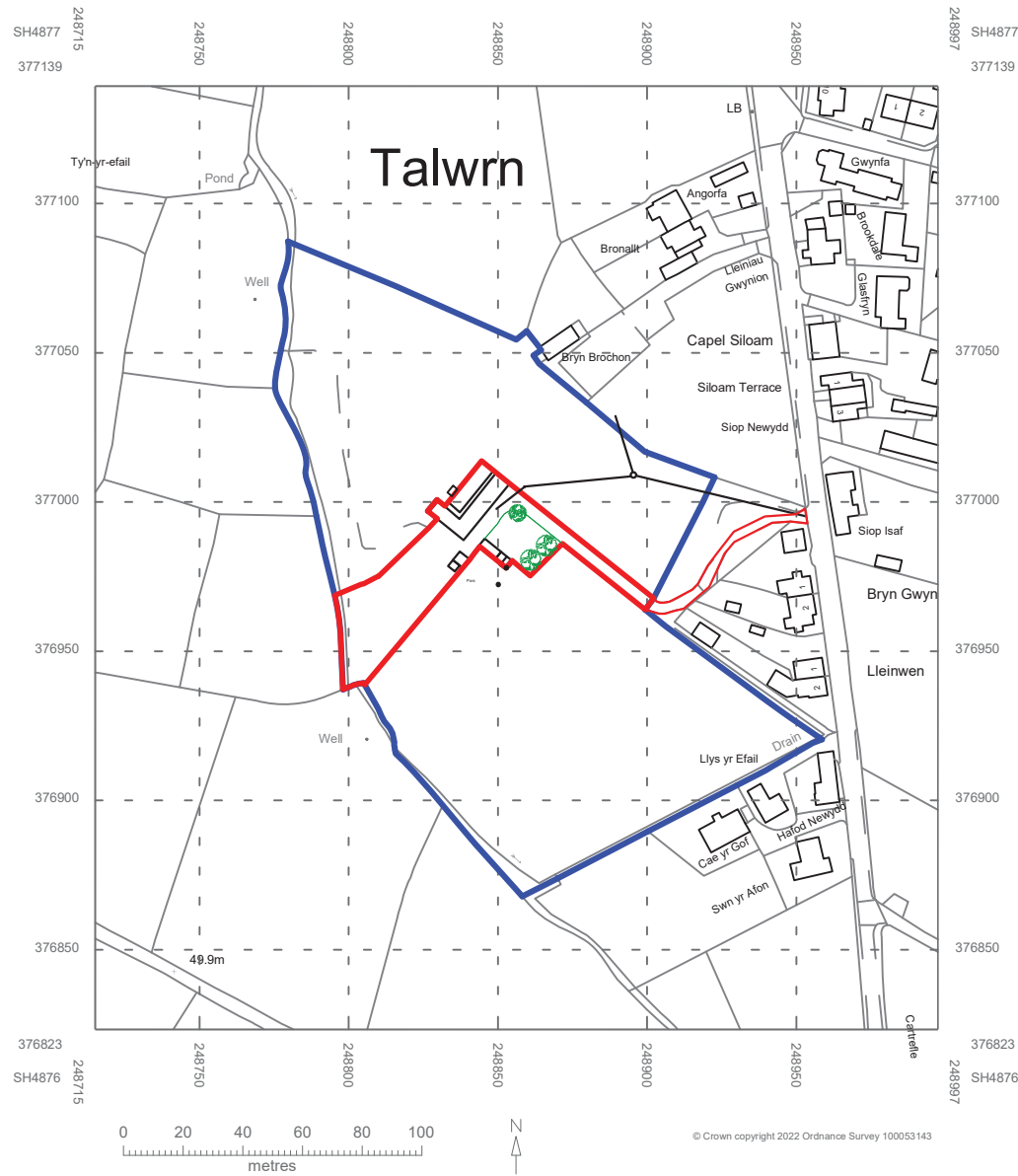

Site location plan
Scale 1:2500



Parc Talwrn
Restoration of existing
smallholding residence

Drawings
Mob: 07423 066533
parctalwrn@gmail.com

FIGURE 02

Reproduction of client existing block plan. *Parc Talwrn* - Drawing 07032024. Scale: as shown.

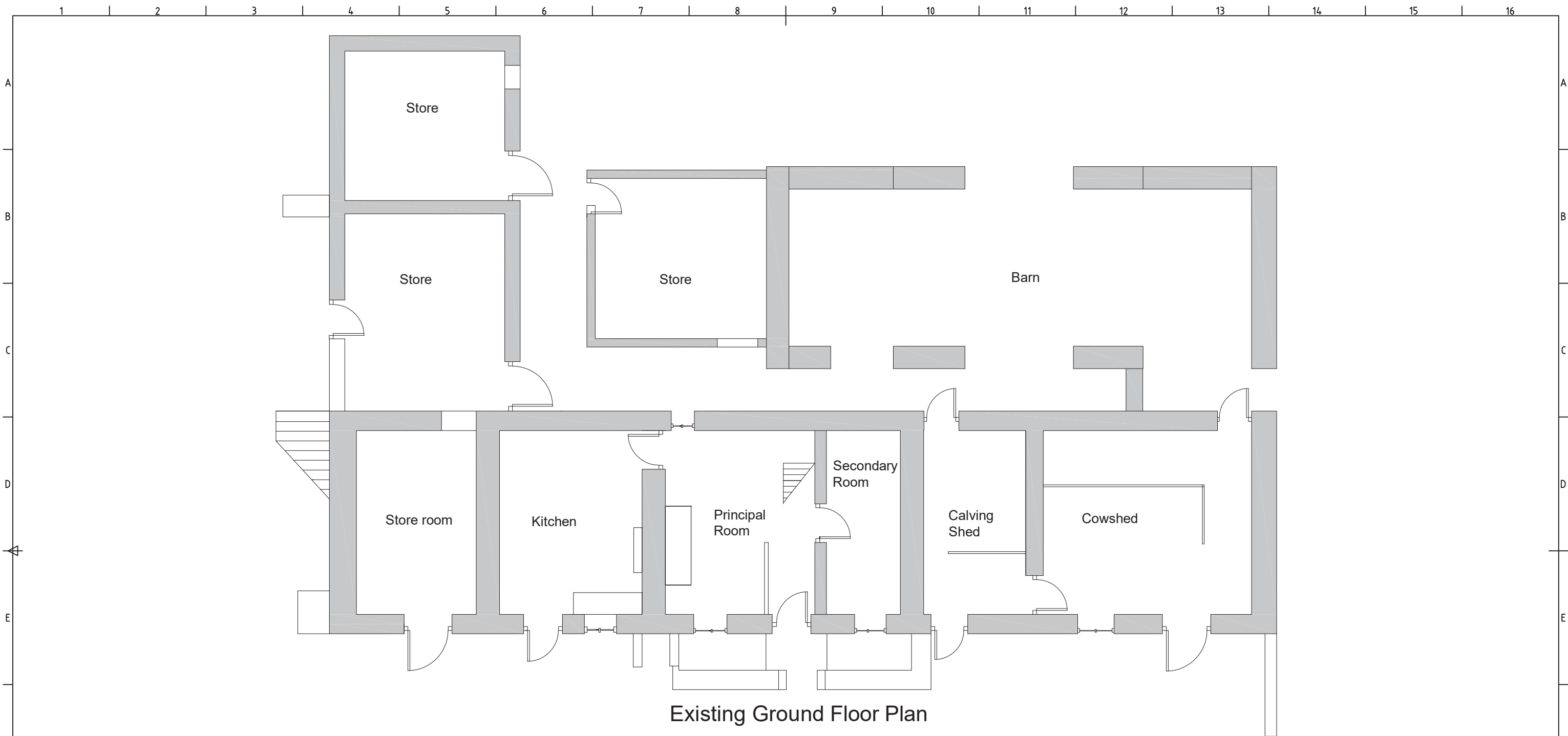

Existing Ground Floor Plan

Scale 1:100

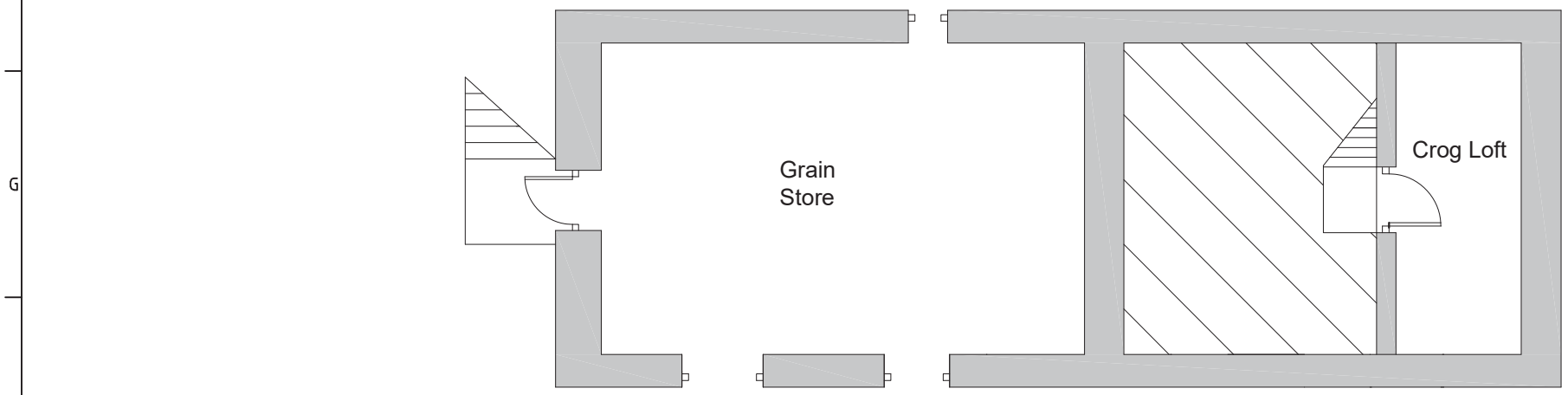

First Floor plan

Scale 1:100

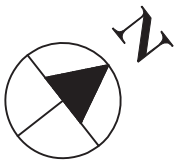

Parc Talwrn

Restoration of existing
smallholding residence

Drawings
Mob: 07423 066533
parctalwrn@gmail.com

PARC	Existing Floor Plan	
	PARC/05/A3	Edition PLANNING Sheet 01

FIGURE 03

Reproduction of Outbuildings plan: Identification and purpose. *Parc Talwrn* - Drawing 14052024. Scale: as shown.

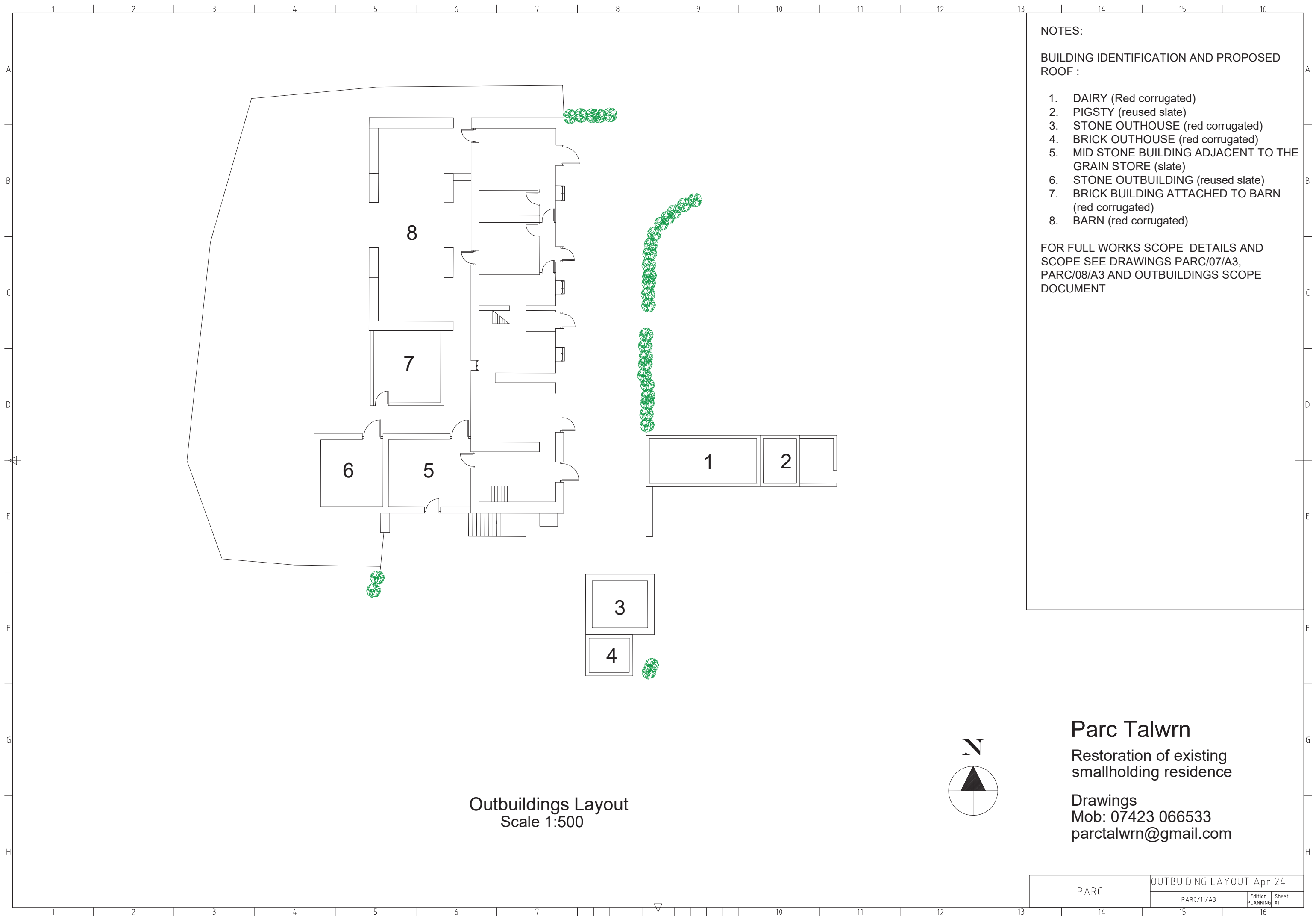

NOTES:

BUILDING IDENTIFICATION AND PROPOSED ROOF :

1. DAIRY (Red corrugated)
2. PIGSTY (reused slate)
3. STONE OUTHOUSE (red corrugated)
4. BRICK OUTHOUSE (red corrugated)
5. MID STONE BUILDING ADJACENT TO THE GRAIN STORE (slate)
6. STONE OUTBUILDING (reused slate)
7. BRICK BUILDING ATTACHED TO BARN (red corrugated)
8. BARN (red corrugated)

FOR FULL WORKS SCOPE DETAILS AND SCOPE SEE DRAWINGS PARC/07/A3, PARC/08/A3 AND OUTBUILDINGS SCOPE DOCUMENT

Outbuildings Layout
Scale 1:500

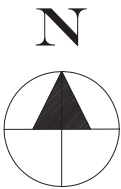

Parc Talwrn
Restoration of existing
smallholding residence

Drawings
Mob: 07423 066533
parctalwrn@gmail.com

APPENDIX I

Heneb: Gwynedd Archaeology Basic Record Pro-Forma

BASIC RECORD		Date
Project name	Project number	Compiler
Location		
Description		
Times of travelling and on-site		
Drawn record details		
Photographic record details		

APPENDIX II

Heneb: Gwynedd Archaeology Room Recording Pro-Forma

HENEB: ARCHEOLEG GWYNEDD			
ROOM RECORDING FORM		Project name	Project number
Room Number	Floor /Level		
Description			
Photographic record numbers		Scales used	Dimensions Length Width Height

	Visit date	Visit by
--	------------	----------

APPENDIX III

Heneb: Gwynedd Archaeology Photographic Metadata Pro-Forma

[illegible]

APPENDIX IV

Heneb: Gwynedd Archaeology Selection Strategy v1.0.

HD24-116_ Parc,Talwrn, Ynys Mon

04/04/2025 v1.0

Selection Strategy

Project Information

Project Management

Project Manager	John Roberts john.roberts @heneb.co.uk
Archaeological Archive Manager	John Roberts john.roberts @heneb.co.uk
Organisation	Heneb: Gwynedd Archaeology

Stakeholders

		Date Contacted
Collecting Institution(s)	Gwynedd Historic Environment Record	03/04/2025
	RCAHMW	On completion of Project Archive
	N/A	If applicable, post-fieldwork based on artefact recovery
Project Lead / Project Assurance	Heneb: Planning Services	tbc
Landowner / Developer	Mr & Mrs Parry	n/a

Resources

Resources required Describe the resources required to implement this Selection Strategy, particularly if unusual resources are required.	No unusual resources required outside of GA normal operating equipment and personnel.
--	---

Context

The full aims and objectives of the project is detailed in the project specific WSI.

Heneb: Gwynedd Archaeology Contracts Department (Heneb: GA) has been commissioned by Mr & Mrs Parry to undertake archaeological mitigation in the form of a Level 2/3 Building Record prior to property development works at Parc, Talwrn, Ynys Môn, LL77 7SS (centred on NGR: SH 48800 76900; Figure 01).

Parc is a Grade II listed (ID 80974) small farmstead located within the village of Talwrn. The small farmstead is recorded in the regional Historic Environment Record (HER) as PRN 66421. Parc comprises of a long range a cottage with garden to the front, flanked by cow-house range to the right, and an out-kitchen and store with granary over to the left (Source: CADW). The former small farmstead was designated as a Grade II listed site on March 12, 2003, in recognition of its historical significance and well-preserved character. It remains an intact example of a traditional small farmstead, consisting of a dwelling and associated agricultural outbuildings that form a cohesive unit. This designation is recorded under reference ID 80974.

The archaeological Level 2/3 record will conform with conditions 5a and 5b, set out under Anglesey County Council reference number FPL/2024/53. In addition, conditions 5a and 5b set out within the Listed Building Consent (LBC), reference LBC/2024/4.

The archaeological mitigation will comprise a Level 2/3 building record prior to any development. The building record will be completed during the 8th of April 2025.

Source: Heneb: Gwynedd Archaeology. 2025. Parc, Talwrn, Ynys Mon (**HD24-116**) Written Scheme of Investigation for Archaeological Mitigation: Level 2/3 Building Record. April 2025. Project HD24-116.

1 – Digital Data

Stakeholders

John Roberts (Heneb: Head of Archaeology);
Sean Deby (Heneb: Gwynedd Historic Environment Record (HER))
Helen Rowe (Senior Archivist), Royal Commission on Ancient and Historical Monuments of Wales.

Selection

All digital data will be collected, stored and selected in lines with the Heneb: Gwynedd Archaeology Data Management Plan located on Gwynedd Archaeologies servers (available on request).

Following the completion of the fieldwork, a working project archive will be created based on following task list;

1. Pro-formas: all cross referenced and complete;
2. Photographic Metadata: completed in *Microsoft Access* and cross-referenced with all pro-formas;
3. Survey data: downloaded using a Computer Aided Design package;
4. Sections: all cross referenced and complete;
5. Plans: all cross referenced and complete;
6. Context register: quantified and register completed.

All relevant site archive data will be added to a digital project register specific to this project, which will be prepared in *Microsoft Excel*. This data will be used as the basis for the physical and digital dataset archives. Information from these will be used to compile the project report. The physical archive will be stored in a designated project folder and the location confirmed in the Henebs project database; the digital dataset will be stored on a dedicated Heneb server, with the location confirmed in Henebs project database via a specific hyperlink. External datasets for the HER and RCAHMW are defined in the dissemination strategy below. De-selected digital data will be confirmed in an updated digital management plan appended to the final report

2 – Documents

Stakeholders

Name the individual(s) responsible for the Documents Selection decisions (i.e. Archaeological Archive Manager, Project Manager, Repository Representative).

John Roberts (Heneb: Head of Archaeology);

Sean Deby (Heneb: Gwynedd Historic Environment Record (HER))

Helen Rowe (Senior Archivist), Royal Commission on Ancient and Historical Monuments of Wales.

Selection

- A digital report will be provided to the regional Historic Environment Record; this will be submitted within six months of project completion (final report only), along with a digital dataset comprising an Event PRN summary. The report and dataset will be submitted in accordance with the required standards set out in *Guidance for the Submission of Data to the Welsh Historic Environment Records (HERs)* (Version 2); and
- A digital report and digital archive dataset will be provided to Royal Commission on Ancient and Historic Monuments, Wales (final report only), in accordance with the *RCAHMW Guidelines for Digital Archives Version 1*. The dataset will be prepared in the format required by RCAHMW and included:
 - Photographic metadata (Microsoft Access);
 - Photographic archive (TIFF format);
 - Project Information form (Excel);
 - File Information form (Excel) – Microsoft Word report text final;
 - File Information form (Excel) – Photographic metadata (general);
 - File Information form (Excel) – Adobe PDF report final; and
 - File Information form (Excel) - Photographic metadata (detail).

De-Selected Documents

Describe the procedure for dealing with De-selected material and what specialist advice has informed this procedure.

This will be confirmed in the finalised selection strategy at project end

APPENDIX II

Heneb Field Services Photographic Metadata

ARCHIVE REFERENCE	SITE SUBDIVISION	DESCRIPTION*	VIEW FROM	SCALE(S)	CREATOR	PLATE
E49216_01	Exterior	View of main house WNW facing elevation (front)	ESE	1x1m	Stuart Murphy	1
E49216_02	Exterior	View of cow and calving Shed (R4 & R5)	ESE	1x1m	Stuart Murphy	2
E49216_03	Exterior	View of store and kitchen (R6 & R3)	S	not used	Stuart Murphy	
E49216_04	Exterior	View of storeroom (R6)	SE	1x1m	Stuart Murphy	3
E49216_05	Exterior	View of kitchen (R3)	SE	1x1m	Stuart Murphy	4
E49216_06	Exterior	NE elevation of the cow shed (R5)	NE	1x1m	Stuart Murphy	5
E49216_07	Exterior	NE elevation of the barn (OB8)	NE	1x1m	Stuart Murphy	6
E49216_08	Exterior	NW elevation of the barn (OB8)	NW	1x1m	Stuart Murphy	7
E49216_09	Exterior	NW elevation of the barn showing blocked up opening (OB8)	NW	1x1m	Stuart Murphy	8
E49216_10	Exterior	NW elevation of storeroom (OB7)	NW	1x1m	Stuart Murphy	9
E49216_11	Exterior	N elevation of storeroom (OB6)	N	1x1m	Stuart Murphy	10
E49216_12	Exterior	View showing Storerooms (OB5 & OB6)	WSW	1x1m	Stuart Murphy	
E49216_13	Exterior	View of N facing elevation storeroom showing doorway and wooden lintel (OB5)	N	1x1m	Stuart Murphy	11
E49216_14	Exterior	View down narrow alley between the main house and the barn	SSW	1x1m	Stuart Murphy	12
E49216_15	Exterior	View of stone arch above window 4 looking into R1	WSW	not used	Stuart Murphy	13
E49216_16	Exterior	View of metal fitting in the wall of OB5	N	not used	Stuart Murphy	
E49216_17	Exterior	View of doorway into OB6	N	1x1m	Stuart Murphy	
E49216_18	Exterior	Close up of metal fitting in the frame of doorway of OB 6	N	not used	Stuart Murphy	
E49216_19	Exterior	View of an original in-situ window with wooden frame, 3 panes of glass above a shuttered bottom opening looking into R3	N	not used	Stuart Murphy	

ARCHIVE REFERENCE	SITE SUBDIVISION	DESCRIPTION*	VIEW FROM	SCALE(S)	CREATOR	PLATE
E49216_20	Exterior	View of an original window with wooden frame, 3 panes of glass above a shuttered bottom opening previously removed (rear)	N	1x1m	Stuart Murphy	14
E49216_21	Exterior	View of an original window with wooden frame, 3 panes of glass above a shuttered bottom opening previously removed (rear)	N	1x1m	Stuart Murphy	
E49216_22	Exterior	View of an original window with wooden frame, 3 panes of glass above a shuttered bottom opening previously removed (front)	N	1x1m	Stuart Murphy	15
E49216_23	Exterior	View of SSW facing elevation of OB 6	SSW	1x1m	Stuart Murphy	16
E49216_24	Exterior	View of SSW facing elevation of OB 5	SSW	1x1m	Stuart Murphy	17
E49216_25	Exterior	View of broken fire brick	SSW	1x10cm	Stuart Murphy	
E49216_26	Exterior	View of SSW elevation of storeroom (R6) and stairs lead up to storeroom (R7)	SSW	1x1m	Stuart Murphy	18
E49216_27	Exterior	View showing entire SSW facing elevation	SSW	1x1m	Stuart Murphy	19
E49216_28	Exterior	Possible dog kennel built into the stairs leading up to (R7)	SSW	1x1m	Stuart Murphy	20
E49216_29	Exterior	Possible dog kennel built into the stairs leading up to (R7)	SSW	1x1m	Stuart Murphy	
E49216_30	Exterior	View of modern buttress built to support SSW gable end of R6 and R7	SSW	1x1m	Stuart Murphy	21
E49216_31	Exterior	Stone stairs leading up to R7	ESE	1x1m	Stuart Murphy	22
E49216_32	Exterior	View showing entire SSW facing elevation	SSW	1x1m	Stuart Murphy	
E49216_33	Exterior	View of W elevation of OB 3	W	1x1m	Stuart Murphy	23
E49216_34	Exterior	View of W elevation of OB 4	W	1x1m	Stuart Murphy	24
E49216_35	Exterior	S facing elevation of OB4	SW	1x1m	Stuart Murphy	25
E49216_36	Exterior	E facing elevation of OB4	SE	1x1m	Stuart Murphy	26

ARCHIVE REFERENCE	SITE SUBDIVISION	DESCRIPTION*	VIEW FROM	SCALE(S)	CREATOR	PLATE
E49216_37	Exterior	Window in OB3 showing slate lintel and sill	W	not used	Stuart Murphy	27
E49216_38	Exterior	N facing elevation OB3	N	1x1m	Stuart Murphy	28
E49216_39	Exterior	E facing elevation OB3	E	1x1m	Stuart Murphy	29
E49216_40	Exterior	Close -up shot of slate grate in E facing elevation of OB3	E	not used	Stuart Murphy	30
E49216_41	Exterior	SW facing elevation of OB1	SW	1x1m	Stuart Murphy	31
E49216_42	Exterior	View Showing E facing elevation of OB1 and OB2	SE	1x1m	Stuart Murphy	32
E49216_43	Exterior	View of N facing elevation of OB1	N	1x1m	Stuart Murphy	33
E49216_44	Interior	View of feeding troughs in OB2	N	not used	Stuart Murphy	108
E49216_45	Interior	View of ESE interior wall of R1	WNW	1x1m	Stuart Murphy	34
E49216_46	Interior	View of WNW interior wall of R1	ESE	1x1m	Stuart Murphy	35
E49216_47	Interior	View of SSW interior wall of R1	NNE	1x1m	Stuart Murphy	36
E49216_48	Interior	View of NNE interior wall of R1	SSW	1x1m	Stuart Murphy	37
E49216_49	Interior	Coat hanger mounted of NNE interior wall of R1	NW	not used	Stuart Murphy	
E49216_50	Interior	Original fireplace in NNE wall of R2	SW	1x1m	Stuart Murphy	38
E49216_51	Interior	Close-up shot showing decoration on slate fire surround in R2	SW	not used	Stuart Murphy	
E49216_52	Interior	Close-up shot showing decoration on slate fire surround in R2	SW	not used	Stuart Murphy	
E49216_53	Interior	Close-up shot showing decoration on slate fire surround in R2	SW	not used	Stuart Murphy	
E49216_54	Interior	View of window in ESE wall of R2	W	not used	Stuart Murphy	39
E49216_55	Interior	View showing collapsed ceiling in R2	SW	not used	Stuart Murphy	40
E49216_56	Interior	Cast iron sky light	SW	1x1m	Stuart Murphy	41
E49216_57	Interior	View showing D10 and W5 in the ESE wall of R3	WNW	1x1m	Stuart Murphy	42
E49216_58	Interior	View of stone sink and W5 in ESE wall of R3	W	1x1m	Stuart Murphy	43

ARCHIVE REFERENCE	SITE SUBDIVISION	DESCRIPTION*	VIEW FROM	SCALE(S)	CREATOR	PLATE
E49216_59	Interior	NE wall of R3 showing cooking range	W	not used	Stuart Murphy	44
E49216_60	Interior	View showing wooden beam running across the NE wall of R3	S	not used	Stuart Murphy	45
E49216_61	Interior	Wooden joists and WNW wall of R3	SE	not used	Stuart Murphy	46
E49216_62	Interior	Close-up of wooden joists and original window in WNW wall of R3	SE	not used	Stuart Murphy	
E49216_63	Interior	View of SSW wall of R3 showing joist slots	N	1x1m	Stuart Murphy	47
E49216_64	Interior	View of D3 leading from R3 to R2	SW	1x1m	Stuart Murphy	48
E49216_65	Interior	View of upper section of NE wall of R3	S	not used	Stuart Murphy	49
E49216_66	Interior	View of quarry tiled floor in R3	WNW	1x1m	Stuart Murphy	50
E49216_67	Interior	Slate threshold in D10 of R3	WNW	not used	Stuart Murphy	51
E49216_68	Exterior	View showing stable door (D2) leading into R4	SE	1x1m	Stuart Murphy	52
E49216_69	Interior	View of stable door (D2) and ESE wall of R4	WNW	1x1m	Stuart Murphy	53
E49216_70	Interior	View of WNW wall of R4 Showing D6	ESE	1x1m	Stuart Murphy	54
E49216_71	Interior	View of D11 leading from R4 into R5	SW	1x1m	Stuart Murphy	55
E49216_72	Interior	View of NE wall of R4	S	1x1m	Stuart Murphy	56
E49216_73	Interior	View of NE wall of R4 upper section	SW	not used	Stuart Murphy	57
E49216_74	Interior	View of NE wall of R4 upper section	SW	not used	Stuart Murphy	58
E49216_75	Interior	View of SW wall of R4	NW	not used	Stuart Murphy	59
E49216_76	Interior	View of SW wall of R4	E	1x1m	Stuart Murphy	60
E49216_77	Interior	View of wooden partition in R4	SE	1x1m	Stuart Murphy	61
E49216_78	Interior	Other side of wooden partition in R4 showing a small bench	W	1x1m	Stuart Murphy	62
E49216_79	Exterior	Remains of the roof in R4	WNW	not used	Stuart Murphy	63
E49216_80	Interior	View of D4 leading into R5	E	1x1m	Stuart Murphy	64
E49216_81	Interior	SW wall of R5	NE	1x1m	Stuart Murphy	65
E49216_82	Interior	WNW wall of R5 showing cattle stalls	SE	1x1m	Stuart Murphy	66

ARCHIVE REFERENCE	SITE SUBDIVISION	DESCRIPTION*	VIEW FROM	SCALE(S)	CREATOR	PLATE
E49216_83	Interior	WNW wall of R5 showing cattle stalls	SE	1x1m	Stuart Murphy	67
E49216_84	Interior	WNW wall of R5 showing cattle stalls	SE	1x1m	Stuart Murphy	68
E49216_85	Interior	View NNE wall of R5	SW	1x1m	Stuart Murphy	69
E49216_86	Interior	View looking down alley behind cattle stalls in R5	NE	not used	Stuart Murphy	70
E49216_87	Interior	View of ESE wall showing D4 and W3 in R5	NW	1x1m	Stuart Murphy	71
E49216_88	Interior	View of ESE wall showing W3	NW	1x1m	Stuart Murphy	72
E49216_89	Interior	View of roof in R5	E	not used	Stuart Murphy	73
E49216_90	Interior	View of roof in R5	WNW	not used	Stuart Murphy	74
E49216_91	Interior	View of wooden A frame in roof of R5	SW	not used	Stuart Murphy	75
E49216_92	Interior	View of N wall of OB8 Showing window	SSW	not used	Stuart Murphy	76
E49216_93	Interior	View of S wall of OB8	NNE	not used	Stuart Murphy	77
E49216_94	Interior	View showing blocked up opening in W wall of OB8	SE	not used	Stuart Murphy	78
E49216_95	Exterior	View down narrow alley between main house and OB8	SSW	1x1m	Stuart Murphy	79
E49216_96	Exterior	Stones across central opening to OB8	WNW	1x1m	Stuart Murphy	80
E49216_97	Interior	Roof of OB8	SSW	not used	Stuart Murphy	81
E49216_98	Interior	Roof of OB8	NNE	not used	Stuart Murphy	82
E49216_99	Interior	Shot through doorway looking into OB7	SW	not used	Stuart Murphy	83
E49216_100	Exterior	View of wooden door of OB6 possible original	NW	1x1m	Stuart Murphy	84
E49216_101	Interior	Wooden latch on back of door of OB6	SSW	not used	Stuart Murphy	85
E49216_102	Interior	S wall of OB6	NE	1x1m	Stuart Murphy	86
E49216_103	Interior	E wall of OB6	WNW	1x1m	Stuart Murphy	87
E49216_104	Interior	W wall of OB6	ESE	1x1m	Stuart Murphy	88
E49216_105	Interior	N wall of OB6 showing window and door	NNE	1x1m	Stuart Murphy	89
E49216_106	Interior	Roof of OB6	NE	not used	Stuart Murphy	90

ARCHIVE REFERENCE	SITE SUBDIVISION	DESCRIPTION*	VIEW FROM	SCALE(S)	CREATOR	PLATE
E49216_107	Interior	Plough in OB6	WNW	not used	Stuart Murphy	91
E49216_108	Interior	Pulleys in OB6	E	1x1m	Stuart Murphy	92
E49216_109	Interior	View inside OB5	SW	not used	Stuart Murphy	93
E49216_110	Interior	View inside OB5	WNW	not used	Stuart Murphy	
E49216_111	Interior	View of OB4	ESE	1x1m	Stuart Murphy	94
E49216_112	Interior	Collapsed wall of OB4 View through doorway looking into OB3	ESE	1x1m	Stuart Murphy	95
E49216_113	Interior	View through doorway looking into OB3	NE	not used	Stuart Murphy	96
E49216_114	Interior	View through doorway looking into OB3	NE	not used	Stuart Murphy	97
E49216_115	Interior	Roof of OB3	NE	not used	Stuart Murphy	98
E49216_116	Interior	View of N wall of OB1	W	1x1m	Stuart Murphy	99
E49216_117	Interior	View of metal fittings and two stones jutting out of the N wall of OB1	W	not used	Stuart Murphy	100
E49216_118	Interior	View of S wall of OB1	N	1x1m	Stuart Murphy	101
E49216_119	Interior	View of metal fittings on S wall of OB1	N	not used	Stuart Murphy	102
E49216_120	Interior	View of E wall of OB1	WNW	not used	Stuart Murphy	103
E49216_121	Interior	View of interior of OB2	ESE	not used	Stuart Murphy	104
E49216_122	Exterior	Location shot showing W facing elevation of Parc	NNW	not used	Stuart Murphy	105
E49216_123	Exterior	Location shot showing N facing elevation of Parc	NNE	not used	Stuart Murphy	106
E49216_124	Exterior	Location shot showing E facing elevation of Parc	E	not used	Stuart Murphy	107
E49216_125	Exterior	View of W2 looking into R2	ESE	not used	Stuart Murphy	
E49216_126		Wooden spikes possible threshing tines found by owner in R7 roof	N/A	1x30cm	Stuart Murphy	

APPENDIX III

Heneb Field Services Selection Strategy v2.0 Final.

HD24-116_ Parc_Talwrn, Ynys Môn

23/05/2025 v2.0

Selection Strategy

Project Information

Project Management

Project Manager	John Roberts john.roberts @heneb.co.uk
Archaeological Archive Manager	John Roberts john.roberts @heneb.co.uk
Organisation	Heneb: Gwynedd Archaeology

Stakeholders

		Date Contacted
Collecting Institution(s)	Gwynedd Historic Environment Record	03/04/2025
	RCAHMW	On completion of Project Archive
	N/A	If applicable, post-fieldwork based on artefact recovery
Project Lead / Project Assurance	Heneb: Planning Services	tbc
Landowner / Developer	Mr & Mrs Parry	n/a

Resources

Resources required Describe the resources required to implement this Selection Strategy, particularly if unusual resources are required.	No unusual resources required outside of GA normal operating equipment and personnel.
--	---

Context

Heneb Field Services was commissioned by Mr & Mrs Parry to undertake archaeological mitigation in the form of a Level 2/3 Building Record prior to property development works at Parc, Talwrn, Ynys Môn, LL77 7SS (centred on NGR: SH 48853 77014; Figure 01).

Parc is a Grade II listed (ID 80974) small farmstead located within the village of Talwrn. The small farmstead is recorded in the regional Historic Environment Record (HER) as PRN 66421. Parc comprises of a long range a cottage with garden to the front, flanked by cow-house range to the right, and an out-kitchen and store with granary over to the left (Source: CADW, 2025). The former small farmstead was designated as a Grade II listed site on March 12, 2003, in recognition of its historical significance and well-preserved character. It remains an intact example of a traditional small farmstead, consisting of a dwelling and associated agricultural outbuildings that form a cohesive unit. This designation is recorded under reference ID 80974.

The archaeological Level 2/3 record conformed with conditions 5a and 5b, set out under Anglesey County Council reference number FPL/2024/53. Furthermore, Listed Building Consent (LBC) was obtained for the works, under reference LBC/2024/4. The proposed developments which are regulated under the Anglesey County Council authority are outlined in Document Ref No. 07052024 and include the following:

1. Parc Talwrn Smallholding Residence Farmhouse, for internal and external works, including demolition and rebuilding of single storey side offshoot.
 2. Building No.1: Conversion of dairy into a workshop, including internal and external alterations by replacing the roof, rebuilding stonework and repoint and stabilise all walls.
 3. Building No. 2: Conversion of pigsty into an animal enclosure, including removal of tree, stabilisation of walls, reinstating roof capping wall and timber door, demolition of a wall, and clearance around base of walls.
- Building No. 3: Conversion of outbuilding into a shed for storage, including replacing asbestos roof with similar roof system to match dairy, repair window frames and reinstate glass panes, removal of existing cementitious mortar repairs, repoint with lime mortar where necessary and clearance around base of walls.
 - Building No. 4: Conversion of outbuilding into a shed for storage, including repoint brickwork, replace timber wall plate, replace timber roof joists, replace roof with new to match dairy, and clearance around base of walls.
 - Outbuilding 5: Conversion of outbuilding into a shed for storage, including repoint and stabilise walls internally and externally, replace timber wall plate, roof joists and lintel, rebuild lintels above doorways, replace roof with new to match grain store, and installation of gutter.

- Building No.6: Conversion of outbuilding into a shed for storage, including removal of existing roof, removal of cementitious mortar and replace with lime mortar, replace timber wall plate, joists and lintel, reinstate door and window, existing floor, installation of gutter and clearance around base of walls.
- Building No. 7: Conversion of outbuilding to housing of utilities, including repointing internally and externally, reinstating wall plates and joists, replaced roof to match dairy, reinstate door and window, installation of gutter and clearance around base of walls.
- Building No. 8: Restoration of existing barn, including repointing and stabilisation of all walls internally and externally, replace roof and timber roof joists, and alterations to existing ground level to north end, clearance around base of walls and reinstating guttering.

The archaeological mitigation comprised of a Level 2/3 building record prior to development. The building record was completed during the 8th of April 2025 and monitored by Heneb: GA in accordance with an approved written scheme of investigation (Appendix I). In line with the regional Historic Environment Record (HER) requirements, the HER was contacted at the onset of the project to ensure that any data arising was formatted in a manner suitable for accession; the HER Event Primary Reference Number for this project is 49216.

All work was planned, managed and undertaken by Heneb: Gwynedd Archaeology Field Services

Heneb: Gwynedd Archaeology. 2025. Parc, Talwrn, Ynys Mon **(HD24-116)** Report No. 18.17. Archaeological Mitigation: Level 2/3 Building Record. April 2025. Project HD24-116.

1 – Digital Data

Stakeholders

John Roberts (Heneb: Head of Archaeology);
Sean Deby (Heneb: Gwynedd Historic Environment Record (HER))
Helen Rowe (Senior Archivist), Royal Commission on Ancient and Historical Monuments of Wales.

Selection

All digital data will be collected, stored and selected in lines with the Heneb: Gwynedd Archaeology (GA) Data Management Plan located on GA's servers (available on request).

The final version of all born digital documents have been selected for inclusion in the Preserved Archive; these comprise:

- HD24-116_Parc_Talwrn_Written_Scheme_of_Investigation (Microsoft Word and Adobe PDF);
- HD24-116_Photographic_Metadata (Microsoft Access);
- GAT_1817 (Microsoft Word and Adobe PDF);
- Photographic archive (126 images in TIFF format);
- Photographic archive (126 images in RAW format);
- Photographic archive (126 images in JPEG format);

A digital archive dataset has been created for the Royal Commission on Ancient and Historic Monuments Wales, in accordance with the *RCAHMW Guidelines for Digital Archives Version 1*. The dataset has been prepared in the format required by RCAHMW and comprise:

- Photographic metadata (Microsoft Access);
- Photographic archive (TIFF format);
- Project Information form (Excel);
- File Information form (Excel) – Microsoft Word report text final;
- File Information form (Excel) – Photographic metadata (general);
- File Information form (Excel) – Adobe PDF report final; and
- File Information form (Excel) - Photographic metadata (detail).
-

The digital archive has been stored on a dedicated Trust server, with the location confirmed in the Heneb project database via a specific hyperlink.

De-Selected Digital Data

The following client data will not form part of the preserved archive and have been deselected:

- HD24-116 Figure 01 Client produced location plan of development area
- HD24-116 Figure 02 client produced existing plans of development area
- HD24-116 Figure 03 client produced existing plans of development area

The following Heneb data generated for the report will not form part of the preserved archive and have been deselected:

- HD24-116_combined_figures.pdf
- HD24-116_combined_plates.pdf
- HD24-116_Figures_and_Plates_List.docx

- HD24-116_Appendix_I.pdf
- HD24-116_Appendix_II.docx
- HD24-116_Appendix_III.pdf
- HD24-116_front_cover.pdf
- HD24-116_inner_cover.pdf
- HD24-116_rear_cover.pdf
- Plates 01 to 107.pdf
-

Amendments

No amendments to the above selection strategy have been made.

Date	Amendment	Rationale	Stakeholders

2 – Documents

Stakeholders

John Roberts (Heneb: Head of Archaeology);
 Sean Deby (Heneb: Gwynedd Historic Environment Record (HER))
 Helen Rowe (Senior Archivist), Royal Commission on Ancient and Historical Monuments of Wales.
 Gareth Edwards, Head of Knowledge and Understanding, RCAHMW

Selection

- A digital report will be provided to Gwynedd Historic Environment Record; this will be submitted within six months of project completion (final report only), along with a digital dataset comprising an Event PRN summary. The report and dataset will be submitted in accordance with the required standards set out in *Guidance for the Submission of Data to the Welsh Historic Environment Records (HERs)* (Version 4.1); and
- A digital report and digital archive dataset will be provided to Royal Commission on Ancient and Historical Monuments, Wales (final report only), in accordance with the *RCAHMW Guidelines for Digital Archives Version 1*.

The dataset will be prepared in the format required by RCAHMW, and where relevant, include:

- Photographic metadata (Microsoft Access);
- Project Information form (Excel);
- File Information form (Excel) – Microsoft Word report text final; and
- File Information form (Excel) – Adobe PDF report final.
- File Information form (Excel) – Microsoft Word report text final;
- File Information form (Excel) – Photographic metadata (general);
- File Information form (Excel) – Adobe PDF report final; and
- File Information form (Excel) - Photographic metadata (detail).

Following the completion of the fieldwork, all documentary material created, generated and/or annotated during data gathering and fieldwork has been selected for inclusion in the preserved archive, and comprises:

- HD24-116 basic record sheets x 5
- HD24-116 room recording sheet x8
- HD24-116 photographic register sheets x 6

The physical archive has been stored in a designated project folder and the location confirmed in the Heneb project database.

De-Selected Documents

Describe the procedure for dealing with De-selected material and what specialist advice has informed this procedure.

No documents have been de-selected.



Craig Beuno, Ffordd y Garth, Bangor, Gwynedd, LL57 2RT

www.heneb.org.uk

Ffon: 01248 352535 email: gat@heneb.org.uk