

# AERIAL MAPPING PROJECT 1998-99

Report on SH77SW

**G1555**

Ymddiriedolaeth Archaeolegol Gwynedd  
Gwynedd Archaeological Trust

Report No. 307

# **AERIAL MAPPING PROJECT 1998-99**

Report on SH77SW

**G1555**

Ymddiriedolaeth Archaeolegol Gwynedd  
Gwynedd Archaeological Trust

Report No. 307

## AERIAL MAPPING 1998-99 (G1555) . . .

### Introduction

The aerial mapping project for 1998-99 began work on OS quartersheet SH77SW, following on from the previous years' work on SH67SE. The project covered an area of approximately five square kilometres, centred on SH7174, extending eastwards to the prehistoric complex of Cefn Coch and south to Ffridd Fadog and the Afon Ddu. The project area, located in the north east of the Snowdonia National Park, consisted of open upland rough grazing to the east with enclosed *ffridd* and smaller fields on the lower ground to the west. The area was bounded to the north by the outcrop Clip yr Orsedd and the southern extent of Graiglwyd. The area exhibits considerable variations in altitude, ranging from c. 220m OD in the west to a maximum of 435m OD on the summit of Moelfre. A number of river valleys with steeply sloping sides cross the area, most notably Afon Ddu and Afon Maes-y-Bryn.

### Methodology

The methodology broadly followed that established in previous years, (see GAT Report No. 299). The principal sources of information were black and white vertical photographs supplied by the Royal Commission on Ancient and Historic Monuments and the Welsh Office Air Photograph library. Of these, the best source was the 1948 March sortie *CPE/UK/2525*. The 1947 April sortie *CPE/UK/1996* was also used but was significantly less clear. Information from the vertical sources was supplemented by a number of oblique black and white prints supplied by RCAHM. Within the area covered by the project, oblique photographs were only available for specific sites, namely the Cefn Coch complex, Dinas hillfort and environs and a sheepfold at Maes y Bryn.

As with last years project, problems of accuracy were encountered due to the height variations across the area. This was not so much of a problem when mapping the small enclosures in the west of the area, but control points were hard to come by on the open moorland to the east and in some places, details had to be sketched in as accurately as possible by eye. These areas are identified with text on the final FastCad drawing.

As a background to the mapped archaeology, an extract of the OS 1:10000 scale colour map data was used. This is supplied to the Gwynedd Sites and Monuments Record under an agreement with Conwy County Borough Council and can be used for SMR enhancement purposes. The OS background data is reproduced in this report under licence no. LA0900L and is for display purposes only.

### Results

An extract of the Sites and Monuments Record for quartersheet SH77SW was used as the basis for mapping and record creation. Prior to the project, around 38 sites of archaeological interest were recorded in the area finally covered. These included the prehistoric complex at Cefn Coch, a group of cairns at Bryniau Bugeilydd and a number of settlements sites in the environs of Dinas Hillfort. After mapping and record creation, 103 new sites had been added to the record and significant details had been added to six of the existing sites/groups of sites. The results of the project are discussed in more detail under period headings below.

#### *Prehistoric*

The best known and probably the earliest prehistoric remains in the project area are those at Cefn Coch, to the south of Graiglwyd. The complex consists of two major monuments, the Druid' Circle stone circle and a ring cairn just to the south west. A number of cairns and enclosures are also recorded in the area and as a result of the project, another enclosure has been added as well as four circular features. In addition, an enclosure noted previously from the air by Mary Aris and recorded in *Archaeology in Wales*, (PRN 5065), has been mapped in more detail.

A number of burnt mounds have been recorded in two main areas, south west of Clip yr Orsedd and around Ffridd Forfudd. The majority of the sites are located on the banks of small streams but, as some show as spread circular mounds, their identification is necessarily tentative.

Hut circles, both individual and in groups, account for the remaining prehistoric sites. Twelve possible single hut circles have been identified, some of which appeared to be associated with field walls/field systems. However, with some sites, for example PRN 8031, it is impossible to say categorically that the hut is contemporary with the enclosure from the evidence of the aerial photograph, however likely that would seem, (see fig.1).

Evidence to suggest the possibility of two new hut groups was mapped, one at a previously recorded enclosure, PRN 5473 and the other on open ground to the east of Ffridd Forfudd, PRN 8069. The latter consists of two hut circles and a substantial earth bank which may be the remains of an associated field system. Again, on the evidence of the photographs alone, this is purely conjecture.

Further detail was also added to a hut group recorded in the Caernarvonshire Inventory, to the east of Dinas Hillfort, (PRN 498). Four huts were previously recorded here, two of which had been mapped by the OS. The site has now been mapped in more detail and it is clear that the site is enclosed, although the evidence suggests that the enclosure and the two smaller huts within it were later additions, (see fig.2).

For the most part, the hut circle settlements have been recorded as being of prehistoric date. It is quite likely that many of these sites continued in use into the Romano British period and some may have originated at a later date.

#### Dinas Hillfort.

The site of the hillfort was partially included in the area although the majority of the site lies in SH67SE. Because of the difficulties in obtaining control points on such a steep sided hill, and despite excellent oblique coverage, the hillfort has not been mapped. It was decided not to attempt sketching in any details as the OS background was missing for at least half the hillfort and it would be almost impossible to create an accurate record of the site. It may be possible to rectify this omission as part of next years project.

#### *Romano British*

Only two sites in the survey area were recorded as being of Romano British date. One was a single hut circle and the other was an enclosure recorded as a Roman Fortlet, PRN 3990. A large rectangular enclosure was mapped close to the NGR for PRN 3990 and it is likely that this is the site in question. However, there is no evidence to suggest a Roman date and, in fact, the location of the enclosure makes the interpretation of a fortlet very unlikely.

#### *Medieval*

The majority of sites recorded as being of medieval date are settlements sites – long huts and platform huts, although this is on typological grounds and can be problematical as long huts continued to be built into the post medieval period. Five such sites were newly recorded during the project and four were already known to exist in the area. In most cases, areas of cultivation were recorded nearby the settlement sites, whether they were contemporary or not is difficult to say. A significant number of the field systems recorded as part of this project may well have been medieval in date but, with the lack of conclusive evidence, they have been recorded as period 'undetermined'.

#### *Post medieval and modern*

The vast majority of the sites recorded as part of this project are agricultural in nature and probably post medieval in date. These include field walls, both relict and otherwise, enclosures and sheepfolds. A number of the domestic settlements marked on the OS map and still inhabited today may be of post medieval date, but these have not been included in the project. The most notable post medieval site within the survey area was the multi cellular sheepfold, PRN 8042. This site, (see fig. 3), consists of five individual compartments, one of which is sub-divided into two sections. The compartments are linked by walls. Immediately to the south and west of the sheepfold, traces of an underlying structure may indicate an earlier use of the site, which is located on slightly sloping ground on the north bank of Afon Maes-y-Bryn.

Because of the difficulties of assigning dates to many of the features mapped from the aerial photographs, it is not possible to say to what extent post medieval and later land use has obliterated earlier field patterns. However, there does seem to be a reasonable degree of survival amongst the enclosures to the south of the area, around Ffridd Forgan, whereas to the north, improvement and drainage may have removed similar evidence.

### *Industrial*

The only evidence for industrial activity in the area comes in the form of what may be linear spoil heaps, to the west of Clip yr Orsedd. The interpretation is fairly tentative, especially as the features are not visible on the clearer 1948 vertical photographs.

### Conclusions

#### *Archaeological*

As has already been said, the majority of sites recorded during the project are the remains of the past, agricultural, use of the land, either of post medieval or unknown date. As might be expected, the smaller fields at lower altitudes showed the greatest degree of survival, despite continuity of use and improvement. The open land to the east of the area remains largely empty with the notable exceptions of Cefn Coch and Bryniau Bugeilydd, and the possible hut circle settlement east of Ffridd Forfudd.

It is hard to draw conclusions from the mapped evidence alone but, without the benefit of fieldwork, the following are offered as observations.

To the north and east of Dinas Hillfort, settlement remains exist in the form of single hut circles, often associated with field walls although not necessarily contemporary with them. Two long huts are recorded in this region and the faint traces of one of them were mapped during the project. The majority of the long huts in the area, however, lie to the south and east of the hillfort around Ffridd Fadog and Ffridd Forfudd. An area of small fields and enclosures around the former, associated with traces of cultivation, may represent some continuity of land use, at least from the medieval period onwards.

It is also to the south and east of Dinas Hillfort that the remains of the hutgroups are found, four in all although, again, not necessarily contemporary. The area around the hillfort itself is of interest as having examples of all three settlement sites in close proximity, (see fig.4). The remains of field systems here may have been contemporary with the hut circles in their original form and later modified by the occupants of the long huts.

The other observation that can be made is that, as one would expect, the traces of settlement and cultivation are found at the lower altitudes to the west of the area whereas to the east, the archaeology is made up of cairns, both field clearance and funerary, mounds and the trappings of upland, pastoral agriculture. Again, it is worth mentioning the exception to this rule, the hut circle settlement PRN 8069, a site which would greatly benefit from fieldwork to confirm this interpretation.

#### *Methodological*

Although this has been the case in all the previous aerial mapping projects, it is worth stating again the problems encountered with the sort of terrain being covered, as this poses the greatest problems. By definition, the Snowdonia National Park is an upland area and the two main difficulties encountered in upland areas are i. large open areas with few mapped features off which control points can be taken and ii. marked variations in height across any given area, making the number and accuracy of control points vitally important. The combination of these two factors significantly limits the amount of mapping that can be achieved within the given timescale. In some of the open areas around Waun Llanfair and Moelfre, it was not possible to get the level of accuracy below 20m, which was not satisfactory within the project specifications. This is the main reason why the project concentrated on mapping the area to the west where control points were easier to come by.

The project is also dependant on the availability of good photographic sources, and in this case, good cover was not available for the whole area. The choice is between better preserved, modern vertical photographs where some of the archaeology has been lost and the black and white sources showing perhaps more archaeology but in poorer condition themselves and the earlier sources are not always the best. Using both in combination may be a possibility worth investigating.

A third factor in determining the amount and quality of information that can be mapped in any given project is the hardware and software available for use. As in previous years, this project used AutoCad 12 to digitise and rectify the information, FastCad 2 to draw it up and Fastmap 3.2 for the record creation stage. Recent advances

in both GIS and CAD software have served to emphasise the limitations of this methodology. The problems of using the DOS version of Fastmap with an external database have been mentioned in previous years and it is still the case that descriptions and measured dimensions of sites have to be noted on paper first as it is impossible to do this at the same time as completing the record form which fills the whole screen. It is also worth noting that the half day needed to overcome Fastmap's memory problems has become a familiar part of the methodology. Some of the options for replacing Fastmap would be well worth investigating.

#### *General*

The 1998-99 aerial mapping project covered an area of approximately five square kilometres and resulted in the creation of 103 new records, of which most were agricultural features. Approximately 38 sites were already recorded in the area and enhanced detail was added to six sites/groups of sites, including the Cefn Coch complex. Unfortunately, due to problems of accuracy, Dinas Hillfort and the cairns at Bryniau Bugeilydd were omitted.

The project identified several areas that would benefit from further survey, notably the environs of Dinas Hillfort, Ffridd Forgan, Ffridd Forfudd and Maes-y-Bryn, all of which demonstrated a reasonable degree of archaeological survival, hitherto unrecorded.

#### **Sources.**

##### *Photographic*

CPE/UK/1996 2284-90 & 4293-300 1947 1:10000  
CPE/UK/2525 4042-8 & 4061-5 1948 1:10000

RCAHMW oblique prints  
945116/61-70  
945123/51-2  
945140/59-65  
965001/55  
965002/41-6

##### *Published*

RCAHM 1956 Inventory of the Ancient Monuments of Caernarvonshire Vol. I (East)  
CBA Group 2 1986 Archaeology in Wales Vol.26

##### *Unpublished*

Gwynedd Sites and Monuments Record

PRN 8031 -  
which may or  
Scale: 1:750

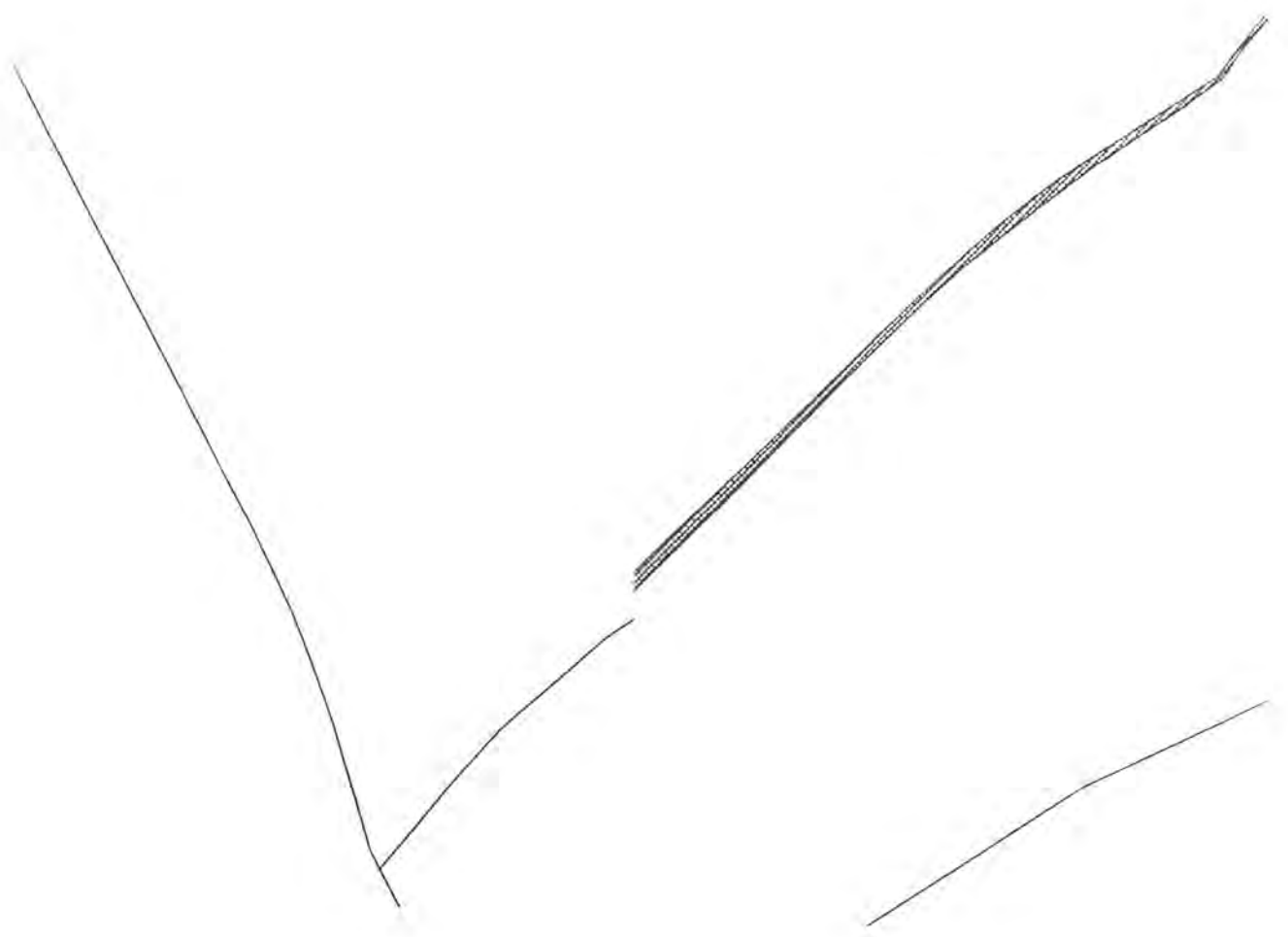
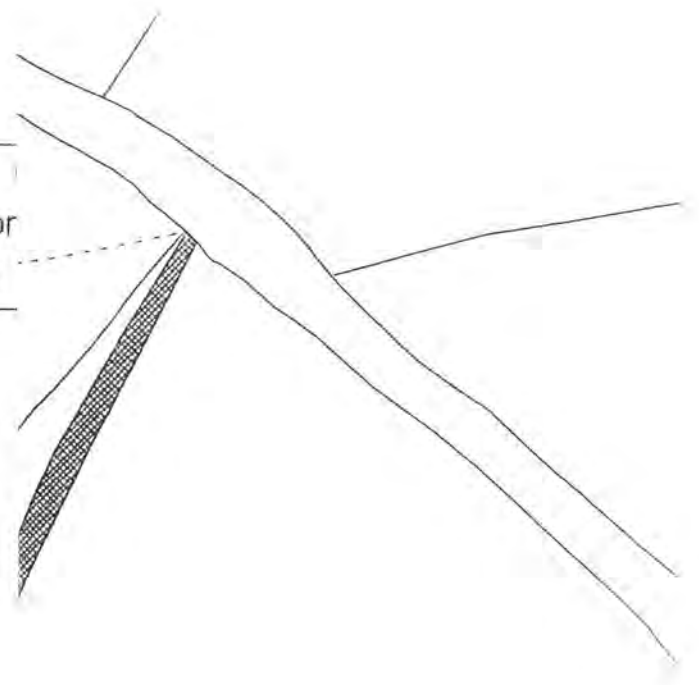

PRN 498 - Enclosed Hut Group,  
Scale: 1:500  
FIG. 2

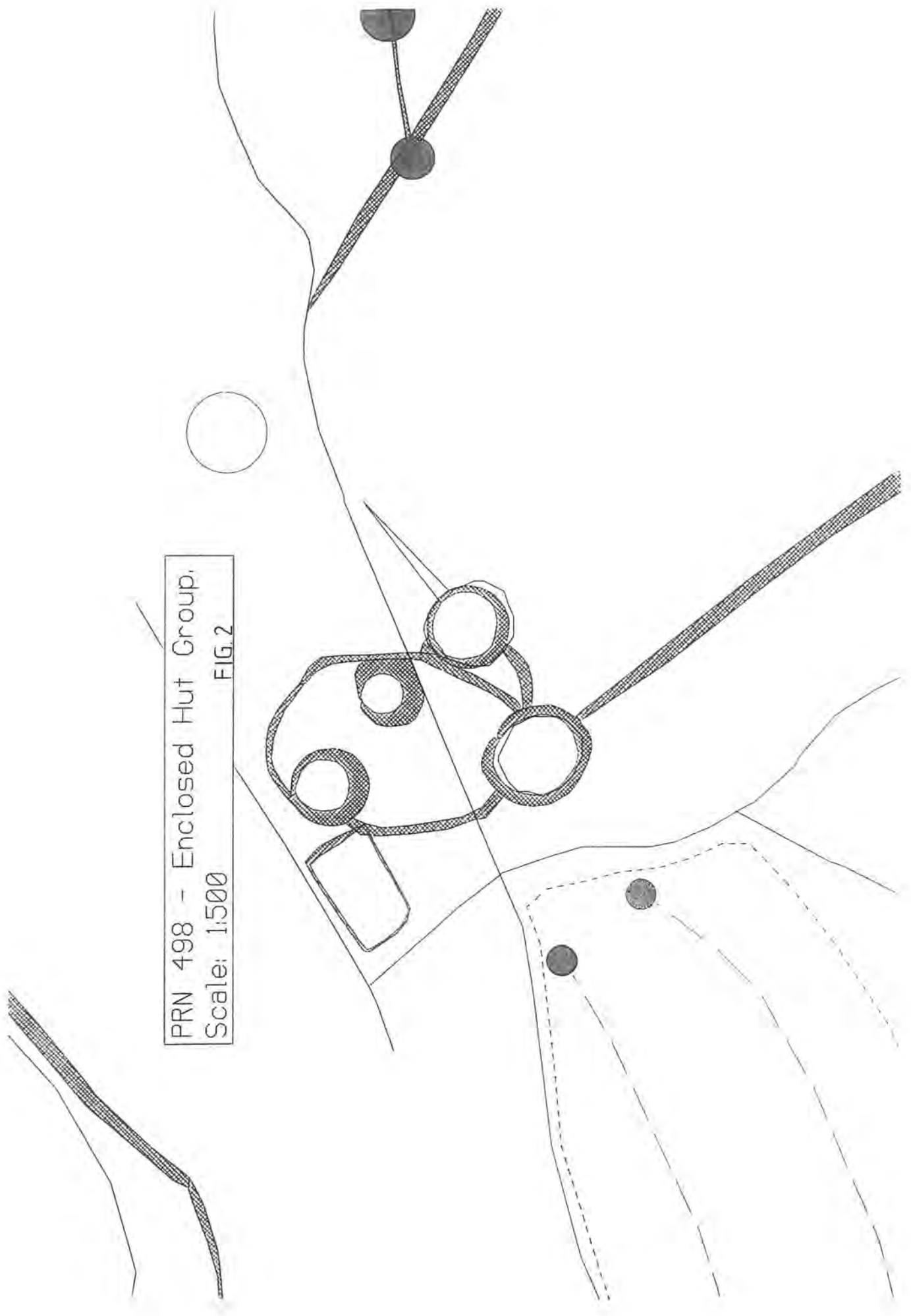



PRN 8042 - Multi-cellular sheepfold at Maes y Bryn  
Scale: 1:500

FIG. 3

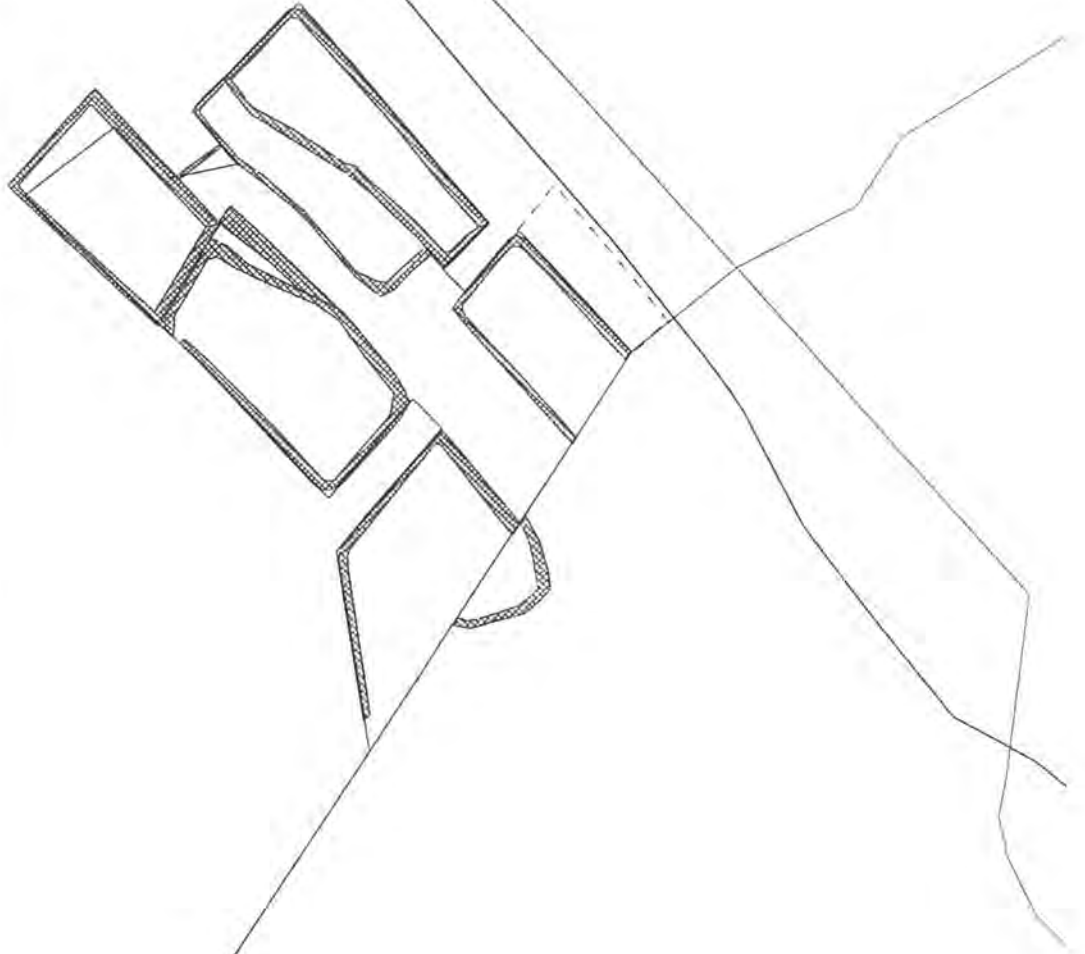

viroons of Dinas Hillfort.  
FIG. 4

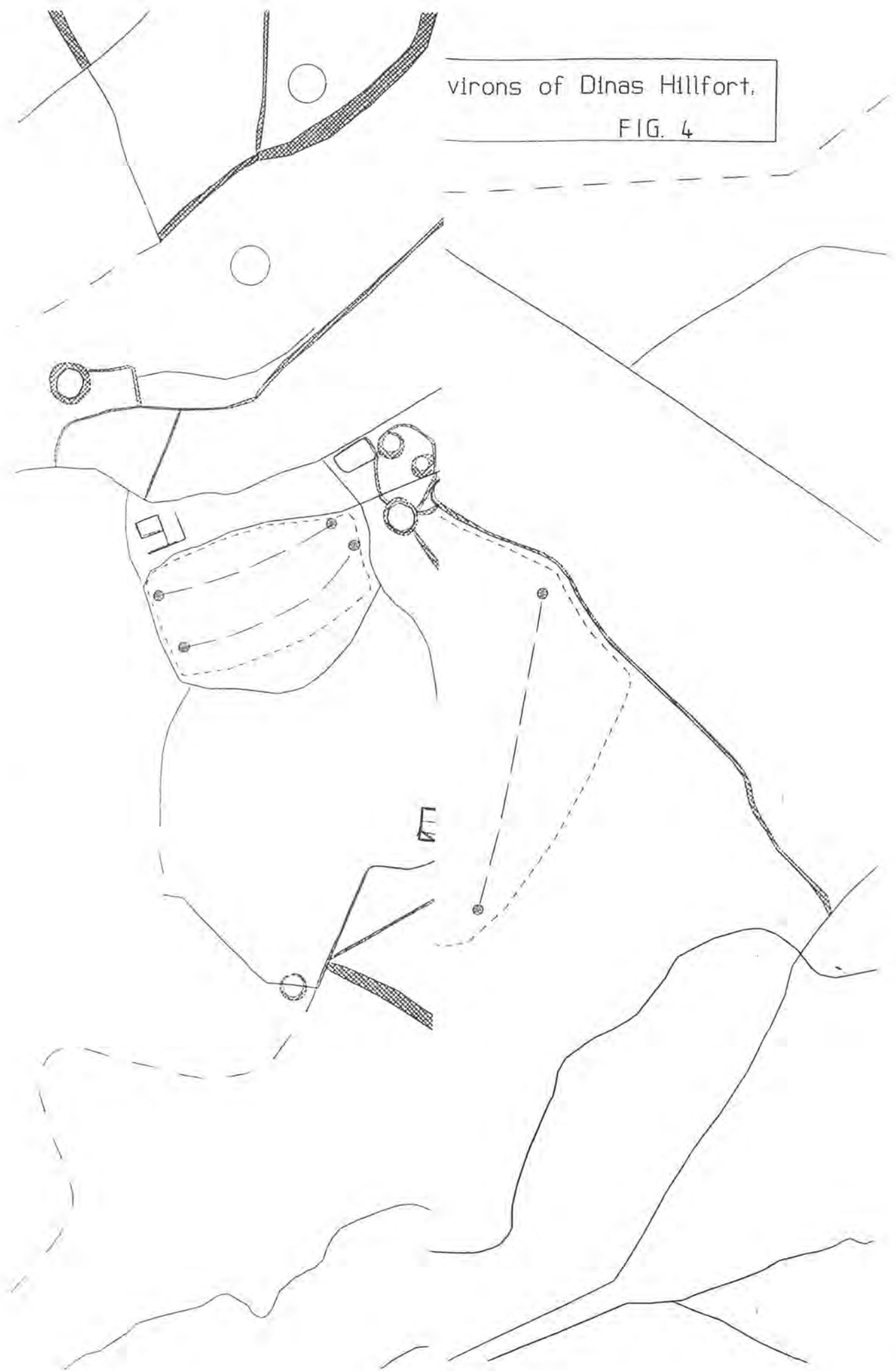

## **Appendix 1.**

SMR database for OS quartersheet SH77SW – with new records added.

<u>PRN</u>	<u>SITENAME</u>	<u>NGR</u>	<u>STATUS NO</u>
/392	DINAS CAMP HILLFORT	SH70027379	C049
/456	CAIRN, CARNEDD Y DDELW	SH70787055	
/457	PLATFORM HOUSE <i>A SMALL PLATFORM HUT, 7M X 5M AND ALIGNED E-W.                  IS CONSIDERABLY THICKER. TRACES OF 72 PADDOCKS                  AND EAST.</i>	SH70107390 <i>THE WALLS ARE C. 0.4M TO 0.5M THICK, BUT THE S WALL                  OF SIMILAR DIMENSIONS ARE ATTACHED TO THE SOUTH</i>	
/458	LONG HUTS, WAUN LLANFAIR	SH70797458	
/459	CAIRN, FOEL LWYD	SH71397273	
/460	CAIRN, CEFN COCH	SH71727441	C024
/461	CAIRN, FFRIDD ARW	SH70417234	
/462	CAIRN, AFON DDU	SH71037241	
/463	CAIRN, LLANERCH FEDW	SH70897198	
/464	CAIRN, CEFN COCH <i>SMALL GRASSED OVER CAIRN.</i>	SH71667468	C024
/465	BARROW, MAES Y BRYN <i>SMALL MOUND 2.5M ACROSS RECORDED ON SMR AS A</i>	SH70527412	
			<i>BARROW.</i>
466	BURNT MOUND, WAUN LLANFAIR	SH71507415	
/467	BURNT MOUND	SH71737383	
/468	BURNT MOUND, W OF FOEL LWYD	SH71207285	
/469	BURNT MOUND, AFON DDU	SH71067244	
/470	CAIRNFIELD, N OF FOEL LWYD	SH71987334	
/471	CAIRNFIELD, CERRIG GWYNION	SH72257366	
/472	CAIRNFIELD, BRYNIAU BUGEILYDD	SH72007394	

<u>PRN</u>	<u>SITENAME</u>	<u>NGR</u>	<u>STATUS</u> <u>NO</u>
473/	CAIRNFIELD, BRYNIAU BUGEILYDD	SH71827401	
474/	CAIRNFIELD, BRYNIAU BUGEILYDD	SH71847404	
475/	BOULDERS COVERED BY MOUND, BRYNIAU BUGEILYDD	SH72007393	
476/	CAIRNFIELD, CERRIG GWYNION	SH72307366	
477/	CAIRNFIELD, N OF FOEL LWYD	SH72007333	
478/	CAIRN, BRYNIAU BUGEILYDD	SH71957378	
479/	HUT, W OF FOEL LWYD	SH71387226	
480/	HUT CIRCLES, W. OF FOEL LWYD	SH71357237	
481/	HUT CIRCLES, W. OF FOEL LWYD	SH71347253	
482/	SETTLEMENT, W. OF FOEL LWYD	SH71327277	
483/	CAIRN, LLANERCH FEDW	SH70557201	
484/	CAIRN, BRYNIAU BUGEILYDD	SH71967408	
485/	CAIRN, BRYNIAU BUGEILYDD	SH72007398	
486/	CAIRN, BRYNIAU BUGEILYDD	SH71957392	
487/	CAIRN, BRYNIAU BUGEILYDD	SH72047390	
488/	BURNT MOUND, BRYNIAU BUGEILYDD	SH72037393	
489/	CAIRN, BRYNIAU BUGEILYDD	SH71957384	
490/	CAIRN, BRYNIAU BUGEILYDD	SH72037382	
491/	CAIRN, BRYNIAU BUGEILYDD	SH72017379	
492/	CAIRN, BRYNIAU BUGEILYDD	SH72077379	
493/	CAIRN	SH72067324	

<u>PRN</u>	<u>SITENAME</u>	<u>NGR</u>	<u>STATUS NO</u>
494 ✓	CAIRN, N OF FOEL LWYD	SH72097328	
495 ✓	CAIRNFIELD, CERRIG GWYNION	SH72207370A	
496 ✓	CAIRN, CERRIG GWYNION	SH72227366	
497 ✓	MOUND OF STONES, BRYNIAU BUGEILYDD	SH71797403	
498 ✓	HUT CIRCLE SETTLEMENT, DINAS CAMP <i>ENCLOSED HUT GROUP CONSISTING OF SUB-OVAL ENCLOSURE AND 4 HUTS. HUT1 IS 10M IN DIAMETER, HUT2 C.8.5M BOTH APPEAR TO PREDATE TO THE ENCLOSURE AND ARE ATTACHED BY A SHORT CURVING WALL. HUTS3 &amp; 4 ARE SMALLER, INSIDE THE ENCLOSURE. RECT. HUT TO THE NW</i>	SH70177392	
499 ✓	ENCLOSURE & ROUND HUT, FFRITH Y DDWYFFRWD	SH74287241	
500 ✓	ROUND HUT/ENCLOSURE, FFRITH Y DDWYFFRWD	SH74297214	
501 ✓	HUT CIRCLE & ENCLOSURE, NR. MAEN-Y-BARDD	SH73917151	C181
502 ✓	HUT PLATFORM, NR. MAEN Y BARDD	SH73987163	C181
503 ✓	LONG HUT & ENCLOSURE, NR. MAEN Y BARDD	SH74097207	C157
504 ✓	SETTLEMENT, NR MAEN Y BARDD	SH73877215	
505 ✓	LONG HUT AND ENCLOSURE	SH74447235	
506 ✓	PLATFORM HOUSE	SH74267247	
507 ✓	PLATFORM HOUSE, NR. MAEN Y BARDD	SH74047186	C157
508 ✓	PLATFORM HOUSE, NR. MAEN Y BARDD	SH73997219	
509 ✓	HUT PLATFORM, NR. MAEN Y BARDD	SH73937140	C181
510 ✓	LONG HUT, NR. MAEN Y BARDD	SH73967224	
511 ✓	HUT PLATFORM, NR. MAEN Y BARDD	SH73777145	C181
512 ✓	HUT CIRCLE, PEN-Y-GROES UCHAF	SH74777038	
513 ✓	SETTLEMENT, PEN Y GADAIR	SH73807001	

<u>PRN</u>	<u>SITENAME</u>	<u>NGR</u>	<u>STATUS_NO</u>
514 ✓	HUT CIRCLES, TAFOLOG	SH72447121	
515 ✓	HUTS/ENCLOSURE	SH71637181	
516 ✓	LONG HUT	SH71687171	
517 ✓	LONG HUT, BWLCH Y DDEUFAEN	SH71407185	C129
518 ✓	LONG HUT, TAFOLOG	SH72407119	
519 ✓	CAIRN, BARCLODIAD Y GAWRES, BWLCH Y DDEUFAEN	SH71647166	C131a
520 ✓	ROUND CAIRN BWLCH Y DDEUFAEN	SH71827158	C131b
521 ✓	ROUND CAIRN BWLCH Y DDEUFAEN	SH71687163	C131c
523 ✓	STANDING STONE, BWLCH Y DDEUFAEN	SH71527178	C129a
524 ✓	STANDING STONE, BWLCH Y DDEUFAEN	SH71467183	C129a
525 ✓	STANDING STONES, NR. MAEN Y BARDD	SH74177182	C157
526 ✓	STANDING STONE, NR. MAEN Y BARDD	SH73557164	C181
527 ✓	STANDING STONE, NR. MAEN Y BARDD	SH73927170	C181
528 ✓	CERRIG PRYFAID STONE CIRCLE	SH72457132	C130
529 ✓	MAEN Y BARDD BURIAL CHAMBER	SH74067178	C027
530 ✓	BURIAL CHAMBER, NR. MAEN Y BARDD	SH74127189	C157
531 ✓	BURNT MOUND, TAFOLOG	SH72967125	
532 ✓	SETTLEMENT, NR. MAEN Y BARDD	SH73867139	C181
533 ✓	LONG HUT, W. OF CEFN MAEN AMOR	SH73397396	
534 ✓	CAIRNS, CEFN COCH	SH71687476	C024
535 ✓	CAIRNS, CEFN COCH	SH71727472	C024

<u>PRN</u>	<u>SITENAME</u>	<u>NGR</u>	<u>STATUS</u> <u>NO</u>
536 /	CAIRNS, CEFN COCH	SH71727473	C024
537 /	MOUND & STONE CIRCLE, CEFN COCH	SH72607480	C024
538 /	MOUND, CEFN COCH	SH72387470	C024
539 /	STONE RING, CEFN COCH, ABOVE PENMAENMAWR	SH72507476	C024f
540 /	CAIRN, MAEN CRWN	SH73267499	
541 /	DRUIDS' CIRCLE (STONE CIRCLE), CEFN COCH <i>THIS SITE IS ALREADY DESCRIBED IN DETAIL IN A NUMBER OF SOURCES. NO FURTHER DETAIL ADDED FROM THE APS.</i>	SH72287464	C024
542 /	RING CAIRN, CEFN COCH, ABOVE PENMAENMAWR <i>THE SITE IS ALREADY DESCRIBED IN DETAIL IN A NUMBER OF SOURCES. NO FURTHER DETAIL WAS ADDED FROM THE APS.</i>	SH72157456	C024b
543 /	STONE CIRCLE, CEFN COCH	SH71847466	C024
544 /	STONE CIRCLE, CEFN COCH, ABOVE PENMAENMAWR <i>ROUGHLY OVAL SHAPED FEATURE THOUGHT TO MARK THE LOCATION OF THE STONE CIRCLE. PRN 544.</i>	SH72197463	C024d
545 /	HUT GROUP (ENCLOSED), NR. MAEN Y BARDD	SH74417216	
546 /	ENCLOSURE, NR. MAEN Y BARDD	SH74097191	C157
547 /	HUT GROUP, NR. MAEN Y BARDD	SH74007187	C157
548 /	ENCLOSURE, NR. MAEN Y BARDD	SH74037172	C181
549 /	ENCLOSURE, NR. MAEN Y BARDD	SH74027161	C181
550 /	HUT GROUP (ENCLOSED), NR. MAEN Y BARDD	SH73787167	C181
551 /	HUT CIRCLES, NR. MAEN Y BARDD	SH73507166	C181
553 /	CAIRN, CLIP YR ORSEDD <i>NOT SEEN ON AP SOURCES</i>	SH70837483	
554 /	HUT CIRCLE, CLIP YR ORSEDD	SH71037499	
555 /	CAIRN, CEFN COCH	SH72127448	C024



<u>PRN</u>	<u>SITENAME</u>	<u>NGR</u>	<u>STATUS NO</u>
556 ✓	CAIRN, CERRIG GWYNION ✓	SH72627423	
557 ✓	HUT CIRCLE SETTLEMENT, TAL-Y-FAN	SH73397355	
558 ✓	ROCK & MOUND, FOEL LWYD	SH72447278	
559 ✓	ROUND CAIRN, BWLCH Y DDEUFAEN	SH71387183	C129b
560 ✓	ROUND CAIRN BWLCH Y DDEUFAEN	SH71727158	C131d
561 ✓	LONG HUT & ENCLOSURES, CEFN MAEN AMOR	SH73917346	
562 ✓	MAEN PENDDU STANDING STONE	SH73907357	C126
563 ✓	CAER BACH HILLFORT	SH74437297	C125
564 ✓	ENCLOSURE, FFRITH Y DDWYFFRWD	SH74447272	
565 ✓	HUT CIRCLE, CAER BACH	SH74367293	
566 ✓	LONG HUTS, FFRITH Y DDWYFFRWD	SH74607270	
567 ✓	LONG HUTS & ENCLOSURES, CRAIG CENNIN	SH74947310	
569 ✓	PLATFORM HOUSE, CAER BACH	SH74397293	C125
570 ✓	PLATFORM HOUSE, CAER BACH	SH74587300	
571 ✓	PLATFORM HOUSE, CAER BACH	SH74477300	
575 ✓	CAIRN WEST OF MAEN PENDDU	SH73847359	
576 ✓	STANDING STONE, HAFOTY	SH74797496	C116
1430 ✓	CROSS-INCISED STONE NR MAEN Y BARDD, ROWEN	SH73627162	
1903 ✓	ARROW STONE, LLANERCH FEDW	SH71017249	
2860 ✓	CIRCLE WITH TUMULUS, WAEN GYRACH	SH74007492	
2874 ✓	CAIRN, E. OF RED FARM	SH73257499	

<u>PRN</u>	<u>SITENAME</u>	<u>NGR</u>	<u>STATUS_NO</u>
3487 ✓	BURIAL CHAMBER SITE OF BLAEN-Y-BARDD	SH74407170A	
3842 ✓	ROMAN ROAD : CANOVIUM - SEGONTIUM	SH	C131e
3859 ✓	TRACKWAY : NR. DRUID'S CIRCLE, CEFN COCH	SH	C024
3860 ✓	TRACKWAY : OVER BWLCH Y DDEUFAEN	SH	C024
3888 ✓	PLATFORM HOUSE, DROSGL	SH70727164	
3990 ✓	ROMAN FORTLET (POSS.), WAUN LLANFAIR <i>REMAINS OF A LARGE RECTANGULAR ENCLOSURE, NOTED ON THE SMR AS A POSS. ROMAN FORTLET. THE ENCLOSURE MEASURES 87M X 104M. ALTHOUGH THIS IS NOT ITS FULL LENGTH AS IT IS CUT BY A MODERN FIELD WALL. ALIGNED SE-NE. LOCATION MAKES ROMAN ORIGIN UNLIKELY</i>	SH70457414	
4603 ✓	ARROW STONE - FINDSPOT, NR TYDDYN GRASOD,	SH74307470A	
4678 ✓	MAEN CRWN STANDING STONE	SH73107499	
4679 ✓	CAIRNS/MOUNDS, CEFN COCH	SH72307457	C024
4680 ✓	MOUNDS (NATURAL?) - CEFN COCH	SH72347455	C024
4681 ✓	CAIRN, CEFN COCH	SH72367454	C024
4682 ✓	CAIRN - CEFN COCH	SH72217458	C024
4683 ✓	MOUND, PEN Y GADAIK	SH73527021	
4684 ✓	HUT CIRCLE, WAUN LLANFAIR <i>SMALL HUT CIRCLE. C.8.7M IN DIAMETER</i>	SH70917467	
4685 ✓	LONG HUT (REMAINS OF), WAUN LLANFAIR	SH70727461	
4686 ✓	CIST (REMAINS OF), N OF TYDDYN GRASOD	SH74277493	
4687 ✓	CAIRNS, FFRITH Y DDRYFFRWD	SH74297261	
4688 ✓	ROMAN MILESTONE	SH71987155	
4689 ✓	STANDING STONE (ALLEGED), MAEN Y BARDD	SH74227177	

<u>PRN</u>	<u>SITENAME</u>	<u>NGR</u>	<u>STATUS NO</u>
4691 ✓	FIELD SYSTEM, NR. MAEN Y BARDD	SH74107200C	C157
4692 ✓	LONG HUT, FFRITH Y DDWYFFRWD	SH74297229	
4693 ✓	EARLY FIELD SYSTEM, PEN Y GROES UCHAF	SH74507000A	
4694 ✓	PLATFORM HOUSE (REMAINS OF), PEN Y GROES UCHAF	SH74737026	
4695 ✓	CAIRN WITH CIST, FFRITH Y DDWYFFRWD	SH74327230	
4696 ✓	HOUSE, MAEN Y BARDD	SH74437167	
4700 ✓	SETTLEMENT, PEN Y GADAIR	SH73777000	
4701 ✓	LONG HUT, PEN Y GADAIR	SH73717008	
4702 ✓	ENCLOSURE	SH71607177	
4703 ✓	LONG HUT	SH71667170	
4704 ✓	GRAIG LWYD AXE, FINDSPOT	SH72007150A	
4705 ✓	ANCIENT CULTIVATION, CERRIG GWYNION	SH72907420A	
4706 ✓	PLATFORM HOUSE & CAIRN	SH71947492	
4707 ✓	CAIRN - SITE OF, CEFN COCH	SH72387462	C024
4708 ✓	HUT CIRCLES, W OF FOEL LWYD	SH71317231	
4709 ✓	HUT CIRCLES, W OF FOEL LWYD	SH71357241	
4710 ✓	CAIRNFIELD, BRYNIAU BUGEILYDD	SH71837403	
4711 ✓	PEAT STACK, CEFN MAEN AMOR	SH73957352	
4712 ✓	ENCLOSURE, TAL-Y-FAN	SH72977355	
4713 ✓	PEAT HOUSE, TAL-Y-FAN	SH73347357	
4714 ✓	HUT CIRCLE - SITE OF	SH71617319	

<u>PRN</u>	<u>SITENAME</u>	<u>NGR</u>	<u>STATUS_NO</u>
4715 ✓	LONG HUT, TYDDYN GRASOD	SH74347469	
4716 ✓	HUT CIRCLE, CERRIG GWYNION	SH72607421	
4717 ✓	LONG HUT, N.W. OF FOEL LWYD	SH71517292	
4718 /	CAIRN, N OF CAER BACH	SH74367314	
4719 ✓	ENCLOSURE?	SH71017144	
4720 ✓	GRAIG LWYD AXE - FINDSPOT	SH70507380A	
5065 ✓	CIRCULAR ENCLOSURE, CEFN COCH <i>THIS SITE WAS RECORDED BY MARY ARIS AND MARKED THE CORRECT LOCATION.</i>	SH72237463	C024
		<i>AT THE NGR SH72237463. HOWEVER, I THINK THIS IS</i>	
5066 ✓	STONE CIRCLE - CEFN MAEN AMOR	SH73867359	
5077 ✓	STONE CIRCLE : BWLCH Y DDEUFAEN	SH71537175	
5473 ✓	POSSIBLE ENCLOSED HUT GROUP, FFRIDD FORFUDD <i>SUB-CIRCULAR ENCLOSURE C.49M IN DIAMETER WITH ONE FURTHER THREE SMALLER HUTS AGAINST THE ENCLOSURE WALL. THE ENCLOSURE APPEARS TO BE DIVIDED INTO 2 HALVES BY A CURVILINEAR BANK ASSOC WITH PRN 7943</i>	SH70287328	
		<i>CENTRAL HUT, 11.3M IN DIAMETER AND POSSIBLY A</i>	
		<i>WALL. THE ENCLOSURE APPEARS TO BE DIVIDED INTO</i>	
5491 ✓	FIELD SYSTEM, MAEN AMOR	SH74507420C	
5837 ✓	RIDGE AND FURROW, CRAIG CELYNIN	SH74957300	
6096 ✓	PEAT HOUSE, W. OF FFRIDDLYS	SH73907350	
6227 ✓	CAIRN, MAEN AMOR	SH74117439	
6229 ✓	CAIRN, FOEL LWYD	SH71327275	
8000 ✓	LINEAR FEATURES W OF CLIP YR ORSEDD <i>POSSIBLE LINEAR SPOIL HEAPS NOT LOCATED ON 1948 AP SOURCES, A LARGE SUB-OVAL MOUND 15M TO THE WEST MAY BE ASSOCIATED WITH THE SPOIL HEAPS.</i>	SH70677472	
8001 ✓	FIELD BOUNDARY, W OF CLIP YR ORSEDD <i>LINE OF FORMER FIELD BOUNDARY SURVIVING AS A LOW AND SOUTH-EAST.</i>	SH7547478	
		<i>EARTHWORK. SIMILAR BOUNDARIES EXIST TO THE WEST</i>	
8002 ✓	ENCLOSURE, N OF CEFN COCH <i>SMALL ENCLOSURE BUILT AGAINST FIELD WALL.</i>	SH72147475	

PRN	SITENAME	NGR	STATUS NO
8003	CIRCULAR FEATURE, CEFN COCH SMALL CIRCULAR FEATURE C.8.5M IN DIAMETER CUT THE CEFN COCH COMPLEX, NOT LOCATE ON THE OBLIQUE	SH72207465 BY THE TRACKWAY WHICH RUNS IMMEDIATELY NORTH OF PRINTS BUT SHOWS CLEARLY ON THE 1948 VERTICALS	C024
8004	2 CIRCULAR FEATURES, CEFN COCH 2 CIRCULAR FEATURES OF SIMILAR DIAMETER (7.4M) CIRCLE. ALTHOUGH THEY SHOW CLEARLY ON THE VERTICAL AS CHANGES IN VEGETATION.	SH72147459 LOCATED CLOSE TOGETHER TO THE WEST OF THE DRUID'S APS AS EARTHWORKS, ON THE OBLIQUES THEY ARE VISIBL	C024
8005	SEMI CIRCULAR FEATURES, CEFN COCH SLIGHTLY ENIGMATIC SEMI CIRCULAR FEATURES CUT BY THE TRACKWAYS THAT LEAD FROM IT. INTERPRETA	SH72267463 IMMEDIATELY TO THE SW OF THE DRUID'S CIRCLE AND VERY UNCERTAIN INDEED.	C024
8006	OVAL ENCLOSURE, WAUN LLANFAIR SMALL OVAL ENCLOSURE C.12M X 10M	SH71357457	
8007	HUT CIRCLE, W OF CLIP YR ORSEDD A SMALL HUT CIRCLE, C.8.4M IN EXTERNAL DIAMETER ON THE WESTERN SIDE. A CURVED LENGTH OF WALL LEADS SW.	SH70537491 WITH AVERAGE WALL THICKNESS OF 0.6M BUT GREATER FROM THE HUT TO THE NE AND BELOW THE HUT TO THE	
8008	POSS. HUT CIRCLE, W OF CLIP YR ORSEDD POSS. HUT CIRCLE REVEALED AS CIRCULAR EARTHWORK ATTACHED TO THE S AND NE.	SH70497493 C. 12M IN EXTERNAL DIAMETER. AGAIN, HAS WALLING	
8009	ENCLOSURES, W. OF CLIP YR ORSEDD TRACES OF ENCLOSURES/FIELDS REVEALED AS LINEAR	AND ENCLOSING EARTHWORKS.	SH70787486
8010	2 RECTANGULAR STRUCTURES, W OF CLIP YR ORSEDD TRACES OF 2 RECTANGULAR STRUCTURES. THE SOUTH- NE-SW AND DIVIDED INTO TWO COMPARTMENTS. THE 8.2M X 3.8M AND ALIGNED NNE-SSW.	SH70927472 EASTERN STRUCTURE MEASURES 6.6M X 3.3M, ALIGNED STRUCTURE TO THE NW IS LARGER AND MORE EPHEMERAL	
8011	SHEEPFOLD, SW OF CLIP YR ORSEDD CONSISTS OF 2 SEPARATE COMPARTMENTS. ONE IS ARY BY A SHORT LENGTH OF WALL. THE OTHER, SLIGHTLY INTO TWO SECTIONS.	SH70767470 RECTANGULAR AND ATTACHED TO THE MODERN FIELD BOUND TO THE EAST IS SUB-RECTANGULAR AND SUB-DIVIDED	
8012	CULTIVATION RIDGES, SW OF CLIP YR ORSEDD SMALL AREA OF CULTIVATION RIDGES 608M SQUARE WITH FIELD BOUNDARY TO THE WEST OF LONG HUTS PRN458 AND	SH70647469 THE RIDGES RUNNING NNE-SSW, LOCATED WITHIN EARLIER PRN4685.	
8013	POSSIBLE HUT CIRCLE, WAUN LLANFAIR POSSIBLE REMAINS OF A HUT CIRCLE, CUT BY THE HUT IS APPROX. 11M. TRACES OF A SECOND HUT TO THE	SH70807463 MODERN FIELD WALL. THE EXTERNAL DIAMETER OF THE SOUTH?	
8014	CIRCULAR FEATURE, BLAEN LLWYN FEATURE CONSISTS OF A CIRCULAR EARTHWORK C.12M THE STONEWORK APPEARS TO BE BUILT UP INTO THE LATTER APPEARS TO RESPECT THE ?EARLIER FEATURE.	SH70267472 IN DIAMETER WITH STONEWORK SURVIVING TO THE SOUTH. CORNER OF A BUILDING AND FIELD BOUNDARY. THE	
8015	FIELD BOUNDARY, SE OF BLAEN LLWYN CURVILINEAR FIELD BOUNDARY MAPPED BY THE OS TO THE THE BOUNDARY FORMS THE WESTERN SIDE OF A SMALL	SH70377465 EAST BUT ALSO CONTINUES TO THE WEST. AT THIS NGR ENCLOSURE.	

<u>PRN</u>	<u>SITENAME</u>	<u>NGR</u>	<u>STATUS NO</u>
8016	OVAL ENCLOSURE, BLAEN LLWYN <i>SMALL OVAL ENCLOSURE LOCATED ON PART OF THE FIELD BOUNDARY PRN 8015 18M X 12M</i>	SH70307467	
8017	AREA OF EARTHWORKS/SPOIL HEAPS <i>SMALL AREA OF EARTHWORKS OR MOUNDS. POSSIBLY SPOIL HEAPS?</i>	SH70607457	
8018	FORMER FIELD BOUNDARY, NR WAUN LLANFAIR <i>SURVIVES AS A SPREAD EARTHWORK BETWEEN 2.5 AND 3M WIDE, CURVING TO THE SOUTH WEST. ONE OF A NUMBER OF RELICT FIELD BOUNDARIES IN THIS AREA REVEALING EVIDENCE OF THE FORMER FIELD PATTERN.</i>	SH70547460	
8019	TRACKWAY, NEAR WAUN LLANFAIR <i>LINEAR EARTHWORKS ALIGNED N-S AND STRETCHING FOR C.56M, POSSIBLY INDICATING THE LINE OF A SUNKEN TRACKWAY.</i>	SH70547453	
8020	FIELD BOUNDARY, NEAR WAUN LLANFAIR <i>FIELD BOUNDARY REVEALED AS A SPREAD EARTHWORK C.1.5M WIDE. PART OF THE SAME PATTERN AS PRN 8018</i>	SH70267442	
8021	CIRCULAR FEATURE, NEAR WAUN LLANFAIR <i>CIRCULAR FEATURE C.8.5M IN DIAMETER - INTERPRETATION UNCERTAIN.</i>	SH40467454	
8022	HUT CIRCLE AND ENCLOSURE, N OF WAEN <i>PROBABLE HUT CIRCLE AND ENCLOSURE. THE HUT HAS A DIAMETER OF C.9M, CUT BY THE MODERN FIELD BOUNDARY THE ENCLOSURE WALL IS ATTACHED TO THE NE, CURVING AROUND TO THE SOUTH.</i>	SH70107438	
8023	POSSIBLE HUT CIRCLE, WAUN LLANFAIR <i>POSSIBLE HUT CIRCLE, 8M IN DIAMETER, LOCATED BETWEEN 2 LINEAR FEATURES PRESUMABLY PART OF A FORMER FIELD SYSTEM</i>	SH70787434	
8024	RECTANGULAR STRUCTURE WAUN LLANFAIR <i>RECTANGULAR STRUCTURE C.11.5M X 5.7M, ALIGNED NE-SW AND DIVIDED INTO TWO COMPARTMENTS. THE OS SHOW A SUB-CIRCULAR ENCLOSURE TO THE SOUTH, NOT MAPPED. POSSIBLY A LONG HUT BUT MORE PROBABLY A SHEEPFOLD.</i>	SH70867432	
8025	WALL, WAUN LLANFAIR <i>LENGTH OF WALLING CONTINUING AS AN EARTH BANK TO THE SOUTH WEST. THE OS SHOWS A SMALL RECTANGULAR ENCLOSURE HERE, NOT MAPPED.</i>	SH70817440	#
8026	FIELD BOUNDARIES <i>A SERIES OF RECTILINEAR FIELD BOUNDARIES ARE NOT NECESSARILY ALL CONTEMPORARY.</i>	SH70397433	
8027	HUT CIRCLE, N OF DINAS HILLFORT <i>LARGE HUT CIRCLE, OBLITERATED ON W SIDE BY MODERN THICK. LOCATED IN AN AREA OF LINEAR AND CURVILINEA FIELD WALL. EXTERNAL DIAMETER C.14M. WALLS C.1.5M FIELD BOUNDARIES.</i>	SH70317426	
8028	CIRCULAR ENCLOSURE, N OF DINAS HILLFORT <i>CIRCULAR ENCLOSURE REVEALED AS A SPREAD (BARELY UPSTANDING) EARTHWORK WITH AN EXTERNAL DIAMETER OF C.26M AND AN INTERNAL DIAMETER OF C.17M.</i>	SH70317418	
8029	?FIELD CLEARANCE CAIRNS, NE OF DINAS <i>3 SMALL CIRCULAR MOUNDS OR CAIRNS, PROBABLY FIELD CLEARANCE.</i>	SH70257425	

- | PRN  | SITENAME   | NGR        | STATUS |
|------|--|------------|--------|
| 8030 | FIELD BOUNDARY/HOLLOWAY, NE OF DINAS<br>LINEAR FEATURE. MAY BE THE UPSTANDING EARTHWORK SW, BUT AT THIS POINT APPEARS TO BE A NEGATIVE   | SH70187423 |        |
| 8031 | HUT CIRCLE AND ENCLOSURE, NE OF DINAS<br>CIRCULAR HUT 11.2M IN DIAMETER SITUATED IN THE X-45M. THE ENCLOSURE HAS WALLS (OR BANKS) ATTACHED   | SH70157403 |        |
| 8032 | HUT CIRCLE, NE OF DINAS<br>HUT CIRCLE OF SIMILAR DIMENSIONS TO PRN 8031 AND  | SH70137398 |        |
| 8033 | HUT CIRCLE, NEAR DINAS HILLFORT<br>THIS SINGLE HUT CIRCLE WAS FORMERLY RECORDED AS THE HUT HAS AN EXTERNAL DIAMETER OF 12M WITH WALLS AND THE SITE IS SET AMONGST TRACES OF EARLY FIELDS | SH70087394 |        |
| 8034 | AREA OF CULTIVATION, E OF DINAS HILLFORT<br>SMALL, SUB-RECTANGULAR FIELD WITH TRACES OF  | SH70137388 |        |
| 8035 | HUT CIRCLE, SE OF DINAS HILLFORT<br>HUT CIRCLE, C.8M IN DIAMETER. LOCATED IN THE   | SH70147377 |        |
| 8036 | RECTANGULAR STRUCTURE, SE OF DINAS HILLFORT<br>STONE BUILT STRUCTURE SHOWN BY OS SUB-DIVIDED INTO FIELD WALLS/BANKS. TO ONE OF WHICH IT IS ATTACHED                                      | SH70187381 |        |
| 8037 | ?HUT CIRCLE, E OF DINAS HILLFORT<br>CIRCULAR FEATURE C.8M IN DIAMETER. LOCATED 20M   | SH70217394 |        |
| 8038 | LONG HUT, E OF DINAS HILLFORT<br>SUBSTANTIAL LONG HUT, C.18M X 9M. ALIGNED E-W. FORMS PART OF A LARGER ENCLOSURE. AN AREA OF RELIC   | SH70327390 |        |
| 8039 | AREA OF CULTIVATION, E OF DINAS HILLFORT<br>TRACES OF NARROW FIELDS LEADING OF A LONG, LINEAR ENCLOSURE. FIELDS ENCLOSE REMAINS OF CULTIVATION VARIATION BETWEEN INDIVIDUAL FIELDS.      | SH70457386 |        |
| 8040 | LONG HUT/PLATFORM HOUSE, E OF DINAS HILLFORT<br>PLOUGHED OUT REMAINS OF A PROBABLE LONG HUT OF CULTIVATION PRN 8039 AND POSSIBLY PRE-DATING  | SH70477380 |        |
| 8041 | CIRCULAR ENCLOSURE, E OF DINAS HILLFORT<br>FAINT TRACES OF A CIRCULAR ENCLOSURE. APPROX. TRACES OF POSSIBLE FIELD WALLS/BANKS.   | SH70427376 |        |
| 8042 | SHEEPFOLD, AFON MAES Y BRYN<br>MULTICELLULAR SHEEPFOLD CONSISTING OF 6 INDIVIDUAL SOME CONJOINED, OTHERS FREESTANDING. TRACES OF AN PHASE OF THE FOLD OR BELONG TO A SEPARATE STRUCTUR   | SH70707387 |        |

<u>PRN</u>	<u>SITENAME</u>	<u>NGR</u>	<u>STATUS</u> <u>NO</u>
✓ 8043	ENCLOSURES, AFON MAES Y BRYN 2 SMALL STONE BUILT ENCLOSURES NEAR A CONFLUENCE MOST LIKELY TO BE OF RECENT ORIGIN, CONNECTED	SH70987394 IN THE STREAMS WHICH MAKE UP THE AFON MAES Y BRYN WITH SHEEP FARMING.	
✓ 8044	FIELD BOUNDARIES, AFON MAE Y BRYN LINEAR EARTHWORKS SHOWING EVIDENCE OF FORMER FIELD PATTERN.		SH70807397
✓ 8045	SQUARE STRUCTURE, S OF DINAS HILLFORT SMALL ALMOST SQUARE STONE-BUILT STRUCTURE, 9M X SUBSTANTIAL EARTH BANK TO THE N AND W, AND A THE STRUCTURE MAY BE LONG HUT, LATER MODIFIED.	9.4M. SURROUNDED BY A SUB-RECTANGULAR ENCLOSURE. A SLIGHTER ONE TO THE S. INDICATE FORMER TERRACES	SH70037348
✓ 8046	POSSIBLE HUT GROUP, W OF FRIDD FORFUDD POSSIBLE REMAINS OF A SMALL HUT GROUP CONSISTING SMALLER. 6.3M IN DIAMETER. A LINEAR BANK RUNS NW BESIDE THE BANK AND THE E. HUT IS CONNECTED TO IT.	OF 2 LARGER HUTS. 11M AND 10M IN DIAMETER AND ONE -SE BETWEEN THE 2 LARGER HUTS. THE SMALLER HUT LIE	SH70087342
✓ 8047	FIELD SYSTEM, W OF FRIDD FORFUDD TRACES OF LINEAR BANKS INDICATING FORMER FIELD PATTERN.		SH70257354
✓ 8048	POSSIBLE BURNT MOUND, W. OF FRIDD FORFUDD A SMALL CIRCULAR MOUND, C. 4.5M IN DIAMETER, LOCATE A BURNT MOUND.	LOCATED ON THE NORTH BANK OF A STREAM. POSSIBLY	SH70217348
✓ 8049	CIRCULAR ENCLOSURE, W OF FRIDD FORFUDD SUB-CIRCULAR ENCLOSURE. C. 17M IN DIAMETER. FIELD WALL.	CONNECTED TO MODERN FIELD BOUNDARY BY RELICT	SH70247339
✓ 8050	2 PITS/DEPRESSIONS, W OF FRIDD FORFUDD INTERPRETATION UNCLEAR.		SH70277338
✓ 8051	FIELD CLEARANCE CAIRN, W OF FRIDD FORFUDD		SH70407359
✓ 8052	FEATURES, W OF FRIDD FORFUDD CIRCULAR, LINEAR AND CURVILINEAR FEATURES.	PROBABLY TRACES OF FORMER FIELDS/ENCLOSURES.	SH70697347
✓ 8053	2 SHEEPFOLDS/ENCLOSURES, FRIDD FORFUDD 2 SHEEPFOLDS OR ENCLOSURES LOCATED ON THE EAST SUB-CIRCULAR ENCLOSURE WITH A SMALLER COMPARTMENT ATTACHED TO THE SOUTH.	BANK OF A SMALL STREAM. CONSISTS OF ONE LARGER	SH70357312
✓ 8054	POSSIBLE HUT GROUP, N OF FRIDD FADOG CIRCULAR AND SUB-CIRCULAR FEATURES AND LEVELLED SITE CONTINUES WEST OF THE MAPPED AREA (OS DETAIL MAY ENCLOSE THE SITE.	AREAS MAY INDICATE THE SITE OF A HUT GROUP. THE NOT AVAILABLE). A LINEAR EARTHWORK TO THE EAST	SH70027325
✓ 8055	TERRACES, FRIDD FADOG AREA OF TERRACES AND FIELD BOUNDARIES CENTRED ON THIS PRN.		SH70087318
✓ 8056	2 LONG HUTS, FRIDD FORGAN THE 2 HUTS LIE SIDE BY SIDE BETWEEN 2 FIELD WALLS. MEASURES 16.8M X 8.2M. BOTH ARE ALIGNED NE-SW. THE HUTS	THE HUT TO THE W IS 14.4M X 8M AND THE EASTERN HUT TRACES OF FIELD SYSTEMS EXIST TO THE N AND SW OF	SH70257301



PRN	SITENAME	NGR	STATUS NO
8057	POSSIBLE LONG HUT RECTANGULAR PLATFORM, C. 11M X 6M, ALIGNED E-W	SH70327299	MAY BE THE SITE OF ANOTHER HUT.
8058	CIRCULAR FEATURE, FFRIDD FADOG PLOUGHED OUT CIRCULAR FEATURE ROUGHLY 13M IN MOUND OR FIELD CLEARANCE.	SH70177304	DIAMETER. COULD BE THE REMAINS OF A HUT, CAIRN
8059	POSSIBLE HUT CIRCLE, FFRIDD FADOG POSSIBLE REMAINS OF A PLOUGHED OUT CIRCULAR HUT CULTIVATION RIDGES.	SH70217300	SOME 9M IN DIAMETER. LOCATED WITHIN AN AREA OF
8060	CIRCULAR FEATURE, FFRIDD FADOG POSSIBLY A PLOUGHED OUT CAIRN OR HUT CIRCLE.	SH70197294	DIAMETER APPROX 8.5M
8061	CULTIVATION RIDGES, FFRIDD FADOG AREA OF CULTIVATION RIDGES KNOWN AS FRIDD FADOG. SMALLER FIELDS. THE CULTIVATION RIDGES RUN ROUGHLY	SH70187296	TRACES OF SUB-DIVISION OF EXISTING ENCLOSURE INTO N-S.
8062	RECTANGULAR FEATURE, AFON DDU RECTANGULAR FEATURE APPROX. 24M X 19.5M. ALIGNED POSSIBLY A PLOUGHED OUT LONG HUT?	SH70657306	NW-SE. ENCLOSES TRACES OF A SMALLER RECTANGLE
8063	POSSIBLE BURNT MOUND, AFON DDU A SPREAD CIRCULAR MOUND 8.6M IN DIAMETER ON THE POSSIBLY A BURNT MOUND.	SH70687275	W BANK OF A STREAM DRAINING INTO THE AFON DDU
8064	3 CAIRNS, AFON DDU 3 SMALL CAIRNS BETWEEN 4 AND 6M IN DIAMETER. NORTH OF THE AFON DDU.	SH70667290	LOCATED IN SLIGHTLY MARSHY ROUGH PASTURE TO THE
8065	ENCLOSURE, AFON DDU SMALL STONE BUILT ENCLOSURE AGAINST FRIDD WALL	SH70607286	
8066	BURNT MOUND, FFRIDD FORFUDD CIRCULAR MOUND C 6.9M IN DIAMETER ON THE NORTH MOUND.	SH70677316	BANK OF STREAM. PROBABLY THE REMAINS OF A BURST
8067	CIRCULAR FEATURE, FFRIDD FORFUDD CIRCULAR FEATURE 10.7M IN DIAMETER. POSSIBLY A	SH70617328	CAIRN OR MOUND.
8068	FORMER FIELD BOUNDARIES, FFRIDD FORFUDD	SH70757333	
8069	HUTS AND ENCLOSURES, E OF FFRIDD FORFUDD SITE INCLUDES ON LARGE CIRCULAR HUT, C. 13M IN THE NE. THE LARGER HUT HAS ATTACHED WALLING RUNNIN BANK TO THE WEST MAY INDICATE ENCLOSURES/FIELD SYS	SH71267339	DIAMETER AND ONE SMALLER, 8M IN DIAMETER, 95M TO ROUGHLY E-W ON EITHER SIDE. A SUBSTANTIAL EARTH
8070	POSSIBLE BURNT MOUND, E OF MAES Y BRYN SMALL CIRCULAR MOUND C. 5M IN DIAMETER. POSSIBLY	SH71167369	THE REMAINS OF A BURNT MOUND.

<u>PRN</u>	<u>SITENAME</u>	<u>NGR</u>	<u>STATUS NO</u>
8071	CIRCULAR FEATURE, E OF MAES Y BRYN <i>CIRCULAR FEATURE C.6M IN DIAMETER. POSSIBLY A CAIRN OR MOUND.</i>	SH71127356	
8072	CIRCULAR FEATURE, MAES Y BRYN <i>CIRCULAR FEATURE SIMILAR TO PRN 8071.</i>	SH71107381	
8073	CIRCULAR FEATURE, MAES Y BRYN <i>AS 8072, 6.5M IN DIAMETER.</i>	SH71077389	
8074	TRACKWAYS, MAES Y BRYN <i>2 NARROW PARALLEL TRACKWAYS RUNNING ROUGHLY N-S AND CURVING SLIGHTLY. THE FEATURES MAPPED IMMEDIATELY TO THE WEST MAY BE VEGETATION CHANGES.</i>	SH71177384	
8075	LINE OF FORMER FIELD BOUNDARY, MAES Y BRYN	SH71127365	
8076	ENCLOSURES/FIELDS, S OF WAUN LLANFAIR <i>EVIDENCE OF FORMER FIELD PATTERN IN THE SHAPE OF LINEAR EARTHWORK BANKS DENOTING FIELDS/ENCLOSURES.</i>	SH71257399	
8077	TRACKWAYS, WAUN LLANFAIR <i>AREA OF TRACKWAYS RUNNING ROUGHLY NW-SE</i>	SH71527404	
8078	CAIRN, WAUN LLANFAIR <i>ONE OF TWO CAIRNS 20M APART LYING BETWEEN 2 OF THE TRACKWAYS WHICH MAKE UP PRN 8077. DIAMETER 4.5M.</i>	SH71487407	
8079	CAIRN, WAUN LLANFAIR <i>SEE PRN 8078 FOR DESCRIPTION. THIS CAIRN HAS A DIAMETER OF C.4M.</i>	SH71467405	
8080	MOUND, WAUN LLANFAIR <i>CIRCULAR MOUND C.5.5M IN DIAMETER. POSSIBLY A GRASSED OVER CAIRN.</i>	SH71517409	
8081	MOUND, WAUN LLANFAIR <i>CIRCULAR MOUND 4.5M IN DIAMETER. POSSIBLY A GRASSE OVER CAIRN</i>	SH71537412	
8082	LINEAR FEATURES, WAUN LLANFAIR <i>LINEAR FEATURES, PRESUMABLY TRACES OF FORMER ENCLOSURES</i>	SH71617408	
8083	ENCLOSURE, BRYNIAU BUGEILYDD <i>SMALL STONE BUILT ENCLOSURE, MAY HAVE BEEN USED AS A SHEEPFOLD OR SHEPHERDS SHELTER.</i>	SH71647394	
8084	ENCLOSURE, BRYNIAU BUGEILYDD <i>SMALL RECTANGULAR ENCLOSURE, PROBABLY SIMILAR PURPOSE AS PRN 8083.</i>	SH71687401	
8085	CIRCULAR FEATURE, WAUN LLANFAIR <i>SMALL CIRCULAR FEATURE, 3.5M IN DIAMETER. COULD BE A SMALL MOUND OR GRASSED OVER CAIRN.</i>	SH71607402	
8086	SMALL CAIRN, WAUN LLANFAIR <i>SMALL CAIRN C 3M IN DIAMETER.</i>	SH71637403	

<u>PRN</u>	<u>SITENAME</u>	<u>NGR</u>	<u>STATUS NO</u>
8087	CIRCULAR ENCLOSURE, WAUN LLANFAIR <i>STONE BUILT CIRCULAR ENCLOSURE, C.15.5M IN DIAMETE</i>	SH71727404	
8088	CIRCULAR FEATURE, BRYNIAU BUGEILYDD <i>SMALL CIRCULAR FEATURE, C.5M IN DIAMETER. POSS. ANOTHER SMALL MOUND/CAIRN.</i>	SH71707412	
8089	SMALL ENCLOSURE, SLIP YR ORSEDD <i>SMALL STONE BUILT ENCLOSURE ATTACHED TO THE WALL RUNNING NW TO THE EAST OF CLIP YR ORSEDD.</i>	SH71297492	
8090	OVAL ENCLOSURE, CLIP YR ORSEDD <i>FAINT TRACES OF A SMALL OVAL ENCLOSURE S OF THE TRACKWAY.</i>	SH71267477	
8091	TRACKWAYS, SW OF CLIP YR ORSEDD <i>TRACKWAYS RUNNING NW-SE</i>	SH70927457	
8092	CIRCULAR FEATURE, S OF CLIP YR ORSEDD <i>SMALL CIRCULAR FEATURE, COULD BE A MOUND, CAIRN OR POSSIBLY CLEARANCE.</i>	SH71037447	
8093	CIRCULAR MOUND, S OF CLIP YR ORSEDD <i>SMALL CIRCULAR MOUND 4.9M IN DIAMETER. LOCATED TO THE SOUTH OF CLIP YR ORSEDD.</i>	SH71307472	
8094	CIRCULAR MOUND, W OF CORS Y CARNEDDAU <i>SMALL CIRCULAR MOUND, C.6M IN DIAMETER. POSSIBLY GRASSED OVER CAIRN.</i>	SH71357460	
8095	CAIRNFIELD, CORS Y CARNEDDAU <i>AREA OF SMALL MOUNDS WHICH MAY BE GRASSED OVER SOUTH OF THE TRACKWAY WERE NOT IDENTIFIED, THIS CAIRNS. HOWEVER, AS THE SCHEDULED CAIRNS TO THE SITE REQUIRES FIELDWORK TO CONFIRM INTERPRETATION</i>	SH71787478	
8096	RECTANGULAR STRUCTURE, N OF MOELFRE <i>STONE BUILT RECTANGULAR STRUCTURE 10.8M X 8.1M OF UNEQUAL SIZE. PROBABLY A SHEEPFOLD RATHER THAN A HUT. ALIGNED NW-SE. SUB-DIVIDED INTO TWO COMPARTMENTS</i>	SH71907474	
8097	FIELD WALL, W OF CLIP YR ORSEDD <i>FIELD WALL STILL IN USE ON 1948 APS BUT NOT ON OS DIGITAL MAP</i>	SH71627491	
8098	TRACKWAY, N OF CORS Y CARNEDDAU	SH71667480	
8099	ENCLOSURE, CORS Y CARNEDDAU <i>SUB-RECTANGULAR ENCLOSURE. 15.5M X 7.5M. ALIGNED NNW-SSE.</i>	SH	C024
8100	TERRACING, CWM GRAIGLWYD <i>TRACES OF FORMER TERRACING.</i>	SH72017498	
8101	MOUND, CWM GRAIGLWYD <i>SMALL CIRCULAR MOUND C.3.7M IN DIAMETER.</i>	SH72157481	
8102	3 POSSIBLE BURNT MOUNDS, NEAR WAUN LLANFAIR <i>3 MOUNDS VARYING IN DIAMETER BETWEEN 4M AND 6M. MOUNDS? LOCATED IN A WET, MARSHY AREA - POSSIBLE BURNT</i>	SH70657451	

<u>PRN</u>	<u>SITENAME</u>	<u>NGR</u>	<u>STATUS NO</u>
8103 ✓	BURNT MOUND, NEAR WAUN LLANFAIR <i>BURNT MOUND, 6M IN DIAMETER. LOCATED ON THE</i>	SH70677446	
	<i>NORTH BANK OF A SMALL STREAM, TO THE SOUTH OF PRN</i>		
	<i>8102</i>		

21035 ✓	QUARRY, TYDDYN GRASOD	SH74407460	
---------	-----------------------	------------	--

21036 ✓	QUARRY, FRITH Y DDWY FFRWD	SH74807230	
---------	----------------------------	------------	--

Records printed: 281

