

Ucheldir has several historic features that need to be protected during harvesting of the current timber crop and appropriately buffered when replanting. Trees need to be felled away from the features and machines need to remain 10m away from the round barrow, 2305, and the defence line (cubes) and pillbox.

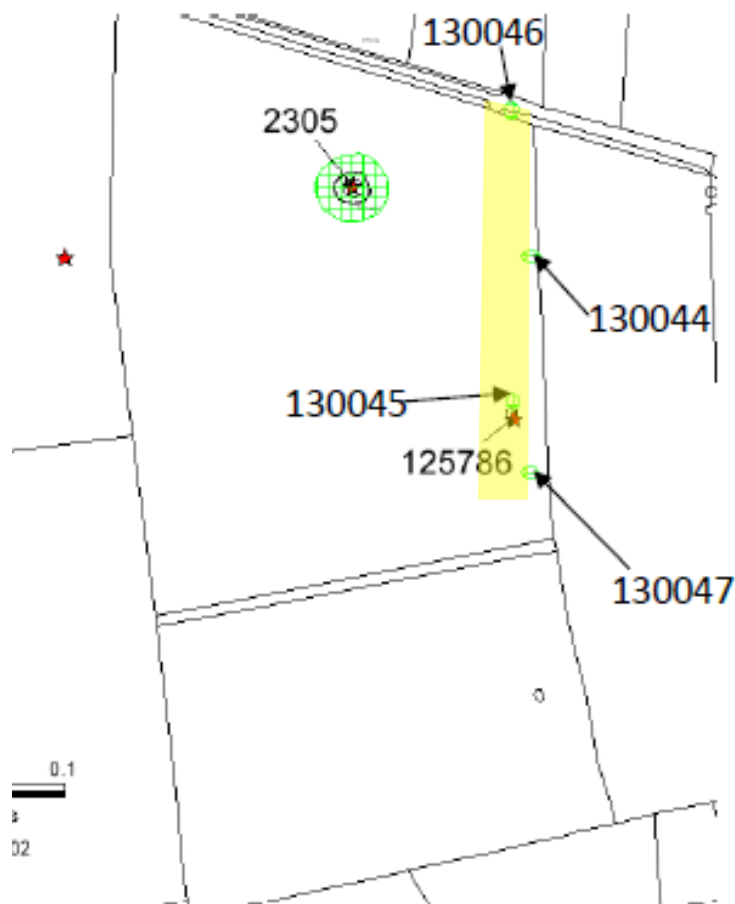

Restocking will buffer the features as follows:

2305 Round barrow - 20m buffer of no planting and then slow growing native shrub & tree species (hazel, rowan, hawthorn) for 10m to create a 30m bufferzone.

125786 Defence Line - No planting in the yellow zone. The narrow section between the yellow zone and the fence to the East to be replanted with slow growing native spp as above. To the West spruce to be planted to provide a level of shade to reduce bramble and scrub growth.