



DAT 14228

Suzanne Lilley-Owen
Team Leader, Felling Permitting
Natural Resources Wales

14th October 2019

Dear Suzanne,

FLA 201 19-20 St Davids Diocesan Land

Thank you for your consultation and attached Cadw map, clearly this proposed work is taking place in areas of high archaeological sensitivity which extend beyond the scheduled areas identified on Cadw's map. We would urge that the removal of trees is undertaken with caution to ensure that no historic structures or earthworks are damaged either in the felling or the extraction of wood. I have checked the map boundaries against the regional Historic Environment Record (HER) and other sources and provide the following map extracts to indicate what features are recorded.

001 & 002 locations on your map are located adjacent to Dewiston Mill (PRN 47598) and appear to be located alongside the tail race of the mill. We do not have any information on the current condition of this feature, but the scheduled leat (above the mill) appears to survive substantially. It may incorporate built banks or retaining walls, or be an earthwork feature. Either would be vulnerable to damage caused by tree felling and replanting.

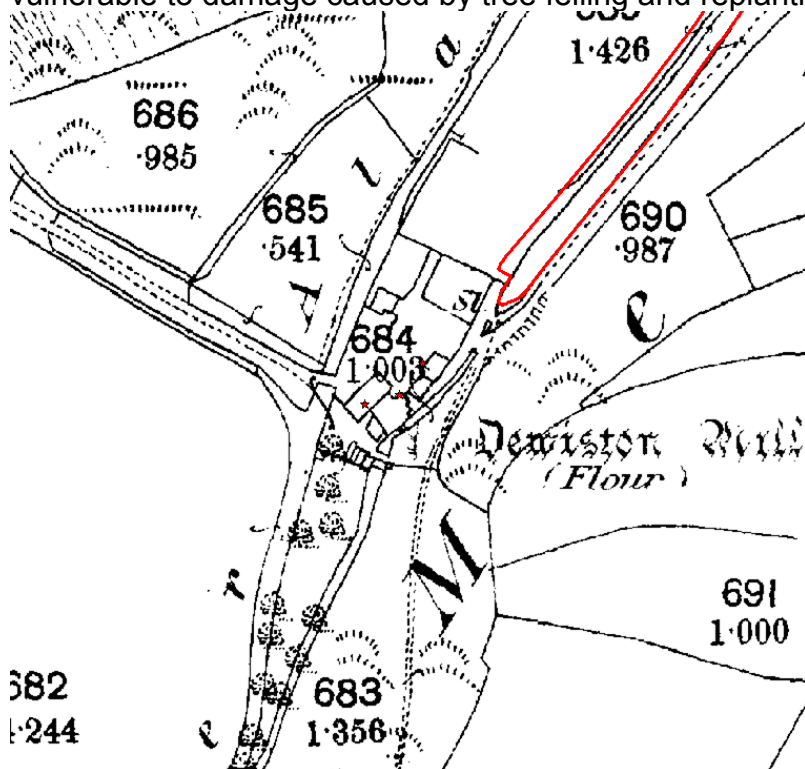

1st edition, 1889, OS Pembrokeshire sheet 20.03 (scheduled area in red)

© and database right Crown copyright and Landmark Information Group Ltd (All rights reserved)
14/10/2019

YMDDIRIEDOLAETH
ARCHAEOLEGOL
DYFED CYF

The Corner House
6 Stryd Caerfyrddin
Llandeilo
Sir Gaerfyrddin
SA19 6AE

01558 823121

Ebost
info@dyfedarchaeology.org.uk
Gwefan
www.archaeolegdyfed.org.uk

Cwmni cyfyngedig (1198990)
ynghyd ag elusen gofrestredig
(504616) yw'r Ymddiriedolaeth

DYFED
ARCHAEOLOGICAL
TRUST LTD

The Corner House
6 Carmarthen Street
Llandeilo
Carmarthenshire
SA19 6AE

01558 823121

Email
info@dyfedarchaeology.org.uk
Web
www.dyfedarchaeology.org.uk

The Trust is both a Limited
Company (1198990) and a
Registered Charity (504616)



Cadeirydd/Chair
J Protheroe-Jones

Cyfarwyddwr/Director
Mr K Murphy BA MCIfA



Location 003 is adjacent to listed buildings and 004 lies within the scheduled area of The Bishop's Palace and garden. We presume that Cadw are supplying specific details for the scheduled area.

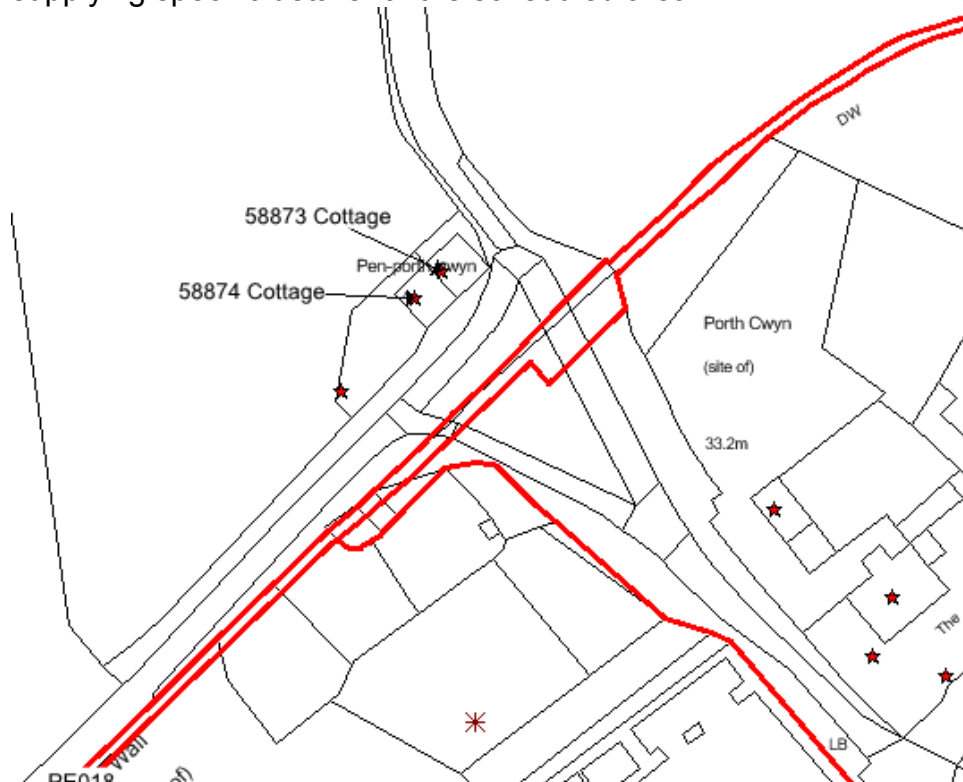

Location 005 lies at the head of the scheduled mill leat for Dewiston Mill – we presume that Cadw are supplying specific details for the scheduled area.

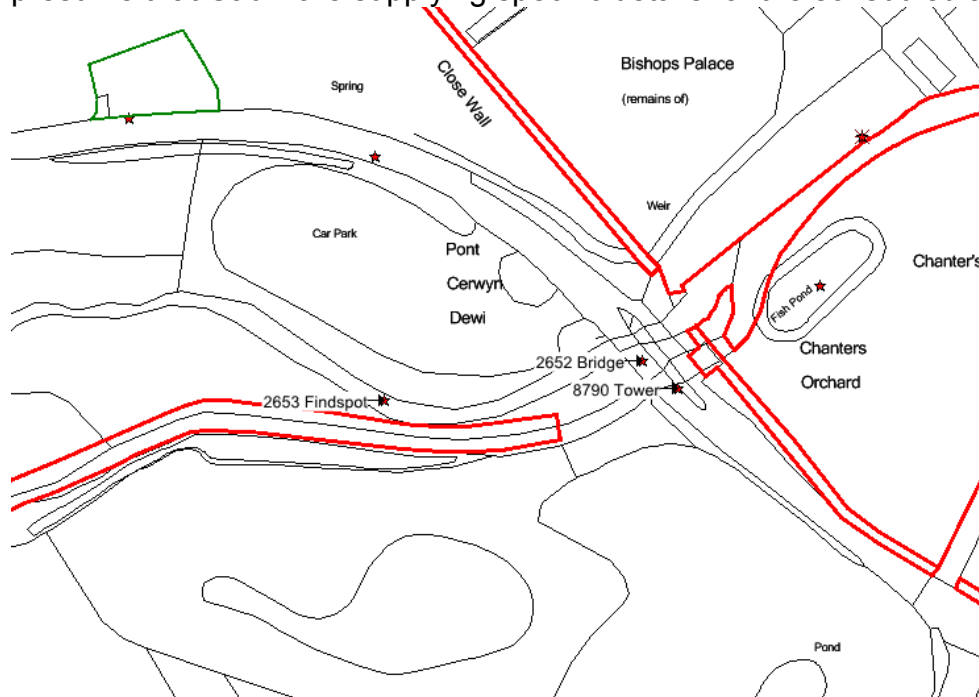

Reproduced by permission of Ordnance Survey on behalf of HMSO. © Crown copyright and database right 2011. All rights reserved. Ordnance Survey Licence number 100017916.

YMDDIRIEDOLAETH
 ARCHAEOLEGOL
 DYFED CYF

The Corner House
 6 Stryd Caerfyrddin
 Llandeilo
 Sir Gaerfyrddin
 SA19 6AE

01558 823121

Ebost
info@dyfedarchaeology.org.uk
 Gwefan
www.archaeolegdyfed.org.uk

Cwmni cyfyngedig (1198990)
 ynghyd ag elusen gofrestredig
 (504616) yw'r Ymddiriedolaeth

DYFED
 ARCHAEOLOGICAL
 TRUST LTD

The Corner House
 6 Carmarthen Street
 Llandeilo
 Carmarthenshire
 SA19 6AE

01558 823121

Email
info@dyfedarchaeology.org.uk
 Web
www.dyfedarchaeology.org.uk

The Trust is both a Limited
 Company (1198990) and a
 Registered Charity (504616)



Cadeirydd/Chair
 J Protheroe-Jones

Cyfarwyddwr/Director
 Mr K Murphy BA MCIfA



There is always the possibility for previously unknown remains to survive within this area of which we have no knowledge. Should further archaeological features or finds be identified it is important that Dyfed Archaeological Trust Heritage Management is informed and further information and advice can then be provided as required.

Alice Pyper

Alice Pyper
Heritage Management Project Manager
01558 825993

YMDDIRIEDOLAETH
ARCHAEOLEGOL
DYFED CYF

The Corner House
6 Stryd Caerfyrddin
Llandeilo
Sir Gaerfyrddin
SA19 6AE

01558 823121

Ebost
info@dyfedarchaeology.org.uk
Gwefan
www.archaeolegdyfed.org.uk

Cwmni cyfyngedig (1198990)
ynghyd ag elusen gofrestredig
(504616) yw'r Ymddiriedolaeth

DYFED
ARCHAEOLOGICAL
TRUST LTD

The Corner House
6 Carmarthen Street
Llandeilo
Carmarthenshire
SA19 6AE

01558 823121

Email
info@dyfedarchaeology.org.uk
Web
www.dyfedarchaeology.org.uk

The Trust is both a Limited
Company (1198990) and a
Registered Charity (504616)



Cadeirydd/Chair
J Protheroe-Jones

Cyfarwyddwr/Director
Mr K Murphy BA MCIfA