



31st May 2023

Dear Peter,

**NRW Screening Request FLA 27 23-24
Allt Dolau Cothi near Pumsaint.**

Thank you for your felling licence consultation. I have reviewed the map boundaries against the regional Historic Environment Record (HER) and other sources and note that this application lies within Historic Parks and Gardens of Dolaucothi PGW (Dy) 7(CAM) and includes part of the scheduled monument Pumsaint Roman Fort (CM226) therefore Cadw must be consulted. I am copying this response to Louise Mees Inspector of Ancient Monuments and Archaeology (South West Wales) and Lisa Fiddes Inspector of Historic Parks and Gardens.

<https://cadwpublic-api.azurewebsites.net/reports/sam/FullReport?lang=en&id=2168>

In addition, I have also noted the following features recorded on the Historic Environment Record:

PRN49967 POST MEDIEVAL LEAT SN66214167

A leat or water channel marked on an estate map of Dolaucothi, thought to date to around 1770. The western end of this feature is visible as faint earthwork running through the wood. The line of the channel is then lost as it passes through an improved field just east of the woodland. The channel seems to have supplied water to Cefn Coed Mawr farm (NT no.80439), and is one of a number of channels which were taken off springs in a field named Cae Garw. (See also PRNs 49970 and 49971).

PRN49971 POST MEDIEVAL WATER CHANNEL SN66214146

An estate map of Dolaucothi (?1770) shows a number of channels being fed by a stream in this area. These channels conveyed water to Dolaucothi Farm, and also to the farm at Cefn Coed Mawr. On the ground, this area is difficult to interpret. There are earthwork remains of watercourses, but it is not clear how many of these have been caused by the shifting course of the stream, and how many may have artificial origins. There are a number of picnic tables set by the stream, and a short flight of steps has been put in place to lead down to the level ground at the stream's edge. There are also two footbridges, allowing visitors to walk a short circular route crossing the water.

PRN49973 POST MEDIEVAL TRACKWAY SN66204163

A trackway seen on an estate map of around 1770. The track still survives but has been re-surfaced for much of its length and part of it is open as a public walk through the woods.

PRN52189 POST MEDIEVAL WATER CHANNEL SN66254157

The approximate line of a water channel marked on an estate map of c.1770 providing water to Cefn Coed Mawr. The channel is described as 'made by Richard Davies about 30 years last' (i.e. c.1740).

YMDDIRIEDOLAETH
ARCHAEOLEGOL
DYFED CYF

The Corner House
6 Stryd Caerfyrddin
Llandeilo
Sir Gaerfyrddin
SA19 6AE

01558 823121

Ebost
info@dyfedarchaeology.org.uk
Gwefan
www.archaeologydyfed.org.uk

Cwmni cyfyngedig (1198990)
ynghyd ag elusen gofrestredig
(504616) yw'r Ymddiriedolaeth

DYFED
ARCHAEOLOGICAL
TRUST LTD

The Corner House
6 Carmarthen Street
Llandeilo
Carmarthenshire
SA19 6AE

01558 823121

Email
info@dyfedarchaeology.org.uk
Web
www.dyfedarchaeology.org.uk

The Trust is both a Limited
Company (1198990) and a
Registered Charity (504616)



Cadeirydd/Chair
Judith Wainwright MA MSc
FIC FRSA

Cyfarwyddwr/Director
Mr K Murphy BA MCIFA

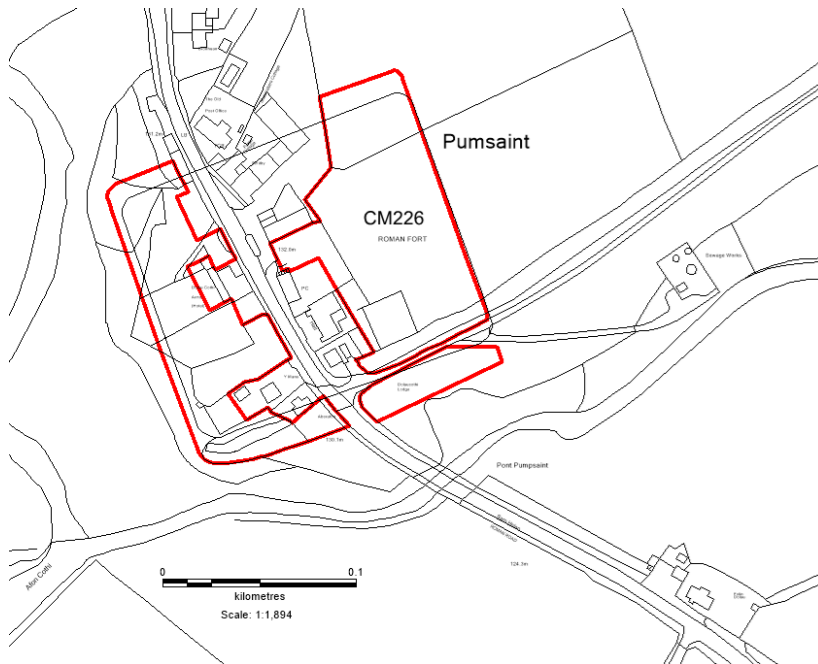

© Crown Copyright. Welsh Government. Licence Number: 100017916 (2022)
 © Hawlfraint y Goron. Llywodraeth Cymru. Rhif Trwydded: 100017916 (2022)

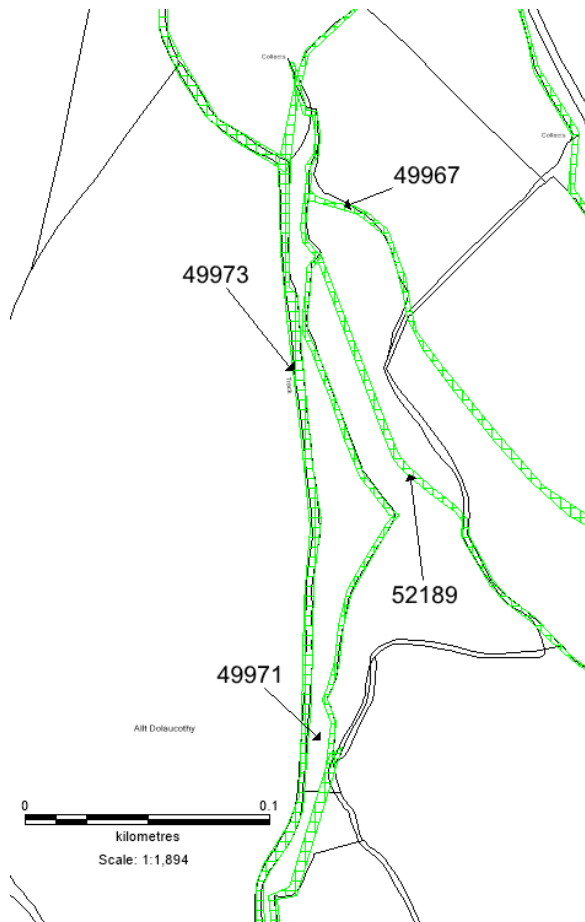

© Crown Copyright. Welsh Government. Licence Number: 100017916 (2022)
 © Hawlfraint y Goron. Llywodraeth Cymru. Rhif Trwydded: 100017916 (2022)

YMDDIRIEDOLAETH
 ARCHAEOLEGOL
 DYFED CYF

The Corner House
 6 Stryd Caerfyrddin
 Llandeilo
 Sir Gaerfyrddin
 SA19 6AE

01558 823121

Ebost
info@dyfedarchaeology.org.uk
 Gwefan
www.archaeolegdyfed.org.uk

Cwmni cyfyngedig (1198990)
 ynghyd ag elusen gofrestredig
 (504616) yw'r Ymddiriedolaeth

DYFED
 ARCHAEOLOGICAL
 TRUST LTD

The Corner House
 6 Carmarthen Street
 Llandeilo
 Carmarthenshire
 SA19 6AE

01558 823121

Email
info@dyfedarchaeology.org.uk
 Web
www.dyfedarchaeology.org.uk

The Trust is both a Limited
 Company (1198990) and a
 Registered Charity (504616)



Cadeirydd/Chair
 Judith Wainwright MA MSc
 FIC FRSA

Cyfarwyddwr/Director
 Mr K Murphy BA MCIFA



The current condition of these features is unknown; however, they may survive as ruins, earthworks or below ground archaeology. We advise that these historic environment features (labelled on the map above and marked with red outline or green polygon) are protected from damage during forest operations, to comply with UKFS Forests and the historic environment guidance.

There is always the possibility for previously unknown remains to survive within this area of which we have no knowledge. Should further archaeological features or finds be identified it is important that Dyfed Archaeological Trust Heritage Management is informed and further information and advice can then be provided as required.

Alexandra Powell
Heritage Management Archaeologist
a.powell@dyfedarchaeology.org.uk

YMDDIRIEDOLAETH
ARCHAEOLEGOL
DYFED CYF

The Corner House
6 Stryd Caerfyrddin
Llandeilo
Sir Gaerfyrddin
SA19 6AE

01558 823121

Ebost
info@dyfedarchaeology.org.uk
Gwefan
www.archaeolegdyfed.org.uk

Cwmni cyfyngedig (1198990)
ynghyd ag elusen gofrestredig
(504616) yw'r Ymddiriedolaeth

DYFED
ARCHAEOLOGICAL
TRUST LTD

The Corner House
6 Carmarthen Street
Llandeilo
Carmarthenshire
SA19 6AE

01558 823121

Email
info@dyfedarchaeology.org.uk
Web
www.dyfedarchaeology.org.uk

The Trust is both a Limited
Company (1198990) and a
Registered Charity (504616)



Cadeirydd/Chair
Judith Wainwright MA MSc
FIC FRSA

Cyfarwyddwr/Director
Mr K Murphy BA MCIfA