



16th December 2022

Dear Lisa,

NRW Screening Request FLA 353 22-23 Coed Marnie

Thank you for your felling licence consultation. I've had a look at these proposals in reference to the Historic Environment Record and note the following historic environment features, all derived from historic map sources:

PRN 93852 UNKNOWN Post-Medieval cottage? SN2584142941
Structure recorded on 1st Edition Ordnance Survey and 2nd Edition Ordnance Survey maps.

PRN 93855 UNKNOWN Post-Medieval cottage? SN25834292
The tithe map records a small building in the south of a field enclosure, presumably identifying a cottage site. No further clues are provided on the apportionment. The building is marked in outline by the time of the Ordnance Survey 1st edition map (1888), presumably having been abandoned by that time.

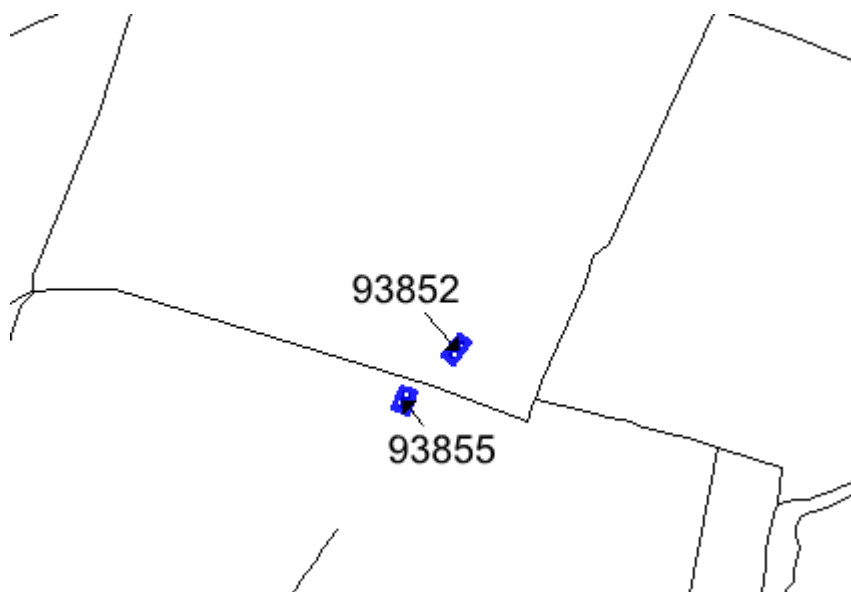

Reproduced by permission of Ordnance Survey on behalf of HMSO. © Crown copyright and database right 2011. All rights reserved. Ordnance Survey Licence number 100017916.

The current condition of these features is unknown; however they may survive as ruins, earthworks or below ground archaeology. To comply with UKFS Forests and the historic environment guidance, we advise that these historic environment features (shown in blue and marked with arrows on the maps above) are protected from damage during forest operations, and that access tracks/loading areas should not cross these features.

YMDDIRIEDOLAETH
ARCHAEOLEGOL
DYFED CYF

The Corner House
6 Stryd Caerfyrddin
Llandeilo
Sir Gaerfyrddin
SA19 6AE

01558 823121

Ebost
info@dyfedarchaeology.org.uk
Gwefan
www.archaeologydyfed.org.uk

Cwmni cyfyngedig (1198990)
ynghyd ag elusen gofrestredig
(504616) yw'r Ymddiriedolaeth

DYFED
ARCHAEOLOGICAL
TRUST LTD

The Corner House
6 Carmarthen Street
Llandeilo
Carmarthenshire
SA19 6AE

01558 823121

Email
info@dyfedarchaeology.org.uk
Web
www.dyfedarchaeology.org.uk

The Trust is both a Limited
Company (1198990) and a
Registered Charity (504616)



Cadeirydd/Chair
Judith Wainwright MA MSc
FIC FRSA

Cyfarwyddwr/Director
Mr K Murphy BA MCIfA



There is always the possibility for previously unknown remains to survive within this area of which we have no knowledge. Should further archaeological features or finds be identified it is important that Dyfed Archaeological Trust Heritage Management is informed and further information and advice can then be provided as required.

Alexandra Powell
Heritage Management Archaeologist
a.powell@dyfedarchaeology.org.uk

YMDDIRIEDOLAETH
ARCHAEOLEGOL
DYFED CYF

The Corner House
6 Stryd Caerfyrddin
Llandeilo
Sir Gaerfyrddin
SA19 6AE

01558 823121

Ebost
info@dyfedarchaeology.org.uk
Gwefan
www.archaeolegdyfed.org.uk

Cwmni cyfyngedig (1198990)
ynghyd ag elusen gofrestredig
(504616) yw'r Ymddiriedolaeth

DYFED
ARCHAEOLOGICAL
TRUST LTD

The Corner House
6 Carmarthen Street
Llandeilo
Carmarthenshire
SA19 6AE

01558 823121

Email
info@dyfedarchaeology.org.uk
Web
www.dyfedarchaeology.org.uk

The Trust is both a Limited
Company (1198990) and a
Registered Charity (504616)



Cadeirydd/Chair
Judith Wainwright MA MSc
FIC FRSA

Cyfarwyddwr/Director
Mr K Murphy BA MCIfA