



14th December 2022

Dear Karen,

NRW Screening Request FLA348 22-23 Afon Gido

Thank you for your felling licence consultation. I've had a look at these proposals in reference to the Historic Environment Record and note the following historic environment features, all derived from historic map sources:

PRN 62647 CWM-MOCY-GIDO POST MEDIEVAL COTTAGE SN41055796

There is a cottage recorded above the confluence of the Afon Gido and Afon Mot on the Ordnance Survey 1st edition map (1890). The cottage is shown, but not named on the later 2nd edition (1906), suggesting that it had been abandoned by then.

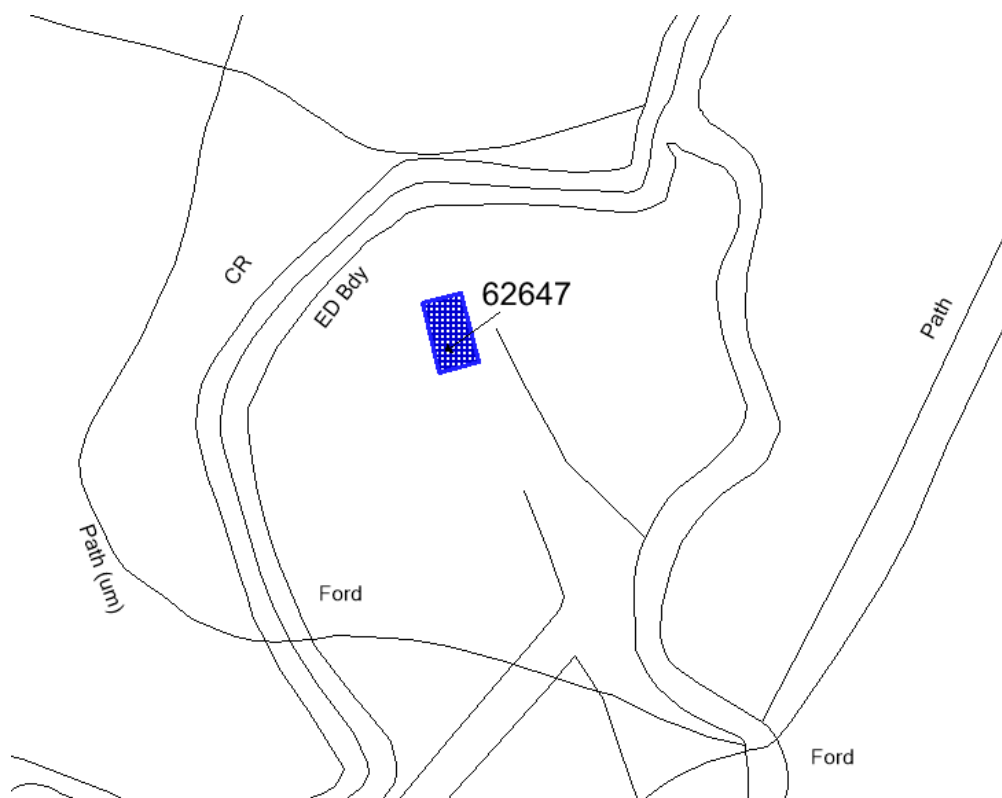

Reproduced by permission of Ordnance Survey on behalf of HMSO. © Crown copyright and database right 2011. All rights reserved. Ordnance Survey Licence number 100017916.

PRN 62648 LLANARTH POST MEDIEVAL COTTAGE SN40915771

A cottage is marked in outline, un-named on the Ordnance Survey 1st edition map (1890) suggesting that it had already been abandoned. Present condition unknown.

PRN 129487 LLANARTH POST MEDIEVAL FARM BUILDING SN4091757695

Small square building recorded on the 1st Edition Ordnance Survey map and 2nd Edition Ordnance Survey map. A. Powell 2022.

YMDDIRIEDOLAETH
ARCHAEOLEGOL
DYFED CYF

The Corner House
6 Stryd Caerfyrddin
Llandeilo
Sir Gaerfyrddin
SA19 6AE

01558 823121

Ebost
info@dyfedarchaeology.org.uk
Gwefan
www.archaeologydyfed.org.uk

Cwmni cyfyngedig (1198990)
ynghyd ag elusen gofrestredig
(504616) yw'r Ymddiriedolaeth

DYFED
ARCHAEOLOGICAL
TRUST LTD

The Corner House
6 Carmarthen Street
Llandeilo
Carmarthenshire
SA19 6AE

01558 823121

Email
info@dyfedarchaeology.org.uk
Web
www.dyfedarchaeology.org.uk

The Trust is both a Limited
Company (1198990) and a
Registered Charity (504616)



Cadeirydd/Chair
Judith Wainwright MA MSc
FIC FRSA

Cyfarwyddwr/Director
Mr K Murphy BA MCIfA

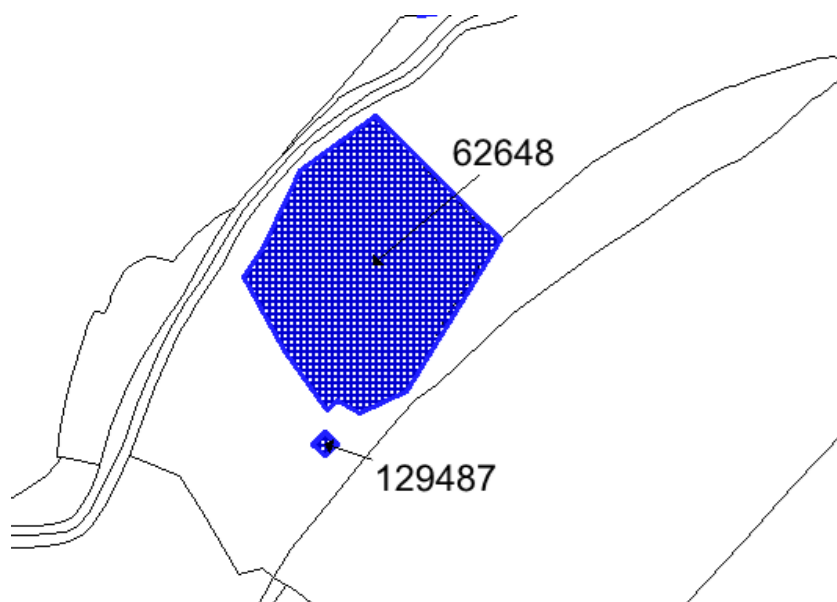

Reproduced by permission of Ordnance Survey on behalf of HMSO. © Crown copyright and database right 2011. All rights reserved. Ordnance Survey Licence number 100017916.

PRN 62649 LLANLLWCHAIARN POST MEDIEVAL COTTAGE SN40825764

A redundant cottage and enclosure recorded on the Ordnance Survey 1st edition map (1890). Present condition unknown.

PRN 62646 CWM-PEN-LLWYBR POST MEDIEVAL COTTAGE SN40775758

A cottage situated alongside the Afon Gido, recorded on the Ordnance Survey 1st edition map (1889). It is not named on the later 2nd edition (1906), suggesting that it had been abandoned by that time.

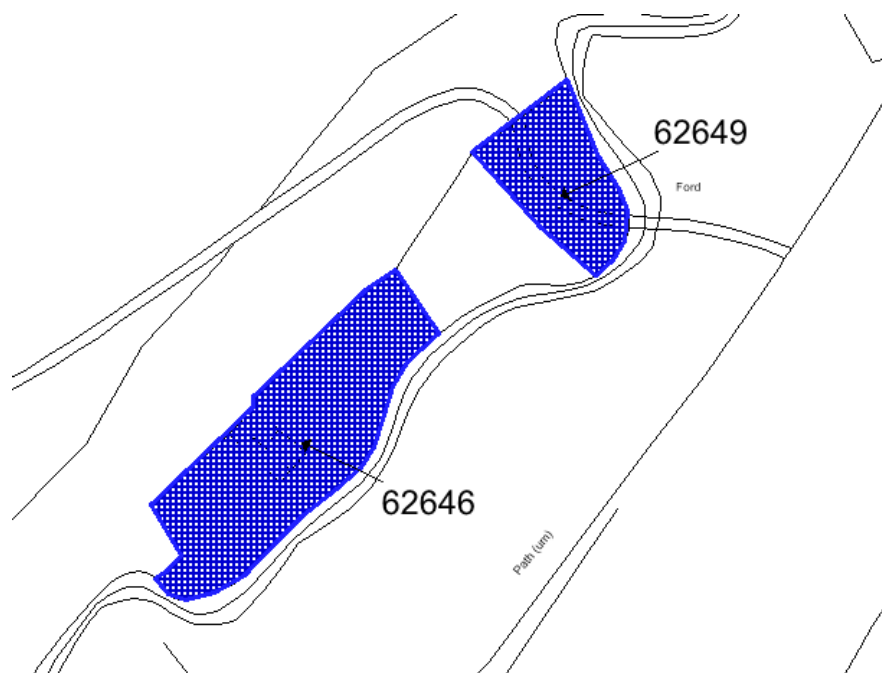

Reproduced by permission of Ordnance Survey on behalf of HMSO. © Crown copyright and database right 2011. All rights reserved. Ordnance Survey Licence number 100017916.

YMDDIRIEDOLAETH
 ARCHAEOLEGOL
 DYFED CYF

The Corner House
 6 Stryd Caerfyrddin
 Llandeilo
 Sir Gaerfyrddin
 SA19 6AE

01558 823121

Ebost
 info@dyfedarchaeology.org.uk
 Gwefan
 www.archaeologydyfed.org.uk

Cwmni cyfyngedig (1198990)
 ynghyd ag elusen gofrestredig
 (504616) yw'r Ymddiriedolaeth

DYFED
 ARCHAEOLOGICAL
 TRUST LTD

The Corner House
 6 Carmarthen Street
 Llandeilo
 Carmarthenshire
 SA19 6AE

01558 823121

Email
 info@dyfedarchaeology.org.uk
 Web
 www.dyfedarchaeology.org.uk

The Trust is both a Limited
 Company (1198990) and a
 Registered Charity (504616)



Cadeirydd/Chair
 Judith Wainwright MA MSc
 FIC FRSA

Cyfarwyddwr/Director
 Mr K Murphy BA MCIFA



PRN 129490 POST MEDIEVAL FOOTBRIDGE SN4044557341
Footbridge recorded on the 1st Edition Ordnance Survey map and 2nd Edition
Ordnance Survey map. A. Powell 2022.

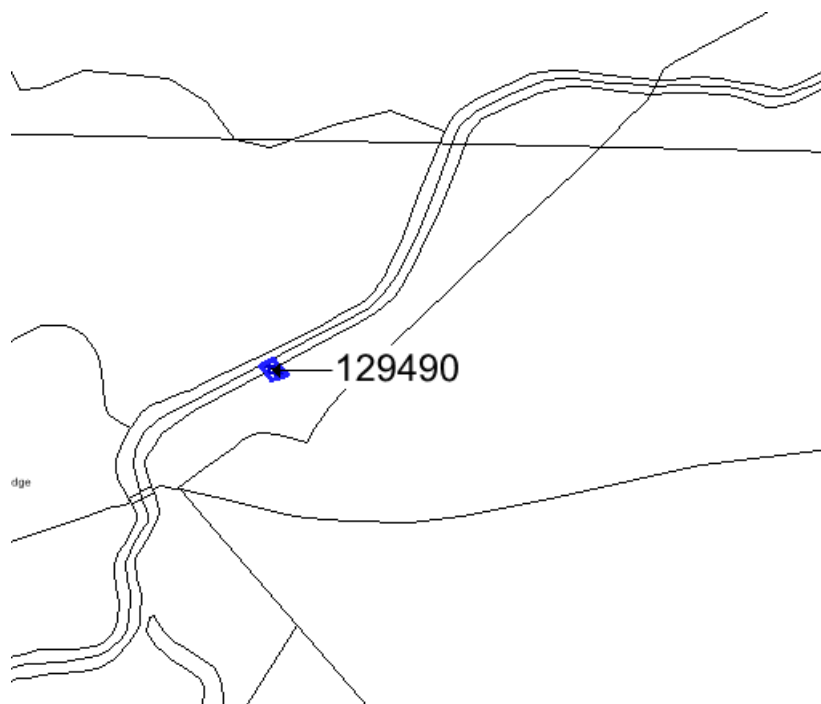

Reproduced by permission of Ordnance Survey on behalf of HMSO. © Crown copyright and database right 2011. All rights reserved. Ordnance Survey Licence number 100017916.

The current condition of these features is unknown; however they may survive as ruins, earthworks or below ground archaeology. We advise that these historic environment features (shown in blue and marked with arrows on the maps above) are protected from damage during forest operations, to comply with UKFS Forests and the historic environment guidance.

There is always the possibility for previously unknown remains to survive within this area of which we have no knowledge. Should further archaeological features or finds be identified it is important that Dyfed Archaeological Trust Heritage Management is informed and further information and advice can then be provided as required.

Alexandra Powell
Heritage Management Archaeologist
a.powell@dyfedarchaeology.org.uk

YMDDIRIEDOLAETH
ARCHAEOLEGOL
DYFED CYF

The Corner House
6 Stryd Caerfyrddin
Llandeilo
Sir Gaerfyrddin
SA19 6AE

01558 823121

Ebost
info@dyfedarchaeology.org.uk
Gwefan
www.archaeolegdyfed.org.uk

Cwmni cyfyngedig (1198990)
ynghyd ag elusen gofrestredig
(504616) yw'r Ymddiriedolaeth

DYFED
ARCHAEOLOGICAL
TRUST LTD

The Corner House
6 Carmarthen Street
Llandeilo
Carmarthenshire
SA19 6AE

01558 823121

Email
info@dyfedarchaeology.org.uk
Web
www.dyfedarchaeology.org.uk

The Trust is both a Limited
Company (1198990) and a
Registered Charity (504616)



Cadeirydd/Chair
Judith Wainwright MA MSc
FIC FRSA

Cyfarwyddwr/Director
Mr K Murphy BA MCIFA