

# PRESELI ESA, HISTORIC MONITORING

BASELINE 1994

A

OS 1:10000 SHEET: SM/SN 03 SE	GRID REF: SM/SN 0920 3010
PRN: 1582 SITE NAME: CARN - AFR	
AIR PHOTO No 57/92/137 No GROUND PHOTOS: 9	LANDSCAPE TYPE: A
DATE SURVEYED: 5/1/95	SURVEYED BY: GA Hopwood
ACCESS: land owned by Mr Jenkins, Froules fm. Tel: maenlochog 532392. Grid ref: 103295.	

B

LAND COVER:
SITE: Grassy smpg with juncus. Some patches of vaccinium. Rocky outcrops and numerous boulders/rocks present.
HALO:

## PRESELI ESA, HISTORIC MONITORING

BASELINE 1994

PRN: 1582

C

### LAND MANAGEMENT:

**SITE:** Land used for hill grazing. No stock present when visited but farmer indicated that cattle, sheep and goats used the area.

**HALO:** Area around monument very grassy and is highly grazed. Veronica and some calluna present around site with junos on wetter areas.

D

### DESCRIPTION/CONDITION OF MONUMENT:

Not easy to distinguish exact location because of numerous rocks, boulders and rock outcrops. Monument appear as round/rectangular enclosures bordered by broken lines of stones. Some upright stones appear to mark 'walls' at some points. In some places a clearly visible mound of stones marks the site of a wall. There appear to be 4 or 5

E

### POTENTIALLY THREATENING FACTORS: (see Table 1)

Main problems are damage from livestock trampling the walls. Because area around site is grassy livestock probably graze here in greater numbers than on rest of the area. Junos spreading over part of site. Area generally fairly exposed to weather.

CONTINUED? YES ☒ NO ☐



# PRESELI ESA, HISTORIC MONITORING

BASELINE 1994

SUPPLEMENTARY NOTES TO FIELD SURVEYS PAGE ... OF ... PRN: 1582.

D/ individual enclosures at this site. Growth of juniper is obscuring the outline of enclosures in places. The more rectangular enclosures are slightly more obvious having a definite raised lip with a level interior floor area.

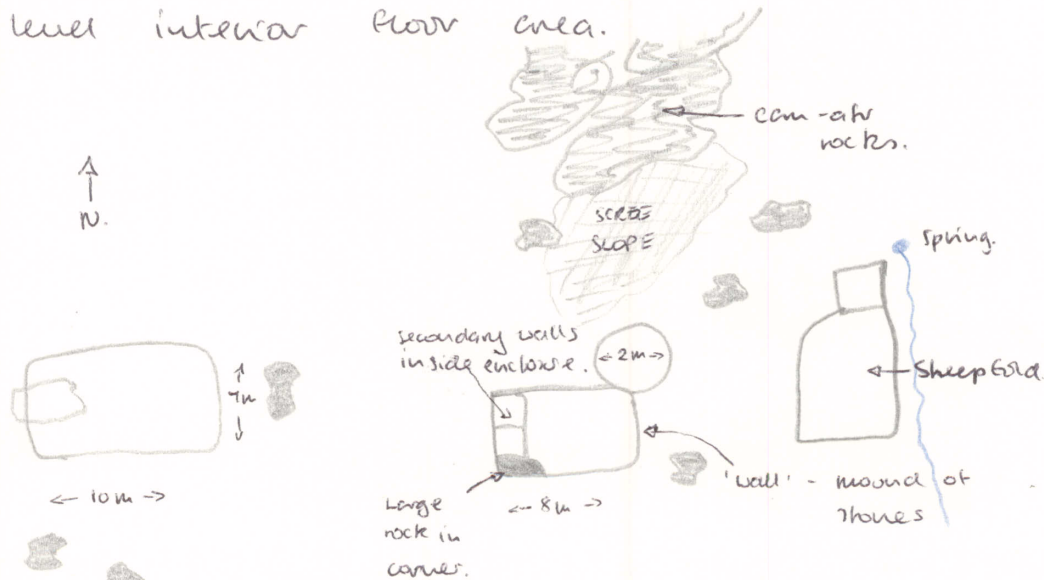

TABLE 1

PRESELI ESA, HISTORIC MONITORING, BASELINE 1994

PRN: 1582

POTENTIALLY THREATENING FACTORS			
AGENT	PRESENT?	ACTION	SIGNIFICANCE
ANIMALS	<input checked="" type="checkbox"/>	■ Burrowing - badgers, foxes, rabbits	■ damage/disturbance to underground artefacts
	<input type="checkbox"/>	■ Overgrazing - cattle, horses, sheep	■ loss of vegetation cover/soil damage, leading to erosion
	<input type="checkbox"/>	■ Poaching - cattle, horses, sheep	■ as above, possible damage to upstanding feature
	<input checked="" type="checkbox"/>	■ Rubbing point/erosion focus point - cattle, horses, sheep	
HUMAN	<input type="checkbox"/>	■ Demolition or removal of monument	■ active removal of artefacts/monument
	<input type="checkbox"/>	■ Rubbish Dumping	■ infilling/contamination
	<input type="checkbox"/>	■ Trampling/poaching - on footpaths/desire lines	■ loss of vegetation cover/soil damage leading to erosion
	<input type="checkbox"/>	■ Mountain Bikes/Motorcross etc	■ as above
	<input type="checkbox"/>	■ Deep Ploughing/Drainage Works/Building	■ damage/disturbance of artefacts
	<input type="checkbox"/>	■ Shallow cultivation/Reseeds	■ as above
	<input type="checkbox"/>	■ Tree/Scrub removal by uprooting	■ as above
	<input type="checkbox"/>	■ Scrub Burning in Bonfires	■ intense heat at point source, damage to artefacts and alteration of soil profile
VEGETATION	<input type="checkbox"/>	■ Root damage - trees and scrub (especially where deep rooted (heavy crowns)	■ damage/disturbance of artefacts
	<input type="checkbox"/>	■ Tree Windthrow	■ potential massive damage/disturbance
	<input type="checkbox"/>	■ Scrub Encroachment - bracken, gorse, rhododendron, thorn	■ root or rhizome damage/disturbance (bracken least significant)
WEATHER/SITE FACTORS	<input checked="" type="checkbox"/>	■ High rainfall/windspeeds - exposure	■ greater erosion risk than level, non exposed site
	<input type="checkbox"/>	■ High Gradient	



PRESELI ESA RESURVEY 1997  
POINT LINEAR / HISTORICAL MONITORING

SQUARE No. ☐

OWNERSHIPS ☐

LAND COVER ☐

BOUNDARIES ☐

PHOTO RECORD ☐

1582

PRESELI

SN0920 3010

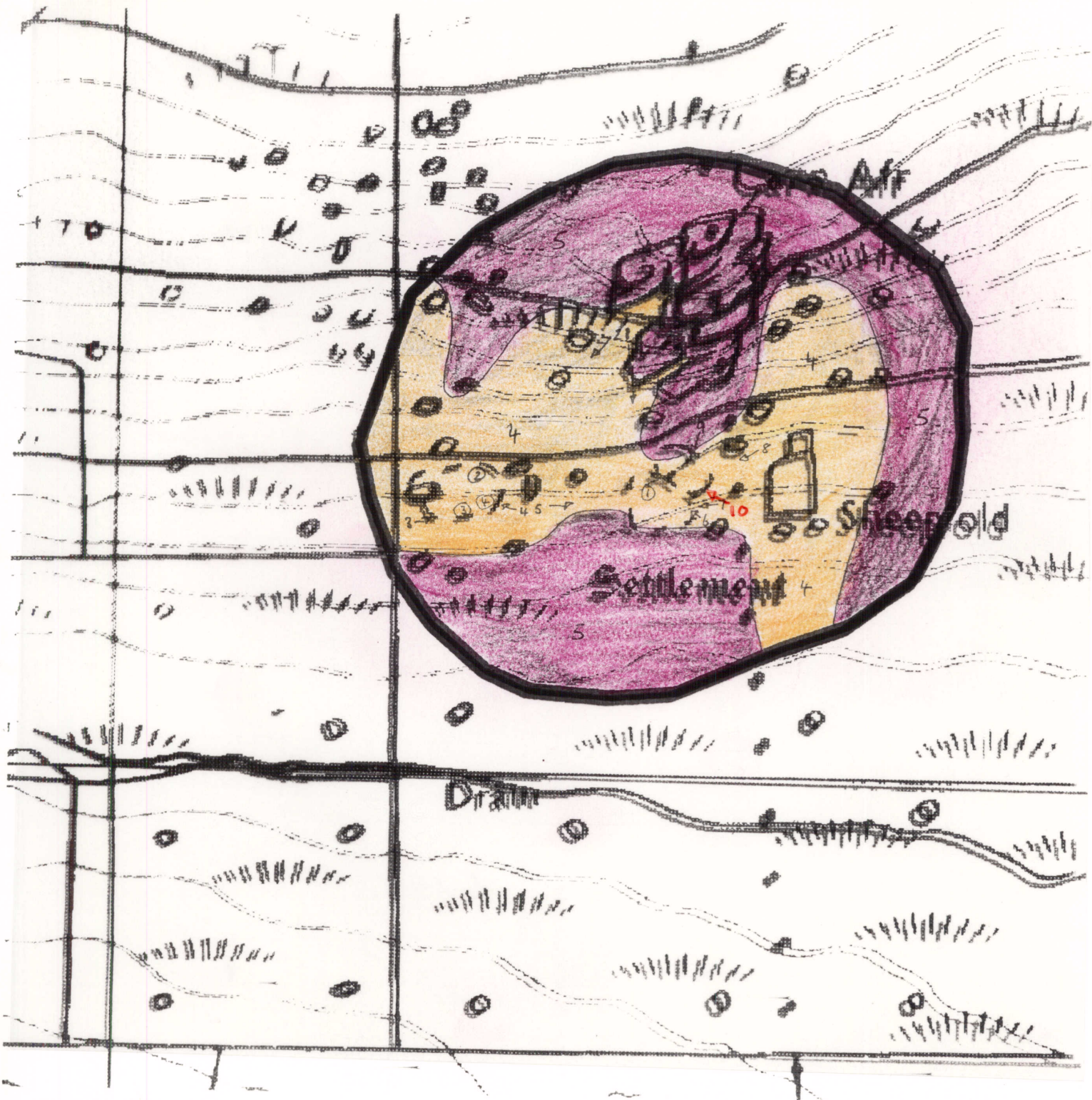

PRESELI ESA HISTORIC MONITORING RESURVEY 1997/98

A

OS 1:10,000 SHEET: SO/SH/SN 035E		GRID REF: SO/SH/SN 0920 3010	
PRN: 1582 SITE NAME: CARP - AFR			
AIR PHOTO No: 57/92/137		LANDSCAPE TYPE: A	
No GROUND PHOTOS: 14/15			
DATE RESURVEYED: 22/9/97		RESURVEYED BY: SA Hopwood	

IF CHANGES TO ANY OF THE FOLLOWING HAVE OCCURRED SINCE THE BASELINE, DETAIL THESE CHANGES IN THE APPROPRIATE SECTION OF THE RESURVEY PROFORMA.

- A: CHANGES TO ACCESS?
- B: CHANGES TO LANDCOVER
- C: CHANGES TO LAND MANAGEMENT
- D: CHANGES IN DESCRIPTION/CONDITION OF MONUMENT
- E: CHANGES IN POTENTIALLY THREATENING FACTORS
- F: CHANGE IN RATE OF DECAY N/A.

NO ✓	YES
NO ✓	YES
NO ✓	YES
NO ✓	YES
NO ✓	YES
NO	YES

A: ACCESS
-----------

B:LANDCOVER

SITE:

HALO:

C:LAND MANAGEMENT

SITE:

HALO:

D:DESCRIPTION/CONDITION OF MONUMENT



E: POTENTIALLY THREATENING FACTORS (see table 1)

F

RATE OF DECAY:

STABLE

SLOW

RAPID

CONTINUED?

YES

NO

POTENTIALLY THREATENING FACTORS			
AGENT	PRESENT	ACTION	SIGNIFICANCE
ANIMALS	Y N	Burrowing - badgers, foxes, rabbits	Damage/disturbance to underground artefacts
	Y N	Overgrazing - cattle, horses, sheep	Loss of vegetation cover/soil
	Y N	Poaching - cattle, horses, sheep	Damage to vegetation cover, leading to erosion
	Y N	Rubbing point/erosion focus point - cattle, horses, sheep	As above, plus possible damage to upstanding features
HUMAN	Y N	Demolition or removal of monument	Active removal of artefacts/monument
	Y N	Rubbish dumping	Infilling/contamination
	Y N	Trampling/poaching - on footpaths/desire lines	Loss of vegetation cover/soil damage resulting in erosion
	Y N	Mountain bikes/Motorcross etc	As above
	Y N	Deep ploughing/Drainage works/Building	Damage/disturbance of artefacts
	Y N	Shallow cultivation/reseeds	As above
	Y N	Tree/Scrub removal by uprooting	As above
	Y N	Scrub burning in bonfires	Intense heat at point source, damage to artefacts and alteration of soil profile
VEGETATION	Y N	Root damage - trees and scrub (especially where deep rooted - heavy crowns)	Damage/disturbance of artefacts
	Y N	Tree windthrow	Potential massive damage/disturbance
	Y N	Scrub encroachment - bracken, gorse, rhodedendron, thorn	Root or rhizome damage/disturbance (bracken least significant)
WEATHER/SITE FACTORS	Y N	High rainfall/windspeeds - exposure	Greater erosion risk than level, non exposed site
	Y N	High gradient	