

Photographic survey of Llandeloy Village Hall (SA62 6LJ) –
for conditions of 18/0915/PA

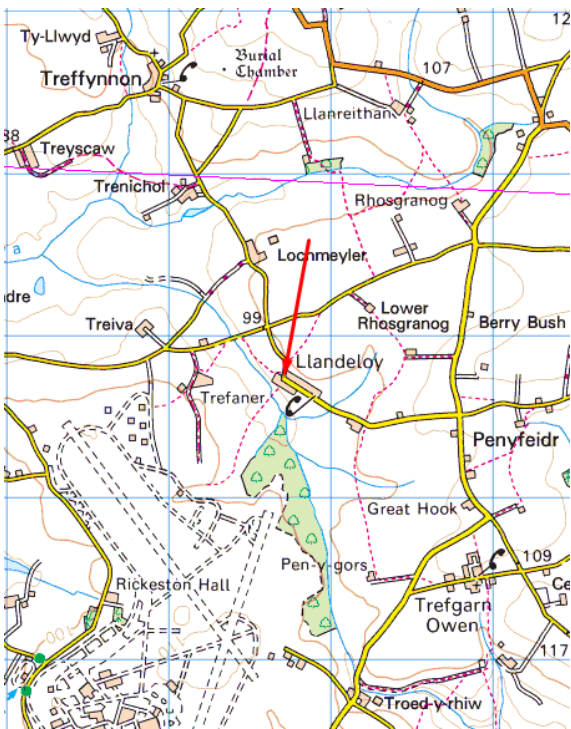

Location plan, building marked in red

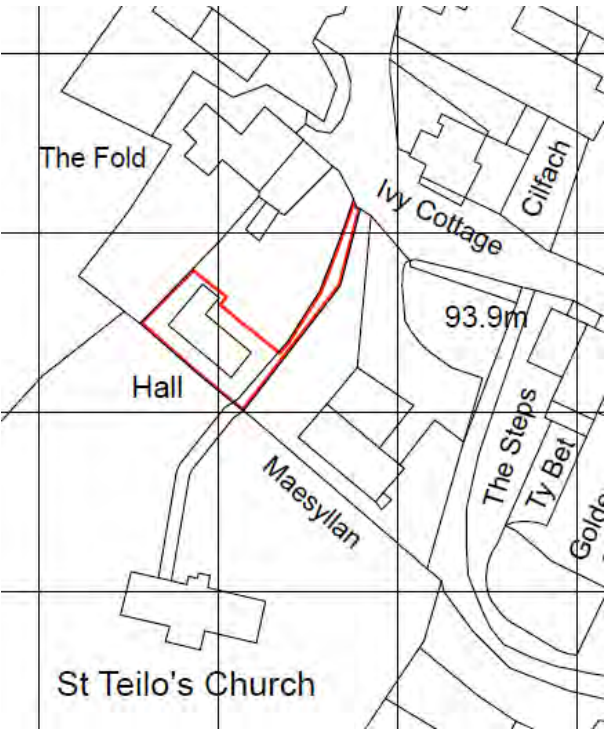
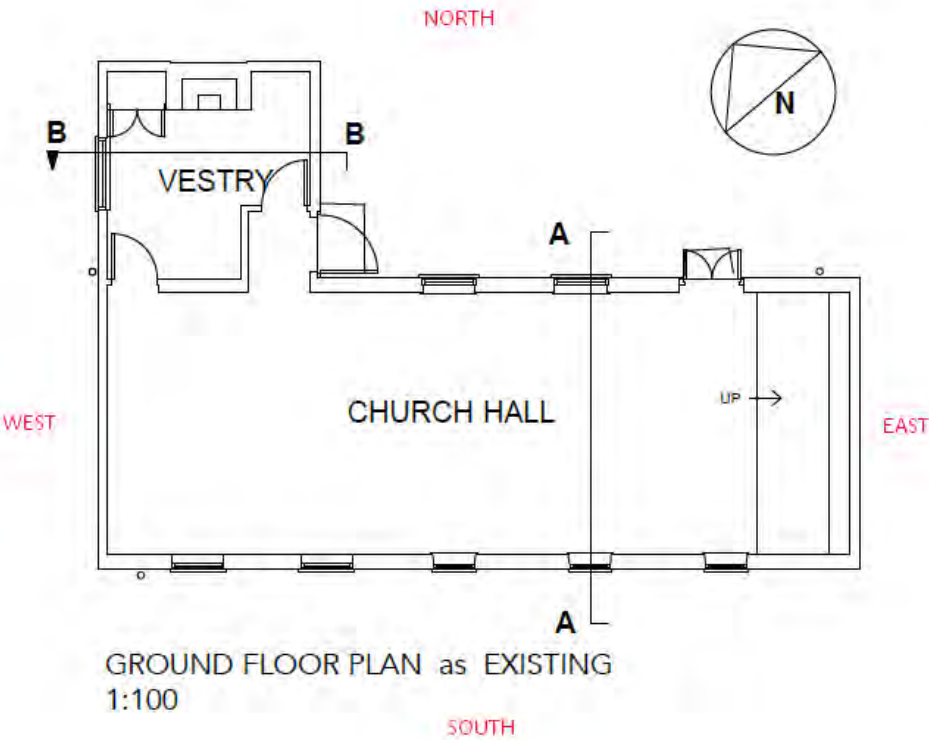

Building plan with compass points for subsequent caption referencing

Interior of Building

In all subsequent images, the tongue and groove panelling can be used as a dimensional scale (6-inch centres)



Each panel is six inches / 150mm wide



Looking to the east



The raised area at the east, presumably used as an altar area



Looking to the west end with vestry door to right



Close up of roof trusses



South side



Window details on south



North side



Old north door and windows



Close up of interior eaves details



Door into vestry on north side and entrance lobby on vestry east face



Vestry fireplace, north side



South side of vestry with entrance lobby



Old electrical fittings

Exterior of building

Moving clockwise around building from north...



North face



North east face – front door



North east face – front door detail



East face

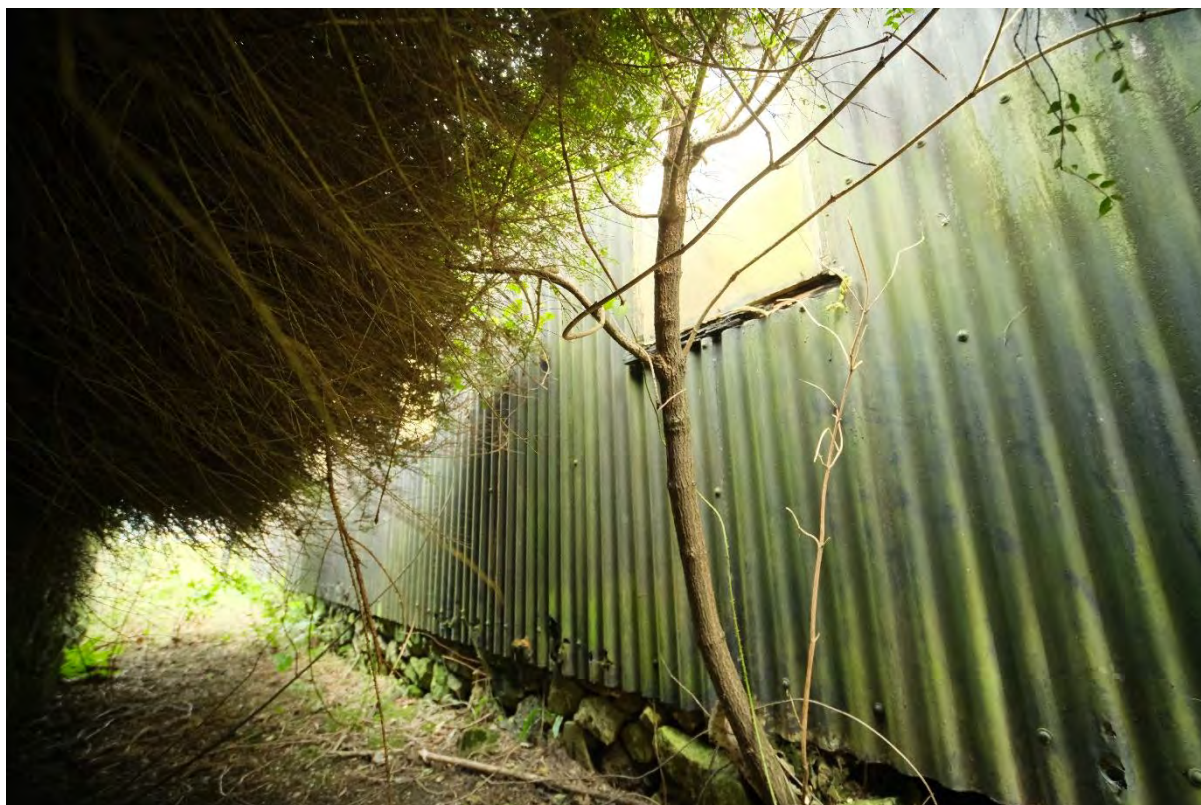

South east



South east



South west face



North west



West face – vestry to left



North west - vestry extension



North – vestry extension



North – vestry extension (cont)



North – door to east side of vestry



Roof detail





Roof details - vestry extension