

Prime Architecture Ltd,
Unit 4,
3 Llandeilo Road,
Cross Hands,
Llanelli,
SA14 6NA

01269 842 575
info@prime-arch.co.uk
www.prime-arch.co.uk

15/11/2021



PHOTOGRAPHIC SURVEY



Photograph 1 (P1) – East facing elevation

Prime Architecture Ltd,
Unit 4,
3 Llandeilo Road,
Cross Hands,
Llanelli,
SA14 6NA

01269 842 575
info@prime-arch.co.uk
www.prime-arch.co.uk

PRIME
ARCHITECTURE



Photograph 2 (P2) – West facing elevation



Photograph 3 (P3) – West facing elevation

Prime Architecture Ltd,
Unit 4,
3 Llandeilo Road,
Cross Hands,
Llanelli,
SA14 6NA

01269 842 575
info@prime-arch.co.uk
www.prime-arch.co.uk

PRIME
ARCHITECTURE



Photograph 4 (P4) – South facing elevation



Photograph 5 (P5) – East facing elevation

Prime Architecture Ltd,
Unit 4,
3 Llandeilo Road,
Cross Hands,
Llanelli,
SA14 6NA

01269 842 575
info@prime-arch.co.uk
www.prime-arch.co.uk

PRIME
ARCHITECTURE



Photograph 6 (P6) – Internal view looking at South elevation



Photograph 7 (P7) – East facing elevation

Prime Architecture Ltd,
Unit 4,
3 Llandeilo Road,
Cross Hands,
Llanelli,
SA14 6NA

01269 842 575
info@prime-arch.co.uk
www.prime-arch.co.uk

PRIME
ARCHITECTURE



Photograph 8 (P8) – West facing elevation



Photograph 9 (P9) – Internal view looking at North elevation

Prime Architecture Ltd,
Unit 4,
3 Llandeilo Road,
Cross Hands,
Llanelli,
SA14 6NA

01269 842 575
info@prime-arch.co.uk
www.prime-arch.co.uk

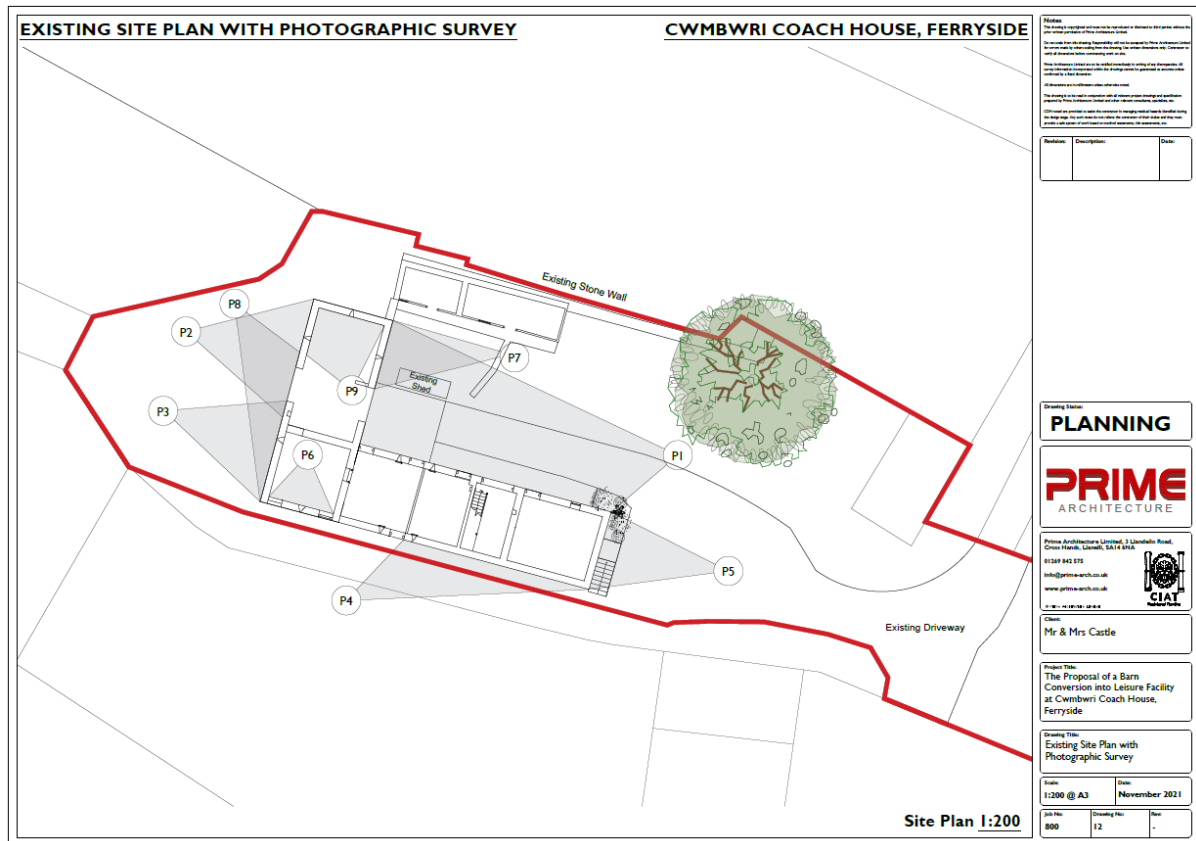

Existing Site Plan with Photographic Survey

Many thanks

Yours sincerely

Rebecca Evans BSc (Hons) Arch
Prime Architecture Limited