

# PENCAER COMMUNITY

## TRADITIONAL FARM BUILDINGS STUDY

### VOLUME II

Final Version

For

Pembrokeshire County Council

Prepared by

Acanthus Holden Architects

May 2004

**Farm No: 1**

**Community: Penciaer**

**Farm Name: Carne**

Permission:

Owner home ☐ yes      Permission given ☐ no      Viewed from road only ☐

Typical view of farm

Number of traditional farm buildings/ ranges:

Description:

Design Features:

Listed or Scheduled Ancient Monument status:

Historical/ archaeological value:      Approximate age:

Landscape value:

Current use:

Access:

Condition: reasonable

Major constructional problems: roofs not inspected

Owners attitude if determined:

| Awaiting<br>funding/<br>conversion/ part<br>converted | Positive<br>towards<br>alternative<br>uses | Interested in<br>buildings and<br>their future | Not interested           | Not<br>applicable/<br>Busy/ not<br>home |
|---|--|--|--------------------------|---|
| <input type="checkbox"/>                              | <input type="checkbox"/>                   | <input type="checkbox"/>                       | <input type="checkbox"/> | <input type="checkbox"/>                |

Additional comments:

Farm No: 2

Community: Pencaer

Farm Name: Fferm Tresinwen

Permission:

Owner home ☐ yes      Permission given ☐ yes      Viewed from road only ☐



Typical view of farm

Number of traditional farm buildings/ ranges: 5

Description: Buildings informally grouped either side of sloping lane and also around former cottage – now bungalow

Design Features: some grouted roofs

Listed or Scheduled Ancient Monument status: none

Historical/ archaeological value: average      Approximate age: before 1850

Landscape value: important

Current use: farming: livestock/ storage

Access: reasonable

Condition: reasonable

Major constructional problems: roofs not inspected

Owners attitude if determined:

|   |  |  |                |   |
|---|--|--|----------------|---|
| Awaiting<br>funding/<br>conversion/ part<br>converted | Positive<br>towards<br>alternative<br>uses | Interested in<br>buildings and<br>their future | Not interested | Not<br>applicable/<br>Busy/ not<br>home |
|---|--|--|----------------|---|

|                          |                          |                                     |                          |                          |
|--------------------------|--------------------------|-------------------------------------|--------------------------|--------------------------|
| <input type="checkbox"/> | <input type="checkbox"/> | <input checked="" type="checkbox"/> | <input type="checkbox"/> | <input type="checkbox"/> |
|--------------------------|--------------------------|-------------------------------------|--------------------------|--------------------------|

Additional comments:

**Farm No: 3**

**Community: Pencaer**

**Farm Name: Llanwnwr**

Permission:

Owner home ☐ yes      Permission given ☐      Viewed from road only ☐



Typical view of farm

Number of traditional farm buildings/ ranges: 5

Description: model farm type layout. Buildings form three sides to a courtyard

Design Features: dovecote, brick arch heads

Listed or Scheduled Ancient Monument status: none

Historical/ archaeological value: v. important      Approximate age: mid 19<sup>th</sup> C

Landscape value: v. important – very prominent

Current use: farming/ dwelling/ garages

Access: good

Condition: very good

Major constructional problems: roofs not inspected

Owners attitude if determined:

|   |  |  |                |   |
|---|--|--|----------------|---|
| Awaiting<br>funding/<br>conversion/ part<br>converted | Positive<br>towards<br>alternative<br>uses | Interested in<br>buildings and<br>their future | Not interested | Not<br>applicable/<br>Busy/ not<br>home |
|---|--|--|----------------|---|

☐      ☒      ☐      ☐      ☐

Additional comments:

Farm No: 4

Community: Pencaer

Farm Name: Penysgwarne

Permission:

Owner home ☒ Permission given ☐ Viewed from road only ☐



Typical view of farm

Number of traditional farm buildings/ ranges: 6

Description: Model-type three sided arrangement with house and former schoolhouse closing off the fourth side. Formerly arched access to farmland beyond

Design Features: interesting roof structure, stone arched heads to cart house, several grouted roofs

Listed or Scheduled Ancient Monument status: Listed Grade II

Historical/ archaeological value: V. Important Approximate age: mid 19<sup>th</sup> C

Landscape value: important

Current use: farming/ stable/ redundant

Access: good

Condition: fair condition. Grouted roofs deteriorating

Major constructional problems: roofs not inspected

Owners attitude if determined:

|   |  |  |                |   |
|---|--|--|----------------|---|
| Awaiting<br>funding/<br>conversion/ part<br>converted | Positive<br>towards<br>alternative<br>uses | Interested in<br>buildings and<br>their future | Not interested | Not<br>applicable/<br>Busy/ not<br>home |
|---|--|--|----------------|---|

|                      |                      |                      |                      |                      |
|----------------------|----------------------|----------------------|----------------------|----------------------|
| <input type="text"/> | <input type="text"/> | <input type="text"/> | <input type="text"/> | <input type="text"/> |
|----------------------|----------------------|----------------------|----------------------|----------------------|

Additional comments:

Farm No: 5

Community: Pencaer

Farm Name: Pontiago Farm

Permission:

Owner home ☐ no Permission given ☐ Viewed from road only ☐ no

Typical view of farm

Number of traditional farm buildings/ ranges:

Description:

Design Features:

Listed or Scheduled Ancient Monument status:

Historical/ archaeological value: Approximate age:

Landscape value:

Current use:

Access:

Condition: reasonable

Major constructional problems: roofs not inspected

Owners attitude if determined:

| Awaiting<br>funding/<br>conversion/ part<br>converted | Positive<br>towards<br>alternative<br>uses | Interested in<br>buildings and<br>their future | Not interested | Not<br>applicable/<br>Busy/ not<br>home |
|---|--|--|----------------|---|
|---|--|--|----------------|---|

|                      |                      |                      |                      |                      |
|----------------------|----------------------|----------------------|----------------------|----------------------|
| <input type="text"/> | <input type="text"/> | <input type="text"/> | <input type="text"/> | <input type="text"/> |
|----------------------|----------------------|----------------------|----------------------|----------------------|

Additional comments:

Farm No: 6

Community: Pencaer

Farm Name: Rhoshowell – **unable to locate**

Permission:

Owner home ☐ Permission given ☐ Viewed from road only ☐

Typical view of farm

Number of traditional farm buildings/ ranges:

Description:

Design Features:

Listed or Scheduled Ancient Monument status:

Historical/ archaeological value: Approximate age:

Landscape value:

Current use:

Access:

Good ☐ Reasonable | Poor ☐ Tarmac ☐

Condition:

Major constructional problems: roofs not inspected

Owners attitude if determined:

| Awaiting<br>funding/<br>conversion/ part<br>converted | Positive<br>towards<br>alternative<br>uses | Interested in<br>buildings and<br>their future | Not interested           | Not<br>applicable/<br>Busy/ not<br>home |
|---|--|--|--------------------------|---|
| <input type="checkbox"/>                              | <input type="checkbox"/>                   | <input type="checkbox"/>                       | <input type="checkbox"/> | <input type="checkbox"/>                |

Additional comments:

**Farm No: 7**

**Community: Pencaer**

**Farm Name: Trefisheg**

Permission:

Owner home ☐ Permission given ☐ Viewed from road only ☒



Typical view of farm

Number of traditional farm buildings/ ranges: 1

Description: under conversion

Design Features:

Listed or Scheduled Ancient Monument status: none

Historical/ archaeological value: none Approximate age: 19<sup>th</sup> C

Landscape value: moderate

Current use: under conversion

Access: good

Condition: unknown

Major constructional problems: n/a

Owners attitude if determined:

|   |  |  |                |   |
|---|--|--|----------------|---|
| Awaiting<br>funding/<br>conversion/ part<br>converted | Positive<br>towards<br>alternative<br>uses | Interested in<br>buildings and<br>their future | Not interested | Not<br>applicable/<br>Busy/ not<br>home |
|---|--|--|----------------|---|

|     |  |  |  |  |
|-----|--|--|--|--|
| yes |  |  |  |  |
|-----|--|--|--|--|

Additional comments:



Farm No: 8

Community: Penciaer

Farm Name: Tresinwen - duplication

Permission:

Owner home ☐ Permission given ☐ Viewed from road only ☐

Typical view of farm

Number of traditional farm buildings/ ranges:

Description:

Design Features:

Listed or Scheduled Ancient Monument status:

Historical/ archaeological value: Approximate age:

Landscape value:

Current use:

Access:

Condition:

Major constructional problems: roofs not inspected

Owners attitude if determined:

| Awaiting<br>funding/<br>conversion/ part<br>converted | Positive<br>towards<br>alternative<br>uses | Interested in<br>buildings and<br>their future | Not interested           | Not<br>applicable/<br>Busy/ not<br>home |
|---|--|--|--------------------------|---|
| <input type="checkbox"/>                              | <input type="checkbox"/>                   | <input type="checkbox"/>                       | <input type="checkbox"/> | <input type="checkbox"/>                |

Additional comments:

Farm No: 9

Community: Pencaer

Farm Name: Bwlch y Rhos Farm

Permission:

Owner home ☐ yes      Permission given ☐ yes      Viewed from road only ☐



Typical view of farm

Number of traditional farm buildings/ ranges: 3

Description: Small individual buildings grouped around yard

Design Features: ventilation slits in cowhouse

Listed or Scheduled Ancient Monument status: none

Historical/ archaeological value: none      Approximate age: before 1850

Landscape value: important

Current use:

Access: reasonable

Condition: reasonable

Major constructional problems: roofs not inspected

Owners attitude if determined:

|   |  |  |                |   |
|---|--|--|----------------|---|
| Awaiting<br>funding/<br>conversion/ part<br>converted | Positive<br>towards<br>alternative<br>uses | Interested in<br>buildings and<br>their future | Not interested | Not<br>applicable/<br>Busy/ not<br>home |
|---|--|--|----------------|---|

|                          |                          |                          |                          |                                       |
|--------------------------|--------------------------|--------------------------|--------------------------|---------------------------------------|
| <input type="checkbox"/> | <input type="checkbox"/> | <input type="checkbox"/> | <input type="checkbox"/> | <input checked="" type="checkbox"/> x |
|--------------------------|--------------------------|--------------------------|--------------------------|---------------------------------------|

Additional comments:

Farm No: 10

Community: Pencaer

Farm Name: Carngowil – not able to view it sufficiently from road.

Permission:

Owner home ☐ no      Permission given ☐      Viewed from road only ☐ no



Typical view of farm

Number of traditional farm buildings/ ranges:

Description:

Design Features:

Listed or Scheduled Ancient Monument status:

Historical/ archaeological value:      Approximate age:

Landscape value:

Current use:

Access:

Condition:

Major constructional problems: roofs not inspected

Owners attitude if determined:

|   |  |  |                |   |
|---|--|--|----------------|---|
| Awaiting<br>funding/<br>conversion/ part<br>converted | Positive<br>towards<br>alternative<br>uses | Interested in<br>buildings and<br>their future | Not interested | Not<br>applicable/<br>Busy/ not<br>home |
|---|--|--|----------------|---|

|                      |                      |                      |                      |                      |
|----------------------|----------------------|----------------------|----------------------|----------------------|
| <input type="text"/> | <input type="text"/> | <input type="text"/> | <input type="text"/> | <input type="text"/> |
|----------------------|----------------------|----------------------|----------------------|----------------------|

Additional comments:

**Farm No: 16**

**Community: Pencaer**

**Farm Name: Treissyllt Fach**

**Farm No: 17**

**Community: Pencaer**

**Farm Name: Ty Isaf – could not locate**

Permission:

Owner home ☐ Permission given ☐ Viewed from road only ☐

Typical view of farm

Number of traditional farm buildings/ ranges:

Description:

Design Features:

Listed or Scheduled Ancient Monument status:

Historical/ archaeological value:                      Approximate age:

Landscape value:

Current use:

Access:

Condition:

Major constructional problems: roofs not inspected

Owners attitude if determined:

| Awaiting<br>funding/<br>conversion/ part<br>converted | Positive<br>towards<br>alternative<br>uses | Interested in<br>buildings and<br>their future | Not interested | Not<br>applicable/<br>Busy/ not<br>home |
|---|--|--|----------------|---|
|---|--|--|----------------|---|

|                          |                          |                          |                          |                          |
|--------------------------|--------------------------|--------------------------|--------------------------|--------------------------|
| <input type="checkbox"/> | <input type="checkbox"/> | <input type="checkbox"/> | <input type="checkbox"/> | <input type="checkbox"/> |
|--------------------------|--------------------------|--------------------------|--------------------------|--------------------------|

Additional comments:

Farm No: 18

Community: Pencaer

Farm Name: Dedwyddfa Farm

Permission:

Owner home ☐ no      Permission given ☐      Viewed from road only ☐ yes

Typical view of farm



Number of traditional farm buildings/ ranges: 1

Description: single building

Design Features:

Listed or Scheduled Ancient Monument status: none

Historical/ archaeological value: none      Approximate age: 19<sup>th</sup> C

Landscape value: none

Current use: unknown

Access: good

Condition: good

Major constructional problems: roofs not inspected

Owners attitude if determined:

|   |  |  |                |   |
|---|--|--|----------------|---|
| Awaiting<br>funding/<br>conversion/ part<br>converted | Positive<br>towards<br>alternative<br>uses | Interested in<br>buildings and<br>their future | Not interested | Not<br>applicable/<br>Busy/ not<br>home |
|---|--|--|----------------|---|

|                          |                          |                          |                          |                                       |
|--------------------------|--------------------------|--------------------------|--------------------------|---------------------------------------|
| <input type="checkbox"/> | <input type="checkbox"/> | <input type="checkbox"/> | <input type="checkbox"/> | <input checked="" type="checkbox"/> X |
|--------------------------|--------------------------|--------------------------|--------------------------|---------------------------------------|

Additional comments:

Farm No: 19

Community: Pencaer

Farm Name: Granston Farm

Permission:

Owner home  Permission given  Viewed from road only

Typical view of farm



Number of traditional farm buildings/ ranges: 2

Description:

Design Features: grouted roofs

Listed or Scheduled Ancient Monument status: Grade II

Historical/ archaeological value: v. important      Approximate age: before 1850

Landscape value: important

Current use: farming

Access: good

Condition: poor

Major constructional problems: roofs not inspected

Owners attitude if determined:

|   |  |  |                |   |
|---|--|--|----------------|---|
| Awaiting<br>funding/<br>conversion/ part<br>converted | Positive<br>towards<br>alternative<br>uses | Interested in<br>buildings and<br>their future | Not interested | Not<br>applicable/<br>Busy/ not<br>home |
|---|--|--|----------------|---|

|                      |                      |                      |                      |                                |
|----------------------|----------------------|----------------------|----------------------|--------------------------------|
| <input type="text"/> | <input type="text"/> | <input type="text"/> | <input type="text"/> | <input type="text" value="X"/> |
|----------------------|----------------------|----------------------|----------------------|--------------------------------|

Additional comments:

**Farm No: 19.**

**Community: Pencaer**

**Farm Name: Granston Farm**

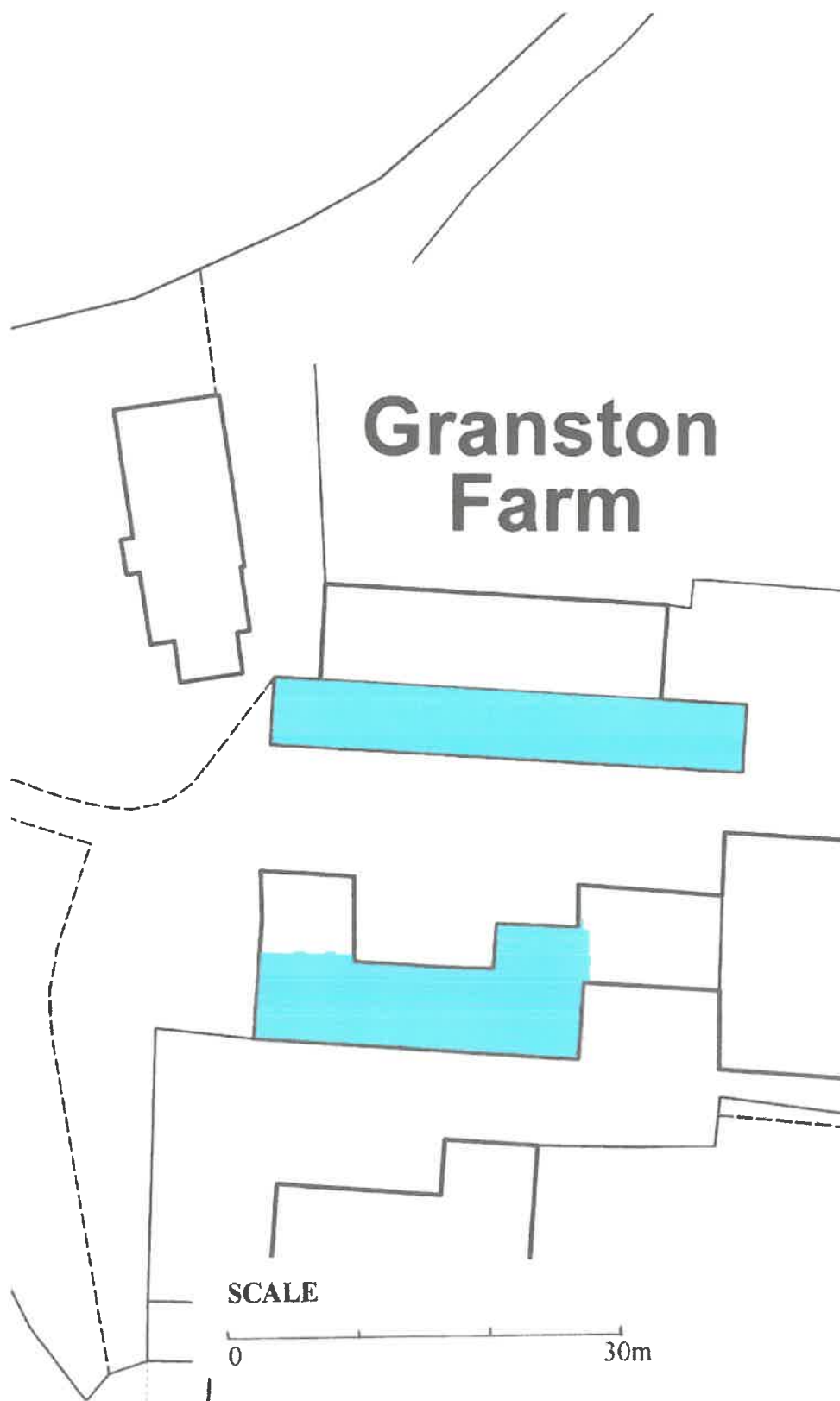



Farm No: 20

Community: Pencaer

Farm Name: Granston Hall

Permission:

Owner home ☐ no      Permission given ☐      Viewed from road only ☐ yes



Typical view of farm

Number of traditional farm buildings/ ranges: 3

Description: to far away to comment

Design Features:

Listed or Scheduled Ancient Monument status: Grade II

Historical/ archaeological value: v. important      Approximate age: mid 19<sup>th</sup> C

Landscape value: important

Current use: farming

Access: good

Condition: reasonable

Major constructional problems: roofs not inspected

Owners attitude if determined:

|   |  |  |                |   |
|---|--|--|----------------|---|
| Awaiting<br>funding/<br>conversion/ part<br>converted | Positive<br>towards<br>alternative<br>uses | Interested in<br>buildings and<br>their future | Not interested | Not<br>applicable/<br>Busy/ not<br>home |
|---|--|--|----------------|---|

☐☐☐☐☒

Additional comments:

**Farm No: 20**

**Community: Pencaer**

**Farm Name: Granston Hall**

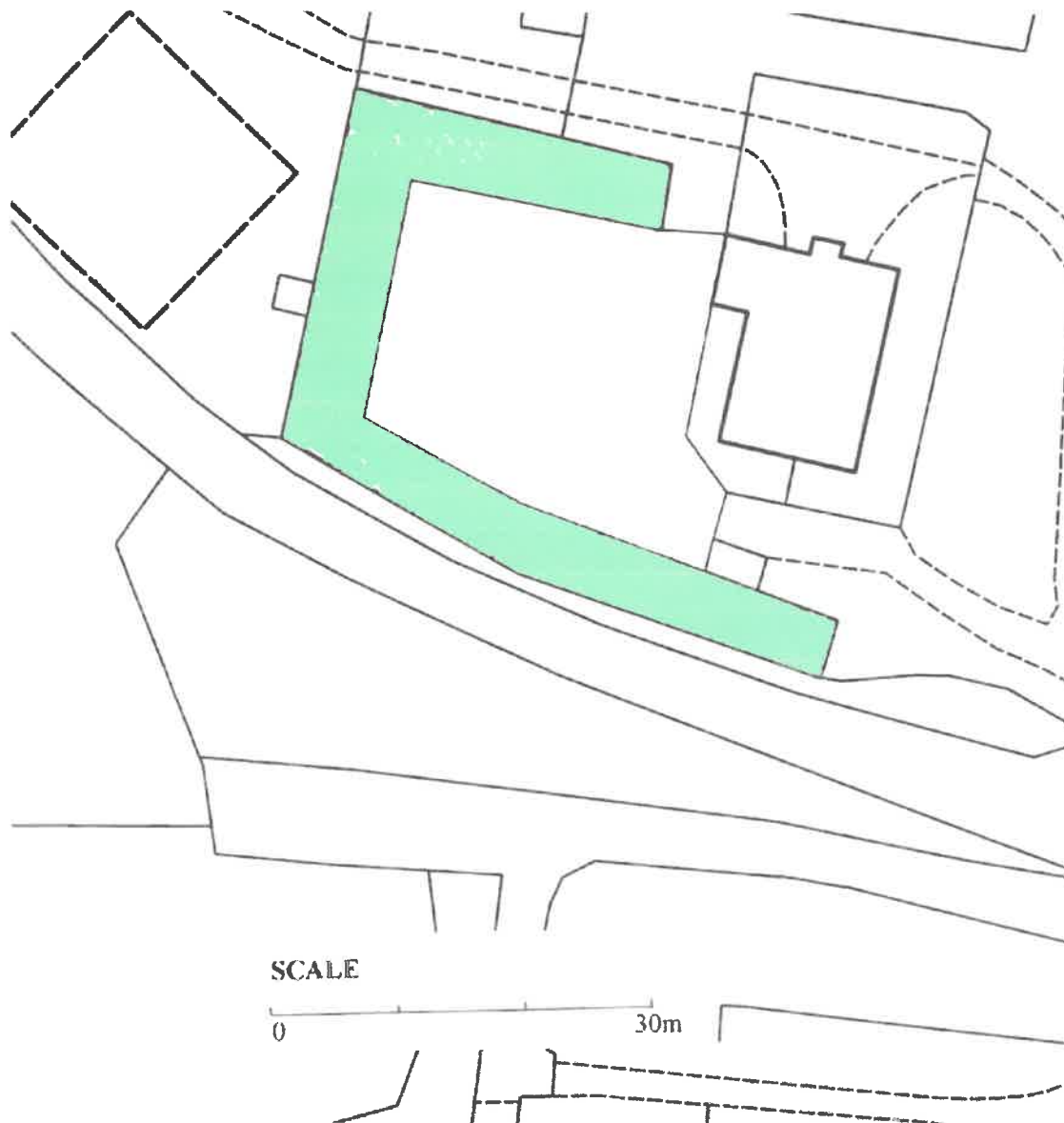

Farm No: 21

Community: Pencaer

Farm Name: Greenginal

Permission:

Owner home ☐ no      Permission Given ☐      Viewed from road only ☐ Yes



Typical view of farm

Number of traditional farm buildings/ ranges: none

Description:

Design Features:

Listed or Scheduled Ancient Monument status:

Historical/ archaeological value:      Approximate age:

Landscape value:

Current use:

Access:

Condition:

Major constructional problems: roofs not inspected

Owners attitude if determined:

|   |  |  |                |   |
|---|--|--|----------------|---|
| Awaiting<br>funding/<br>conversion/ part<br>converted | Positive<br>towards<br>alternative<br>uses | Interested in<br>buildings and<br>their future | Not interested | Not<br>applicable/<br>Busy/ not<br>home |
|---|--|--|----------------|---|

|                      |                      |                      |                      |                      |
|----------------------|----------------------|----------------------|----------------------|----------------------|
| <input type="text"/> | <input type="text"/> | <input type="text"/> | <input type="text"/> | <input type="text"/> |
|----------------------|----------------------|----------------------|----------------------|----------------------|

Additional comments:

Farm No: 22

Community: Penaer

Farm Name: Llangoffan Farm - Ty Isaf

Permission:

Owner home ☐ yes      Permission given ☐      Viewed from road only ☐



Typical view of farm

Number of traditional farm buildings/ ranges: 6

Description: L shaped range. grouted roof

Design Features:

Listed or Scheduled Ancient Monument status: Grade II

Historical/ archaeological value: v. important      Approximate age: mid 19<sup>th</sup> C

Landscape value: important

Current use: storage/ redundant

Access: good

Condition: very good

Major constructional problems: roofs not inspected

Owners attitude if determined:

|   |  |  |                |   |
|---|--|--|----------------|---|
| Awaiting<br>funding/<br>conversion/ part<br>converted | Positive<br>towards<br>alternative<br>uses | Interested in<br>buildings and<br>their future | Not interested | Not<br>applicable/<br>Busy/ not<br>home |
|---|--|--|----------------|---|

|                          |                          |                                     |                          |                          |
|--------------------------|--------------------------|-------------------------------------|--------------------------|--------------------------|
| <input type="checkbox"/> | <input type="checkbox"/> | <input checked="" type="checkbox"/> | <input type="checkbox"/> | <input type="checkbox"/> |
|--------------------------|--------------------------|-------------------------------------|--------------------------|--------------------------|

Additional comments:

Llangoffan Farm Ty Uchaf has successfully diversified into the cheese-making centre

**Farm No: 23****Community: Pencaer****Farm Name: Penbryn Farm**

Permission:

Owner home ☐ no      Permission given ☐      Viewed from road only ☐ Yes



Typical view of farm

Number of traditional farm buildings/ ranges: none

Description:

Design Features:

Listed or Scheduled Ancient Monument status:

Historical/ archaeological value:      Approximate age:

Landscape value:

Current use:

Access:

Condition:

Major constructional problems: roofs not inspected

Owners attitude if determined:

|   |  |  |                |   |
|---|--|--|----------------|---|
| Awaiting<br>funding/<br>conversion/ part<br>converted | Positive<br>towards<br>alternative<br>uses | Interested in<br>buildings and<br>their future | Not interested | Not<br>applicable/<br>Busy/ not<br>home |
|---|--|--|----------------|---|

|  |  |  |  |  |
|--|--|--|--|--|
|  |  |  |  |  |
|--|--|--|--|--|

Additional comments:

Farm No: 24

Community: Pencaer

Farm Name: Rydyfferm – not located

Permission:

Owner home ☐ Permission given ☐ Viewed from road only ☐

Typical view of farm

Number of traditional farm buildings/ ranges:

Description:

Design Features:

Listed or Scheduled Ancient Monument status:

Historical/ archaeological value: Approximate age:

Landscape value:

Current use:

Access:

Condition:

Major constructional problems: roofs not inspected

Owners attitude if determined:

| Awaiting<br>funding/<br>conversion/ part<br>converted | Positive<br>towards<br>alternative<br>uses | Interested in<br>buildings and<br>their future | Not interested | Not<br>applicable/<br>Busy/ not<br>home |
|---|--|--|----------------|---|
|---|--|--|----------------|---|

|                          |                          |                          |                          |                          |
|--------------------------|--------------------------|--------------------------|--------------------------|--------------------------|
| <input type="checkbox"/> | <input type="checkbox"/> | <input type="checkbox"/> | <input type="checkbox"/> | <input type="checkbox"/> |
|--------------------------|--------------------------|--------------------------|--------------------------|--------------------------|

Additional comments:

**Farm No: 25****Community: Pencaer****Farm Name: Tregwynt Farm**

Permission:

Owner home ☐ yes      Permission given ☐ yes      Viewed from road only ☐



Typical view of farm

Number of traditional farm buildings/ ranges: 2

Description:

Design Features:

Listed or Scheduled Ancient Monument status: Grade II\*

Historical/ archaeological value: v. important      Approximate age: before 1850

Landscape value: v. important

Current use: farming and dwelling

Access: reasonable

Condition: reasonable

Major constructional problems: roofs not inspected

Owners attitude if determined:

| Awaiting<br>funding/<br>conversion/ part<br>converted | Positive<br>towards<br>alternative<br>uses | Interested in<br>buildings and<br>their future | Not interested           | Not<br>applicable/<br>Busy/ not<br>home |
|---|--|--|--------------------------|---|
| <input type="checkbox"/>                              | <input type="checkbox"/>                   | <input checked="" type="checkbox"/>            | <input type="checkbox"/> | <input type="checkbox"/>                |

Additional comments:

**Farm No: 26****Community: Pencaer****Farm Name: Woodland Farm**

Permission:

Owner home ☐ yes      Permission given ☐ yes      Viewed from road only ☐

Typical view of farm

Number of traditional farm buildings/ ranges: 0

Description:

Design Features:

Listed or Scheduled Ancient Monument status:

Historical/ archaeological value:      Approximate age:

Landscape value:

Current use:

Access:

Condition:

Major constructional problems: roofs not inspected

Owners attitude if determined:

|   |  |  |                |   |
|---|--|--|----------------|---|
| Awaiting<br>funding/<br>conversion/ part<br>converted | Positive<br>towards<br>alternative<br>uses | Interested in<br>buildings and<br>their future | Not interested | Not<br>applicable/<br>Busy/ not<br>home |
|---|--|--|----------------|---|

|  |  |  |  |  |
|--|--|--|--|--|
|  |  |  |  |  |
|--|--|--|--|--|

Additional comments:



Farm No: 27

Community: Pencaer

Farm Name: Treisissyllt

Permission:

Owner home ☐ yes      Permission given ☐ yes      Viewed from road only ☐



Typical view of farm

Number of traditional farm buildings/ ranges: 7

Description:

Design Features:

Listed or Scheduled Ancient Monument status: none

Historical/ archaeological value: good example      Approximate age: mid 19<sup>th</sup> C

Landscape value: important

Current use: storage/ redundant/converted

Access: reasonable

Condition: very good

Major constructional problems:

Owners attitude if determined:

|   |  |  |                |   |
|---|--|--|----------------|---|
| Awaiting<br>funding/<br>conversion/ part<br>converted | Positive<br>towards<br>alternative<br>uses | Interested in<br>buildings and<br>their future | Not interested | Not<br>applicable/<br>Busy/ not<br>home |
|---|--|--|----------------|---|

|   |  |  |  |  |
|---|--|--|--|--|
| X |  |  |  |  |
|---|--|--|--|--|

Additional comments:

**Farm No: 28****Community: Pencaer****Farm Name: Bristgarn**

Permission:

Owner home ☐ yes      Permission given ☐ Yes      Viewed from road only ☐



Typical view of farm

Number of traditional farm buildings/ ranges: 3

Description: three individual buildings grouped around a yard

Design Features: hipped grouted roof – well maintained

Listed or Scheduled Ancient Monument status: none

Historical/ archaeological value: good      Approximate age: before 1850

Landscape value: moderate

Current use: farming/ storage/garage

Access: good

Condition: very good condition

Major constructional problems: roofs not inspected

Owners attitude if determined:

|   |  |  |                |   |
|---|--|--|----------------|---|
| Awaiting<br>funding/<br>conversion/ part<br>converted | Positive<br>towards<br>alternative<br>uses | Interested in<br>buildings and<br>their future | Not interested | Not<br>applicable/<br>Busy/ not<br>home |
|---|--|--|----------------|---|

☐      ☐      ☒ X      ☐      ☐

Additional comments:

**Farm No: 28**

**Community: Pencaer**

**Farm Name: Bristgarn**

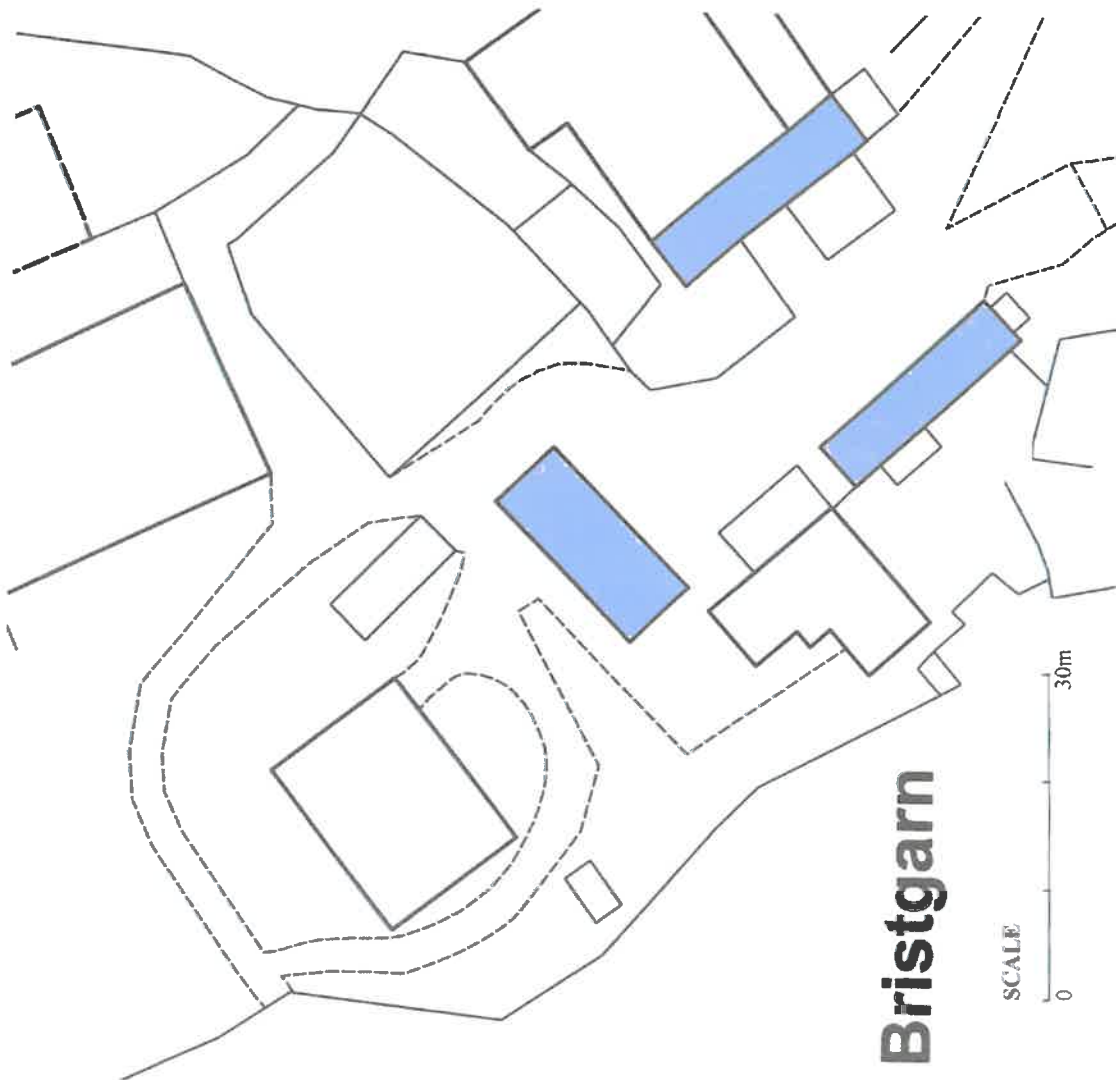

**Farm No: 29**

**Community: Pencaer**

**Farm Name: Broeurig – could not locate**

Permission:

Owner home ☐ Permission given ☐ Viewed from Road only ☐

Typical view of farm

Number of traditional farm buildings/ ranges:

Description:

Design Features:

Listed or Scheduled Ancient Monument status:

Historical/ archaeological value:                      Approximate age:

Landscape value:

Current use:

Access:

Condition:

Major constructional problems: roofs not inspected

Owners attitude if determined:

|   |  |  |                |   |
|---|--|--|----------------|---|
| Awaiting<br>funding/<br>conversion/ part<br>converted | Positive<br>towards<br>alternative<br>uses | Interested in<br>buildings and<br>their future | Not interested | Not<br>applicable/<br>Busy/ not<br>home |
|---|--|--|----------------|---|

|                      |                      |                      |                      |                      |
|----------------------|----------------------|----------------------|----------------------|----------------------|
| <input type="text"/> | <input type="text"/> | <input type="text"/> | <input type="text"/> | <input type="text"/> |
|----------------------|----------------------|----------------------|----------------------|----------------------|

Additional comments:

Farm No: 30

Community: Pencaer

Farm Name: Eithin Man - **Could not locate**

Permission:

Owner home ☐ Permission given ☐ Viewed from road only ☐

Typical view of farm

Number of traditional farm buildings/ ranges:

Description:

Design Features:

Listed or Scheduled Ancient Monument status:

Historical/ archaeological value: Approximate age:

Landscape value:

Current use:

Access:

Condition:

Major constructional problems: roofs not inspected

Owners attitude if determined:

|   |  |  |                |   |
|---|--|--|----------------|---|
| Awaiting<br>funding/<br>conversion/ part<br>converted | Positive<br>towards<br>alternative<br>uses | Interested in<br>buildings and<br>their future | Not interested | Not<br>applicable/<br>Busy/ not<br>home |
|---|--|--|----------------|---|

|                          |                          |                          |                          |                          |
|--------------------------|--------------------------|--------------------------|--------------------------|--------------------------|
| <input type="checkbox"/> | <input type="checkbox"/> | <input type="checkbox"/> | <input type="checkbox"/> | <input type="checkbox"/> |
|--------------------------|--------------------------|--------------------------|--------------------------|--------------------------|

Additional comments:

Farm No: 31

Community: Pencaer

Farm Name: Gilfach Farm

Permission:

Owner home ☐ yes      Permission given ☐ yes      Viewed from road only ☐



Typical view of farm

Number of traditional farm buildings/ ranges: 1

Description: small stone building in yard

Design Features:

Listed or Scheduled Ancient Monument status: none

Historical/ archaeological value: none      Approximate age: before 1850

Landscape value: average

Current use: unknown

Access: reasonable

Condition: fair

Major constructional problems: roofs not inspected

Owners attitude if determined:

|   |  |  |                |   |
|---|--|--|----------------|---|
| Awaiting<br>funding/<br>conversion/ part<br>converted | Positive<br>towards<br>alternative<br>uses | Interested in<br>buildings and<br>their future | Not interested | Not<br>applicable/<br>Busy/ not<br>home |
|---|--|--|----------------|---|

☐      ☐      ☒      ☐      ☐

Additional comments:

Farm No: 32

Community: Pencaer

Farm Name: Goytan

Permission:

Owner home ☐ yes      Permission given ☐ Yes      Viewed from Road only ☐

Typical view of farm

Number of traditional farm buildings/ ranges: 0

Description:

Design Features:

Listed or Scheduled Ancient Monument status:

Historical/ archaeological value:      Approximate age:

Landscape value:

Current use:

Access:

Condition:

Major constructional problems: roofs not inspected

Owners attitude if determined:

| Awaiting<br>funding/<br>conversion/ part<br>converted | Positive<br>towards<br>alternative<br>uses | Interested in<br>buildings and<br>their future | Not interested | Not<br>applicable/<br>Busy/ not<br>home |
|---|--|--|----------------|---|
|---|--|--|----------------|---|

|                      |                      |                      |                      |                      |
|----------------------|----------------------|----------------------|----------------------|----------------------|
| <input type="text"/> | <input type="text"/> | <input type="text"/> | <input type="text"/> | <input type="text"/> |
|----------------------|----------------------|----------------------|----------------------|----------------------|

Additional comments:

Owner manages Penyswarne

Farm No: 33

Community: Pencaer

Farm Name: Good Hope

Permission:

Owner home ☐ yes      Permission given ☐ yes      Viewed from road only ☐



Typical view of farm

Number of traditional farm buildings/ ranges: 3

Description: two outbuildings attached to cottage, one detached. Detached building not shown on 1871 map. Long lane providing access.

Design Features:

Listed or Scheduled Ancient Monument status: none

Historical/ archaeological value: average      Approximate age: pre 1891 and post 1891

Landscape value: important

Current use: farming/ under conversion/ under conversion

Access: poor

Condition: v. good

Major constructional problems: roofs not inspected

Owners attitude if determined:

|   |  |  |                |   |
|---|--|--|----------------|---|
| Awaiting<br>funding/<br>conversion/ part<br>converted | Positive<br>towards<br>alternative<br>uses | Interested in<br>buildings and<br>their future | Not interested | Not<br>applicable/<br>Busy/ not<br>home |
|---|--|--|----------------|---|

|   |  |  |  |  |
|---|--|--|--|--|
| X |  |  |  |  |
|---|--|--|--|--|

Additional comments:

One building in National Trust ownership – used for farming



**Farm No: 34****Community: Pencaer****Farm Name: North Pole**

Permission:

Owner home ☐ no      Permission given ☐ no      Viewed from road only ☐



Typical view of farm

Number of traditional farm buildings/ ranges: **none**

Description: cottage accessed from steep track

Design Features:

Listed or Scheduled Ancient Monument status:

Historical/ archaeological value:      Approximate age:

Landscape value:

Current use:

Access:

Condition:

Major constructional problems: roofs not inspected

Owners attitude if determined:

|   |  |  |                |   |
|---|--|--|----------------|---|
| Awaiting<br>funding/<br>conversion/ part<br>converted | Positive<br>towards<br>alternative<br>uses | Interested in<br>buildings and<br>their future | Not interested | Not<br>applicable/<br>Busy/ not<br>home |
|---|--|--|----------------|---|

Additional comments:

Farm No: 35

Community: Pencaer

Farm Name: Panteurig

Permission:

Owner home ☐ yes      Permission given ☐ yes      Viewed from road only ☐



Typical view of farm

Number of traditional farm buildings/ ranges: 4

Description: Farm buildings informally arranged around former yard.

Design Features: grouted roof.

Listed or Scheduled Ancient Monument status: Grade II

Historical/ archaeological value: v. important      Approximate age: pre 1850s

Landscape value: important

Current use: storage/ garage/ redundant

Access: poor

Condition: poor

Major constructional problems: some roof missing

Owners attitude if determined:

|   |  |  |                |   |
|---|--|--|----------------|---|
| Awaiting<br>funding/<br>conversion/ part<br>converted | Positive<br>towards<br>alternative<br>uses | Interested in<br>buildings and<br>their future | Not interested | Not<br>applicable/<br>Busy/ not<br>home |
|---|--|--|----------------|---|

|                          |                          |                          |                          |                                     |
|--------------------------|--------------------------|--------------------------|--------------------------|-------------------------------------|
| <input type="checkbox"/> | <input type="checkbox"/> | <input type="checkbox"/> | <input type="checkbox"/> | <input checked="" type="checkbox"/> |
|--------------------------|--------------------------|--------------------------|--------------------------|-------------------------------------|

Additional comments:

Farm No: 36

Community: Pencaer

Farm Name: Penysgwarne - **duplication**

Permission:

Owner home ☐ Permission given ☐ Viewed from road only ☐

Typical view of farm

Number of traditional farm buildings/ ranges:

Description:

Design Features:

Listed or Scheduled Ancient Monument status:

Historical/ archaeological value: Approximate age:

Landscape value:

Current use:

Access:

Condition:

Major constructional problems: roofs not inspected

Owners attitude if determined:

| Awaiting<br>funding/<br>conversion/ part<br>converted | Positive<br>towards<br>alternative<br>uses | Interested in<br>buildings and<br>their future | Not interested           | Not<br>applicable/<br>Busy/ not<br>home |
|---|--|--|--------------------------|---|
| <input type="checkbox"/>                              | <input type="checkbox"/>                   | <input type="checkbox"/>                       | <input type="checkbox"/> | <input type="checkbox"/>                |

Additional comments:

**Farm No: 37****Community: Pencaer****Farm Name: Trehowell**

Permission:

Owner home ☐ yes      Permission given ☐ no      Viewed from road only ☐

Typical view of farm

Number of traditional farm buildings/ ranges: 3

Description:

Design Features:

Listed or Scheduled Ancient Monument status: Grade II

Historical/ archaeological value: v. important      Approximate age:

Landscape value:

Current use:

Access:

Condition:

Major constructional problems: roofs not inspected

Owners attitude if determined:

|   |  |  |                |   |
|---|--|--|----------------|---|
| Awaiting<br>funding/<br>conversion/ part<br>converted | Positive<br>towards<br>alternative<br>uses | Interested in<br>buildings and<br>their future | Not interested | Not<br>applicable/<br>Busy/ not<br>home |
|---|--|--|----------------|---|

|                      |                      |                      |                      |                      |
|----------------------|----------------------|----------------------|----------------------|----------------------|
| <input type="text"/> | <input type="text"/> | <input type="text"/> | <input type="text"/> | <input type="text"/> |
|----------------------|----------------------|----------------------|----------------------|----------------------|

Additional comments:

Farm No: 38

Community: Pencaer

Farm Name: Trenchwydd

Permission:

Owner home ☐ no      Permission ☐ given      Viewed from road only ☒ yes



Typical view of farm

Number of traditional farm buildings/ ranges: 3

Description: L shaped arrangement of farm buildings to side of impressive house.

Design Features: grouted roofs

Listed or Scheduled Ancient Monument status: Grade II

Historical/ archaeological value: v. important      Approximate age: 19<sup>th</sup> C

Landscape value: important

Current use: unknown

Access: good

Condition: reasonable

Major constructional problems: roofs not inspected

Owners attitude if determined:

|   |  |  |                |   |
|---|--|--|----------------|---|
| Awaiting<br>funding/<br>conversion/ part<br>converted | Positive<br>towards<br>alternative<br>uses | Interested in<br>buildings and<br>their future | Not interested | Not<br>applicable/<br>Busy/ not<br>home |
|---|--|--|----------------|---|

|                          |                          |                          |                          |                                     |
|--------------------------|--------------------------|--------------------------|--------------------------|-------------------------------------|
| <input type="checkbox"/> | <input type="checkbox"/> | <input type="checkbox"/> | <input type="checkbox"/> | <input checked="" type="checkbox"/> |
|--------------------------|--------------------------|--------------------------|--------------------------|-------------------------------------|

Additional comments:

**Farm No: 38**

**Community: Pencaer**

**Farm Name: Trenewydd**



Farm No: 39

Community: Pencaer

Farm Name: Llanferran Farm

Permission:

Owner home ☐ yes      Permission given ☐ yes      Viewed from road only ☐



Typical view of farm

Number of traditional farm buildings/ ranges: 5

Description: Three sided courtyard arrangement. House facing into the yard.

Design Features: stone arches, grouted roofs

Listed or Scheduled Ancient Monument status:

Historical/ archaeological value: good example      Approximate age: mid 19<sup>th</sup> C

Landscape value: important

Current use: farming/ storage

Access: reasonable

Condition: good

Major constructional problems: roofs not inspected

Owners attitude if determined:

|   |  |  |                |   |
|---|--|--|----------------|---|
| Awaiting<br>funding/<br>conversion/ part<br>converted | Positive<br>towards<br>alternative<br>uses | Interested in<br>buildings and<br>their future | Not interested | Not<br>applicable/<br>Busy/ not<br>home |
|---|--|--|----------------|---|

|                          |                          |                                     |                          |                          |
|--------------------------|--------------------------|-------------------------------------|--------------------------|--------------------------|
| <input type="checkbox"/> | <input type="checkbox"/> | <input checked="" type="checkbox"/> | <input type="checkbox"/> | <input type="checkbox"/> |
|--------------------------|--------------------------|-------------------------------------|--------------------------|--------------------------|

Additional comments:

Farm No: 40

Community: Pencaer

Farm Name: Velindre

Permission:

Owner home ☐ yes      Permission given ☐ yes      Viewed from road only ☐



Typical view of farm

Number of traditional farm buildings/ ranges: 4

Description: Interesting ruinous complex. Water mill in valley basin

Design Features: overshot wheel and boarded waterchute from leat.

Listed or Scheduled Ancient Monument status: Grade II

Historical/ archaeological value: v. important      Approximate age: 19<sup>th</sup> C

Landscape value: important

Current use: storage/ unknown

Access: good

Condition: fair

Major constructional problems: roofs not inspected

Owners attitude if determined:

|   |  |  |                |   |
|---|--|--|----------------|---|
| Awaiting<br>funding/<br>conversion/ part<br>converted | Positive<br>towards<br>alternative<br>uses | Interested in<br>buildings and<br>their future | Not interested | Not<br>applicable/<br>Busy/ not<br>home |
|---|--|--|----------------|---|

|                          |                          |                                     |                          |                          |
|--------------------------|--------------------------|-------------------------------------|--------------------------|--------------------------|
| <input type="checkbox"/> | <input type="checkbox"/> | <input checked="" type="checkbox"/> | <input type="checkbox"/> | <input type="checkbox"/> |
|--------------------------|--------------------------|-------------------------------------|--------------------------|--------------------------|

Additional comments:



**Farm No: 40**

**Community: Pencaer**

**Farm Name: Velindre**

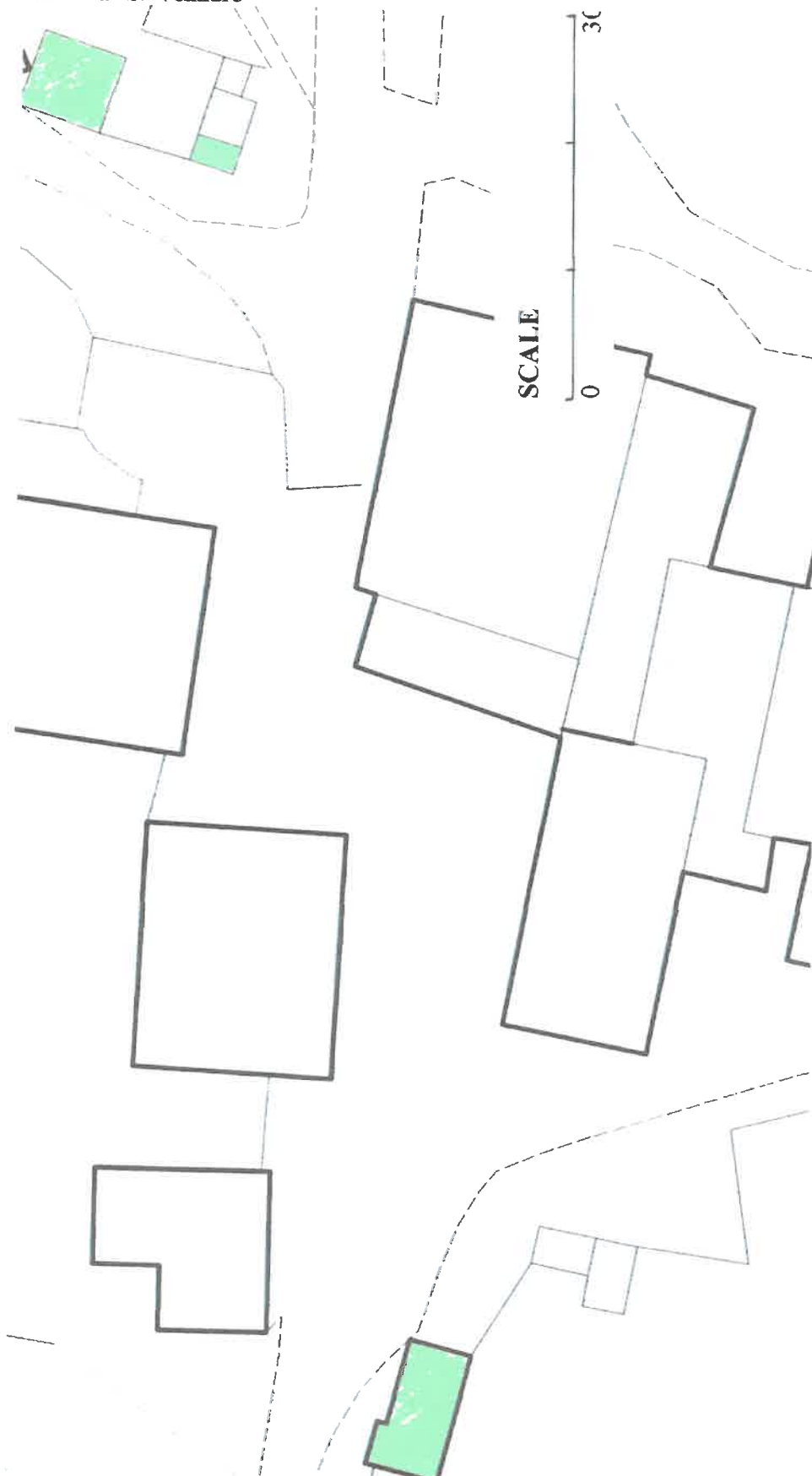

Farm No: 41

Community: Pencaer

Farm Name: Bank Farm

Permission:

Owner home ☐ yes      Permission given ☐ yes      Viewed from road only ☐



Typical view of farm

Number of traditional farm buildings/ ranges: 5

Description: Three sided courtyard arrangement. House at fourth side but not facing into yard.

Design Features: Ventilation slits to cowhouse. Brick heads, grouted roofs.

Listed or Scheduled Ancient Monument status: none

Historical/ archaeological value: average Approximate age: mid 19<sup>th</sup> C

Landscape value: important

Current use: stables/ farming/ one building converted

Access: good

Condition: v. good condition

Major constructional problems: roofs not inspected

Owners attitude if determined:

| Awaiting<br>funding/<br>conversion/ part<br>converted | Positive<br>towards<br>alternative<br>uses | Interested in<br>buildings and<br>their future | Not interested           | Not<br>applicable/<br>Busy/ not<br>home |
|---|--|--|--------------------------|---|
| <input type="checkbox"/>                              | <input type="checkbox"/>                   | <input checked="" type="checkbox"/>            | <input type="checkbox"/> | <input type="checkbox"/>                |

Additional comments: Active stables

**Farm No: 42****Community: Pencaer****Farm Name: Gwndwn Gwyn**

Permission:

Owner home ☐ no      Permission given ☐ no      Viewed from road only ☐ yes

Typical view of farm

Number of traditional farm buildings/ ranges: 1

Description: small outbuilding

Design Features:

Listed or Scheduled Ancient Monument status: none

Historical/ archaeological value: average      Approximate age: pre 1981

Landscape value: average

Current use: unknown/ redundant

Access: good

Condition: reasonable

Major constructional problems: roofs not inspected

Owners attitude if determined:

|   |  |  |                |   |
|---|--|--|----------------|---|
| Awaiting<br>funding/<br>conversion/ part<br>converted | Positive<br>towards<br>alternative<br>uses | Interested in<br>buildings and<br>their future | Not interested | Not<br>applicable/<br>Busy/ not<br>home |
|---|--|--|----------------|---|

|  |  |  |  |  |
|--|--|--|--|--|
|  |  |  |  |  |
|--|--|--|--|--|

Additional comments:

**Farm No: 43****Community: Pencaer****Farm Name: Pant y Beudy**

Permission:

Owner home ☐ no      Permission given ☐ no      Viewed from road only ☐ yes



Typical view of farm

Number of traditional farm buildings/ ranges: **none**

Description:

Design Features:

Listed or Scheduled Ancient Monument status: none

Historical/ archaeological value:      Approximate age:

Landscape value:

Current use:

Access:

Condition:

Major constructional problems:

Owners attitude if determined:

| Awaiting<br>funding/<br>conversion/ part<br>converted | Positive<br>towards<br>alternative<br>uses | Interested in<br>buildings and<br>their future | Not interested           | Not<br>applicable/<br>Busy/ not<br>home |
|---|--|--|--------------------------|---|
| <input type="checkbox"/>                              | <input type="checkbox"/>                   | <input type="checkbox"/>                       | <input type="checkbox"/> | <input type="checkbox"/>                |

Additional comments:

Farm No: 44

Community: Pencaer

Farm Name: Talygaer

Permission:

Owner home ☐ no      Permission given ☐ no      Viewed from road only ☐ yes



Typical view of farm

Number of traditional farm buildings/ ranges: 4

Description:

Design Features:

Listed or Scheduled Ancient Monument status: Grade II

Historical/ archaeological value: v. important

Approximate age: pre 1850

Landscape value: important

Current use: 2 converted, 2 unknown

Access: good

Condition: fair/ converted - good

Major constructional problems: roofs not inspected

Owners attitude if determined:

| Awaiting<br>funding/<br>conversion/ part<br>converted | Positive<br>towards<br>alternative<br>uses | Interested in<br>buildings and<br>their future | Not interested | Not<br>applicable/<br>Busy/ not<br>home |
|---|--|--|----------------|---|
|---|--|--|----------------|---|

|  |  |  |  |   |
|--|--|--|--|---|
|  |  |  |  | x |
|--|--|--|--|---|

Additional comments:

**Farm No: 44**

**Community: Pencaer**

**Farm Name: Talygaer**

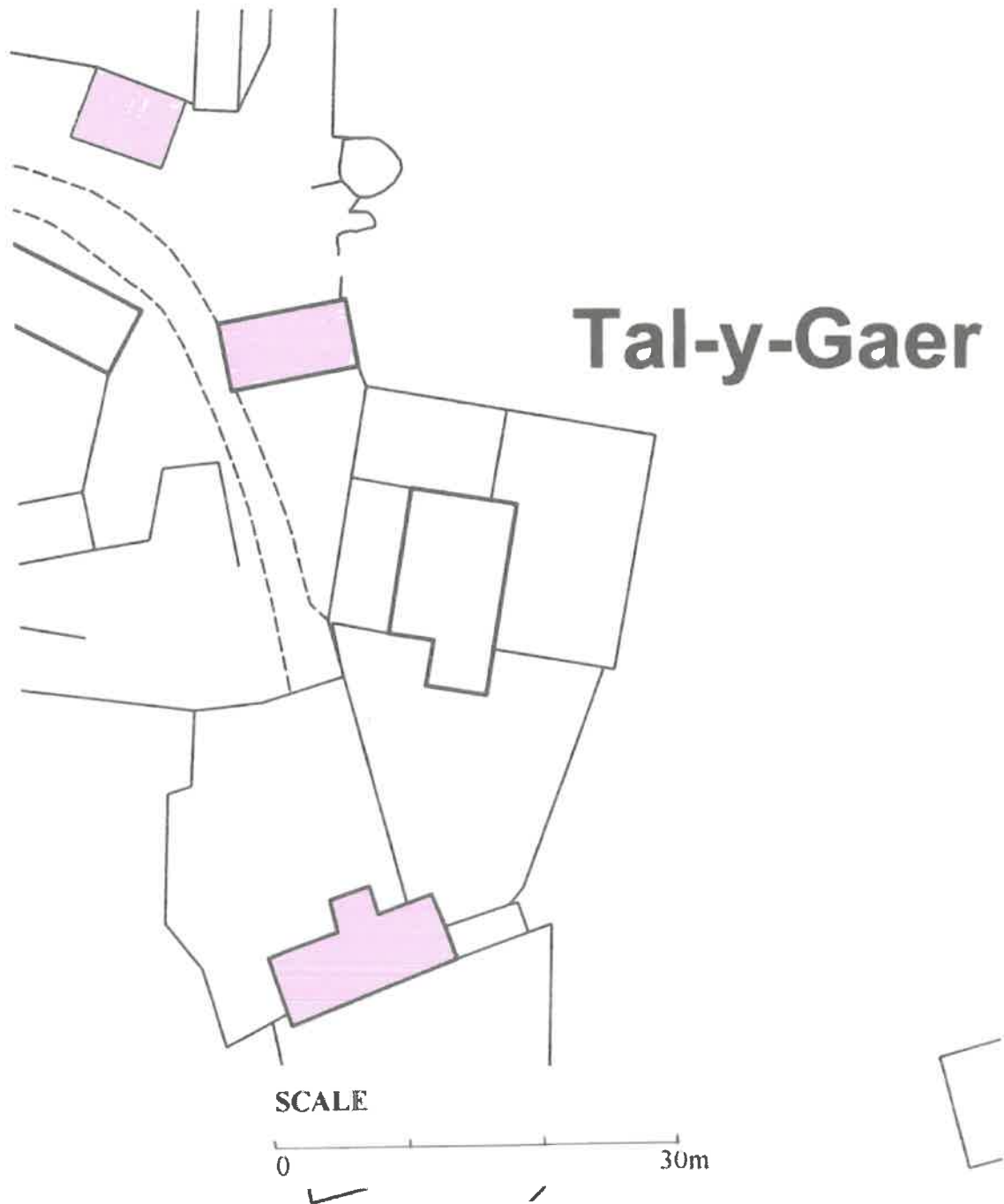

Farm No: 45

Community: Pencaer

Farm Name: Treathro Farmhouse

Permission:

Owner home ☐ yes      Permission given ☐ yes      Viewed from road only ☐



Typical view of farm

Number of traditional farm buildings/ ranges: 7

Description: Three sided courthouse arrangement, fourth side closed by wall. View shows granary with stable below.

Design Features: Several grouted roofs. Brick arched heads to carthouse, some timber lintels.

Listed or Scheduled Ancient Monument status: none

Historical/ archaeological value: v. important

Approximate age: pre 1850s

Landscape value: v. important

Current use: 3 farming/ 4 unknown

Access: good

Condition: good

Major constructional problems: roofs not inspected

Owners attitude if determined:

|   |  |  |                |   |
|---|--|--|----------------|---|
| Awaiting<br>funding/<br>conversion/ part<br>converted | Positive<br>towards<br>alternative<br>uses | Interested in<br>buildings and<br>their future | Not interested | Not<br>applicable/<br>Busy/ not<br>home |
|---|--|--|----------------|---|

|                          |                          |                                     |                          |                          |
|--------------------------|--------------------------|-------------------------------------|--------------------------|--------------------------|
| <input type="checkbox"/> | <input type="checkbox"/> | <input checked="" type="checkbox"/> | <input type="checkbox"/> | <input type="checkbox"/> |
|--------------------------|--------------------------|-------------------------------------|--------------------------|--------------------------|

Additional comments:

**Farm No: 45**

**Community: Pencaer**

**Farm Name: Treathro Farmhouse**

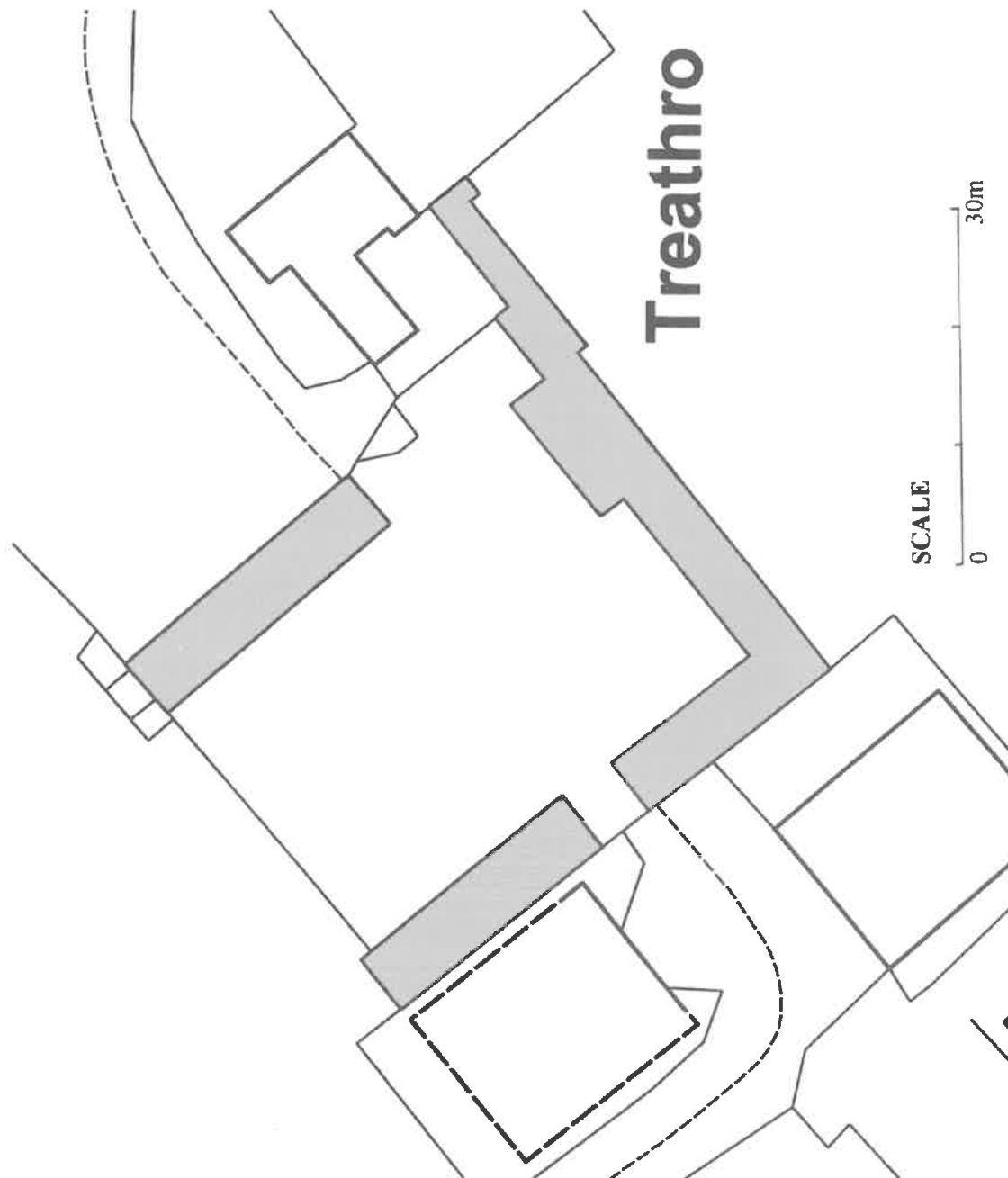



**Farm No: 46****Community: Pencaer****Farm Name: Trefasser Isaf**

Permission:

Owner home ☐ **yes**      Permission ☐ **given**      ☒ **no**      Viewed from road only ☐



Typical view of farm

Number of traditional farm buildings/ ranges: 1

Description:

Design Features:

Listed or Scheduled Ancient Monument status: Grade II

Historical/ archaeological value:      Approximate age:

Landscape value:

Current use:

Access:

Condition:

Major constructional problems: roofs not inspected

Owners attitude if determined:

|   |  |  |                |   |
|---|--|--|----------------|---|
| Awaiting<br>funding/<br>conversion/ part<br>converted | Positive<br>towards<br>alternative<br>uses | Interested in<br>buildings and<br>their future | Not interested | Not<br>applicable/<br>Busy/ not<br>home |
|---|--|--|----------------|---|

|                      |                      |                      |                      |                      |
|----------------------|----------------------|----------------------|----------------------|----------------------|
| <input type="text"/> | <input type="text"/> | <input type="text"/> | <input type="text"/> | <input type="text"/> |
|----------------------|----------------------|----------------------|----------------------|----------------------|

Additional comments:

**Farm No: 46**

**Community: Pencaer**

**Farm Name: Trefasser Isaf**



Farm No: 47

Community: Pencaer

Farm Name: Trehilyn East

Permission:

Owner home ☐ yes      Permission given ☐ yes      Viewed from road only ☐



Typical view of farm

Number of traditional farm buildings/ ranges: 2

Description: Two ranges facing across small farmyard. Grouted roofs. Roofs are breaking up.

Design Features: Brick and timber heads.

Listed or Scheduled Ancient Monument status: Grade II

Historical/ archaeological value: v. important

Approximate age: pre 1850s

Landscape value: important

Current use: farming

Access: reasonable

Condition: poor

Major constructional problems: roof appear to be sagging due to weight and grouting has begun to fall in.

Owners attitude if determined:

|   |  |  |                |   |
|---|--|--|----------------|---|
| Awaiting<br>funding/<br>conversion/ part<br>converted | Positive<br>towards<br>alternative<br>uses | Interested in<br>buildings and<br>their future | Not interested | Not<br>applicable/<br>Busy/ not<br>home |
|---|--|--|----------------|---|

☐ ☐ ☒ ☐ ☐

Additional comments:

**Farm No: 47**

**Community: Pencaer**

**Farm Name: Trehilyn East**



**Farm No: 48****Community: Pencaer****Farm Name: Trehilyn West**

Permission:

Owner home ☐ yes      Permission given ☐ yes      Viewed from road only ☐



Typical view of farm

Number of traditional farm buildings/ ranges: 2

Description:

Design Features: one range former cottage

Listed or Scheduled Ancient Monument status: none

Historical/ archaeological value: average

Approximate age: 19<sup>th</sup> C

Landscape value: important

Current use: 1 farming, 1 redundant

Access: reasonable

Condition: poor

Major constructional problems: roofs not inspected

Owners attitude if determined:

| Awaiting<br>funding/<br>conversion/ part<br>converted | Positive<br>towards<br>alternative<br>uses | Interested in<br>buildings and<br>their future | Not interested                        | Not<br>applicable/<br>Busy/ not<br>home |
|---|--|--|---------------------------------------|---|
| <input type="checkbox"/>                              | <input type="checkbox"/>                   | <input type="checkbox"/>                       | <input checked="" type="checkbox"/> x | <input type="checkbox"/>                |

Additional comments:

**Farm No: 48**

**Community: Pencaer**

**Farm Name: Trehilyn West**

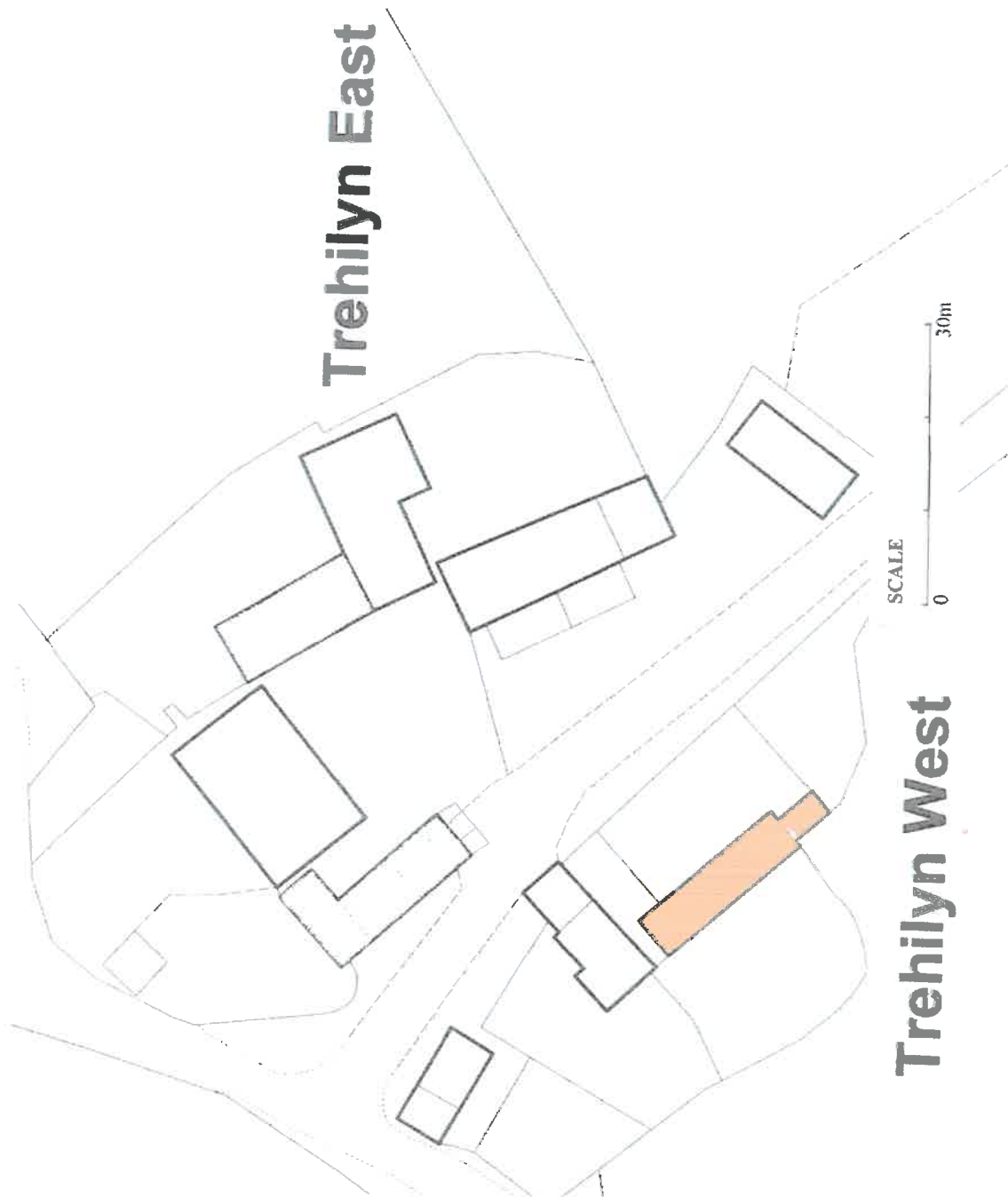

**Farm No: 49**

**Community: Pencaer**

**Farm Name: Fferm Trellys – could not locate**

Permission:

Owner home ☐ Permission given ☐ Viewed from road only ☐

Typical view of farm

Number of traditional farm buildings/ ranges:

Description:

Design Features:

Listed or Scheduled Ancient Monument status:

Historical/ archaeological value:                      Approximate age:

Landscape value:

Current use:

Access:

Condition:

Major constructional problems: roofs not inspected

Owners attitude if determined:

|   |  |  |                |   |
|---|--|--|----------------|---|
| Awaiting<br>funding/<br>conversion/ part<br>converted | Positive<br>towards<br>alternative<br>uses | Interested in<br>buildings and<br>their future | Not interested | Not<br>applicable/<br>Busy/ not<br>home |
|---|--|--|----------------|---|

|                          |                          |                          |                          |                          |
|--------------------------|--------------------------|--------------------------|--------------------------|--------------------------|
| <input type="checkbox"/> | <input type="checkbox"/> | <input type="checkbox"/> | <input type="checkbox"/> | <input type="checkbox"/> |
|--------------------------|--------------------------|--------------------------|--------------------------|--------------------------|

Additional comments:

Farm No: 50

Community: Pencaer

Farm Name: Trellys y Cnw

Permission:

Owner home ☐ yes      Permission given ☐ yes      Viewed from road only ☐



Typical view of farm

Number of traditional farm buildings/ ranges: 2

Description: 'U' shaped arrangement

Design Features:

Listed or Scheduled Ancient Monument status: none

Historical/ archaeological value: average      Approximate age: pre 1891

Landscape value: good

Current use: farming

Access: good

Condition: very good condition

Major constructional problems: roofs not inspected

Owners attitude if determined:

|   |  |  |                |   |
|---|--|--|----------------|---|
| Awaiting<br>funding/<br>conversion/ part<br>converted | Positive<br>towards<br>alternative<br>uses | Interested in<br>buildings and<br>their future | Not interested | Not<br>applicable/<br>Busy/ not<br>home |
|---|--|--|----------------|---|

|  |   |  |  |  |
|--|---|--|--|--|
|  | x |  |  |  |
|--|---|--|--|--|

Additional comments:



**Farm No: 51****Community: Pencaer****Farm Name: Penrhiw- outside area**

Permission:

Owner home ☐ Permission given ☐ Viewed from road only ☐

Typical view of farm

Number of traditional farm buildings/ ranges:

Description:

Design Features:

Listed or Scheduled Ancient Monument status:

Historical/ archaeological value:                      Approximate age:

Landscape value:

Current use:

Access:

Condition:

Major constructional problems: roofs not inspected

Owners attitude if determined:

| Awaiting<br>funding/<br>conversion/ part<br>converted | Positive<br>towards<br>alternative<br>uses | Interested in<br>buildings and<br>their future | Not interested | Not<br>applicable/<br>Busy/ not<br>home |
|---|--|--|----------------|---|
|---|--|--|----------------|---|

|                      |                      |                      |                      |                      |
|----------------------|----------------------|----------------------|----------------------|----------------------|
| <input type="text"/> | <input type="text"/> | <input type="text"/> | <input type="text"/> | <input type="text"/> |
|----------------------|----------------------|----------------------|----------------------|----------------------|

Additional comments:

**Farm No: 52****Community: Pencaer****Farm Name: Penlan – not visited**

Permission:

Owner home ☐ Permission given ☐ Viewed from road only ☐

Typical view of farm

Number of traditional farm buildings/ ranges:

Description:

Design Features:

Listed or Scheduled Ancient Monument status:

Historical/ archaeological value: Approximate age:

Landscape value:

Current use:

Access:

Condition:

Major constructional problems: roofs not inspected

Owners attitude if determined:

| Awaiting<br>funding/<br>conversion/ part<br>converted | Positive<br>towards<br>alternative<br>uses | Interested in<br>buildings and<br>their future | Not interested | Not<br>applicable/<br>Busy/ not<br>home |
|---|--|--|----------------|---|
|---|--|--|----------------|---|

|                          |                          |                          |                          |                          |
|--------------------------|--------------------------|--------------------------|--------------------------|--------------------------|
| <input type="checkbox"/> | <input type="checkbox"/> | <input type="checkbox"/> | <input type="checkbox"/> | <input type="checkbox"/> |
|--------------------------|--------------------------|--------------------------|--------------------------|--------------------------|

Additional comments:

**Farm No: 53****Community: Pencaer****Farm Name: Pencnwc – not visited**

Permission:

Owner home ☐ Permission given ☐ Viewed from road only ☐

Typical view of farm

Number of traditional farm buildings/ ranges:

Description:

Design Features:

Listed or Scheduled Ancient Monument status:

Historical/ archaeological value:                      Approximate age:

Landscape value:

Current use:

Access:

Condition:

Major constructional problems: roofs not inspected

Owners attitude if determined:

|   |  |  |                |   |
|---|--|--|----------------|---|
| Awaiting<br>funding/<br>conversion/ part<br>converted | Positive<br>towards<br>alternative<br>uses | Interested in<br>buildings and<br>their future | Not interested | Not<br>applicable/<br>Busy/ not<br>home |
|---|--|--|----------------|---|

|                          |                          |                          |                          |                          |
|--------------------------|--------------------------|--------------------------|--------------------------|--------------------------|
| <input type="checkbox"/> | <input type="checkbox"/> | <input type="checkbox"/> | <input type="checkbox"/> | <input type="checkbox"/> |
|--------------------------|--------------------------|--------------------------|--------------------------|--------------------------|

Additional comments:

**Farm No: 54**

**Community: Pencaer**

**Farm Name: Llyn y Gorras Farm – could not find**

Permission:

Owner home ☐ Permission given ☐ Viewed from road only ☐

Typical view of farm

Number of traditional farm buildings/ ranges:

Description:

Design Features:

Listed or Scheduled Ancient Monument status:

Historical/ archaeological value:                      Approximate age:

Landscape value:

Current use:

Access:

Condition:

Major constructional problems: roofs not inspected

Owners attitude if determined:

|   |  |  |                |   |
|---|--|--|----------------|---|
| Awaiting<br>funding/<br>conversion/ part<br>converted | Positive<br>towards<br>alternative<br>uses | Interested in<br>buildings and<br>their future | Not interested | Not<br>applicable/<br>Busy/ not<br>home |
|---|--|--|----------------|---|

|                      |                      |                      |                      |                      |
|----------------------|----------------------|----------------------|----------------------|----------------------|
| <input type="text"/> | <input type="text"/> | <input type="text"/> | <input type="text"/> | <input type="text"/> |
|----------------------|----------------------|----------------------|----------------------|----------------------|

Additional comments:

Farm No: 55

Community: Pencaer

Farm Name: Starway Farm

Permission:

Owner home ☐ no      Permission given ☐      Viewed from road only ☒ yes



Typical view of farm

Number of traditional farm buildings/ ranges: none

Description:

Design Features:

Listed or Scheduled Ancient Monument status: none

Historical/ archaeological value:      Approximate age:

Landscape value:

Current use:

Access:

Condition:

Major constructional problems: roofs not inspected

Owners attitude if determined:

|   |  |  |                |   |
|---|--|--|----------------|---|
| Awaiting<br>funding/<br>conversion/ part<br>converted | Positive<br>towards<br>alternative<br>uses | Interested in<br>buildings and<br>their future | Not interested | Not<br>applicable/<br>Busy/ not<br>home |
|---|--|--|----------------|---|

|                      |                      |                      |                      |                      |
|----------------------|----------------------|----------------------|----------------------|----------------------|
| <input type="text"/> | <input type="text"/> | <input type="text"/> | <input type="text"/> | <input type="text"/> |
|----------------------|----------------------|----------------------|----------------------|----------------------|

Additional comments:

Farm No: 56

Community: Pencaer

Farm Name: Maildy Uchaf

Permission:

Owner home ☐ yes      Permission given ☐ yes      Viewed from road only ☐



Typical view of farm

Number of traditional farm buildings/ ranges: 1

Description: Long range of outbuildings including granary/ cartshed and cowhouse

Design Features:

Listed or Scheduled Ancient Monument status: none

Historical/ archaeological value: none

Approximate age: 19<sup>th</sup> C

Landscape value: important

Current use: storage/ unknown

Access: reasonable

Condition: poor

Major constructional problems: gable part collapsed, roof part missing

Owners attitude if determined:

| Awaiting<br>funding/<br>conversion/ part<br>converted | Positive<br>towards<br>alternative<br>uses | Interested in<br>buildings and<br>their future | Not interested           | Not<br>applicable/<br>Busy/ not<br>home |
|---|--|--|--------------------------|---|
| <input type="checkbox"/>                              | <input type="checkbox"/>                   | <input checked="" type="checkbox"/>            | <input type="checkbox"/> | <input type="checkbox"/>                |

Additional comments:

Farm No: 57

Community: Pencaer

Farm Name: Llandruidion

Permission:

Owner home ☒ yes      Permission given ☒ yes      Viewed from road only ☐



Typical view of farm

Number of traditional farm buildings/ ranges: 5

Description: our sided courtyard arrangement – very prominent

Design Features: Some stone arches, most of brick

Listed or Scheduled Ancient Monument status: none

Historical/ archaeological value: v. important

Approximate age: mid 19<sup>th</sup> C

Landscape value: v. important – ver prominent

Current use: redundant

Access: poor

Condition: v. poor

Major constructional problems: roofs missing / about to collapse

Owners attitude if determined:

|   |  |  |                |   |
|---|--|--|----------------|---|
| Awaiting<br>funding/<br>conversion/ part<br>converted | Positive<br>towards<br>alternative<br>uses | Interested in<br>buildings and<br>their future | Not interested | Not<br>applicable/<br>Busy/ not<br>home |
|---|--|--|----------------|---|

|   |  |  |  |  |
|---|--|--|--|--|
| x |  |  |  |  |
|---|--|--|--|--|

Additional comments:

Likely site of archaeological interest. Owner wishes to convert it into retreat.

Farm No: 58

Community: Pencaer

Farm Name: Caerau Farmhouse

Permission:

Owner home ☐ no      Permission given ☐      Viewed from road only ☒ yes



Typical view of farm

Number of traditional farm buildings/ ranges: 1

Description:

Design Features:

Listed or Scheduled Ancient Monument status: none

Historical/ archaeological value: average

Approximate age: mid 19<sup>th</sup> C

Landscape value: average

Current use: converted

Access: good

Condition: very good

Major constructional problems: roofs not inspected

Owners attitude if determined:

|   |  |  |                |   |
|---|--|--|----------------|---|
| Awaiting<br>funding/<br>conversion/ part<br>converted | Positive<br>towards<br>alternative<br>uses | Interested in<br>buildings and<br>their future | Not interested | Not<br>applicable/<br>Busy/ not<br>home |
|---|--|--|----------------|---|

|                          |                          |                          |                          |                                       |
|--------------------------|--------------------------|--------------------------|--------------------------|---------------------------------------|
| <input type="checkbox"/> | <input type="checkbox"/> | <input type="checkbox"/> | <input type="checkbox"/> | <input checked="" type="checkbox"/> x |
|--------------------------|--------------------------|--------------------------|--------------------------|---------------------------------------|

Additional comments:



**Farm No: 58**

**Community: Pencaer**

**Farm Name: Caerau Farmhouse**

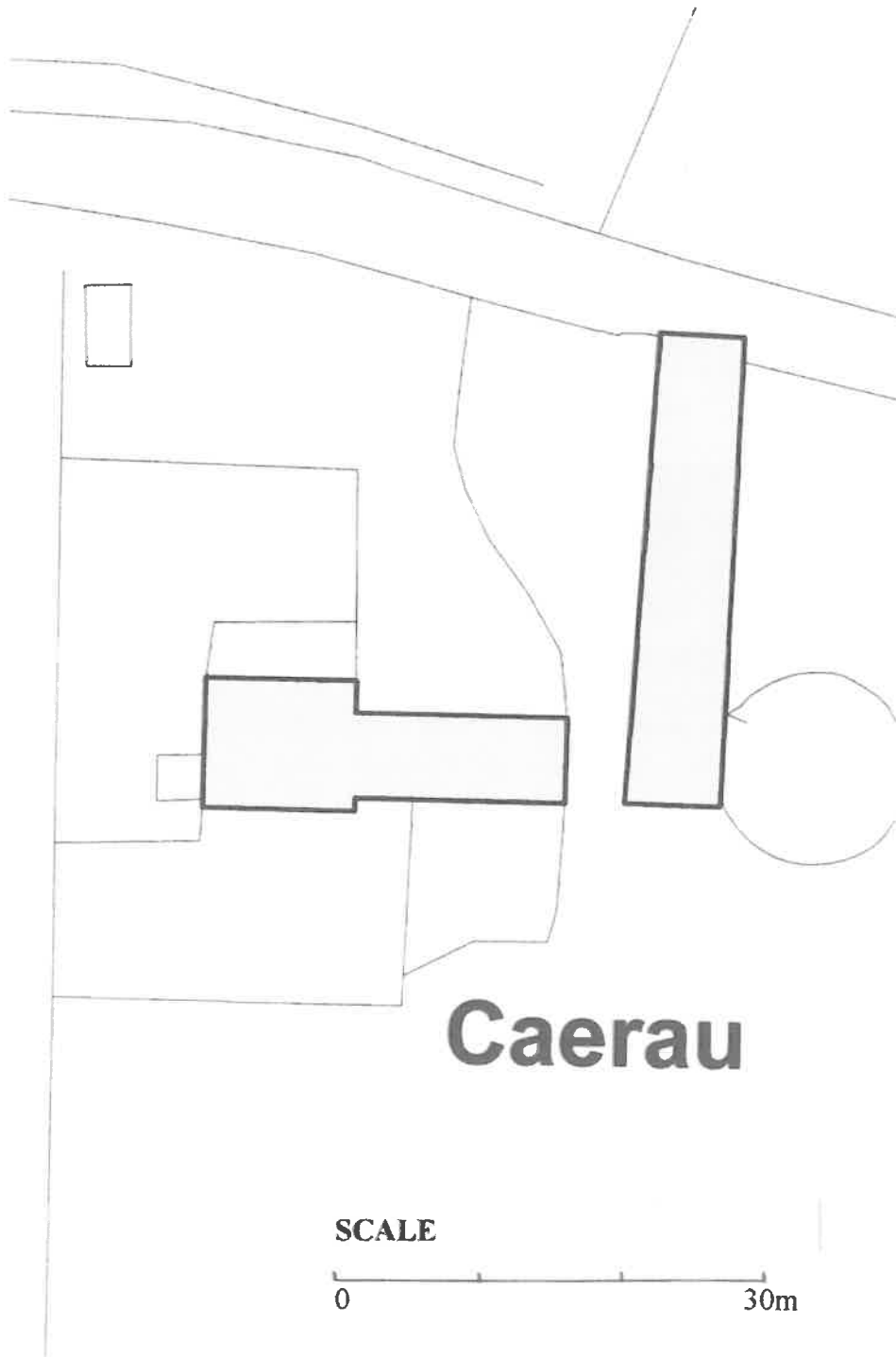

Farm No: 59

Community: Pencaer

Farm Name: Caerau Farm Plot 2 – see previous page

Permission:

Owner home ☐ no      Permission given ☐      Viewed from road only ☐ yes



Typical view of farm

Number of traditional farm buildings/ ranges: 1

Description:

Design Features:

Listed or Scheduled Ancient Monument status: none

Historical/ archaeological value: average/none

Approximate age: mid 19<sup>th</sup> C/ modern

Landscape value: average

Current use: converted

Access: good

Condition: v. good

Major constructional problems:

Owners attitude if determined:

|   |  |  |                |   |
|---|--|--|----------------|---|
| Awaiting<br>funding/<br>conversion/ part<br>converted | Positive<br>towards<br>alternative<br>uses | Interested in<br>buildings and<br>their future | Not interested | Not<br>applicable/<br>Busy/ not<br>home |
|---|--|--|----------------|---|

|                          |                          |                          |                          |                                       |
|--------------------------|--------------------------|--------------------------|--------------------------|---------------------------------------|
| <input type="checkbox"/> | <input type="checkbox"/> | <input type="checkbox"/> | <input type="checkbox"/> | <input checked="" type="checkbox"/> x |
|--------------------------|--------------------------|--------------------------|--------------------------|---------------------------------------|

Additional comments:

Difficult to determine where farmhouse and plot 2 divide externally and date.

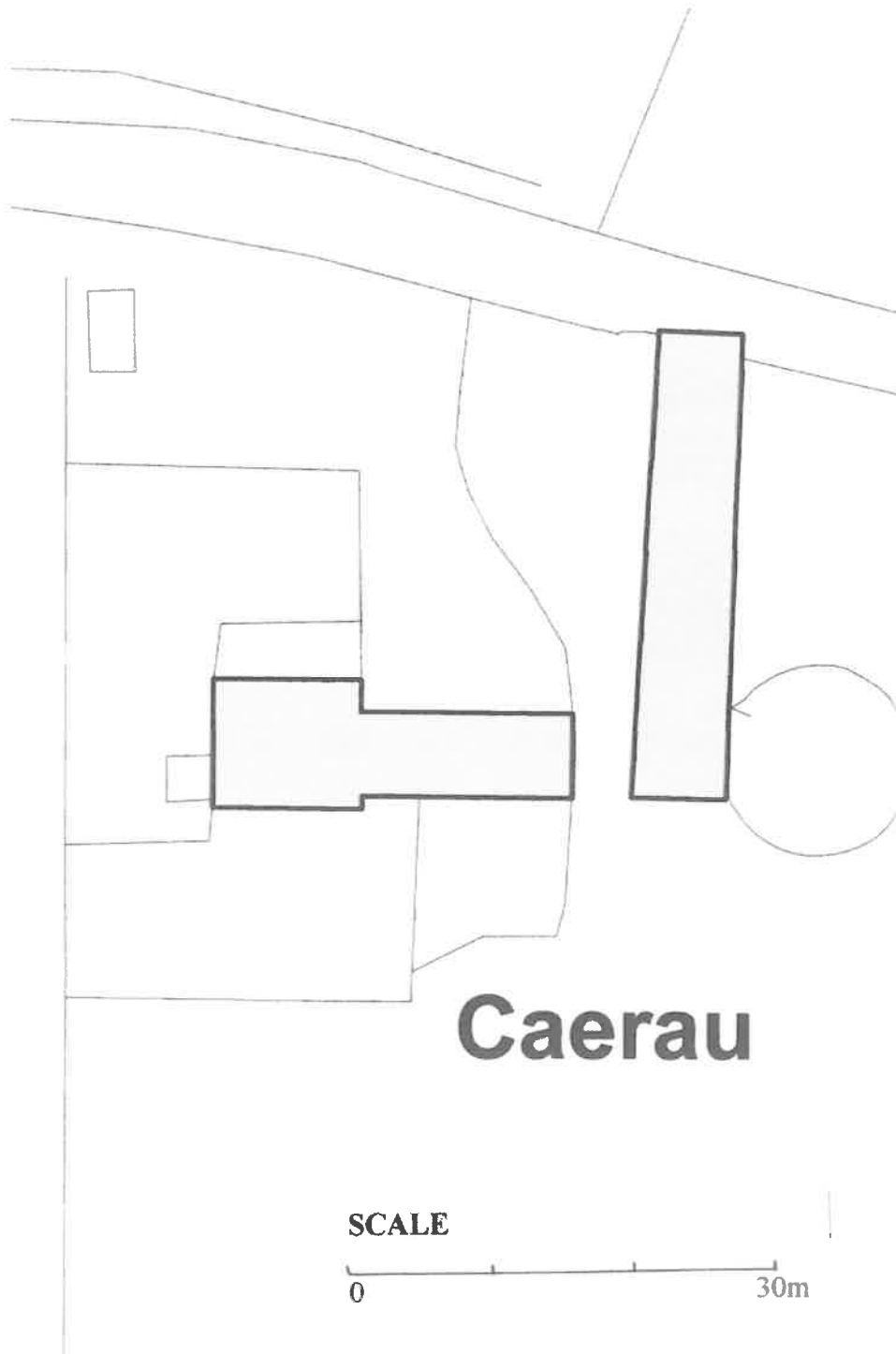

**Farm No: 60**

**Community: Pencaer**

**Farm Name: Caersegan**

Permission:

Owner home ☐ yes      Permission given ☐ no      Viewed from road only ☐

Typical view of farm

Number of traditional farm buildings/ ranges:

Description:

Design Features:

Listed or Scheduled Ancient Monument status: none

Historical/ archaeological value:      Approximate age:

Landscape value:

Current use:

Access:

Condition:

Major constructional problems:

Owners attitude if determined:

|   |  |   |                |                                   |
|---|--|---|----------------|-----------------------------------|
| Awaiting<br>funding/<br>conversion/ part<br>converted | Positive<br>towards<br>alternative<br>uses | Interested in buildings and<br>their future | Not interested | Not applicable/<br>Busy/ not home |
|---|--|---|----------------|-----------------------------------|

|  |  |  |  |  |
|--|--|--|--|--|
|  |  |  |  |  |
|--|--|--|--|--|

Additional comments:

Farm No: 61

Community: Pencaer

Farm Name: Cranged farm

Permission:

Owner home ☐ yes      Permission given ☐ yes      Viewed from road only ☐



Typical view of farm

Number of traditional farm buildings/ ranges: 1

Description:

Design Features:

Listed or Scheduled Ancient Monument status: none

Historical/ archaeological value: none

Approximate age: 19<sup>th</sup> C

Landscape value: average

Current use: storage/ redundant and unknown

Access: good

Condition: very good

Major constructional problems: roofs not inspected

Owners attitude if determined:

|   |  |   |                |                                   |
|---|--|---|----------------|-----------------------------------|
| Awaiting<br>funding/<br>conversion/ part<br>converted | Positive<br>towards<br>alternative<br>uses | Interested in buildings and<br>their future | Not interested | Not applicable/<br>Busy/ not home |
|---|--|---|----------------|-----------------------------------|

|   |  |  |  |  |
|---|--|--|--|--|
| x |  |  |  |  |
|---|--|--|--|--|

Additional comments:

**Farm No: 62**

**Community: Pencaer**

**Farm Name: Ffynnonruidion**

Permission:

Owner home ☐ no      Permission given ☐      Viewed from road only ☐ yes



Typical view of farm

Number of traditional farm buildings/ ranges: 3

Description: L shaped arrangement, repaired over the years with blockwork infill

Design Features:

Listed or Scheduled Ancient Monument status: none

Historical/ archaeological value: v. important      Approximate age: mid 19<sup>th</sup> C

Landscape value: good

Current use: unknown

Access: good

Condition: not good condition

Major constructional problems: roofs not inspected

Owners attitude if determined:

|   |  |   |                |                                   |
|---|--|---|----------------|-----------------------------------|
| Awaiting<br>funding/<br>conversion/ part<br>converted | Positive<br>towards<br>alternative<br>uses | Interested in buildings and<br>their future | Not interested | Not applicable/<br>Busy/ not home |
|---|--|---|----------------|-----------------------------------|

|                          |                          |                          |                          |                                       |
|--------------------------|--------------------------|--------------------------|--------------------------|---------------------------------------|
| <input type="checkbox"/> | <input type="checkbox"/> | <input type="checkbox"/> | <input type="checkbox"/> | <input checked="" type="checkbox"/> X |
|--------------------------|--------------------------|--------------------------|--------------------------|---------------------------------------|

Additional comments:

**Farm No: 63**

**Community: Penciaer**

**Farm Name: Llemair - could not find**

Permission:

Owner home ☐ Permission given ☐ road only ☐ Viewed from ☐

Typical view of farm

Number of traditional farm buildings/ ranges:

Description:

Design Features:

Listed or Scheduled Ancient Monument status:

Historical/ archaeological value:      Approximate age:

Landscape value:

Current use:

Access:

Condition:

Major constructional problems:

Owners attitude if determined:

|   |  |   |                |                                   |
|---|--|---|----------------|-----------------------------------|
| Awaiting<br>funding/<br>conversion/ part<br>converted | Positive<br>towards<br>alternative<br>uses | Interested in buildings and<br>their future | Not interested | Not applicable/<br>Busy/ not home |
|---|--|---|----------------|-----------------------------------|

|                      |                      |                      |                      |                      |
|----------------------|----------------------|----------------------|----------------------|----------------------|
| <input type="text"/> | <input type="text"/> | <input type="text"/> | <input type="text"/> | <input type="text"/> |
|----------------------|----------------------|----------------------|----------------------|----------------------|

Additional comments:

**Farm No: 64**

**Community: Pencaer**

**Farm Name: Llys y Onnen- could not find**

Permission:

Owner home ☐ Permission given ☐ road only ☐ Viewed from ☐

Typical view of farm

Number of traditional farm buildings/ ranges:

Description:

Design Features:

Listed or Scheduled Ancient Monument status:

Historical/ archaeological value:      Approximate age:

Landscape value:

Current use:

Access:

Condition:

Major constructional problems:

Owners attitude if determined:

|   |  |  |                |   |
|---|--|--|----------------|---|
| Awaiting<br>funding/<br>conversion/ part<br>converted | Positive<br>towards<br>alternative<br>uses | Interested in<br>buildings and<br>their future | Not interested | Not<br>applicable/<br>Busy/ not<br>home |
|---|--|--|----------------|---|

|                      |                      |                      |                      |                      |
|----------------------|----------------------|----------------------|----------------------|----------------------|
| <input type="text"/> | <input type="text"/> | <input type="text"/> | <input type="text"/> | <input type="text"/> |
|----------------------|----------------------|----------------------|----------------------|----------------------|

Additional comments:



**Farm No: 65**

**Community: Pencaer**

**Farm Name: Llysawel**

Permission:

Owner home ☐ yes      Permission given ☐ yes      Viewed from road only ☐



Typical view of farm

Number of traditional farm buildings/ ranges: **none**

Description:

Design Features:

Listed or Scheduled Ancient Monument status: none

Historical/ archaeological value:      Approximate age:

Landscape value:

Current use:

Access:

Condition:

Major constructional problems:

Owners attitude if determined:

|   |  |  |                |   |
|---|--|--|----------------|---|
| Awaiting<br>funding/<br>conversion/ part<br>converted | Positive<br>towards<br>alternative<br>uses | Interested in<br>buildings and<br>their future | Not interested | Not<br>applicable/<br>Busy/ not<br>home |
|---|--|--|----------------|---|

|                      |                      |                      |                      |                      |
|----------------------|----------------------|----------------------|----------------------|----------------------|
| <input type="text"/> | <input type="text"/> | <input type="text"/> | <input type="text"/> | <input type="text"/> |
|----------------------|----------------------|----------------------|----------------------|----------------------|

Additional comments:

Farm No: 66

Community: Pencaer

Farm Name: Trefayog Farm

Permission:

Owner home ☐ yes      Permission given ☐ yes      Viewed from road only ☐



Typical view of farm

Number of traditional farm buildings/ ranges: 4

Description: Model farm U shaped arrangement with additional building also

Design Features: Brick headed windows. House does not look over courtyard but is separated from it by the buildings. Part grouted roof to outbuilding.

Listed or Scheduled Ancient Monument status: none

Historical/ archaeological value: good example

Approximate age: mid 19<sup>th</sup> C

Landscape value: important

Current use: 2 farming, 1 storage, 1 garage

Access: reasonable

Condition: good

Major constructional problems: roofs not inspected

Owners attitude if determined:

| Awaiting<br>funding/<br>conversion/ part<br>converted | Positive<br>towards<br>alternative<br>uses | Interested in<br>buildings and<br>their future | Not interested           | Not<br>applicable/<br>Busy/ not<br>home |
|---|--|--|--------------------------|---|
| <input type="checkbox"/>                              | <input type="checkbox"/>                   | <input checked="" type="checkbox"/>            | <input type="checkbox"/> | <input type="checkbox"/>                |

Additional comments:

**Farm No: 67**

**Community: Pencaer**

**Farm Name: Trefelgarn**

Permission:

Owner home ☐ yes ☐ no      Permission given ☐ yes ☒ no      Viewed from road only ☐ yes ☐ no

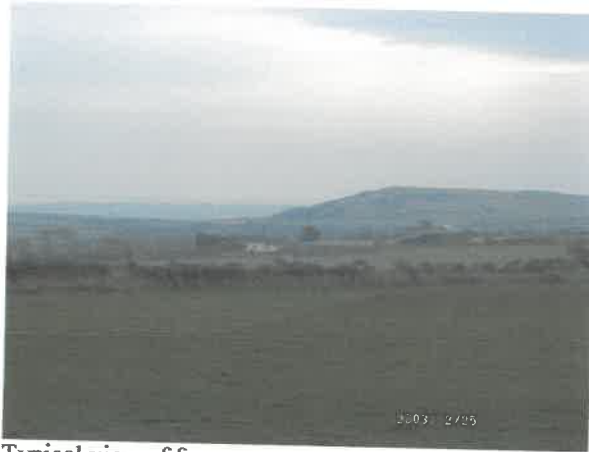

Typical view of farm

Number of traditional farm buildings/ ranges: 1

Description:

Design Features:

Listed or Scheduled Ancient Monument status:

Historical/ archaeological value:      Approximate age:

Landscape value:

Current use:

Access:

Condition:

Major constructional problems: roofs not inspected

Owners attitude if determined:

|   |  |  |                |   |
|---|--|--|----------------|---|
| Awaiting<br>funding/<br>conversion/ part<br>converted | Positive<br>towards<br>alternative<br>uses | Interested in<br>buildings and<br>their future | Not interested | Not<br>applicable/<br>Busy/ not<br>home |
|---|--|--|----------------|---|

|                      |                      |                      |                      |                      |
|----------------------|----------------------|----------------------|----------------------|----------------------|
| <input type="text"/> | <input type="text"/> | <input type="text"/> | <input type="text"/> | <input type="text"/> |
|----------------------|----------------------|----------------------|----------------------|----------------------|

Additional comments:

**Farm No: 68****Community: Pencaer****Farm Name: Trellys y Coed**

Permission:

Owner home ☐ yes      Permission given ☐ yes      Viewed from road only ☐



Typical view of farm

Number of traditional farm buildings/ ranges: 1

Description:

Design Features:

Listed or Scheduled Ancient Monument status: none

Historical/ archaeological value: none      Approximate age: 19<sup>th</sup> C

Landscape value: none

Current use: under conversion/ converted

Access: good

Condition: very good

Major constructional problems: none

Owners attitude if determined:

|   |  |  |                |   |
|---|--|--|----------------|---|
| Awaiting<br>funding/<br>conversion/ part<br>converted | Positive<br>towards<br>alternative<br>uses | Interested in<br>buildings and<br>their future | Not interested | Not<br>applicable/<br>Busy/ not<br>home |
|---|--|--|----------------|---|

|   |  |  |  |  |
|---|--|--|--|--|
| x |  |  |  |  |
|---|--|--|--|--|

Additional comments:

**Farm No: 68**

**Community: Pencaer**

**Farm Name: Trellys y Coed**

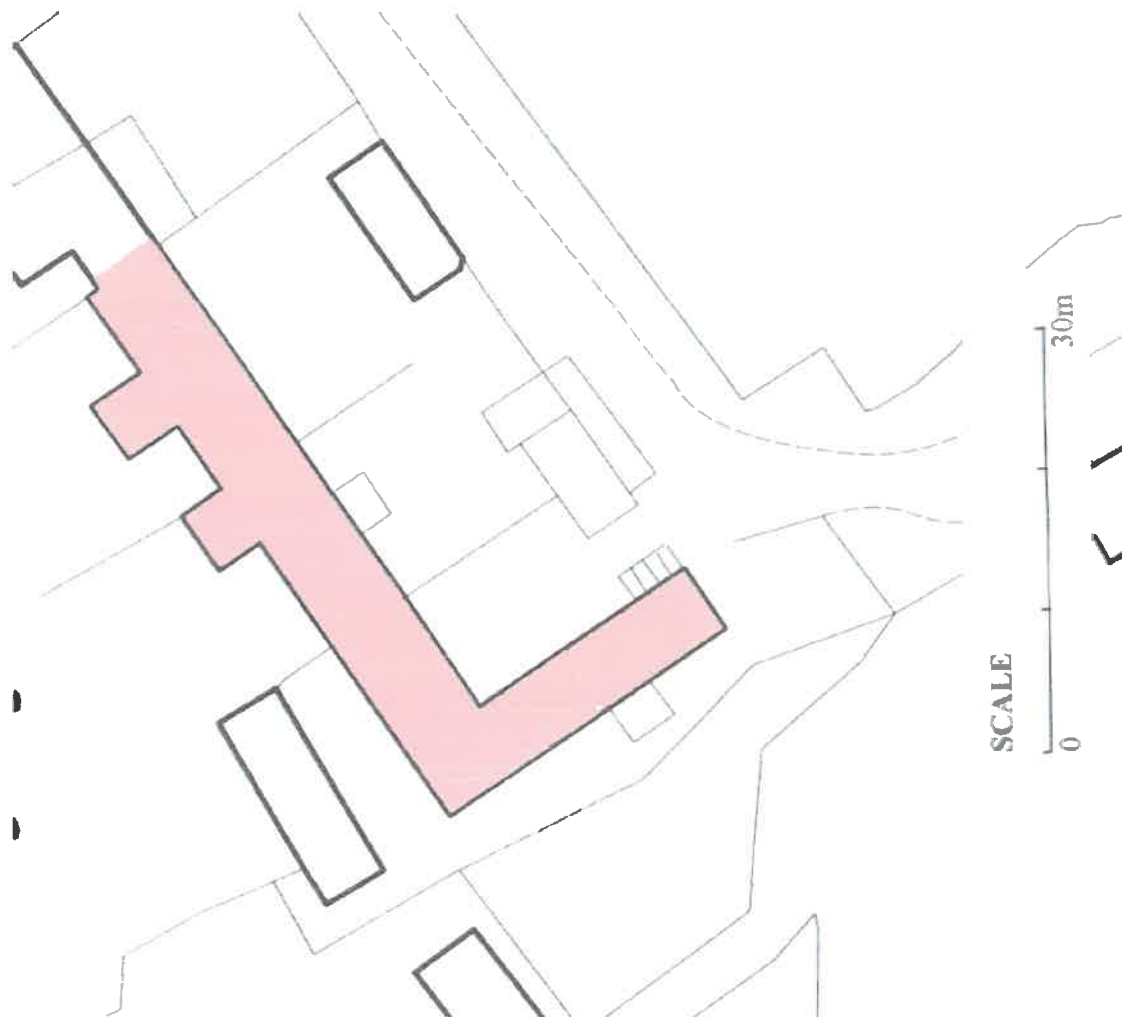

**Farm No: 69**

**Community: Pencaer**

**Farm Name: Ville Delmare – could not find**

Permission:

Owner home ☐ Permission given ☐ Viewed from road only ☐

Typical view of farm

Number of traditional farm buildings/ ranges:

Description:

Design Features:

Listed or Scheduled Ancient Monument status:

Historical/ archaeological value:                      Approximate age:

Landscape value:

Current use:

Access:

Condition:

Major constructional problems: roofs not inspected

Owners attitude if determined:

| Awaiting<br>funding/<br>conversion/ part<br>converted | Positive<br>towards<br>alternative<br>uses | Interested in<br>buildings and<br>their future | Not interested           | Not<br>applicable/<br>Busy/ not<br>home |
|---|--|--|--------------------------|---|
| <input type="checkbox"/>                              | <input type="checkbox"/>                   | <input type="checkbox"/>                       | <input type="checkbox"/> | <input type="checkbox"/>                |

Additional comments:

**Farm No: 70**

**Community: Pencaer**

**Farm Name: Ynys Deullyn – could not find**

Permission:

Owner home ☐ Permission given ☐ Viewed from road only ☐

Typical view of farm

Number of traditional farm buildings/ ranges:

Description:

Design Features:

Listed or Scheduled Ancient Monument status:

Historical/ archaeological value:      Approximate age:

Landscape value:

Current use:

Access:

Condition:

Major constructional problems: roofs not inspected

Owners attitude if determined:

|   |  |  |                |   |
|---|--|--|----------------|---|
| Awaiting<br>funding/<br>conversion/ part<br>converted | Positive<br>towards<br>alternative<br>uses | Interested in<br>buildings and<br>their future | Not interested | Not<br>applicable/<br>Busy/ not<br>home |
|---|--|--|----------------|---|

|                          |                          |                          |                          |                          |
|--------------------------|--------------------------|--------------------------|--------------------------|--------------------------|
| <input type="checkbox"/> | <input type="checkbox"/> | <input type="checkbox"/> | <input type="checkbox"/> | <input type="checkbox"/> |
|--------------------------|--------------------------|--------------------------|--------------------------|--------------------------|

Additional comments: