

Head of Planning
Carmarthenshire County Council
Planning Department
Ty Elwyn
Llanelli
SA15 3AP



The Planning Studio, Hayston Bridge
Johnston, Haverfordwest
Pembrokeshire SA62 3HJ
01437 891 817
07515 851 704
andrew@haystonplanning.co.uk
www.planningpembrokeshire.co.uk

5th January 2021

Dear Sir / Madam,

**Proposed Discharge of Condition 11 of Planning Permission PL/00209 for
Alteration of South Barn to a holiday let - Allt Fawr, Llanon, Llanelli,
Carmarthenshire SA14 8JX**

Decision Notice: PL/00209

Proopsal: Farm Diversification Proposal for the Conversion and Alteration of an Existing Barn to a Holiday Unit

Location: Allt Fawr, Llanon, Llanelli, Carmarthenshire, SA14 8JX

Application Type: Full Planning Permission

Applicant: Mrs Sally-Ann Sheen

Granted: 12/11/2020

Condition 11.

Development shall not begin until a photographic survey of the existing building has been carried out in accordance with guidelines provided by the Local Planning Authority's archaeological advisors – Dyfed Archaeological Trust Development Management. The resulting photographs should be submitted to and approved in writing by the local planning authority prior to the commencement of development and deposited with the regional Historic Environment Record, held and maintained by the Dyfed Archaeological Trust, Corner House, 6 Carmarthen Street, Llandeilo, Carmarthenshire, SA19 6AE, (Tel 01558-823121).

Reason:

To ensure adequate photo records are available for the building given it is of historical interest.

1.0 INTRODUCTION

1.1 Hayston Developments & Planning Ltd has been engaged by Mrs Sally-Ann Sheen to submit details to discharge condition 11 of full planning permission PL/00209 which was granted consent on 12th November 2020.

1.2 Condition 11 requires a photographic survey to be undertaken of the existing buildings (in accordance with Dyfed Archaeological Trust Development Management). A copy of this

submission has been sent to Dyfed Archaeological Trust, Corner House, 6 Carmarthen St, Llandeilo, Carmarthenshire, SA19 6AE. Appendix A contains these photographic survey Images (which are referenced) together with a drawing (plan) of the detailed location of each of these photographs. This cover letter also, however, contains all the photos as larger images and the electronic copies were downloaded as part of the submission (via planning portal) and a disc sent to Dyfed Archaeological Trust.

1.3 It should be noted that planning permission was granted at the same time (ref: PL/00345) for the 'Conversion of a barn for ancillary family accommodation (annex)' at Allt Fawr and the same condition imposed (on Condition 5). As such, a discharge of condition application has also been submitted for this and the same photographic survey included and copied to Dyfed Archaeological Trust.

1.4 To support this application the following documentation has therefore been submitted:-

- **Cover Letter** (this document)
- **Drawing 584/205: Location Plan**
- **Appendix A Photographic Survey**
 - Copies of Photographs (a disc also sent to DAT)
 - Drawing 01A - A3 Photographic Key Plan_References Barn A (for PL/00209)
- **Planning Fee: £115.00**



Above - Aerial photograph of application site (Source: Google Maps)



General setting of the planning permissions PL/00209 for alteration of South Barn to a holiday let (in the foreground) and planning permission PL/00345 for conversion of North Barn for ancillary family accommodation (annex) (to the rear)



View of south-east elevation and north-east gable end (A1)



View of the south-east elevation and showing free standing stonework (A2)



South-east elevation showing brick inserts and freestanding stonework (A3)



View of south-east elevation and shed extension on south-west elevation (A4)



South-west elevation showing subsequent shed extension (A5)



*Gable end with shed extension
Shows freestanding stonework on south-east elevation (A6)*



View of north-west elevation with side shed and of gable end with stone extension (north-east elevation) (A7)



View of part of north-west elevation with side extension (A8)



View of north-east elevation – gable end (A9)



Interior view looking north-west (A10)



Interior view looking south-east (A11)

Should you require any further information please do not hesitate to contact this office.

Yours sincerely,

MARTIN BELL BA MRTPI (RETIRED)
SENIOR PLANNER

ANDREW VAUGHAN-HARRIES
CHARTERED TOWN PLANNER BSC (HONS) DIP TP MRTPI



RTPI

mediation of space · making of place

Appendix A

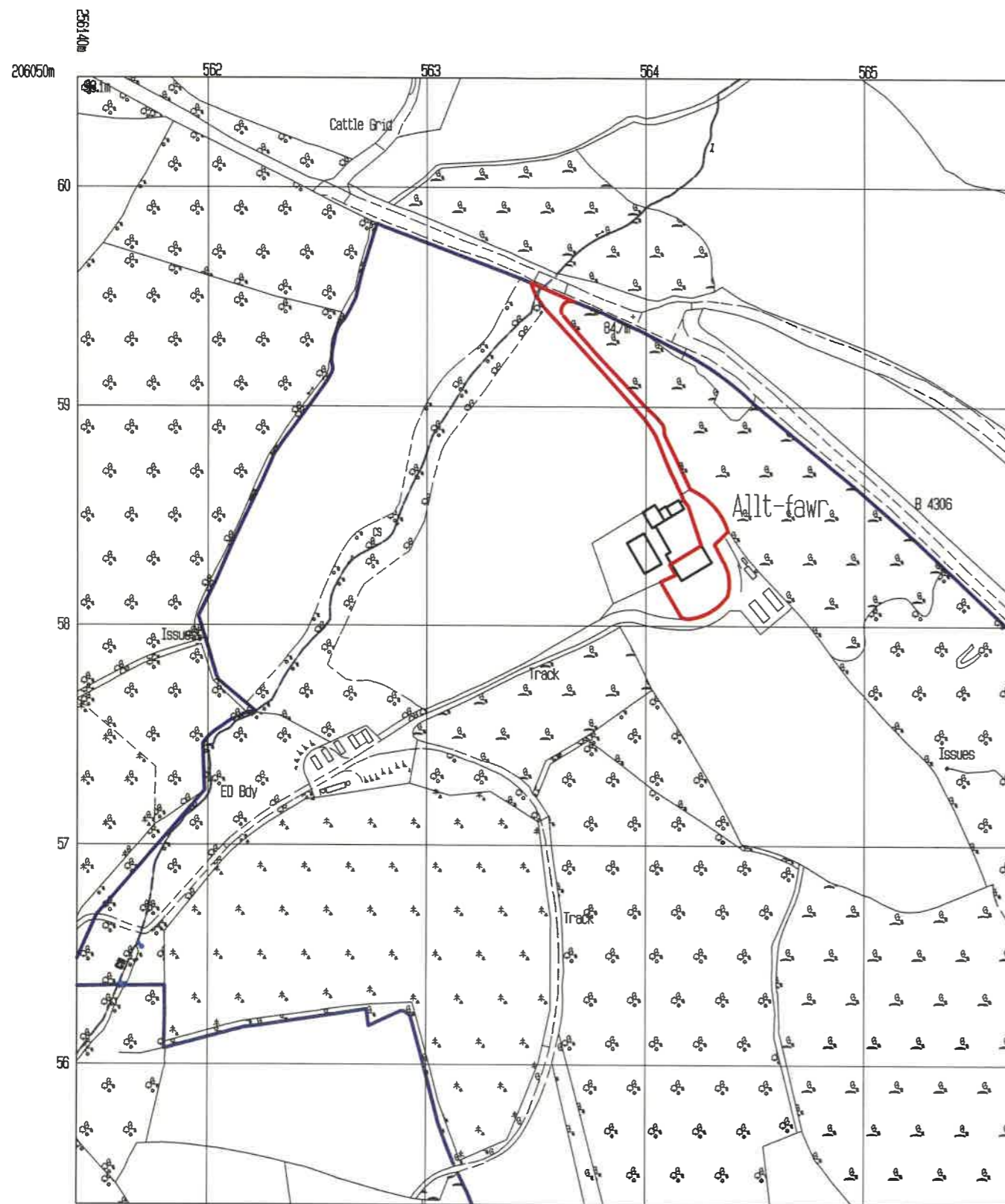

20 0 20 40 60 80 100
Metres

© Crown copyright and database rights 2019 OS 100035409
Reproduction in whole or in part is prohibited
without the permission of Ordnance Survey.



Location Plan, Allt fawr, Llannon, Llanelli SA14 8JX

Amendments

Gordon Russell
Chartered Architect

Mount Pleasant, Llwynteg, Llannon,
Llanelli, Carm. SA14 8JW
Tel : 01269 845192

Project
Barn Conversion at
Allt fawr, Llannon, Llanelli

Drawing : Revision
Location Plan
584/205

Scale
1:2500 @ A3

Appendix A: Photos for Proposed Discharge of Conditions 11 & 5 of Planning Permission PL/00209 (A1-11) & PL/00345 (B1-14) Respectively (Applicant – Mrs Sally-Ann –Sheen)



A1 - se elev and ne gable



A2 - se elev



A3 - se elev



A4 - se elev and shed sw elev



A5 - sw elev



A6 - gable end se elev



A7 - nw elev



A8 - nw elev



A9 - ne elev



A10 - interior looking nw



A11 - interior looking se



B1 - sw elev



B2 - sw and se elevs



B3 - se elev



B4 - se elev



B5 - se elev



B6 - se and ne elevs



B7 - ne elev



B8 - ne and nw elevs



B9 - nw elev



B10 - nw elev



B11 - nw elev



B12 - stone extension nw elev



B13 - interior facing sw



B14 - interior facing ne

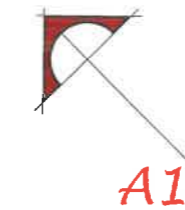
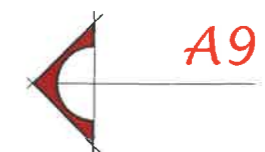
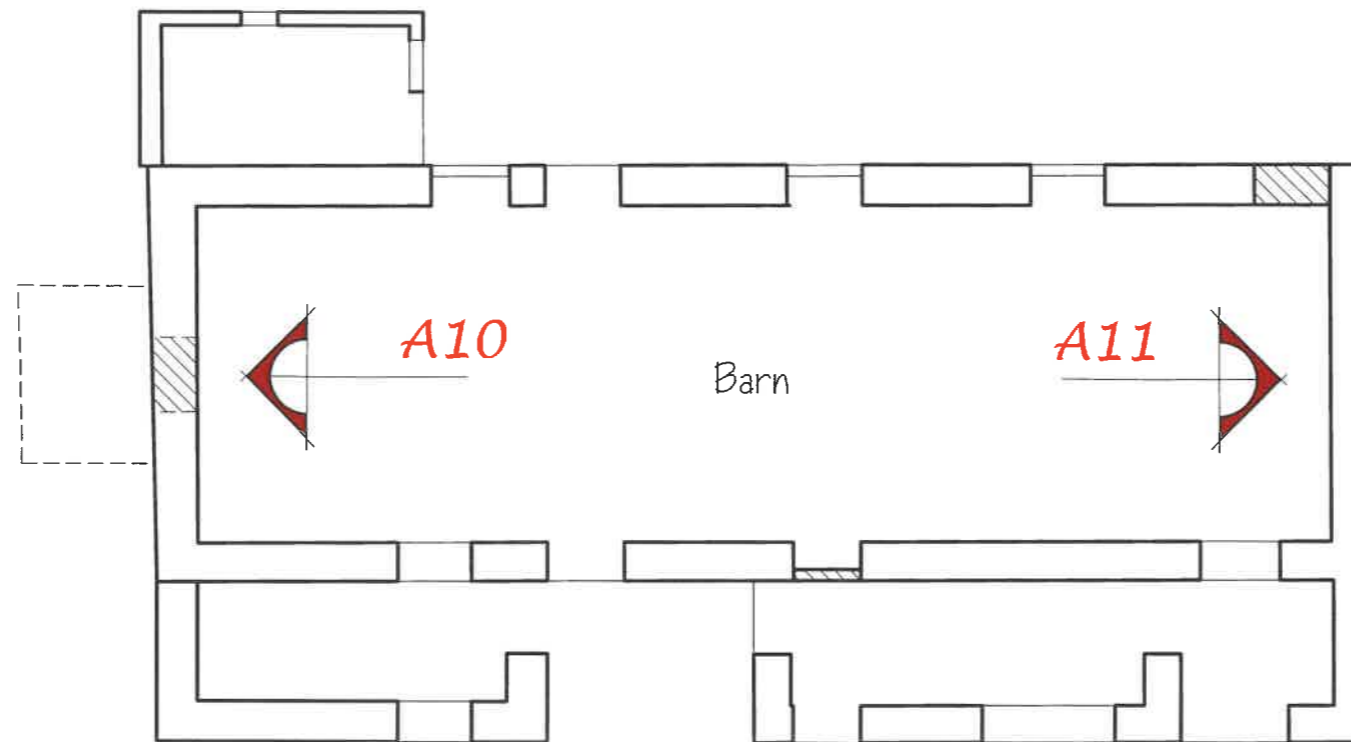
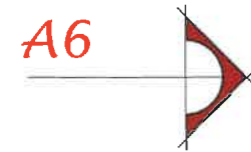
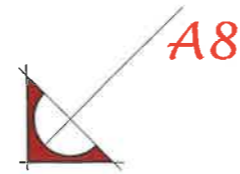
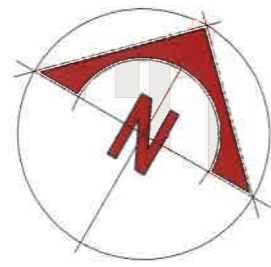

Floor Plan - Barn A



The Planning Studio, Hayston Bridge
Johnston, Haverfordwest
Pembrokeshire SA62 3HJ
01437 891 817
07515 851 704
andrew@haystonplanning.co.uk
www.planningpembrokeshire.co.uk

**Farm Diversification Proposal for the Conversion and Alteration of
Existing Barns to Holiday Let - Condition 11 of PL/00209
Allt Fawr, Llannon, Llanelli**

Designed by

Checked by

File name
AVH_694

Date
06.12.2020

Scale
A3 @ 1:100

Client

Mr & Mrs Sheen

Drawing Title

Key Plan to Photographic Survey - Barn A

Dwg No.

01a