



# Land at Berthela, Pont Creuddyn, Lampeter, Ceredigion

## Archaeological Watching Brief



*By*

Richard Scott Jones (*BA, MA, MCIfA*)

November 2020

HRS Wales  
Report No: 224

# ARCHAEOLOGICAL WATCHING BRIEF

## Land at Berthela, Pont Creuddyn, Lampeter, Ceredigion

By  
Richard Scott Jones (*BA Hons, MA, MCIfA*)

*Prepared for:*

Miss H Nutting,  
Berthela,  
Creuddyn Bridge,  
Lampeter,  
Ceredigion, SA48 8BL

*On behalf of:*

*Date:* November 2020

HRSW Report No: 224



## Contents

### *i) List of Illustrations and Photo plates*

Non Technical Summary.....	Page 01
1. Introduction .....	Page 02
2. Aims & Objectives .....	Page 03
3. Methodology .....	Page 04
4. Cartographic Sources .....	Page 04
5. Results of Watching Brief .....	Page 05
6. Conclusions .....	Page 07
7. Acknowledgements .....	Page 07
8. Bibliography .....	Page 08

Appendix I: Figures

Appendix II: Photo plates

Appendix III: Context Register

Appendix IV: Archive Cover Sheet

### **Copyright Notice:**

*Heritage Recording Services Wales retain copyright of this report under the Copyright, Designs and Patents Act, 1988, and have granted a licence to the Nutting family to use and reproduce the material contained within.*

*The Ordnance Survey have granted Heritage Recording Services Wales a Copyright Licence (No. 100052823) to reproduce map information; Copyright remains otherwise with the Ordnance Survey.*

## **i) List of Illustrations**

### **Figures**

- Fig 01: Location map (OS 1:50,000 Landranger)
- Fig 02: Location map (OS 1:25,000 Explorer)
- Fig 03: OS Aerial Photo and proposed development areas.
- Fig 04: Site Block Plan - Existing.
- Fig 05: Site Block Plan - Proposed.
- Fig 06: OS Surveyors Drawing (1819)
- Fig 07: Tithe Map (1846).
- Fig 08: Historic OS Maps (1889 - 1953)
- Fig 09: Site Block Plan - Area of proposed stripping.
- Fig 10: Menage Ground Plan - Results
- Fig 11: Post-hole in Menage Area.
- Fig 12: Stable Ground Plan - Results.

### **Photo Plates**

- Plates 01: Area of proposed Menage prior to groundwork.
- Plates 02 - 03: Working shots during turf and top soil strip - Stable building.
- Plates 04 - 09: Stable building area.
- Plates 10 - 11: Working shots during turf and top soil strip - Menage.
- Plates 12 - 16: Working shots during turf and top soil strip - Menage.
- Plates 17 - 18: Post-hole - Menage area.
- Plate 19: Menage area following stripping and excavation.



## **Non Technical Summary**

*The following report presents the results of a program of archaeological works and mitigation undertaken during groundwork for a stable building and menage/sand on land attached to Berthela, Creuddyn Bridge, Lampeter, Ceredigion (NGR: SN 5538 5340).*

*The specific objective of this work was to undertake an archaeological watching brief during groundwork for the proposed development of a stable building and a ménage/sand for private use.*

*The archaeological watching brief during groundwork for the proposed development on land attached to Berthela, near Pont Creuddyn, Lampeter, Ceredigion, exposed no archaeological finds, features or deposits of any significance during groundwork in the area of the proposed stable building at the far north end of the farmstead. The top soil in this area was fairly shallow and the sub soil was a natural clay and shale, Dateable finds recovered in this area included 20<sup>th</sup> and late 19<sup>th</sup> century pottery and glass fragments and plastic.*

*However, the groundwork for the proposed ménage area at the far west end of the Berthela farm did manage to expose a potentially significant post-hole located at the far north end of the cleared area. Unfortunately, excavation of this post-hole did not manage to recover any dateable material from within its fill, which consisted of clayey sand and stones. As a precaution the immediate 20 meters or so surrounding this post-hole was investigated closely for evidence of any further post-holes, however none were found. This would suggest that this post-hole is either just a lone feature, or else any other potential post-holes were very discrete and not observed during the stripping exercise. Given the fact that there was no evidence for any post-hole observed within the top soil for this feature, would suggest that it is early in date, possibly prehistoric, and given that there are records within the HER that suggest the presence of several undated cropmark enclosures in close proximity to the development area (PRN's 6042, 6043 and 6044), thought to be possibly prehistoric, then there is a possibility that this post-hole is contemporary in date to these cropmark features. As such, it is recommended that any future proposed development within the immediate landscape of this post-hole and the possibly associated cropmark features, is undertaken under archaeological supervision.*

*Other than this post-hole in the ménage area, no other significant archaeological finds, features and deposits became exposed during the groundwork at the site.*

## 1 Introduction

- 1.1 The following report presents the results of a program of archaeological works and mitigation undertaken during groundwork for a stable building and menage/sand on land attached to Berthela, Creuddyn Bridge, Lampeter, Ceredigion (NGR: SN 5538 5340).
- 1.2 The specific objectives of this work were to:
- Undertake an archaeological watching brief during groundwork for the proposed development of a stable building and a ménage/sand.
- 1.3 The Technical Appendices for this report contains the following information:
- Appendix I: Figures;*  
*Appendix II: Photographs*  
*Appendix III: Finds Register*  
*Appendix IV: Archive Cover Sheet*

### **Site Location & Description** (see Figures 1 - 4)

- 1.4 The proposed development area is positioned on agricultural land attached to a small holding known as Berthela, approximately 4km northwest of Llanbedr pont Stefan (Lampeter) and 1km northeast of Pont Creuddyn, Ceredigion (NGR: SN 5538 5340). The site lies at a height of approximately 220 meters AOD.
- 1.5 The proposed stable building is to be positioned within an enclosed field to the north of Berthela, and the ménage/sand area immediately to the west.

### **Development Proposals**

- 1.6 The proposed development consists of the erection of a stable building and a menage/sand school for private use only. The proposed stables will be located on land to the north of the existing small holding and comprise 4 stables with a tack/equipment & hay storage. It will measure 18m by 12m and 3.6m to eaves height and 5m to eaves height. The walls will be finished with concrete panels up to 1.8m high with box profile sheeting above, and corrugated fibre cement roof. It will have large double doors to each side end.
- 1.7 The proposed ménage/sand school will be located to the west of the small holding and will measure 20m by 60m and will have an all-weather surface with a timber post and rail fence measuring 1.35m in height around to enclose it.

### **Planning Background**

- 1.8 On 4<sup>th</sup> August 2020 planning permission was granted by Ceredigion County Council to carry out the proposed development, but with the following archaeological and heritage conditions (No. 5):

Condition 5:

*No development shall take place until a qualified and competent archaeologist has submitted a written scheme of investigation (WSI) for approval in writing by the local planning authority. This WSI will describe the different stages of the work and demonstrate that it has been fully resourced and given adequate time. On behalf of the local planning authority, their archaeological advisors (DAT DM) will monitor all aspects of this work through to the final discharging of the condition. This work will not be deemed complete until all aspects of the WSI have been addressed and the final report submitted and approved.*

**Reason:** To protect historic environment interests whilst enabling development"

- 1.9 HRS Wales were commissioned to undertake this archaeological work.

**Historical & Archaeological Background** (see Figures 5 - 7)

- 1.10 The Regional Historic Environment Record search undertaken by the Dyfed Archaeological Trust revealed that the site in question lies within close proximity to several cropmark enclosures, which although currently undated, may represent prehistoric burial monuments (PRN's 6042, 6043 and 6044). These types of features are often found in groups and consequently further examples may survive as buried deposits on site. Therefore it is possible that buried archaeological features may extend into the application area and become damaged or destroyed by the proposed development.

**Geology**

- 1.17 The application area is positioned within an area of Undifferentiated Llandovery Rocks consisting of Mudstone, Siltstone and Sandstone.

## **2 Aims & Objectives**

- 2.1 The aims of the watching brief, as defined by the ClfA (2014) are:
- to allow, within the resources available, the preservation by record of archaeological deposits, the presence and nature of which could not be established (or established with sufficient accuracy) in advance of development or other potentially disruptive works;
  - to provide an opportunity, if needed, for the watching archaeologist to signal to all interested parties, before the destruction of the material in question, that an archaeological find has been made for which the resources allocated to the watching brief itself are not sufficient to support treatment to a satisfactory and proper standard.
- 2.2 The watching brief is not intended to reduce the requirement for excavation or preservation of known or inferred deposits, and it is intended to guide, not replace, any requirement for contingent excavation or preservation of possible deposits.
- 2.3 The objective of the watching brief is to establish and make available information about the archaeological resource existing on the site.

### 3 Methodology

#### *Watching Brief*

- 3.1 The archaeological watching brief was undertaken by HRS Wales staff using current best practice on 26<sup>th</sup> October 2020.
- 3.2 All work was carried out by a suitably qualified archaeologist with relevant level membership of the Chartered Institute for Archaeologists (CIfA) and followed the CIfA Standard and Guidance for an archaeological watching brief (CIfA 2014).
- 3.3 All proposed groundwork was undertaken under close and constant archaeological supervision. All groundwork by the contractor was undertaken using a mechanical digger with a toothless grading bucket.
- 3.4 All archaeological deposits or features when encountered were cleaned, recorded and partially excavated. All finds recovered during the watching brief were bagged and where considered necessary a grid coordinate was taken using a handheld GPS device in order to locate the find-spot with the OS national grid.
- 3.5 Recording was carried out using HRS Wales recording systems (pro-forma context sheets etc), using a continuous number sequence for all contexts.
- 3.6 Where considered necessary plans and sections were drawn to a scale of 1:50, 1:20 and 1:10 as required and related to Ordnance Survey datum and published boundaries where appropriate.
- 3.7 All features identified were tied in to both the OS National Grid and all local site and ground plans.
- 3.8 Photographs were appropriated in digital format, using both a 24 mega-pixel DSLR camera in RAW format, to be exported later to TIFF format for archive.

### 4 Cartographic Sources *(Figures 6 – 8)*

#### 4.1 *OS Surveyors Drawing (1819)*

- 4.2 This early Ordnance Survey drawing marks the farm of Berthela as *Perth Ela* and only the main farmhouse and another long barn are marked, all set within an enclosure.

#### 4.3 *Tithe Map and Apportionment details for Silian Parish (1846)*

- 4.4 The Silian parish tithe map of 1846 marks the Berthela farm as *Perthhele*. The farm's apportionment No. is 13 and the proposed development areas are marked as No's 12, 18 and 19. Fields 18 and 19 were divided at this time but these are presently one open field. According to the tithe apportionment details, the farm at this time was owned by one Evan Evans who tenanted the farm to one Evan Jones.

- 4.5 *Ordnance Survey First Edition Map (1889)*
- 4.6 The OS First Edition map shows the farm marked as Perth-hela, complete with all field boundaries. Both the main farmhouse and the long barn are marked along with a small pond at the west end of the farmyard.
- 4.7 *Ordnance Survey Second Edition Map (1906)*  
No change from the earlier map series.
- 4.8 *Ordnance 1953 Edition Map*
- 4.9 No change from the earlier map series.

## **5 Results of Watching Brief**

- 5.1 The archaeological watching brief was undertaken on the 26<sup>th</sup> November 2020. All numbers enclosed in ( ) refer to contexts encountered.

### *1) Stable Building*

- 5.2 The proposed stable building was to be located on land to the north of the existing small holding and is to comprise four stables with a tack/equipment & hay storage. The building will measure 18m by 12m and 3.6m to eaves height and 5m to eaves height. The walls will be finished with concrete panels up to 1.8m high with box profile sheeting above, and corrugated fibre cement roof. It will have large double doors to each side end. The stable building was to be constructed on top of a concrete foundation slab
- 5.3 The groundwork for the building foundation comprised the stripping of the turf and top soil. Once the turf (100) had been stripped away using a mechanical excavator with a non-toothed bucket, a mid brown sandy clay top soil (101) became exposed. A walkover of this exposed top soil managed to recover a few dateable fragments of 20<sup>th</sup> and 19<sup>th</sup> century glass and china (not retained) and plastic. Following the walkover, the top soil was then removed to expose a natural sandy/clay sub soil (102). This exposed sub soil was again examined for finds and features. No dateable finds were recovered. However, an area of organically stained soil was exposed at the west end of the area. In order to assess this apparent staining, a small evaluation trench was inserted through the highlighted area so as to gauge whether the sub soil was untouched ground or whether the staining represented a possible buried feature. This small trench revealed that the staining was in fact a natural clay and shale geological deposit (102) that was folding up into the natural sandy sub soil, which had subsequently become stained by a mound of slurry that had formerly been positioned in this location (*pers comm*).
- 5.4 Other than the 19<sup>th</sup> century pottery fragments recovered from within the top soil, no further dateable finds or features were recovered or exposed during the groundwork for the stable building.

### *2) Menage/sand*

- 5.5 The proposed menage/sand school was to be located to the west of the small holding and will measure 20m by 60m and will have an all-weather surface with a timber post and rail fence

measuring 1.35m in height around to enclose it.

- 5.6 Groundwork for the proposed ménage/sand area comprised the stripping of the turf and top soil from the entire area. Given that the area of the proposed ménage was on a slope, the groundwork comprised the stripping of both the turf and top soil from the entire area and then the excavation of the upper east side of the area and the relocating of the excavated soil to the western side, thus creating a levelled area on which to create the sand training area.
- 5.7 Once the turf (200) had been stripped away from the entire area of the proposed ménage using a mechanical excavator with a non-toothed bucket, a relatively shallow mid brown sandy top soil (201) became exposed. On average across the entire area the top soil only averaged approximately 0.15m in depth. Throughout the turf and top soil strip no dateable finds were recovered within the area.
- 5.8 With the top soil now cleared from across the entire area, a variable orange and grey sandy/clay (202) became exposed. This exposed deposit appeared to be natural. A walkover of the entire area recovered no dateable finds of any kind. However, three features did become exposed, two of which were long narrow trenches (203 + 204), each approximately 0.10m in width maximum, and running almost the length of the entire development area. Both these two narrow trenches contained a modern BT telephone cable. These cables were both obsolete and appeared to mark the former route of earlier telephone poles, now absent from the site.
- 5.9 The other remaining feature exposed was an apparent post-hole (205) positioned toward the far north end of the development area (*see Figures 9, 10 and 11, and Photo plates 17 and 18*), highlighted by an area of orange sandy clay (206) within an area of natural grey sandy clay and shale (202) that was projecting up through the sub soil. This apparent post-hole was sectioned and the excavation confirmed that it was indeed a post-hole that had been dug through the natural grey clay and shale. This post-hole reached a depth of only 0.30m and was approximately 0.45m in width at its shoulder. However, the post-hole was also surrounded by shallower excavations. The hole was filled with orange clay and sand and large stones (206), likely former packing material. Unfortunately no dateable finds or deposits were recovered from this post-hole.
- 5.10 Given that a significant post-hole had become exposed at the far north end of the development area, further groundwork of the immediate area took a cautious approach, in case further post-holes became exposed. Unfortunately no further post-holes became exposed across the entire development area.,
- 5.11 Once the sub soil had been removed entirely from the eastern half of the development area, a natural grey/pale orange clay and shale deposit (207) became exposed. This exposed natural deposit was walked over and inspected. No further finds or features were discovered. Given that the top eastern half of the site was the only area required to be excavated down to natural as the area needed to be levelled, no further archaeological watching brief was required during the remaining groundwork, as this entailed the spreading of the accumulated excavated soil over the western side of the area so as to create a levelled area suitable for the ménage.

## **6. Conclusion and Recommendations**

- 6.1 The archaeological watching brief during groundwork for the proposed development on land attached to Berthela, near Pont Creuddyn, Lampeter, Ceredigion, exposed no archaeological finds, features or deposits of any significance during groundwork in the area of the proposed stable building at the far north end of the farmstead. The top soil in this area was fairly shallow and the sub soil was a natural clay and shale, Dateable finds recovered in this area included 20<sup>th</sup> and late 19<sup>th</sup> century pottery and glass fragments and plastic.
- 6.2 However, the groundwork for the proposed ménage area at the far west end of the Berthela farm did manage to expose a potentially significant post-hole located at the far north end of the cleared area. Unfortunately, excavation of this post-hole did not manage to recover any dateable material from within its fill, which consisted of clayey sand and stones. As a precaution the immediate 20 meters or so surrounding this post-hole was investigated closely for evidence of any further post-holes, however none were found. This would suggest that this post-hole is either just a lone feature, or else any other potential post-holes were very discrete and not observed during the stripping exercise. Given the fact that there was no evidence for any post-hole observed within the top soil for this feature, would suggest that it is early in date, possibly prehistoric, and given that there are records within the HER that suggest the presence of several undated cropmark enclosures in close proximity to the development area (PRN's 6042, 6043 and 6044), thought to be possibly prehistoric, then there is a possibility that this post-hole is contemporary in date to these cropmark features. As such, it is recommended that any future proposed development within the immediate landscape of this post-hole and the possibly associated cropmark features, is undertaken under archaeological supervision.
- 6.3 Other than this post-hole in the ménage area, no other significant archaeological finds, features and deposits became exposed during the groundwork at the site.

## **7 Acknowledgements**

Thanks to; the Nutting family for allowing access to the site to undertake the watching brief.

## 8 Bibliography

### *Cartographic Sources*

- *OS Surveyors Drawing (1819)*
- *Tithe Map and Apportionment details for Silian Parish (1846)*
- *Ordnance Survey First Edition Map (1889)*
- *Ordnance Survey Second Edition Map (1906)*
- *Ordnance Survey 1953 Edition Map*

### *Other References*

Soils of England and Wales 1983. Sheet 2: Wales, 1:25000



# **APPENDIX I:**

## **Figures**





**Project Title:** Land at Berthela, Pont Creuddyn, Lampeter, Ceredigion

**Date:** 11th Nov 2020

**Approx. Scale (@ A4):**

**Drawn by:**

**Drawing No.**

**Figure 1.**

Location Map (OS 1:50,000 Landranger)





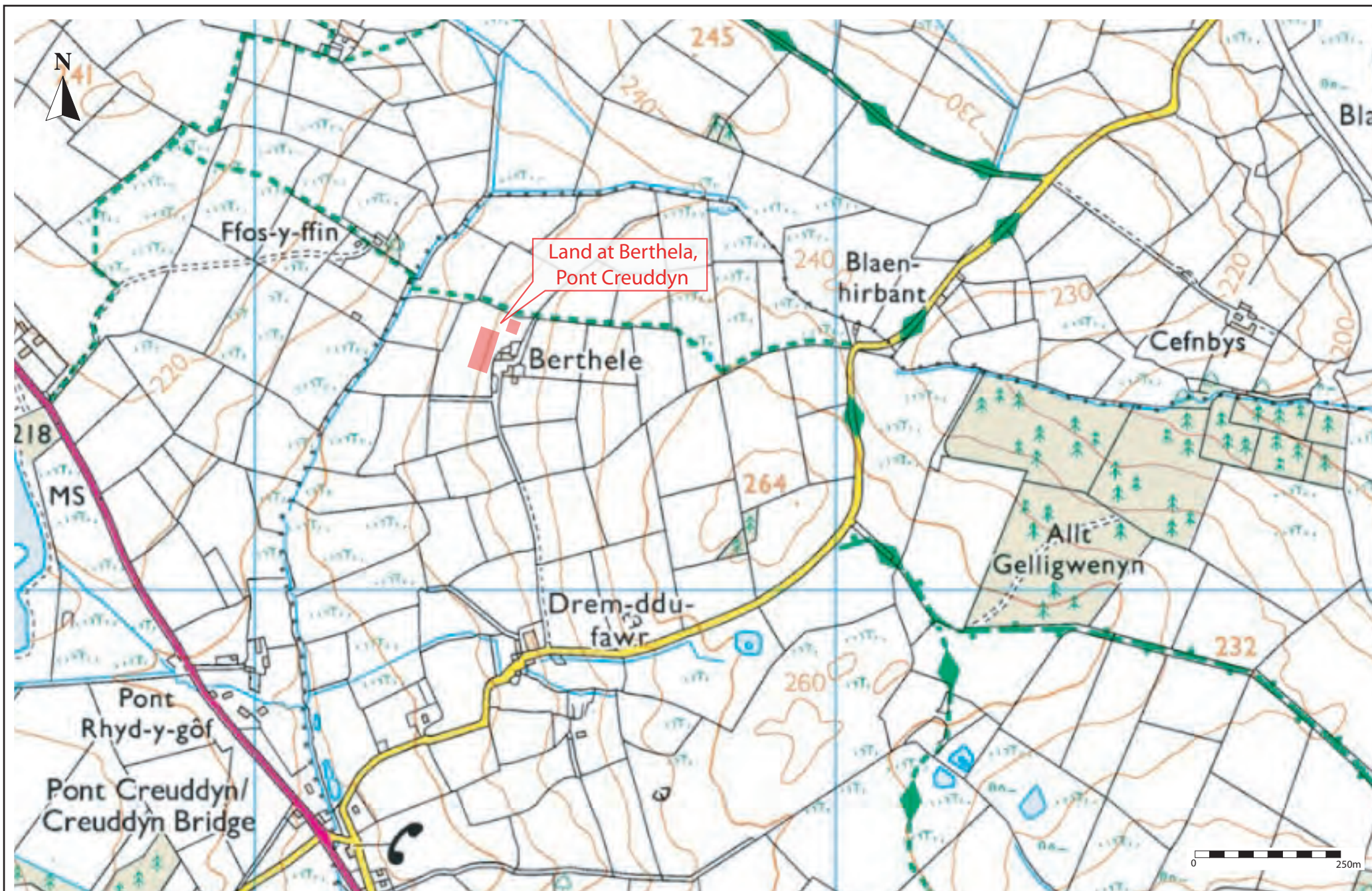

**Project Title:** Land at Berthela, Pont Creuddyn, Lampeter, Ceredigion

**Date:** 11th Nov 2020

**Approx. Scale (@ A4):**

**Drawn by:**

**Drawing No.**

**Figure 2.**

Location Map (OS 1:25,000 Explorer)







**Project Title:** Land at Berthela, Pont Creuddyn, Lampeter, Ceredigion

**Date:** 11th November 2020

**Drawn by:**

**Approx. Scale (@ A4):**

**Drawing No.**

**Figure 3.**

Proposed development areas overlying OS Aerial Photo (2014).



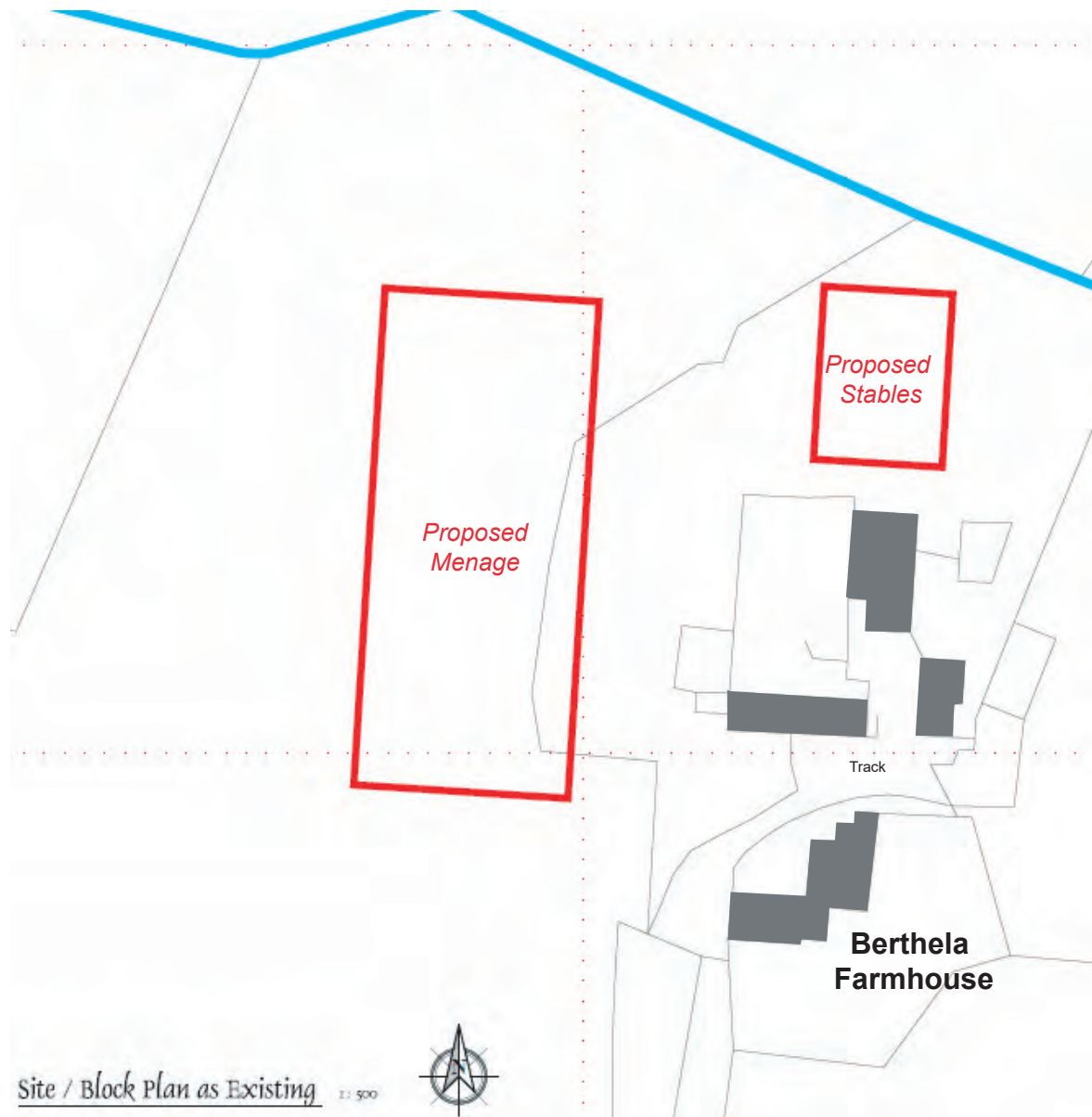

**Project Title:** Land at Berthela, Pont Creuddyn, Lampeter, Ceredigion

**Date:** 11th November 2020

**Approx. Scale (@ A4):**

**Drawn by:**

**Drawing No.**

**Figure 4.**

Site Block Plan - Existing





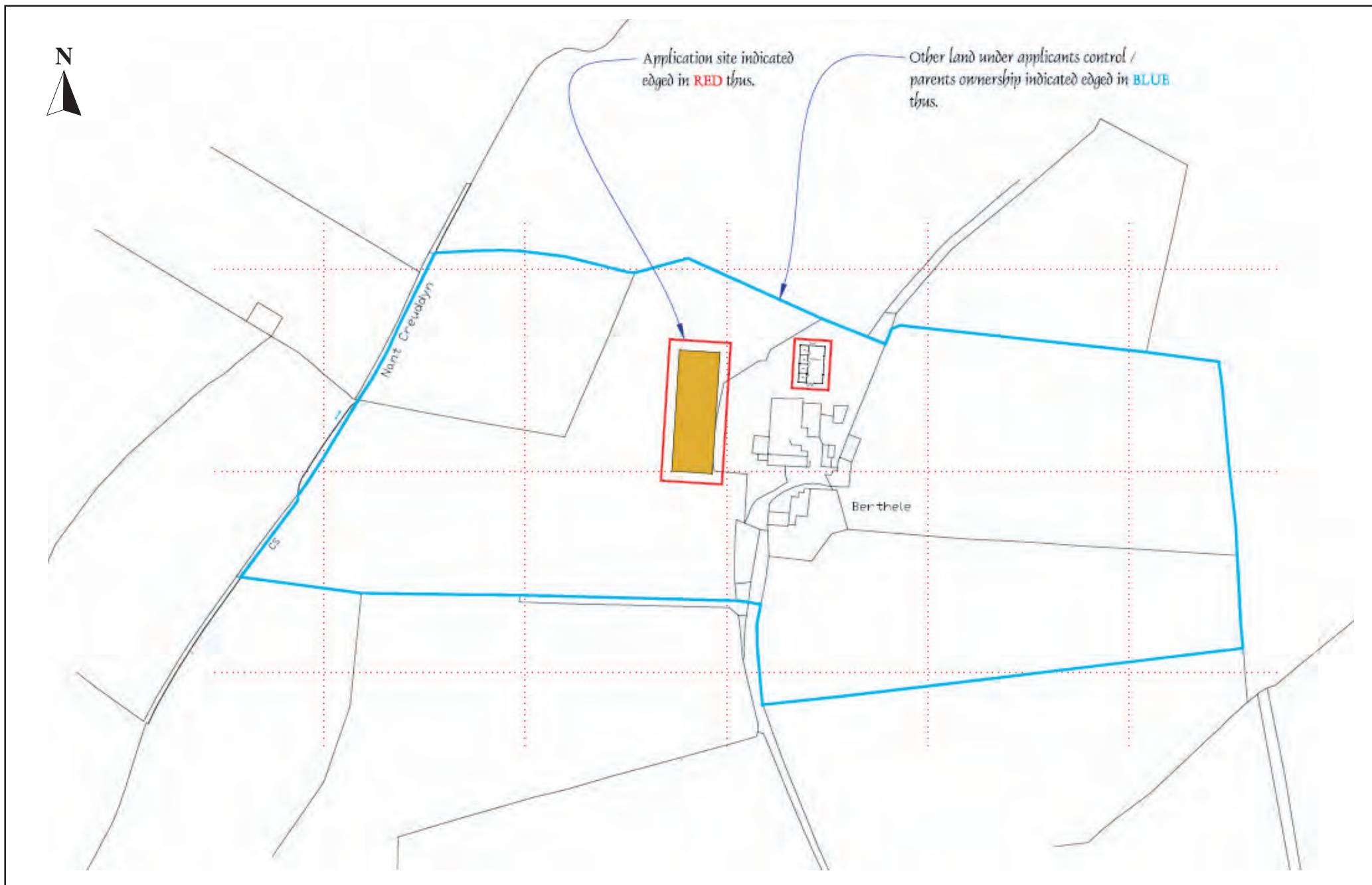

**Project Title:** Land at Berthela, Pont Creuddyn, Lampeter, Ceredigion

**Date:** 11th November 2020

**Approx. Scale (@ A4):**

**Drawn by:**

**Drawing No.**

**Figure 5.**

Site Block Plan - Proposed.







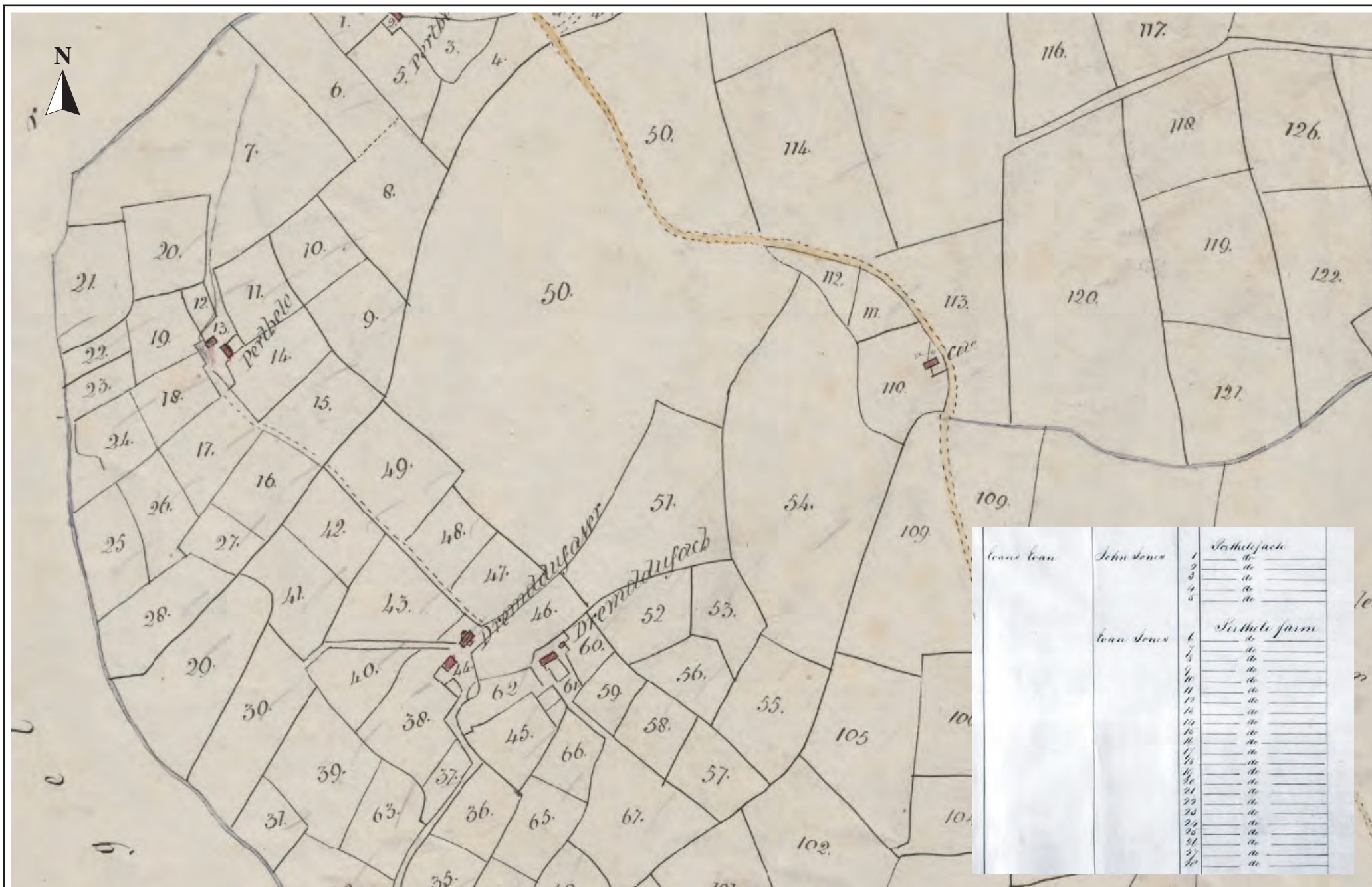

**Project Title:** Land at Berthela, Pont Creuddyn, Lampeter, Ceredigion

**Date:** 11th November 2020

**Drawn by:**

**Approx. Scale (@ A4):**

**Drawing No.**

**Figure 7.**

Tithe Map and Apportionment details for Silian Parish (1846)





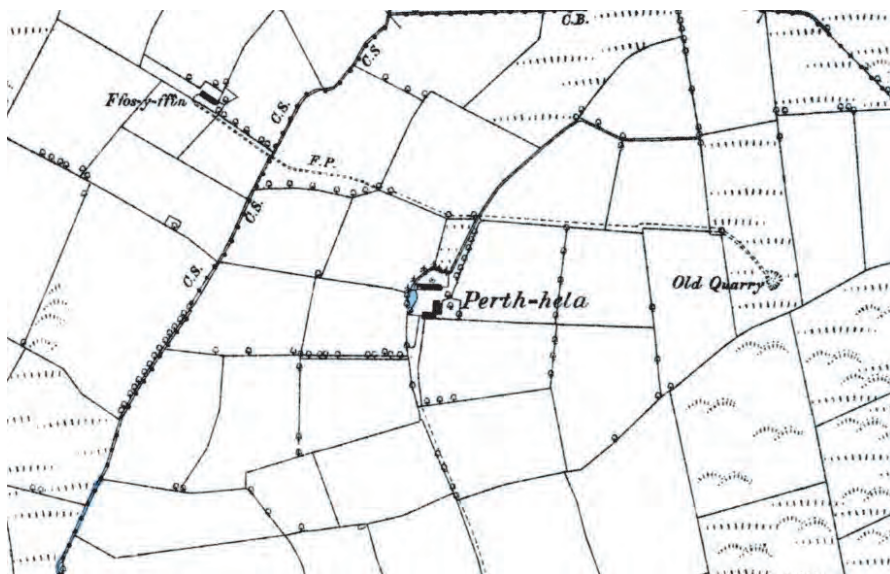

a) OS First Edition Map (1889)

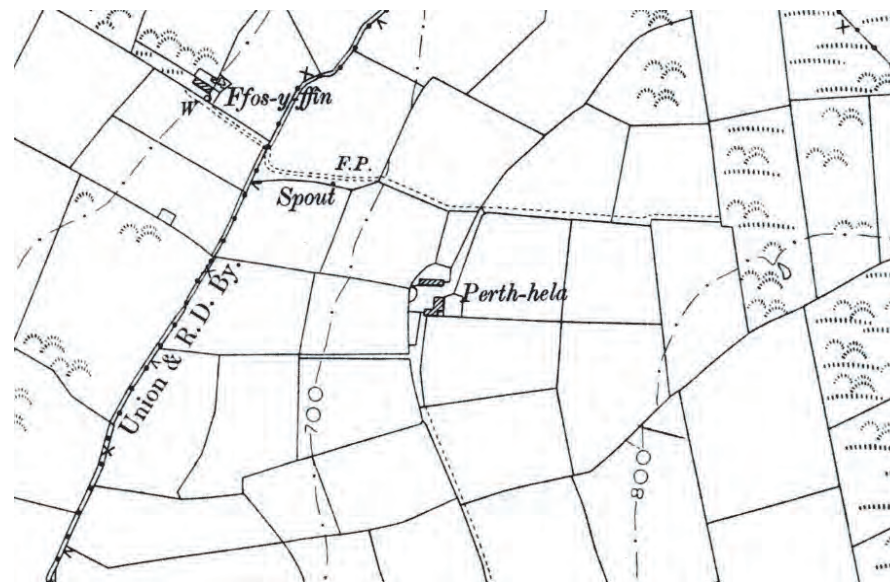

b) OS Second Edition Map (1906)

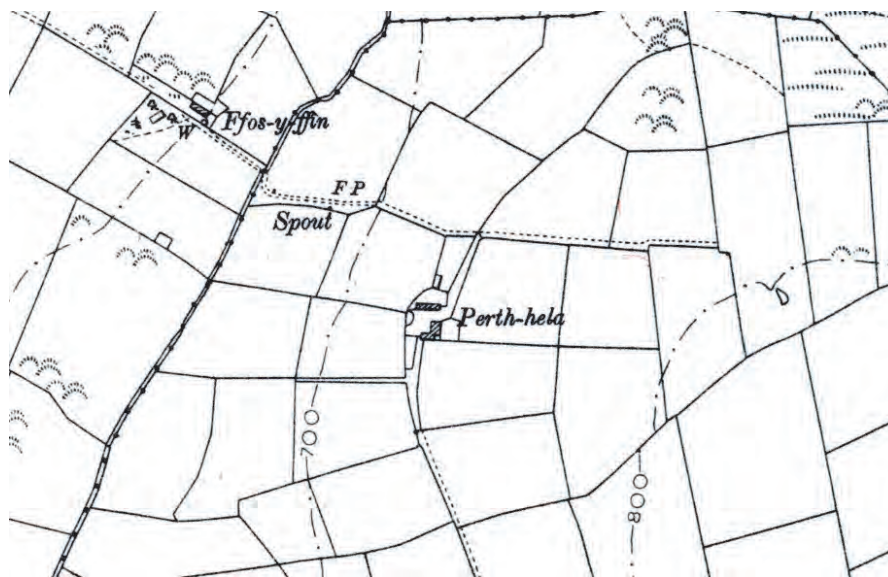

c) OS 1953 Edition Map

**Project Title:** Land at Berthela, Pont Creuddyn, Lampeter, Ceredigion

**Date:** 11th November 2020

**Drawn by:**

**Approx. Scale (@ A4):**

**Drawing No.**

**Figure 8.**

Ordnance Survey Map 1889 - 1953





**Project Title:** Land at Berthela, Pont Creuddyn, Lampeter, Ceredigion

**Date:** 11th November 2020

**Drawn by:**

**Approx. Scale (@ A4):**

**Drawing No.**

**Figure 9.**

Site Block Plan - Areas of proposed turf and top soil strip



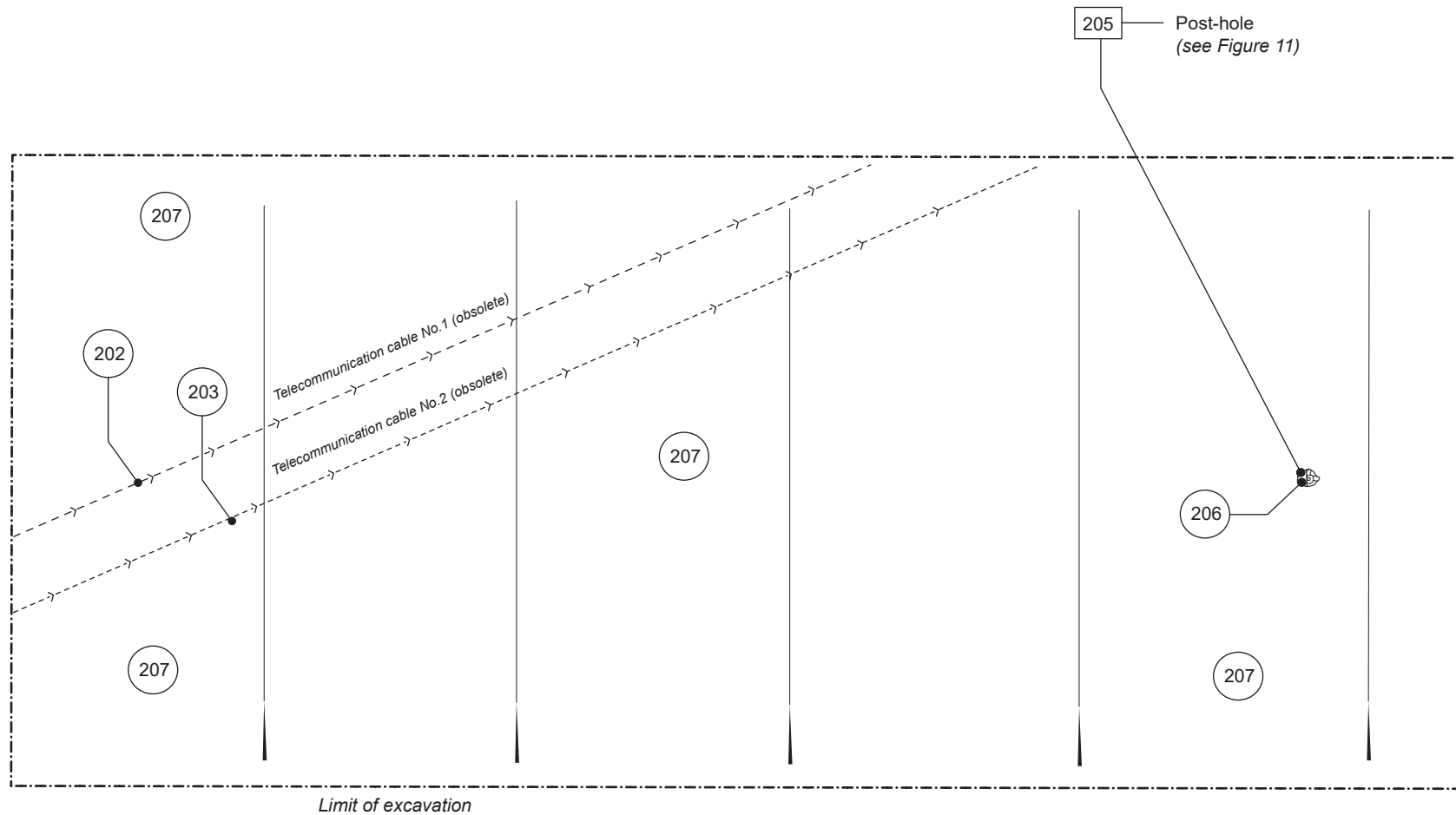

**Project Title:** Land at Berthela, Pont Creuddyn, Lampeter, Ceredigion

**Date:** 11th November 2020

**Drawn by:**

**Approx. Scale (@ A4):**

**Drawing No.**

**Figure 10.**

Menage - Results following turf and top soil strip



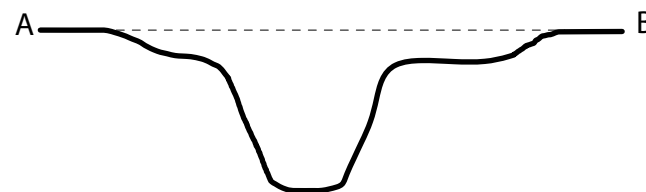
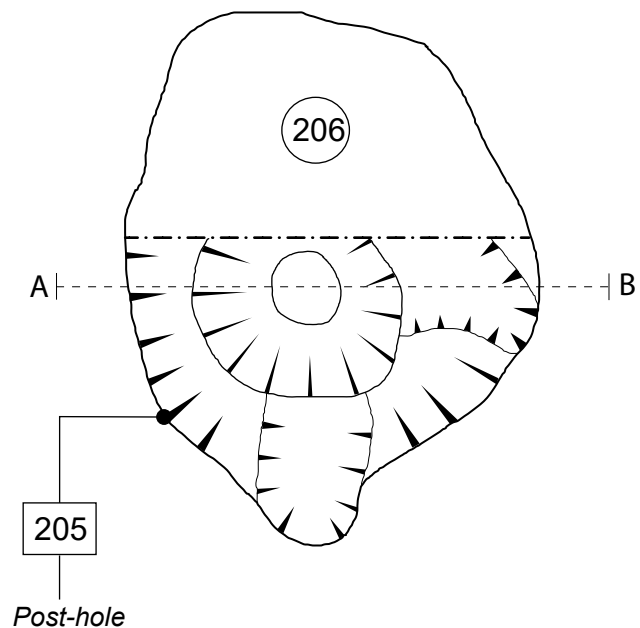

North facing section A-B



**Project Title:** Land at Berthela, Pont Creuddyn, Lampeter, Ceredigion

**Date:** 11th November 2020

**Approx. Scale (@ A4):**

**Drawn by:**

**Drawing No.**

**Figure 11.**

Post-hole (205) - Ground Plan and section



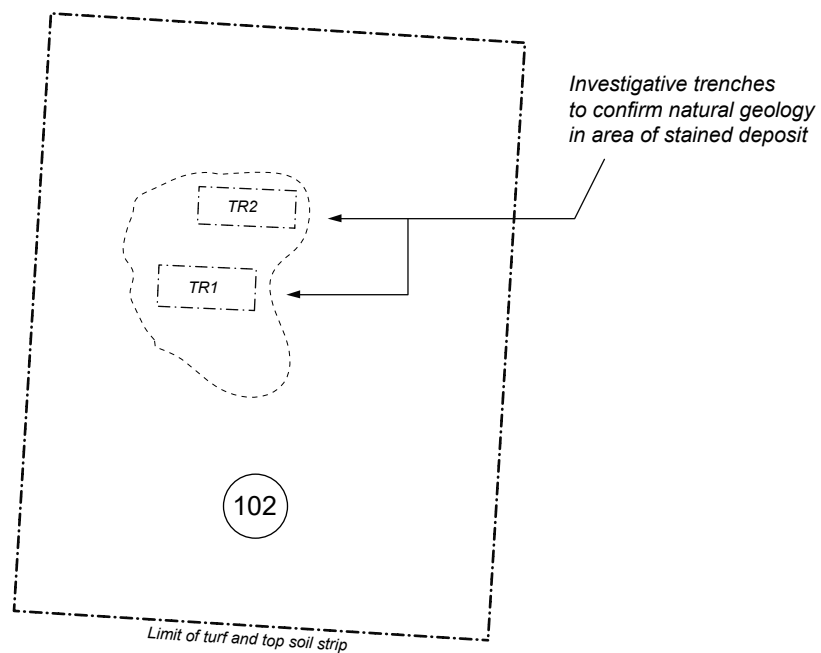

**Project Title:** Land at Berthela, Pont Creuddyn, Lampeter, Ceredigion

**Date:** 11th November 2020

**Approx. Scale (@ A4):**

**Drawn by:**

**Drawing No.**

**Figure 12.**

Stable building - Ground Plan results



## **APPENDIX II:**

### **Photo plates**



*Plate 1. View of area of proposed Menage prior to turf and top soil strip. Looking south to southwest.*

**Project Title:** Land at Berthela, Pont Creuddyn, Lampeter, Ceredigion

**Date taken:** 26th October 2020

**Appropriated by:** Richard Scott Jones

**Plate No's.**

01







Plate 02. View of proposed Stable development area during turf and top soil strip. Looking southwest.



Plate 03. View of proposed Stable development area during turf and top soil strip. Looking northwards.

**Project Title:** Land at Berthela, Pont Creuddyn, Lampeter.

**Date Taken:** 26th October 2020

**Appropriated by:** RSJ

**Approx. Scale (@ A4):**

**Drawing No.**

**Photo Plate No's.**

02 - 03







Plate 04. View of proposed Stable development area during turf and top soil strip. Looking southwards.



Plate 05. View of area of stained soil in area of proposed Stable development area following turf and top soil strip. Looking westward.



Plate 06. Area of proposed Stable building following turf and top soil strip. Looking northwards.



Plate 07. Area of proposed Stable building following turf and top soil strip. Looking southwards.



Plate 08. Small evaluation trench in area of stained soil following turf and top soil strip in area of proposed Stable building. Looking northwards.



Plate 09. Small evaluation trench in area of stained soil following turf and top soil strip in area of proposed Stable building. Looking northwards.

Project Title: Land at Berthela, Pont Creuddyn, Lampeter		Photo Plate No's.  04- 09	
Date Taken: 26th October 2020	Approx. Scale (@ A4):		
Appropriated by: RSJ	Drawing No.		





Plate 10. View of proposed Menage development area during turf and top soil strip. Looking southwest.



Plate 11. View of proposed Menage development area during turf and top soil strip. Looking southwest.

**Project Title:** Land at Berthela, Pont Creuddyn, Lampeter.

**Date Taken:** 26th October 2020 **Approx. Scale (@ A4):**

**Appropriated by:** RSJ **Drawing No.**

**Photo Plate No's.**

10 - 11







Plate 12. View of proposed Menage development area during turf and top soil strip. Looking northwards.



Plate 13. View of proposed Menage development area during turf and top soil strip. Looking westwards.



Plate 14. View of proposed Menage development area during turf and top soil strip. Looking northwards.



Plate 15. View of proposed Menage development area during turf and top soil strip. Looking southwards.



Plate 16. Area of change in soil coloration demarcating post-hole at far northern end of Menage area. Looking northwards.

Project Title: Land at Berthela, Pont Creuddyn, Lampeter		Photo Plate No's.  12 - 16	
Date Taken: 26th October 2020	Approx. Scale (@ A4):		
Appropriated by: RSJ	Drawing No.		





*Plate 17. View of area of post-hole prior to excavation. Positioned at far north end of Menage area.*



*Plate 18. View of sectioned post-hole. Positioned at far north end of Menage area.*

<b>Project Title:</b> Land at Berthela, Pont Creuddyn, Lampeter.		<b>Photo Plate No's.</b>  17 - 18	
<b>Date Taken:</b> 26th October 2020	<b>Approx. Scale (@ A4):</b>		
<b>Appropriated by:</b> RSJ	<b>Drawing No.</b>		



*Plate 19. View of area of proposed Menage following turf and top soil strip. Looking south to southwest.*

**Project Title:** Land at Berthela, Pont Creuddyn, Lampeter, Ceredigion

**Date taken:** 26th October 2020

**Appropriated by:** Richard Scott Jones

**Plate No's.**

19



## **APPENDIX III:**

### **Context Register**

## APPENDIX III

### Context Register

#### Stable Area

##### *Context No.s*

100. Turf

101. Deposit – Top soil. Mid brown sandy sandy/clay soil. Dateable finds include 20<sup>th</sup> and late 19<sup>th</sup> century pottery and glass fragments and plastic.

102. Deposit – Natural orange/grey clay and shale.

#### Menage Area

##### *Context No.s*

200. Turf

201. Deposit – Top soil. Mid brown sandy sandy/clay soil.

202. Deposit – Sub soil. Orange sand/clay and shale. Natural.

203. Trench – Telecommunications trench. Modern.

204. Trench – Telecommunications trench. Modern.

205. Cut – Post-hole. Positioned at far north end of ménage area. Reached a depth of approximately 30cm and a width to its shoulders of approximately 45cm. Further sloping sides extended to approximately 0.85m.

206. Fill – Fill of post-hole (205). Sandy clay with stones of shale averaging between 5cm to 10cm in size. No dateable finds recovered.

207. Deposit – Natural orange and grey clay and grey shale.

**APPENDIX IV:**  
**Archive Cover Sheet**



## ARCHIVE COVER SHEET

Land at Berthela, Pont Creuddyn, Lampeter, Ceredigion.

ARCHIVE DESTINATION - RCAHMW

<b>Site Name:</b>	Land at Berthela, Pont Creuddyn, Lampeter, Ceredigion.
<b>Site Code:</b>	BCB/2020/WB
<b>PRN:</b>	-
<b>NPRN:</b>	-
<b>SAM No.</b>	
<b>Other Ref No.</b>	HRSW Rpt No. 224
<b>NGR:</b>	SN 5538 5340
<b>Site Type:</b>	Post Medieval farmstead
<b>Project Type:</b>	Archaeological Watching Brief
<b>Project Manager:</b>	Richard Scott Jones
<b>Project Date(s):</b>	26th October 2020
<b>Categories Present:</b>	None
<b>Location of Original Archive:</b>	HRSW
<b>Location of Duplicate Archive:</b>	RCAHMW
<b>Number of Find Boxes:</b>	N/A
<b>Location of Finds:</b>	N/A
<b>Museum Ref:</b>	N/A
<b>Copyright:</b>	HRS Wales
<b>Restrictions to Access:</b>	None



Egwyl, Llwyn-y-groes, Tregaron, Ceredigion SY25 6QE

Tel: 01570 493759 Fax: 08712 428171 E-mail: [richard@hrswales.co.uk](mailto:richard@hrswales.co.uk)