

# *Archaeology Wales*

## **Haverfordwest Welsh Medium School, Withybush, Haverfordwest**

Archaeological Desk-Based Assessment



By Philip Poucher

Report No: 1478

Archaeology Wales Limited  
The Reading Room, Town Hall, Great Oak Street  
Llanidloes, Powys SY18 6BN  
Telephone: 01686 440371  
E-mail: [admin@arch-wales.co.uk](mailto:admin@arch-wales.co.uk)

# *Archaeology Wales*

## **Haverfordwest Welsh Medium School, Withybush, Haverfordwest**

### Archaeological Desk-Based Assessment

Prepared For: Pembrokeshire County Council

Edited by: Adrian Hadley

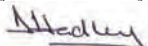
Signed: 

Position: Senior Archaeologist

Date: 06/07/16

Edited by: Mark Houlston

Signed: 

Position: Managing Director

Date: 07/07/16

By  
Philip Poucher

Report No: 1478

**June 2016**

# CONTENTS

Non-Technical Summary	1
1. Introduction	2
2. Site Description	2
3. Methodology	3
4. Archaeological and Historical Background	4
4.1 Previous Archaeological Studies	4
4.2 The Historic Landscape	4
4.3 Scheduled Ancient Monuments	5
4.4 Listed Buildings	5
4.5 Known Archaeological Remains and Historical Development	5
5. Map Regression	9
6. Aerial Photographs & Lidar	12
7. Site Visit	13
8. Impact Assessment	14
8.1 Assessment of Archaeological Potential and Importance	14
8.2 Previous Impacts	15
8.3 Potential Impacts of the Proposed Development	15
9. Conclusions	18
9.1 Impacts	18
9.2 Mitigation	19
10. Sources	21
Appendix I: Gazetteer of Sites Recorded on the Regional HER	
Appendix II: Designated Archaeological Sites	
Appendix III: Specification	
Appendix IV: Archive Cover Sheet	

## List of Tables

1 Potential Impacts	18
---------------------	----

## List of Figures

1 Location map
2 Plan of the development area
3 Proposed development details
4 Designated archaeological landscapes within a 2km study area
5 Designated archaeological sites within a 2km study area
6 Non-designated archaeological sites within a 1km study area
7 Archaeological sites within the proposed development area

- 8 Extract from the 1843 tithe map
- 9 Extract from the Ordnance Survey map of 1889
- 10 Extract from the Ordnance Survey map of 1939
- 9 Lidar data

#### List of Photographs

- 1 Vertical aerial photograph of 1955
- 2 Satellite imagery of 2006
- 3-5 General shots of fields at the western end of site
- 6-7 General shots of fields at the south-eastern end of site
- 8-9 Standing stone PRN 13075
- 10-14 Picket Post PRN 28541
- 15-16 Latrine block PRN 28542
- 17-18 Accommodation blocks HWMS 03 & HWMS 05
- 19 View from Crowhill Rath PE 218
- 20 View from Haverfordwest Castle PE 366

#### *Copyright Notice:*

*Archaeology Wales Ltd. retain copyright of this report under the Copyright, Designs and Patents Act, 1988, and have granted a licence to Pembrokeshire County Council, to use and reproduce the material contained within.*

*The Ordnance Survey has granted Archaeology Wales Ltd a Copyright Licence (No. 100055111) to reproduce map information; Copyright remains otherwise with the Ordnance Survey.*

## Non-Technical Summary

*In May 2016, Archaeology Wales was commissioned by Pembrokeshire County Council, to carry out an Archaeological Desk-Based Assessment and site visit to determine the archaeological potential of land near to the Withybush Industrial Estate, Haverfordwest, Pembrokeshire. The assessment has been undertaken in advance of the submission of a planning application for the construction of a new Welsh Medium School and associated playing fields and infrastructure.*

*No Scheduled Ancient Monument, Listed Building, registered Historic Landscape, Conservation Area or listed Historic Park & Garden will be directly affected by the proposed development.*

*The site will have a negligible indirect (visual) impact on Historic Landscape Character Area 309 Haverfordwest, associated with the registered Historic Landscape Milford Haven Waterway (HLW (D) 3). The site lies within the Landmap historic landscape area of Crundale (PMBRKHL46209). This will have both a direct and indirect (visual) impact on this landscape through altering a small area of field enclosures that form part of the character of this area. This is considered to be a minor impact.*

*Eleven sites of specific archaeological interest have been identified within the proposed development site. These comprise a standing stone (PRN 13075), potentially Bronze Age in date, and the location of a second removed stone (HWMS 01). Alongside this are the remains of several structures that form a former accommodation area (PRN 102563) associated with the Second World War airfield to the north; these are individually identified as a picket post (PRN 28541), latrine block (PRN 28542), four or five accommodation blocks and further latrines (HWMS 02 – 08). Two of these structures (PRN 28541 & 28542) are standing whilst the remainder survive only partially as scrub-covered concrete footings. The presence of possible Bronze Age standing stones also highlights a general archaeological potential for Bronze Age archaeological remains to exist within the site area (HWMS 09). The proposed scheme is considered to have a major impact on all individually identified archaeological sites, as they will be disturbed or destroyed during groundworks for the proposed development.*

*It is recommended that a geophysical survey of the site may assist in ascertaining the presence or absence of below-ground archaeological remains, particularly in association with the potential Bronze Age standing stones. More intrusive archaeological evaluation may also be subsequently required on any identified features, including standing stone PRN 13075, to help determine the extent, date and relative importance of any archaeological features. These archaeological investigations will help inform decision making and any further archaeological mitigation measures.*

*The structures relating to the Second World War accommodation (PRNs 28541 & 28542, and HWMS 02 – 05) should be recorded prior to their removal. It is suggested that a photographic survey and plan of their remains, subsequent to vegetation clearance, would be sufficient to ensure preservation through record.*

*The scale of any further archaeological investigations should be agreed with the local planning authority and their relevant archaeological advisors prior to any work being undertaken.*

## 1 Introduction

- 1.1 In May 2016 Archaeology Wales (AW) was commissioned by Pembrokeshire County Council to carry out an Archaeological Desk-Based Assessment for the proposed construction of a new Welsh Medium School on land near to the Withybush Industrial Estate in Haverfordwest, Pembrokeshire (NGR SM 962 174, Figures 1 - 3, AW Project Number 2436).
- 1.2 This assessment has been prepared prior to the submission of a planning application. A Specification for the Desk-Based Assessment was produced by AW in May 2016 and approved by Dyfed Archaeological Trust Planning Services (DAT-PS), who act as archaeological advisors to the local planning authority, in this case Pembrokeshire County Council (PCC) (see Appendix III).
- 1.3 The purpose of the Desk-Based Assessment, which is detailed in the following report, is to provide PCC with the information they are likely to request in respect of the proposed development, the requirements for which are set out in Planning Policy WALES, Edition 8, January 2016, Chapter 6, and Welsh Office Circular 60/96. The work is to highlight and assess the impact upon standing and buried remains of potential archaeological interest and to ensure that they are fully investigated and recorded if they are disturbed or revealed as a result of subsequent activities associated with the development.
- 1.4 The proposed development comprises plans for the construction of new Welsh Medium School, covering a site area of approximately 8.4 hectares (20.8 acres). Detailed development plans have not yet been finalised, but it is understood that work will include the construction of the main school building, along with sports pitches, landscaping and associated infrastructure (Figure 3).

## 2 Site Description

- 2.1 The development site for the proposed school is located on relatively level land that rises slightly to the south, from 32m OD to 37m OD. The site encompasses four fields bounded by straight-sided hedgerows. Withybush Road forms the northeast boundary, beyond which lies the Withybush Industrial Estate and Haverfordwest Airport. To the south the site is bounded by the A40 (T) beyond which lies residential development of Prendergast on the northern side of Haverfordwest. To the north and east lies further agricultural land and the village of Crundale.
- 2.2 Haverfordwest lies on the Western Cleddau (*circa* 600m to the west of the proposed development site) in central Pembrokeshire. The site is located on the northern fringes of development around Haverfordwest; the town centre is some 1.7km to the south, on the western side of the river.
- 2.3 The underlying bedrock of the proposed development area comprises mudstones of the Slade and Redhill Formation, partly overlain to the east by sand and gravel glacio-fluvial deposits (BGS, 2016).

### 3 Methodology

- 3.1 The methodology for this assessment follows that set out in the approved Specification (Appendix III).
- 3.2 The primary objective is to assess the impact of the development proposals on the historic environment. This will help inform future decision making, design solutions and potential mitigation strategies. The aim is to make full and effective use of existing information in establishing the archaeological significance of the site, to elucidate the presence or absence of archaeological material, its character, distribution, extent, condition and relative significance.
- 3.3 The work includes a comprehensive assessment of regional context within which the archaeological evidence rests and aims to highlight any relevant research issues within national and regional research frameworks.
- 3.4 This report provides information of sufficient detail to allow informed planning decisions to be made which can safeguard the archaeological resource. Preservation *in situ* has been advocated where at all possible, but where engineering or other factors result in loss of archaeological deposits, preservation by record has been recommended.
- 3.5 This assessment considers the following:
- a) The nature, extent and degree of survival of archaeological sites, structures, deposits and landscapes within the study area through assessment of various readily available primary sources:
- Collation and assessment of all relevant information held in the regional HER at DAT within a 1km radius of the development site;
  - Collation and assessment of all Designated archaeological sites within a 2km radius of the development site;
  - Assessment of all available excavation report and archives including unpublished and unprocessed material affecting the site and its setting.
  - Assessment of aerial photographic (AP) and satellite imagery evidence;
  - Assessment of archive records held at the County Archive, the National Library of Wales (NLW) and the Royal Commission on Ancient and Historical Monuments in Wales (RCAHMW);
  - Records held by the developer e.g. bore-hole logs, geological/geomorphological information, aerial photographs, maps, plans, ztv data;
  - Map regression analysis using all relevant cartographic sources e.g. all editions of the Ordnance Survey County Series, Tithe and early estate maps (as available);
  - Place-name evidence;
  - Historic documents (e.g. charters, registers, estate papers).
- b) The significance of any remains in their context both regionally and nationally and in light of the findings of the desk based study.
- c) The history of the site.

- d) The potential visual impact of any proposed development on the setting of known sites of archaeological importance.
  - e) The potential for further archaeological remains to be present, which have not been identified in pre-existing archaeological records.
  - f) the potential for further work, with recommendations where appropriate for a suitable investigative and/or mitigation methodology.
- 3.6 This work conforms to the Standard and Guidance for Archaeological Desk-Based Assessment, as produced by the Chartered Institute for Archaeologists (CIfA 2014).

## 4 Archaeological and Historical Background

### 4.1 *Previous Archaeological Studies*

- 4.1.1 The site of the proposed development has not been subject to any previous known archaeological investigations.
- 4.1.2 The only recorded archaeological investigation within a 1km search area around the site relates to Cadw grant-aided threat related assessment of 20<sup>th</sup> century military sites, specifically on airfields, which was undertaken in 2011-12 (Pyper & Page, 2012). The study on Haverfordwest Airfield identified numerous military buildings, some of which are located within the development site. These buildings are not specifically described within the report, but it does provide a brief history of the airfield and the historical context for these structures.

### 4.2 *The Historic Landscape (Figure 4)*

- 4.2.1 The proposed development site does not lie within any registered Historic Landscape (Cadw, CCW & ICOMOS 1998). Part of the Milford Haven Waterway Landscape of Outstanding Historic Interest (HLW (D) 3) lies within 200m to the south of the site. This area has been sub-divided into a number of Historic Landscape Character Areas (HLCAs), some of which extend beyond the boundaries of the registered Historic Landscape. HLCA 309 Haverfordwest, which is largely drawn around the urban limits of Haverfordwest, extends as far as the southern and western boundaries of the proposed development site. Part of HLCA 327 Uzmaston and Boulston lies 1.4km to the southwest of the site, within the 2km search area.
- 4.2.2 Haverfordwest Conservation Area lies just over 1.4km to the southwest. This area is drawn around the main historic centre of Haverfordwest and contains a large number of listed buildings.
- 4.2.3 There are no registered Historic Parks and Gardens within the 2km search area around the proposed development site.
- 4.2.4 The site lies in the Landmap Historic Landscape area of Crundale (PMBRKHL46209). This is described as a small but distinct lowland area of medium-sized, fairly regular field enclosures that appear to have their origins as medieval strip fields. The area is now characterised by modern settlement, with a settlement pattern of small informal



farms, scattered 19<sup>th</sup>/20<sup>th</sup> century roadside ribbon development, and the nucleated settlement at Crundale. The area is valued within the Landmap historic landscape descriptions as 'moderate'.

#### 4.3 *Scheduled Ancient Monuments (Figure 5, Appendix II)*

- 4.3.1 There are four Scheduled Ancient Monuments within a 2km search area around the proposed development, none of which lie within the area of proposed development.
- 4.3.2 The closest of the SAM sites is the Crowhill Rath (PE218), which lies *circa* 980m to the west of the site, on the opposite side of the Western Cleddau. This is an Iron Age hillfort occupying a low inland promontory overlooking the river valley.
- 4.3.3 Just over 1.5km to the northwest lies a Pit Circle near Cottesmore Farm (PE462), presumed to be a ritual monument Neolithic in date. Just over 1.7km to the southwest lies Haverfordwest Castle (PE366), a medieval castle occupying a prominent position in the centre of Haverfordwest. 1.8km to the northeast lies the Leachpool round barrow (PE356), a Bronze Age funerary monument.

#### 4.4 *Listed Buildings (Figure 5, Appendix II)*

- 4.4.1 There are 242 Listed Buildings within the 2km search area around the proposed development, 225 of which lie within the Haverfordwest Conservation Area. These Listed Buildings include two Grade I listed buildings (LB 12031 Haverfordwest Castle and LB 12226 Church of St Mary) and 21 Grade II\* listed buildings (LBs 12002, 12020, 12021, 12041, 12044, 12045, 12046, 12081, 12090, 12092, 12097, 12104, 12110, 12111, 12116, 12118, 12122, 12123, 12172, 22762 & 87060); the remainder are all Grade II listed. No Listed Building lies within the proposed development site.
- 4.4.2 The closest Listed Building lies 400m to the west, and comprises Glanafon, a Grade II early Victorian small country house (LB 26984).
- 4.4.3 The remaining listed buildings comprise a wide variety of structures including chapels and churches, houses, farm buildings, mills, inns, municipal buildings, a war memorial, bridges and mileposts. They range in date from the medieval to modern periods.

#### 4.5 *Known Archaeological Remains and Historical Development (Figures 6 & 7, Appendix I)*

- 4.5.1 There are 61 sites listed on the HER within 1km of the proposed scheme. Four of these sites lie within the development site. These include a possible Bronze Age standing stone (PRN 13075), a picket post (PRN 28541) and latrine (PRN 28542), belonging to a former military camp (PRN 102563) which was part of the 2<sup>nd</sup> World War RAF Haverfordwest site. The full catalogue provided by Dyfed Archaeological Trust is included in the rear of this report.
- 4.5.2 There are also 8 sites listed on the National Monuments Record (NMR) maintained by the Royal Commission of Ancient and Historical Monuments Wales (RCAHMW) within

the same search area, none of which lie within the proposed development area. Four of these are duplicated on the HER records, with four additional sites comprising modern Withybush hospital (NPRN 401805), post-medieval Shoals Hook farmhouse (NPRN 30233) and outbuildings (NPRN 22638), and the garden associated with Glanafon House (NPRN 265271).

- 4.5.3 There are no records of artefacts or coins listed within the Portable Antiquities Scheme database ([www.finds.org.uk](http://www.finds.org.uk)) as lying within a similar search area.
- 4.5.4 The HER sites are briefly described below, according to period, where they are incorporated into a summary of the historical development of the area.

*Prehistoric: Palaeolithic (c.450,000 – 10,000 BC), Mesolithic (c.10,000 – 4400 BC), Neolithic (4400 BC – 2300 BC), Bronze Age (2300 BC – 700 BC) & Iron Age (700 BC – 43 AD)*

- 4.5.5 There is currently no recorded evidence of Palaeolithic or Mesolithic activity either within the 1km search area, or indeed the wider landscape. Activity during these periods is likely to be largely based on hunter-gatherer societies who moved through the landscape, leaving little trace of their presence in this area.
- 4.5.6 During the subsequent Neolithic period there appears to have been a gradual move away from hunter-gatherer societies with groups starting to become more settled and adopting agriculture to varying degrees. Sea levels also began to approach their current levels, with the potential for maritime activity along the Cleddau River. Evidence of Neolithic activity can be seen in the pit circle at Cottesmore to the northwest and the Stone Park chambered tomb just to the north of Haverfordwest Airfield, but there are no recorded Neolithic sites within the 1km search area around the site.
- 4.5.7 The appearance of several monuments and earthworks in the wider area, dated to the Bronze Age, may suggest population levels were increasing during this period. Evidence of settlement sites are rare, although these have been recorded at Priory Farm Cave near Pembroke, and the former Esso refinery site further down the Cleddau. Within the surrounding landscape, burnt mounds and funerary monuments in the form of burial mounds have been recorded, such as the Leachpool Barrow to the northeast, and a possible round barrow 750m to the north of the proposed scheme (PRN 4539). Within the development site area lies a possible standing stone (PRN 13075) that may be Bronze Age in origin. A further possible standing stone is also recorded 550m to the south (PRN 13066). Such features are somewhat enigmatic, and may have been used as funerary and ritual markers during the Bronze Age. Few such sites have been excavated, but some of those that have, have recorded Bronze Age finds and occasional burials in association with the stones. Stone were however erected for a variety of reasons in many different periods, sometimes as boundary markers, sometimes as rubbing stones for cattle.
- 4.5.8 There are no recorded Iron Age sites within the 1km search area, however Crowhill Rath, an Iron Age promontory fort overlooking the Cleddau valley lies just over 1km to the west. In the wider landscape Iron Age monuments are largely dominated by defensive sites (determined by local topography unlike that of the development site).

However, undefended sites are also evident, such as the late Iron Age settlement recorded at nearby Shoals Hook, to the east of the proposed scheme (Poucher, 2015).

*Roman (AD 43 – c. AD 410) & Early Medieval (c. AD 410 – AD 1086)*

- 4.5.9 There are no recorded Roman sites within the 1km search area, however, the picture of activity in this area during the Roman period is a changing one. The recent discovery of a Roman Fort at Wiston (Meek & Wilson, 2013) to the east indicates an early military presence in the area. A Roman road runs westwards from this fort, but the line is soon lost and it is not clear where this route would have crossed the Cartlett Brook to the east of the development site. The undefended Iron Age enclosure at Shoals Hook also continued in occupation into the Roman period (Poucher 2015), and Roman era finds have been recorded within Haverfordwest to the south.
- 4.5.10 The early centuries after the end of Roman administration in Wales are not well documented, and no early medieval sites are recorded within the 1km search area. This area lay within the emerging kingdom of Dyfed following the end of the Roman era, which was subsumed into the larger realm of Deheubarth in the early 10<sup>th</sup> century. The closest recorded activity of this period is the suggestion that a medieval chapel and cemetery at the Iron Age hillfort of Rudbaxton Rath (2.3km to the northeast) may have its origins in the early medieval period.

*Medieval (1086 – 1536)*

- 4.5.11 The town of Haverfordwest was founded in the early twelfth century in the shadow of the castle, which may have been built in 1110 by Tancred the Fleming. The town originally grew up around the northern and western sides of the castle and became known as Castleton. The town prospered as a port for the import and export of cloth and wool and attracted merchants from all over southern Pembrokeshire. In 1220 the town was raided by Llewellyn the Great, who succeeded in burning the town **'right up to the castle'**. In response to this a murage grant was issued and town walls were constructed by 1270. There were originally five gates into the town, plus another into the castle: these include North Gate located on the site of the modern roundabout where Thomas Parry Way meets North Street Mews; **and St Martin's Gate which lay close to St Martin's Church.**
- 4.5.12 The town continued to prosper into the fourteenth century and became one of the largest towns in Wales and a thriving port, which traded with England and the continent. In 1349 the town was hit by the Black Death which decimated the population, killing nearly half the inhabitants of Haverfordwest. The prosperity of the town inevitably suffered, however, it remained the main port for this part of Pembrokeshire and became the County town in the 15<sup>th</sup> century, with suburbs expanding across the river to the east.
- 4.5.13 There is no indication that medieval settlement extended into the proposed development area, indeed there are no recorded medieval sites within the 1km search area. It is possible however that the site lay within the agricultural hinterland

surrounding the town. There is some suggestion that the field layout in this area may have medieval origins (Landmap description), although evidence of a potential medieval open-field system is better evidenced to the northeast around Crundale.

*Post-Medieval (1536 – 1899) & Modern (1900 – present day)*

- 4.5.14 In the post-medieval period Haverfordwest attracted wealthy local landowners who built townhouses to complement their country estates. In the late 18<sup>th</sup> and early 19<sup>th</sup> century the town underwent an extensive programme of rebuilding and many of the Regency style buildings that still exist today date from that period. Industry grew up in the early nineteenth century and there were several mills and an iron forge in the town in the early 1800s, while new quays were added to the port to allow an expansion in trade. This however soon went into decline as new ports were established lower down the Cleddau, and the arrival of the railway in 1853 further reduced Haverfordwest as a centre for trade, commerce and industry. The settlement at Crundale appears largely to have been established in the later post-medieval period, and the recorded archaeological sites in the area include many 18<sup>th</sup> to 19<sup>th</sup> century houses (PRNs 17774, 24366 & 60000), farmsteads (PRN 44898 & NPRN 30233) and the early Victorian country house at Glanafon (PRN 20962/60001). By this period this area was firmly agricultural in character, and some of the field boundaries defining the site area may have been established during this period. Some small-scale industrial activity is also indicated by the presence of several small quarries recorded in the 19<sup>th</sup> century (PRNs 44908, 44909, 46911 & 46913).
- 4.5.15 The area around the proposed development site is likely to have changed little into the 20<sup>th</sup> century, until the advent of the Second World War. RAF Haverfordwest Airfield was established to the north of the development site. Construction initially began in 1941 but the airfield did not become fully operational until 1943, when it then became home to No.3 (Coastal) Operations Training Unit, training in reconnaissance skills. In 1944 they were replaced by No.4 Refresher Flying Unit, delivering aircraft throughout the country. This unit was disbanded later the same year and replaced at the start of 1945 by No.8 Operations Training Unit who continued training in general reconnaissance. An RAF Aircrew Holding Unit was the last to be based at the airfield before it closed in November 1945. The airfield was reopened as a civilian airfield in 1952, and is still operational. The RAF airfield consisted of three runways, with bomb stores to the north, technical and training areas to the east, and accommodation to the south. One such accommodation block was established within the proposed development area, identified on air ministry plans as Site 11 (PRN 102563). This consisted of separate barrack blocks and latrines for airmen, sergeants and officers, along with a picket post or watch hut. Aerial photography from 2009 show that the picket post (PRN 28541) and sergeants latrine (PRN 28542) survive as standing structures, with concrete footings of two of the sergeants and officers barracks surviving.

## 5 Map Regression (Figures 8 – 10)

### 5.1 *Ordnance Survey Drawing (Haverfordwest) of 1810*

5.1.1 The original **surveyor's** drawings of the early 19<sup>th</sup> century record the settlement pattern, road networks and many of the main topographical features in the area, but lack precise accurate detail. The map shows the core of urban settlement in Haverfordwest clustered around and to the south of the castle, with roadside settlement extending into Prendergast alongside the B4329, as far as the junction with Hall Park (Fishguard Road), Cardigan Road and Shoals Hook Lane. Little detail is given as to the layout off the land, although the suggestion is that it lies within enclosed agricultural land. A short lane lies just to the south, possibly connects the Cardigan and Fishguard/Withybush roads. The closest settlement would appear to be Crowsnest, which lies at the junction of the Fishguard and Withybush roads to the **southwest of the site, and Stephen's Ford, a farmstead just to the northeast of the proposed development.**

5.1.2 No specific features of archaeological interest are noted within this site area itself.

### 5.2 *Prendergast Parish Tithe Map of 1843 (Figure 8)*

5.2.1 The tithe map of 1843 appears to accurately depict the layout of field boundaries, settlement sites and river and road routes. The area of proposed development comprises small to medium-sized, straight-sided field enclosures. There would appear to be a mix of long narrow fields, which lie largely to the south between Shoals Hook Lane and the Cartlett Brook, and small square and rectangular fields to the north. The long rectangular fields appear typical of enclosed open field systems, which may have their origins in the medieval period. The square and rectangular fields appear more reminiscent of later post-medieval enclosure. The site occupies an area in between these two field systems and is divided up into a mix of long rectangular fields and square fields.

5.2.2 The current field boundaries that define the site, with the exception of the north-south boundary dividing the north-western fields, were in place by the time of the tithe survey, although all the fields were also further subdivided. The south-eastern field was divided into two fields, (No.137 to the west, and No.139 to the east). The north-eastern field was similarly subdivided into two narrow fields to the east (No.135) and west (No.136). As stated the north-western fields were not subdivided into two units to the east and west as they currently appear, rather they were divided into two fields to the north (No.123) and south (No.127), with an east-west field boundary. The descriptions of the fields in the accompanying tithe apportionments are relatively basic, **with most fields in this area described simply as 'Field', with the exception of field nos.135 and 136, which are named 'East/West Long Forland' respectively, and field no.137, which is named 'Square Park'.** The fields are used as a mixture of arable, pasture and meadow. The fields in this area are divided between several different landowners and occupiers. Within the site boundary those fields named above are owned by Elizabeth Phillipps, occupied by Mary Rofser or Rosser. The fields to the west, and the south-eastern field, are owned by Thomas Davies, with the western fields occupied by Thomas Evans, and the south-eastern field by William Lloyd. Land

to the north and east are owned by the Reverend Thomas Martin, with several further occupiers named for the surrounding fields.

- 5.2.3 The settlement pattern appears largely based around small dispersed roadside farmsteads and dwellings, with only Glanafon Farm to the west set back from the road. To the south lies the village of Prendergast, still centred largely on the banks of the Cleddau and extending as far as the Fishguard Road, Cardigan Road and Shoals Hook Lane road junction. There are no settlements or structures marked within the development site, the closest being Crowsnest to the southwest (owned by the Reverend Martin but occupied by Phillip White), along with the Hermitage which has been built alongside a lane between the Cardigan and Fishguard roads. The Hermitage is owned by Elizabeth Philipps, but is occupied by the seemingly unusual name of St Clair Heslop. A Luke Coates Heslop, surgeon, is recorded as living there in 1846 (PA:D-EE/40/7). Stephens Ford farmstead lies on the roadside to the east, and a further small dwelling, called Pennsylvania House, lies in the northwest corner of the field immediately to the north of the site.
- 5.24 No specific features of archaeological interest are noted within the proposed development area. Traditional boundaries do appear largely preserved within the site area.

### 5.3 *Ordnance Survey 1:2,500 Map of 1889 (Figure 9)*

- 5.3.1 The 1<sup>st</sup> edition Ordnance Survey map of 1889 depicts a very similar landscape to that recorded on the previous tithe map, largely agricultural in nature, but provides a little more detail and accuracy in the layout of the land. The fields within the site area are as depicted on the tithe map, with the addition of an internal north-south boundary within the north-western field, part of the current boundary. The northern part of this field is still subdivided as a separate area, with an area of rough ground depicted, likely to relate to wet ground. Along the boundary between these fields a stone is marked. A similar stone is marked in the field to the east, which relates to the possible Bronze Age standing stone (PRN 13075) that is still visible today. It is not clear if this western stone is a similar feature as it no longer stands. The fields to the east are bounded by hedgerows; a stream runs along the northern edge of the site, and Brandy Lane (and an unenclosed track to The Hermitage) runs along the southern edge of the site.
- 5.3.2 The two stones are the only features of archaeological interest noted within the site area. More detail on the surrounding settlement sites is provided, with **The Hermitage and Crow's Nest to the southwest. Both would appear to be dwellings with some associated farm buildings or surrounding outbuildings. To the northeast lies Stephen's Ford**, a small farmstead arranged alongside the road, with some smaller dwellings along the roadside to the south. To the northwest Pennsylvania House appears to have been removed, although the enclosure is still visible, alongside another marked stone. Small collections of roadside dwellings also appear to be developing along the Fishguard Road out of Prendergast.

#### 5.4 ***Sales Map 1896 (Stephen's Ford)***

- 5.4.1 Various particulars of sale for land in Prendergast parish in 1896 comes with a map attached (PA:HDX/337/35). **Stephen's Ford was one of the areas offered for sale, and** is depicted on the accompanying plans. This land however lies immediately to the east of the site, and depicts nothing of note within the proposed development area.

#### 5.5 *Ordnance Survey 1:2,500 Map of 1907*

- 5.5.1 The 2<sup>nd</sup> edition Ordnance Survey map depicts a very similar landscape, and the fields within the proposed development area remain unchanged. Somewhat less detail is shown on this map, as tree cover along the hedgerows, and the location of the stones, are no longer marked.

#### 5.6 *Ordnance Survey 1:2,500 Map of 1939 (Figure 10)*

- 5.6.1 Prior to the outbreak of the Second World War there appears to be little obvious change within the proposed development area. The site still lies in an agricultural landscape, the field boundaries remain unchanged. Brandy Lane, which formed part of the southern boundary to the site, is no longer apparent on this map. Both **The Hermitage and Crow's Nest to the southwest have expanded the range of farm-buildings or out-buildings that surround the site, and even Stephen's Ford to the north** has expanded slightly. There has also been some extension of development along Fishguard Road, but this appears relatively minor.
- 5.6.2 Nothing of archaeological interest is noted on this map within the development site.

#### 5.7 *Ordnance Survey 1:2,500 Map of 1966*

- 5.7.1 By the mid-1960s there had clearly been a significant change in the surrounding landscape, and although the field boundaries within the site remain largely unchanged with some alterations, buildings are now shown within the fields.
- 5.7.2 These buildings consist of three structures located within the north-eastern field. The field itself has also been amalgamated into a single unit since the previous map. The buildings are located in the southwest corner of the field, and consist of one long rectangular building with an adjacent smaller building, and a small square structure immediately to the north. These buildings are recorded on the regional HER as including a picket post (PRN 28541) and latrine (PRN 28542), belonging to a former military camp (PRN 102563) which was part of the Second World War RAF Haverfordwest site. A similar structure is also shown in the field to the east, presumably associated, but outside the proposed development area.
- 5.7.3 To the north of these buildings the stone, first marked on the 1889 map, is once again depicted. The second stone previously depicted to the northwest is no longer shown, and indeed the field boundary alongside which it stood, also appears to have been removed by this time.

- 5.7.4 Within the wider landscape the site now occupies an area of mixed agriculture, urban and industrial development. Urban development has extended north from Prendergast along the Cardigan and Fishguard roads, alongside which the Withybush Hospital has also been built. To the northwest of the site the Withybush Trading Estate has been established, to the north of which lies the extensive Haverfordwest (Withybush) Aerodrome (first established in the war) and associated with the buildings constructed within the site area.

## 5.8 *Ordnance Survey 1:10,000 Map of 1975-92*

- 5.8.1 The A40 bypass road represents the most significant change to the surrounding landscape in the later 20<sup>th</sup> century; this road links Cardigan Road to the east, and Fishguard Road to the west. This route now forms the southern boundary to the site, and has taken a route just to the north of the previous field boundaries. The two fields in the southeast corner of the site have also become amalgamated into a single unit.

## 6 Aerial Photographs & Lidar (Photos 1 & 2, Figure 11)

- 6.1 Aerial photographic evidence of the area held by the Aerial Photographic Unit in Cardiff has been examined, including photographs from 1946 to the present day.
- 6.2 The available aerial photographs illustrate both the layout of the military camp associated with RAF Withybush to the north, and the abandonment of some internal field boundaries during the later 20<sup>th</sup> century. The layout of the camp is shown in Photos 1 and 2. Photo 1, from 1955, shows a complex of eight or nine buildings within the proposed development area, clustered around the southern edge of the central field, although even by this date most of the structures appear to have been removed and only faint traces of their footings remains. The picket post (PRN 28541) and latrine block (PRN 28542) are visible against the southern edge of the field. In between stand two long rectangular buildings that formed part of the accommodation blocks. To the northeast lie the faint traces of further buildings, comprising two further accommodation blocks, with smaller buildings to the west possibly representing further latrines. A final larger rectangular building also lies against the western field boundary. It is clear that those structures that lie further into the field have already been demolished down to their footings, or in the case of one small building to the west, appear to be roofless. The footings of most of these buildings are still visible on satellite imagery of 2006, with only the picket post (PRN 28541) remaining intact with a roof. What is also clear from aerial photographs is the extent of temporary structures built across this area during the Second World War to house the various units associated with RAF Withybush. A further accommodation block can be seen in the adjacent field to the east (outside the proposed development area), alongside the B3229 (Cardigan Road), in fields to the south and closer to the airfield to the northwest.
- 6.3 Standing stone PRN 13075 is difficult to identify on the aerial photographs, and no features associated with either this site, or the second stone identified from historic mapping, is visible. No further features of archaeological interest are noted from the available aerial photographs.



- 6.4 Lidar DTM data (without building & vegetation cover) and DSM (with building and vegetation cover) is available at 0.5m resolution for this area (Figure 11). This data helps to illustrate the topographical layout of the site area. Field boundaries in the eastern half of the site appear to consist of dense hedgerows, with the stream-line along the northern boundary of the site covered in thick vegetation. The buildings in the centre of the site are visible, but only the two smaller buildings of the three that are depicted on the 1966 OS map. A further, presumably modern, building is also depicted in the southeast corner of the same field. All fields appear to show faint traces of ploughing scars, generally running north-north-east to south-south-west. Other than the buildings, no features of archaeological interest are noted within the site area, and the standing stone is indistinguishable within this data.

## 7 Site Visit (Photos 3 – 20)

- 7.1 A site visit was undertaken on the 26<sup>th</sup> May 2016. Conditions were slightly overcast but dry with good visibility. The site comprises four main fields, all laid to pasture and bounded by hedgerows. At the western end of the site lie two fields subdivided to the east and west by a low hedgerow that gives way to a ditch and wetter ground to the north. The ground falls away slightly to the northwest. The main school building will sit within this area. No features of archaeological interest were identified at this location during the site visit. These fields are bounded to the west by the slightly elevated Withybush Road and a driveway to a private residence. Beyond this lies the Withybush trading estate. To the north lies agricultural land and a further industrial estate. One further field bounds the site to the south, beyond this lies the A40 with dense vegetation along its southern edge and urban development beyond that.
- 7.2 At the southeast end of the site lies a large rectangular field, relatively level but with a gradual slope to the northeast. This field is bounded by further fields to the west, north and east, with the A40 forming the southern boundary. There is a relatively open aspect to the A40, beyond which lies a further field and then the urban development of Prendergast. No features of archaeological interest were identified within this field during the site visit.
- 7.3 In the centre of the site lies a rectangular field containing identified archaeological remains. This field is also relatively level but with a gradual slope towards the north; a small scrub-covered stream runs along the northern boundary. To the north lies further agricultural land, with another field bounding the field to the east, with mature trees along the hedgerow, beyond which lies the B4329 and further agricultural land.
- 7.4 The standing stone (PRN 13075) is located within this central field, slightly to the east of the grid reference given in the HER, located at SM 96226 17457. It consists of an upright stone with a slight lean to the north-east. It stands 1.1m tall, the east and west faces are 0.9m wide at the base with a slightly rounded top. The north and south faces are 0.6m wide tapering to a point towards the top. It is located within a relatively level area, with the ground falling away slightly to the north towards a small stream. There is little evidence from the standing remains alone to closely date this feature. It is of a size, and in a location, that is compatible with a later cattle rubbing stone, but similarly the angular nature of the stone may suggest it represents an earlier standing stone.

- 7.5 The remains of modern brick and concrete structures are clustered along the southern edge of the field, but with many remains currently lost to vegetation cover. The picket post (PRN 28541) would appear to be the best preserved, and still stands as a rectangular brick-built building measuring 7m by 6m, with a concrete floor and corrugated asbestos sheet gable roof. The entrance is in the northeast wall, with a blocked window adjacent. There are two narrow steel-framed windows in the southeast wall. The southwest wall also has two windows; the larger eastern window has been blocked. There is one small window, alongside two blocked doorways and a blocked window in the northwest wall. The roof is deteriorating, and the interior has been cleared of internal features and partitions and used for storage, and the exterior is becoming scrub-covered.
- 7.6 The latrine (PRN 28542) was largely covered in vegetation and could not be examined in detail. The northeast wall indicates it is a simple brick-built structure that was original externally rendered in unpainted concrete, and now appears to be in an advanced state of ruin and roofless. To the west a dense spread of undergrowth hides the concrete and brick footings of further buildings.
- 7.7 Site visits were also made to the surrounding designated archaeological sites, to examine potential visual effects of the proposed development. These are discussed in Section 8 below.

## 8 Impact Assessment

### 8.1 *Assessment of Archaeological Potential and Importance*

- 8.1.1 Four sites of archaeological interest have been recorded on the regional HER lying within the proposed development area. These consist of a standing stone (PRN 13075) that may be Bronze Age in date. At the centre of the site also stand the remains, in varying degrees of survival, of several structures built during the Second World War in association with RAF Haverfordwest (which is located to the north of the development site). These structures include the relatively well-preserved remains of a picket post (PRN 28541) and the partially-standing but roofless and deteriorating remains of a latrine block (PRN 28542). Alongside these are the scrub-covered concrete footings of barrack blocks associated with the larger military camp (PRN 102563). Due to scrub coverage these features could not be closely examined, but these footings are likely to survive in various states of preservation, but are of limited archaeological interest. The locations of these buildings can be identified on aerial photography, and have been labelled as HWMS 02 – 08 on Figure 7.
- 8.1.2 Historical research has also identified the site of a potential second standing stone (HWMS 01) within the proposed development area towards the northwest. The stone itself is no longer present, but associated archaeological remains may survive below ground.
- 8.1.3 No further features of archaeological interest have been identified within the research, however the presence of possible Bronze Age standing stones highlights an increased potential for possible archaeological finds, features or deposits associated with Bronze Age activity to be present. This archaeological potential is referenced HWMS 09 for the purposes of this report (and is not represented on Figure 7).

## 8.2 *Previous Impacts*

- 8.2.1 The site has been in agricultural use since at least the early 19<sup>th</sup> century and probably long before that date. During this time it is clear the site has been ploughed, and continued agricultural activity has led to the removal of some field boundaries and the site of a possible standing stone.
- 8.2.2 The only structures identified in the development site area are the WWII barracks blocks, latrines and a picket post noted above. These buildings all appear to have been built off concrete footings, so modern ground disturbance within and around these structures is likely. The Second World War structures are located within the central area of the site; there is no evidence for development in the remaining parts of the site.

## 8.3 *Potential Impacts of the Proposed Development*

- 8.3.1 The proposed development includes the construction of a new school building, along with sports pitches, landscaping and associated infrastructure. Any of the following activities associated with the proposed development could therefore expose, damage or destroy archaeological remains:
- **Enabling works, such as installation of contractor's compound, construction of access roads, parking area, storage areas, borrow pits and associated services;**
  - Landscaping and terracing works;
  - Surface stripping;
  - Foundation excavations;
  - Construction of roads and infrastructure;
  - Service installation
- 8.3.2 The proposed development also has the potential to generate indirect (visual) effects on archaeological sites, such as altering the visual setting or tranquillity of the sites and landscapes.

### *Historic Landscapes*

- 8.3.3 No registered Historic Landscape, Conservation Area or Historic Park & Garden will be directly affected by the proposed development.
- 8.3.4 Milford Haven Waterway Landscape of Outstanding Historic Interest (HLW (D) 3) lies within 200m to the south of the site, with two associated Historic Landscape Character Areas (HLCAs) lying within 2km of the proposed development site, namely HLCA 309 Haverfordwest and HLCA 327 Uzmaaston and Boulston. HLCA 327 lies some distance to the southwest, and the proposed development will have no visual impact on this area. HLCA 309 is drawn around the urban limits of Haverfordwest. The addition of a new school can be seen as an extension to this HLCA, and affecting the rural setting surrounding the town. However, the new school building will lie in an area of modern development on the fringes of the urban centre and will not alter the main characteristics of this area, also it does not affect any important views of the HLCA. The proposed development is considered to have a negligible indirect (visual) impact.

- 8.3.5 The site lies within the Landmap historic landscape area of Crundale (PMBRKHL46209). This is valued as **an area of 'moderate' value**, with the description of the main character elements highlighting modern settlement, a nucleated centre at Crundale, late post-medieval roadside ribbon settlement and more scattered informal farms. Surrounding these settlements is a distinct area of medium-sized regular field enclosures with possible medieval origins. The proposed development will have a direct impact by changing the use of some of these field enclosures to modern development, which is more in character with the neighbouring Landmap area drawn around the same area, with the same criteria, as HLCA 309 Haverfordwest. The core of these field enclosures are centred on Crundale, this area lies on the periphery. Therefore the proposed development is considered to have a minor direct and indirect impact on this Landmap historic landscape area.
- 8.3.6 Haverfordwest Conservation Area lies just over 1.4km to the southwest. There will be no visual relationship between this area and the site however, and the proposed development is considered to have only a negligible indirect impact on the wider urban setting around the Conservation Area.

#### Scheduled Ancient Monuments

- 8.3.6 No Scheduled Ancient Monument (SAM) will be directly affected by the proposed development.
- 8.3.7 To the west lies Crowhill Rath (PE218), however views towards the proposed development site are blocked by areas of vegetation and woodland and therefore there will be no impact on this site.
- 8.3.8 To the northwest lies Cottesmore Farm Pit Circle (PE462), but any visual relationship is blocked both by trees around the SAM site, and by the intervening development of Withybush Trading Estate. Haverfordwest castle (PE366) occupies a prominent position in Haverfordwest to the southwest, however, any visual relationship is blocked by the urban development of Prendergast. Leachpool Round Barrow (PE356) lies to the northeast, however, thickly wooded hedgerows and modern development in Crundale on one side and Withybush Trading Estate on the other serves to prevent any visual relationship between the two sites. The development will therefore have no indirect (visual) impact on surrounding SAM sites.

#### Listed Buildings

- 8.3.9 No listed buildings will be directly affected by the proposed development.
- 8.3.10 There are 242 Listed Buildings within the 2km search area around the proposed development site. However, the vast majority of these buildings are located within the dense urban setting of Haverfordwest to the southwest and are not visible from the site, nor is the proposed development considered to impact upon the settings of these buildings.
- 8.3.11 To the west lies Glanafon (LB 26984), the closest Listed Building, and Prendergast Mill (LB 13037) and Bridge (LB 13038). The sites are separated from the proposed development both physically and visually by topography, vegetation cover and development around Withybush Trading Estate and the A40/Withybush Road roundabout.

- 8.3.12 To the northwest lies Cottessmore House and associated buildings (LBs 12002, 26980, 26981 & 26982). All views towards the proposed development area are blocked by woodland, and intervening modern development. To the north lies Plas Gwyn (LB 26983) but this house has a northerly aspect, and intervening views are also blocked by vegetation and **urban development. To the northeast lies Fiddler's Hall (LB 26985)**, with intervening views blocked by the village of Crundale. To the southeast lies a milestone (LB 82965) on the A40, with no views of the proposed development.
- 8.3.13 The proposed development is considered to have no indirect (visual) impact on any Listed Building or their settings.

*Non-designated Archaeological Sites*

- 8.3.14 Eleven individual non-designated sites of archaeological interest have been identified within the proposed development boundary. A standing stone (PRN 13075), possibly Bronze Age in origin, and a series of buildings (PRNs 28541, 28542, HWMS 02 - 08), some standing, some reduced to concrete footings, but all built in the 1940s as part of a military camp (PRN 102563) and associated with RAF Haverfordwest, all stand in relatively close proximity in an area of proposed playing field development. This area is likely to see landscaping works that will have a major direct impact on these sites resulting in their removal as part of the development works. Such work is also likely to have a direct impact on any potential buried archaeological remains associated with these sites.
- 8.3.15 To the northwest the site of a second standing stone (HWMS 01) has been identified from historic mapping. No above ground evidence of this site remains, and its provenance is untested. However, it may be associated with Bronze Age activity and further archaeological remains may survive below ground. This lies close to the location of the main school building, it is likely therefore that development works will have a major direct impact on any below-ground remains associated with this site, should they exist.
- 8.3.16 The existence of probable potential Bronze Age monuments in the proposed development area highlights the potential for further Bronze Age archaeological remains to be present below-ground in this area (HWMS 09). As such proposed development works have the potential to have a direct impact on any remains should they exist.

Table 1: Potential impacts.

Reference	Site type	Location	Level of impact
PRN 13075	?Bronze Age Standing Stone	SM 9624 1746	Major
PRN 28541 (pt of PRN 102563)	WWII Picket Post	SM 1919 1742	Major
PRN 28542 (pt of PRN 102563)	WWII Latrine Block	SM 9626 1738	Major
HWMS 01	Standing Stone (location)	SM 9618 1759	Major
HMWS 02 (pt of PRN 102563)	WWII Accommodation Block (footings)	SM 9624 1742	Major
HWMS 03 (pt of PRN 102563)	WWII Accommodation Block (footings)	SM 9626 1742	Major
HWMS 04 (pt of PRN 102563)	WWII Accommodation Block (footings)	SM 9622 1741	Major
HWMS 05 (pt of PRN 102563)	WWII Accommodation Block (footings)	SM 9625 1740	Major
HWMS 06 (pt of PRN 102563)	WWII ?Latrine Block (footings)	SM 9623 1742	Major
HWMS 07 (pt of PRN 102563)	WWII ?Latrine Block (footings)	SM 9621 1744	Major
HWMS 08 (pt of PRN 102563)	WWII ?Accommodation Block (not visible)	SM 9620 1744	Major
HMWS 09	Archaeological potential – Bronze Age	Across site	Moderate
HLCA 309 Haverfordwest	Registered Historic Landscape Character Area	Haverfordwest	Negligible
Crundale (PMBRKHL46209)	Landmap historic landscape area	Across site	Minor

## 9 Conclusions

### 9.1 Impacts

9.1.1 No Scheduled Ancient Monument or Listed Building will be directly or indirectly affected by the proposed development.

9.1.2 No Registered Historic Landscapes, Conservation Areas or Listed Historic Parks & Gardens will be directly affected by the proposed development. The site lies adjacent to HLCA 309 Haverfordwest, part of the registered Historic Landscape of Milford Haven Waterway (HLW (D) 3). There will be a negligible indirect impact on this landscape, largely through the slight expansion of the urban limits into the surrounding rural setting. The site lies within the Landmap Historic Landscape area of Crundale (PMBRKHL46209). The development will have a minor direct and indirect (visual)

impacts on this landscape by removing a small element of the enclosed fields that form a characteristic of this landscape.

- 9.1.3 Eleven sites of specific archaeological interest have been identified within the proposed development site. These comprise a standing stone (PRN 13075), potentially Bronze Age in date, and the location of a second removed stone (HWMS 01). Alongside this are the remains of numerous structures that form a former accommodation area (PRN 102563) associated with the Second World War airfield to the north. These structures are individually identified as the standing remains of a picket post (PRN 28541), the ruinous standing remains of a latrine block (PRN 28542), and the scrub-covered concrete footings of four or five accommodation blocks and further latrines (HWMS 02 – 08). Alongside these specific sites, the presence of possible Bronze Age standing stones highlights a general potential for Bronze Age archaeological remains to exist within the site area (HWMS 09).
- 9.1.4 The standing stone (PRN 13075) and all elements of the WWII accommodation area (PRN 102563) lie in an area that is likely to see ground levelling works to create sports pitches, which will likely result in the removal of all elements of these remains. Similarly, the site of the second standing stone (HWMS 01) lies within the footprint of the proposed school building, which will likely result in the disturbance of associated archaeological remains, should they exist. The proposed development is therefore considered to have a major impact on these sites. General development work throughout the area is considered to have a moderate impact on the general archaeological potential (HWMS 09).

## 9.2 *Mitigation*

- 9.2.1 Preservation *in situ* is the preferred response for sites of archaeological interest, however development proposals for this site are likely to have a direct impact on all features identified within the report, with the disturbance or removal of many of these features, and therefore preservation through record is recommended.
- 9.2.2 The structures relating to the WWII accommodation (PRNs 28541 & 28542, and HWMS 02 – 08) were built as temporary brick-built structures in the early to mid-1940s. Only two survive as upstanding structures (PRNs 28541 & 28542), both of which are deteriorating, and the remainder survive only as concrete footings. These sites are considered to be of low archaeological value, given the largely poor state of preservation and limited features of interest within the two remaining standing structures. It is recommended therefore that a photographic survey of the Picket Post and Latrine block (PRNs 28541 & 28542) and plan of the structures be undertaken prior to their removal, but subsequent to vegetation removal around the structural remains. This is to ensure their preservation by record.
- 9.2.3 The date and relative importance of the standing stone PRN 13075 and site of a second standing stone HWMS 01, along with the extent of any associated below features and potential archaeological remains HWMS 09, is not yet fully understood. It is likely that further information on their extent, date and relative importance may be requested prior to any development works being undertaken that may affect these remains. It is suggested that a geophysical survey is initially undertaken in order to help determine

the presence or absence of below-ground archaeological remains. Subsequent to this, intrusive archaeological evaluation at the standing stone PRN 13075 and any features identified through geophysical survey (including the site of the second standing stone HWMS 01) may be required to help ascertain the date, extent and relative importance of any archaeological remains. The archaeological investigation would, in particular, clarify if Standing Stone PRN 13075 will need to be retained within the development site.

- 9.2.4 Information gained from these archaeological investigations will help to inform future decision making and any further archaeological mitigations measures that may be required in order to ensure complete preservation through record prior to the loss of archaeological features. Archaeological evaluation work is intended only to identify archaeological features, and therefore more complete excavation would be required should identified features need to be removed to allow development. The scope and extent of any such archaeological work, including any preliminary geophysical survey and evaluation works, should be agreed with the local planning authority and their relevant archaeological advisors prior to any work being undertaken.



## 10 Sources

- Cadw, CCW & ICOMOS UK. 1998, *Register of Landscapes of Historic Interest in Wales*.
- Edwards, S. 2001, *The Story of Milford Haven Waterway*, Almeley; Logaston Press.
- Hall, J. & Sambrook, P. 2012, *Heartlands Hub Heritage and Natural Environment Audit*.
- Jones, I. 2007, *Airfields and Landing Grounds of Wales: West*.
- Lewis, S. 1833, *A Topographical Dictionary of Wales*, London.
- Meek, J. & Wilson, H. 2013, *Archaeological Investigations at Wiston Roman Fort, Pembrokeshire: Interim Report*, Dyfed Archaeological Trust Report No.2013/70.
- Miles, D. (ed). 1999, *A History of Haverfordwest*, Gomer Press; Llandysul.
- Phillips, A. 2006, *Military Airfields Wales*.
- Poucher, P. 2008, *Milford Haven Waterway Ports & Harbours Project*, Dyfed Archaeological Trust Report No. 2008/38.
- Poucher, P. 2015, *Shoals Hook Farm, Haverfordwest: Archaeological Strip, Map & Sample* Archaeology Wales Report No.1325.
- Pyper, A. & Page, M. 2012, *Twentieth Century Military Sites: Airfields*, Dyfed Archaeological Trust Report No.2011/48.
- Thomas, R.J.C. 1993, *Survey of 19<sup>th</sup> and 20<sup>th</sup> Century Military Buildings of Pembrokeshire*.
- Williams, G. 1988, *The Standing Stones of Wales and South-West England*, BAR British Series, Vol.197.

### Archives

#### *Pembrokeshire Record Office*

- HAR/SE/21/17 *Particulars and Conditions of Sale of lands in the parish of Prendergast* 1856
- HDX/337/35 *Particulars of sale: **Stephen's Ford*** 1896
- PCC/SE/103/1659 *Road improvements for RAF Withybush* 1943
- D-RTP/GLA/63 *List of properties of John Lloyd Davies in mortgage to the trustees of David Morgan Lloyd* 1907

### Maps

- Anon. 1843, *Prendergast Parish Tithe Map & Apportionments*
- British Geological Survey. 2016, *Geology of Britain Viewer* - (accessed 20/6/16)
- Bowen, E. 1729, *Map of South Wales*
- Budgen, T. 1810, ***Ordnance Survey Original Surveyors' Drawings**, Haverfordwest*
- 
- |                 |      |  |
|-----------------|------|--|
| Ordnance Survey | 1889 | <i>1<sup>st</sup> edition 1:2,500 map, Pembrokeshire</i> |
| Ordnance Survey | 1907 | <i>2<sup>nd</sup> edition 1:2,500 map, Pembrokeshire</i> |
| Ordnance Survey | 1939 | <i>3<sup>rd</sup> edition 1:2,500 map, Pembrokeshire</i> |
| Ordnance Survey | 1966 | <i>1:2,500 map, Pembrokeshire</i>                        |

Ordnance Survey      1975-93      *1:10,00 map, Pembrokeshire*

Rees, W. 1932, *South Wales and the Borders in the 14<sup>th</sup> century*

### *Aerial Photographs*

Royal Air Force	1946	Vertical Aerial Photographs – 106G UK 1625, frame 3376
Royal Air Force	1946	Vertical Aerial Photographs – 106G UK 1472, frame 3349
Royal Air Force	1948	Vertical Aerial Photographs – CPE UK 2500, frame 40410140
Royal Air Force	1950	Vertical Aerial Photographs – 541 RAF 543 RX, frame 3220
Royal Air Force	1960	Vertical Aerial Photographs – 58 RAF 4020
Meridian Airmaps	1955	MAL 178/55, frame 25556
Ordnance Survey	1963	Vertical Aerial Photographs – OS 63 178, frames 35 & 51
Ordnance Survey	1970	Vertical Aerial Photographs – OS 70 394, frames 142
Ordnance Survey	1974	Vertical Aerial Photographs – OS 74 212, frames 87
Ordnance Survey	1989	Vertical Aerial Photographs – OS 89 280, frames 8
Ordnance Survey	1970	Vertical Aerial Photographs – OS 70 394, frames 142
JA Story (NRSC)	1983	Frames 5783: 675
Geonex (NRSC)	1992	Frames 5492: 147
Google Earth	2006/2009/2016	Satellite imagery



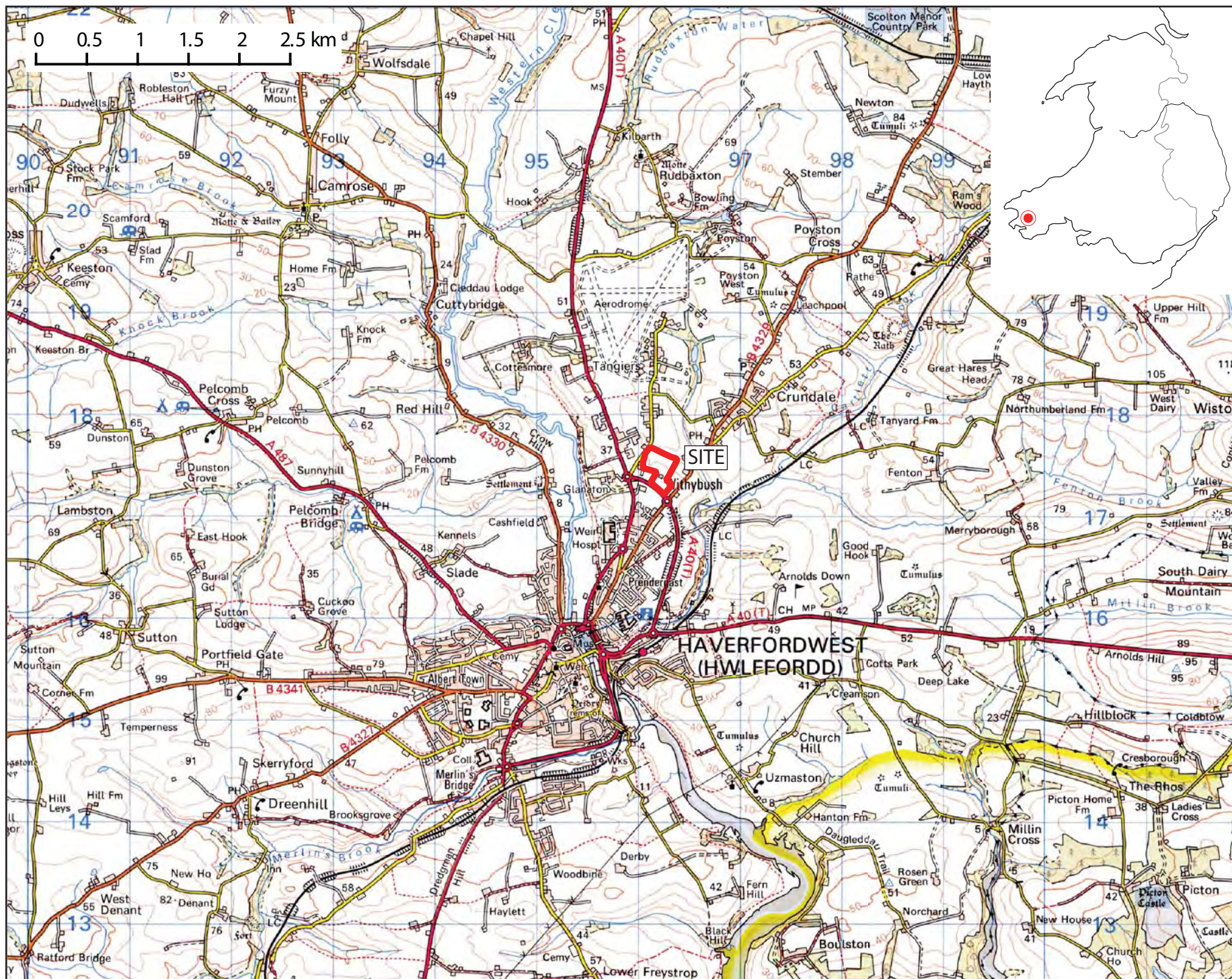

Figure 1: Location map,  
1:50,000 @ A4

The Ordnance Survey has granted Archaeology Wales Ltd a Copyright Licence (No. 100055111) to reproduce map information; Copyright remains otherwise with the Ordnance Survey



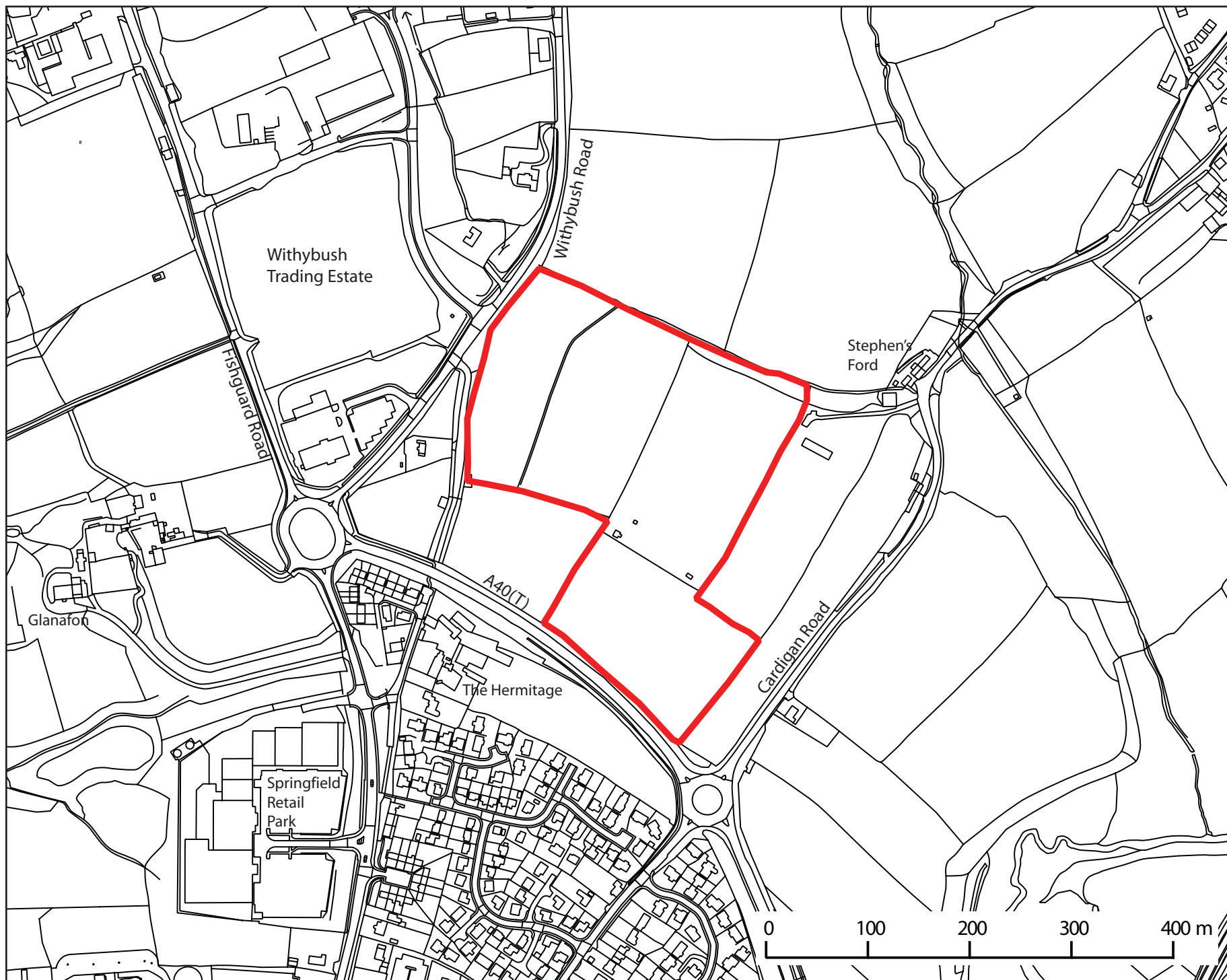
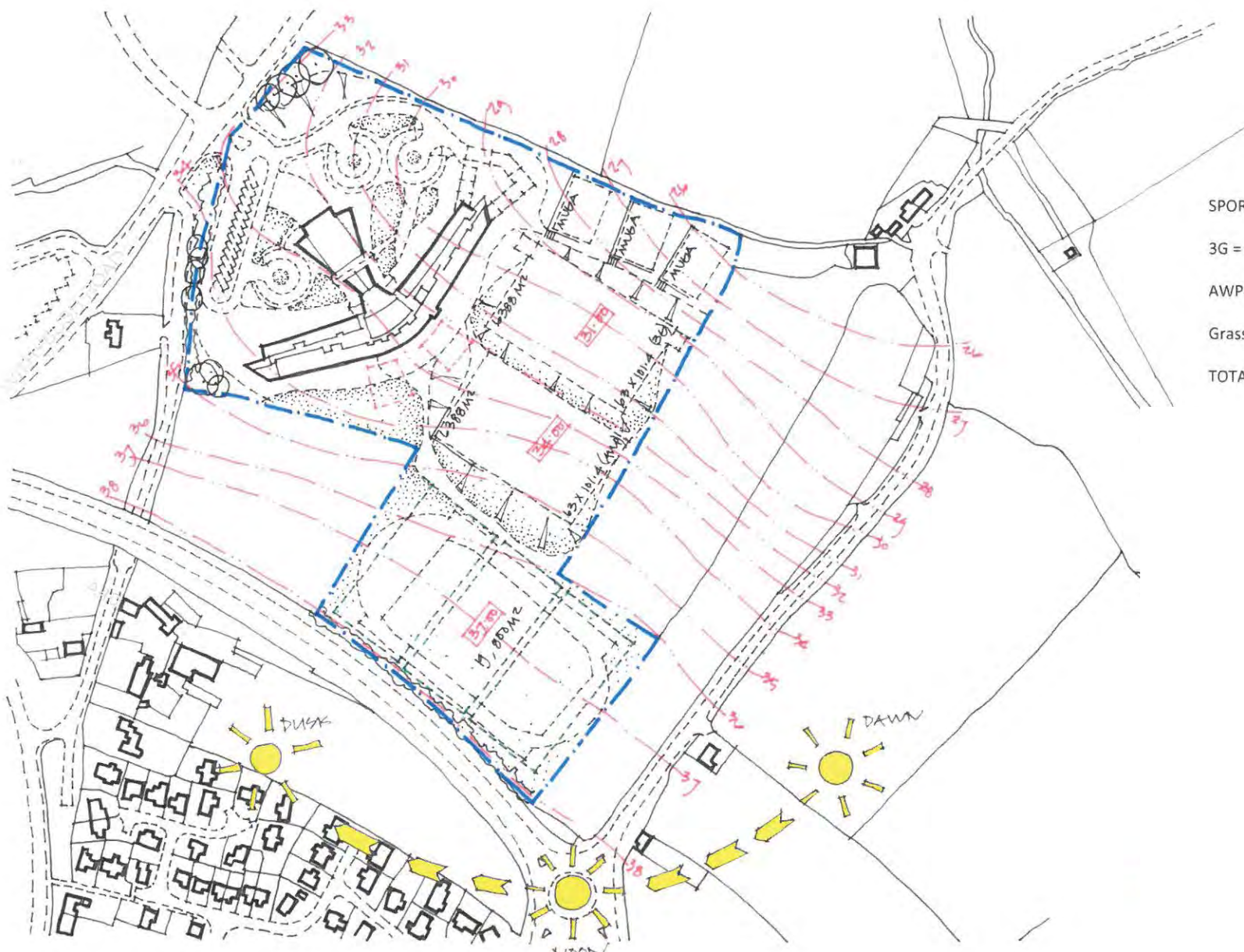

Figure 2: Site boundary plan,  
1:5000 @ A4

The Ordnance Survey has granted Archaeology Wales Ltd a Copyright Licence (No. 100055111) to reproduce map information; Copyright remains otherwise with the Ordnance Survey

# SKETCH SITE LAYOUT PLAN



## SPORTS PITCHES:

3G = 6388 x 2 = 12, 776

AWP= 6388 x 2 = 12, 776

Grass = 19, 800

TOTAL: 45, 352

Figure 3: Initial sketch plan of proposed development.  
Plan produced by  
Stride Treglown



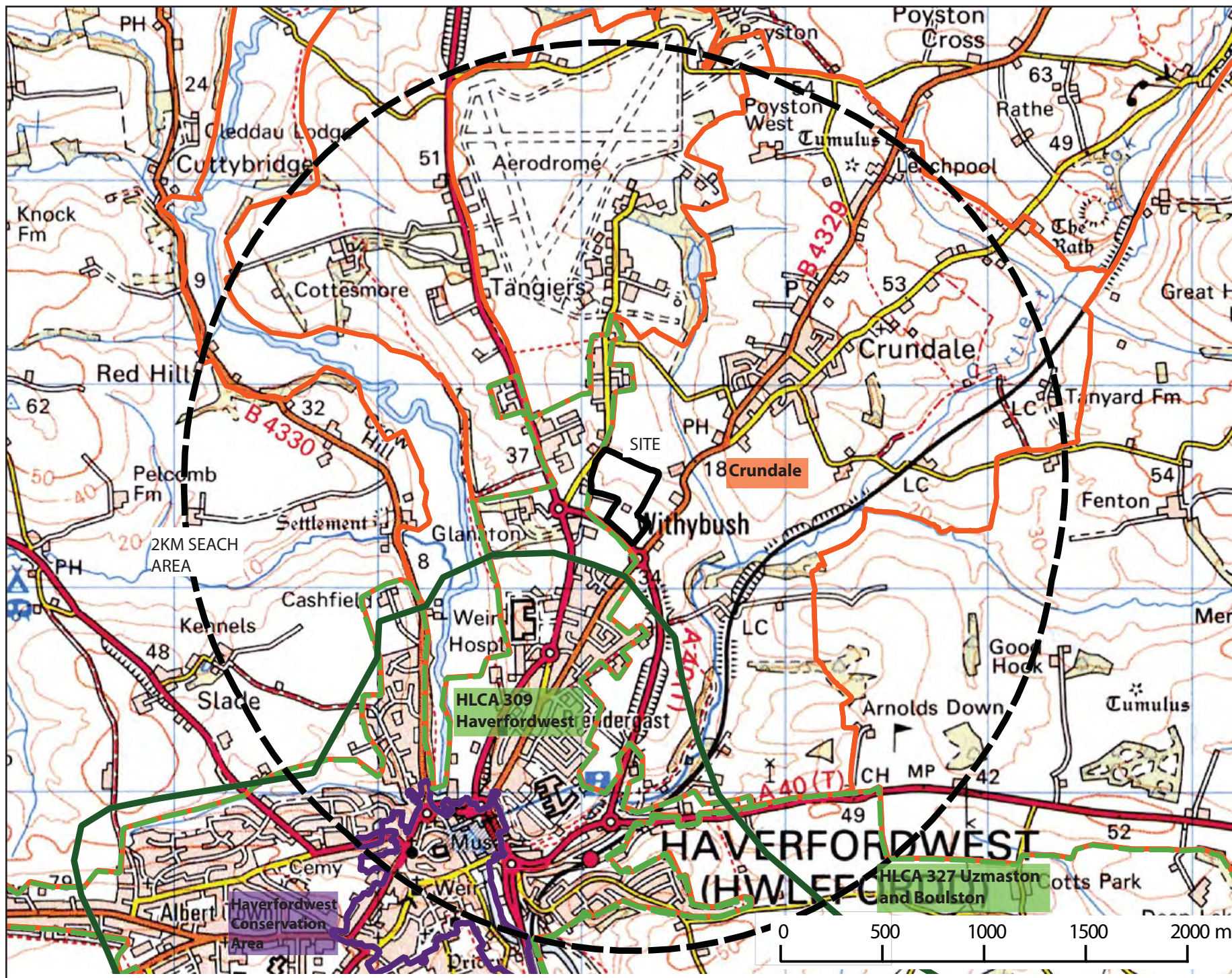

- Registered Historic Landscape - Milford Haven Waterway
- Historic Landscape Character Area
- Conservation Areas
- Landmap Historic Landscape Areas

Figure 4: Designated archaeological areas and Landmap Historic Landscapes within a 2km search area around the proposed development site.

1:25,000 @ A4

The Ordnance Survey has granted Archaeology Wales Ltd a Copyright Licence (No. 100055111) to reproduce map information; Copyright remains otherwise with the Ordnance Survey



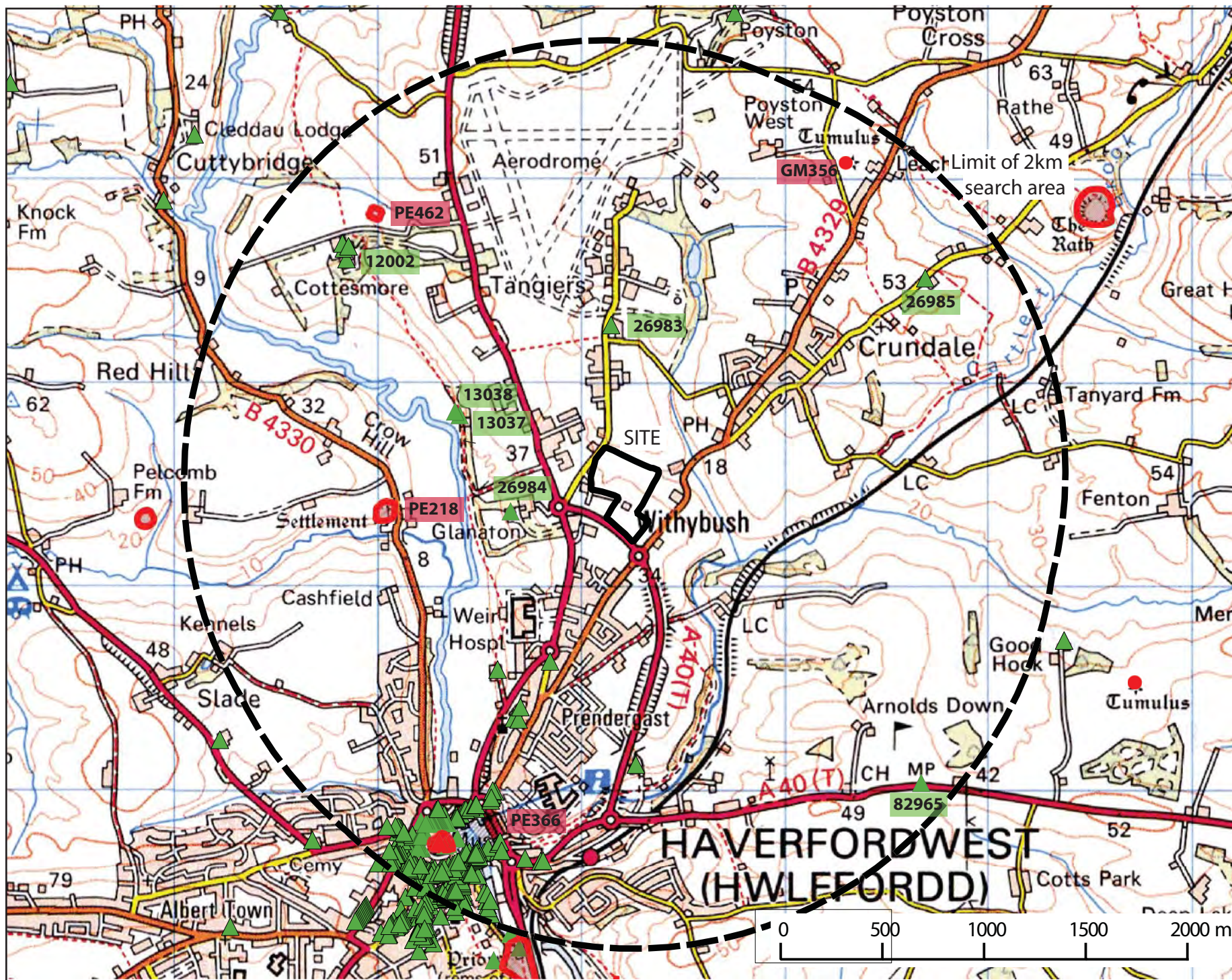



-  Scheduled Ancient Monument
-  Listed Building

Figure 5: Designated archaeological sites within a 2km search area, labelled by reference numbers given in the main text.

1:25,000 @ A4

The Ordnance Survey has granted Archaeology Wales Ltd a Copyright Licence (No. 100055111) to reproduce map information; Copyright remains otherwise with the Ordnance Survey



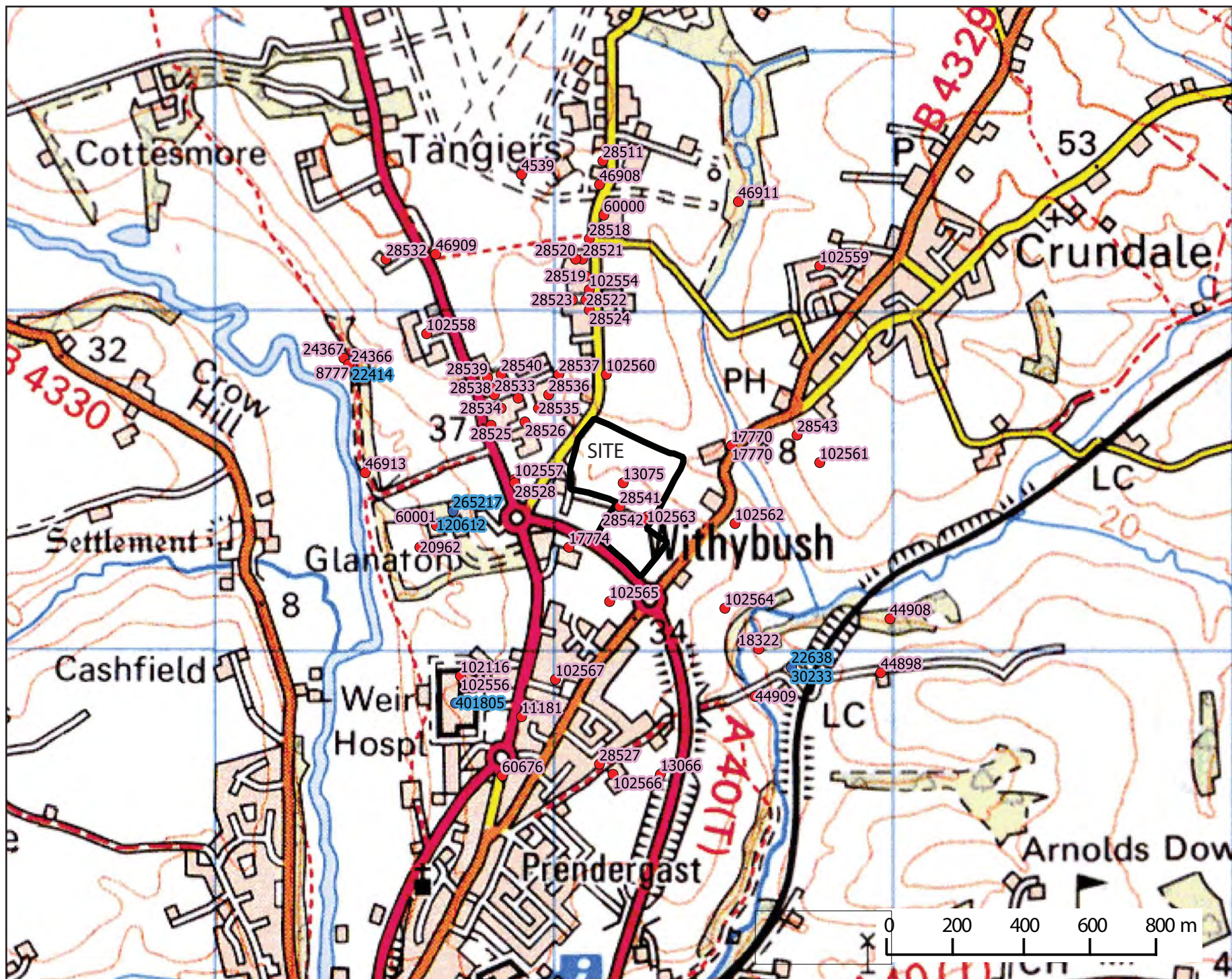

- Site recorded on the HER
- Additional site recorded on the NMR

Figure 6: Non-designated archaeological sites within a 1km search area, labelled by reference numbers given in the main text.  
1:15,000 @ A4

The Ordnance Survey has granted Archaeology Wales Ltd a Copyright Licence (No. 100055111) to reproduce map information; Copyright remains otherwise with the Ordnance Survey



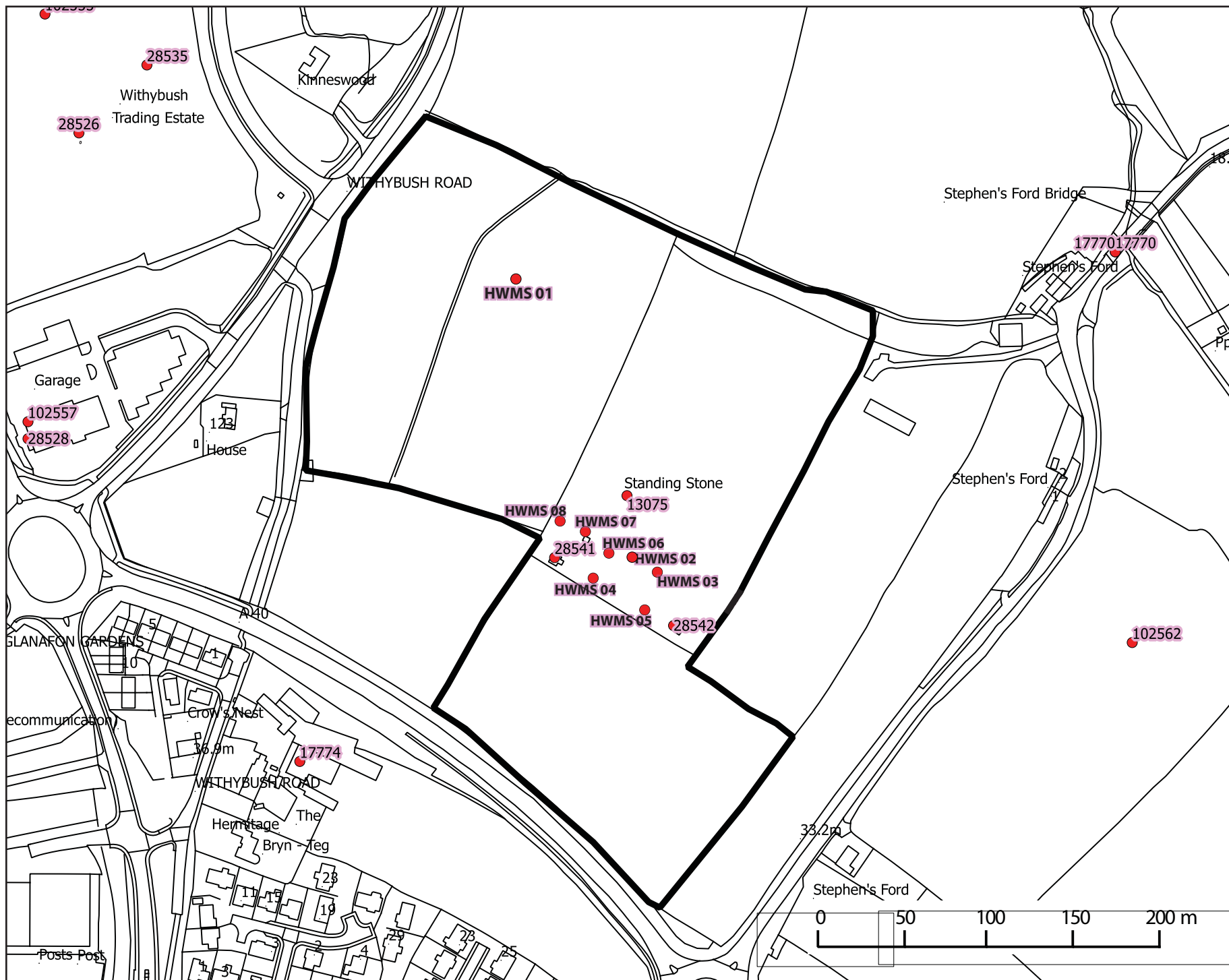

Figure 7: Identified archaeological sites within the proposed development area. Sites labelled by references given in the main text.

1:3000 @ A4

The Ordnance Survey has granted Archaeology Wales Ltd a Copyright Licence (No. 100055111) to reproduce map information; Copyright remains otherwise with the Ordnance Survey

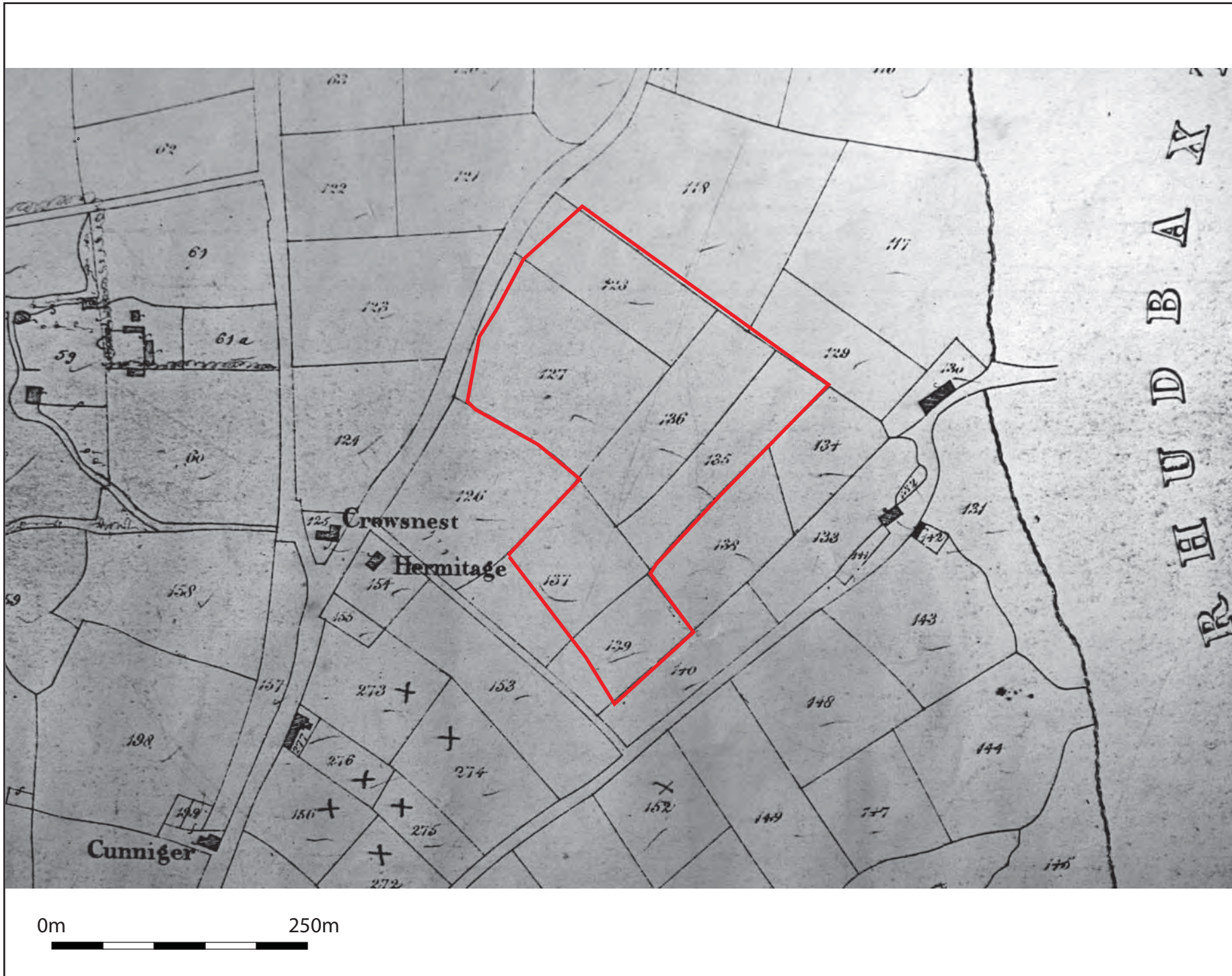

Figure 8: Extract from the Prendergast parish tithe map of 1843. Approximate outline of proposed development area highlighted in red.



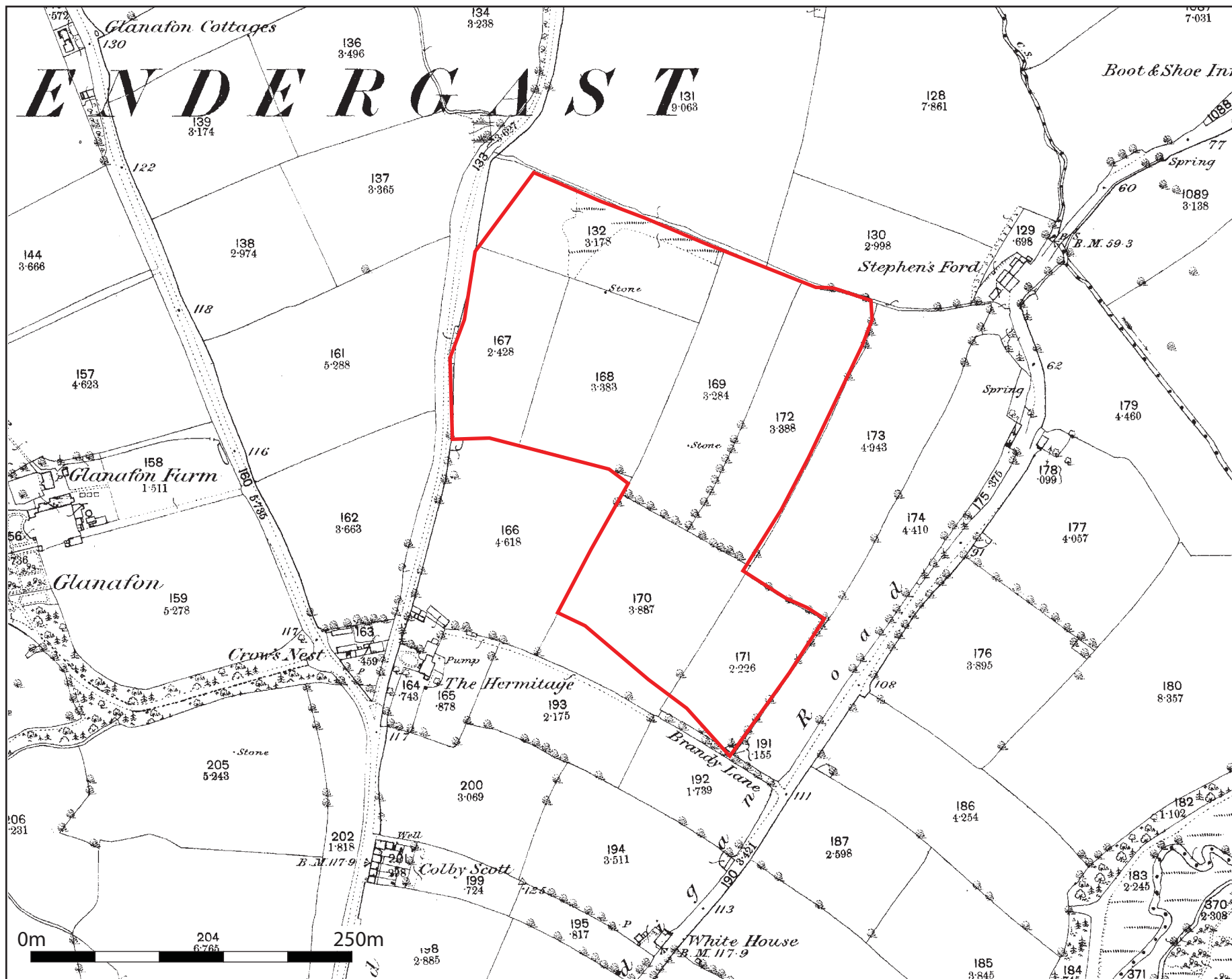

Figure 9: Extract from the 1st edition Ordnance Survey 1:2500 map of Pembrokeshire, dated 1889. Approximate outline of proposed development area highlighted in red.

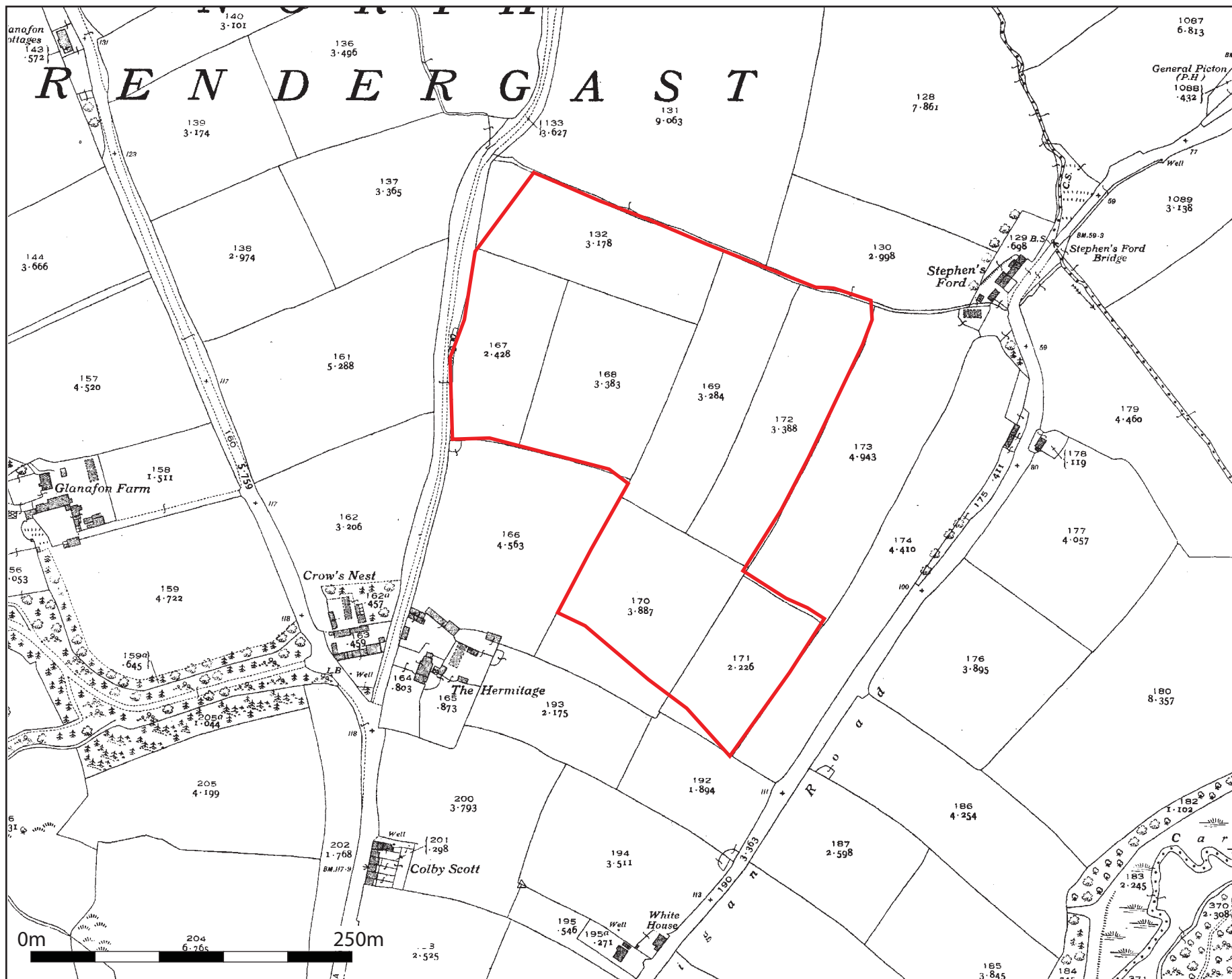

Figure 10: Extract from the 3rd edition Ordnance Survey 1:2500 map of Pembrokeshire, dated 1939. Approximate outline of proposed development area highlighted in red.



Figure 11: Lidar 1m DTM.  
Approximate outline of  
proposed development  
highlighted in red.

Contains Natural Resources  
Wales information  
© Natural Resources Wales and  
Database Right.  
All rights Reserved.





Photo 1: Aerial photograph from 1955 of the proposed development area, showing the layout of WWII structures (PRNs 28541, 28542, HWMS 02 – 08) within the centre of the site.



Photo 2: Satellite imagery taken from Google earth 2006, showing the locations of the buildings and building footings (PRNs 28541, 28542, HWMS 02 – 08) within the centre of the site.



Photo 3: Fields at the western end of the site, taken from the southeast corner facing north.



Photo 4: Fields at the western end of the site, taken from the southeast corner facing northwest.





Photo 5: The boundary between the two western fields facing south-southwest, showing the hedgerow with ditch to the north.



Photo 6: Field at the southeast end of the site, taken from the northwest corner, facing southeast.





Photo 7: Field at the southeast end of the site, taken from the southwest corner, facing northeast.



Photo 8: View northeast of standing stone PRN 13075 within the central field. 1m scale.





Photo 9: View northeast of standing stone PRN 13075, 1m scale.



Photo 10: View east of the exterior of Picket Post PRN 28541





Photo 11: Internal view of Picket Post PRN 28541, northeast wall. 1m scale.



Photo 12: Internal view of Picket Post PRN 28541, southeast wall. 1m scale.





Photo 13: Internal view of Picket Post PRN 28541, southwest wall. 1m scale



Photo 14: Internal view of Picket Post PRN 28541, northwest wall. 1m scale





Photo 15: Southeast view of latrine block PRN 28542.



Photo 16: Southwest view of latrine block PRN 28542.





Photo 17: Southwest view of remains of barrack block HWMS 05. 1m scale.



Photo 18: Southwest view of barrack blocks HWMS 05 and HWMS 03, with latrine PRN 28542 to the left.





Photo 19: View towards site from Crowhill Rath (SAM PE 218). Site not visible.



Photo 20: View towards site from Haverfordwest Castle (SAM PE 366), site not visible.

# *Archaeology* *Wales*

## **APPENDIX I: HER Gazetteer**





## **HISTORIC ENVIRONMENT RECORD INFORMATION**

Prepared by Felicity Sage, Dyfed Archaeological Trust

Produced for Philip Poucher from the Regional Historic Environment  
Record:

Dyfed Archaeological Trust, Corner House, 6 Carmarthen Street,  
Llandeilo, Carmarthenshire, SA19 6AE

Tel (01558) 823131 , Email [info@dyfedarchaeology.org.uk](mailto:info@dyfedarchaeology.org.uk)

Pdf file produced - 14.06.16 - from DAT HER, **DAT enquiry number  
782.**

**Use of this information is subject to the terms and conditions of  
access to Welsh HER data published on DAT's website**

[www.dyfedarchaeology.org.uk](http://www.dyfedarchaeology.org.uk)

## **HISTORIC ENVIRONMENT FEATURES**

[Search criteria:](#)

Please could I have a gazetteer and GIS information for all HER data  
within a 1km radius of SM 9624 1751

A search of the regional Historic Environment Record (HER) held by the Dyfed Archaeological Trust has identified the following historic environment features. These are listed and described below. Each feature is allocated a Primary Reference Number (PRN) that should be quoted in any correspondence. Where the identification of a site is not certain then all possible interpretations are given in the type field e.g. 'enclosure, henge'. Possible date ranges are also shown in this way in the period field. If a field contains no information then it is either not recorded, not known or not applicable for that site.

Please contact the HER if you have any further questions regarding this information, if you would like any of the sources followed up or if you have information that could improve these records in any way.

Source prefixes:

Ph = Published, historic (pre-1900)

Mh = Unpublished, historic

Pm/Mm = Published/Unpublished modern (post-1899)

Desc Text = Descriptive text.

GP/AP = Ground photograph/Aerial photograph.

All other source types should be self-explanatory; please contact the HER if you require assistance with them.

**PRN** 102116 **NAME** RAF HAVERFORDWEST  
**TYPE** Sick Quarters **PERIOD** Modern  
**NGR** SM95721692 **COMMUNITY** Rudbaxton  
**CONDITION** Near Destroyed **STATUS** *None recorded* **EVIDENCE**

#### **SUMMARY**

Site No.4. Used as a hospital until the early 1970's. Demolished

#### **DESCRIPTION**

#### **SOURCES**

#### **OTHER SOURCES**

---

**PRN** 102554 **NAME** RAF HAVERFORDWEST SITE NO 2  
**TYPE** Military Training Site **PERIOD** Modern  
**NGR** SM96101806 **COMMUNITY** Rudbaxton  
**CONDITION** Various **STATUS** *None recorded* **EVIDENCE** Complex

#### **SUMMARY**

RAF Haverfordwest Site No 2 (Instructional) is identified on the Haverfordwest Site Record Plan 4733/44. Here training was undertaken in Turret Instructional building PRN 28518. When visited in 2013 other buildings were also surviving. A Pyper 2013.

#### **DESCRIPTION**

## SOURCES

### OTHER SOURCES

Plan Air Ministry 1944 Haverfordwest Record Site Plan Sites No.2 - No 15 (dispersed)

Plan Air Ministry 1944 Haverfordwest Record Site Plan Site No.1 (Airfield site) 4732/44

---

**PRN** 102555 **NAME** RAF HAVERFORDWEST SITE NO 3

**TYPE** Military Camp **PERIOD** Modern

**NGR** SM95891774 **COMMUNITY** Rudbaxton

**CONDITION** Near Destroyed **STATUS** *None*

*recorded* **EVIDENCE** Complex

## SUMMARY

RAF Haverfordwest Site No 3 (Communal) is identified on the Haverfordwest Site Record Plan 4733/44. Here barrack huts and recreational facilities were provided for the airmen and women of RAF Haverfordwest. When visited in 2013 only one surviving building was identified. A Pyper 2013.

## DESCRIPTION

## SOURCES

### OTHER SOURCES

Plan Air Ministry 1944 Haverfordwest Record Site Plan Sites No.2 - No 15 (dispersed)

---

**PRN** 102556 **NAME** RAF HAVERFORDWEST SITE NO 4

**TYPE** Military Hospital **PERIOD** Modern

**NGR** SM95721692 **COMMUNITY** community

**CONDITION** Destroyed **STATUS** *None recorded* **EVIDENCE** Complex

## SUMMARY

RAF Haverfordwest Site No 4 (Sick Quarters) is identified on the Haverfordwest Site Record Plan 4733/44. Here the sick quarters barrack huts and mortuary stood. The site has been completely destroyed and is now occupied by Withybush General Hospital. A Pyper 2013.

## DESCRIPTION

### SOURCES

#### OTHER SOURCES

Plan Air Ministry 1944 Haverfordwest Record Site Plan Sites No.2 - No 15 (dispersed)

---

**PRN** 102557 **NAME** RAF HAVERFORDWEST SITE NO 5

**TYPE** Military Camp **PERIOD** Modern

**NGR** SM95881750 **COMMUNITY** community

**CONDITION** Near Destroyed **STATUS** *None*

*recorded* **EVIDENCE** Complex

### SUMMARY

RAF Haverfordwest Site No 5 is identified on the Haverfordwest Site Record Plan 4733/44. Here stood barrack huts for Airmen and officers. When visited in 2013 the site had been completely cleared. A Pyper 2013.

## DESCRIPTION

### SOURCES

#### OTHER SOURCES

Plan Air Ministry 1944 Haverfordwest Record Site Plan Sites No.2 - No 15 (dispersed)

---

**PRN** 102558 **NAME** RAF HAVERFORDWEST SITE NO 6

**TYPE** Military Camp **PERIOD** Modern

**NGR** SM95621793 **COMMUNITY** community

**CONDITION** Destroyed **STATUS** *None recorded* **EVIDENCE** Complex

### SUMMARY

RAF Haverfordwest Site No 6 is identified on the Haverfordwest Site Record Plan 4733/44. Here stood barrack huts for airmen, sergeants and officers. When visited in 2013 the site had previously been cleared and redeveloped. A Pyper 2013.

## DESCRIPTION

### SOURCES

#### OTHER SOURCES

Plan Air Ministry 1944 Haverfordwest Record Site Plan Sites No.2 - No 15 (dispersed)

---

**PRN** 102559 **NAME** RAF HAVERFORDWEST SITE NO 7

**TYPE** Military Camp **PERIOD** Modern

**NGR** SM96781813 **COMMUNITY** community

**CONDITION** Destroyed **STATUS** *None recorded* **EVIDENCE** Complex

### SUMMARY

RAF Haverfordwest Site No 7 is identified on the Haverfordwest Site Record Plan 4733/44. Here stood barrack huts for airmen, sergeants and officers. When visited in 2013 the site was found to have been redeveloped into a housing estate. A Pyper 2013.

## DESCRIPTION

### SOURCES

#### OTHER SOURCES

Plan Air Ministry 1944 Haverfordwest Record Site Plan Sites No.2 - No 15 (dispersed)

---

**PRN** 102560 **NAME** RAF HAVERFORDWEST SITE NO 8

**TYPE** Military Camp **PERIOD** Modern

**NGR** SM96151781 **COMMUNITY** community

**CONDITION** Near Destroyed **STATUS** *None recorded* **EVIDENCE** Complex

### SUMMARY

RAF Haverfordwest Site No 8 is identified on the Haverfordwest Site Record Plan 4733/44. Here stood barrack huts for airmen, sergeants and officers. When visited in 2013 the site was found to have been cleared and reinstated to agricultural land and was under pasture. A Pyper 2013.

## DESCRIPTION

### SOURCES

#### OTHER SOURCES

Plan Air Ministry 1944 Haverfordwest Record Site Plan Sites No.2 - No 15 (dispersed)

---

**PRN** 102561 **NAME** RAF HAVERFORDWEST SITE NO 9

**TYPE** Military Camp **PERIOD** Modern

**NGR** SM96781755 **COMMUNITY** community

**CONDITION** Near Destroyed **STATUS** *None*

*recorded* **EVIDENCE** Complex

### SUMMARY

RAF Haverfordwest Site No 9 is identified on the Haverfordwest Site Record Plan 4733/44. Here stood barrack huts for airmen, sergeants and officers. Access was not gained on the site visit in 2013, however aerial photographs from 2009 suggest the site has been cleared and returned to agricultural use. A Pyper 2013.

## DESCRIPTION

### SOURCES

#### OTHER SOURCES

Plan Air Ministry 1944 Haverfordwest Record Site Plan Sites No.2 - No 15 (dispersed)

---

**PRN** 102562 **NAME** RAF HAVERFORDWEST SITE NO 10

**TYPE** Military Camp **PERIOD** Modern

**NGR** SM96531737 **COMMUNITY** community

**CONDITION** Near Destroyed **STATUS** *None*

*recorded* **EVIDENCE** Complex

### SUMMARY

RAF Haverfordwest Site No 10 is identified on the Haverfordwest Site Record Plan 4733/44. Here stood barrack huts for airmen, sergeants and officers. When visited in 2013 the site had been cleared and returned to

agricultural use. A Pyper 2013.

## DESCRIPTION

## SOURCES

### OTHER SOURCES

Plan Air Ministry 1944 Haverfordwest Record Site Plan Sites No.2 - No 15 (dispersed)

---

**PRN** 102563 **NAME** RAF HAVERFORDWEST SITE NO 11

**TYPE** Military Camp **PERIOD** Modern

**NGR** SM96271739 **COMMUNITY** community

**CONDITION** Various **STATUS** *None recorded* **EVIDENCE** Complex

## SUMMARY

Remains of one of a number of accommodation sites for the WWII airfield of RAF Haverfordwest. Recorded on the air ministry plans (4733/44) as Site 11 it included quarters and latrines for airmen, sergeants and officers respectively. Also included was a picket post or small watch hut. The accommodation for the three ranks was in separate fields, although the surviving remains are now in a single field. Recent aerial photographs and mapping show that the picket post (PRN 28541), the sergeants latrine (PRN 28542) still survive as standing if ruined structures. Also surviving are the concrete footings for 2 of the sergeants and officers barrack blocks. RAF Haverfordwest Airfield was operational between 1943 and 1945. Initially for No. 3 (Coastal) Operational Training Unit tasked with training complete crews in general reconnaissance skills. In 1944 No. 3 OTU was disbanded to be replaced by No. 4 Refresher Flying Unit, delivering aircraft all over the country. (H.Pritchard, 2014)

## DESCRIPTION

RAF Haverfordwest Site No 11 is identified on the Haverfordwest Site Record Plan 4733/44. Here stood barrack huts for airmen, sergeants and officers. Access was not gained on the site visit in 2013, however aerial photographs from 2009 suggest that most of the site has been cleared, although some buildings may remain along with the outline of hut bases which can be identified. A Pyper 2013.102563

## SOURCES

## OTHER SOURCES

Plan Air Ministry 1944 Haverfordwest Record Site Plan Sites No.2 - No 15 (dispersed)

---

**PRN** 102564 **NAME** RAF HAVERFORDWEST SITE NO 12

**TYPE** Military Camp **PERIOD** Modern

**NGR** SM96501712 **COMMUNITY** community

**CONDITION** Near Destroyed **STATUS** *None*

*recorded* **EVIDENCE** Complex

## SUMMARY

RAF Haverfordwest Site No 11 is identified on the Haverfordwest Site Record Plan 4733/44. Here stood barrack huts for airmen, sergeants and officers. Access was not gained on the site visit in 2013, however aerial photographs from 2009 suggest that the site has been cleared, and returned to agricultural use. A Pyper 2013.102563

## DESCRIPTION

## SOURCES

### OTHER SOURCES

Plan Air Ministry 1944 Haverfordwest Record Site Plan Sites No.2 - No 15 (dispersed)

---

**PRN** 102565 **NAME** RAF HAVERFORDWEST SITE NO 13

**TYPE** Military Camp **PERIOD** Modern

**NGR** SM96161714 **COMMUNITY** community

**CONDITION** Destroyed **STATUS** *None recorded* **EVIDENCE** Complex

## SUMMARY

RAF Haverfordwest Site No 13 is identified on the Haverfordwest Site Record Plan 4733/44. Here stood barrack huts for airmen, sergeants and officers. When visited in 2013 the site had been cleared and a housing estate now occupies the site. A Pyper 2013.

## DESCRIPTION



## SOURCES

### OTHER SOURCES

Plan Air Ministry 1944 Haverfordwest Record Site Plan Sites No.2 - No 15 (dispersed)

---

**PRN** 102566 **NAME** RAF HAVERFORDWEST SITE NO 14

**TYPE** Radio Station **PERIOD** Modern

**NGR** SM96171663 **COMMUNITY** community

**CONDITION** Near Destroyed **STATUS** *None*

*recorded* **EVIDENCE** Complex

### SUMMARY

RAF Haverfordwest Site No 14 is identified on the Haverfordwest Site Record Plan 4733/44. Here stood the wireless radio building, transformer and masts. When visited in 2013 the site had been cleared and a new residential house occupies the site of the W/T building. A Pyper 2013.

### DESCRIPTION

## SOURCES

### OTHER SOURCES

Plan Air Ministry 1944 Haverfordwest Record Site Plan Sites No.2 - No 15 (dispersed)

---

**PRN** 102567 **NAME** RAF HAVERFORDWEST SITE NO 15

**TYPE** Military Camp **PERIOD** Modern

**NGR** SM96001691 **COMMUNITY** community

**CONDITION** Destroyed **STATUS** *None recorded* **EVIDENCE** Complex

### SUMMARY

RAF Haverfordwest Site No 15 (WAAF) is identified on the Haverfordwest Site Record Plan 4733/44. Here stood barrack huts for sergeants and airwomen. Decontamination centre, sick quarters etc. When visited in 2013 the site had been cleared and a housing estate now occupies the site. A Pyper 2013.

### DESCRIPTION

## SOURCES

### OTHER SOURCES

Plan Air Ministry 1944 Haverfordwest Record Site Plan Sites No.2 - No 15 (dispersed)

---

**PRN** 11181 **NAME** PRESELY PARK

**TYPE** Findspot **PERIOD** Unknown

**NGR** SM959168 **COMMUNITY** Rudbaxton

**CONDITION** Not Known **STATUS** *None recorded* **EVIDENCE** Finds

### SUMMARY

### DESCRIPTION

**SOURCES** Mm List PCM 1980 Card Index F884

### OTHER SOURCES

---

**PRN** 13066 **NAME** SHOALS HOOK

**TYPE** Standing Stone ?, Rubbing Stone ? **PERIOD** Bronze Age , Post-Medieval

**NGR** SM96311663 **COMMUNITY** Haverfordwest

**CONDITION** Not Known **STATUS** *None recorded* **EVIDENCE** Structure

### SUMMARY

### DESCRIPTION

**SOURCES** Mm File 1989 Development application DRF

Mm GP 1987 Marshall,EC 2242-9A-10A DRF

Mm GP Marshall,C and Johnson,M DRF

Pm Map OS 1986 SM91NE DAT record map

### OTHER SOURCES

---

**PRN** 13075 **NAME** STEPHEN'S FORD  
**TYPE** Standing Stone ?, Rubbing Stone ? **PERIOD** Bronze Age , Post-Medieval  
**NGR** SM96201749 **COMMUNITY** Rudbaxton  
**CONDITION** Not Known **STATUS** *None recorded* **EVIDENCE** Structure

### **SUMMARY**

### **DESCRIPTION**

**SOURCES** Pm Map OS 1968 SM91NW DAT record map

#### **OTHER SOURCES**

Report Hall, J and Sambrook, P 2012 Heartlands Hub Heritage and Natural Environment Audit: Part F Rudbaxton Community Audit

---

**PRN** 17770 **NAME** STEPHENS FORD  
**TYPE** Bridge **PERIOD** Post-Medieval  
**NGR** SM96521760 **COMMUNITY** Rudbaxton  
**CONDITION** Not Known **STATUS** *None recorded* **EVIDENCE** Structure

### **SUMMARY**

### **DESCRIPTION**

**SOURCES** Pm Map OS 1968 SM91NE

#### **OTHER SOURCES**

---

**PRN** 17774 **NAME** THE HERMITAGE  
**TYPE** Hermitage **PERIOD** Post-Medieval  
**NGR** SM96041730 **COMMUNITY** Rudbaxton  
**CONDITION** Not Known **STATUS** *None recorded* **EVIDENCE** Building

## SUMMARY

## DESCRIPTION

**SOURCES** Pm Map OS 1968 SM91NE

**OTHER SOURCES**

---

**PRN** 18322 **NAME**

**TYPE** Mill Race **PERIOD** Post-Medieval

**NGR** SM966170 **COMMUNITY** Uzmaston and Boulston

**CONDITION** Not Known **STATUS** *None recorded* **EVIDENCE** Earthwork

## SUMMARY

## DESCRIPTION

**SOURCES** Pm Map OS 1939 Pemb XXVII NE

**OTHER SOURCES**

---

**PRN** 20962 **NAME** GLANAFON

**TYPE** Mansion **PERIOD** Post-Medieval

**NGR** SM956173 **COMMUNITY** Rudbaxton

**CONDITION** Not Known **STATUS** *None recorded* **EVIDENCE** Building

## SUMMARY

## DESCRIPTION

**SOURCES** Mm AP Oblique Musson, CR 1993 AP93-1.06 Glanafon house and grounds (RCAHMW gardens survey), view from W. NB ridged riverside beds at 20551718

Ph List Nicholas,T 1872 County Families of Wales Vol.1,p.908

### **OTHER SOURCES**

Report Hall, J and Sambrook, P 2012 Heartlands Hub Heritage and Natural Environment Audit: Part F Rudbaxton Community Audit

---

**PRN** 24366 **NAME** MILL HOUSE

**TYPE** Dwelling **PERIOD** Post-Medieval

**NGR** SM9539817837 **COMMUNITY** Rudbaxton

**CONDITION** Intact **STATUS** *listed building 13037*

**EVIDENCE** Building

### **SUMMARY**

Georgian country dwelling and presumably a former mill house. RPS August 2001

### **DESCRIPTION**

**SOURCES** Ph Mention 1805 Cambrian & General Weekly Advertiser Sale Notice

Mm Desc Text CADW 1987 Notification of listing DRF

### **OTHER SOURCES**

---

**PRN** 24367 **NAME** THREE ARCHED BRIDGE PRENDERGAST MILL

**TYPE** Bridge **PERIOD** Post-Medieval

**NGR** SM9537617858 **COMMUNITY** Rudbaxton

**CONDITION** Damaged **STATUS** *listed building 13038*

**EVIDENCE** Structure

### **SUMMARY**

### **DESCRIPTION**

**SOURCES** Pm Mention 1805 Cambrian & General Weekly Advertiser Sale Notice

Mm Desc Text CADW 1987 Notification of listing DRF

## OTHER SOURCES

---

**PRN** 28511 **NAME** RAF HAVERFORDWEST

**TYPE** Electricity Sub Station **PERIOD** Modern

**NGR** SM96141844 **COMMUNITY** Rudbaxton

**CONDITION** Near Intact **STATUS** *None recorded* **EVIDENCE** Building

### SUMMARY

1942-45, Sub-Station, present use store. Single storey, fair faced brick construction, flat concrete roof, cat slide annex to rear with corrugated asbestos roof. Porched doorway in west wall, large double steel doors in south wall. Two main internal chambers. Built per Air Ministry Drawing 13241/41 RJC.Thomas, 22.01.93.

### DESCRIPTION

**SOURCES** Pm Desc Text Smith,DJ 1981 Action Stations 3 Patrick

Stephens Limited,ISBN 0-85059-485-5

Mm GP Thomas,R 1993

Pm Desc Text Thomas,R 1994 Survey of 19th 20th Century ^Military Buildings of Pembrokeshire

Mm Record Form Thomas,R 1994 Disused Military Buildings Study Site No. ^075-013

## OTHER SOURCES

---

**PRN** 28518 **NAME** RAF HAVERFORDWEST

**TYPE** Turret Instructional Building **PERIOD** Modern

**NGR** SM96101821 **COMMUNITY** Rudbaxton

**CONDITION** Intact **STATUS** *None recorded* **EVIDENCE** Building

### SUMMARY

Turret instructional building, Type 'A', with 3 bays. For the instruction of air crew in a simulated gun turret. When visited in Nov 2011 it was in use as a garage workshop. A. Pyper 2012.

### DESCRIPTION

1942-45, Type 'A', Turret Instructional Building, present use workshop/store. One and a half storey, rendered 'temporary brick' construction, 1/2--5--1/2 bay rectangular plan, pitched corrugated asbestos gable roof. Built per Air Ministry drawing 11023/40. RJC.Thomas, 22.01.93.

**SOURCES** Pm Desc Text Smith,DJ 1981 Action Stations 3 Patrick Stephens Limited,ISBN 0-85059-485-5  
Mm GP Thomas,R 1993  
Pm Desc Text Thomas,R 1994 Survey of 19th 20th Century ^Military Buildings of Pembrokeshire  
Mm Record Form Thomas,R 1994 Disused Military Buildings Study Site No. ^075-020

### **OTHER SOURCES**

Plan Air Ministry 1944 Haverfordwest Record Site Plan Sites No.2 - No 15 (dispersed)  
Report Pyper,A 2012 Twentieth century military sites: Airfields

---

**PRN** 28519 **NAME** RAF HAVERFORDWEST  
**TYPE** Training Structure **PERIOD** Modern  
**NGR** SM96091810 **COMMUNITY** Rudbaxton  
**CONDITION** Intact **STATUS** *None recorded* **EVIDENCE** Building

### **SUMMARY**

Recorded on the Air Ministry plan as a Gunnery and Crew Procedure Building. Nine by five bay temporary brick construction with a corrugated asbestos gable roof. Reclad with corrugated iron on the south gable. Tall 30 light windows in each bay. When visited in 2013 in use as a garage, and some bays have been broken through to create openings. A Pyper 2013.

### **DESCRIPTION**

1942-45, Gunnery and Crew Procedure Building, present use garage. One and a half storey, rendered 'temporary brick' construction, 9 X 5 bay rectangular plan, pitched corrugated asbestos gable roof. Tall 30 light standard steel windows per bay. Built per Air Ministry drawing 4597/41. RJC.Thomas, 22.01.93.

**SOURCES** Pm Desc Text Smith,DJ 1981 Action Stations 3 Patrick Stephens Limited,ISBN 0-85059-485-5

Mm GP Thomas,R 1993

Pm Desc Text Thomas,R 1994 Survey of 19th 20th Century ^Military Buildings of Pembrokeshire

Mm Record Form Thomas,R 1994 Disused Military Buildings Study Site No. ^075-021

### **OTHER SOURCES**

Plan Air Ministry 1944 Haverfordwest Record Site Plan Sites No.2 - No 15 (dispersed)

---

**PRN** 28520 **NAME** RAF HAVERFORDWEST

**TYPE** Link Trainer **PERIOD** Modern

**NGR** SM96061815 **COMMUNITY** Rudbaxton

**CONDITION** Intact, Near Intact **STATUS** *None recorded* **EVIDENCE** , Building

### **SUMMARY**

Identified on the Air Ministry plan of the Haverfordwest this single storey, temporary brick construction and reclad corrugated iron roof. When visited in 2013 was in use as a store. A Pyper 2013.

### **DESCRIPTION**

**SOURCES** Pm Desc Text Smith,DJ 1981 Action Stations 3 Patrick Stephens Limited,ISBN 0-85059-485-5

Mm GP Thomas,R 1993

Pm Desc Text Thomas,R 1994 Survey of 19th 20th Century ^Military Buildings of Pembrokeshire

Mm Record Form Thomas,R 1994 Disused Military Buildings Study Site No. ^075-022

### **OTHER SOURCES**

Plan Air Ministry 1944 Haverfordwest Record Site Plan Sites No.2 - No 15 (dispersed)

---

**PRN** 28521 **NAME** RAF HAVERFORDWEST

**TYPE** Link Trainer **PERIOD** Modern

**NGR** SM96081815 **COMMUNITY** Rudbaxton

**CONDITION** Intact, Near Destroyed **STATUS** *None recorded* **EVIDENCE** Building, Demolished Building



## SUMMARY

The building described by R Thomas appears to have been demolished. A Pyper 2013. 1942-45, Aircraft Simulator/Link Trainer, present use officr. Single storey, rendered 'temporary brick' construction, 2--1/2--2--1/2--2--1/2 bay, rectangular plan, 18'x75'. Corrugated asbestos pitched gable roof. Built per Air Ministry drawing 4188/42. RJC.Thomas, 22.01.93.

## DESCRIPTION

**SOURCES** Pm Desc Text Smith,DJ 1981 Action Stations 3 Patrick Stephens Limited,ISBN 0-85059-485-5  
Mm GP Thomas,R 1993  
Pm Desc Text Thomas,R 1994 Survey of 19th 20th Century ^Military Buildings of Pembrokeshire  
Mm Record Form Thomas,R 1994 Disused Military Buildings Study Site No. ^075-023

## OTHER SOURCES

---

**PRN** 28522 **NAME** RAF HAVERFORDWEST  
**TYPE** Latrine **PERIOD** Modern  
**NGR** SM96091803 **COMMUNITY** Rudbaxton  
**CONDITION** Damaged, Near Destroyed **STATUS** *None recorded* **EVIDENCE** Building, Demolished Building

## SUMMARY

The building described by R Thomas in 1993 has now been demolished. A Pyper 2013. 1942-45, WAAF Officer's Latrine, now derelict. Single storey, rendered 'temporary brick' construction, single pitched corrugated asbestos roof. Built per Air Ministry drawing 4587/41. RJC.Thomas, 22.01.93.

## DESCRIPTION

**SOURCES** Pm Desc Text Smith,DJ 1981 Action Stations 3 Patrick Stephens Limited,ISBN 0-85059-485-5  
Mm GP Thomas,R 1993

Pm Desc Text Thomas,R 1994 Survey of 19th 20th Century ^Military Buildings of Pembrokeshire  
Mm Record Form Thomas,R 1994 Disused Military Buildings Study Site No. ^075-024

### **OTHER SOURCES**

---

**PRN** 28523 **NAME** RAF HAVERFORDWEST  
**TYPE** Training Structure **PERIOD** Modern  
**NGR** SM96051803 **COMMUNITY** Rudbaxton  
**CONDITION** Damaged, Near Destroyed **STATUS** *None recorded* **EVIDENCE** Building, Demolished Building

### **SUMMARY**

The building described by R Thomas in 1993 has now been demolished. A Pyper 2013. 1942-45, Wireless Telegraphy Operational Instructional Block, now derelict. Two interlinked, steel framed, corrugated zinc clad nissen huts. Built per Air Ministry drawing 12944/41. RJC.Thomas, 22.01.93.

### **DESCRIPTION**

**SOURCES** Pm Desc Text Smith,DJ 1981 Action Stations 3 Patrick Stephens Limited,ISBN 0-85059-485-5  
Mm GP Thomas,R 1993  
Pm Desc Text Thomas,R 1994 Survey of 19th 20th Century ^Military Buildings of Pembrokeshire  
Mm Record Form Thomas,R 1994 Disused Military Buildings Study Site No. ^075-025

### **OTHER SOURCES**

---

**PRN** 28524 **NAME** RAF HAVERFORDWEST  
**TYPE** Training Structure **PERIOD** Modern  
**NGR** SM96101800 **COMMUNITY** Rudbaxton  
**CONDITION** Damaged, Near Destroyed **STATUS** *None recorded* **EVIDENCE** Building, Demolished Building

## SUMMARY

The building described by R Thomas in 1993 has now been demolished. A Pyper 2013. 1942-45, Instructional Block, now derelict. Four interlinked, steel framed, corrugated zinc clad nissen huts. Built per Air Ministry drawing 12881/41. RJC.Thomas, 22.01.93.

## DESCRIPTION

**SOURCES** Pm Desc Text Smith,DJ 1981 Action Stations 3 Patrick Stephens Limited,ISBN 0-85059-485-5  
Mm GP Thomas,R 1993  
Pm Desc Text Thomas,R 1994 Survey of 19th 20th Century ^Military Buildings of Pembrokeshire  
Mm Record Form Thomas,R 1994 Disused Military Buildings Study Site No. ^075-026

## OTHER SOURCES

---

**PRN** 28525 **NAME** RAF HAVERFORDWEST

**TYPE** Quarters **PERIOD** Modern

**NGR** SM95811766 **COMMUNITY** Rudbaxton

**CONDITION** Intact **STATUS** *None recorded* **EVIDENCE** Building

## SUMMARY

1942-45, Airwomens Quarters, present use furniture store. Six interlinked, single storey, rendered 'temporary brick' construction, six bay pitched corrugated asbestos gable roofed huts. Arranged in two rows of three, 60' X 18' (18.35 X 5.49m). RJC.Thomas, 22.01.93.

## DESCRIPTION

**SOURCES** Pm Desc Text Smith,DJ 1981 Action Stations 3 Patrick Stephens Limited,ISBN 0-85059-485-5  
Mm GP Thomas,R 1993  
Pm Desc Text Thomas,R 1994 Survey of 19th 20th Century ^Military Buildings of Pembrokeshire  
Mm Record Form Thomas,R 1994 Disused Military Buildings Study Site No. ^075-027

## OTHER SOURCES

---

**PRN** 28526 **NAME** RAF HAVERFORDWEST  
**TYPE** Ablutions Block **PERIOD** Modern  
**NGR** SM95911767 **COMMUNITY** Rudbaxton  
**CONDITION** Near Intact **STATUS** *None recorded* **EVIDENCE** Building

### SUMMARY

1942-45, Airwomen's Ablutions and Latrines, present use store. Single storey, rendered 'temporary brick' construction, combined water tower and chimney located against the west wall. Built per Air Ministry Drawing NT.542. RJC.Thomas, 22.01.93.

### DESCRIPTION

**SOURCES** Pm Desc Text Smith,DJ 1981 Action Stations 3 Patrick Stephens Limited,ISBN 0-85059-485-5  
Mm GP Thomas,R 1993  
Pm Desc Text Thomas,R 1994 Survey of 19th 20th Century ^Military Buildings of Pembrokeshire  
Mm Record Form Thomas,R 1994 Disused Military Buildings Study Site No. ^075-028

## OTHER SOURCES

---

**PRN** 28527 **NAME** RAF HAVERFORDWEST  
**TYPE** Transformer Box **PERIOD** Modern  
**NGR** SM96131666 **COMMUNITY** Rudbaxton  
**CONDITION** Near Intact **STATUS** *None recorded* **EVIDENCE** Structure

### SUMMARY

1942-45, Transformer Plinth/Transformer Kiosk, present use garage. Rectangular, brick walled enclosure. Structure converted into a garage by the installation of a door in the north wall, and a flat roof. Formerly associated with the wireless telegraphy building. RJC.Thomas, 22.01.93.

### DESCRIPTION

**SOURCES** Pm Desc Text Smith,DJ 1981 Action Stations 3 Patrick Stephens Limited,ISBN 0-85059-485-5  
Pm Desc Text Thomas,R 1994 Survey of 19th 20th Century ^Military Buildings of Pembrokeshire  
Mm Record Form Thomas,R 1994 Disused Military Buildings Study Site No. ^075-029

**OTHER SOURCES**

---

**PRN** 28528 **NAME** RAF HAVERFORDWEST  
**TYPE** Transformer Plinth **PERIOD** Modern  
**NGR** SM95881749 **COMMUNITY** Rudbaxton  
**CONDITION** Near Intact **STATUS** *None recorded* **EVIDENCE** Structure

**SUMMARY**

1942-45, Transformer Plinth/Transformer Kiosk, now derelict, square brick walled enclosure. RJC.Thomas, 24.02.93.

**DESCRIPTION**

**SOURCES** Pm Desc Text Smith,DJ 1981 Action Stations 3 Patrick Stephens Limited,ISBN 0-85059-485-5  
Pm Desc Text Thomas,R 1994 Survey of 19th 20th Century ^Military Buildings of Pembrokeshire  
Mm Record Form Thomas,R 1994 Disused Military Buildings Study Site No. ^075-030

**OTHER SOURCES**

---

**PRN** 28532 **NAME** RAF HAVERFORDWEST  
**TYPE** Navigation Aid **PERIOD** Modern  
**NGR** SM95501815 **COMMUNITY** Rudbaxton  
**CONDITION** Near Intact, Damaged **STATUS** *None recorded* **EVIDENCE** , Structure

**SUMMARY**



A brick built enclosure which formed the Main Beacon for RAF Haverfordwest. Consists of a brick walled enclosure c 1.5m high with a concrete floor within. Converted for agricultural use when visited in 2013 with the southwest wall enclosed and roofed for stock. A Pyper 2013

### **DESCRIPTION**

1942-45, Main Beacon Platform, present use low grade agricultural. Large square concrete floor enclosed by a 5'0" (1.52m) approx high brick wall. RJC.Thomas, 08.03.93.

**SOURCES** Pm Desc Text Smith,DJ 1981 Action Stations 3 Patrick

Stephens Limited,ISBN 0-85059-485-5

Mm GP Thomas,R 1993

Pm Desc Text Thomas,R 1994 Survey of 19th 20th Century ^Military Buildings of Pembrokeshire

Mm Record Form Thomas,R 1994 Disused Military Buildings Study Site No. ^075-034

### **OTHER SOURCES**

Plan Air Ministry 1944 Haverfordwest Record Site Plan Sites No.2 - No 15 (dispersed)

---

**PRN** 28533 **NAME** RAF HAVERFORDWEST

**TYPE** Storehouse **PERIOD** Modern

**NGR** SM95821775 **COMMUNITY** Rudbaxton

**CONDITION** Near Intact **STATUS** *None recorded* **EVIDENCE** Building

### **SUMMARY**

1942-45, Ration Store, present use store. Single storey, 'temporary brick' construction, pitched gable corrugated asbestos roof, seven bay rectangular plan. Built per Air Ministry Drawing 3577/41. RJC.Thomas, 08.03.93.

### **DESCRIPTION**

**SOURCES** Pm Desc Text Smith,DJ 1981 Action Stations 3 Patrick

Stephens Limited,ISBN 0-85059-485-5

Mm GP Thomas,R 1993

Pm Desc Text Thomas,R 1994 Survey of 19th 20th Century ^Military Buildings of Pembrokeshire

Mm Record Form Thomas,R 1994 Disused Military Buildings Study Site  
No. ^075-036

## OTHER SOURCES

---

**PRN** 28534 **NAME** RAF HAVERFORDWEST

**TYPE** Canteen **PERIOD** Modern

**NGR** SM95841771 **COMMUNITY** Rudbaxton

**CONDITION** Near Intact **STATUS** *None recorded* **EVIDENCE** Building

## SUMMARY

1942-45, Dining Room, present use Council Depot. Single storey, 'temporary brick' construction, pitched gable corrugated asbestos roofs. Three parallel ranges, formerly linked by a cross range. Built per Air Ministry Drawing 3577/41. RJC.Thomas, 08.03.93.

## DESCRIPTION

**SOURCES** Pm Desc Text Smith,DJ 1981 Action Stations 3 Patrick Stephens Limited,ISBN 0-85059-485-5

Mm GP Thomas,R 1993

Pm Desc Text Thomas,R 1994 Survey of 19th 20th Century ^Military Buildings of Pembrokeshire

Mm Record Form Thomas,R 1994 Disused Military Buildings Study Site  
No. ^075-035

## OTHER SOURCES

---

**PRN** 28535 **NAME** RAF HAVERFORDWEST

**TYPE** Transformer Plinth **PERIOD** Modern

**NGR** SM95951771 **COMMUNITY** Rudbaxton

**CONDITION** Near Intact **STATUS** *None recorded* **EVIDENCE** Structure

## SUMMARY

1942-45, Transformer Plinth/Transformer Kiosk, present use Toilet. Small square, concrete floor enclosed by a 6'0" (1.83m) high brick wall. Entrance protected by a brick blast wall. RJC.Thomas, 08.03.93.

## DESCRIPTION

**SOURCES** Pm Desc Text Smith,DJ 1981 Action Stations 3 Patrick Stephens Limited,ISBN 0-85059-485-5  
Pm Desc Text Thomas,R 1994 Survey of 19th 20th Century ^Military Buildings of Pembrokeshire  
Mm Record Form Thomas,R 1994 Disused Military Buildings Study Site No. ^075-037

## OTHER SOURCES

---

**PRN** 28536 **NAME** RAF HAVERFORDWEST  
**TYPE** Gymnasium , Chapel **PERIOD** Modern  
**NGR** SM95981775 **COMMUNITY** Rudbaxton  
**CONDITION** Intact **STATUS** *None recorded* **EVIDENCE** Building

## SUMMARY

1942-45, Gymnasium/Chapel, present use garage. Long, three range building. Western range single storey, central and Eastern range one and a half storey, the central range being taller with clerestory windows. 'Temporary brick' construction, cement rendered. Corrugated asbestos pitched gable roofs, tall asbestos cement ventilators to central range. Built per Air Ministry Drawing 4911/42. RJC.Thomas, 08.03.93.

## DESCRIPTION

**SOURCES** Pm Desc Text Smith,DJ 1981 Action Stations 3 Patrick Stephens Limited,ISBN 0-85059-485-5  
Mm GP Thomas,R 1993  
Pm Desc Text Thomas,R 1994 Survey of 19th 20th Century ^Military Buildings of Pembrokeshire  
Mm Record Form Thomas,R 1994 Disused Military Buildings Study Site No. ^075-038

## OTHER SOURCES

---

**PRN** 28537 **NAME** RAF HAVERFORDWEST  
**TYPE** Ablutions Block **PERIOD** Modern  
**NGR** SM96011781 **COMMUNITY** Rudbaxton  
**CONDITION** Near Intact **STATUS** *None recorded* **EVIDENCE** Building

### **SUMMARY**

1942-45, Sergeant's Ablutions and Latrines, now derelict. Single storey, 'T' plan, 'temporary brick' construction, pitched gable corrugated asbestos roofs. Combined water towers and chimney set centrally in north wall. Built per Air Ministry Drawing 4585/41. RJC.Thomas, 08.03.93.

### **DESCRIPTION**

**SOURCES** Pm Desc Text Smith,DJ 1981 Action Stations 3 Patrick Stephens Limited,ISBN 0-85059-485-5  
Mm GP Thomas,R 1993  
Pm Desc Text Thomas,R 1994 Survey of 19th 20th Century ^Military Buildings of Pembrokeshire  
Mm Record Form Thomas,R 1994 Disused Military Buildings Study Site No. ^075-039

### **OTHER SOURCES**

---

**PRN** 28538 **NAME** RAF HAVERFORDWEST  
**TYPE** Ablutions Block **PERIOD** Modern  
**NGR** SM95811777 **COMMUNITY** Rudbaxton  
**CONDITION** Intact **STATUS** *None recorded* **EVIDENCE** Building

### **SUMMARY**

1942-45, Officer's Baths and Latrines, present use garage. Single storey, cement rendered 'temporary brick' construction, pitched gable corrugated asbestos roofs. Built per Air Ministry Drawing 4585/41. RJC.Thomas, 08.03.93.

### **DESCRIPTION**

**SOURCES** Pm Desc Text Smith,DJ 1981 Action Stations 3 Patrick Stephens Limited,ISBN 0-85059-485-5

Mm GP Thomas,R 1993

Pm Desc Text Thomas,R 1994 Survey of 19th 20th Century ^Military Buildings of Pembrokeshire

Mm Record Form Thomas,R 1994 Disused Military Buildings Study Site No. ^075-040

### **OTHER SOURCES**

---

**PRN** 28539 **NAME** RAF HAVERFORDWEST

**TYPE** Squash Court **PERIOD** Modern

**NGR** SM95801780 **COMMUNITY** Rudbaxton

**CONDITION** Intact **STATUS** *None recorded* **EVIDENCE** Building

### **SUMMARY**

1942-45, Squash Court, present use coachworks. Tall, one and a half storey, cement rendered 'temporary brick' construction, pitched gable corrugated asbestos roof, three bay rectangular plan. RJC.Thomas, 08.03.93.

### **DESCRIPTION**

**SOURCES** Pm Desc Text Smith,DJ 1981 Action Sations 3 Patrick Stephens Limited,ISBN 0-85059-485-5

Mm GP Thomas,R 1993

Pm Desc Text Thomas,R 1994 Survey of 19th 20th Century ^Military Buildings of Pembrokeshire

Mm Record Form Thomas,R 1994 Disused Military Buildings Study Site No. ^075-041

### **OTHER SOURCES**

---

**PRN** 28540 **NAME** RAF HAVERFORDWEST

**TYPE** Officers Mess **PERIOD** Modern

**NGR** SM95841781 **COMMUNITY** Rudbaxton

**CONDITION** Not Known **STATUS** *None recorded* **EVIDENCE** Building

### **SUMMARY**

1942-45, Officer's Mess, present use retail unit. Two 30' span, steel



framed, corrugated zinc clad, Nissen huts. Dorms side windows, 'temporary brick' gable walls. Built per Air Ministry Drawing 12867/41. RJC.Thomas, 08.03.93.

## DESCRIPTION

**SOURCES** Pm Desc Text Smith,DJ 1981 Action Stations 3 Patrick Stephens Limited,ISBN 0-85059-485-5  
Mm GP Thomas,R 1993  
Pm Desc Text Thomas,R 1994 Survey of 19th 20th Century ^Military Buildings of Pembrokeshire  
Mm Record Form Thomas,R 1994 Disused Military Buildings Study Site No. ^075-042

## OTHER SOURCES

---

**PRN** 28541 **NAME** RAF HAVERFORDWEST  
**TYPE** Picket Post **PERIOD** Modern  
**NGR** SM96191742 **COMMUNITY** Rudbaxton  
**CONDITION** Damaged **STATUS** *None recorded* **EVIDENCE** Building

## SUMMARY

1942-45, Picket Post, now derelict. Part of site 11 of RAF Haverfordwest servicemen accomdation. Single storey, square plan, 'temporary brick' construction, pitched gable corrugated asbestos. Built per Air Ministry Drawing 4587/41. RJC.Thomas, 08.03.93.

## DESCRIPTION

1942-45, Picket Post, now derelict. Single storey, square plan, 'temporary brick' construction, pitched gable corrugated asbestos. Built per Air Ministry Drawing 4587/41. RJC.Thomas, 08.03.93.

**SOURCES** Pm Desc Text Smith,DJ 1981 Action Stations 3 Patrick Stephens Limited,ISBN 0-85059-485-5  
Pm Desc Text Thomas,R 1994 Survey of 19th 20th Century ^Military Buildings of Pembrokeshire  
Mm Record Form Thomas,R 1994 Disused Military Buildings Study Site No. ^075-043

## OTHER SOURCES

---

**PRN** 28542 **NAME** RAF HAVERFORDWEST

**TYPE** Latrine **PERIOD** Modern

**NGR** SM96261738 **COMMUNITY** Rudbaxton

**CONDITION** Damaged **STATUS** *None recorded* **EVIDENCE** Building

### SUMMARY

1942-45, Sergeant's Latrine, now derelict. Part of site 11 of RAF Haverfordwest servicemen accomdation. Single storey, square plan, 'temporary brick' construction, 17'6" (5.33m) in length, single pitch corrugated asbestos roof. Built per Air Ministry Drawing 4587/41. RJC.Thomas, 08.03.93. (H. Pritchard 2014)

### DESCRIPTION

1942-45, Sergeant's Latrine, now derelict. Single storey, square plan, 'temporary brick' construction, 17'6" (5.33m) in length, single pitch corrugated asbestos roof. Built per Air Ministry Drawing 4587/41. RJC.Thomas, 08.03.93.

**SOURCES** Pm Desc Text Smith,DJ 1981 Action Sations 3 Patrick Stephens Limited,ISBN 0-85059-485-5

Pm Desc Text Thomas,R 1994 Survey of 19th 20th Century ^Military Buildings of Pembrokeshire

Mm Record Form Thomas,R 1994 Disused Military Buildings Study Site No. ^075-044

## OTHER SOURCES

---

**PRN** 28543 **NAME** RAF HAVERFORDWEST

**TYPE** Transformer Plinth **PERIOD** Modern

**NGR** SM9671317631 **COMMUNITY** Rudbaxton

**CONDITION** Near Intact **STATUS** *None recorded* **EVIDENCE** Structure

### SUMMARY

1942-45, Transformer Plinth, now derelict. Square concrete floor, open brick walled enclosure, entrance protected by a brick blast wall. RJC.Thomas, 08.03.93.

## DESCRIPTION

**SOURCES** Pm Desc Text Smith,DJ 1981 Action Stations 3 Patrick Stephens Limited,ISBN 0-85059-485-5  
Pm Desc Text Thomas,R 1994 Survey of 19th 20th Century ^Military Buildings of Pembrokeshire  
Mm Record Form Thomas,R 1994 Disused Military Buildings Study Site No. ^075-045

## OTHER SOURCES

---

**PRN** 44898 **NAME** STONE PARK HOMESTEAD  
**TYPE** Farmstead **PERIOD** Post-Medieval  
**NGR** SM96961693 **COMMUNITY** Uzmaston and Boulston  
**CONDITION** Not Known **STATUS** *None recorded* **EVIDENCE** Documentary Evidence

## SUMMARY

Farmstead shown on Tithe, 1st,2nd and 3rd edition OS, but gone by 1968 OS. LRW May 2002

## DESCRIPTION

**SOURCES** Mh Map 1841 Tithe Map & Apport,Uzmaston Ph Farmstead shown on map,schedule No 60  
Mm File 2001 WGS application WGS 52 1856 DC box file  
Ph Map OS 1887 Pembs Sheet XXVII NE 1st ed,1:10560  
Pm Map OS 1948 provisional Pembs Sheet XXVII NE 3rd ed,1:10560

## OTHER SOURCES

---

**PRN** 44908 **NAME**  
**TYPE** Quarry **PERIOD** Post-Medieval  
**NGR** SM9698717089 **COMMUNITY** Uzmaston and Boulston  
**CONDITION** Not Known **STATUS** *None recorded* **EVIDENCE** Earthwork

## SUMMARY

Quarry shown on 1st edition OS map, and on current map

## DESCRIPTION

**SOURCES** Pm Map OS 1891 Pembs Sheet XXVII NE 1st ed,1: 10560

## OTHER SOURCES

---

**PRN** 44909 **NAME** OLD QUARRY

**TYPE** Quarry **PERIOD** Post-Medieval

**NGR** SM96591686 **COMMUNITY** Haverfordwest

**CONDITION** Not Known **STATUS** *None recorded* **EVIDENCE** Placename  
Evidence

## SUMMARY

Quarry shown on 1st edition OS. No longer shown

## DESCRIPTION

**SOURCES** Pm Map OS 1891 Pembs Sheet XXVII NE 1st ed,1: 10560

Pm Map OS 1964 SM91NE

## OTHER SOURCES

---

**PRN** 4539 **NAME** TANGIERS

**TYPE** Round Barrow ? **PERIOD** Bronze Age

**NGR** SM959184 **COMMUNITY** Rudbaxton

**CONDITION** Not Known **STATUS** *None recorded* **EVIDENCE** Placename  
Evidence

## SUMMARY

## DESCRIPTION

**SOURCES** Mh Map Tithe Map & Apport,Prendergast North Ph Schedule No.100,Field name "Tump Field"  
Mm AP Vertical Meridian Airmaps 1955 190-210 25553-4  
Mm List PCM 1980 Card Index Pr B109  
Pm List RCAHM 1925 Pemb No.866,p.298  
Mm List RCAHM 1976 2b,PE

**OTHER SOURCES**

---

**PRN** 46908 **NAME**

**TYPE** Deserted Settlement ? **PERIOD** Post-Medieval

**NGR** SM96131837 **COMMUNITY** Rudbaxton

**CONDITION** Not Known **STATUS** *None recorded* **EVIDENCE** Building

**SUMMARY**

A single un-named rectangular building within a small enclosure shown on the Ordnance Survey 1st ed 1:2500 map but not on later Ordnance Survey editions. Possibly a small cottage with a garden enclosure.

**DESCRIPTION**

**SOURCES** Ph Map OS 1889 1st edition 1:2500 Pembrokeshire sheet XXII.16

**OTHER SOURCES**

---

**PRN** 46909 **NAME**

**TYPE** Milestone **PERIOD** Post-Medieval

**NGR** SM9564718165 **COMMUNITY** Rudbaxton

**CONDITION** Not Known **STATUS** *None recorded* **EVIDENCE** Structure

**SUMMARY**

Milestone. Inscription reads, "Fishguard 13 miles 170 yards - Haverfordwest 1 mile".

**DESCRIPTION**



**SOURCES** Ph Map OS 1889 1st edition 1:2500 Pembrokeshire sheet XXII.16

**OTHER SOURCES**

---

**PRN** 46911 **NAME**

**TYPE** Quarry **PERIOD** Post-Medieval

**NGR** SM96541832 **COMMUNITY** Rudbaxton

**CONDITION** Not Known **STATUS** *None recorded* **EVIDENCE** Earthwork

**SUMMARY**

Quarry shown on Ordnance Survey 1st edition 1:2500 map published in 1889, but not on subsequent editions, indicating that the quarry went out of use around the beginning of the 20th century.

**DESCRIPTION**

**SOURCES** Ph Map OS 1889 1st edition 1:2500 Pembrokeshire sheet XXII.16

**OTHER SOURCES**

---

**PRN** 46913 **NAME**

**TYPE** Quarry **PERIOD** Post-Medieval

**NGR** SM9543917520 **COMMUNITY** Rudbaxton

**CONDITION** Not Known **STATUS** *None recorded* **EVIDENCE** Earthwork

**SUMMARY**

Quarry marked as Old Quarry on the Ordnance Survey 1st edition 1:10560 map published in 1891, suggesting that the quarry was out of use by the later 19th century. It was not shown on the Ordnance Survey 2nd edition maps.

**DESCRIPTION**

**SOURCES** Ph Map OS 1891 1st edition 1:10560 Pembrokeshire sheet XXVII.NE

## OTHER SOURCES

---

**PRN** 60000 **NAME** PLAS GWYN  
**TYPE** House **PERIOD** Post-Medieval  
**NGR** SM9614318280 **COMMUNITY** Rudbaxton  
**CONDITION** Not Known **STATUS** *listed building 26983*  
**II EVIDENCE** Building

### SUMMARY

Grade II listed house

### DESCRIPTION

### SOURCES

#### OTHER SOURCES

Report Hall, J and Sambrook, P 2012 Heartlands Hub Heritage and Natural Environment Audit: Part F Rudbaxton Community Audit

---

**PRN** 60001 **NAME** GLANAFON  
**TYPE** House **PERIOD** Post-Medieval  
**NGR** SM9564917364 **COMMUNITY** Rudbaxton  
**CONDITION** Not Known **STATUS** *listed building 26984*  
**II EVIDENCE** Building

### SUMMARY

Grade II listed house

### DESCRIPTION

### SOURCES

#### OTHER SOURCES

---

**PRN** 60676 **NAME** MILESTONE  
**TYPE** Milestone **PERIOD** Post-Medieval

**NGR** SM9584316626 **COMMUNITY** Haverfordwest  
**CONDITION** Not Known **STATUS** *listed building 87069*  
**II EVIDENCE** Building

## SUMMARY

Grade II listed milestone

## DESCRIPTION

## SOURCES

## OTHER SOURCES

---

**PRN** 8777 **NAME** PRENDERGAST MILLS; MILLBANK MILL  
**TYPE** Mill , Paper Mill **PERIOD** Post-Medieval  
**NGR** SM95391784 **COMMUNITY** Rudbaxton  
**CONDITION** Near Intact, Damaged **STATUS** *None*  
*recorded* **EVIDENCE** Documentary Evidence, Ruined Building

## SUMMARY

A three-storey brick cotton mill built in 1766 and converted to a paper mill by 1791. It straddles the end of a pond fed by a long mill-race (PRN 17741) diverted from the Western Cleddau to the northwest. Recorded on the 1889 1st edition Ordnance Survey map and shown as disused by the time of the 1907 2nd ed.OS. Thought to have ceased production by 1900 and fell derelict between the two world wars. It was partially demolished in 1986. The nearby mill house (PRN 24366) is Grade II listed (M.Ings, 2013, from various sources)

## DESCRIPTION

The site was visited as part of the Cadw funded Mills Survey of 2012-14. The owners were away but I was granted permission to view the ruin by a staff member from the business based at the mill house. However, the rear of the building and the mill race were inaccessible. The facade of the mill still stands three storeys high but the rear, seen through the window apertures is far more ruinous and overgrown, being taken over by woodland. The roof has now gone. Fireplaces were evident on the ground and first floors of the main entrance space, part of the later 19th century redevelopment of the paper mill. The main mill building is of red brick,

with a later extension to the east side of masonry. The area of the wheel-pit was obscured by vegetation but the tail-race is still well preserved (M.Ings, 2013) Former cotton mill probably converted to a paper mill in 1842. A corn mill also operated here in the nineteenth century. MRP based on Wells 2009.

**SOURCES** Pm Desc Text 1980 DRF W.Telegraph 24-1-1980,GP's

Mm Desc Text Kennedy,PA 1985 Prendergast Paper Mill DRF

Mm Letter Kennedy,R 1986 DRF

Mm List RCAHM 1979 17f,PE

Mm Mention RCAHM 1979 DRF

**OTHER SOURCES**

Article Wells,T 2009 Papermaking in West Wales

Report Hall, J and Sambrook, P 2012 Heartlands Hub Heritage and

Natural Environment Audit: Part F Rudbaxton Community Audit

Map Ordnance Survey 1889 1st edition, 1:2500, Pembrokeshire Sheet 27.04

Map Ordnance Survey 1907 2nd edition, 1:2500, Pembrokeshire Sheet 27.04

---

Archaeological data, from the Regional Historic Environment Record, supplied by The Dyfed Archaeological Trust in partnership with Local Authorities, Cadw and the partners of ENDEX DAT, 2011 (and in part Crown, 2011).

# *Archaeology* *Wales*

## **APPENDIX II: Designated Archaeological Sites**



#### Scheduled Ancient Monuments within 2km

SAM No.	Name	Eastings	Northings	Site Type	Period
PE218	Crowhill Rath	195035	217367	Promontory Fort - inland	Prehistoric
PE356	Leachpool Round Barrow	197297	219078	Round barrow	Prehistoric
PE366	Haverfordwest Castle	195338	215742	Castle	Medieval
PE462	Pit Circle 250m NE of Cottessmore Farm	194985	218829	Pit circle	Prehistoric

#### Listed Buildings within 2km

LB No.	Name	Eastings	Northings	Grade
12002	Cottessmore including attached E conservatory and NW wing.	194842	218604	II*
12020	New Bridge and four lamp standards	195519	215689	II*
12021	The Old Bridge	195404	215876	II*
12022	No 1 Spring Gardens	195093	215693	II
12023	No 5 Spring Gardens including area railings	195078	215669	II
12027	Nos. 43, 45 & 47 Bridge Street	195374	215852	II
12028	2 Bridge Street	195429	215693	II
12029	The Millford Arms Inn	195720	215658	II
12030	Cartlett House including low front wall and railings	195797	215644	II
12031	Haverfordwest Castle	195343	215728	I
12032	The Governor's House	195327	215721	II
12033	Former County Gaol	195297	215738	II
12034	Castle Hotel	195418	215657	II
12035	Nos. 2 and 3 Castle Square	195423	215682	II
12036	Friars Vaults Inn	195446	215691	II
12037	Wall enclosing garden behind No. 4 on W side	195139	215744	II
12039	Church of Saint David	195664	216347	II
12040	Churchyard wall at St. David's Church, enclosing churchyard on S & E sides	195687	216340	II
12041	Church of Saint Martin of Tours	195169	215733	II*
12042	Churchyard walls and gates to Saint Martin's Church	195148	215718	II
12043	Cromwell House, Nos. 1 and 3 City Road	195112	215727	II
12044	Tabernacle Congregational Church	195097	215744	II*
12045	Tabernacle Church School	195107	215761	II*
12046	Forecourt dwarf wall and railings to Tabernacle Church and to Tabernacle Church School	195118	215744	II*
12047	Elm Cottage and front railings	195095	215788	II
12048	Nos. 12 and 14 City Road	195129	215779	II
12049	No. 20 City Road	195114	215802	II
12050	No. 22 City Road	195110	215807	II
12051	No. 24 City Road	195103	215811	II
12052	No. 26 City Road	195095	215814	II
12053	No. 28 City Road	195083	215816	II

12057	Nos. 3-6 Dark Street	195222	215616	II
12058	Summerville House	195189	215623	II
12059	No. 11 Dark Street	195167	215630	II
12060	Nos. 12 & 13 Dark Street (The Gloster Arms Inn)	195161	215633	II
12061	Nos. 14 and 14a Dark Street	195148	215643	II
12080	More House	195300	215459	II
12081	Williamston House including area railings	195312	215463	II*
12082	Clive House including area railings	195322	215470	II
12083	Two warehouses between Nos. 11 and 13 Goat Street	195339	215478	II
12084	No.13	195348	215485	II
12085	Nos. 15 and 17 Goat Street	195355	215489	II
12086	Orielton House	195366	215494	II
12087	No.23	195380	215500	II
12088	Walden House	195284	215471	II
12089	Nos 6 and 6a Goat Street	195289	215475	II
12090	Nos. 8 and 10 Goat Street and garages	195301	215483	II*
12091	Building to W of Foley House	195323	215494	II
12092	Foley House	195332	215505	II*
12093	Boundary wall to Foley House	195349	215506	II
12094	No. 16 Goat Street and garage to left	195371	215518	II
12095	Hillside	195377	215521	II
12096	No.20	195385	215524	II
12097	Hermon's Hill House	195417	215492	II*
12098	Boundary wall enclosing grounds to Hermon's Hill House on W, S and E sides	195418	215470	II
12099	No.6 Hermon's Hill	195420	215442	II
12100	No.7 Hermon's Hill	195422	215434	II
12101	No.7 High Street	195251	215573	II
12102	Nos. 9 and 11 High Street	195256	215575	II
12103	No.13 High Street	195264	215578	II
12104	15 High Street (Premises occupied by W. H. Smith and Son)	195273	215580	II*
12105	19 High Street (Premises of Trustee Savings Bank)	195298	215587	II
12106	Nos. 21 and 23 High Street	195305	215589	II
12107	No.35 High Street	195348	215603	II
12108	No. 43 High Street (Premises occupied by Munts)	195382	215610	II
12109	No.45 High Street	195397	215611	II
12110	The Shire Hall	195414	215609	II*
12111	Railings, gates, steps and retaining wall to the Shire Hall	195411	215623	II*
12112	The Olde Three Crowns	195427	215625	II
12113	No. 2 High Street (Premises occupied by Swale Music Centre)	195226	215598	II
12114	No.4 High Street	195231	215598	II
12115	No. 6 High Street (Premises occupied by S. D. Pugh and Son)	195237	215597	II
12116	No.12 High Street	195262	215611	II*
12117	No.14 High Street	195276	215609	II
12118	No.22 High Street	195306	215609	II*

12119	Nos. 24 and 26 High Street	195313	215610	II
12120	Barclay's Bank	195345	215623	II
12122	Nos. 36 and 38 High Street	195365	215628	II*
12123	Nos. 40 and 42 High Street	195374	215632	II*
12124	The Old St. Mary's Vicarage	195413	215522	II
12125	Hilltop	195411	215532	II
12126	Emlyn House	195410	215539	II
12127	No. 33 Hill Lane	195408	215547	II
12128	Gazebo to NE of No. 33 Hill Lane	195412	215577	II
12129	No. 22 and archway to left with railings	195383	215573	II
12130	No.24	195385	215595	II
12158	1 Gloucester Terrace	195309	215837	II
12159	Railings in front of Nos 1-6 Gloucester Terrace	195291	215842	II
12160	Belsize, No 13 Gloucester Terrace	195250	215830	II
12165	Hotel Mariners	195131	215621	II
12166	Premises occupied by W. Roch James and house adjoining to SE	195219	215537	II
12167	Nos. 7 and 7a Market Street	195223	215528	II
12168	No.9 Market Street	195225	215521	II
12169	Kent House and railings	195232	215504	II
12172	The Crypt	195226	215560	II*
12173	Nos 6, 8, 10, 12 Market Street, Including the wing to rear of No 6 Market Street	195242	215543	II
12174	No.22 Market Street	195252	215505	II
12175	The George's Inn	195256	215498	II
12178	No. 1 Castle Terrace	195219	215801	II
12179	Retaining wall, railings and pavement before Nos, 1-7 Castle Terrace	195208	215786	II
12180	Rock House	195208	215841	II
12184	No. 7 Old Bridge (Archie Griffith's Warehouse)	195480	215902	II
12187	Nos. 23 and 25 Old Bridge	195555	215962	II
12188	No.2 Bridge Street	195421	215895	II
12189	No.4 Bridge Street	195429	215898	II
12190	10 Bridge Street (The Commercial Hotel)	195454	215910	II
12192	NO.18 OLD BRIDGE	195475	215920	II
12193	NO.20 OLD BRIDGE	195480	215922	II
12194	The Greyhound Inn	195149	215650	II
12195	Allied House	195322	215874	II
12196	Ebenezer Chapel	195284	215895	II
12197	Dwarf wall, railings and gates before the Ebenezer Chapel	195292	215903	II
12198	Former Wesleyan Methodist Chapel	195168	215765	II
12199	Former Wesleyan Methodist Sunday School	195166	215775	II
12200	The Former Masonic Hall	195590	215694	II
12201	Picton House	195538	215712	II
12202	No.18	195589	215731	II
12205	Hill Park Baptist Church	195562	215973	II
12206	Sunday School to Hill Park Baptist Church	195573	215987	II
12207	Railings, gates and gatepiers to Hill Park Baptist Chapel	195561	215991	II

12208	Balfour Conservative Club and railings	195439	215599	II
12210	Nos. 5 and 7 Quay Street	195449	215593	II
12211	Nos. 9, 11 and 13 Quay Street	195454	215587	II
12212	Wilton House	195461	215603	II
12213	No 8 Quay Street (Premises occupied by 'Margaret's')	195469	215593	II
12214	10 Quay Street (Premises occupied by the New Studio and Gift Shop)	195476	215587	II
12215	The Candle Stores	195520	215492	II
12216	The Bristol Trader Inn	195530	215449	II
12217	No. 24 (Joseph Rank Ltd.) and No. 26 (Bristol Garage)	195536	215429	II
12218	Warehouse occupied by Haverfordwest Agricultural Cooperative Society	195547	215397	II
12219	Warehouse adjoining former Agricultural Co-op Warehouse	195552	215385	II
12221	No.21 Church Street	195213	215709	II
12222	No.22 Church Street	195207	215709	II
12223	No.23 Church Street	195201	215707	II
12224	No.24 Church Street	195193	215706	II
12226	Church of Saint Mary	195191	215569	I
12227	Churchyard walls, gates, gatepiers and railings at Church of Saint Mary	195197	215551	II
12228	Former Temperance Hall	195212	215601	II
12229	The Assembly Rooms	195187	215604	II
12236	The County Hotel	195597	215741	II
12237	No.3	195168	215612	II
12238	No.5	195163	215618	II
12242	Nos. 1 and 3 Victoria Place	195445	215642	II
12243	Nos. 4, 6 and 8 Victoria Place	195465	215675	II
12244	No.12	195493	215689	II
12245	Warehouse at rear of No. 12 Victoria Place	195485	215705	II
12246	Ty Twt	195585	216586	II
13010	No.10	195486	215686	II
13035	No. 20 Bridge Street (including Hylton John Boys Shop)	195388	215756	II
13037	Mill House	195398	217837	II
13038	Bridge at Prendergast Mill	195376	217858	II
13044	Scotchwell House	196265	216119	II
13046	Telephone call-box on NW abutment of Old Bridge	195383	215870	II
14539	No. 9 Gloucester Terrace	195270	215833	II
14540	No. 18 (West Wales Guardian), Market Street (NE side)	195248	215517	II
15672	HSBC Bank	195371	215608	II
15883	Nos. 44 and 46 High Street	195387	215640	II
21508	No.19	195551	215943	II
22762	Bethesda Baptist Church including vestry block attached to left	195118	215675	II*
22767	Gates and railings at Bethesda Baptist Church	195105	215678	II
26980	Outbuilding to N of Cottesmore	194829	218656	II

26981	Coach-house at Cottesmore	194822	218681	II
26982	Stable at Cottesmore	194852	218667	II
26983	Plas Gwyn	196143	218280	II
26984	Glanafon	195649	217364	II
26985	Fiddler's Hall	197688	218510	II
82965	Milepost on A40	197668	216029	II
87017	No 2 Spring Gardens	195091	215688	II
87018	No 3 Spring Gardens	195088	215684	II
87019	No 4 Spring Gardens	195085	215679	II
87020	Pembroke House Hotel including area railings	195071	215659	II
87021	Nos 8 and 8A Spring Gardens, including area railings	195064	215644	II
87022	No 9 Spring Gardens, including area railings	195059	215635	II
87032	Nos. 9, 11 and 13 Quay Street	195460	215580	II
87034	The Post Office	195489	215575	II
87036	The Old Wool Market	195534	215483	II
87037	Hillside Cottage	195554	215956	II
87038	No. 24 (Joseph Rank Ltd.) and No. 26 (Bristol Garage)	195539	215415	II
87039	Nos. 43, 45 & 47 Bridge Street (Fishguard Arms P.H.)	195378	215854	II
87040	The Old Quay	195550	215450	II
87041	The Fishguard Arms Inn	195386	215857	II
87042	44 & 46 Bridge Street	195339	215831	II
87043	The Carmarthen Arms Inn	195809	215646	II
87044	2 & 3 Castle Square	195431	215685	II
87045	Churchyard gates and railings, Church of Saint Thomas a Becket	195375	215421	II
87046	Nos. 12 and 14 City Road	195124	215785	II
87047	No. 34 City Road	195041	215815	II
87048	No.4	195219	215617	II
87049	The War Memorial	195605	215695	II
87052	Somerset House	195183	215625	II
87053	Nos 9 & 10 Dark Street	195174	215627	II
87054	Nos. 12 & 13 Dark Street (The Gloster Arms Inn)	195155	215638	II
87056	Nos. 6-8	195188	215525	II
87060	Nos. 8 and 10 Goat Street and garages	195309	215486	II*
87061	The Studio	195315	215489	II
87062	Cleeve House including area railings	195328	215474	II
87063	Nos. 15 and 17 Goat Street	195361	215491	II
87064	The Liberal Chambers	195201	215607	II
87065	Egerton House	195371	215496	II
87066	Former Town Council offices	195220	215599	II
87067	No.23a	195380	215500	II
87068	Former Stables	195053	215695	II
87069	Milestone	195843	216626	II
87070	No.8 High Street	195248	215597	II
87071	No.12 High Street	195153	215603	II
87072	No.14 High Street	195150	215610	II
87073	Nos. 1, 3, 5, 7, 9, 11, 13, 15 and 17 Victoria Place	195453	215646	II



87074	Lloyds Bank	195466	215651	II
87075	Nos. 1, 3, 5, 7, 9, 11, 13, 15 and 17 Victoria Place	195476	215657	II
87076	Nos. 1, 3, 5, 7, 9, 11, 13, 15 and 17 Victoria Place	195482	215660	II
87077	Nos. 1, 3, 5, 7, 9, 11, 13, 15 and 17 Victoria Place	195488	215663	II
87078	Nos. 1, 3, 5, 7, 9, 11, 13, 15 and 17 Victoria Place	195495	215667	II
87079	Nos. 4, 6 and 8 Victoria Place	195472	215678	II
87080	Nos. 4, 6 and 8 Victoria Place	195479	215682	II
87081	Nos. 9, 11 and 13 Quay Street	195457	215584	II
87082	Penrhiwllan	195697	216402	II
87083	No. 2 Castle Terrace	195217	215795	II
87084	No. 3 Castle Terrace	195216	215790	II
87085	No. 4 Castle Terrace	195215	215784	II
87086	No. 5 Castle Terrace	195213	215778	II
87087	No. 6 Castle Terrace	195212	215773	II
87088	No. 7 Castle Terrace	195211	215767	II
87089	No.11 Market Street	195228	215514	II
87090	Borough House	195260	215596	II
87091	Nichol memorial adjoining No 10 High Street	195267	215598	II
87092	Nos. 24 and 26 High Street	195322	215612	II
87093	Nos. 40 and 42 High Street	195381	215637	II
87094	Nos. 44 and 46 High Street	195393	215642	II
87095	Nos. 9 and 11 High Street	195260	215578	II
87096	No.17 High Street	195292	215586	II
87097	Nos. 21 and 23 High Street	195311	215590	II
87108	No.2	195326	215838	II
87110	2 Gloucester Terrace	195304	215837	II
87111	3 Gloucester Terrace	195299	215836	II
87112	4 Gloucester Terrace	195294	215836	II
87113	5 Gloucester Terrace	195289	215835	II
87114	6 Gloucester Terrace	195284	215834	II
87115	7 Gloucester Terrace	195279	215834	II
87116	8 Gloucester Terrace	195275	215834	II
87117	No. 10 Gloucester Terrace	195265	215832	II
87118	No. 11 Gloucester Terrace	195261	215831	II
87119	No. 12 Gloucester Terrace	195256	215831	II
87120	Maesteg House, No 14 Gloucester Terrace	195241	215828	II
87121	Uplands, No 15 Gloucester Terrace	195232	215827	II
87525	Former Stables attached to No 6 Dark Street	195206	215626	II

# *Archaeology* *Wales*

## **APPENDIX III: Specification**

**Archaeology Wales Ltd**

The Reading Room, Town Hall, Llanidloes SY18 6BN

T: 01686 440371

E: [info@arch-wales.co.uk](mailto:info@arch-wales.co.uk)

[www.arch-wales.co.uk](http://www.arch-wales.co.uk)

## Specification

For Archaeological Desk Based Assessment and Site Visit:

Haverfordwest Welsh Medium School,  
Withybush, Haverfordwest

Prepared for:  
Pembrokeshire County Council

Project No: 2436

9<sup>th</sup> May 2016

Archaeology Wales Limited  
The Reading Room, Town Hall,  
Great Oak St., Llanidloes, Powys, SY18 6BN  
Tel: +44 (0) 1686 440319  
Email: [admin@arch-wales.co.uk](mailto:admin@arch-wales.co.uk)

## NON TECHNICAL SUMMARY

*This Specification details the proposal for an archaeological Desk Based Assessment and Site Visit associated with the proposed construction of new secondary school in Haverfordwest. It has been prepared by Archaeology Wales Ltd for Pembrokeshire County Council.*

### 1. Introduction

The proposed development comprises plans for the construction of a new Welsh Medium School on land near to the Withybush Industrial Estate in Haverfordwest, Pembrokeshire (henceforth – the site), centred on NGR SM 962 174 (Figure 1 and 2). The local planning authority is the Pembrokeshire County Council (henceforth – PCC).

This Specification has been prepared by Philip Poucher, Archaeology Wales Ltd (Henceforth - AW) at the request of Pembrokeshire County Council. It provides information on the methodology that will be employed by AW during a Desk Based Assessment and Site Visit.

The purpose of the proposed Desk Based Assessment and Site Visit is to help understand the feasibility of the development, and provide information that is likely to be requested in respect of the proposed development, the requirements for which are set out in Planning Policy Wales 8 (Ed.8 January 2016), Section 6.5, and Welsh Office Circular 60/96. The work is to highlight and assess the impact upon standing and buried remains of potential archaeological interest to ensure that they are adequately preserved or fully investigated and recorded if they are disturbed or revealed as a result of subsequent activities associated with the development.

This specification is to be approved by the Dyfed Archaeological Trust (henceforth – DAT) who act as archaeological advisers to PCC.

All work will conform to the Standard and Guidance for Archaeological Desk Based Assessment (CIfA December 2014) and be undertaken by suitably qualified staff to the highest professional standards.

### 2 Development Details & Site description

Detailed development plans have not been finalised, but a sketch plan is provided to the rear (Figure 2) depicting the main school building, along with sports pitches, landscaping and associated infrastructure.

The site covers an area of approximately 8.4 hectares of relatively level land, rising slightly to the south from 32m OD to 37m OD. The site is currently defined by four fields, defined by straight-sided hedgerow boundaries. The site is bounded by the Withybush Road to the northeast, beyond which lies the Withybush Industrial Estate and Haverfordwest Airport. To the south the site is bounded by the A40 (T) beyond which lies residential development of Prendergast on the northern side of Haverfordwest. To the north and east lies further agricultural land and the village of Crundale.

Haverfordwest lies on the Western Cleddau (which lies c.600m to the west of the proposed development site) in central Pembrokeshire. The site is located on the northern fringes of development around Haverfordwest, the town centre lies some 1.7km to the south, on the western side of the river.

The underlying bedrock of the proposed development area comprises mudstones of the Slade and Redhill Formation, partly overlain to the east by sand and gravel glacio-fluvial deposits (BGS 2016).

### 3 Site specific objectives

The primary objective will be to assess the potential impact of the development proposals on the historic environment by means of a detailed desk top study and site visit. This will help inform future decision making, design solutions and potential mitigation strategies. The aim will be to make full and effective use of existing information in establishing the archaeological significance of the site, to elucidate the presence or absence of archaeological material, its character, distribution, extent, condition and relative significance.

The work will include a comprehensive assessment of regional context within which the archaeological evidence rests and will aim to highlight any relevant research issues within national and regional research frameworks.

The work will result in a report that will provide information of sufficient detail to allow informed planning decisions to be made which can safeguard the archaeological resource. Preservation *in situ* will be advocated where at all possible, but where engineering or other factors result in loss of archaeological deposits, preservation by record will be recommended.

### 4 The proposed archaeological work

The proposed archaeological work relates to the whole of the site, i.e. all of the application area.

The aim of the work will be to establish and make available information about the archaeological resource existing on the site. The work will include the following elements:

- A detailed desk top study (Stage 1)
- A site visit (Stage 2)
- The production of an illustrated report and the deposition of the site archive (Stage 3)

### 5 Method statement for a detailed desk top study (Stage 1)

The assessment will consider the following:

- a) The nature, extent and degree of survival of archaeological sites, structures, deposits and landscapes within the study area. It will involve the following areas of research:



1. Collation and assessment of all relevant information held in the regional HER at Dyfed Archaeological Trust in Llandeilo, within 1km from the edge of the proposed development area.
2. Collation and basic assessment of the impact on all Designated archaeological sites (Scheduled Ancient Monuments, Listed Buildings, Historic Parks & Gardens, landscapes, Conservation Areas) within 2km from the edge of the aforementioned area.
3. Assessment of all available excavation report and archives including unpublished and unprocessed material affecting the site and its setting.
4. Assessment of all extant aerial photographic (AP) evidence. This will include visits to Central Register of Air Photography for Wales, in Cardiff.
5. Assessment of archive records held at the County Archives, and as appropriate, site files held by RCAHMS
6. Records held by the developer e.g. bore logs, geological/geomorphological information, aerial photographs, maps, plans.
7. Map regression analysis using all relevant cartographic sources e.g. All editions of the Ordnance Survey County Series, Tithe and early estate maps (as available).
8. Place name evidence.
9. Internet sourced satellite imagery and Lidar imagery as available.
10. Assessment of the records held at the Portable Antiquities Scheme.
11. Historic documents (e.g. Charters, registers, estate papers).

b) The significance of any remains in their context both regionally and nationally and in light of the findings of the desk based study.

c) The history of the site, based on the areas of research outlined above.

d) The potential visual impact of any proposed development on the setting of known sites of archaeological importance.

e) The potential for further archaeological remains to be present, which have not been identified in pre-existing archaeological records.

f) The potential for further work, with recommendations if requested and where appropriate for a suitable investigative and/or mitigation methodology.

## 6 Method statement for a Site Visit (Stage 2)

The site visit will be a visual walked search of the entire development area. The ground surface will be visually inspected for all earthworks, structures and finds. The location of any environmental archaeological deposits, or areas which may have a potential for such **deposits, will also be taken into account along with the more traditional 'visible' archaeology.**

All located sites or finds will be accurately fixed by means of GPS. Each individual find or site location will have an accurate NGR reference attached. Where a close cluster of related features is identified a single NGR for the centre of the cluster will be used, and each constituent feature separately described in the text.

The character, function, condition, vulnerability, potential dating and relationship to other features of each identified site or find will be described fully. The importance of the site or find will be assessed in terms of local, regional or national significance.

A sketch survey of each identified site layout will be made with accompanying metric measurements

Written, drawn and photographic records of an appropriate level of detail will be maintained throughout the course of the project. Digital photographs, including metric scales, will be taken using cameras with resolutions of 14 mega pixels or above. Photographs will be taken in RAW format.

Illustrations will be drawn to a scale of 1:50, 1:20 and 1:10 as required, and these will be related to Ordnance Survey datum and published boundaries where appropriate.

The site visit will also assess the visual impact of the proposed development on the setting of known sites of archaeological importance. Photographs will be taken from the proposed development to help illustrate and assess this visual impact and Designated sites within the study area will also be visited with photographs taken towards the proposed development to help illustrate and assess this visual impact on these sites.

## 7 Method statement for the production of an illustrated report and the deposition of the site archive (Stage 3)

A report will be produced which synthesises the results of stages 1 and 2 and thereby assesses the total archaeological resource within the development area.

The results will be presented in a report and will be detailed and laid out in such a way that data and supporting text are readily cross-referenced. The HER Officer will be contacted to ensure that any sites or monuments not previously recorded in the HER are given a Primary Record Number (PRN) and that data structure is compatible with the HER. The historical development of the site will be presented in phased maps and plans comprising clearly, the outline of the site.

Within the report an attempt will be made to indicate areas of greater or lesser archaeological significance and the sites will be ranked in level of overall archaeological importance (locally, regionally and nationally).

All relevant aerial photographs, re-plots and historic maps will be included and be fully referenced. Any site photographs included in the report will be appropriately captioned and clearly located on a suitably scaled site plan.

The report will specifically include the following:

1. a copy of the design brief
2. a location plan
3. all identified sites plotted on an appropriately scaled plan of the proposal site
4. a gazetteer of all located sites with full dimensional and descriptive detail including grid reference and period

Copies of the report will be sent to Pembrokeshire County Council, to DAT and for inclusion in the HER. Digital copies will be provided in pdf format if required.

Any further stages of archaeological work, after the submission of the report for stages one and two outlined above, will be the subject of an additional DAT curatorial brief against which a further AW specification will be drawn up.

#### The site archive

A project archive will be prepared in accordance with the National Monuments Record (Wales) agreed structure and be deposited with the National Monuments Records, held and maintained by the RCAHMW, Aberystwyth, on completion of site analysis and report production. It will also conform to the guidelines set out in 'Management of Archaeological Projects Two, Appendix 3' (Historic England 2015). The digital archive will be deposited with the NMR.

Although there may be a period during which client confidentiality will need to be maintained, the report and the archive will be deposited not later than six months after completion of the work.

Other significant digital data generated by the survey (ie AP plots, EDM surveys, CAD drawings, GIS maps, etc) will be presented as part of the report on a CD/DVD. The format of this presented data will be agreed with the curator in advance of its preparation.

## 8 Resources and timetable

#### Standards

The desk based assessment will be undertaken by AW staff using current best practice.

All work will be undertaken to the standards and guidelines of the CIfA.

#### Staff

The project will be undertaken by suitably qualified AW staff. Overall management of the project will be undertaken by Philip Poucher.

#### Equipment

The project will use existing AW equipment.

#### Timetable of archaeological works

The work will be undertaken at the convenience of the client and is likely to commence imminently.

#### Insurance

AW holds Public Liability Insurance through Aviva Insurance Ltd, with a £5,000,000 Limit of Indemnity (expires 05/12/16), Employers Liability Insurance through Aviva Insurance Ltd, with a £10,000,000 Limit of Indemnity (expires 05/12/16) and Professional Indemnity Insurance through Hiscox Insurance Company Ltd, with a £1,000,000 Limit of Indemnity (expires 05/12/16).

#### Arbitration

In the event of any dispute arising out of this Agreement (including those considered as such by only one of the parties) either party may forthwith give to the other notice

in writing of such a dispute or difference and the same shall be and is hereby referred **for decision in accordance with the Rules of the Chartered Institute of Arbitrators'** Arbitration scheme for the Institute for Archaeologists applying at the date of this Agreement.

Health and safety

All members of staff will adhere to the requirements of the *Health & Safety at Work Act*, 1974, and the Health and Safety Policy Statement of AW.



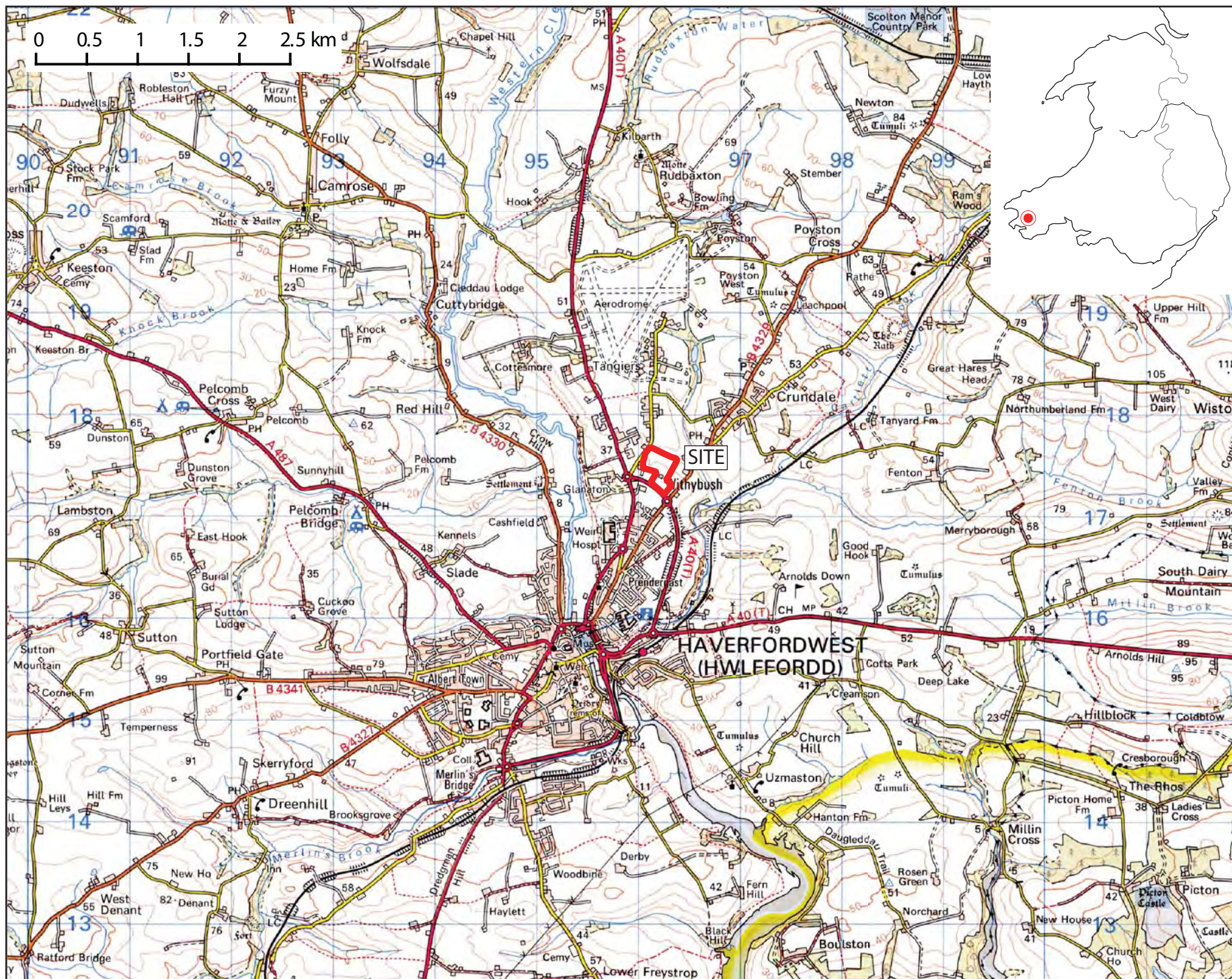
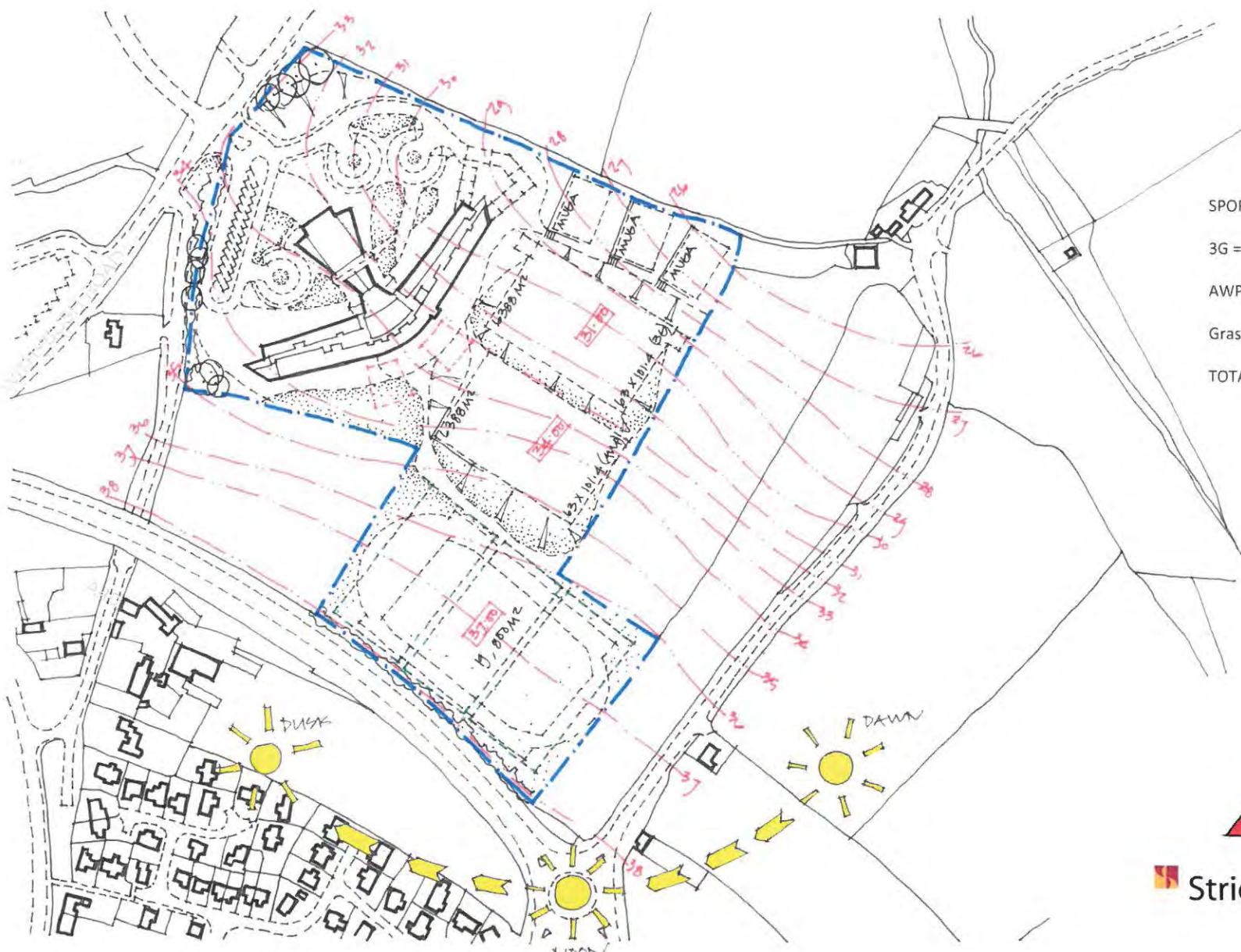

Figure 1: Location map,  
1:50,000 @ A4

The Ordnance Survey has granted Archaeology Wales Ltd a Copyright Licence (No. 100055111) to reproduce map information; Copyright remains otherwise with the Ordnance Survey



# SKETCH SITE LAYOUT PLAN



SPORTS PITCHES:

3G =  $6388 \times 2 = 12,776$

AWP =  $6388 \times 2 = 12,776$

Grass = 19,800

TOTAL: 45,352

Figure 2: Sketch proposed development plan



# *Archaeology* *Wales*

## **APPENDIX IV: Archive Cover Sheet**

# ARCHIVE COVER SHEET

## Haverfordwest Medium School, Withybush, Pembrokeshire

Site Name:	Haverfordwest Medium School
Site Code:	HWMS/16/DBA
PRN:	-
NPRN:	-
SAM:	-
Other Ref No:	-
NGR:	NGR SM 962 174
Site Type:	Agricultural land / WWII airfield barracks
Project Type:	Desk-based assessment
Project Manager:	Philip Poucher
Project Dates:	June 2016
Categories Present:	Prehistoric to Modern
Location of Original Archive:	AW
Location of duplicate Archives:	RCAHMW, Aberystwyth
Number of Finds Boxes:	0
Location of Finds:	N/A
Museum Reference:	
Copyright:	AW
Restrictions to access:	None

# *Archaeology Wales*

**Archaeology Wales Limited**

The Reading Room, Town Hall, Great Oak Street,  
Llanidloes, Powys SY18 6BN

**Tel: +44 (0) 1686 440371**

Email: [admin@arch-wales.co.uk](mailto:admin@arch-wales.co.uk)

Company Directors: Mark Houlston MIFA & Jill Houlston

Company Registered No. 7440770 (England & Wales).

Registered office: Morgan Griffiths LLP, Cross Chambers,  
9 High Street, Newtown, Powys, SY16 2NY