

CASTLEMARTIN ARMY TRAINING ESTATE PEMBROKESHIRE

CONDITION SURVEY



Report No. 2004/39
Report Prepared for:
WESSEX ARCHAEOLOGY

CAMBRIA ARCHAEOLOGY

REPORT NO. 2004/39
PROJECT RECORD NO. 50079

Castlemartin Army Training Estate Pembrokeshire condition survey

MARCH 2004

By

Cambria Archaeology

Cambria Archaeology is the marketing name of the Dyfed Archaeological Trust Limited.

The report has been prepared for the specific use of the client. The Dyfed Archaeological Trust Ltd can accept no responsibility for its use by any other person or persons who may read it or rely on the information it contains.

ARCHAEOLEG CAMBRIA

Ymddiriedolaeth Archaeolegol Dyfed Cyf
Neuadd y Sir, Stryd Caerfyrddin, Llandeilo, Sir Gaerfyrddin SA19 6AF
Ffon: Ymholiadau Cyffredinol 01558 823121
Adran Rheoli Treftadaeth 01558 823131
Ffacs: 01558 823133
Epost: cambria@acadat.com Gwefan: www.acadat.com

CAMBRIA ARCHAEOLOGY

Dyfed Archaeological Trust Limited
The Shire Hall, Carmarthen Street, Llandeilo, Carmarthenshire SA19 6AF
Tel: General Enquiries 01558 823121
Heritage Management Section 01558 823131
Fax: 01558 823133
Email: cambria@acadat.com Website: www.acadat.com

The Trust is both a Limited Company (No. 1198990) and a Registered Charity (No. 504616)
CADEIRYDD CHAIRMAN: B.C.BURNHAM, MA PHD FSA MIFA. CYFARWYDDWR DIRECTOR: E G HUGHES BA MIFA

Castlemartin Army Training Estate Pembrokeshire condition survey

REPORT NUMBER 2004/39

March 2004

This report has been prepared by Nigel Page

Position Project Manager

Signature Date

This report has been checked and approved by Ken Murphy on behalf of Cambria Archaeology,
Dyfed Archaeological Trust Ltd.

Position Principal Archaeological Officer - Contracts

Signature Date.....

As part of our desire to provide a quality service we would welcome any comments you may
have on the content or presentation of this report

CASTLEMARTIN ARMY TRAINING ESTATE PEMBROKESHIRE CONDITION SURVEY

CONTENTS	PAGE
1. Introduction	1
2. Methodology	1
2.1 SMR searches	1
2.2 Site visits	1
2.3 Reporting	1
3. The survey	2
3.1 Sites by period	2
3.2 Site condition	4
3.3 Site stability	6
3.4 Site vulnerability	7
4. Conclusions	9
4.1 Remedial work	9
4.2 Further survey and recording	10
Appendix 1: Pro-forma site recording sheet	11
 List of tables	
Table 1: Number of sites by period	2
Table 2: Breakdown of prehistoric sites by period	3
Table 3: Site condition	4
Table 4: Site stability	6
 List of plates	
Plate 1: Bulliber Iron Age Hillfort (PRN 549)	3
Plate 2: Military meshed steel track (PRN 28790)	4
Plate 3: Slade Limekiln (PRN 26300)	5
Plate 4: St. Govan's Head Observation Post (PRN 33454)	5
Plate 5: Crow Back Tumulus	6
Plate 6: Trenorgan Farmstead	7
Plate 7: Disused blockhouse (PRN 28780)	8
Plate 8: Findspot site (PRN 9999) on St. Govan's Head	8
 Maps	
Maps 1, 3, 5, 7 and 9 Distribution of archaeological site polygons	
Maps 2, 4, 6, 8 and 10 Distribution of findspots	
Maps 10 – 15 Distribution of archaeological site polygons on historic Ordnance Survey mapping	

CASTLEMARTIN ARMY TRAINING ESTATE PEMBROKESHIRE CONDITION SURVEY

1.0 INTRODUCTION

1.0.1 The Castlemartin Army Training Estate occupies an area of some 2389ha within the Pembrokeshire Coast National Park and it contains a large number (402¹) of archaeological and historical sites. This survey was part of the Ministry of Defence (Defence Estates) management strategy for the Castlemartin Ranges and was carried out to record baseline conditions for all known archaeological and historical sites within the Ranges. There was no provision within this project to undertake new research or to record new sites, although many features within the range are unrecorded.

1.0.2 The majority of the survey was carried out in early January 2004, prior to the ranges being closed for increased firing throughout late winter and spring 2004, with some visits taking place over several weekends in late January and early February.

2.0 METHODOLOGY

2.1 SMR searches

2.1.1 Following the extraction of the records from the Sites and Monuments Record (see footnote 1 below) they were assessed and 61 sites were excluded from the subsequent field visits. The excluded sites were made up of sites with four-figure grid references, cave sites, sites known from places names only, and records of previous archaeological projects within the ranges. This left a total 341 sites requiring site visits, however, some sites were multiple sites (i.e. farmsteads with several elements) – or had multiple records with the same National Grid Reference (NGR), which resulted in 283 individual site locations being visited and recorded.

2.1.2 There are 14 Scheduled Ancient Monument (SAM) sites within the Ranges. However, some sites have secondary records for subsequent reuse, which are also scheduled, making 18 SAM records in the SMR.

2.2 Site visits

2.2.1 During the site visits each site location visited was recorded using a pro-forma recording sheet supplied by Defence Estates², to ensure a consistent approach for all sites. A single digital photograph was taken of all identified sites, with findspot locations being photographed for context only. Where possible new NGRs were taken using a handheld Global Positioning System (GPS) on the centre point of the monument. Findspots, or sites where no above-ground remains survived were not given new grid references. Given the open nature of most of the range the accuracy

¹ This was the number of known archaeological and historical sites recorded on the Sites and Monuments Record (SMR), maintained by Cambria Archaeology, Llandeilo, in December 2003, when the survey was commissioned.

² A sample pro-forma recording sheet has been included as Appendix 1.

obtained by the handheld GPS, despite the accepted limitations of the equipment³, was sufficiently reliable to be entered into the database for use with the GIS mapping.

2.3 Reporting

2.3.1 Once the site visits were completed the field data on the pro-forma sheets was input into Microsoft Word files, with each site being saved as an individual file, named by its Primary Record Number (PRN)⁴. This site data was the main project output. Digital images were saved onto CD and the locations from which the photographs were taken were saved as a Geographical Information System (GIS) layer, using MapInfo 6.5. This, along with the paper site record sheets, formed the core of the project archive: digital copies of the site information were stored on CD and also included in the archive.

3.0 THE SURVEY

3.1 Sites by period

The recorded sites covered all the major archaeological periods, from the Palaeolithic through to the modern period. The numbers of sites by period (Table 1) show an inevitable bias towards the post-medieval period because of the advent of mapping and better record keeping.

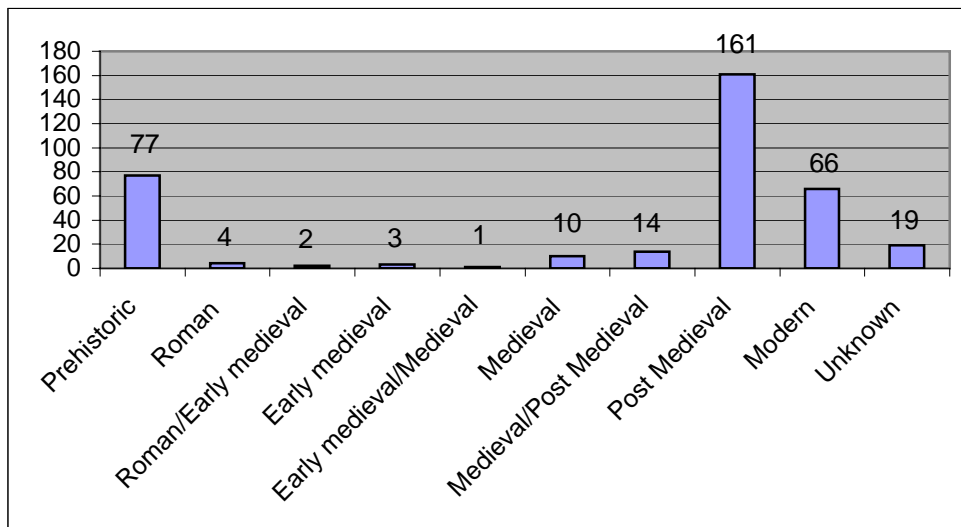

Table 1: Number of sites by period. For a breakdown of the prehistoric sites by period see Table 2).

3.1.1 The high number of prehistoric sites is a reflection of a variety of factors. Many of the sites are findspots of lithic material recovered as individual finds or in scatters, representing anything from chance losses, to tool manufacture and repair to occupation sites, and they range in date from the Upper Palaeolithic to the Iron Age. Other prehistoric sites include Bronze Age round barrows, Iron Age promontory forts

³ For a recent detailed appraisal of the use of GPS in archaeological surveying see Ainsworth S and Thomason B 2003 *Where are Earth are We? The global positioning system (GPS) in archaeological field survey*. London. English Heritage.

⁴ Primary Record Number = the unique number assigned to a site within the SMR.

and possible standing stones. Roman sites are rare, with only 6 possible sites recorded, all of which were findspots and 4 were recorded from within Iron Age hill or promontory forts. During the medieval and post-medieval period the area was settled and farmed from large estates, principally, Brownslade, Pricaston and Flimston, although many smaller farms were also in existence. The modern sites are for the most part military structures.

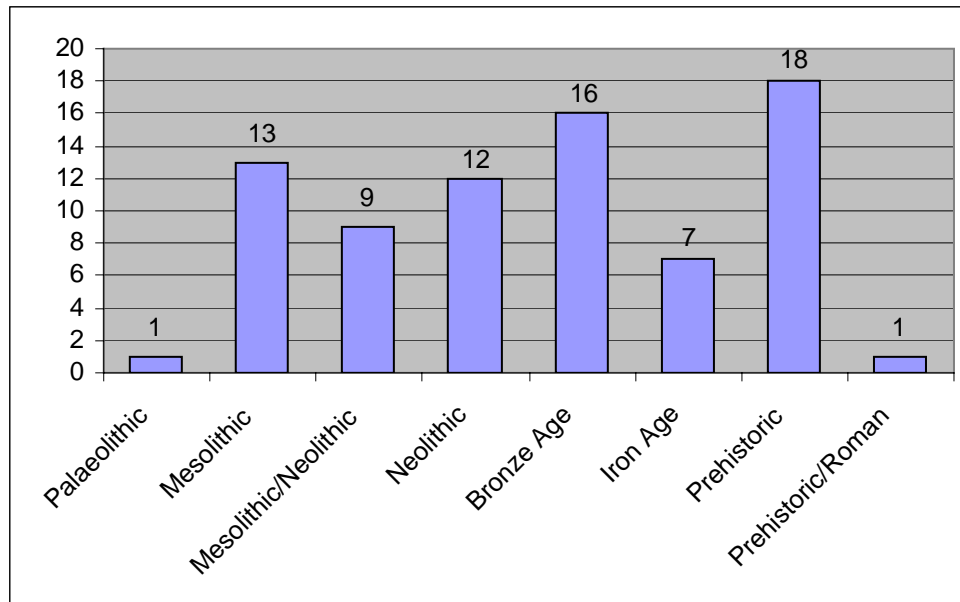

Table 2: Detailed breakdown of prehistoric sites by period.



Plate 1: Bulliber Iron Age Hillfort (PRN 549). On-going scrub clearance is uncovering the eastern defences. The partially cleared eastern bank is visible on the left hand side of the photograph.

3.2 Site condition

3.2.1 The condition of the sites varied greatly, from structures that are intact and still in use to sites that have been comprehensively demolished and in some cases possibly completely removed. The condition of the identified sites⁵ was assessed using the pre-set categories devised by Defence Estates, the categories were: Not found; Good; Fair; Poor (Table 3). The employment of these categories was in line with other projects being undertaken by Cambria Archaeology, such as the pan-Wales Cadw grant-aided surveys of all prehistoric funerary and ritual sites and deserted rural settlement sites in southwest Wales.

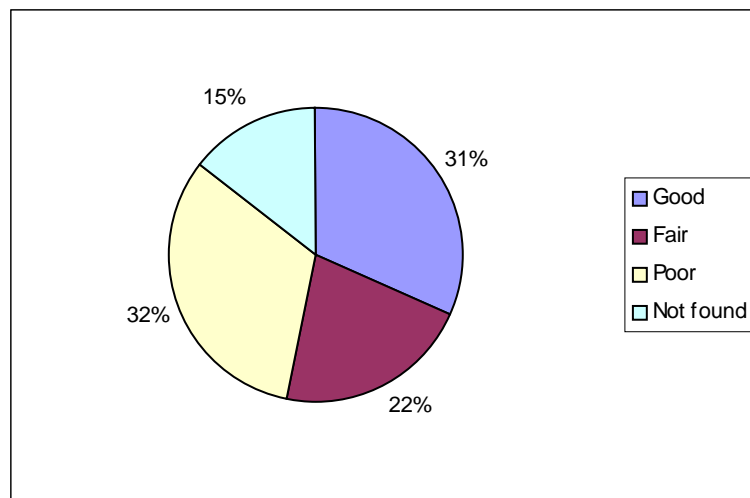

Table 3: Site condition.



Plate 2: A length of military meshed steel track (PRN 28790). The track survives only in short lengths and is in poor condition overall.

⁵ Findspots or buried features were not allocated to a category, unless it was decided that post-find changes had occurred to the site.

3.2.2 natural processes are having a significant impact on many sites, with scrub encroachment and erosion perhaps the two biggest problems, although structural collapse on the many surviving buildings across the range is also a concern. Scrub encroachment is beginning to obscure many sites, and the development of the vegetation will have long-term implications for sites with standing structures and earthworks (Plate 3).



Plate 3: Scrub encroachment on and around Slade Limekiln (PRN 26300). This is typical of many of the sites with standing remains.

3.2.3 Erosion is a problem on some sites, particularly those close to the coastline, where visitors to the Pembrokeshire Coast Path, wind and cliff erosion are all factors affecting the condition of some sites.



Plate 4: Visitor erosion is having a significant impact on the protective earth mound of the St. Govan's Head Observation Post (PRN 33454), despite the provision of purpose built steps (on the right). This mound is also suffering from severe wind erosion and burrowing animals.

3.3 Site stability

3.3.1 The stability of the sites was reasonably good, with more sites being stable or improving than showing signs of decline (Table 4). There are still a significant number of sites that are in decline, although in most cases that decline is gradual and for some sites the decline is the result of natural actions, such as cliff erosion. In many cases rapid decline has been precipitated by the removal of material following the abandonment of a site, or the construction of military structures. For findspots and sites with buried remains the general area was assessed for stability, even if the exact site location was uncertain, and included on the relevant site recording forms. As with Table 3, only those sites positively identified in the field are included below, therefore findspots and sites with buried remains are excluded.

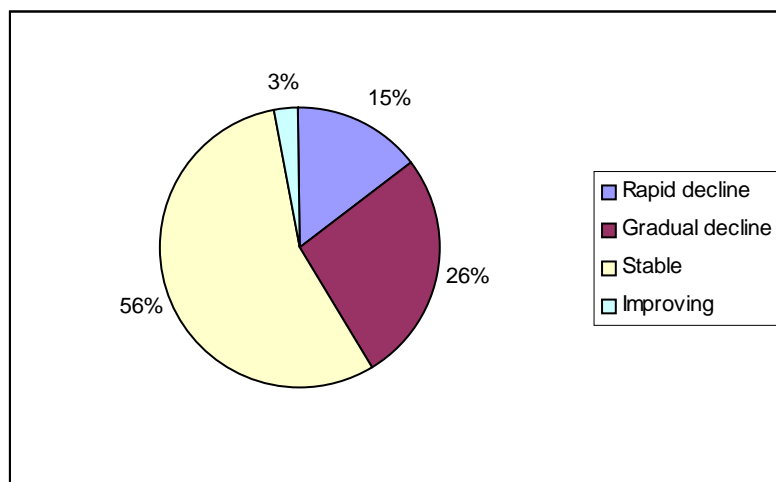

Table 4: Site stability

3.3.2 There are some specific concerns including the scheduled Bronze Age round barrow, Crow Back (PRN 536), which is suffering from erosion on its northwest - seaward side (Plate 3). The erosion is active and mitigatory measures are required.



Plate 5: Crow Back Tumulus (PRN 536) showing the active erosion on its west side.

3.3.3 The condition and stability of six sites are considered to be improving. Most of these have active roles within the military use of the range, although St. Govan's Chapel (PRN630) and its associated Holy Well (PRN 1268) are also regularly maintained as a visitor attraction.



Plate 6: Tenorgan Farm (PRN 464043) is a good example of a site where the condition and stability have been improved for military purposes. The abandoned farmstead has been renovated and recently opened as a 'stone tent'.

3.4 Site vulnerability

3.4.1 Most sites within the range are vulnerable to some process or another, with the sites located in the active impact areas obviously most at risk. All the Scheduled Ancient Monuments are currently excluded from active impact areas, although some show signs of past shelling, and many have ordnance fragments inside the scheduled area indicating misdirected shelling, or in some cases perhaps ricochets or shells that bounced into the sites. During the site visits the extent of the active firing ranges was not always clear and it is possible that more sites have been classed as of high vulnerability than may actually be the case.

3.4.2 Whilst active military action is undoubtedly the most acute pressure facing the archaeological resource, the effects of natural processes and other factors cannot be ignored. The coastal sites are inevitably suffering from long-term wind and cliff erosion and those close to the Coast Path are susceptible to visitor damage, which can take the form of erosion as people use the same path to visit a site or particular viewpoint, or it can be as people find archaeological material, such as flints, and remove them. The casual recovery of flints from the Coast Path has resulted in many findspots recorded on the SMR, but often the location and context information is missing, reducing the archaeological 'value' of these sites.



Plate 7: Disused blockhouse (PRN 28780) with target tanks placed on its protective earth mound. The blockhouse has been virtually destroyed.



Plate 8: A typical findspot, on St. Govan's Head. This site was the reported findspot of Mesolithic flint blades, flakes and a microlith. The path on the left leads to the St. Govan's Head Observation Post (PRN 33454 – see Plate 4 above) and is used by thousands of visitors each year. This and similar sites along the coast path are vulnerable to the casual recovery of flints.

4.0 CONCLUSIONS

4.0.1 The survey has shown that for the most part the sites within the range are stable, or only suffering gradual decline, usually through natural processes, and that where necessary protective measures are in place and effective. It has also highlighted deficiencies in the existing SMR record, with many features not recorded.

4.1 Remedial work

4.1.1 There are a number of sites that require some remedial works to mitigate current pressures.

4.1.2 Crow Back Tumulus (PRN 536 – see Plate 3), is suffering severe erosion on its west side. Cadw should be consulted to devise the most appropriate strategy for consolidation, if not reinstatement, of the monument.

4.1.3 The clearance works on Bulliber Hill Fort (PRN 549 – see Plate 1) should continue and the infantry target close to the base of the bank on the north side could be moved further from the monument

4.1.4 Standing building recording and some consolidation works have recently been completed for the Brownslade Farm complex (part of PRN 6447, but see 4.2.3 below).

4.1.5 Consolidation works are required at Flimston Farmhouse (PRN 6452) and Pricaston Farm (PRN 6076) and the scope and extent of these works are the subject of on-going discussions. All works should be accompanied by appropriate levels of building recording.

4.1.6 The promontory forts along the coast, Linney Head (PRN 539), Flimston Bay (PRN 602), Crockysdam (PRN 605) and Buckspool (PRN 609), are generally in fair condition, but they are suffering from varying amounts of natural and visitor erosion. It is understood that all of these sites will be subject to individual management plans in the near future. However, in order to help in assessing the scale of the erosion and for future monitoring a topographic survey should be carried out of each site, which will identify the extent and location of the problem areas. The information gained by the surveys should be used to formulate management plans and to identify areas requiring further archaeological investigation or recording and, where appropriate, reinstatement.

4.1.7 The Bronze Age Brownslade Barrow (PRN 542) and the nearby medieval chapel (PRN 544) are being affected by a large badger sett, which is disturbing below ground deposits, including human bone. Investigation works have taken place and the extent of the disturbance has been fairly well established. It is understood that MOD Defence Estates are currently exploring options for the exclusion of the badgers from the site.

4.1.8 Other measures required are outlined in the individual site forms.

4.2 Further survey and recording

4.2.1 As well as the remedial works required the survey has highlighted areas that require further survey and recording.

4.2.2 The incompleteness in the record for the Ranges has been mentioned above and further survey is required to fill in the gaps and record those features not yet included in the SMR.

4.2.3 In some cases the existing record needs to be clarified and probably refined, particularly in the case of the former Brownslade Mansion (PRN 6447), the PRN for which also includes the large model farm complex to the west. The farm complex should be recorded under a separate PRN, with individual elements within it also having their own PRNs in order to allow for easier description and to aid the management of the buildings. There are other problems with the Brownslade area, for example the demolished dwelling PRN 26451, which was identified from a late 18th century estate map, close to the former Brownslade Mansion (PRN 6447) may have been misidentified during earlier recording and the original estate documents should be reassessed.

4.2.4 The earthwork remains of Linney deserted medieval settlement (PRN 14632) should be subject to topographic survey to fully define the extent and form of the settlement in order to allow an effective management strategy to be drawn up for this important site. Once the boundaries are established with some certainty the site should be marked with no digging and no vehicle signs.

4.2.5 The widespread and remarkable range of post-medieval farms, farmsteads and cottages are in decline, with many of the smaller sites becoming overgrown and the information they contain being lost. Some of the sites have been removed to at least ground level, but some below ground remains may survive. It would be useful to undertake a programme of trial trenching on the sites of the 'lost farms' PRNs 6448 (Bulliber), 6969 (Linney), 26321 (Coxey), 26445 (Star Sheeping) and the previously unrecorded Newton Farm (NGR SR96419381) – some of which are likely to have medieval origins – to assess the survival and extent of any below ground deposits in order to devise an appropriate management strategy for these sites.

4.2.6 Pembrokeshire has one of the highest numbers of flint and lithic findspots in Wales, and they are correspondingly numerous within the range boundaries. The findspots range from individual artefacts to sites containing thousands of flints. A recent Cadw grant-aided survey of the lithic finds in southwest Wales has emphasised the potential of these site types and the problems associated with their recording and management. A programme of survey and excavation of a sample of these sites could be implemented in order to investigate their formation and nature in order to provide information regarding the development and use of lithics in prehistoric Pembrokeshire and to allow effective long-term management strategies – based on reliable data – to be devised and implemented.

APPENDIX 1: PRO-FORMA SITE RECORDING SHEET

A. LOCATION CASTLEMARTIN ARMY TRAINING ESTATE, PEMBROKESHIRE							
National monument record system No.		Smr no:		<i>SAM/LB</i> No. * delete as applicable		Any other designation:	
Grid ref: (centre point)		Country/county	Wales Pembrokeshire	Local Planning Authority:	Pembrokeshire Coast National Park (PCNP)	monument name:	

B. RECORDED BY			
surveyor:		date:	

C: FORM OF MONUMENT <i>Please tick which boxes apply, can be more than one</i>			
Earthwork	<input type="checkbox"/>	Levelled(i.e. cropmarks)	<input type="checkbox"/>
Findspot	<input type="checkbox"/>	Built Over	<input type="checkbox"/>
Upstanding (relic) structural feature	<input type="checkbox"/>	Historic upstanding extant structure or building	<input type="checkbox"/>

D: form of Earthwork*/relic structural feature* <i>(Use only for earthworks and ruins not buildings and sub-surface remains)</i>			
maximum vertical dimensions (m):		% of estimated original site surviving	

E: LAND USE <i>tick appropriate boxes for conditions on site in column A and indicate %, tick column B to indicate presence of other types of land use within 10metres (approx 35 feet of site)</i>								
Type (tick appropriate box or boxes)		√	(A) On-Site % cover/use	(B) Close to site (within 10m) √ if present	Type (tick appropriate box or boxes)	√	(A) On-Site % cover/use	(B) Close to site (within 10m) √ if present
agriculture:	Arable				road / track			
	Pasture				civilian			
	buildings				Bare ground			
Grassland	Mown/garden				Other (specify)			
forestry	coniferous							
	deciduous							
	mixed							
	Scrub							
<i>mod facilities (on or close to site)</i>								
	buildings				security fence			
	hardstandings				landscaped areas			
	runway &				naval dock			
	other (specify):							
<i>military activity (indicate military activity where known)</i>								
	manoeuvre area				driver training			
	recreational				rifle ranges			
	engineer training				garrison			
	impact area				fibua/training			
	camps				airfield			
	drop zone				other (specify):			

*Castlemartin Army Training Estate Pembrokeshire
archaeological condition survey*

F: DAMAGE TO SITE/STRUCTURE AND IMMEDIATE LOCALITY; In (A) tick appropriate box to indicate damage on-site and note approximate percentage of site affected. Note if damage is current within the last year, Recent within last 3 years or old more than 3 years). In (B) simply tick to indicate presence of type of damage within 10metres (35 feet of monument)

	(A) directly on monument (estimate % disturbed)						(B) within 10m of monument ✓ if present		
	current		recent		old		current	recent	old
vehicle damage		%		%		%			
tree damage (wind blow)		%		%		%			
digging		%		%		%			
shelling		%		%		%			
scrub encroachment		%		%		%			
overgrazing		%		%		%			
burrowing animals – badger		%		%		%			
burrowing animals – rabbits		%		%		%			
burrowing animals - moles		%		%		%			
water erosion		%		%		%			
ploughing		%		%		%			
footpath erosion		%		%		%			
tipping		%		%		%			
DEVELOPMENT ENCROACHMENT		%		%		%			
collapse of structural features		%		%		%	n/a	n/a	n/a
removal of structural material		%		%		%	n/a	n/a	n/a
other (specify)		%		%		%			

G: MONUMENT CONDITION TICK APPROPRIATE BOX

Not found		good		fair		poor	
-----------	--	------	--	------	--	------	--

H: STABILITY tick appropriate box to indicate first impression if this is the first time a condition form has been compiled for this monument OR change since last condition monitoring

rapid decline		gradual decline		stable		improving	
---------------	--	-----------------	--	--------	--	-----------	--

I: IN SITU PROTECTIVE MEASURES tick where appropriate to indicate presence and condition of protective measures

		IF NONE PRESENT TICK HERE:		
	good condition	average condition	poor condition	
no digging (star) or signs				
no vehicle signs				
agricultural penning				
palisaded				
dragons teeth				
fenced				
screen of trees				
Temporary repair/support				
Burrowing animal control				
other (specify type and condition):				

J: VULNERABILITY tick relevant box and add detail to describe any observed threats man made or natural

		IF NOT CONSIDERED VULNERABLE TICK HERE:	
low		from what:	
medium		from what:	
high		from what:	

K : PHOTOGRAPHS please tick type of photo taken during monitoring visit and note where this is held and any reference number given

col. slide:	col. print:	b&w print:	digital:
-------------	-------------	------------	----------

Castlemartin Army Training Estate Pembrokeshire
archaeological condition survey

L: MANAGEMENT RECOMMENDATIONS <i>Tick initial ideas required for management action, this will be referred on for appraisal and action.</i>		
recommend actions required to enhance management	tick as many as required and define urgency	
management action	required (tick)	timescale (urgent, medium term, long term)
Prepare Management Plan		
mark monument with 'no digging' signs (star signs or equiv)		
mark monument with 'no vehicle' signs		
repair extant 'no digging' signs (star signs or equiv)		
repair extant 'no vehicle' signs		
restrict access – enclose within fence		
restrict access – enclose within palisade		
repair protective fence		
repair protective palisade		
deflect vehicles off monument – dragon's teeth		
divert vehicle track off monument		
harden earth tracks over or in vicinity of monument		
divert footpath off monument		
clear scrub		
clear trees		
remove vegetation off structural features		
make safe structural features		
shape plantation to remove risk to monument		
control rabbits		
control moles		
relocate badgers		
remove from ploughing		
reduce stocking levels		
relocate fence/s		
relocate trough/s		
relocate gate/s		
enter into management agreement with tenant farmer		
pursue countryside stewardship grant		
repair erosion scars		
move targets		
mark on establishment map		
bring to attention of site users during briefings		

M: AUDIT/ACTION OF SURVEY INFORMATION				
copies of form sent to:	Estate advisor		EST	Conservation group
Management recommendations discussed with:				
Management action				
Date				

N: NOTES

	A	B	C	D	E	F	G	H	I	J	K	L	M	N	O	P	Q	R	S
1	Site Identification					Site Location			Management measures	Condition				Stability/Change in condition from last survey					
2	National Monument Record No. Add prefix NMRE for England NMRS for Scotland NMRW for Wales	SMR No.	SM or LB Ref No. preceded by " LB" or "SM".)	Name	Form of Monument Earthwork Findspot Upstanding Ruin Levelled (i.e cropmark or demolished) Built over	MOD Site/Property name	County or Unitary Authority	OS Grid Ref	Signed Fenced Agricultural penning Palisade Temporary repair Burrowing animal control None Other+description	Good	Fair	Poor	Unknown	Improving	Stable	Gradual Decline	Rapid Decline	Unknown	Date of last survey
3	109974	10103			Findspot	Castlemartin	Pembs.	SR8900296999	None						Stable				08/01/2004
4	110444	10574			Findspot	Castlemartin	Pembs.	SR9760192801	None						Stable				10/01/2004
5	110866	10998		Freynd Mill	Historic building	Castlemartin	Pembs.	SR901975	None			Poor					Rapid decline		05/01/2004
6	111312	11448		Frainslake	Findspot	Castlemartin	Pembs.	SR89699772	None						Stable				21/02/2004
7	111313	11449			Findspot	Castlemartin	Pembs.	SR89949802	None						Stable				17/02/2004
8	112094	12245			Findspot	Castlemartin	Pembs.	SR901975	None						Stable				05/01/2004
9	101229	1250		Linney Burrows	Findspot	Castlemartin	Pembs.	SR89669751	None						Stable				14/01/2004
10	101230	1251		Brownslade Burrows	Findspot	Castlemartin	Pembs.	SR89359781	None						Stable				14/01/2004
11	101231	1252		Brownslade Burrows	Findspot	Castlemartin	Pembs.	SR89389776	None						Stable				14/01/2004
12	101247	1268	LB2*: SM Pemb321	St. Govan's Holy Well	Historic building	Castlemartin	Pembs.	SR9671592949	None	Good				Improving					10/01/2004
13	112657	12818		Bluck's Pool	Findspot	Castlemartin	Pembs.	SR88809710	None				Unknown					Unknown	21/02/2004
14	114312	14631		Berry Slade Quarry	Earthwork	Castlemartin	Pembs.	SR8874396968	None	Good					Stable				08/01/2004
15	114313	14632			Earthwork	Castlemartin	Pembs.	SR895967	None		Fair				Stable				09/01/2004
16	114317	14636			Findspot	Castlemartin	Pembs.	SR95429362	None						Stable				15/02/2004
17	114318	14637		Kenton Platform	Earthwork	Castlemartin	Pembs.	SR9139198162	None			Poor			Stable				08/02/2004
18	114319	14638			Earthwork	Castlemartin	Pembs.	SR914981	None			Poor			Stable				08/02/2004
19	114320	14639			Earthwork	Castlemartin	Pembs.	SR92419483	None				Unknown					Unknown	11/01/2004
20	114321	14640			Findspot	Castlemartin	Pembs.	SR88909569	None							Gradual decline			07/01/2004
21	114322	14641			Findspot	Castlemartin	Pembs.	SR88849594	None							Gradual decline			07/01/2004
22	114325	14644			Levelled (buried feature)	Castlemartin	Pembs.	SR90639601	None				Unknown					Unknown	07/02/2004
23	114326	14645		Mount Sion Lane	(buried feature)	Castlemartin	Pembs.	SR91189629	None						Stable				13/01/2004
24	114327	14646		Mount Sion Lane	Levelled (buried)	Castlemartin	Pembs.	SR91179634	None						Stable				13/01/2004
25	114328	14647			Findspot	Castlemartin	Pembs.	SR91659608	None						Stable				07/02/2004
26	114329	14648		Apostles Park Inhumation	Levelled (buried feature)	Castlemartin	Pembs.	SR91639625	None				Unkown					Unknown	07/02/2004

	A	B	C	D	E	F	G	H	I	J	K	L	M	N	O	P	Q	R	S
27	114330	14649		Apostles Park Ditches	Levelled (buried feature)	Castlemartin	Pembs.	SR91819642	None				Unkown					Unknown	12/01/2004
28	114331	14650		Upper Layton	Levelled (buried feature)	Castlemartin	Pembs.	SR91969688	None				Unkown		Stable				13/01/2004
29	114332	14651		Upper Layton rubbish pit	Levelled (buried feature)	Castlemartin	Pembs.	SR92059689	None				Unkown		Stable				13/01/2004
30	114333	14652		Hunston Ditch	Levelled (buried)	Castlemartin	Pembs.	SR92459704	None				Unkown		Stable				13/01/2004
31	114,334	14653		Brownslade Burrows	Findspot	Castlemartin	Pembs.	SR89209848	None						Stable				15/01/2004
32	114335	14654			Findspot	Castlemartin	Pembs.	SR89549835	None						Stable				15/01/2004
33	114336	14655		Brownslade Burrows	Findspot	Castlemartin	Pembs.	SR89209843	None						Stable				15/01/2004
34	114337	14656		Brownslade Burrows	Findspot	Castlemartin	Pembs.	SR89539817	None							Gradual decline			15/01/2004
35	114338	14657		Brownslade Burrows	Findspot	Castlemartin	Pembs.	SR89409817	None						Stable				15/01/2004
36	114339	14658			Findspot	Castlemartin	Pembs.	SR89559796	None						Stable				17/12/2003
37	114344	14663			Earthwork	Castlemartin	Pembs.	SR883968	Fenced				Unknown					Unknown	08/01/2004
38	114345	14664			Earthwork	Castlemartin	Pembs.	SR8884495794	None		Fair				Stable				07/01/2004
39	115568	15917			Earthwork	Castlemartin	Pembs.	SR8952298546	None	Good					Stable				17/12/2003
40	115569	15918		Pen-y-holt Quarry	Earthwork	Castlemartin	Pembs.	SR8948995652	None	Good					Stable				08/01/2004
41	115575	15924			Earthwork	Castlemartin	Pembs.	SR9573893257	None	Good					Stable				15/02/2004
42	115642	15991				Castlemartin	Pembs.	SR92039631	None				Unknown					Unknown	08/02/2004
43	115643	15992			Historic building	Castlemartin	Pembs.	SR9391196812	None	Good				Improving					16/01/2004
44	115644	15993		Clay Pit Park Brickworks	Earthwork: Levelled	Castlemartin	Pembs.	SR92729529	None			Poor			Stable				12/01/2004
45	115645	15994			Earthwork	Castlemartin	Pembs.	SR94729525	None	Good					Stable				10/01/2004
46	115646	15995			Earthwork: Upstanding structure	Castlemartin	Pembs.	SR9480195250	None		Fair					Gradual Decline			10/01/2004
47	125944	26300		Slade Limekiln	Earthwork: Upstanding structure	Castlemartin	Pembs.	SR9108896383	None		Fair					Gradual Decline			13/01/2004
48	125945	26301		Buckspool Limekiln	Earthwork: Upstanding structure	Castlemartin	Pembs.	SR8900897004	None			Poor			Stable				08/01/2004
49	125949	26305			Built over	Castlemartin	Pembs.	SR94389604	None				Unknown					Unknown	09/01/2004
50	125951	26307			Earthwork: Upstanding structure	Castlemartin	Pembs.	SR9668993212	None				Unknown					Unknown	10/01/2004
51	125952	26308		Moor Gravel Pit	Earthwork	Castlemartin	Pembs.	SR9189897542	None		Fair				Stable				08/02/2004
52	125953	26309		Great Furznip Gravel Pit	Earthwork	Castlemartin	Pembs.	SR8887998805	None			Poor					Rapid Decline		17/12/2003

	A	B	C	D	E	F	G	H	I	J	K	L	M	N	O	P	Q	R	S
53	125955	26311		Brownslade Quarry	Earthwork	Castlemartin	Pembs.	SR9075098019	None			Poor			Stable				08/02/2004
54	125956	26312		Linney Quarry	Earthwork	Castlemartin	Pembs.	SR8886896939	None	Good					Stable				08/01/2004
55	125957	26313			Earthwork	Castlemartin	Pembs.	SR89169657	None				Unknown					Unknown	08/01/2004
56	125958	26314			Earthwork	Castlemartin	Pembs.	SR9097697461	None	Good					Stable				05/01/2004
57	125960	26316		Brownslade Quarry	Earthwork	Castlemartin	Pembs.	SR9128697326	None			Poor					Rapid Decline		08/02/2004
58	125961	26317		Brownslade Quarry	Earthwork	Castlemartin	Pembs.	SR91379710	None			Poor					Rapid Decline		08/02/2004
59	125962	26318		Cloyne Quarry	Earthwork	Castlemartin	Pembs.	SR9010497438	None	Good					Stable				05/01/2004
60	125963	26319			Earthwork	Castlemartin	Pembs.	SR86929690	None				Unknown					Unknown	09/01/2004
61	125964	26320			Upstanding structure	Castlemartin	Pembs.	SR8978897296	None			Poor				Gradual decline			09/01/2004
62	125965	26321		Mayhill Farmstead	Earthwork: Upstanding structure	Castlemartin	Pembs.	SR9033296887	None			Poor				Gradual decline			06/01/2004
63	125966	26322		Warmans Hill Limekiln	Earthwork: Upstanding structure	Castlemartin	Pembs.	SR9013896621	Fenced			Poor				Gradual decline			08/02/2004
64	125967	26323		Warmans Hill Farmstead	Historic building	Castlemartin	Pembs.	SR9012596533	None			Poor				Gradual decline			08/02/2004
65	125968	26324		Castle Lady Vally Quarry	Earthwork	Castlemartin	Pembs.	SR90759635	None		Fair				Stable				21/02/2004
66	125969	26325		Mount Sion Quarry	Earthwork	Castlemartin	Pembs.	SR9116196247	None	Good					Stable				13/01/2004
67	125970	26326		Mount Sion Limekiln	Earthwork: Upstanding structure	Castlemartin	Pembs.	SR9131096164	None			Poor				Gradual decline			13/01/2004
68	125972	26328		Winter Pit Farmsyead	Historic building	Castlemartin	Pembs.	SR9154396045	None		Fair				Stable				07/02/2004
69	125973	26329		Witner Pits Quarry	Earthwork	Castlemartin	Pembs.	SR91619603	None	Good					Stable				07/02/2004
70	125974	26330			Upstanding structure	Castlemartin	Pembs.	SR92559585	None				Unknown					Unknown	12/01/2004
71	125975	26331		Thimbles End Quarry	Earthwork	Castlemartin	Pembs.	SR9266596167	Fenced	Good					Stable				21/02/2004
72	125980	26336			Earthwork	Castlemartin	Pembs.	SR93689555	None				Unknown					Unknown	09/01/2004
73	125981	26337		Longstone farmstead	Upstanding structure: Historic building	Castlemartin	Pembs.	SR9345595649	None			Poor			Stable				09/01/2004
74	125982	26338		Addlegutter Cottage	Earthwork	Castlemartin	Pembs.	SR93059566	None			Poor					Rapid decline		09/01/2004
75	125986	26342		Merrion Quarry	Earthwork	Castlemartin	Pembs.	SR93179703	None			Poor				Gradual Decline			16/01/2004
76	125987	26343		Merrion Limekiln	Earthwork	Castlemartin	Pembs.	SR93049707	None				Unknown					Unknown	16/01/2004
77	125993	26349		Mount Sion Covert Quarry	Earthwork	Castlemartin	Pembs.	SR91539580	None		Fair				Stable				21/02/2004
78	125994	26350			Upstanding structure	Castlemartin	Pembs.	SR9645493526	None			Poor			Stable				10/01/2004
79	125995	26351		Crickmail Cottage	Earthwork: Historic	Castlemartin	Pembs.	SR9466394114	None			Poor					Rapid decline		15/02/2004
80	125996	26352			Historic building	Castlemartin	Pembs.	SR9483094110	None			Poor					Rapid decline		15/02/2004

	A	B	C	D	E	F	G	H	I	J	K	L	M	N	O	P	Q	R	S
81	125997	26353		Stennis Ford Quarry	Earthwork	Castlemartin	Pembs.	SR9651492877	None	Good					Stable				15/02/2004
82	125998	26354		The Devil's Barn Limekiln	Earthwork: Upstanding structure	Castlemartin	Pembs.	SR9604492995	None			Poor					Rapid decline		15/02/2004
83	126000	26356		Southrow farmstead	Historic building	Castlemartin	Pembs.	SR9488595303	None			Poor				Gradual Decline			10/01/2004
84	126001	26357		Anseys Down Farmstead	Historic building	Castlemartin	Pembs.	SR94929510	None				Unknown					Unknown	10/01/2004
85	126002	26358		Crickmail Farm	Earthwork: Historic	Castlemartin	Pembs.	SR9519294338	None			Poor					Rapid Decline		15/02/2004
86	126003	26359		Windy Berry farmstead	Earthwork: Upstanding structure	Castlemartin	Pembs.	SR9456294623	None			Poor			Stable				11/01/2004
87	126004	26360		Westland Cottage	Earthwork	Castlemartin	Pembs.	SR95479434	None			Poor					Rapid decline		15/02/2004
88	126005	26361		Eastland farmstead	Historic building	Castlemartin	Pembs.	SR9571394268	None			Poor					Rapid decline		15/02/2004
89	126007	26363			Built over	Castlemartin	Pembs.	SR92629547	None			Poor					Rapid decline		12/01/2004
90	126008	26364		Frainslake Mill Quarry	Earthwork	Castlemartin	Pembs.	SR90029759	None	Good					Stable				05/01/2004
91	126010	26366		Buckspool Cottage	Historic building	Castlemartin	Pembs.	SR9579593683	None			Poor					Rapid decline		15/02/2004
92	126016	26372		Kiln Park Limekiln	Historic building	Castlemartin	Pembs.	SR9516494469	None			Poor				Gradual Decline			15/02/2004
93	126017	26373			Historic building	Castlemartin	Pembs.	SR96379392	None		Fair					Gradual Decline			10/01/2004
94	126025	26381		Westland farmstead	Historic building	Castlemartin	Pembs.	SR9515394231	None			Poor					Rapid Decline		15/02/2004
95	126028	26384		Warren Farmstead	Built over	Castlemartin	Pembs.	SR93179755	None			Poor					Rapid Decline		16/01/2004
96	126041	26397		Warren Cottage	Built over	Castlemartin	Pembs.	SR93169753	None				Unknown				Rapid Decline		16/01/2004
97	126047	26403		Trenorgan Farmstead	Historic building	Castlemartin	Pembs.	SR9484395855	None	Good				Improving					09/01/2004
98	126048	26404		Trenorgan Limekiln	Historic building	Castlemartin	Pembs.	SR9490795861	Fenced		Fair					Gradual decline			09/01/2004
99	126053	26409		Thorne Cottage		Castlemartin	Pembs.	SR94539616	None				Unknown					Unknown	09/01/2004
100	126055	26411			Built over	Castlemartin	Pembs.	SR94349606	Fenced				Unknown					Unknown	09/01/2004
101	126078	26434			Findspot	Castlemartin	Pembs.	SR97479280	None						Stable				09/01/2004
102	126079	26435			Levelled	Castlemartin	Pembs.	SR935955	Fenced				Unknown		Stable				09/01/2004
103	126081	26437				Castlemartin	Pembs.	SR97299314	None				Unknown					Unknown	10/01/2004
104	126083	26439		Moody Nose	Earthwork: Upstanding structure	Castlemartin	Pembs.	SR9361194331	None			Poor				Gradual decline			11/01/2002
105	126084	26440		Ermigate Cottage		Castlemartin	Pembs.	SR92809635	None				Unknown					Unknown	12/01/2004
106	126086	26442		Merrion Dwelling	Historic building	Castlemartin	Pembs.	SR9373596961	Fenced	Good				Improving					16/01/2004
107	126087	26443		Southrow Farmstead		Castlemartin	Pembs.	SR93709560	None				Unknown					Unknown	09/01/2004
108	126088	26444			Levelled	Castlemartin	Pembs.	SR92689547	None			Poor					Rapid Decline		12/01/2004
109	126089	26445		Star Shipping	Earthwork: Historic building	Castlemartin	Pembs.	SR9173195441	None			Poor					Rapid Decline		07/02/2004

	A	B	C	D	E	F	G	H	I	J	K	L	M	N	O	P	Q	R	S
110	126090	26446		Cloyne Limekiln	Earthwork	Castlemartin	Pembs.	SR90019746	None			Poor			Stable				05/01/2004
111	126091	26447				Castlemartin	Pembs.	SR89729667	None				Unknown					Unknown	09/01/2004
112	126092	26448		Holy Cottage	Upstanding structure	Castlemartin	Pembs.	SR8875896924	None			Poor				Gradual decline			08/01/2004
113	126095	26451		Brownslade Mansion		Castlemartin	Pembs.	SR91019753	Fenced				Unknown					Unknown	05/01/2004
114	126098	26454		Quay		Castlemartin	Pembs.	SR974931	None				Unknown					Unknown	10/01/2004
115	126099	26455			Levelled	Castlemartin	Pembs.	SR93689590	None				Unknown					Unknown	09/01/2004
116	126100	26456			Earthwork	Castlemartin	Pembs.	SR9444394532	None			Fair			Stable				10/01/2004
117	126101	26457			Earthwork	Castlemartin	Pembs.	SR9389895494	None			Fair			Stable				09/01/2004
118	126102	26458			Earthwork	Castlemartin	Pembs.	SR94259427	None				Unknown					Unknown	11/01/2004
119	126103	26459		Brownslade Lodge	Historic building	Castlemartin	Pembs.	SR9142597697	None			Poor			Stable				09/01/2004
120	126104	26460			Historic building	Castlemartin	Pembs.	SR9138397248	None			Poor			Stable				08/02/2004
121	126105	26461			Historic building	Castlemartin	Pembs.	SR9094397593	None			Poor			Stable				05/01/2004
122	126106	26462		Brownslade Tannery	Historic building	Castlemartin	Pembs.	SR9102997614	None		Good				Stable				05/01/2004
123	126107	26463			Earthwork	Castlemartin	Pembs.	SR9344895690	None		Good				Stable				09/01/2004
124	126108	26464			Earthwork	Castlemartin	Pembs.	SR9355495573	None		Good				Stable				09/01/2004
125	126111	26467		Flimston Bay Quay	Earthwork: Upstanding structure	Castlemartin	Pembs.	SR9303194485	None			Fair			Stable				21/02/2004
126	126112	26468		Flimston Castle Quarry	Earthwork	Castlemartin	Pembs.	SR9303094725	None			Fair			Stable				11/01/2004
127	126113	26469			Earthwork	Castlemartin	Pembs.	SR91759555	None			Fair			Stable				07/02/2004
128	126115	26471			Earthwork	Castlemartin	Pembs.	SR9101495132			Good				Stable				07/02/2004
129	126116	26472			Earthwork	Castlemartin	Pembs.	SR89809659	None		Good				Stable				09/01/2004
130	126117	26473		Linneyrow Quarry	Earthwork	Castlemartin	Pembs.	SR8970896879	None			Fair			Stable				09//01/04
131	126118	26474		Penyholt Limekiln	Historic building	Castlemartin	Pembs.	SR8988895480	None			Poor					Rapid decline		07/02/2004
132	126119	26475		Penyholt Quarry	Earthwork	Castlemartin	Pembs.	SR8984195385	None		Good				Stable				07/02/2004
133	126120	26476		Caslte Lady Valley Limekiln		Castlemartin	Pembs.	SR90769642	None				Unknown					Unknown	21/02/2004
134	126121	26477		Kiln Park Quarry	Earthwork: Historic	Castlemartin	Pembs.	SR9516794480	None		Good				Stable				15/02/2004
135	126122	26478		Eastland Cottages	Historic building	Castlemartin	Pembs.	SR9563494304	None			Fair					Rapid decline		15/02/2004
136	126123	26479		Buckspool Quarry	Earthwork	Castlemartin	Pembs.	SR9618394087	None		Good				Stable				15/02/2004
137	126124	26480			Earthwork	Castlemartin	Pembs.	SR9534295026	None		Good				Stable				10/01/2004
138	126124	26481			Earthwork	Castlemartin	Pembs.	SR9524095179	None			Fair			Stable				10/01/2004
139	126129	26485		Buckspool Coastguard Station	Upstanding structure	Castlemartin	Pembs.	SR8903996972	None			Poor			Stable				08/01/2004
140	126130	26486			Earthwork	Castlemartin	Pembs.	SR8889398808	None		Good				Stable				07/01/2004
141	126131	26487		Mount Sion Quarry	Earthwork	Castlemartin	Pembs.	SR91409625	None			Fair			Stable				13/01/2014

	A	B	C	D	E	F	G	H	I	J	K	L	M	N	O	P	Q	R	S
142	126132	26488		CLV Quarry	Earthwork	Castlemartin	Pembs.	SR9070896488	None	Good					Stable				13/01/2004
143	126133	26489			Earthwork	Castlemartin	Pembs.	SR90419651	None				Unknown					Unknown	08/02/2004
144	126134	26490			Earthwork	Castlemartin	Pembs.	SR9165296163	None	Good					Stable				07/02/2004
145	126135	26491			Earthwork	Castlemartin	Pembs.	SR9173696221	None	Good					Stable				07/02/2004
146	126136	26492		Quarry	Earthwork	Castlemartin	Pembs.	SR9056397299	Signed		Fair				Stable				06/01/2004
147	126137	26493		Brownslade Quarry	Historic building	Castlemartin	Pembs.	SR9054797703	None	Good					Stable				05/01/2004
148	126139	26495		Flimston Coastguard	Levelled	Castlemartin	Pembs.	SR9260795296	None			Poor					Rapid decline		12/01/2004
149	126140	26496		Linney Quarry	Earthwork	Castlemartin	Pembs.	SR89419672	None			Poor			Stable				08/01/2004
150	126142	26498		Buckspool Down Limekiln	Earthwork: Historic	Castlemartin	Pembs.	SR9571693272	None			Poor				Gradual decline			15/02/2004
151	126145	26501		Quarry	Earthwork	Castlemartin	Pembs.	SR90059753	None				Unknown					Unknown	05/01/2004
152	126146	26502			Earthwork	Castlemartin	Pembs.	SR9030597490	None	Good					Stable				05/01/2004
153	126147	26503		Penyholt Limekiln	Earthwork: Upstanding structure	Castlemartin	Pembs.	SR8950495722	None			Poor				Gradual decline			08/01/2004
154	126148	26504		Slade Quarry	Earthwork	Castlemartin	Pembs.	SR9104496387	None	Good					Stable				13/01/2004
155	126149	26505		Buckspool Quarry	Earthwork	Castlemartin	Pembs.	SR 8899096998	None	Good					Stable				08/01/2004
156	126152	26508				Castlemartin	Pembs.	SR96679322	None				Unknown					Unknown	10/01/2004
157	126154	26510			Earthwork	Castlemartin	Pembs.	SR90139659	None		Fair				Stable				08/02/2004
158	126155	26511			Earthwork	Castlemartin	Pembs.	SR92559585	None	Good					Stable				12/01/2004
159	126157	26513			Earthwork	Castlemartin	Pembs.	SR93689555	None		Fair				Stable				09/01/2004
160	126159	26515		Merrion Quarry	Earthwork	Castlemartin	Pembs.	SR9300097120	None	Good					Stable				16/01/2004
161	126161	26517		Penyholt Quarry	Earthwork	Castlemartin	Pembs.	SR8991695474	None	Good					Stable				07/02/2004
162	127778	28549		Warren Radar Station	Earthwork: Upstanding structure	Castlemartin	Pembs.	SR9269297511	None			Poor			Stable				16/01/2004
163	127779	28550		Warren Transmitter Block	Earthwork: Historic building	Castlemartin	Pembs.	SR9269597750	Fenced	Good				Improving					16/01/2004
164	127780	28551		Warren Telephone Junction Box	Earthwork: Upstanding structure	Castlemartin	Pembs.	SR9253697182	None	Good					Stable				16/01/2004
165	127781	28552		Warren Air raid Shelter	Earthwork: Upstanding structure	Castlemartin	Pembs.	SR9255097192	None		Fair					Gradual Decline			16/01/2004
166	127782	28553		Warren Blockhouse	Earthwork: Historic building	Castlemartin	Pembs.	SR92679720	None		Fair				Stable				16/01/2004
167	127783	28554		Warren Transmitter Block	Earthwork: Historic building	Castlemartin	Pembs.	SR92919732	None		Fair				Stable				16/01/2004
168	127784	28555		Warren guard House	Historic building	Castlemartin	Pembs.	SR9290997296	None	Good					Stable				16/01/2004
169	127785	28556			Earthwork: Historic building	Castlemartin	Pembs.	SR93089748	None		Fair				Stable				16/01/2004
170	127786	26557		Warren NAAFI	Historic building	Castlemartin	Pembs.	SR93139753	Fenced	Good					Stable				16/01/2004
171	127787	28558		Warren Emergency Water Supply	Earthwork: Upstanding structure	Castlemartin	Pembs.	SR9258997365	None			Poor				Gradual Decline			16/01/2004

	A	B	C	D	E	F	G	H	I	J	K	L	M	N	O	P	Q	R	S
172	127788	28559		Warren Gun Emplacement	Earthwork	Castlemartin	Pembs.	SR9255197290	None			Poor			Stable				16/01/2004
173	127789	28560		Transmitter Array	Upstanding structure	Castlemartin	Pembs.	SR9271397550	None		Fair					Gradual Decline			16/01/2004
174	127790	28561			Historic building	Castlemartin	Pembs.	SR9318297570				Poor				Gradual Decline			16/01/2004
175	127970	28743		Brownslade Burrows	Earthwork: Historic building	Castlemartin	Pembs.	SR8912597568	None			Poor					Rapid decline		14/01/2004
176	127971	28744		Linney Defence Post	Earthwork: Historic building	Castlemartin	Pembs.	SR8900497550	None			Poor				Gradual Decline			14/01/2004
177	127972	28745			Earthwork: Historic building	Castlemartin	Pembs.	SR8906197600	None	Good					Stable				14/01/2004
178	127996	28770			Earthwork: Historic building	Castlemartin	Pembs.	SR88289627	None	Good						Gradual Decline			08/01/2004
179	127997	28771				Castlemartin	Pembs.	SR88329638					Unknown					Unknown	08/01/2004
180	127,998	28772			Earthwork: Historic building	Castlemartin	Pembs.	SR8834896693	None	Good						Gradual decline			08/01/2004
181	127999	28773			Earthwork: Historic building	Castlemartin	Pembs.	SR88819598	None	Good					Stable				07/01/2004
182	128000	28774			Earthwork: Historic building	Castlemartin	Pembs.	SR8922896871	None	Good					Stable				08/01/2004
183	128001	28775			Earthwork: Historic building	Castlemartin	Pembs.	SR8934196902	None	Good					Stable				08/01/2004
184	128002	28776		Blockhouse C	Earthwork: Historic building	Castlemartin	Pembs.	SR8910596380	None	Good					Stable				08/01/2004
185	128003	28777		Linney Down Railway	Historic building	Castlemartin	Pembs.	SR89259605	None	Good					Stable				08/01/2004
186	128004	28778		Blockhouse P	Earthwork: Historic building	Castlemartin	Pembs.	SR8939895900	None	Good					Stable				08/01/2004
187	128005	28779		Blockhouse D	Earthwork: Historic building	Castlemartin	Pembs.	SR89749638	None		Fair				Stable				09/01/2004
188	128006	28780		Penyholt Down Blockhouse	Earthwork	Castlemartin	Pembs.	SR8978996153	None			Poor					Rapid decline		07/02/2004
189	128007	28781			Earthwork: Historic building	Castlemartin	Pembs.	SR8976697098	None	Good					Stable				09/01/2004
190	128008	28782			Earthwork: Historic building	Castlemartin	Pembs.	SR8915997280	None	Good					Stable				14/01/2004
191	128009	28783		Linney Gun Emplacement	Upstanding structure	Castlemartin	Pembs.	SR8919797348	None			Poor				Gradual Decline			14/01/2004
192	128010	28784			Earthwork: Historic building	Castlemartin	Pembs.	SR8929997217	None	Good					Stable				14/01/2004
193	128011	28785		Linney Defence Post	Earthwork: Historic building	Castlemartin	Pembs.	SR8894597325	None		Fair					Gradual decline			14/01/2004
194	128012	28786		Linney Defence Post	Earthwork: Historic building	Castlemartin	Pembs.	SR8886997477	None		Fair					Gradual decline			14/01/2004

	A	B	C	D	E	F	G	H	I	J	K	L	M	N	O	P	Q	R	S
195	128013	28787		Linney Defence Post	Earthwork: Historic building	Castlemartin	Pembs.	SR8890197506	None		Fair					Gradual decline			14/01/2004
196	128014	28788			Earthwork: Historic building	Castlemartin	Pembs.	SR8904797585	None			Poor					Rapid decline		14/01/2004
197	128015	28789		Frainslake Sands Bridge	Upstanding structure	Castlemartin	Pembs.	SR8908497693	None	Good					Stable				14/01/2004
198	128016	28790			Earthwork: Upstanding structure	Castlemartin	Pembs.	SR8905897569	None			Poor				Gradual decline			14/01/2004
199	128017	28791		Brownslade Burrows	Earthwork: Historic building	Castlemartin	Pembs.	SR8917697587	None		Fair					Gradual decline			14/01/2004
200	128018	28792		Brownslade Burrows	Historic building	Castlemartin	Pembs.	SR89179757	None			Poor					Rapid decline		14/01/2004
201	128019	28793			Earthwork	Castlemartin	Pembs.	SR89559812	None			Poor				Gradual decline			15/01/2004
202	128020	28794		Brownslade Burrows		Castlemartin	Pembs.	SR89819830					Unknown					Unknown	15/01/2004
203	128021	28795		Brownslade Burrows		Castlemartin	Pembs.	SR89839838					Unknown					Unknown	15/01/2004
204	128022	28796			Earthwork: Upstanding structure	Castlemartin	Pembs.	SR9024097559	None	Good					Stable				06/01/2004
205	128023	28797		Blockhouse B	Earthwork: Upstanding structure	Castlemartin	Pembs.	SR9055296784	None	Good					Stable				06/01/2004
206	128024	28798		Blockhouse E	Earthwork: Upstanding structure	Castlemartin	Pembs.	SR9025996068	Other (Dragon's Teeth)	Good					Stable				07/02/2004
207	128025	28799		Penyholt Down Blockhouse	Earthwork: Upstanding structure	Castlemartin	Pembs.	SR9021195817	Other (Dragon's Teeth)	Good					Stable				07/02/2004
208	128026	28800			Earthwork: Upstanding structure	Castlemartin	Pembs.	SR9062795434	None	Good					Stable				07/02/2004
209	129399	32108			Findspot	Castlemartin	Pembs.	SR934954	None				Unknown						09/01/2004
210	129400	32109			Levelled (buried feature)	Castlemartin	Pembs.	SR93429538	None				Unknown		Stable				09/01/2004
211	129401	32110			Findspot	Castlemartin	Pembs.	SR93409518	None				Unknown		Stable				09/01/2004
212	129402	32111			Findspot	Castlemartin	Pembs.	SR95109415	None				Unknown		Stable				15/02/2004
213	131074	33444			Earthwork: Historic building	Castlemartin	Pembs.	SR8832596478	None	Good						Gradual decline			08/01/2004
214	131075	33445			Earthwork	Castlemartin	Pembs.	SR93029486	None			Poor				Gradual decline			11/01/2004
215	131076	33446			Historic building	Castlemartin	Pembs.	SR9423793926	Fenced	Good					Stable				11/01/2004
216	131077	33447		Buckspool Down Radar Station	Historic building	Castlemartin	Pembs.	SR95529336	Fenced	Good					Stable				15/02/2004
217	131078	33448			Earthwork	Castlemartin	Pembs.	SR9689893065	None			Poor				Gradual decline			10/01/2004
218	131079	33449			Earthwork: Historic building	Castlemartin	Pembs.	SR9696393098	None		Fair					Gradual decline			10/01/2004

	A	B	C	D	E	F	G	H	I	J	K	L	M	N	O	P	Q	R	S
219	131080	33450			Earthwork: Historic building	Castlemartin	Pembs.	SR9683093061	None	Good					Stable				10/01/2004
220	131081	33451			Earthwork: Historic building	Castlemartin	Pembs.	SR9727392931	None	Good					Stable				10/01/2004
221	131082	33452			Earthwork: Historic building	Castlemartin	Pembs.	SR9742193023	None		Fair					Gradual decline			10/01/2004
222	131083	33453			Earthwork: Upstanding structure	Castlemartin	Pembs.	SR9734692958	None		Fair				Stable				10/01/2004
223	131084	33454		Head Observation Post	Earthwork: Historic building	Castlemartin	Pembs.	SR9741392708	None	Good					Stable				10/01/2004
224	131101	33520			Upstanding structure	Castlemartin	Pembs.	SR97209305	None	Good						Gradual decline			10/01/2004
225		38876		Great Furznip Radar Plinth	Built over: Historic building	Castlemartin	Pembs.	SR88859881	Fenced	Good					Stable				17/12/2003
226		38877		Brownslade Burrows military track	Upstanding structure	Castlemartin	Pembs.	SR89719848	None			Poor					Rapid decline		15/01/2004
227		38880			Earthwork: Upstanding structure	Castlemartin	Pembs.	SR91229770	None			Poor			Stable				05/01/2004
228	104648	4678		Frainslake Mill	Historic building	Castlemartin	Pembs.	SR89879763	None		Fair					Gradual decline			05/01/2004
229	100494	511	SM Pemb.468	Linney Round Barrow	Earthwork	Castlemartin	Pembs.	SR8886796963	None		Fair				Stable				08/01/2004
230	100497	514		Brownslade Burrows	Findspot	Castlemartin	Pembs.	SR89209840	None						Stable				15/01/2004
231	100498	515		Frainslake Sands Bridge	Findspot	Castlemartin	Pembs.	SR889979	None							Gradual decline			14/01/2004
232	100504	521			Findspot	Castlemartin	Pembs.	SR8944198582	None							Gradual decline			17/12/2003
233	100506	523			Earthwork	Castlemartin	Pembs.	SR8957098620	None			Poor			Stable				17/12/2003
234	100518	535			Findspot	Castlemartin	Pembs.	SR88909563	None							Gradual decline			07/01/2004
235	100519	536	SM Pemb.467	Crowback Tumulus	Earthwork	Castlemartin	Pembs.	SR8897797483	None		Fair					Gradual decline			14/01/2004
236	100522	539	SM Pemb.316	Linney Head Hillfort	Earthwork	Castlemartin	Pembs.	SR8886195689	Signed		Fair					Gradual decline			07/01/2004
237	100525	542	SM Pemb.315	Brownslade Round Barrow	Earthwork	Castlemartin	Pembs.	SR9052997237	Signed		Fair				Stable				06/01/2004
238	100526	543	SM Pemb.315	Brownslade Churchways	Earthwork	Castlemartin	Pembs.	SR9052997237					Unknown					Unknown	06/01/2004
239	100527	544		Churchways Chapel	Earthwork: Upstanding structure	Castlemartin	Pembs.	SR9055097317	Signed			Poor			Stable				06/01/2004
240	100529	546			Findspot	Castlemartin	Pembs.	SR926953	None			Poor					Rapid decline		12/01/2004
241	100530	547			Findspot	Castlemartin	Pembs.	SR935956	None						Stable				09/01/2004
242	100544	561	SM Pemb.270	Bulliber Camp East	Earthwork	Castlemartin	Pembs.	SR9068896551	Signed		Fair					Gradual decline			13/01/2004
243	100546	563	LB2*	Flimston Chapel	Historic building	Castlemartin	Pembs.	SR9239095593	Other (Stone wall)	Good					Stable				12/01/2004
244	100575	592			Findspot	Castlemartin	Pembs.	SR932948	None						Stable				11/01/2004
245	100585	602	SM Pemb.318	Flimston Bay Fort	Earthwork	Castlemartin	Pembs.	SR9297694606	Signed		Fair					Gradual decline			11/01/2004

	A	B	C	D	E	F	G	H	I	J	K	L	M	N	O	P	Q	R	S
246	100589	606			Findspot	Castlemartin	Pembs.	SR925945	None						Stable				15/02/2004
247	100590	607			Findspot	Castlemartin	Pembs.	SR92609470	None						Stable				11/01/2004
248	100591	608			Findspot	Castlemartin	Pembs.	SR940945	None						Stable				11/01/2004
249	100594	611		Castle Tank	Findspot	Castlemartin	Pembs.	SR96509339	None						Stable				10/01/2004
250	100595	612		Buckspool Down	Findspot	Castlemartin	Pembs.	SR95569333	None						Stable				15/02/2004
251	100596	613		Bosherston Mere	Findspot	Castlemartin	Pembs.	SR96159289	None							Gradual decline			21/02/2004
252	100613	630	LB1: SM Pemb.312	St Govans Chapel	Historic building	Castlemartin	Pembs.	SR9607492962	None	Good				Improving					10/01/2004
253	106387	6440		Frainslake Cottage	Historic building	Castlemartin	Pembs.	SR9007497531	None		Fair				Stable				05/01/2004
254	106389	6442		Cuckoo Rock Cottage	Historic building	Castlemartin	Pembs.	SR9182095520	None			Poor				Gradual decline			07/01/2004
255	106392	6445		Cloyne Farmstead	Earthwork: Upstanding structure	Castlemartin	Pembs.	SR9015197279	None			Poor			Stable				05/01/2004
256	106393	6446		Drayton House	Upstanding structure	Castlemartin	Pembs.	SR9038796665	None			Poor					Rapid decline		06/01/2004
257	106399	6452	LB2*: SM Pemb.447	Flimston Farmstead	Historic building	Castlemartin	Pembs.	SR9241295635	Fenced		Fair				Stable				12/01/2004
258	106906	6076	SM Pemb.451	Pricaston Farmstead	Historic building	Castlemartin	Pembs.	SR91809649	Fenced + Signed		Fair				Stable				12/01/2004
259	107427	7505			Findspot	Castlemartin	Pembs.	SR89509860	None						Stable				17/12/2003
260	108116	8229		Ermigate Cottage		Castlemartin	Pembs.	SR92929619	None						Stable				16/01/2004
261	118669	8791			Historic building	Castlemartin	Pembs.	SR9026497472	None	Good					Stable				05/01/2004
262	109778	9907		Penyholt Farm		Castlemartin	Pembs.	SR89719641	None				Unknown					Unknown	09/01/2004
263	109870	9999			Findspot	Castlemartin	Pembs.	SR97409280	None						Stable				10/01/2004
264	110387 + 107755	10517 + 7846		Moor Cottages	Earthwork: Historic building	Castlemartin	Pembs.	SR9196097920	None			Poor					Rapid decline		16/01/2004
265	101228 + 100516 + 107457	1249 + 533 + 7536		Brownslade Burrows	Findspot	Castlemartin	Pembs.	SR89649758	None			Poor					Rapid decline		14/01/2004
266	114323 + 114324 + 114 343	14642 + 14643 + 14662			Findspot	Castlemartin	Pembs.	SR895973	None						Stable				14/01/2004
267	114340 + 114341	14659 + 14660			Findspot	Castlemartin	Pembs.	SR897972	None						Stable				09/01/2004
268	125959 + 126153	26315 + 26509		Brownslade Quarry	Earthwork	Castlemartin	Pembs.	SR9099397092	None		Fair				Stable				09/01/2004
269	126067 + 126160 + 126114	26423 + 26516 + 26470			Earthwork	Castlemartin	Pembs.	SR9171894463	None	Good					Stable				07/02/2004
270	126085 + 126076	26441 + 26432		Pricaston Mill House and Cottage	Historic building	Castlemartin	Pembs.	SR9174796529	Fenced			Poor				Gradual Decline			12/04/2001
271	126156 + 125976	26512 + 26332		Quarry anf Limekiln	Earthwork	Castlemartin	Pembs.	SR9289596161	None		Fair				Stable				12/01/2004
272	127995 + 131071	28796 + 33441		Observation Post S	Earthwork: Historic building	Castlemartin	Pembs.	SR8834095811	None	Good					Stable				07/01/2004
273	100495 + 100496	512 + 513		Linney Round Barrows	Earthwork	Castlemartin	Pembs.	SR89219725 + SR89199725	None						Stable				14/01/2004

	A	B	C	D	E	F	G	H	I	J	K	L	M	N	O	P	Q	R	S
274	100502 + 100503 + 100505	519 + 520 + 522			Findspot	Castlemartin	Pembs.	SR89399861	None						Stable				17/12/2003
275	100507 + 100508 + 107428 + 107429	524 + 525 + 7506 + 7507			Findspot	Castlemartin	Pembs.	SR89889744	None						Stable				05/01/2004
276	100511 + 100512	528 + 529		Brownslade Burrows	Findspot	Castlemartin	Pembs.	SR89389780	Other (White posts) + Signed							Gradual Decline			14/01/2004
277	100513 + 100514	530 + 531		Brownslade Burrows	Findspot	Castlemartin	Pembs.	SR89719797	None						Stable				21/02/2004
278	100515 + 107458	532 + 7537			Findspot	Castlemartin	Pembs.	SR89539765	None						Stable				14/01/2004
279	107459	534 + 7538			Findspot	Castlemartin	Pembs.	SR8938097080	None						Stable				08/01/2004
280	100532 + 100533	549 + 550	SM Pemb.021	Bulliber Hillfort	Earthwork: Findspot	Castlemartin	Pembs.	SR9028396629	Signed		Fair				Stable				08/02/2004
281	100586 + 100587 + 100588	603 + 604 + 605	SM Pemb.319	Crockysdam Hillfort	Earthwork	Castlemartin	Pembs.	SR9359694326	None		Fair					Gradual Decline			11/01/2004
282	100592 + 100593	609 + 610	SM Pemb.320	Buckspool Camp	Earthwork	Castlemartin	Pembs.	SR95439340	None		Fair				Stable				15/02/2004
283	106394	6447		Brownslade Mansion		Castlemartin	Pembs.	SR91039752	Fenced				Unknown					Unknown	05/01/2004
284	106899 + 126512	6969 + 27079		Linney Farm	Earthwork	Castlemartin	Pembs.	SR89259692	None			Poor					Rapid decline		08/01/2004
285	106908 + 106909	6978 + 6979		Slade Cattage	Historic building	Castlemartin	Pembs.	SR9108096394SR9109196412	None			Poor				Gradual Decline			13/01/2004
286																			
287																			
288																			

archaeological condition survey



Castlemartin Army Training Estate Pembrokeshire
archaeological condition survey

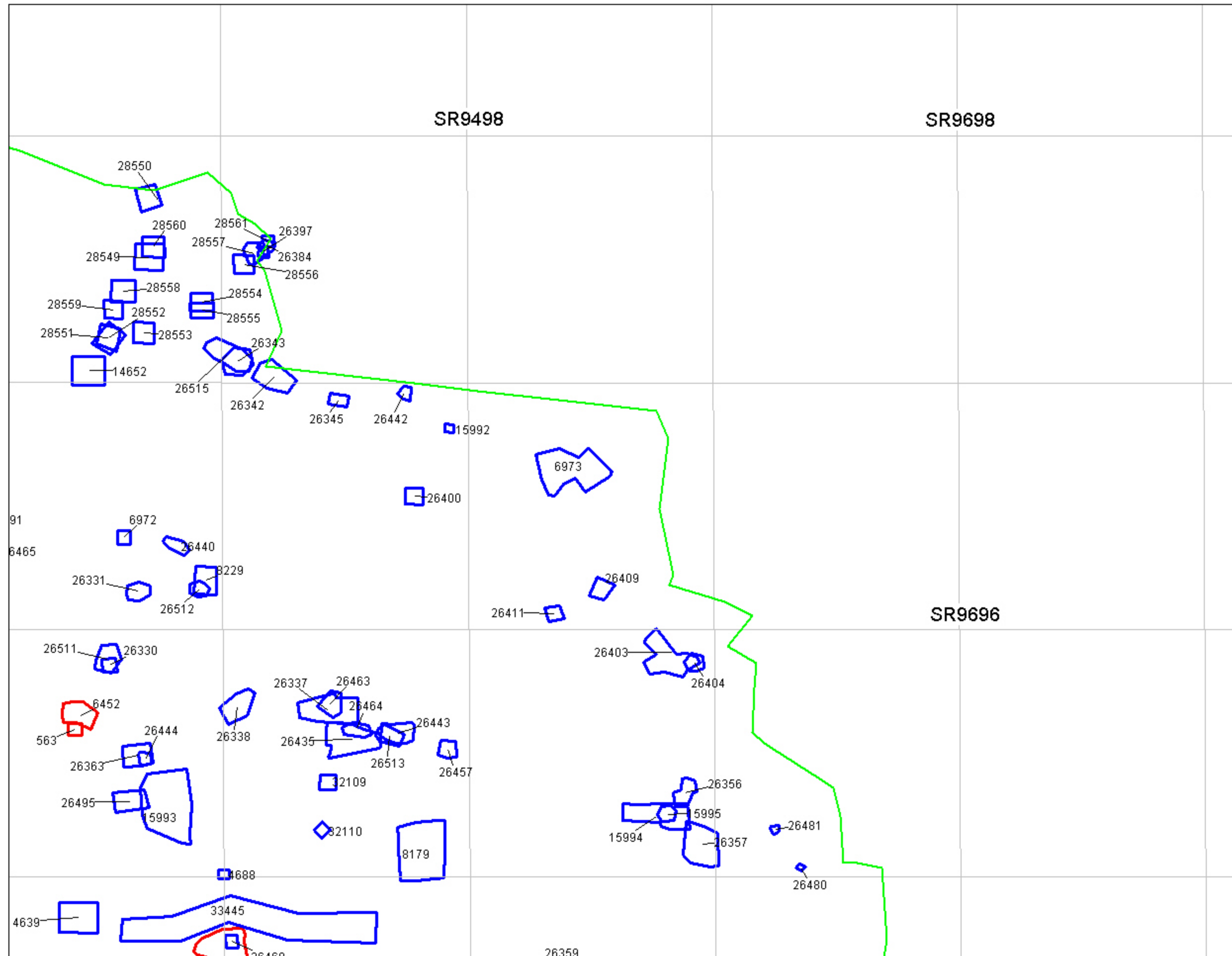

Map 3 Distribution of archaeological site polygons

- Scheduled Ancient Monument (statutory boundary)
- Archaeological site (non-statutory boundary)
- Castlemartin ATE site boundary

Castlemartin Army Training Estate Pembrokeshire
archaeological condition survey

Map 2 Distribution of findspots

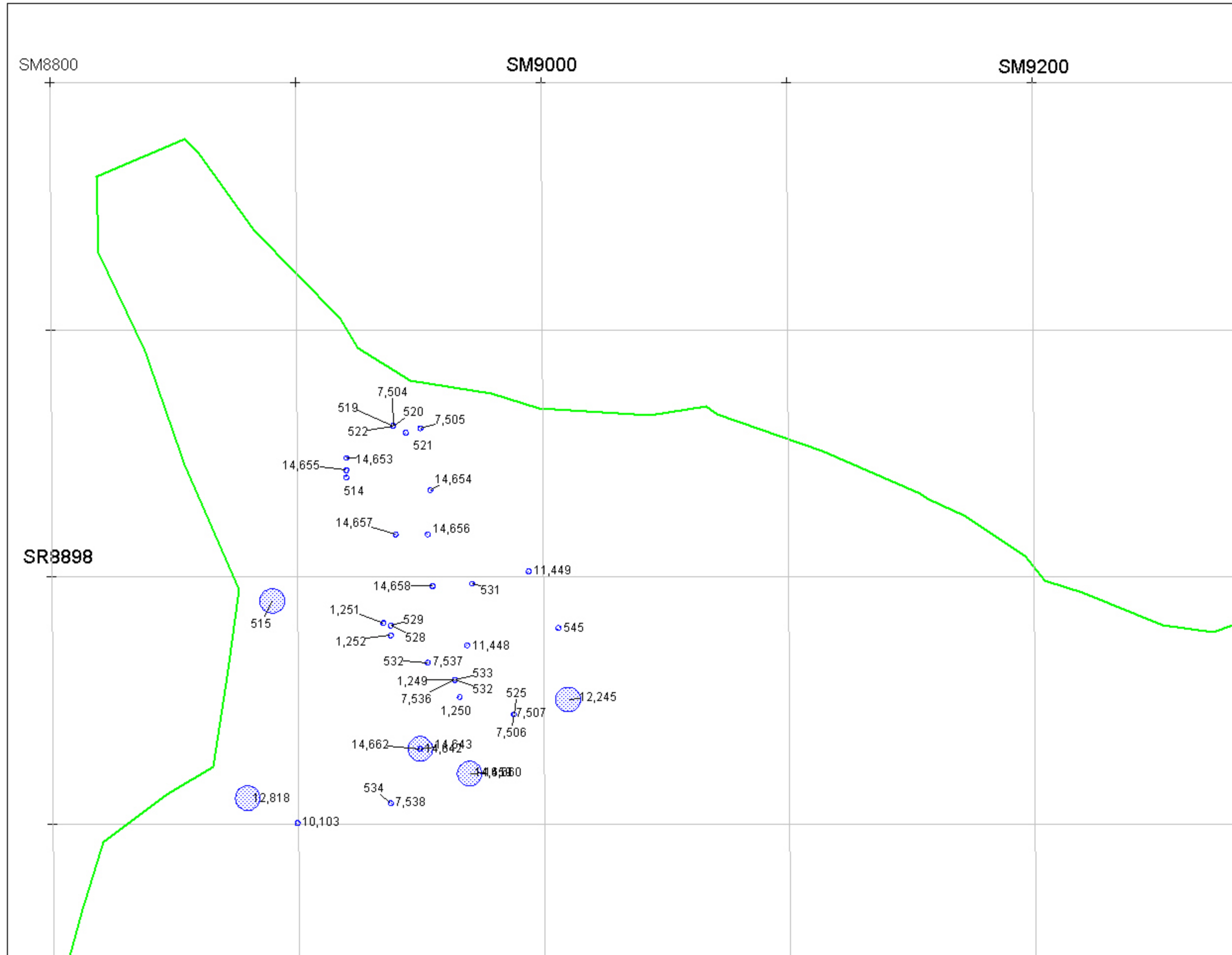

Castlemartin Army Training Estate Pembrokeshire
archaeological condition survey

Map 4 Distribution of findspots

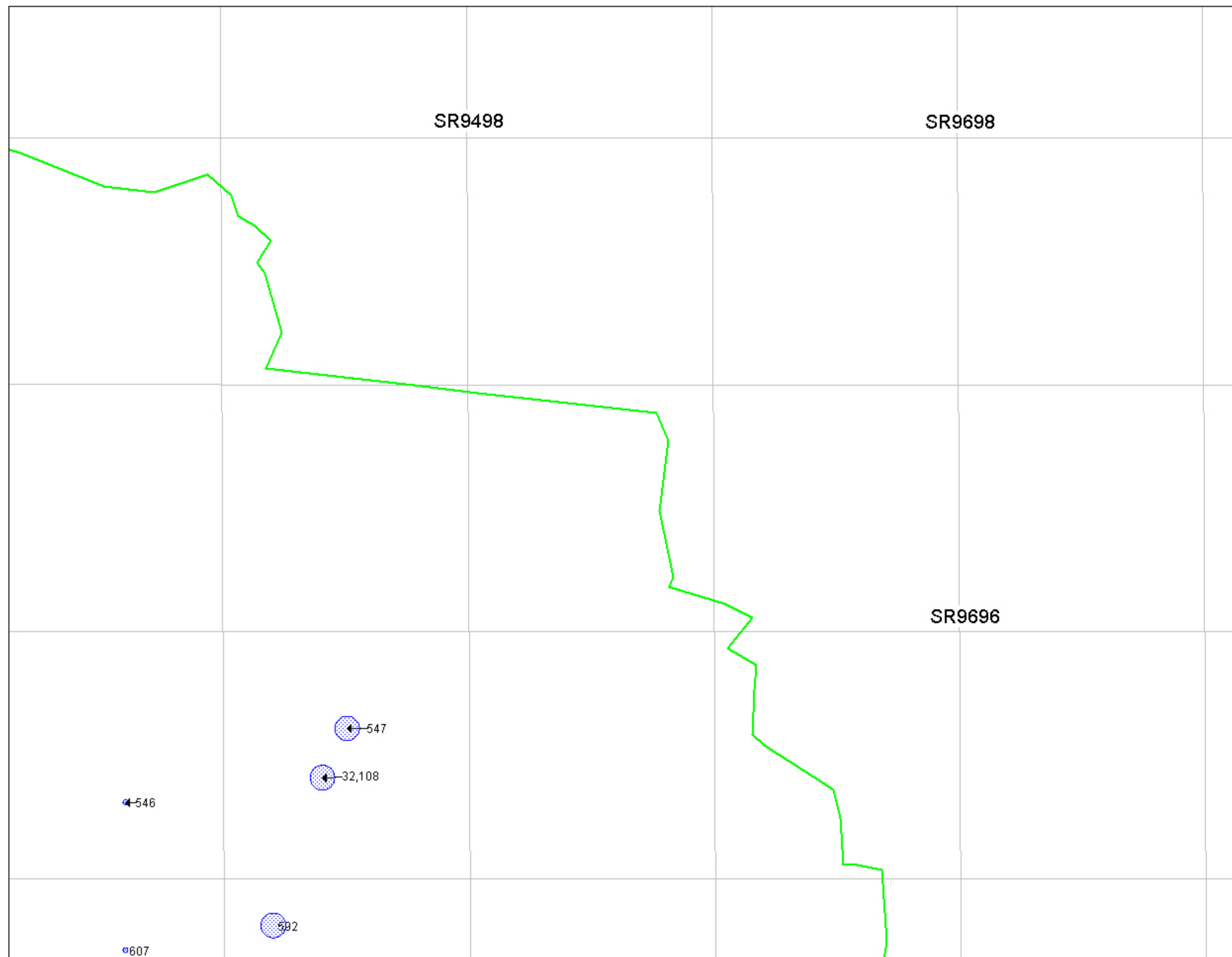

- Findspot - 8-figure NGR
- Findspot - 10-figure NGR
- Findspot - 12-figure NGR

Castlemartin Army Training Estate Pembrokeshire
archaeological condition survey

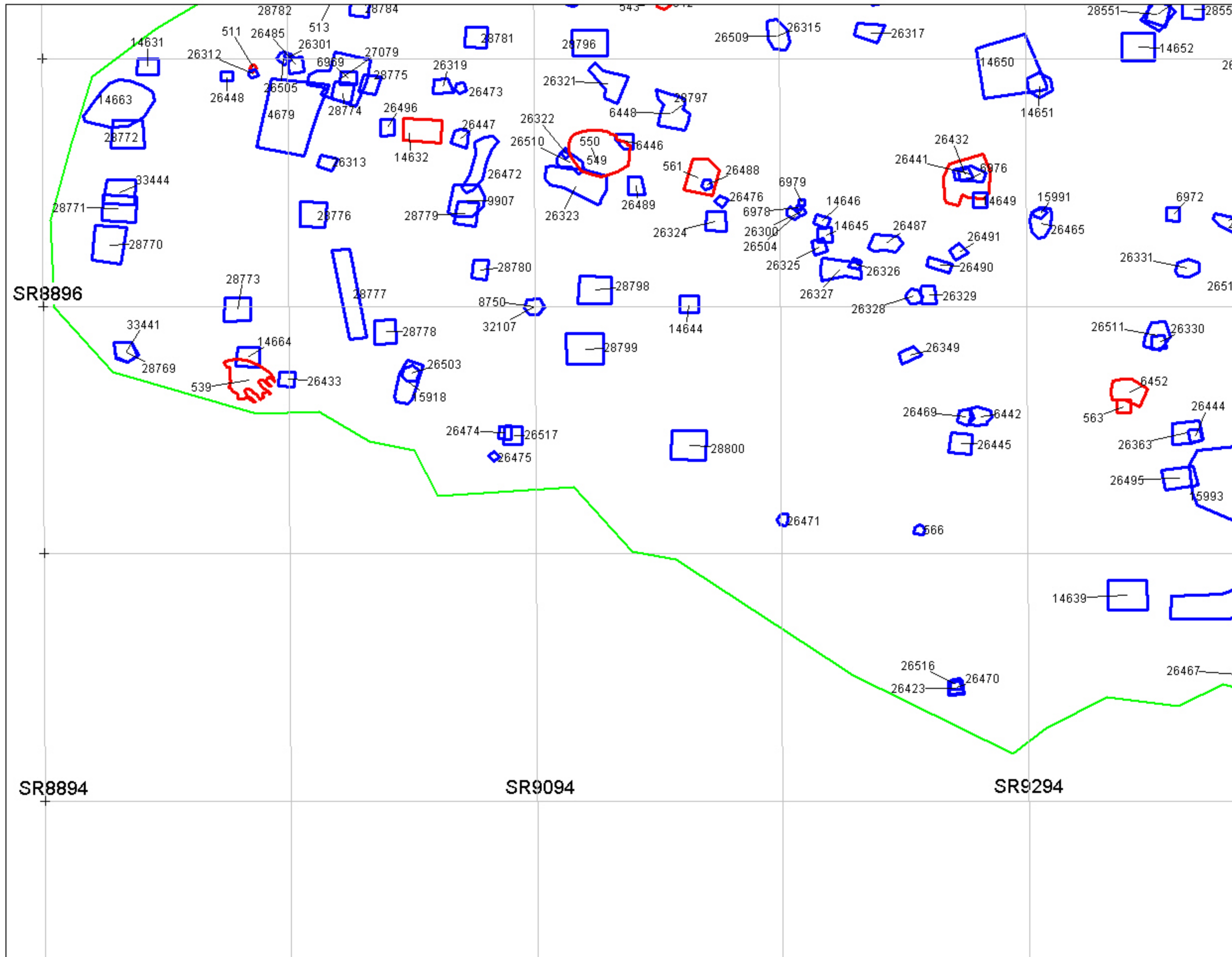

- Map 5 Distribution of archaeological site polygons
- Scheduled Ancient Monument (statutory boundary)
 - Archaeological site (non-statutory boundary)
 - Castlemartin ATE site boundary

Castlemartin Army Training Estate Pembrokeshire
archaeological condition survey

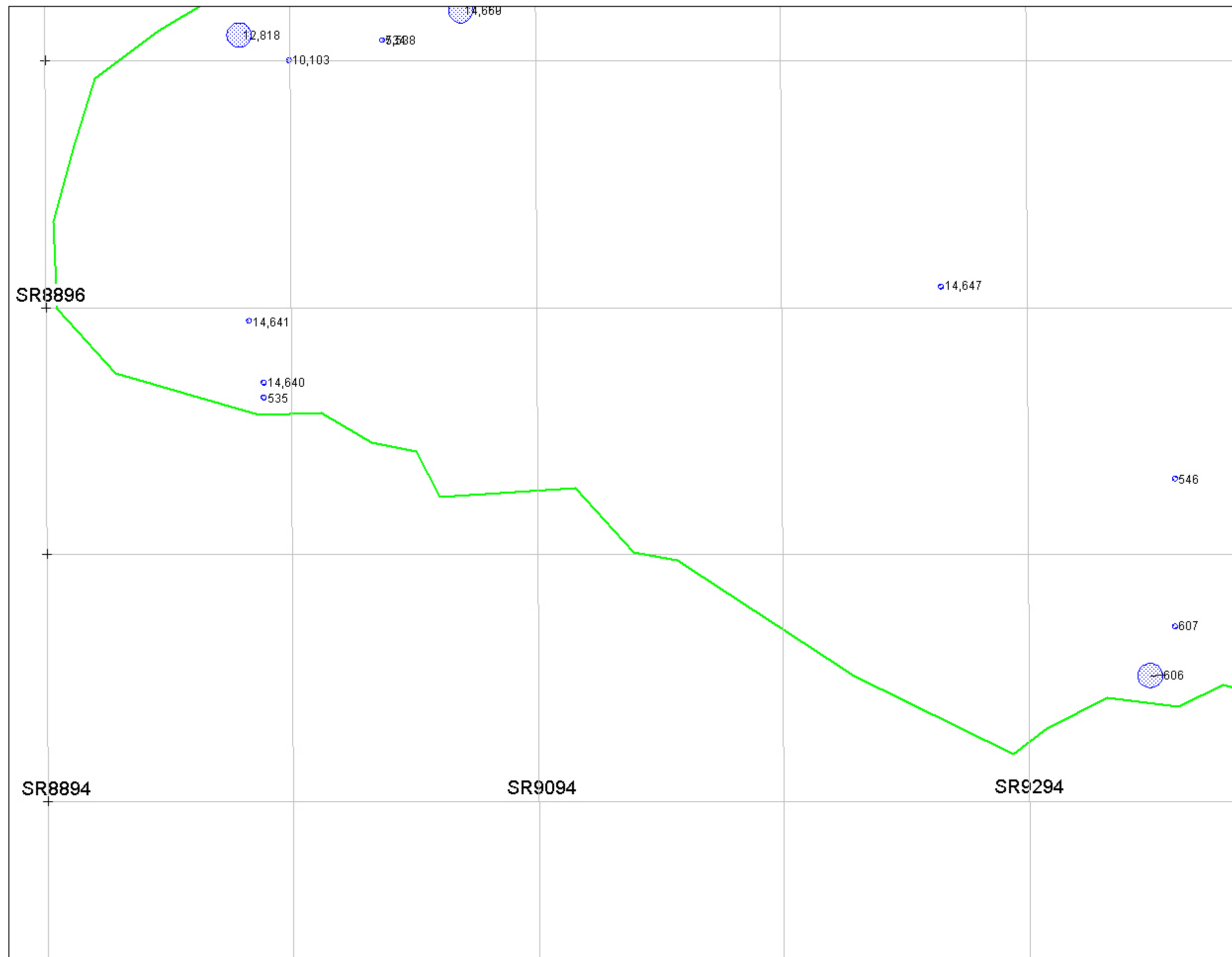

Map 6 Distribution of findspots

- Findspot - 8-figure NGR
- Findspot - 10-figure NGR
- Findspot - 12-figure NGR

archaeological condition survey

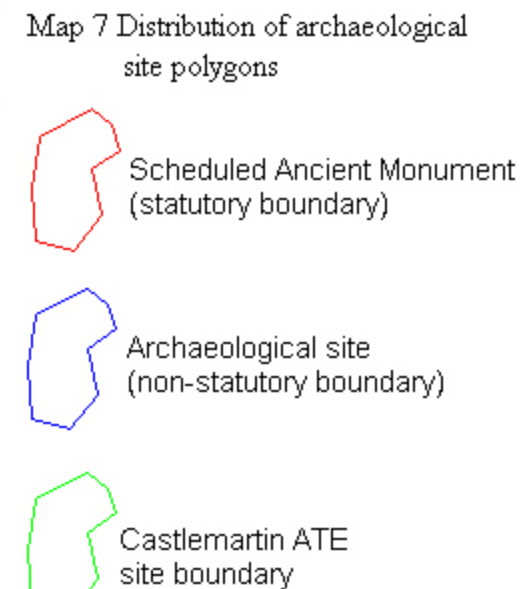

Castlemartin Army Training Estate Pembrokeshire
archaeological condition survey

Map 8 Distribution of findspots

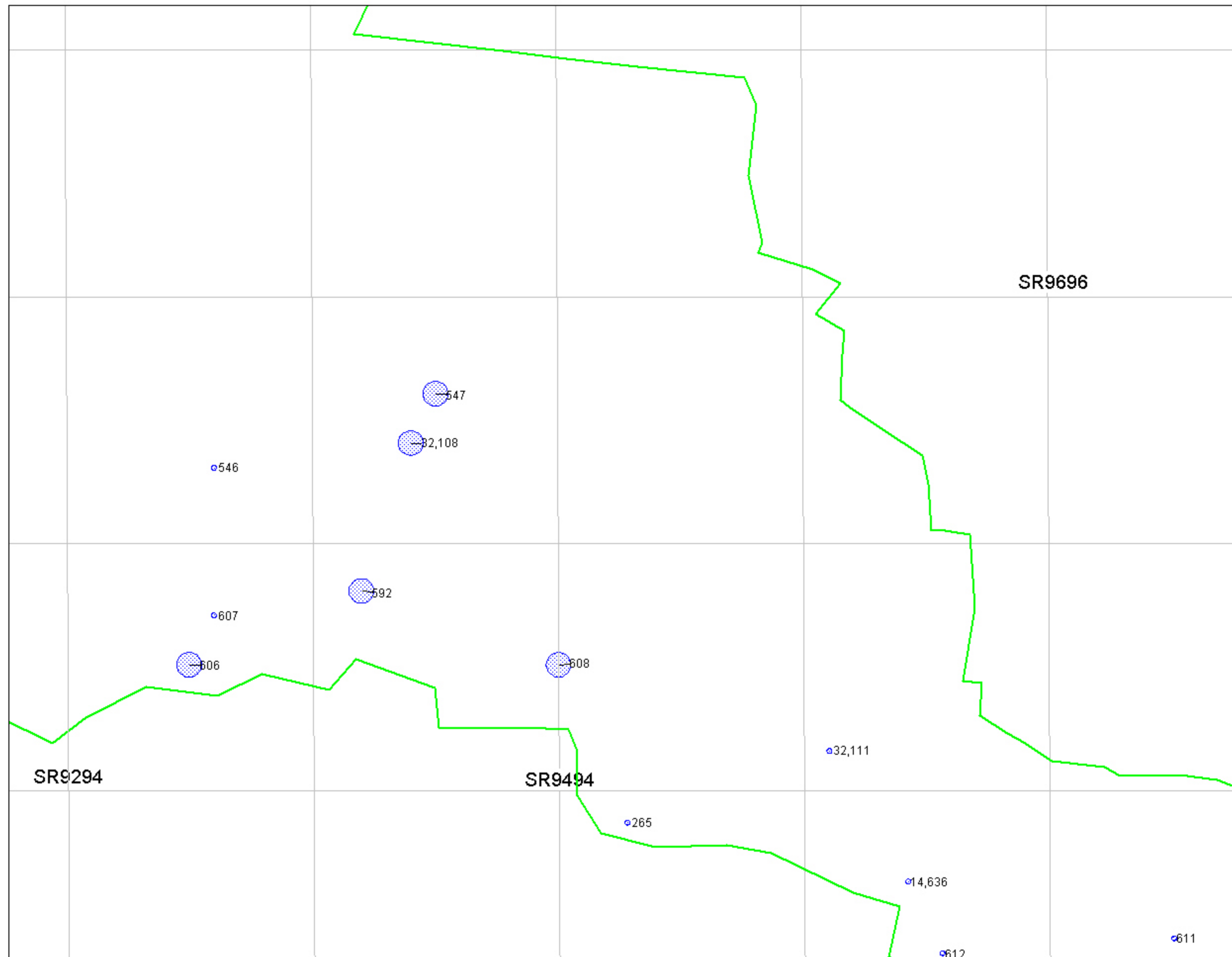

Castlemartin Army Training Estate Pembrokeshire
archaeological condition survey

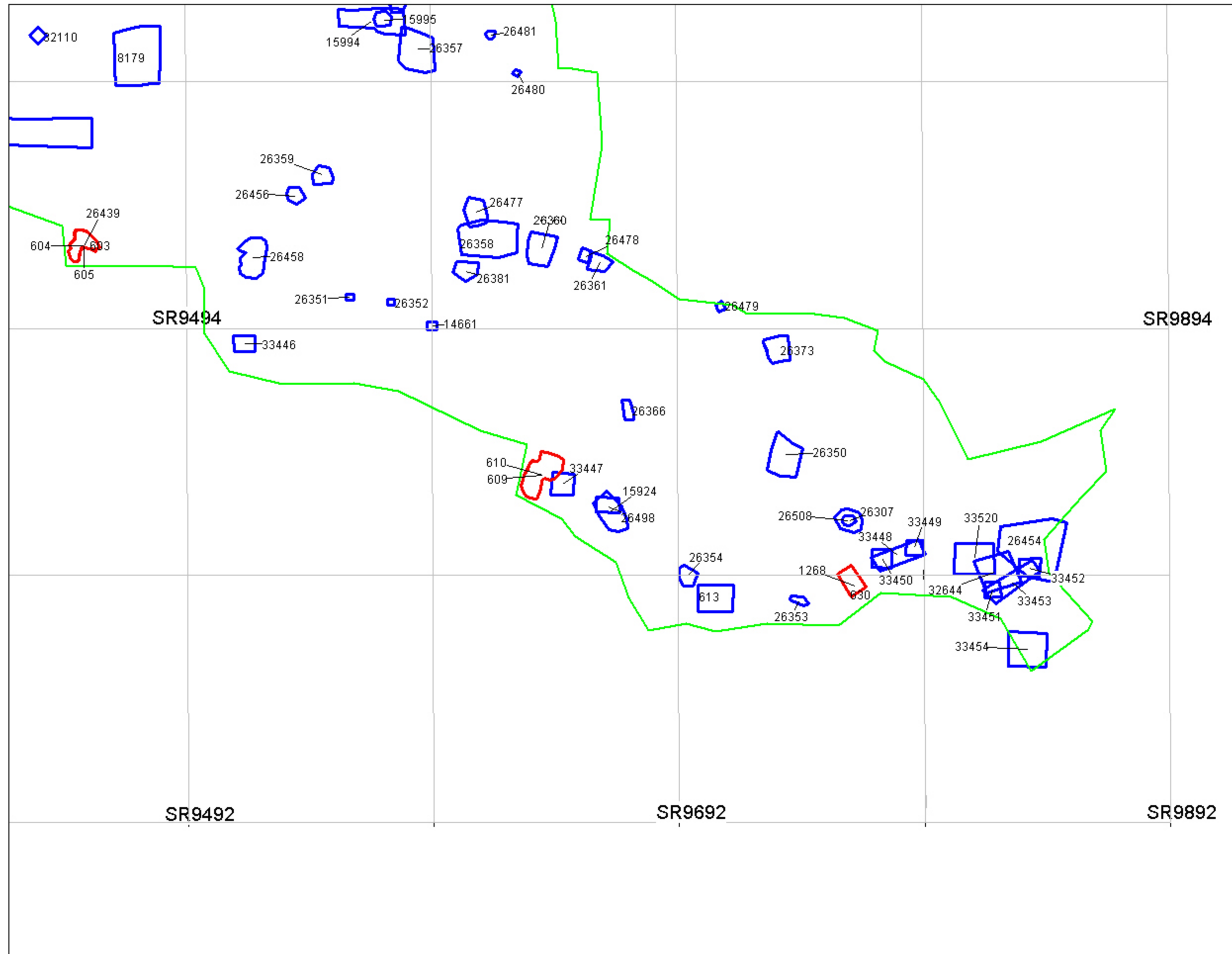

- Scheduled Ancient Monument (statutory boundary)
- Archaeological site (non-statutory boundary)
- Castlemartin ATE site boundary

Castlemartin Army Training Estate Pembrokeshire
archaeological condition survey

Map 10 Distribution of findspots

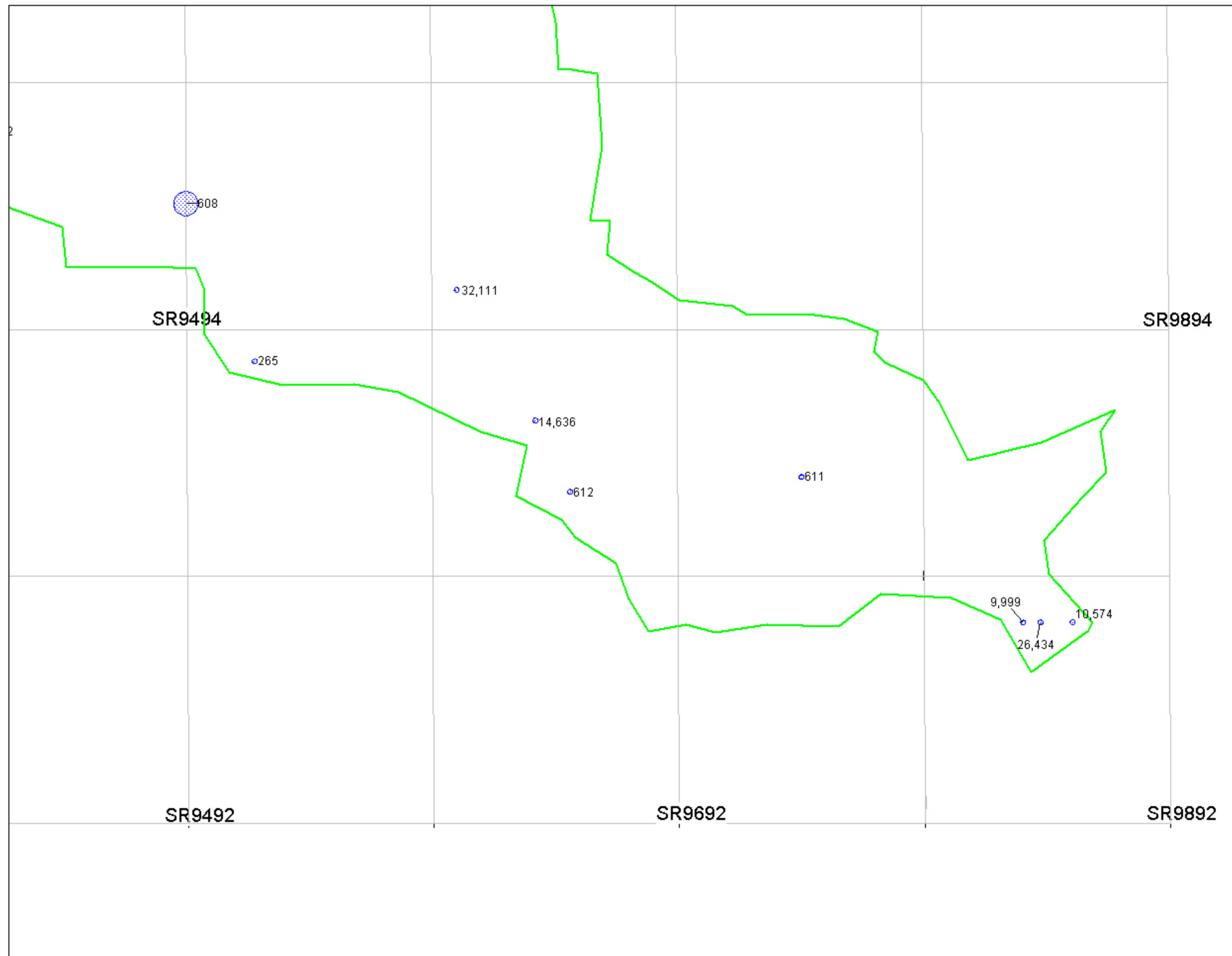

- Findspot - 8-figure NGR
- Findspot - 10-figure NGR
- Findspot - 12-figure NGR

archaeological condition survey

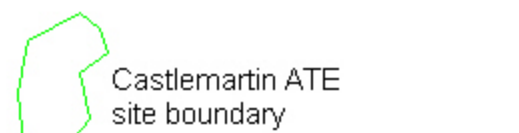

Castlemartin Army Training Estate Pembrokeshire
archaeological condition survey

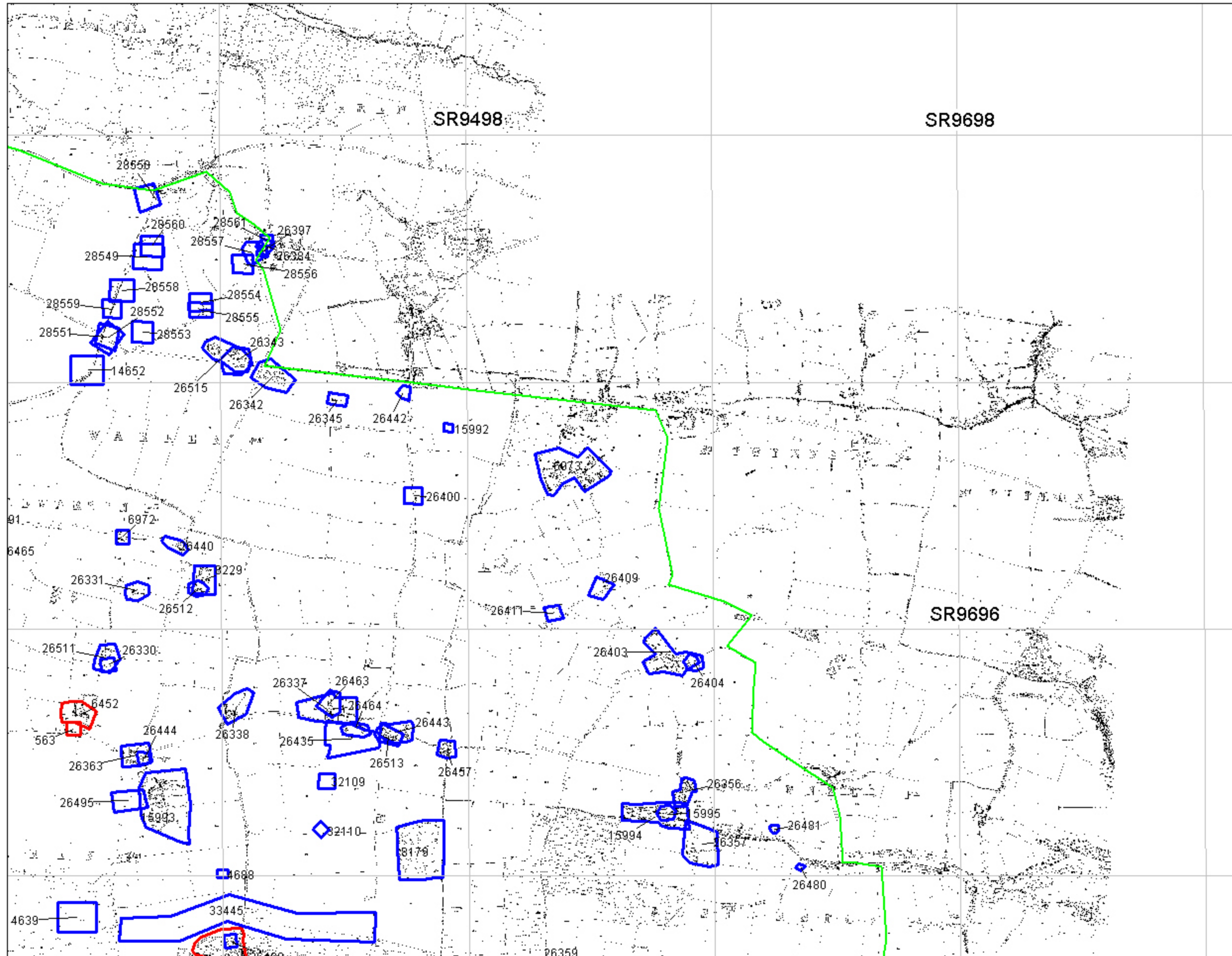

- Scheduled Ancient Monument (statutory boundary)
- Archaeological site (non-statutory boundary)
- Castlemartin ATE site boundary

Castlemartin Army Training Estate Pembrokeshire
archaeological condition survey

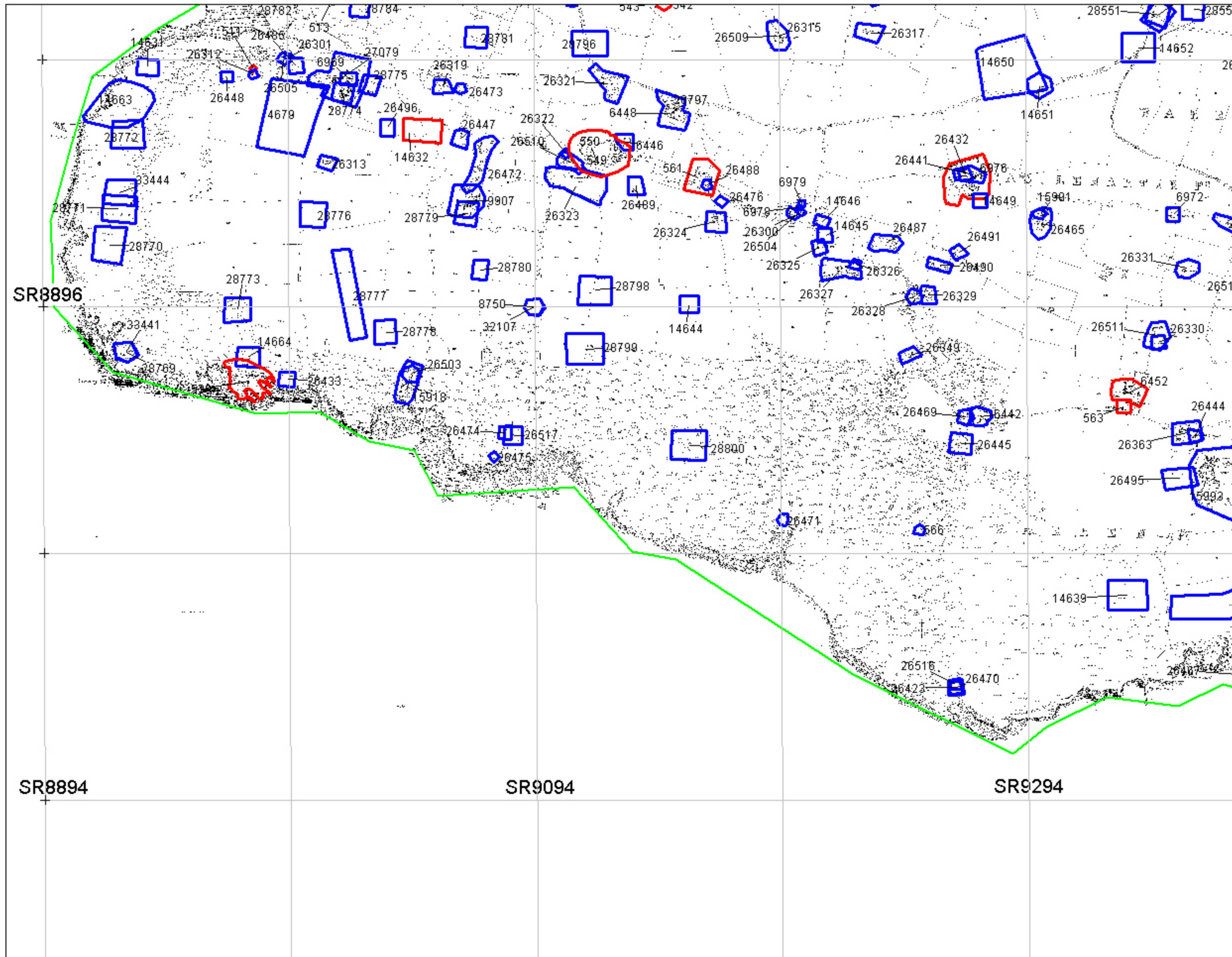

Map 13 Distribution of archaeological site polygons on historic Ordnance Survey mapping

- ▭ Scheduled Ancient Monument (statutory boundary)
- ▭ Archaeological site (non-statutory boundary)
- ▭ Castlemartin ATE site boundary

archaeological condition survey

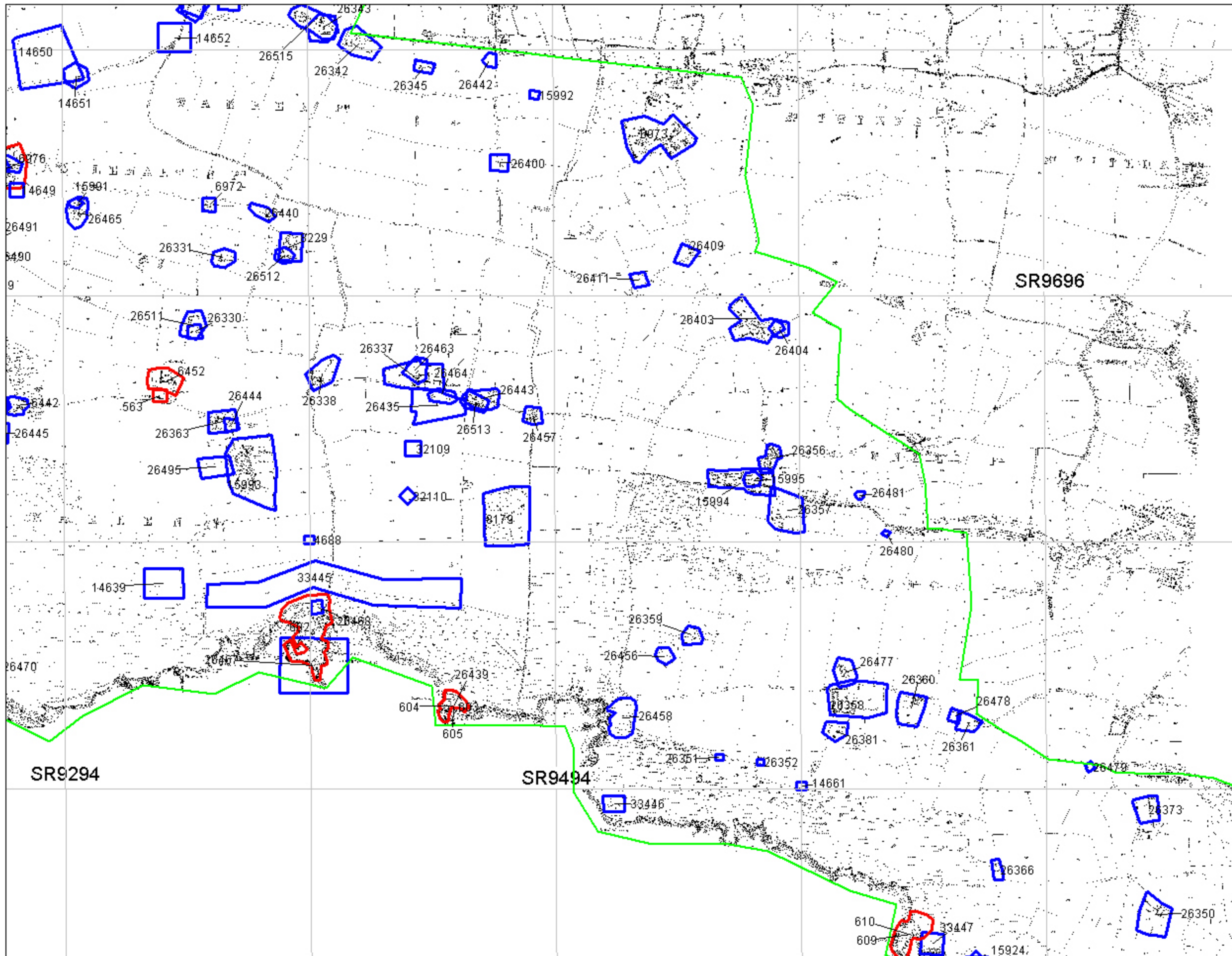

Map 14 Distribution of archaeological site polygons On historic Ordnance Survey mapping

 Scheduled Ancient Monument
(statutory boundary)

Archaeological site
(non-statutory boundary)

Castlemartin ATE
site boundary

Castlemartin Army Training Estate Pembrokeshire
archaeological condition survey

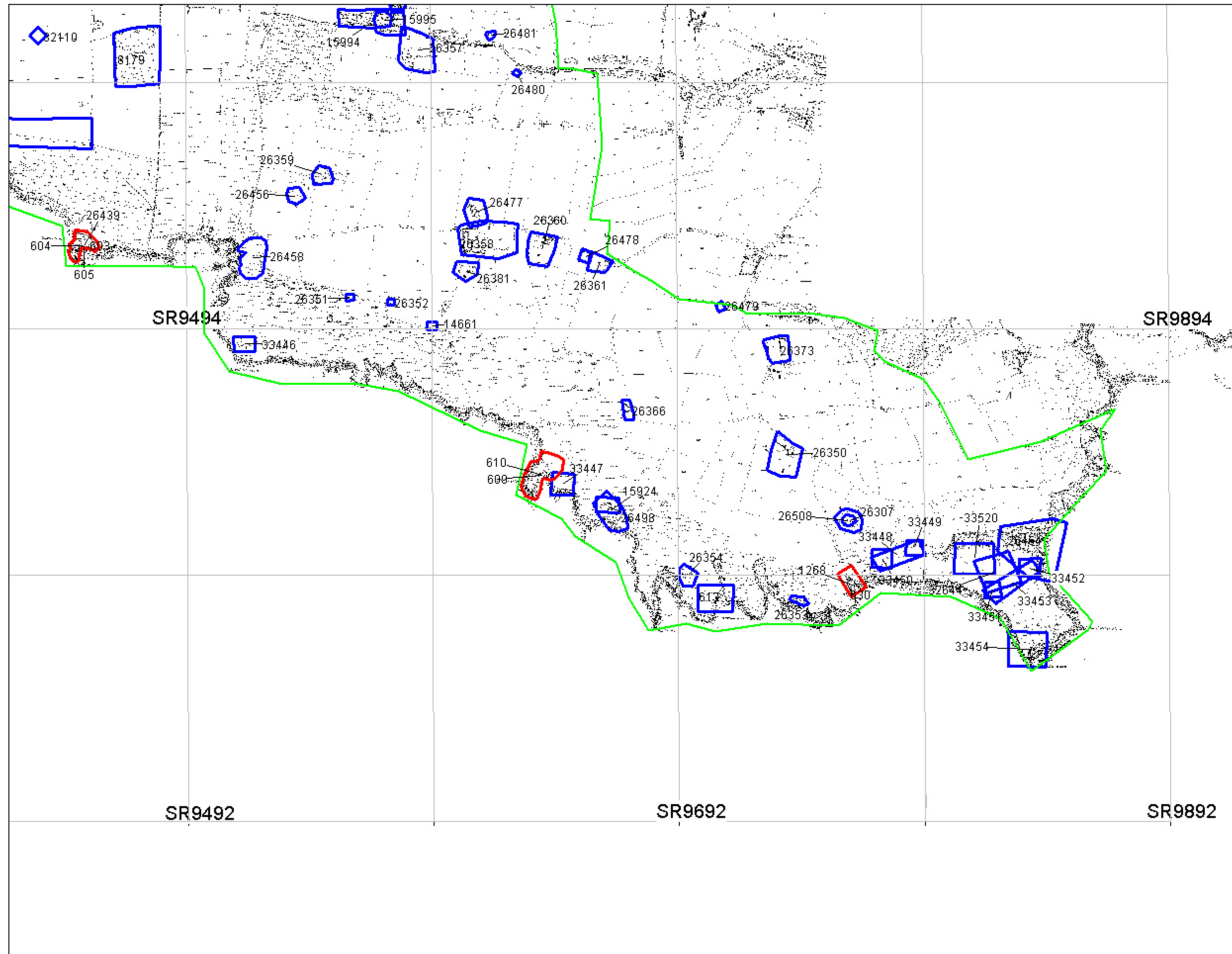

Map 15 Distribution of archaeological site polygons on historic Ordnance Survey mapping

- Scheduled Ancient Monument (statutory boundary)
- Archaeological site (non-statutory boundary)
- Castlemartin ATE site boundary