

# **Tir Gofal Farm Visit Report**

**Cae Iago**

**W/12/2445**

**Report Number 2002/5**

**Report prepared for  
CCW**



A R C H A E O L O G Y

CAMBRIA

A R C H A E O L O G Y

CAMBRIA ARCHAEOLOGY

REPORT NO. 2002/5

PROJECT RECORD NO. 41843

January 2002

CAE IAGO  
TIR GOFAL FARM VISIT REPORT

By

Alice Pyper

*Cambria Archaeology is the marketing name of the Dyfed Archaeological Trust Ltd*

*The report has been prepared for the specific use of the client. The Dyfed Archaeological Trust Ltd can accept no responsibility for its use by any other person or persons who may read it or rely on the information it contains.*

ARCHAEOLEG CAMBRIA	CAMBRIA ARCHAEOLOGY
Ymddiriedolaeth Archaeolegol Dyfed Cyf	Dyfed Archaeological Trust Limited
Neuadd y Sir, Stryd Caerfyrddin, Llandeilo, Sir Gaerfyrddin SA19 6AF	The Shire Hall, Carmarthen Street, Llandeilo, Carmarthenshire, SA19 6AF
Ffon: Ymholiadau Cyffredinol 01558 823121	Tel: General Enquiries 01558 823121
Adran Rheoli Treftadaeth 01558 823131	Heritage Management Section 01558 823131
Ffacs: 01558 823133	Fax: 01558 823133
Ebost: cambria@acadat.com Gwefan: www.acadat.com	Email: cambria@acadat.com Website: www.acadat.com

The Trust is both a Limited Company (No. 1198990) and a Registered Charity (No. 504616)  
CADEIRYDD CHAIRMAN: B.C.BURNHAM, MA PhD FSA MIFA. CYFARWYDDWR DIRECTOR: E.G.HUGHES BA MIFA

**Tir Gofal Application Number** W/12/2445  
**Address** Cae Iago  
Ffarmers, Llanwrda, SA19 8LZ

**National Grid Reference** SN64764578  
**CCW Tir Gofal Project Officer** Kevin Taylor, Llandeilo  
**CA Tir Gofal Archaeologist** Alice Pyper  
**Visit Date** 08/01/02

---

## **CONTENTS**

### **Introduction**

#### **Method Statement**

### **General Description of Farm**

### **Main Management Recommendations**

#### **Key to Management Categories**

#### **Site and Area Designations**

### **Farm Maps**

### **Gazetteer of Sites and Monuments, including Individual Management Recommendations**

### **References**

### **Photographs**

## **INTRODUCTION**

This report is intended to provide a statement on the condition and recommended management of all known archaeological and historical sites and features on the farm at the time it was visited by Cambria Archaeology. This information will be used to inform the Tir Gofal Management Agreement for the farm.

### **Method Statement**

The farm visit consisted of two phases.

Phase 1 was a rapid search of all readily available documentary, cartographic and published sources to try to understand the historical development of the farm and the wider landscape and to identify new sites of archaeological interest. The searches undertaken for this visit include information held in the regional Sites and Monuments Record, the relevant County Records Office and the National Library of Wales. New sites, or areas of interest were plotted onto a GIS-based map for use in the field and for the final report.

Phase 2 was a site visit to assess the extent, character and current condition of the archaeological and historical sites identified during the research phase, although because of constraints, recording is rapid, usually photographs and site notes, and some of the sites may not have been visited. The information gained during the visit has been used to assign the farm and its individual sites to a management category, which have determined the management recommendations for each site.

## GENERAL DESCRIPTION OF FARM

The holding of Cae Iago is situated 1 km to the north of Ffarmers. It has land on either side of the minor road that follows the route of the Roman road, Sarn Helen. The farm has been run as a family business providing horse riding holidays for the last 30 years.

The farmhouse is a rectangular building, south facing, with the gable end to the road. It appears to be late 19th century externally, it has a symmetrical facade in the Georgian tradition with a deep cornice, decorated with modillions. The south facing elevation is rendered and inscribed with ashlar blockwork.

To the north west of the farmhouse is a cow shed aligned north west - south east (PRN 43946). To the south is another cowshed parallel to the first, (PRN 43947). A corrugated iron barn (PRN 43948) and an asbestos building (PRN 43949) to the south of the farmhouse are 20th century additions to the farmstead.

The farm first appears on the original surveyors drawings of 1819, which record the farm name as Ty poeth. The buildings are discernible as two separate ranges at right angles to each other. Similarly the old series ordnance survey map of 1834, also records the buildings in the same arrangement, but named Cae-echo.

The Tithe map and apportionment of Cynwil Gaeo, indicate that the land holding has not changed significantly since 1841, with the addition of a single field to the north, between the Afon Twrch and the road. The farm was named Cae Hecco, and owned and occupied by David Davies Junior (presumably a family connection to David Davies Senior at the adjoining farm of Typoeth). The Tithe map shows a group of three rectangular buildings, two ranges forming a T-shape with an additional range to the west, however it is difficult to identify which of the buildings identified relate to those visible today.

The 1st edition ordnance survey map (1891) shows a group of four buildings to the west side of the road, three of which appear to conform to the arrangement of the present farmstead. The 2nd edition ordnance survey map (1906) records the addition of the extension, to north side of the farmhouse, that is visible today.

The farmstead is a typical cluster of buildings of various ages and although none of the buildings appear to be of great antiquity, this does not detract from their particular historical character. It is likely, given its location on a road known to be of Roman origin, that this may have been the site of a farmstead for many centuries.

The farm boundaries appear to survive almost intact, as established in the 1st edition ordnance survey map of 1891. The boundaries to the east of the road are well constructed with stone and earth (plate 1). The hedgerows on top are very overgrown and are now largely composed of mature trees. To the north west of the farmstead some boundaries have been replaced with post and wire fencing.

## **MAIN MANAGEMENT RECOMMENDATIONS**

The farm boundaries, which form an important historical characteristic of the farm, should be maintained as visible landscape features. Archaeological sites on the holding which require action are detailed below, for other management recommendations see the gazetteer of individual sites.

Currently the farm buildings are maintained in a stable condition, and used in a manner compatible with their original function. If a change of use is considered which may involve alterations to the buildings, the work should maintain the historic fabric intact, and existing openings should be retained as far as possible.

PRN 43947 - At the west end the cow shed is very overgrown with ivy and has considerable cracks in the north east facing wall. The vegetation should be cut, and allowed to die back before being carefully removed. The masonry should then be consolidated.

See gazetteer for detailed management recommendations.

## KEY TO MANAGEMENT CATEGORIES

Category	Importance	Colour on map	Detail
Category A	Sites and Monuments of National Importance	Blue	Scheduled Ancient Monuments Grade 1 and 2* Listed Buildings
		Red	Other Sites and Monuments of National Importance Other Buildings Of National Importance
		Red Toning	Registered Parks and Gardens of Historic Interest
		Red Banding	Registered Landscapes of Historic Interest
Category B	Sites and Monuments of Regional Importance	Amber	Sites and Monuments of Regional Importance Grade 2 Listed Buildings and Other Buildings of Regional Importance
Category C	Sites and Monuments of Local Importance	Green	Sites and Features of Local Importance Buildings of Local Importance
Category D	Sites and Monuments of Unknown Importance	Brown	Sites and Features needing further investigation includings damaged sites or sites with no physical definition

## **SITE AND AREA DESIGNATIONS**

The following abbreviations are used in the gazetteer to refer to site and area status designations.

### **SAM** Scheduled Ancient Monument

SAMs are notified under Section 1 of the Ancient Monuments and Archaeological Areas Act 1979. The schedule of SAMs is maintained and administered by Cadw.

### **LB1, LB2\* and LB2** Listed Buildings

Listed Buildings are notified under Section 1 of the Planning (Listed Buildings and Conservation Areas) Act 1990. The list is maintained and administered by Cadw. Local Authorities are statutory consultees for listed buildings.

### **HLW** Landscapes of Historic Interest in Wales

Defined by the Register of Landscapes, Parks and Gardens of Special Historic Interest in Wales, Landscapes of Historic Interest in Wales: Part 2.1 Landscapes of Outstanding Historic Interest; Part 2.2 Landscapes of Special Historic Interest. The register is advisory only and has no statutory powers. The register was compiled by Cadw in partnership with the Countryside Council for Wales and the International Council on Monuments and Sites (ICOMOS)

### **HGP** Register of Historic Gardens and Parks

Defined by the Register of Landscapes, Parks and Gardens of Special Historic Interest in Wales, Part 1 Parks and Gardens. The register is advisory only and has no statutory powers. The register was compiled by Cadw in partnership with the Countryside Council for Wales and the International Council on Monuments and Sites (ICOMOS)



**Cae Iago Farm Tir Gofal Historic Environment Consultation**  
**Countryside Council for Wales Reference Number W/12/2445**  
**Cambria Archaeology Reference Number 41843**  
**National Grid Reference SN64764578**  
**Scale 1:5,000**

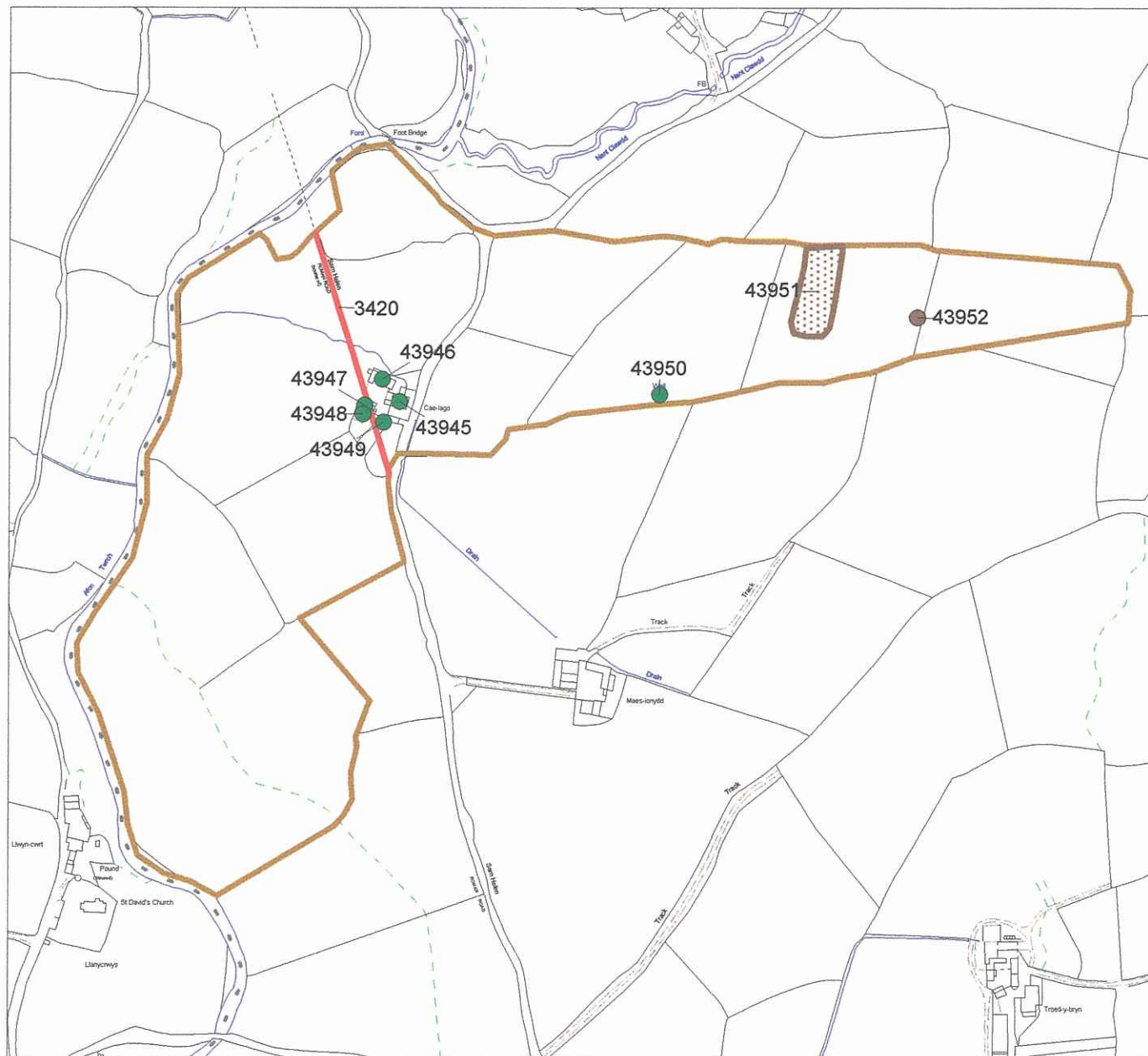

This map is reproduced from the OS map by the National Assembly for Wales with the permission of Ordnance Survey on behalf of the Controller of her Majesty's Stationery Office, © Crown copyright. All rights reserved. Unauthorised reproduction infringes Crown copyright and may lead to prosecution or civil proceedings. Licence number: GD272825G

## GAZETTEER OF SITES AND MONUMENTS

**PRN** 3420      **Site name** SARN HELEN (E);SARN ELEN      **NGR** SN73SE

**Site type** ROAD      **Period** Roman      **Site Status**

### *Description*

The Roman road which runs from Pumpsaint up the Twrch valley to Llanfair Clydogau is largely perpetuated by the modern minor road via Ffarmers. The line of the road crosses Cae Iago farm leaving the existing road to the south of the farmstead and crossing the Afon Twrch to the north west. The course of the road can only be seen on the ground in the garden adjoining the road, where it is indicated by a rise of about 0.5 metre (plate 2). On the land to the north west of the farm there is no visible trace of the road which has probably been ploughed flat in antiquity (plate 3).

### *Recommendations*

Although there are no upstanding remains of the Roman road visible in the farm land to the north west of the farmstead, there is a likelihood of buried archaeological remains surviving. Therefore no ground breaking works should be undertaken in this area.

**Management Category** A      **Visited by** AMP      **Visited On** 08/01/02

---

**PRN** 43946      **Site name** CAE IAGO      **NGR** SN64744573

**Site type** COW SHED      **Period** Post Med      **Site Status**

### *Description*

The cow shed to the north west of the farmhouse is orientated north west - south east. It is constructed of roughly coursed rubble walls and stone quoins and has been finished with whitewash. The south west facing elevation has four doorways; the centre left doorway is a semi-blocked cart entrance with a low brick arch (plate 4). The rest are low doorways with stone voussoirs (the east doorway is also blocked). The east gable end has a large square window, shuttered with plank boards, and at the west gable end is a narrow ventilation slit. In the north east facing wall are three blocked ventilation slits, and two small square openings at the east end of the elevation.

Internal offsets in the gable end walls and cut off beams and sockets in the lateral walls suggest that the roof height has been raised. The roof currently has 6 bays. It is constructed with collared trusses with two pairs of trencled purlins and fixed with iron pins. The roof is covered with corrugated iron. The floor is concrete and there are no historic fittings. To the west is a part stone, part breeze block lean-to with a single pitch corrugated iron roof.

### *Recommendations*

This cow shed is in good condition and should be maintained in its existing stable state.

**Management Category** C      **Visited by** AMP      **Visited On** 08/01/02

---

**PRN** 43947      **Site name** CAE IAGO

**NGR** SN64734571

**Site type** COW SHED

**Period** Post Med

**Site Status**

**Description**

The cow shed to the south west of the farmhouse is orientated north west - south east. It is constructed of roughly coursed rubble walls with stone quoins, and finished with whitewash (plate 5). The north east facing elevation has three doorways, including a full height cart entrance (partly blocked) and an additional small rectangular opening to the west. The south west facing elevation includes an inserted doorway to the east, a central blocked window and a double doorway to the west. The east gable end has a large window. A breeze block outshoot has been constructed along the north east facing wall.

An offset on the interior of the south west facing wall may indicate that the roof height has been raised in this building as seen in the cow shed (PRN 43946). Internally this cow shed has a concrete floor and concrete stall partitions with a feed passage along the south west wall. The roof has 6 bays with trusses of the same construction to those found in the cow shed (PRN 43946) with a square sectioned corrugated iron roof.

**Recommendations**

At the west end the cow shed is very overgrown with ivy and has considerable cracks in the north east facing wall. The vegetation should be cut, and allowed to die back before being carefully removed. The masonry should then be consolidated.

**Management Category** C

**Visited by** AMP

**Visited On** 08/01/02

**PRN** 43948      **Site name** CAE IAGO

**NGR** SN64734570

**Site type** BARN

**Period** Modern

**Site Status**

**Description**

To the south of the cow shed (PRN 43947) is a round topped dutch barn. This is constructed with iron H-sectioned supports and a corrugated iron roof. The sides are open on all but the west, gable end (plate 6).

**Recommendations**

The barn is in good condition and should be maintained in its current state.

**Management Category** C

**Visited by** AMP

**Visited On** 08/01/02

**PRN** 43949      **Site name** CAE IAGO

**NGR** SN64744569

**Site type** PREFABRICATED HOUSE

**Period** Modern

**Site Status**

**Description**

To the south of the farmhouse, orientated on a north east - south west is an asbestos building. This is an Arcon prefabricated house, the first type of prefab built on a commercial scale between 1944 -45. It has square sectioned corrugated asbestos walls and roof (plate 7).

**Recommendations**

The condition of this asbestos prefabricated house is beginning to deteriorate. If possible it would be desirable to repair and maintain this building in a stable condition.

**Management Category** C

**Visited by** AMP

**Visited On** 08/01/02

**PRN** 43950      **Site name** CAE IAGO      **NGR** SN64964572

**Site type** WELL      **Period** Modern?      **Site Status**

**Description**

The well is a rectangular structure built of brick and concrete lined, ca. 1.2m x 1m. It is currently infilled with stone. It is first identified on the 2nd edition ordnance survey map of 1906.

**Recommendations**

This well should be retained as a visible feature.

**Management Category** C      **Visited by** AMP      **Visited On** 08/01/02

---

**PRN** 43951      **Site name** CAE IAGO      **NGR** SN65094581

**Site type** EARTHWORK      **Period** Unknown      **Site Status**

**Description**

Towards the eastern extent of the holding is a large artificial mound or bank which extends in a north east to south west direction (plate 8). From the north hedge boundary the earthwork extends c. 45m across the field and is c. 10m wide. The bank is c. 1m high and follows the contour except where it is broken towards the centre. This may be the remains of a water management feature associated with the culvert identified to the east (PRN 43952).

**Recommendations**

This earthwork is currently under pasture and is in a stable condition under this management regime. This feature should continue to be maintained in this state.

**Management Category** D      **Visited by** AMP      **Visited On** 08/01/02

---

**PRN** 43952      **Site name** CAE IAGO      **NGR** SN65164578

**Site type** DRAIN      **Period** Unknown      **Site Status**

**Description**

To the east of the bank (PRN 43951) and to the west of the field boundary is a stone lined culvert. The culvert is draining the eastern most field of the farm holding and its route can be traced down the field to the break in the bank.

**Recommendations**

No specific management recommendations.

**Management Category** D      **Visited by** AMP      **Visited On** 08/01/02

---

## REFERENCES

### Map

- Ordnance Survey, 1819, Original Surveyors Drawings, -  
Ordnance Survey, 1834, Old Series, -  
Tithe Map, 1841, Cynwyl Gaeo Parish Tithe Map and Apportionment, -  
Ordnance Survey, 1888, 1st edition 1:2500 Carms VIII.4, -  
Ordnance Survey, 1905, 2nd edition 1:2500 Carms VIII.8, -  
Ordnance Survey, 1906, 2nd edition 1:10560 Carms VIII.NE, -  
Ordnance Survey, 1917, 1st edition 1:10560 Carms VIII.NE, -  
-, 1973, *Archaeologia Cambrensis*, Vol.122 p.9

### Aerial Photograph

- Meridian Airmaps, 1955, -, 260-230 20107 29721-4 260-240 20062-70

### Written Description

- Lewis S, 1833, *Topographical Dictionary of Wales*, Llandingat  
Gardner Wilkinson I, 1871, *Collectanea Archaeologica*, Vol.II Pt.2 p.232  
Nicholas T, 1872, *County Families of Wales*, Vol.1 p.198  
Rees W, 1873, *Archaeologia Cambrensis*, 4th Series Vol.4 p.131  
-, 1907, *Transactions of the Carmarthenshire Antiquarian Society*, Vol.3 p.73 76 78-9  
RCAHM, 1917, *Carmarthenshire Inventory of Monuments*, No.117 p.34 No.614 p.209  
O'Dwyer S, 1933, *Transactions of the Carmarthenshire Antiquarian Society*, Vol.58 p.46  
-, 1934, *Archaeologia Cambrensis*, Vol.89 p.195  
Jones JF, 1936, *Transactions of the Carmarthenshire Antiquarian Society*, Vol.36 p.46  
Nash-Williams VE, 1950, *Bulletin of the Board of Celtic Studies*, Vol.14 Pt.I p.79-80 Fig.3  
Margary ID, 1967, *Roman Roads in Britain*, Revised Edition p.335 Route No.62(c)  
Jones GDB, 1971, *Carmarthen Antiquary*, Vol.7 p.15



## Plates



Plate 1 – a stone constructed bank with grown out hedge, to the east of the holding.



Plate 2 – the line of the Roman road *Sarn Helen* (PRN 3420) looking towards Ffarmers





Plate 3 – the route of the Roman road *Sarn Helen* (PRN 3420) crosses this field and through the farmstead of Cae Iago



Plate 4 – the south west facing elevation of the cow shed (PRN 43946)





Plate 5 – the north east facing elevation of the cow shed (PRN 43947)



Plate 6 – the dutch barn (PRN 43948) to the south of the farmyard





Plate 7 – the Arcon asbestos prefabricated building (PRN 43949)



Plate 8 – the earthwork feature (PRN 43951) to the east of the farm holding

**CAE IAGO  
TIR GOFAL FARM VISIT REPORT**

**REPORT NUMBER 2002/5**

**January 2002**

This report has been prepared by Alice Pyper

Position: Tir Gofal Archaeologist

Signature.....*Alice Pyper*.....

Date.....*25/01/02*.....

This report has been checked and approved by Louise Austin on behalf of Cambria Archaeology,  
Dyfed Archaeological Trust Ltd.

Position: Principal Archaeological Officer (Curatorial)

Signature.....*Louise Aust*.....

Date.....*25/01/02*.....

As part of our desire to provide a quality service we would welcome any comments you may have  
on the content or presentation of this report.