

MAY 2001

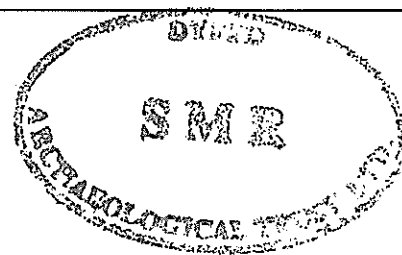

Archaeoleg Cambria Archaeology

Tir Gofal Farm Visit Report

Tre Gynan Isaf

W/11/1856

ACA Report Number 2001/26

ACA Project Record No 41541

**Report prepared for CCW
by ACA**

May, 2001

**Archaeoleg Cambria Archaeology
Shire Hall,
8, Carmarthen Street,
Llandeilo,
Carmarthenshire
SA19 6AF
Tel: (01558) 823121/823131
Fax: (01558) 823133
Email: cambria@acadat.com**

Tir Gofal Application Number W/11/1856

Address Tre Gynan Isaf **NGR** SN54247101
Llanrhystyd, Aberystwyth (Neuadd Farm,
Llanarth, Ceredigion, SA470RL)

TG Project Officer Arfon Williams, Aberystwyth

Archaeoleg Cambria Archaeology Project Record Number 41541

Visit Officer Anwen Cooper **Visit Date** 21/02/01

TIR GOFAL FARM VISIT REPORT

This report is intended to provide a statement on the condition and recommended management of all known archaeological and historical sites and features on this farm at the time it was visited by Cambria Archaeology. This information will be used to inform the Tir Gofal Management Agreement for the farm. The report structure is as follows:

- explanation of archaeological site status and management categories used in the gazetteer.
- a brief statement on the historical background to the farm which enables the reader to put the specific sites into context.
- the main body of the report is a gazetteer of sites previously known or identified during the visit. The gazetteer identifies sites by their Primary Record Number (PRN) which is the reference number used in the Sites and Monuments Record (SMR). It also locates them by National Grid Reference (NGR).
- list of sources consulted during the research for this project.
- explanation of colour coding used on the report map(s).
- site location maps identifying by PRN the location of each site in the gazetteer.
- photographs of specific sites are included where the author considers it useful in order to identify a site or stress a particular management issue.

ARCHAEOLOGICAL SITE STATUS

The following terms which are used in gazetteer refer to site status categories.

SAM Scheduled Ancient Monument.

SAMs are notified under section 1 of the Planning (Listed Buildings and Conservation Areas) Act 1990. The register of SAMs is maintained and administered by Cadw.

LB I, LB II* & LB II Listed Building categories.

Listed buildings are notified under section 1 of the Planning (Listed Buildings and Conservation Areas) Act 1990. The list is maintained and administered by Cadw. Local Authorities are statutory consultees for listed buildings.

HLW Landscapes of Historic Interest in Wales.

Defined by the *Register of Landscapes, Parks and Gardens of Special Historic Interest in Wales*, Landscapes of Historic Interest in Wales: Part 2.1 Landscapes of Outstanding Historic Interest; Part 2.2 Landscape of Special Historic Interest. The register is advisory only and has no statutory powers. The register was compiled by Cadw in partnership with the Countryside Council for Wales and the International Council on Monuments and Sites (ICOMOS).

HGP Register of Historic Gardens & Parks.

Defined by the *Register of Landscapes, Parks and Gardens of Special Historic Interest in Wales*, Part 1 Parks & Gardens. The register is advisory only and has no statutory powers. The register was compiled by Cadw in partnership with the Countryside Council for Wales and the International Council on Monuments and Sites (ICOMOS).

TIR GOFAL SITE MANAGEMENT CATEGORY

As used in accompanying gazetteer.

- | | |
|-------------------|--|
| Category A | Sites and Monuments of National Importance |
| Category B | Sites and Monuments of Regional Importance |
| Category C | Sites/Features of Local Importance |
| Category D | Sites/Features needing further investigation (including damaged sites or sites with no physical definition). |

Description of Tregynanisaf Farm, PRN 42342

Tregynanisaf Farm includes some 82ha of pastureland on undulating coastline about 2km to the northeast of Llanrhystyd in Ceredigion. The archaeology within the holding dates mainly to the late eighteenth and early nineteenth centuries when the farm and basic field system were first established. It is distinguished by its early system of enclosed fields (PRN 42367) and trackways, high density of wells (PRN 42360-5,42371) and fine farm buildings (PRN 42343-55) much of the timber from which has been retrieved from local shipwrecks.

The history of the farm is fairly well documented. It was first recorded on an estate map of 1806 when the holding was owned by Jones Junior and consisted of a farmyard with two parallel ranges of buildings, a house and garden at Troedyrhiw and a system of irregular enclosed fields. Unusually the basic layout of the farm has changed very little since this time. By the time of the tithe survey in 1839 several new farm buildings had been constructed in an irregular arrangement around a central farmyard. The fields along the clifftop to the west of the farm had been enclosed by the time of the 1st edition OS map in 1890 and the layout of the current farmyard was established.

Management Recommendations

The archaeology on the farm has been sensitively managed. The owner has an active interest in the retention, restoration and re-use of the historic features. See individual site recommendation for more details.

PRN 31433 **Site name** TREGYNAN-ISAF **NGR** SN54057112

Site type DESERTED SETTLEMENT **Period** Unknown **Site Status**

Description

Site of possible deserted settlement recorded in an archaeological survey of Cardigan Bay in 1997. The site sits high on the clifftop to the west of Tregynan Isaf Farm and consists of an area of disturbed ground made up of terraced platforms and excavated hollows (plate 1). None of these appears to be structural and it seems more likely that the earthworks relate to some sort of quarrying or mineral extraction. Much of the uneven ground surface in this area may also relate to the natural geology.

Recommendations

The earthworks are completely grassed over and in a stable condition. The ground in this area should not be disturbed. Further documentary and field investigation may clarify the nature and extent of the site.

Management Category D **Visited by** AJC **Visited On** 21/02/01

PRN 31434 **Site name** TREGYNAN-ISAF **NGR** SN54247132

Site type QUARRY **Period** Unknown **Site Status**

Description

Area of quarrying, first recorded in an archaeological survey of Cardigan Bay in 1997. It is not recorded on any historic maps. The quarrying consists of several segmented quarried trenches c.1.5m wide by 1m deep that circuit the clifftop and run for some distance along a field boundary to the south. The area is extremely overgrown, but there may be other evidence small-scale quarrying along the cliff edge to the north and west. A late nineteenth century trackway (PRN 42358) runs from Tregynan Isaf Farm to this area and may relate to the quarrying.

Recommendations

The quarried trenches are overgrown but in a stable condition. They should be kept clear of rubbish and the vegetation in this area should be controlled. Further survey and documentary research may clarify the extent and nature of the quarrying.

Management Category D **Visited by** AJC **Visited On** 21/02/01

PRN 31435 **Site name** TREGYNAN-ISAF **NGR** SN54287134

Site type UNKNOWN **Period** Unknown **Site Status**

Description

Site of a small, rock-cut hollow (c.2.5m across by 1m deep) on a clifftop ridge to the west of Tregynanisaf Farm. First identified during an archaeological survey of Cardigan Bay in 1997 when it was identified as a possible quarry or a World War II foxhole. The owner does not know of any wartime activity in this area and since the hollow lies close to a wider area of quarrying (PRN 31434) it is probably associated with this. The area is now extremely overgrown and this particular hollow was not distinguishable at the time of the farm visit.

Recommendations

The ground in this area should not be disturbed. All rock-cut features should be kept clear of rubbish and the vegetation in this area should be controlled. Further survey work may identify the extent and nature of quarrying.

Management Category D **Visited by** AJC **Visited On** 21/02/01

Tir Gofal Scheme	Tir Gofal Application No W/11/1856
Gazetteer of Archaeological Sites and Management Recommendations: Tregynanisaf, Ceredigion	

PRN 31436 **Site name** TREGYNAN-ISAF **NGR** SN54397143

Site type SHEEP WALK **Period** Post Med **Site Status**

Description

Rubble-built sheep-crawl situated in a blocked-in gateway to the west of Tregynanisaf Farm. Drystone construction with a stone lintel. The origin of this particular sheep-crawl is uncertain although it clearly postdates the nineteenth century field boundary into which it has been built. However the construction of sheep-crawls seems to be characteristic of the nineteenth century field boundaries elsewhere on the farm (PRN 42367) and since most of these have either collapsed or been destroyed the survival of this more recent example is still of historic interest.

Recommendations

The sheep-crawl is in good condition. It should be retained and maintained in a stable condition.

Management Category D **Visited by** AJC **Visited On** 21/02/01

PRN 31437 **Site name** TREGYNAN-ISAF **NGR** SN54347146

Site type QUARRY **Period** Post Med **Site Status**

Description

Semi-circular quarried platform (c.15m by 5m) situated on the end of a seaward-facing ridge to the west of Tregynanisaf Farm. It was identified during an archaeological survey of Cardigan Bay in 1997 and is not recorded on any historic maps. It is skirted by a field boundary on its eastern side and lies on the route of the coastal path. It probably forms part of a wider area of quarrying along the clifftop (PRN's 31434,31435).

Recommendations

The quarry is grassed over and in a stable condition. It should be kept clear of rubbish and maintained in its current condition.

Management Category D **Visited by** AJC **Visited On** 21/02/01

PRN 31441 **Site name** TREGYNAN-ISAF **NGR** SN54407095

Site type UNKNOWN **Period** Unknown **Site Status**

Description

Site of unidentified cropmark within a field to the south of Tregynanisaf Farm. It was recorded as part of an archaeological survey of Cardigan Bay in 1997. There is no evidence of earthworks in this area, although it is possible that buried remains survive.

Recommendations

The nature of this site has not been established, it is understood that the owner does not plan to plough the field and there is no immediate threat to the survival of the site.

Management Category D **Visited by** AJC **Visited On** 21/02/01

PRN 42342 **Site name** TREGYNAN-ISAF **NGR** SN54627124

Site type FARMSTEAD **Period** Post Med **Site Status**

Description

See description at the beginning of the report.

Recommendations

See individual site recommendations.

Management Category C **Visited by** AJC **Visited On** 21/02/01

Tir Gofal Scheme	Tir Gofal Application No W/11/1856
Gazetteer of Archaeological Sites and Management Recommendations: Tregynanisaf, Ceredigion	

PRN 42343 **Site name** TREGYNAN-ISAF **NGR** SN54627124

Site type FARMHOUSE **Period** Post Med **Site Status**

Description

Late eighteenth century/early nineteenth century farmhouse to the east of the farmyard at Tregynanisaf Farm. Orientation east west. It includes a main house and a smaller workers' cottage to the east. Two-storey rubble and lime mortar construction with a gabled slate roof. Asymmetrical elevation with a substantial stack at the western gable end and a smaller one at the eastern gable end of the main house. The exterior has been rendered to the south and most of the fittings are modern. The farm was first recorded on an estate map of 1806 but the date of the farmhouse itself is not clear from map evidence. However, it has certainly been built in several stages and includes a fine arched window in the eastern gable wall.

Recommendations

The house is now occupied by a tenant. No specific management recommendations.

Management Category C **Visited by** AJC **Visited On** 21/02/01

PRN 42344 **Site name** TREGYNAN-ISAF **NGR** SN54657122

Site type FARM BUILDING **Period** Post Med **Site Status**

Description

Range of two single-storey farm buildings to the east of the farmyard at Tregynanisaf Farm, orientation north-south. First recorded on the tithe survey of 1839. They are attached to the farmhouse (PRN 42343) at the northern end forming an L-shape in plan. The northernmost building was reputedly used for plucking turkeys. The southernmost building may have been a pigsty. Rubble and lime mortar construction with dressed stone quoins and gabled roofs. Both buildings have been reroofed with asbestos. The building to the north consists of two rooms with a small stack against the internal dividing wall. The openings are square-headed with stone or timber lintels and stone sills. The exterior was formerly whitewashed. The traditional timber fittings have been retained. The building to the south has been more extensively modified. The openings have been widened, the walls have been partly rebuilt with breeze blocks and the fittings are modern. The interiors were not examined.

Recommendations

The buildings are in good working condition and are now used for storage. They should be maintained in their current state. The original fittings and features should be retained. Any further repairs should be carried out using appropriate traditional materials in a way that is sympathetic to the character of the original building.

Management Category D **Visited by** AJC **Visited On** 21/02/01

PRN 42345 **Site name** TREGYNAN-ISAF **NGR** SN54617121

Site type STABLE **Period** Post Med **Site Status**

Description

Single storey rubble stable with dressed stone quoins and a gabled roof. It lies to the south of the farmyard at Tregynanisaf, orientation east-west. First recorded on the 1st edition OS map of 1890. It consists of two stables separated by an internal dividing wall and accessed by two centrally positioned doors in the north facing wall with symmetrically arranged windows on their outer sides. The openings are directly under the eaves. The fittings are modern and the interior has been concreted.

Recommendations

The stable block is in reasonable condition and is now used for storage purposes. The southern wall is completely overgrown with ivy and this should be removed. It should otherwise be maintained in its current condition.

Management Category D **Visited by** AJC **Visited On** 21/02/01

PRN 42346 *Site name* TREGYNAN-ISAF *NGR* SN54607123

Site type STABLE *Period* Post Med *Site Status*

Description

Two storey rubble and lime mortar stable block with dressed stone quoins and a gabled slate roof. It lies at the southern end of the range that makes up the western side of the farmyard at Tregynanisaf Farm, orientation north-south. First recorded on the 1st edition OS map of 1890. It appears to have been a later addition to the barn that lies immediately to its north. The openings vary but are generally square headed with stone or timber lintels and stone sills. The main entrance to the east is headed with stone voussoirs. The original fittings for these survive but are in poor condition. It is accessed at ground floor level by centrally positioned doorways in the eastern and western walls and a further single width doorway at the northern end of the eastern wall which has been blocked in. Access to first floor level is via a stone stairway and wooden balcony against the western wall through a half-height loft door (plate 2). It is lit at ground floor level by a single, square window to the south of the main east-facing entrance and at first floor level by opposing windows at the northern end of the eastern and western walls. The interior was fitted to house eight horses and many of the original features survive including the pitched stone floor, remains of the oaks stalls and hay manger, tack hooks, and storage recesses. The loft floor survives in poor condition.

Recommendations

The stable is in need of restoration. It is now used to house sheep. The roof has a pronounced sag and may need replacing. The southern wall is completely overgrown with ivy and this should be removed. The stonework along the western wall is unstable in places, especially around the openings and should be consolidated and rebuilt where required. The building should be maintained in a stable condition. The original features should be retained and any repairs or alteration should be carried out using appropriate traditional materials in a way that is sympathetic to the character of the original building.

Management Category C *Visited by* AJC *Visited On* 21/02/01

PRN 42347 *Site name* TREGYNAN-ISAF *NGR* SN54617124

Site type BARN *Period* Post Med *Site Status*

Description

Two-storey rubble and lime mortar barn with dressed stone quoins and a gabled slate roof. It lies to the north of the stable block (PRN 42346) on the western side of the farmyard at Tregynanisaf farm, orientation north-south. It was first recorded on the tithe survey of 1839. The openings vary but are generally square headed with stone or timber lintels and stone sills. The original fittings survive but are in poor condition. The main entrances to the east and west are headed with stone voussoirs. It is accessed via two single-width doorways in the eastern and western gable walls, a later narrow opening in the western wall and a half-height doorway from the hillside above in the northern gable wall. Ventilation is provided by two symmetrically positioned loops in the western wall and a single loop in the eastern wall. The openings for the belts to the threshing machine survive in the eastern wall which adjoins an engine house (PRN 42348). The interior is open to roof height and was formerly whitewashed and rendered. Many of the original fittings survive including the flagged floor and parts of the threshing machine.

Recommendations

The barn is in reasonable working condition and is now used for storing animals. The walls should be repointed and maintained in a stable state. The roof has a distinct sag and may need replacing. The original fittings should be retained. Any repairs and alterations should be carried out using appropriate traditional materials in a way that is sympathetic to the character of the original building.

Management Category C *Visited by* AJC *Visited On* 21/02/01

Tir Gofal Scheme	Tir Gofal Application No W/11/1856
Gazetteer of Archaeological Sites and Management Recommendations: Tregynanisaf, Ceredigion	

PRN 42348 **Site name** TREGYNAN-ISAF **NGR** SN54627124

Site type ENGINE HOUSE **Period** Post Med **Site Status**

Description

Single storey, L-shaped rubble engine house with dressed stone quoins and a sloping roof. It lies to the east of the barn (PRN 42347) on the western side of the farmyard at Tregynanisaf Farm. The building has been partly demolished and its original form is hard to determine. The walls stand to full height in places but the roof has been completely removed. It was accessed by a single doorway in the southern wall and lit by a shuttered opening in the eastern wall with a timber lintel and stone sill. The original wooden fitting for this survives. The interior is filled with farm debris and rubble. A drystone wall has been built around the derelict walls to separate them from the farmyard. A recent single storey rubble log shed has been built against the northern wall.

Recommendations

The engine house is in poor condition and no longer functions as a working building. The exposed walls are unstable and the quoins have fallen loose in places. The owner would like to consolidate the walls and clear the rubbish from the building. This would considerably enhance its appearance and would arrest its decay. Ideally it should be reroofed so that it can function as a working building.

Management Category C **Visited by** AJC **Visited On** 21/02/01

PRN 42349 **Site name** TREGYNAN-ISAF **NGR** SN54617125

Site type CART SHED **Period** Post Med **Site Status**

Description

Detached single storey rubble and lime mortar cart shed with dressed stone quoins and a gabled slate roof. It lies at the northern end of the western side of the farmyard at Tregynanisaf Farm, orientation north-south. It is accessed by two, double width cart entrances headed with huge timber lintels. The roof appears to have been raised but there is no evidence of a loft floor. A rubble wall originally extended eastwards beyond the building from the northern gable wall but this has collapsed. Several original features survive including a triangular arrangement of nesting boxes with stone surrounds in the southern gable wall and various storage recesses within the building.

Recommendations

The cartshed is in good working condition and is used for storage purposes. It should be maintained in its current state. Any alterations and repairs should be carried out using appropriate traditional materials in a way that is sympathetic to the character of the original structure.

Management Category C **Visited by** AJC **Visited On** 21/02/01

Tir Gofal Scheme	Tir Gofal Application No W/11/1856
Gazetteer of Archaeological Sites and Management Recommendations: Tregynanisaf, Ceredigion	

PRN 42350 **Site name** TREGYNAN-ISAF **NGR** SN54637125

Site type COW HOUSE **Period** Post Med **Site Status**

Description

One and a half storey rubble and lime mortar cow house with dressed stone quoins and a gabled slate roof. It lies to the north of the farmyard at Tregynanisaf Farm, orientation east-west. It was first recorded on the 1st edition OS map of 1890. The openings are symmetrically arranged and uniformly headed with stone voussoirs. It is accessed by three single-width openings in the southern wall with dressed stone surrounds. A more recent brick shed stands against the southern wall and probably housed a bulk tank. It is lit by a centrally positioned window in the northern wall. None of the original fittings survive. The interior was cleared out in the 1990's and converted for use as a brewery.

Recommendations

The cow house is in very good condition and was recently converted for use as a brewery. It now lies empty but its walls and roof are in good repair. It should be maintained in its current state. Any repairs or alterations should be made using appropriate traditional materials in a way that is sympathetic to the character of the original building.

Management Category C **Visited by** AJC **Visited On** 21/02/01

PRN 42351 **Site name** TREGYNAN-ISAF **NGR** SN54647125

Site type ANIMAL PEN **Period** Post Med **Site Status**

Description

Single storey rubble animal pen with dressed stone quoins and a gabled slate roof. It lies to the east of the cow house on the northern side of the farmyard at Tregynanisaf Farm, orientation east-west. It was first recorded on the 1st edition OS map of 1890. The openings have been modified and are headed by a full-length timber wall plate. It is accessed by two double width doorways in the southern wall. The fittings are modern. The interior was not examined.

Recommendations

The animal pen is in good condition and is now used for storage purposes. It should be maintained in its current state. Any alterations and repairs should be carried out using appropriate traditional materials in a way that is sympathetic to the character of the original building.

Management Category D **Visited by** AJC **Visited On** 21/02/01

PRN 42352 **Site name** TREGYNAN-ISAF **NGR** SN54657124

Site type FARM BUILDING **Period** Post Med **Site Status**

Description

Ruined rubble farm building to the north of the farmhouse on the eastern side of the farmyard at Tregynanisaf Farm, orientation east-west?. The building is partially dug into the ground and was formerly used for storing potatoes. The roof has completely collapsed but the walls apparently survive. The area around it is completely overgrown and the building was inaccessible at the time of the visit.

Recommendations

The potato storage shed was completely inaccessible and its condition is difficult to assess. If possible this area should be cleared and the ruin should be stabilised and maintained.

Management Category C **Visited by** AJC **Visited On** 21/02/01

Tir Gofal Scheme	Tir Gofal Application No W/11/1856
Gazetteer of Archaeological Sites and Management Recommendations: Tregynanisaf, Ceredigion	

PRN 42353 **Site name** TREGYNAN-ISAF **NGR** SN54637122
Site type CART SHED **Period** Post Med **Site Status**

Description

Two-storey rubble and lime mortar cart shed with dressed stone quoins and a gabled slate roof. It lies in the southeastern corner of the farmyard at Tregynanisaf farm, orientation north-south. It was first recorded on the 1st edition OS map of 1890. It is accessed at ground floor level by a double-width arched cart entrance in the eastern wall (plate 3). Access to first floor level is via stone steps against the northern gable wall. It is lit by a single square window to the south of the entrance at ground floor level and small, centrally positioned windows in the southern, eastern and western walls at first floor level. The entrances are headed with stone voussoirs, the windows are square headed with stone lintels and sills. The original fittings for these survive but are in poor condition. The interior was not examined but the loft floor is apparently in good condition.

Recommendations

The cart shed is in reasonable working condition. The owner would like to restore it as part of his Tir Gofal Agreement. This would considerably enhance the survival and continued use of the building. The walls are in reasonable repair but should be repointed. The stonework on the steps is loose and overgrown. They should be cleared of intrusive vegetation and consolidated. The window fittings have decayed and should be replaced. The southern gable wall is completely overgrown with ivy and this should be cleared. The roof is in poor condition (particularly at the southern end) and probably needs replacing. These repairs should be carried out using appropriate traditional materials in a way that is sympathetic to the character of the original building.

Management Category C **Visited by** AJC **Visited On** 21/02/01

PRN 42354 **Site name** TREGYNAN-ISAF **NGR** SN54637122
Site type ANIMAL PEN **Period** Post Med **Site Status**

Description

Rubble goose shed with a sloping slate roof attached to the eastern wall of the cart shed at the southern end of Tregynanisaf Farm. The entrance at the eastern end has been modified.

Recommendations

The goose shed is in good condition and the owner would like to retain it when he carries out restoration work on the adjacent cart shed. It should be maintained in its current state.

Management Category C **Visited by** AJC **Visited On** 21/02/01

PRN 42355 **Site name** TREGYNAN-ISAF **NGR** SN54637122
Site type PRIVY **Period** Post Med **Site Status**

Description

Single seater privy, against the northern wall of the cart shed (PRN 42353) on the southern side of the farmyard at Tregynanisaf Farm. It appears to have been added to the cart shed and is probably of late nineteenth century date. Single storey rubble and lime mortar structure with dressed stone quoins and a sloping slate roof. The interior was not accessible but the walls appear to have been whitewashed and the original stone floor and wooden fittings survive. It is accessed via a doorway in the northern wall.

Recommendations

The privy is in poor condition but the owner would like to retain and renovate it when he restores the cart shed to the south as part of his Tir Gofal Agreement. The roof has collapsed and needs replacing. The walls need repointing.

Management Category C **Visited by** AJC **Visited On** 21/02/01

Tir Gofal Scheme	Tir Gofal Application No W/11/1856
Gazetteer of Archaeological Sites and Management Recommendations: Tregynanisaf, Ceredigion	

PRN 42356 **Site name** TREGYNAN-ISAF **NGR** SN54537098
Site type TRACKWAY **Period** Post Med **Site Status**

Description

Narrow farm track (c.3m wide) leading southwestwards from the farmyard at Tregynanisaf Farm (plate 4). It is defined to either side by hedged stone and earth banks (c.1.2m high) with laid stone faces and has been cut into the bedrock in places. It was first recorded on an estate map of 1806 at which time it provided access to open ground at Bryn Meirch.

Recommendations

The trackway is overgrown and very wet in places. Some of the stonework on the banks is loose and the hedges have not been maintained. The banks have also been eroded by grazing animals. The track is no longer used as a route of access but the owner would like to reinstate it as part of his Tir Gofal Agreement. He would like to fence the field boundary to the south of it and clear the itself trackway of intrusive vegetation. This would considerably enhance the condition and promote the use of this feature. The banks should also be maintained in a stable condition.

Management Category C **Visited by** AJC **Visited On** 21/02/01

PRN 42357 **Site name** TREGYNAN-ISAF **NGR** SN54117095
Site type TRACKWAY **Period** Post Med **Site Status**

Description

Terraced farm track (c.4m wide) running southwestwards from Tregynanisaf Farm towards Banc Farm. It is defined in places by a low stone and earth bank (c.0.6m high) with laid stone faces. It was first recorded on the 1st edition OS map of 1890. It runs across a large area of marshy ground and may originally have been built to provide access the double well (PRN 42360) at the centre of the farm.

Recommendations

The trackway is in good condition and is still used as a route of access. It should be maintained in its current state.

Management Category D **Visited by** AJC **Visited On** 21/02/01

PRN 42358 **Site name** TREGYNAN-ISAF **NGR** SN54477120
Site type TRACKWAY **Period** Post Med **Site Status**

Description

Terraced farm track (c.3m wide) leading southwestwards from the northern end of the farmyard at Tregynanisaf Farm. It is not recorded on any historic maps but is probably of nineteenth century date.

Recommendations

The trackway is still in use but is overgrown. It should be kept clear of rubble and intrusive vegetation.

Management Category D **Visited by** AJC **Visited On** 21/02/01

Tir Gofal Scheme	Tir Gofal Application No W/11/1856
Gazetteer of Archaeological Sites and Management Recommendations: Tregynanisaf, Ceredigion	

PRN 42359 **Site name** TREGYNAN-ISAF **NGR** SN54317123
Site type TRACKWAY **Period** Post Med **Site Status**

Description

Terraced farm track (c.4m wide) with a roughly gravelled surface leading westwards from Tregynanisaf Farm towards the clifftop. The section immediately to the west of the farmyard is defined by rubble walling on both its terraced and open sides. It was first recorded on the 1st edition OS map of 1890. It leads to an area of quarrying along the cliff top and may have been built to facilitate the transport of material from these quarries.

Recommendations

The trackway is in good condition and is still in use. It should be maintained in its current state.

Management Category D **Visited by** AJC **Visited On** 21/02/01

PRN 42360 **Site name** TREGYNAN-ISAF **NGR** SN54157098
Site type WELL **Period** Post Med **Site Status**

Description

Site of double well, first recorded on an estate map of 1806 when it was described as Ffynnon Bryn Meirch. The site of the wells is now marked by an area of wet ground (c.5m by 3m) in the corner of a field alongside a trackway (PRN 42357) at the centre of the holding. An opening through the adjacent field-wall to the north, leads to a fine rectangular stone trough (c.5m by 4m) that runs parallel to the field boundary (plate 5).

Recommendations

The spring or 'well' is now silted up. The owner would like to fence off this area to make it safer for animals. He would also like to reinstate the trough as a working feature which would enhance its future use and maintenance. The silted up 'well' and trough should be cleared out and restored under archaeological supervision. The area should be kept clear of intrusive vegetation.

Management Category C **Visited by** AJC **Visited On** 21/02/01

PRN 42361 **Site name** TREGYNAN-ISAF **NGR** SN54667138
Site type WELL **Period** Post Med **Site Status**

Description

Stone-lined circular well (c.0.8m in diameter) on the hilltop to the north of Treynanisaf Farm. It was initially sunk to supply water to the farmhouse and still holds water. The owner has concreted the area around it and covered the well shaft with a large slab to prevent damage to livestock.

Recommendations

The well is in very good condition and should be maintained in its current state.

Management Category C **Visited by** AJC **Visited On** 21/02/01

Tir Gofal Scheme	Tir Gofal Application No W/11/1856
Gazetteer of Archaeological Sites and Management Recommendations: Tregynanisaf, Ceredigion	

PRN 42362 **Site name** TREGYNAN-ISAF **NGR** SN54657120

Site type WELL **Period** Post Med **Site Status**

Description

Circular stone-lined well (c.0.8m in diameter) with a rectangular stone surround (c.1.5m by 3m) to the southeast of the farmyard at Tregynanisaf Farm, orientation north-south. The well shaft is positioned at the northern end (plate 6) and covered by a large stone slab. It is accessed from a built-in recess to the south of the well shaft via an opening from the west through the stone surround. The sides of the access recess are faced with rubble.

Recommendations

The well is in good condition but is overgrown and the owner would like to restore it. The adjacent hedge has grown over it and may be affecting the stonework. Any intrusive vegetation should be removed. The stonework is in reasonable condition but should be consolidated and maintained in a stable condition.

Management Category C **Visited by** AJC **Visited On** 21/02/01

PRN 42363 **Site name** TREGYNAN-ISAF **NGR** SN54627126

Site type WELL **Period** Post Med **Site Status**

Description

Circular stone-lined well, built into the terraced south-facing hillside in the northwestern corner of Tregynanisaf Farm. It is accessed by a square headed opening with a stone lintel cut into the stone faced terraced slope. The owner has made a temporary cover to prevent livestock from entering it.

Recommendations

The well is in good condition. It should be retained and maintained in its current state.

Management Category C **Visited by** AJC **Visited On** 21/02/01

PRN 42364 **Site name** TREGYNAN-ISAF **NGR** SN54647123

Site type WELL **Period** Post Med **Site Status**

Description

Circular stone-lined well (c. 0.8m in diameter) to the south of the farmhouse at Tregynanisaf Farm (plate 7). The area around it has been concreted and the top of the well shaft is now protected by a metal drain cover. It is still used to supply water to the yard.

Recommendations

The well is in very good condition. It should be retained and maintained in its current condition.

Management Category C **Visited by** AJC **Visited On** 21/02/01

PRN 42365 **Site name** TREGYNAN-ISAF **NGR** SN54577106

Site type WELL **Period** Post Med **Site Status**

Description

Site of well, situated alongside a trackway (PRN 42356) to the south of Tregynanisaf farm. First recorded on the 1st edition OS map of 1890. This area was extremely wet at the time of the visit but there was no evidence here of a formal well. It lies along the route of a stone culvert (PRN 42366) and may have been a point of access to the water along this rather than a built structure.

Recommendations

No specific management recommendations.

Management Category C **Visited by** AJC **Visited On** 21/02/01

Tir Gofal Scheme	Tir Gofal Application No W/11/1856
Gazetteer of Archaeological Sites and Management Recommendations: Tregynanisaf, Ceredigion	

PRN 42366 **Site name** TREGYNAN-ISAF **NGR** SN54657100

Site type DRAIN **Period** Post Med **Site Status**

Description

Stone line culvert running eastwards from a large area of wet ground at the centre of the holding of Tregynanisaf Farm. It runs along the line of a former open drainage channel that was recorded on an estate map of 1806. The culvert was probably inserted during the mid nineteenth century. It runs underground for much of its length, but surfaces alongside a trackway to the south of the farmyard (PRN 42356) where it is defined to the south by a rubble wall and resurfaces again just to the north of Treodyrhiw house (PRN 42370).

Recommendations

The owner has repaired the underground section in places but would like to retain the original stone culvert. The culvert should be retained and maintained in a stable condition. Any loose stone work should be consolidated.

Management Category C **Visited by** AJC **Visited On** 21/02/01

PRN 42367 **Site name** TREGYNAN-ISAF **NGR** SN54047104

Site type FIELD SYSTEM **Period** Post Med **Site Status**

Description

System of enclosed fields at Tregynanisaf Farm, the earliest of which were first recorded on an estate map of 1806. The fields to the west of the farm are defined by hedged stone and earth banks (c. 0.6m high) with laid stone faces and were first recorded on an estate map of 1806. Those to the east of the farm alongside the coast were established in the late nineteenth century and are defined by more substantial stone and earth banks, again with laid stone faces. These later boundaries contain sheep-crawls, many of which have collapsed. The best surviving example (PRN 31436) is of uncertain date. The rubble walls that define the eastern boundary of the farm along the clifftop contain substantial oak posts which at one time held a fence to prevent the escape of sheep.

Recommendations

The field boundaries are generally in reasonable condition. They should be maintained in a stable condition and any loose stonework should be consolidated. Any original features such as sheep-crawls should be retained. The owner plans to fence along some of these boundaries to provide a more effective barrier to livestock. This should also protect the walls from erosion.

Management Category C **Visited by** AJC **Visited On** 21/02/01

PRN 42368 **Site name** TREGYNAN-ISAF **NGR** SN54057107

Site type CAIRN **Period** Post Med **Site Status**

Description

Site of cairn, first recorded on the 1st edition OS map of 1890. No evidence of the cairn remains but it seems likely that it marked a prominent high point along the coast which was named on an estate map of 1806 as Pen y Foel.

Recommendations

The ground in this area should not be disturbed to protect any associated buried remains.

Management Category C **Visited by** AJC **Visited On** 21/02/01

Tir Gofal Scheme	Tir Gofal Application No W/11/1856
Gazetteer of Archaeological Sites and Management Recommendations: Tregynanisaf, Ceredigion	

PRN 42369 **Site name** TREGYNAN-ISAF **NGR** SN54567126

Site type QUARRY **Period** Post Med **Site Status**

Description

Small quarry c.25m by 4m by 5m high alongside a trackway (PRN 42359) to the west of the farmyard at Tregynanisaf Farm. It was first recorded on the 1st edition OS map of 1890 and was probably excavated to extract stone for buildings in the farmyard.

Recommendations

The quarry is slightly overgrown but the face appear to be stable. It has been used for dumping rubbish and rubble. It should be cleared of rubbish and otherwise maintained in its current state.

Management Category C **Visited by** AJC **Visited On** 21/02/01

PRN 42370 **Site name** TROEDYRHIW HOUSE **NGR** SN54727094

Site type DESERTED SETTLEMENT **Period** Post Med **Site Status**

Description

Ruined house and garden of Troedyrhiw, first recorded on an estate map of 1806. The ruin lies alongside a busy layby on the A478 on the eastern edge of Tregynanisaf Farm. It consists of a single storey two-roomed rubble dwelling (orientation east-west) set to the north of a triangular enclosure. It was accessed via a gateway from the road to the east. The cottage walls stand to full height at the gable ends although the side walls are lower. The easternmost room was accessed by a single doorway in the southern wall, which is square headed with a timber lintel. There was no internal access between the rooms and the entrance to the westernmost room no longer survives. The westernmost room was lit by a square, timber lintelled window in the southern wall. Several of the original internal features survive including the stack at the western gable end, the remains of the bread oven and storage alcoves (plate 8). The garden enclosure is extremely overgrown but is defined by low (c.0.5m high) stone and earth banks with laid stone faces.

Recommendations

The ruined house and garden are both extremely overgrown and the standing walls of the house are unstable. Any intrusive vegetation should be removed and loose stonework should be consolidated. The interior of the house and the area around the enclosure is also littered with rubbish, much of which has probably been left from visitors to the adjacent layby. The site is clearly of interest to visitors to the layby and the unstable state of the ruin may be problematic. The site should be considered for more extensive clearance and consolidation. An interpretation board could be erected in the adjacent layby to inform visitors and warn them about the unstable condition of the ruin.

Management Category C **Visited by** AJC **Visited On** 21/02/01

PRN 42371 **Site name** TROEDYRHIW HOUSE **NGR** SN54727096

Site type WELL **Period** Post Med **Site Status**

Description

Site of well, situated just to the north of Troedyrhiw house on the eastern edge of Tregynanisaf Farm. It was first recorded on the 1st edition OS map of 1890 and probably supplied water to Troedyrhiw House. There was no evidence of a formal structure on the ground although the site is marked by a very wet area of ground. It lies at the end of a nineteenth century culvert (PRN 42366) and it is possible that the map evidence recorded a source of access to water from this culvert rather than a built structure.

Recommendations

The ground in this area should not be disturbed to protect any subsurface remains.

Management Category C **Visited by** AJC **Visited On** 21/02/01

Map

Clement Davies J, 1806, Estate Map of Tregynan Isaf, Ucha

Tithe Map, 1839, Tithe Map and Apportionment, Llanrhystyd Parish

Ordnance Survey, 1890, 1st edition Cardiganshire sheet XIV NE, 1:10560

Ordnance Survey, 1906, 2nd edition Cardiganshire sheet XIV NE, 1:10560

Written Description

TIR GOFAL COLOUR CODING

As used on accompanying report maps.

Category A	Blue	Scheduled Ancient Monuments Grade 1 and 2* Listed Building
	Red	Other Sites and Monuments of National Importance Other Buildings of National Importance
	Red toning Red Banding	Registered Parks and Gardens of Historic Interest Registered Landscapes of Historic Interest
Category B	Amber	Sites and Monuments of Regional Importance Grade 2 Listed and Other Buildings of Regional Importance
Category C	Green	Sites / Features of Local Importance Buildings of Local Importance
Category D	Brown	Sites / Features of Unknown Importance

Tir Gofal Farm Visit
Tre Gynan Isaf Farm
ACA Report No.2001/26
Map 1
SN57SW

Reproduced from Ordnance Survey map
with the kind permission of the Controller of
Her Majesty's Stationary Office.
Crown Copyright reserved.
Countryside Council for Wales
Licence No.GD272825G

Scale 1:10000

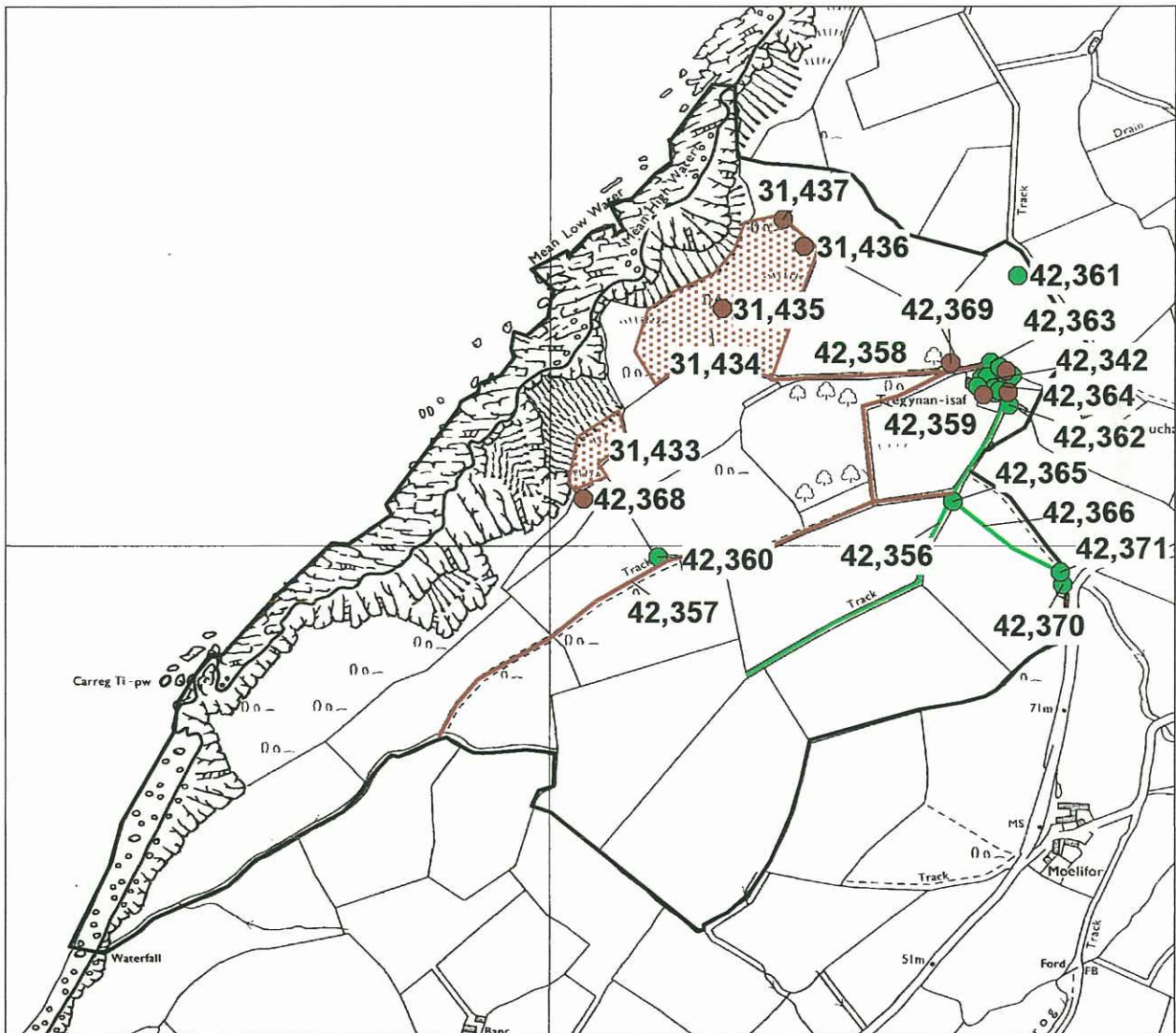

Tir Gofal Farm Visit
Tre Gynan Isaf Farm
ACA Report No.2001/26
Map 2
SN57SW

Reproduced from Ordnance Survey map
with the kind permission of the Controller of
Her Majesty's Stationary Office.
Crown Copyright reserved.
Countryside Council for Wales
Licence No.GD272825G

Scale 1:500

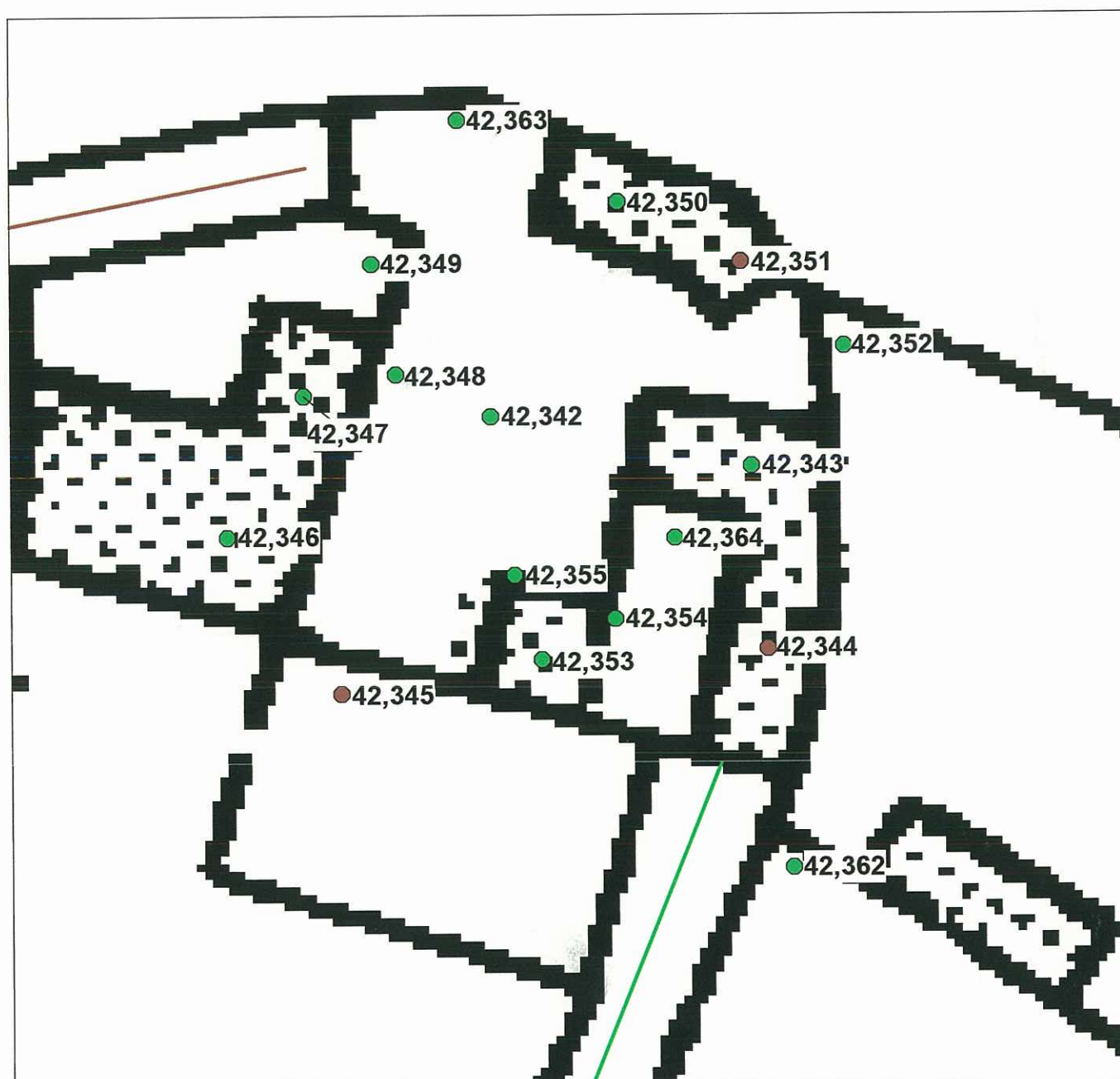

Plates



Plate 1 - possible settlement site/quarrying (PRN31433) along the cliffs.



Plate 2 - unstable wall and stairway to the rear (west) of the stable (PRN42346).



Plate 3 - cart shed (PRN42353) showing poor roof repair and overgrown southern wall



Plate 4 - eighteenth century trackway (PRN 42356) showing unstable banks and overgrown interior.



Plate 5 - eighteenth century well (PRN42360) showing silted up trough alongside field boundary.



Plate 6 - overgrown well (PRN42362) to the southeast of the farmyard.



Plate 7 - rubble lined well (PRN42364) to the south of the farmhouse, showing the typical form of the many wells on the farm.

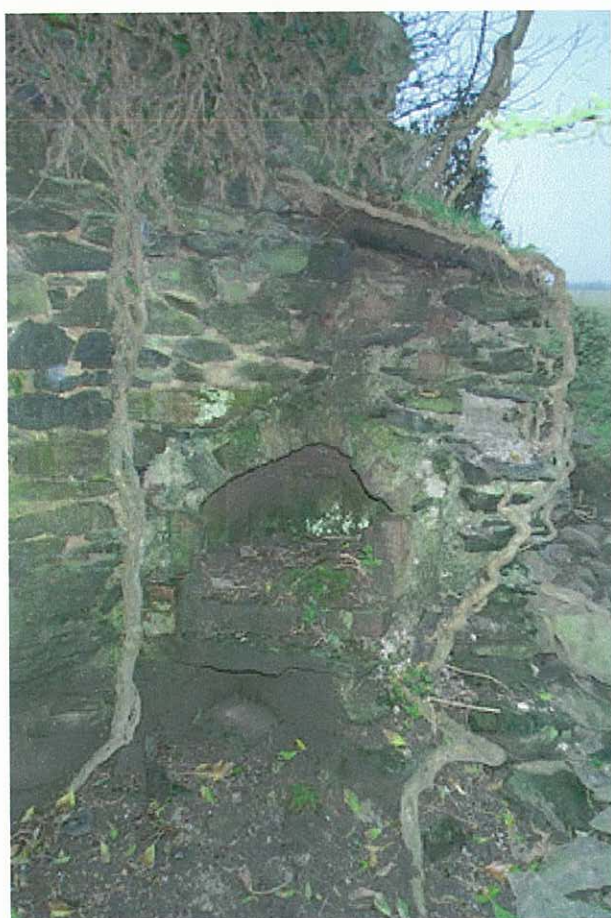

Plate 8 - remains of the bread oven in Treodyrhiw house (PRN42370).

**TRE GYNAN ISAF
TIR GOFAL FARM VISIT REPORT**

**REPORT NUMBER 2001/26
PROJECT RECORD NUMBER 41541
MAY 2001**

This report has been prepared by Anwen Cooper

Position: Project Officer

Signature  Date 14/05/01

This report has been checked and approved by Louise Austin on behalf of Cambria Archaeology,
Dyfed Archaeological Trust Ltd.

Position: Principal Archaeological Officer (Curatorial)

Signature Louise Austin Date 15/05/01

As part of our desire to provide a quality service we would welcome any comments you may have
on the content or presentation of this report