

01/01/2001



Archaeoleg Cambria Archaeology

Tir Gofal Farm Visit Report

Lecha

W/13/1100

ACA Report Number 2001/1

ACA Project Record 39463

Report prepared for CCW
by ACA

January, 2001

Archaeoleg Cambria Archaeology
Shire Hall,
8, Carmarthen Street,
Llandeilo,
Carmarthenshire
SA19 6AF
Tel: (01558) 823121/823131
Fax: (01558) 823133
Email: cambria@acadat.com



A R C H A E O L E G

CAMBRIA

A R C H A E O L O G Y

Tir Gofal Application Number W/13/1100

Address

Lecha

NGR

SM811271

Solva, Haverfordwest

TG Project Officer Kevin Taylor, Llandeilo

Archaeoleg Cambria Archaeology Project Record Number 39463

Visit Officer

Anwen Cooper

Visit Date

27/09/00

TIR GOFAL FARM VISIT REPORT

This report is intended to provide a statement on the condition and recommended management of all known archaeological and historical sites and features on this farm at the time it was visited by Cambria Archaeology. This information will be used to inform the Tir Gofal Management Agreement for the farm.

The report structure is as follows:

- explanation of archaeological site status and management categories used in the gazetteer.
- a brief statement on the historical background to the farm which enables the reader to put the specific sites into context.
- the main body of the report is a gazetteer of sites previously known or identified during the visit. The gazetteer identifies sites by their Primary Record Number (PRN) which is the reference number used in the Sites and Monuments Record (SMR). It also locates them by National Grid Reference (NGR).
- list of sources consulted during the research for this project.
- explanation of colour coding used on the map.
- site location maps identifying by PRN the location of each site in the gazetteer.
- photographs of specific sites are included where the author considers it useful in order to identify a site or stress a particular management issue.

ARCHAEOLOGICAL SITE STATUS

SAM.

Scheduled Ancient Monument. SAMs are notified under section 1 of the Planning (Listed Buildings and Conservation Areas) Act 1990. The register of SAMs is maintained and administered by Cadw.

LB1, LB2* & LB2.

Listed Building categories. Listed buildings are notified under section 1 of the Planning (Listed Buildings and Conservation Areas) Act 1990. The list is maintained and administered by Cadw.

HL - Landscapes of Exceptional and Great Historic Interest.

Defined by the Register of Landscapes, Parks and Gardens of Special Historic Interest in Wales: Part 2.1 Landscapes of Exceptional and Great Historic Interest. The register is advisory only and has no statutory powers. The register is being compiled by Cadw in partnership with the International Council on Monuments and Sites (ICOMOS) and is concerned with historic elements of the landscape.

HGP - Register of Historic Gardens & Parks.

Defined by the Register of Landscapes, Parks and Gardens of Special Historic Interest in Wales: Part 1 - Parks & Gardens. The register is advisory only and has no statutory powers. The register is being compiled by Cadw in partnership with the International Council on Monuments and Sites (ICOMOS) and is concerned with historic elements of the landscape.

TIR GOFAL SITE MANAGEMENT CATEGORY

Category A - Sites and Monuments of National Importance

Category B - Sites and Monuments of Regional Importance

Category C - Sites/Features of Local Importance

Category D - Sites/Features needing further investigation (including damaged sites or sites with no defined physical presence).

Description of Lecha Farm, PRN 20980

Lecha Farm covers 139ha of pasture, arable and woodland on St David's Peninsula in Pembrokeshire. The holding is made up of two separate farmsteads; one at Lecha, the other about 10km to the north at Llanvirm.

The farm at Lecha lies on south facing slopes to the north of a bend in the Afon Solfach, about 3km to the NE of the village of Solva. The earliest evidence for the occupation of this land dates to the Neolithic period, when the abundant stone (after which the farm is named) was used to construct a monumental tomb. A stone circle was later built just to the north of the tomb, marking the continued significance of this landscape in the later Neolithic and Bronze Age. It is likely that other evidence of prehistoric activity in the area survives below ground. There is no evidence to represent the occupation of Lecha during later prehistory or the medieval period, but its more recent history is well documented. In 1562 Lecha was recorded as part of the estate of Parry of Trecadwgan. From 1625 to 1670 it was occupied by John Jones (grandson of John of Brawdy). By the late seventeenth century, ownership had passed to the Barlows of Slebech. They leased the property in 1941 to the family of Thomas Barzey of Arnolds Hill, who are known to have kept a pack of hounds. During the course of the nineteenth century, ownership passed first to (Sir) William Hamilton, then to Robert Fluke Greville of Castle Hall near Milford and finally to Stephen Thomas. The son of Stephen Thomas, Dr Thomas Nash Thomas was a highly respected doctor known locally as 'O Lecha' and practised in a surgery just to the east of the farmhouse at Lecha. The last occupant of the farm was Mr Elfed Martin of Loch Meyler who died in 1986, having sold the farm to the current owner in the 1970's.

The layout of the farm was first recorded on the Tithe Survey of 1845. At this time, the farm buildings consisted of a substantial detached farmhouse, an adjacent cowhouse and a further building (probably a cartshed) some distance to the south of these. The holding also included two outlying cottages at Pwll Tawr (Bull's Pool) and Clyndu, the later of which has since been sold. By the time of the 1st Edition OS map in 1891, the farm buildings had been extended considerably to enclose the farmyard on three sides, establishing the basic layout for the current farmstead. The farmhouse and surgery were set back from these buildings to the east.

The field boundaries within the holding are defined by substantial stone banks many of which have at one time been hedged. The basic layout of these had already been established at the time of the tithe survey in 1845. At this time, the land on the eastern side of the current holding was described as 'Glebe' and belonged to the church. Some of these earlier fields had been subdivided by the time of the 1st Edition OS map in 1891 (especially in the northern part of the farm) but their essential layout was retained.

Management Recommendations

The farm has undergone considerable alteration in recent years. Its buildings have largely fallen into disuse and the farmhouse itself is a ruin. Whilst most of the holding is still farmed much of it has been landscaped to form lakes and areas of woodland, with a view to creating a leisure park.

Description of Llanvirm Farm, PRN 41439

Llanvirm Farm lies on a clifftop plateau overlooking Aber-Eiddy Bay. Unfortunately, there is no historical documentation of the development of the farm. It was first recorded on tithe surveys in 1842, when the land that lies in St Davids parish was owned by Henry Perkins and that within Llanvirm parish was divided between several farmsteads. By this time, the layout of the current farm buildings at Llanvirm had already been established, consisting of two parallel rows of detached buildings to either side of a farm track. The holding also included a cottage at Nant which has since been sold. Like the farm buildings, the layout of the fields around the farm has remained unaltered since the early nineteenth century. The area around Aber-Eiddy has a long history of quarrying and evidence for this can be found on the land at Llanvirm. Several quarry pits line the western edge of the holding, including an early nineteenth century quarry that was the type-site for the geological series known as 'Llanvirm Slate'.

Management recommendations

The farm holdings are in a derelict state. However all have planning permission for renovation or conversion for domestic purposes. The farmhouse is currently being renovated in a manner which is sensitive to the character of the original building. The field boundaries are in a reasonable condition and should be retained and maintained in their current state. The quarries should be left clear of rubbish and left undisturbed. The owner plans to reforest part of the farm and this is of no particular threat to any archaeological features.

PRN 2745	Site name LECHA	NGR SM811272
Site type STONE CIRCLE?	Period Neolithic; Bronze Age	Site Status

Description

A stone circle in marshy ground to the north of Lecha chambered tomb was recorded on a visit to the farm by Cambrian Archaeological Society in 1922. No evidence remains of it. A large pond has recently been dug where it formerly stood and has probably obliterated any trace of it. The pond is surrounded by large slabs of stone, some of which may have originated from the stone circle. Modern standing stones have also been erected around the pond.

Recommendations

The stones in this area should be left undisturbed and not used for any building work associated with the planned leisure park.

Management Category D	Visited by AJC	Visited On 27/09/00
------------------------------	-----------------------	----------------------------

PRN 2747	Site name LECHA FARM	NGR SM81152710
Site type CHAMBERED TOMB	Period Neolithic	Site Status SAM No 28

Description

Neolithic chambered tomb, situated in a small, wooded gully beside a stream. The most visible element of the monument is a huge capstone which measures 5.3m long and 1.3m thick. This sits on two small side boulders and is abutted by another which may formerly have been a side stone. The size of the chamber is difficult to gauge and stands only 0.1m above the current ground surface. It lies beneath a prominent outcrop of rock from which the capstone probably originates (plate 1).

Recommendations

The site is protected from damage as a Scheduled Ancient Monument. The scheduling also extends to the area around the tomb and this should be cleared of gorse. The field in which it stands should remain under pasture and any periodic ploughing should avoid the area around the monument.

Management Category A	Visited by AJC	Visited On 27/09/00
------------------------------	-----------------------	----------------------------

PRN 2748	Site name LECHA FARM	NGR SM81152710
Site type CHAMBERED TOMB?	Period Neolithic	Site Status SAM No 28

Description

A prominent outcrop of rock, situated on the edge of a small stream, just to the west of Lecha chambered tomb (PRN 2747). The outcrop is of a similar material to that of the capstone of the tomb and was probably the source of stone for it (plate 2).

Recommendations

The outcrop is overgrown with ivy in places and according to the owner, a large slab has recently fallen from its western side. The break is now grassed over and the outcrop appears to be in a stable condition. *the ivy should be cut but not removed + the outcrop*
~~It should be cleared of ivy and treated as an important associate of the tomb itself. It should be considered for inclusion in the scheduled area.~~ *Already within scheduled area*

Management Category B	Visited by AJC	Visited On 27/09/00
------------------------------	-----------------------	----------------------------

<i>PRN</i>	20980	<i>Site name</i>	LECHA FARM	<i>NGR</i>	SM81332723
<i>Site type</i>	FARMSTEAD	<i>Period</i>	Post Med	<i>Site Status</i>	

Description

See farm description.

Recommendations

See individual site descriptions.

<i>Management Category</i>	<i>Visited by</i> AJC	<i>Visited On</i> 27/09/00
----------------------------	-----------------------	----------------------------

<i>PRN</i>	41409	<i>Site name</i>	LECHA FARM	<i>NGR</i>	SM81192725
<i>Site type</i>	WELL	<i>Period</i>	Post Med	<i>Site Status</i>	

Description

Stone lined well c. 2m in diameter. Stands to a height of 0.5m. Probably supplied water for the occupants of Lecha farmhouse. Damaged on its southern side. Date of construction uncertain although it is marked as a spring on the 1st edition OS map of 1891.

Recommendations

The well should be retained as an original feature of the farm. What remains of the upstanding stone surround should be consolidated to prevent further deterioration.

<i>Management Category</i>	<i>Visited by</i> AJC	<i>Visited On</i> 27/09/00
----------------------------	-----------------------	----------------------------

<i>PRN</i>	41420	<i>Site name</i>	LECHA FARM	<i>NGR</i>	SM81382744
<i>Site type</i>	FIELD SYSTEM	<i>Period</i>	Post Med	<i>Site Status</i>	

Description

The fields around Lecha farm are defined by substantial stone-built banks, many of which appear to have been formerly hedged. Most of the current boundaries were established by the early nineteenth century and were recorded on the tithe survey of 1845.

Recommendations

The boundaries are generally in a stable condition although they have not been actively maintained. Few of the hedges survive and there are fallen stones at the base of many of the banks. Any fallen stone should be cleared and used to repair the banks. Any loose stonework should be consolidated. The farmer would like to reinstate the hedges along some of the boundaries and should do so using species that are in-keeping with the character of the original boundaries. All of the boundaries should be retained as integral features of the farm.

<i>Management Category</i>	<i>Visited by</i> AJC	<i>Visited On</i> 27/09/00
----------------------------	-----------------------	----------------------------

PRN 41421	Site name PWLL TARW	NGR SM80952729
Site type COTTAGE	Period Post Med	Site Status

Description

The remains of a two-roomed cottage c.10m by 8m lie within a small, triangular, stone-banked enclosure to the west of Lecha Farm. It is recorded on the tithe map of 1842 as Pwll Tarw (bull's pool). The building footings stand to a height of 1.8m along its northern edge although the southern and interior walls are somewhat lower. The interior is infilled with fallen rubble. Single storey, random rubble and soil construction. No roofing material survives. The enclosure that surrounds the cottage is defined by a stone and earth bank which has been considerably modified in recent years. The original elements stand to a height of 0.5m. However, the south western corner has been breached for access to the field to the north and the southern wall has been built up in recent years using cleared stone from around the fields.

Recommendations

The upstanding remains of the building and its enclosure should be consolidated and cleared of intrusive vegetation. Any loose stone from the building and enclosure walls should be left in-situ.

Management Category C	Visited by AJC	Visited On 27/09/00
------------------------------	-----------------------	----------------------------

PRN 41422	Site name LECHA FARM	NGR SM81282761
Site type MILLPOND	Period Post Med	Site Status

Description

A millpond and leat to the north of Lecha farmstead are first recorded on the 1st Edition OS map (1891) and ran downslope to the waterwheel (PRN 41434) in the farmyard. No surface evidence of these survives. The site of the pond has been dug out to form a lake and the leat lies within an arable field. The owner remembers some stonework and a sluice gate at the site of the millpond and says that the route of the leat is visible when the field is ploughed.

Recommendations

No specific management recommendations.

Management Category D	Visited by AJC	Visited On 27/09/00
------------------------------	-----------------------	----------------------------

PRN 41423	Site name LECHA FARM	NGR SM81232729
Site type TRACKWAY	Period Post Med	Site Status

Description

Stone banked trackway c.5m wide, with a single ditch along its western side. Runs from the farmyard to the fields immediately to the north and west. It was probably formerly hedged. First recorded on tithe survey of 1845.

Recommendations

The banks and ditch should be maintained in their current condition and kept clear of undergrowth.

Management Category D	Visited by AJC	Visited On 27/09/00
------------------------------	-----------------------	----------------------------

<i>PRN</i> 41424	<i>Site name</i> LECHA FARM	<i>NGR</i> SM81432762
<i>Site type</i> TRACKWAY	<i>Period</i> Post Med	<i>Site Status</i>

Description

Remains of former trackway recorded on 1st Edition OS map of 1891. Defined by substantial stone banks to either side which stand to a height of 1m.

Recommendations

Most of the trackway has been removed for the construction of a lake. The remaining section is very overgrown. The remaining section of the trackway should be retained.

<i>Management Category</i> D	<i>Visited by</i> AJC	<i>Visited On</i> 27/09/00
------------------------------	-----------------------	----------------------------

<i>PRN</i> 41425	<i>Site name</i> LECHA FARM	<i>NGR</i> SM81502766
<i>Site type</i> POND	<i>Period</i> Post Med	<i>Site Status</i>

Description

Small pond with stone surround, to the north west of Lecha Farm. First recorded on the 1st edition OS map of 1891. The pond was not visited.

Recommendations

No specific management recommendations.

<i>Management Category</i> C	<i>Visited by</i> AJC	<i>Visited On</i> 27/09/00
------------------------------	-----------------------	----------------------------

<i>PRN</i> 41428	<i>Site name</i> LECHA FARM	<i>NGR</i> SM81342722
<i>Site type</i> FARMHOUSE	<i>Period</i> Post Med	<i>Site Status</i>

Description

Lecha Farmhouse was first recorded on the tithe survey of 1845. However, the farm is known to have been occupied since 1562 and it is possible that parts of the original building survive. The building has obviously been altered and extended on several occasions during its long period of occupation and use as a house and surgery. What remains of the it is of random rubble construction and formerly had a slate roof (although parts of this have been replaced with corrugated asbestos). It is now in a ruinous state and is structurally unsafe. The remains of the former surgery, outbuilding and rubbish pits survived until recently to the rear of the farmhouse but have since been flattened (plate 3).

Recommendations

The building is now completely derelict and unstable. The roof and walls are collapsing and the rooms are filled with rubble. The owner plans to demolish it and reuse the stone for building elsewhere if he is successful in his application to convert the farm into a leisure park. A detailed photographic record of the building should be made prior to and during any demolition work. The owner might consider installing a noticeboard here for visitors to the farm to inform them about its history of use and occupation.

<i>Management Category</i> C	<i>Visited by</i> AJC	<i>Visited On</i> 27/09/00
------------------------------	-----------------------	----------------------------

PRN 41429	Site name LECHA FARM	NGR SM81322722	
Site type BARN	Period Post Med	Site Status	

Description

Small, detached barn forming the eastern side of the farmyard at Lecha. First recorded on the 1st edition OS map of 1891. Orientation north-south. Two storey rubble construction with dressed stone quoins and a gabled slate roof. Accessed at ground floor level by opposing single width doorways to the east and west, headed with huge stone lintels. The entrance to the east has been blocked. The loft floor has been removed (although the joist holes remain) and was formerly accessed by a square headed, timber lintelled door in the southern gable wall. Ventilated by small, square headed, timber lintelled windows above the entrances and ventilation slits along the western side wall. Formerly whitewashed interior (plate 4).

Recommendations

The walls of the barn are in a reasonable condition. The roof is fairly recent and is in good condition. Any conversion or repairs should be carried out in a way which is sympathetic to the original function and construction of the building. Compatible materials should be used and where possible, the original openings and features should be retained.

Management Category C	Visited by AJC	Visited On 27/09/00
------------------------------	-----------------------	----------------------------

PRN 41430	Site name LECHA FARM	NGR SM81342718	
Site type WINNOWING MOUND	Period Post Med	Site Status	

Description

Large, c.5m by 10m by 1.4m high raised platform to the south of Lecha farmhouse and yard. Rubble construction with an internal recess accessed via a stone lintelled opening at the northern end. A sawing pit c.2.5m by 0.5m is built into its southern end and was reputedly used into the twentieth century. First recorded on the 1st edition OS map of 1891 (plate 5).

Recommendations

The stonework that surrounds the platform is loose and its upper surface is overgrown. The owner is willing to clear and consolidate the mound and should seek archaeological advice in doing so. The mound is a rare surviving example and should be considered for scheduling.

Management Category B	Visited by AJC	Visited On 27/09/00
------------------------------	-----------------------	----------------------------

PRN 41431	Site name LECHA FARM	NGR SM81312721	
Site type STABLES	Period Post Med	Site Status	

Description

Two storey rubble stable block with a gabled slate roof. Forms the southern side of Lecha farmyard, orientation east-west. It was not recorded on any historical maps and is presumably of twentieth century date. Ground floor openings have brick voussoirs, first floor openings are directly under the eaves. Accessed at ground floor level by two symmetrically arranged doors in the north-facing wall. Formerly whitewashed interior with concrete feeding troughs and floor. Accessed at first floor level through a single-width door in the eastern gable wall via a stone and concrete stairway that runs up the wall of the adjacent building to the east. The stairway contains a low, brick voussoired recess in its western side, which was presumably a kennel. The loft floor is in poor condition although the struts which support it are in good condition. Fenestrated at ground and first floor levels by symmetrically arranged windows along both side walls and a single window on the western gable wall.

Recommendations

The walls and roof of the stable are in good condition. The loft floor is in poor condition and needs replacing. Any conversion or repairs should be carried out in a way which is sympathetic to the original function and construction of the building. Compatible materials should be used and where possible, the original openings should be retained.

Management Category C	Visited by AJC	Visited On 27/09/00
------------------------------	-----------------------	----------------------------

PRN 41432	Site name LECHA FARM	NGR SM81322720
Site type FARM BUILDING	Period Post Med	Site Status

Description

Two-storey rubble farm building with dressed stone quoins and a gabled slate roof. First recorded on the 1st edition OS map of 1891. It stands at an awkward angle to the other farmyard buildings on the southern side of the farmyard at Lecha. Orientation NW-SE. Includes a triangular arrangement of nesting boxes with slate lintels in the southeastern gable wall. No other original features survive.

Recommendations

The owner has partly converted the building for use as a shower block. Since doing so his plans have changed and no further work has been carried out on the building. Any further conversion or repairs should be carried out in a way which is sympathetic to the original function and construction of the building. Compatible materials should be used and if possible, original openings and features should be retained.

Management Category C	Visited by AJC	Visited On 27/09/00
------------------------------	-----------------------	----------------------------

PRN 41433	Site name LECHA FARM	NGR SM81322724
Site type COWHOUSE	Period Post Med	Site Status

Description

Two storey rubble cowhouse with dressed stone quoins and a gabled slate roof (plate 6). One of the three original buildings at Lecha Farm, first recorded on the tithe survey of 1845. Accessed at ground floor level by two single-span doorways on its southern side and a single doorway on its northern side. Fenestration at ground floor level is provided along the southern wall only. All ground floor openings are headed by brick voussoirs which probably replace earlier stone or timber lintels. The loft is accessed through a single width, brick voussoired doorway, via a stone and slate-built stairway against the western gable wall. The other openings at first floor level are directly under the eaves and have square headed timber lintels and slate sills with the exception of the fine gothic-style arched window in the eastern gable wall. The latter was probably a later nineteenth century addition and may have been designed to decorate the view towards this otherwise functional building from the house. The loft floor has been removed, but the joists survive in good condition. The interior was formerly whitewashed. No original fittings survive.

Recommendations

The roof timbers and joist survive in good condition and have been treated for woodworm. The roof slates are in a reasonable condition although some need replacing. The walls are also in a reasonable condition but need pointing in places and some of the brick work above the openings has fallen loose. Any conversion or repairs should be carried out in a way which is sympathetic to the original function and construction of the building. Compatible materials should be used and if possible, the original openings should be retained.

Management Category C	Visited by AJC	Visited On 27/09/00
------------------------------	-----------------------	----------------------------

PRN 41434	Site name LECHA FARM	NGR SM81322745
Site type ENGINE HOUSE	Period Post Med	Site Status

Description

Two storey rubble engine house with a corrugated tin roof and concrete floor. First recorded on the 1st edition OS map of 1891. All of the openings are square headed with timber lintels and slate sills. Accessed at ground floor level by a low door in its western wall. Accessed at first floor level via a half-height opening in the northern gable wall. The main opening through to the waterwheel in the southern wall has been blocked in but a small ventilation slit above it and a small diagonally shaped cavity in the same wall survive. The loft level has been removed but the joist sockets survive. The interior was formerly whitewashed. No internal fittings survive. The associated wheel pit c.3m long by 1.5m wide lies between the engine house and the cowhouse (PRN 41433) to the south. It is rubble filled and overgrown and its western end has been blocked up. No trace remains of the water system that fed it.

Recommendations

The building is in a reasonable state of repair and needs no immediate consolidation. Any conversion should be carried out in a way which is sympathetic to the original function and construction of the building. Compatible materials should be used and if possible, the original openings should be retained.

Management Category C	Visited by AJC	Visited On 27/09/00
------------------------------	-----------------------	----------------------------

PRN 41435	Site name LECHA FARM	NGR SM81352715
Site type CART HOUSE	Period Post Med	Site Status

Description

Single storey rubble cart house situated about 100m to the south of the main cluster of farm buildings at Lecha. One of three original buildings at Lecha farm, first recorded on the tithe survey of 1845. No roof survives. The openings are crumbling and appear to have been widened. The eastern gable wall survives to gable height, the remaining walls are lower and unstable. The internal fittings are recent concrete and brick constructions (plate 7).

Recommendations

The cart house is essentially derelict and requires substantial repair work. The owner plans to renovate and reroof the building and would like to use it to store farm machinery. Archaeological advice should be sought before commencing this work.

Management Category C	Visited by AJC	Visited On 27/09/00
------------------------------	-----------------------	----------------------------

PRN 41436	Site name LECHA FARM	NGR SM81312728
Site type FIELD BARN	Period Post Med	Site Status

Description

Single storey rubble field barn with dressed stone quoins and a corrugated tin roof. First recorded on the 1st edition OS map of 1891. Orientation E-W. It lies detached from the main cluster of farm buildings, in a field some 50m to the north. Accessed originally by a single width, square headed, stone lintelled doorway in the western gable wall (now blocked). The current entrance spans the width of the eastern gable wall and has obviously been widened and repaired with breeze blocks. Whitewashed interior with breeze block trough along the southern wall. Small ventilation loops are positioned directly beneath the eaves along the northern and southern walls.

Recommendations

The stonework is unstable in places but otherwise the building is in a reasonable condition. The unstable stonework should be consolidated. Any conversion or repairs should be carried out in a way which is sympathetic to the original function and construction of the building. Compatible materials should be used and if possible, the original openings should be retained.

Management Category C	Visited by AJC	Visited On 27/09/00
------------------------------	-----------------------	----------------------------

PRN 41437	Site name LECHA FARM	NGR SM81392716
Site type FARM BUILDING	Period Post Med	Site Status

Description

Derelict single storey rubble farm building, situated about 150m to the south east of the farmyard at Lecha. First recorded on the 1st edition OS map of 1891. The former tin roof has collapsed. The eastern gable wall survives to full height, the other walls are considerably lower. Two small, stone lintelled windows in the southern wall and the remains of a similar window in the northern wall survive. Probably accessed through an opening in the western gable wall.

Recommendations

The building is in a derelict state and is no longer functional. The owner plans to demolish it and reuse the stone for building work elsewhere if he is successful with his application for planning permission to create a leisure park on the farm. A detailed photographic record of the building should be made prior to and during any demolition work.

Management Category C	Visited by AJC	Visited On 27/09/00
------------------------------	-----------------------	----------------------------

PRN 41438	Site name LLANVIRN FARM	NGR SM79763084
Site type QUARRY	Period Post Med	Site Status

Description

The latest and smallest of three former slate quarries cut into the north facing slopes of Llanvirk Farm and running down towards the major quarrying centre at Aber-Eiddy. It is now completely overgrown and inaccessible.

Recommendations

The site is completely overgrown and inaccessible. It should remain undisturbed.

Management Category D	Visited by AJC	Visited On 27/09/00
------------------------------	-----------------------	----------------------------

PRN 41439	Site name LLANVIRN FARM	NGR SM79983047
Site type FARMSTEAD	Period Post Med	Site Status

Description

Farmstead of Llanvirk, situated on an elevated plateau overlooking Aber Eiddy Bay. First recorded on the tithe survey of 1840. The farmyard is made up of two ranges of interfacing buildings on opposite sides of a central trackway, with the house (PRN 41442), carthouse (PRN 41440), cowhouse (PRN 41443) and barn (PRN 41444) to the south west, and the pigsty (PRN 41441), stables (PRN 41445) and an area of ruinous smaller buildings including stone-built kennels to the north east. Orientation northwest-southeast. All of the buildings have undergone considerable modification and are in need of reroofing and renovation. The farmhouse itself is currently undergoing restoration. The fields around the holding were laid out in their current form at the time of the tithe survey in 1840 and are generally defined by hedged stone and earth banks. See individual site descriptions for more details.

Recommendations

All of the standing buildings should be retained and any conversions should be carried out in a way which is sympathetic to the original character of the building. Compatible materials should be used and where possible, the original openings should be retained.

Management Category C	Visited by AJC	Visited On 27/09/00
------------------------------	-----------------------	----------------------------

PRN 41440	Site name LLANVIRN FARM	NGR SM79983047
Site type CARTSHED	Period Post Med	Site Status

Description

Small, detached single-storey cartshed at the north western end of the farm buildings at Llanvirk. Rubble construction with dressed stone quoins and a gabled slate roof. Accessed via an arched opening headed with stone voussoirs at its north-eastern end. First recorded on the tithe survey of 1840 (plate 8).

Recommendations

The cartshed is the most intact of the original farm buildings at Llanvirk and should be retained as an integral feature of the farm. Its conversion should be carried out in a way which is sympathetic to the original character of the building. Compatible materials should be used and if possible, the original openings should be retained.

Management Category C	Visited by AJC	Visited On 27/09/00
------------------------------	-----------------------	----------------------------

PRN 41441	Site name LLANVIRN FARM	NGR SM80003048
Site type PIGSTY	Period Post Med	Site Status

Description

One and a half-storey rubble L-shaped pigsty with a gabled slate roof. First recorded on the tithe survey of 1840. Forms the northwestern end of the north eastern range of farm buildings at Llanvirm. The south eastern section of it which adjoins the stable, appears to have been added at a later date. Accessed by three single-width doors along its southwestern wall and a single-width doorway in its northwestern gable wall. Fenestrated along the southern wall only. Dovecote on the western gable wall with a triangular arrangement of nesting boxes. All of the openings have been modified but are uniformly headed with brick voussoirs and surrounds.

Recommendations

Its conversion should be carried out in a way which is sympathetic to the original character of the building. Compatible materials should be used and if possible, the original openings should be retained.

Management Category C	Visited by AJC	Visited On 27/09/00
------------------------------	-----------------------	----------------------------

PRN 41442	Site name LLANVIRN FARM	NGR SM79963049
Site type FARMHOUSE AND COTTAGE	Period Post Med	Site Status

Description

Two storey rubble farmhouse and adjoining cottage at the northwestern end of the southwestern range of farm buildings at Llanvirm. The original farmhouse to the southeast, was first recorded on the tithe survey of 1840. The cottage which adjoins it to the west was built by the time of the 1st edition OS map in 1891. Both buildings have recently been reroofed with slate and renovated. The interior has undergone considerable modification.

Recommendations

No specific management recommendations.

Management Category C	Visited by AJC	Visited On 27/09/00
------------------------------	-----------------------	----------------------------

PRN 41443	Site name LLANVIRN FARM	NGR SM79983047
Site type COWHOUSE	Period Post Med	Site Status

Description

One and a half storey rubble cowhouse with a gabled slate roof occupying the central portion of the southwestern range of farm buildings at Llanvirm. Accessed by opposing single width doors positioned centrally in its northeastern and southwestern walls. The openings are headed with brick voussoirs and have slate sills. Whitewashed interior. No original internal fittings survive. First recorded on the 1st edition OS map of 1891.

Recommendations

Its conversion should be carried out in a way which is sympathetic to the original character of the building. Compatible materials should be used and if possible, the original openings should be retained.

Management Category C	Visited by AJC	Visited On 27/09/00
------------------------------	-----------------------	----------------------------

PRN 41444	Site name LLANVIRN FARM	NGR SM79993045
Site type BARN	Period Post Med	Site Status

Description

Fine, two-storey barn at the southeastern end of the south western range of farm buildings at Llanvirm. Coursed slate and rubble construction with dressed stone quoins and a gabled slate roof. Accessed via opposing entrances in the northern and southern walls. Entrances are headed with stone voussoirs. The small, square windows in the eastern gable and southern walls are square headed with slate lintels. The walls stand to roof height but are in an unstable condition. The roof has collapsed and is in need of urgent repair. First recorded in the tithe survey of 1840.

Recommendations

The barn is one of the original farm buildings at Llanvirm and should be prioritised in the owners plans to restore and convert the farm buildings. The conversion should be carried out in a way which is sympathetic to the original character of the building. Compatible materials should be used and if possible, the original openings should be retained.

Management Category C	Visited by AJC	Visited On 27/09/00
------------------------------	-----------------------	----------------------------

PRN 41445	Site name LLANVIRN FARM	NGR SM80013047
Site type STABLES	Period Post Med	Site Status

Description

Two storey stable block at the southeastern end of the north eastern range of farm buildings at Llanvirm. Rubble construction with brick quoins and a gabled slate roof. Accessed at ground floor level via a centrally positioned brick voussoired, single-width door in the southern wall. Accessed at first floor level via a stone and brick stairway attached to the eastern gable wall, through a single-width doorway with a brick voussoired head and surround. The openings have been modified. Ventilated by small square cavities in the southwestern wall. The roof and loft floor are in need of repair.

Recommendations

The conversion should be carried out in a way which is sympathetic to the original character of the building. Compatible materials should be used and if possible, the original openings should be retained.

Management Category C	Visited by AJC	Visited On 27/09/00
------------------------------	-----------------------	----------------------------

PRN 41426	Site name LLANVIRN FARM	NGR SM79843067
Site type QUARRY	Period Post Med	Site Status

Description

Slate quarry c. 30m by 20m by 10m deep cut into the north facing slopes of Llanvirm Farm. Recorded on the 1st Edition OS map as 'old quarry' although it was not recorded on the tithe map of 1842. It represents the southernmost of a series of three small quarries that run in a line towards the major nineteenth century quarrying centre at Aber-Eiddy.

Recommendations

The farmer has recently cleared the quarry of rubbish and the faces are in a stable condition. It should be maintained in its current condition.

Management Category D	Visited by AJC	Visited On 27/09/00
------------------------------	-----------------------	----------------------------

PRN 41427	Site name LLANVIRN FARM	NGR SM79783076
Site type QUARRY	Period Post Med	Site Status

Description

Large, irregularly shaped slate quarry c.50m by 20m by 5m cut into the north facing slopes of Llanvirn Farm. First recorded on the tithe survey of 1842 when it was described as 'old quarries'. It is the oldest of three small quarries which run in a line towards the major nineteenth century quarrying centre at Aber-Eiddy. Reputedly the original type-site for the geological series known as 'Llanvirn Slate'. The remnants of a stone and earth wall survive along its northern edge.

Recommendations

The farmer has cleared the quarry of rubbish and it is protected from significant damage and alteration as a SSSI. It should be maintained in its current condition.

Management Category D	Visited by AJC	Visited On 27/09/00
------------------------------	-----------------------	----------------------------

Aerial Photograph

Meridian Airmaps, 1955, -, 180-220 12458-9

Meridian Airmaps, 1955, -, 180-220 12457-8

Musson,C, 1991, -, AP91-36.1 Good clear view from the north

Musson,C, 1991, -, AP91-36.3 Good clear view from the north-west

Map

Tithe Map, 1840, Tithe Map and Apportionment, St. Davids Parish

Tithe Map, 1842, Tithe Map and Apportionment, Llanrian Parish

Tithe Map, 1845, Tithe Map and Apportionment, Llanhowell Parish

Ordnance Survey, 1891, Pembs. Sheet XV SW, 1:10560, 1st edition

Ordnance Survey, 1891, Pembs. Sheet XV NW, 1:10560, 1st edition

Ordnance Survey, 1908, Pembs. Sheet X SW, 1:10560, 2nd edition

Ordnance Survey, 1908, Pembs. Sheet XV NW, 1:10560, 2nd edition

Written Description

Laws & Owen, 1908, Pembrokeshire Archaeological Survey, 35-4

RCAHM, 1925, Pembrokeshire Inventory, No.500

Grimes,WF, 1936, -, Proceedings of thePrehistoric Society

Daniel, 1950, -, Prehistoric Chamber Tombs

TIR GOFAL SITE MANAGEMENT CATEGORY

As used in accompanying site gazetteer.

Category A - Sites and Monuments of National Importance

Category B - Sites and Monuments of Regional Importance

Category C - Sites/Features of Local Importance

Category D - Sites/Features needing further investigation (including damaged sites or sites with no defined physical presence).

TIR GOFAL COLOUR CODING

As used on accompanying holding maps.

Category A - Blue	<i>Scheduled Ancient Monuments Grade 1 and 2* Listed Building</i>
Red	<i>Other Sites and Monuments of National Importance Other Buildings of National Importance</i>
Red toning	<i>Registered Parks and Gardens of Historic Interest</i>
Red Banding	<i>Registered Landscapes of Historic Interest</i>
Category B - Amber	<i>Sites and Monuments of Regional Importance Grade 2 Listed and Other Buildings of Regional Importance</i>
Category C - Green	<i>Sites / Features of Local Importance Buildings of Local Importance</i>
Category D - Grey	<i>Sites / Features of Unknown Importance</i>

ARCHAEOLOGICAL SITE STATUS

Terms used in gazetteer.

SAM.

Scheduled Ancient Monument. SAMs are notified under section 1 of the Planning (Listed Buildings and Conservation Areas) Act 1990. The register of SAMs is maintained and administered by Cadw.

LB1, LB2* & LB2.

Listed Building categories. Listed buildings are notified under section 1 of the Planning (Listed Buildings and Conservation Areas) Act 1990. The list is maintained and administered by Cadw.

HL - Landscapes of Exceptional and Great Historic Interest.

Defined by the Register of Landscapes, Parks and Gardens of Special Historic Interest in Wales: Part 2.1 Landscapes of Exceptional and Great Historic Interest. The register is advisory only, and has no statutory powers. The register is being compiled by Cadw in partnership with the International Council on Monuments and Sites (ICOMOS) and is concerned with historic elements of the landscape.

HGP - Register of Historic Gardens & Parks.

Defined by the Register of Landscapes, Parks and Gardens of Special Historic Interest in Wales: Part 1 - Parks & Gardens. The register is advisory only, and has no statutory powers. The register is being compiled by Cadw in partnership with the International Council on Monuments and Sites (ICOMOS) and is concerned with man-made, historic elements of the landscape.

Scale 1:10000

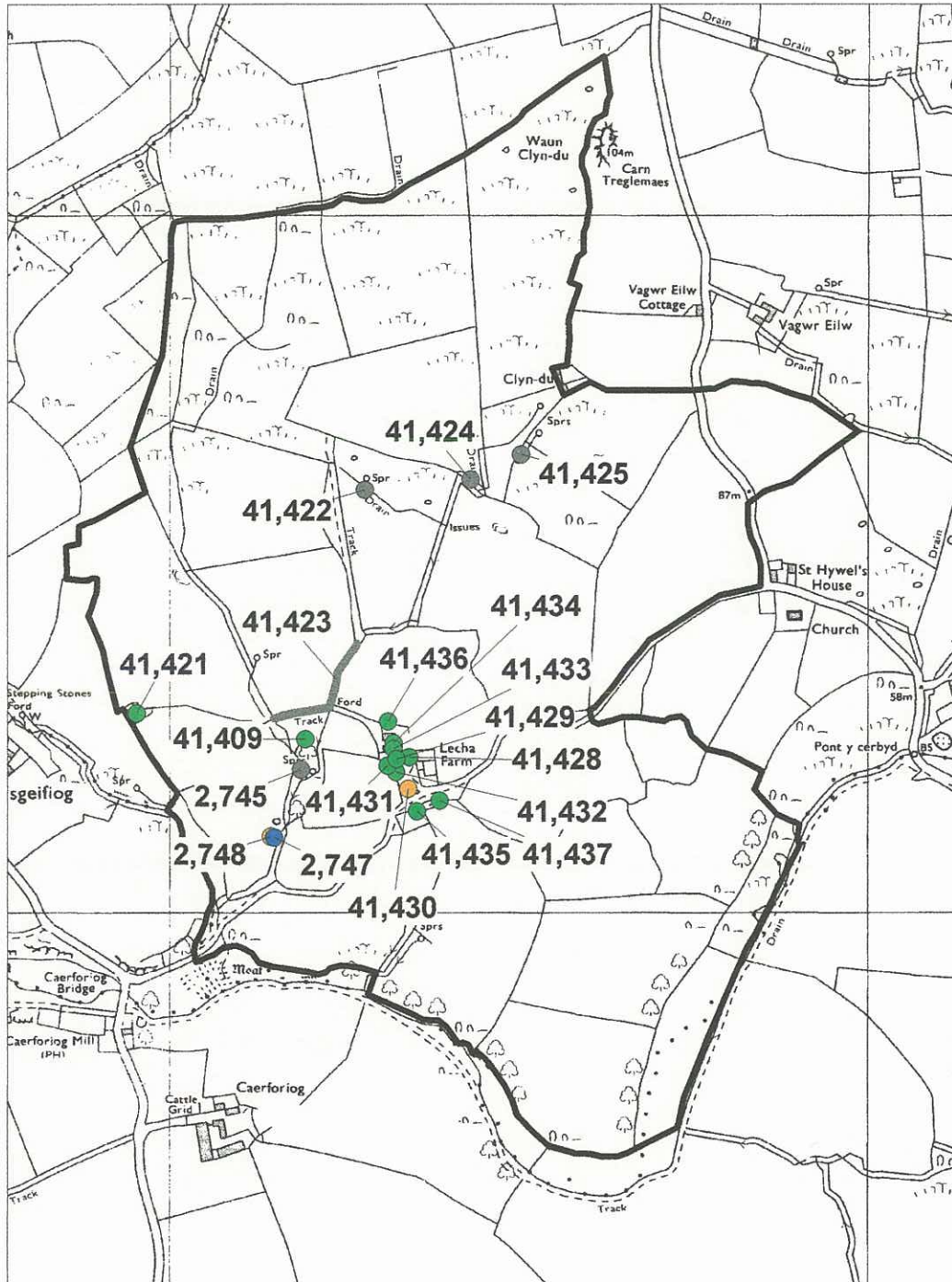

Scale 1:10000

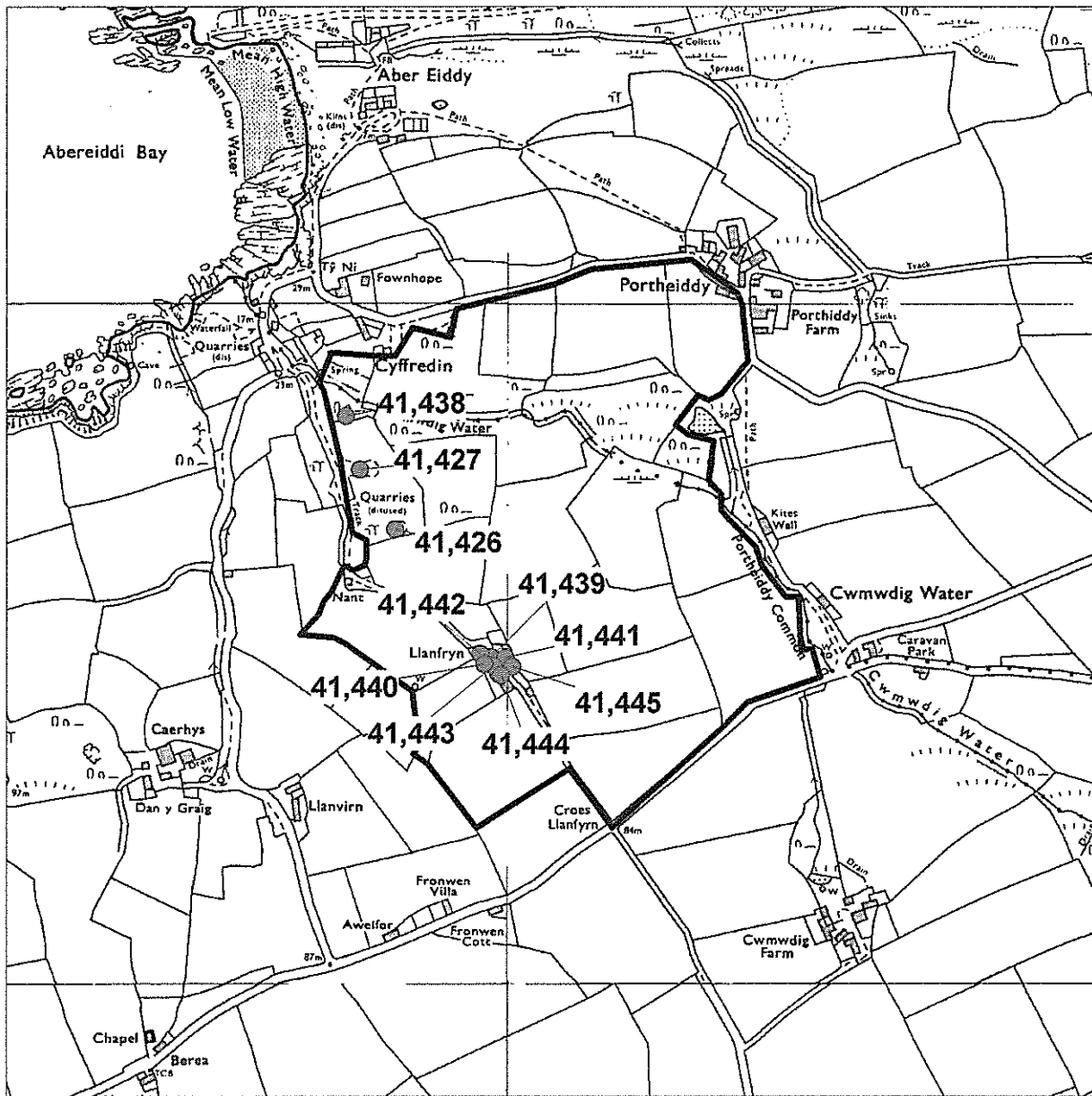

Tir Gofal Farm Visit
Lecha Farm
ACA Report No.2001/1
Map 3
SM82NW
Scale 1:2500

Reproduced from Ordnance Survey map
with the permission of the Controller of
Her Majesty's Stationary Office.
Crown Copyright reserved.
Countryside Council for Wales
Licence No.GD272825G

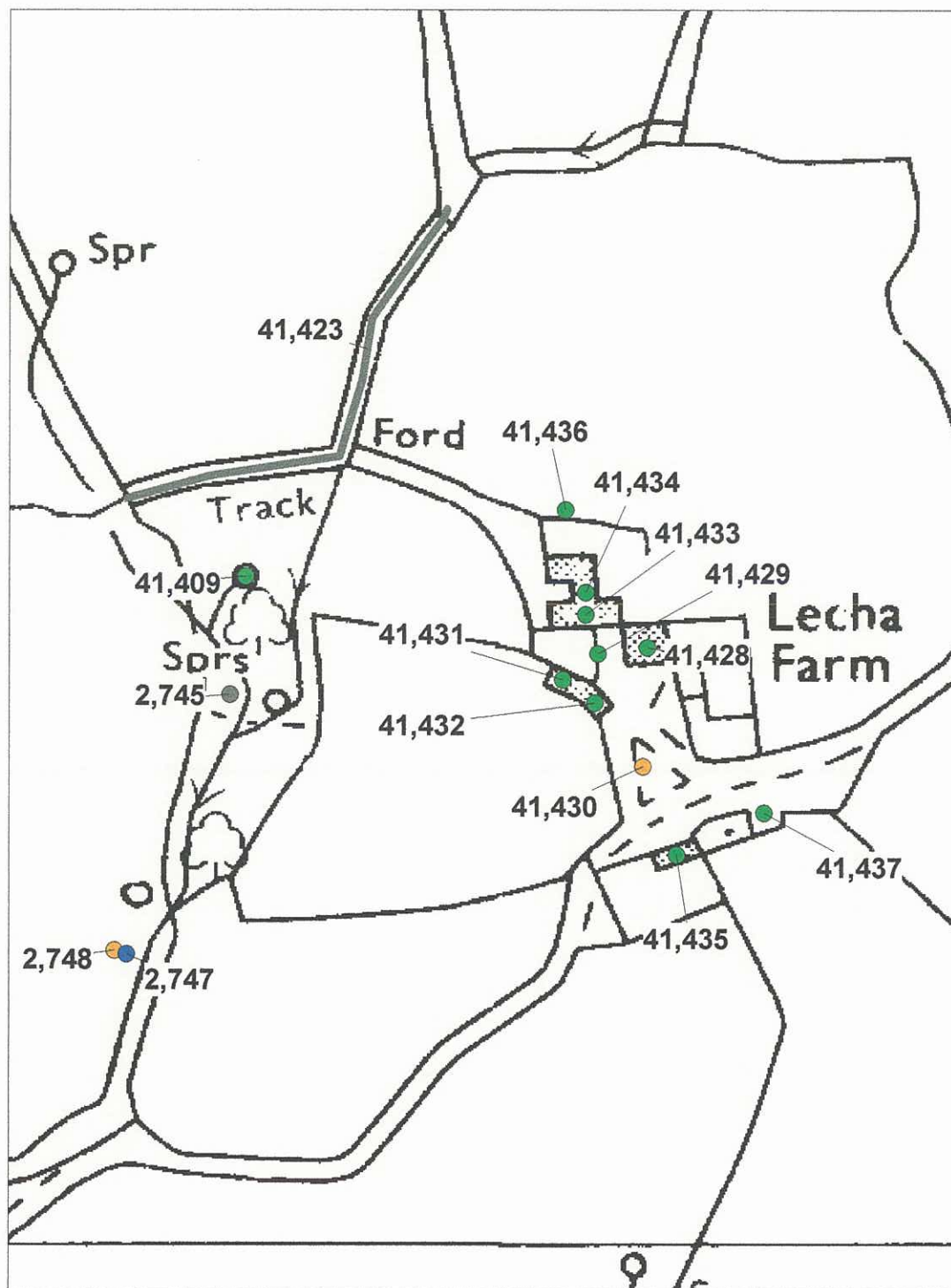

Tir Gofal Farm Visit
Lecha Farm
ACA Report No.2001/1
Map 4
SM73SE

Reproduced from Ordnance Survey map
with the permission of the Controller of
Her Majesty's Stationary Office.
Crown Copyright reserved.
Countryside Council for Wales
Licence No.GD272825G

Scale 1:1500

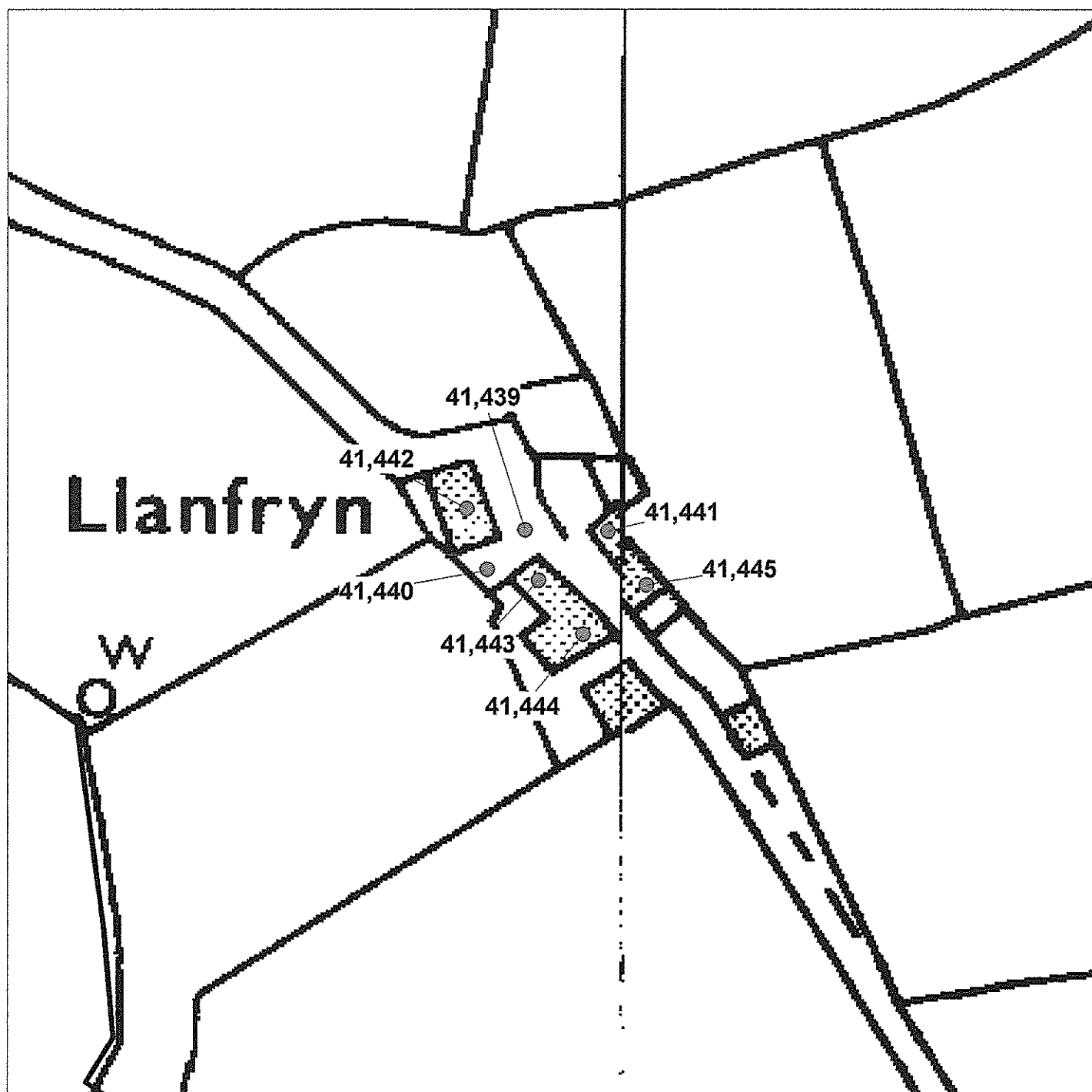

Plates

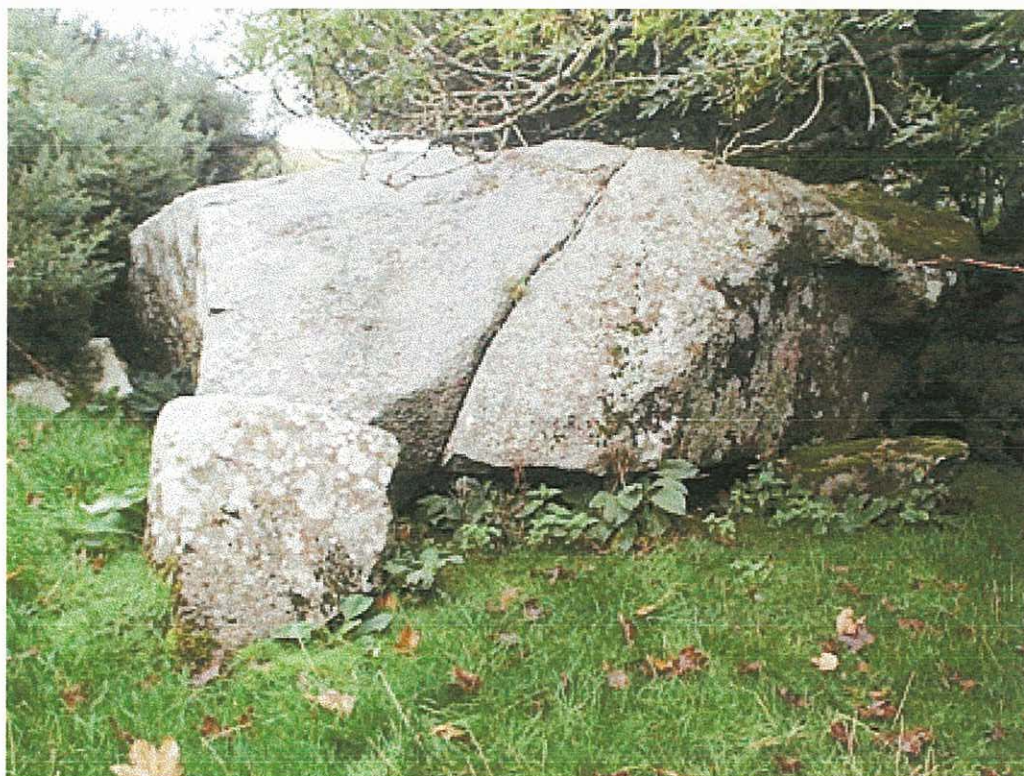

Plate 1 - Lecha Chambered Tomb (PRN 2747).



Plate 2 - Stone source for Lecha Chambered Tomb (PRN 2748).



Plate 3 - Lecha Farmhouse (PRN41428).



Plate 4 - the barn at Lecha Farm (PRN 41429).



Plate 5 - the winnow mound (PRN 41430).



Plate 6 - early nineteenth century cowhouse (PRN 41433).



Plate 7 - the cart shed at Lecha Farm (PRN 41435).



Plate 8 - the cart shed at Llanvirn Farm (PRN 41440).