

**DYFED ARCHAEOLOGICAL TRUST
GLASTIR ADVANCED TARGETED ADVICE**

Cwmcoy A0022691



DAT EVENT RECORD NO. 112712

DAT REPORT NO. 2018-42

HEFs included in this report:

HEF 308619, PRN 64180 Farmstead

HEF 315499, PRN 64699 Farmhouse

HEF 315612, PRN 112713 Ring cairn

HEF 315627, PRN 112714 Ring cairn

HEF 315628, PRN 112715 Ring cairn

HEF 315629, PRN 112716 Clearance cairn?

HEF 315630, PRN 112717 Building

HEF 105631, PRN 112718 Pond and leat

HEF 315632, PRNs 109593, 109594, 109595, 109596, 109597, 112719 Cwmcoy farmstead

Glastir Advanced Historic Environment Feature (HEF) Management Plan

Date: 1st June 2018

HEF No. 315612 & PRN 112713



Customer Reference Number (CRN): CRN A0022691

Farm/Common name: Cwmcoy

This Management Plan has been produced by Dyfed Archaeological Trust to inform management of the Historic Environment feature (HEF). Some or all of the requirements included in this Management Plan may have been included in the Glastir Advanced contract.

HEF Name and Reference Number	HEF No. 315612 & PRN 112713
Grid Reference	SN7038223271
Officer Name	Alice Pyper
Contact Details	01558 825993

Contained within this report:

1. Site Description	
Additional information:	
2. Current Condition	
Management Issues	
3. Map of the Polygon Area Highlighting Management Issues	
4. Management Advice	
Prioritised list of management works:	
4.1 Management Works Methodology	
4.2 Long-term Management Recommendations / Best Practice	
4.3 Opportunities for Public Access and interpretation	
5. Photographs	
6. Definitive Map of the HEF Polygon Area	
7. Contractual Requirements	
7.1 Glastir - Whole Farm Code	

1. Site Description

A prehistoric ring barrow consisting of a circular low earthwork bank. A Pyper June 2018

An earth and stone ring, with a bank reaching c0.5m high and around 20m in circumference.

A large quantity of loose stone is collected in a crescent shape around the southeastern side of the monument.

The monument lies just below and on the southeast side of the ridgetop on a slight slope to the southeast. Extensive views lie to the southeast towards Mynydd Du.

A linear stone and earth field boundary skirt the monument to the northwest, and some of the loose stone may have been built into this later feature. A very well defined monument which lies in permanent pasture. A Pyper 2018.

2. Current Condition

Current condition of the monument is good, it is located in permanent pasture and is in a stable condition.

Management Issues

No management issues identified, management should continue with light grazing and no disturbance.

3. Map of the Polygon Area Highlighting Management Issues

N/A

4. Management Advice

Current management regime should continue; providing light grazing and no disturbance.

4.1 Management Works Methodology

N/A

4.2 Long-term Management Recommendations / Best Practice

The monument should remain as it is currently; in a lightly grazed management regime, so that scrub does not encroach over it. It should remain undisturbed, with loose stone neither added nor taken away from the monument.

4.3 Opportunities for Public Access and interpretation N/A

5. Photographs

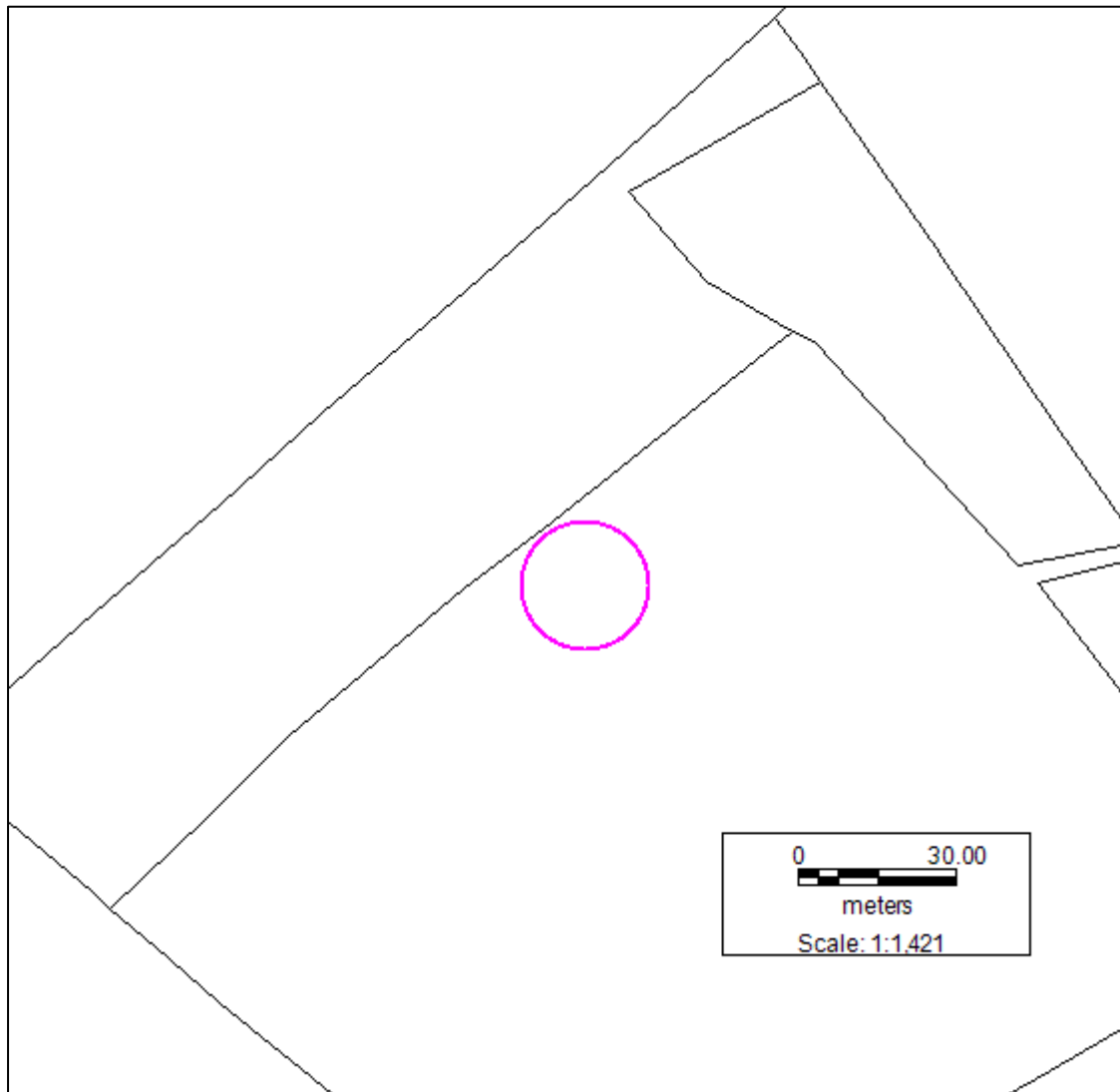

Figure 1. Ring barrow, looking to the southwest



Figure 2. Ring barrow, looking to the northwest

6. Definitive Map of the HEF Polygon Area



7. Contractual Requirements

Some or all of the requirements detailed in the Management Plan may have been included in the Glastir Advanced contract. It is important that you read your contract before undertaking any work included in this Management Plan.

7.1 Glastir - Whole Farm Code

The Glastir Whole Farm Code states:

You must not damage any historic feature identified on your agreement map

Definitions of damage to a historic feature include ANY of the following:

- Ground disturbance or excavation especially extending beneath topsoil
- Dumping or storage of material, including temporary storage
- Removal of any material, including stones, soil or subsoil
- Visible signs of active erosion (loss and disturbance of topsoil) caused by livestock and vehicles or other agricultural practice
- Planting trees
- Allowing scrub to develop
- Ploughing or reseedling
- Displacing individual stone features

Glastir Advanced Historic Environment Feature (HEF) Management Plan

Date: 1st June 2018

HEF No. 315627 & PRN 112714



Customer Reference Number (CRN): CRN A0022691

Farm/Common name: Cwmcoy

This Management Plan has been produced by Dyfed Archaeological Trust to inform management of the Historic Environment feature (HEF). Some or all of the requirements included in this Management Plan may have been included in the Glastir Advanced contract.

HEF Name and Reference Number	HEF No. 315627 & PRN 112714
Grid Reference	SN7026123192
Officer Name	Alice Pyper
Contact Details	01558 825993

Contained within this report:

1. Site Description	
Additional information:	
2. Current Condition	
Management Issues	
3. Map of the Polygon Area Highlighting Management Issues	
4. Management Advice	
Prioritised list of management works:	
4.1 Management Works Methodology	
4.2 Long-term Management Recommendations / Best Practice	
4.3 Opportunities for Public Access and interpretation	
5. Photographs	
6. Definitive Map of the HEF Polygon Area	
7. Contractual Requirements	
7.1 Glastir - Whole Farm Code	

1. Site Description

A prehistoric ring barrow consisting of a circular low earthwork bank. A Pyper June 2018

An earthwork ring with a small area of stone exposed, with a bank reaching 0.25m high and around 10-11m in circumference. The monument lies just below and on the southeast side of the ridgetop on a slight slope to the southeast. Extensive views lie to the southeast towards Mynydd Du.

A stone and earth field boundary skirt the monument to the northwest, and some of the loose stone may have been built into this later feature. A less well defined monument than those which lie to the east (PRNs 112713 and 112715) it lies in permanent pasture. A Pyper 2018.

2. Current Condition

Current condition of the monument is good, although it is less well defined than the other two ring cairns HEFs 315612 and 315628 (PRNs 112713 and 112715), it is located in permanent pasture, with some reeds growing in patches to the southeast side.

Management Issues

No management issues identified, management should continue with light grazing and no disturbance.

3. Map of the Polygon Area Highlighting Management Issues

N/A

4. Management Advice

Current management regime should continue; providing light grazing no disturbance.

4.1 Management Works Methodology

N/A

4.2 Long-term Management Recommendations / Best Practice

The monument should remain as it is currently; in a lightly grazed management regime, so that scrub does not encroach over it. It should remain undisturbed, with loose stone neither added nor taken away from the monument.

4.3 Opportunities for Public Access and interpretation

N/A

5. Photographs

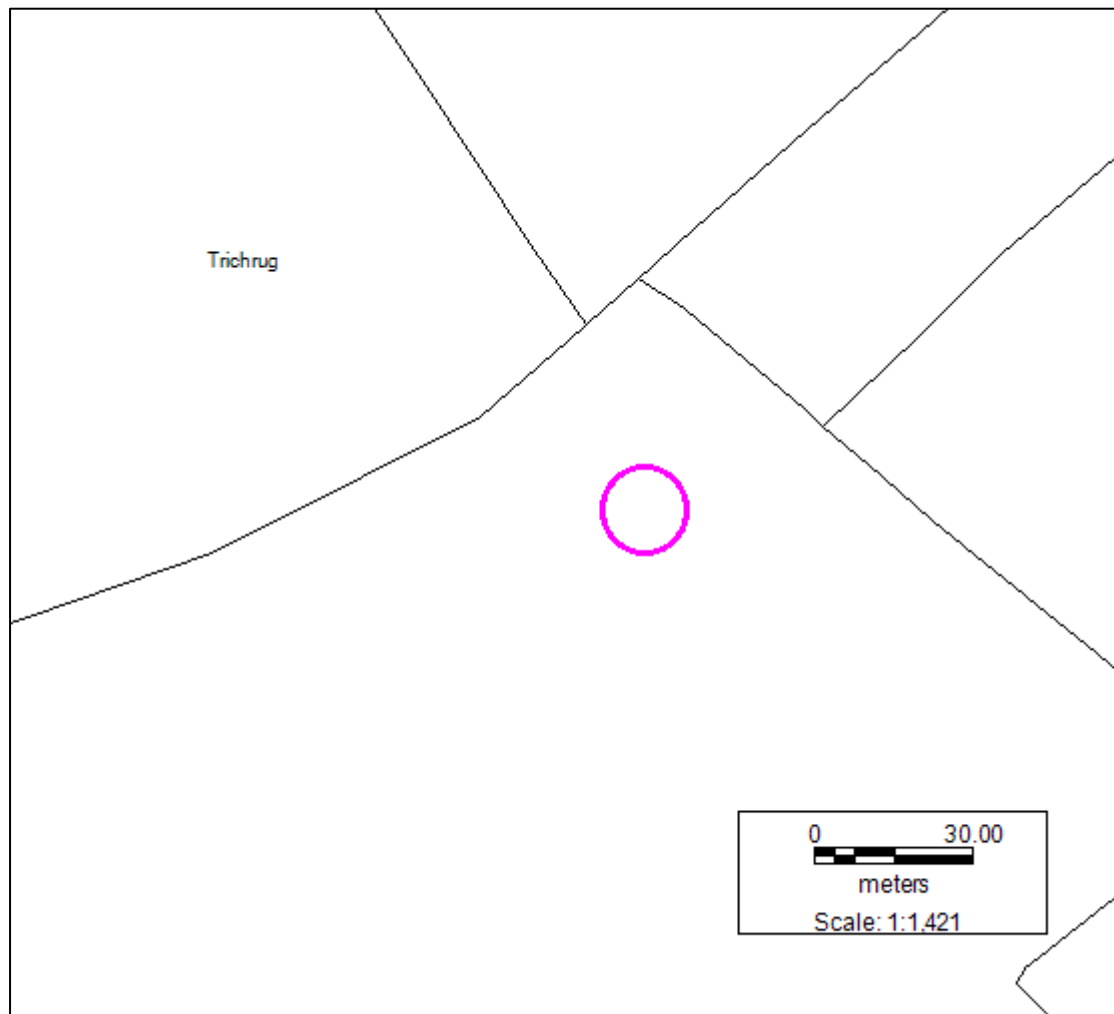

Figure 3. Ring barrow, looking to the northwest



Figure 4. Ring barrow, looking to the southeast

6. Definitive Map of the HEF Polygon Area



7. Contractual Requirements

Some or all of the requirements detailed in the Management Plan may have been included in the Glastir Advanced contract. It is important that you read your contract before undertaking any work included in this Management Plan.

7.1 Glastir - Whole Farm Code

The Glastir Whole Farm Code states:

You must not damage any historic feature identified on your agreement map
Definitions of damage to a historic feature include ANY of the following:

- Ground disturbance or excavation especially extending beneath topsoil

- Dumping or storage of material, including temporary storage
- Removal of any material, including stones, soil or subsoil
- Visible signs of active erosion (loss and disturbance of topsoil) caused by livestock and vehicles or other agricultural practice
- Planting trees
- Allowing scrub to develop
- Ploughing or reseeded
- Displacing individual stone features

Glastir Advanced Historic Environment Feature (HEF) Management Plan

Date: 1st June 2018

HEF No. 315628 & PRN 112715



Customer Reference Number (CRN): CRN A0022691

Farm/Common name: Cwmcoy

This Management Plan has been produced by Dyfed Archaeological Trust to inform management of the Historic Environment feature (HEF). Some or all of the requirements included in this Management Plan may have been included in the Glastir Advanced contract.

HEF Name and Reference Number	HEF No. 315628 & PRN 112715
Grid Reference	SN7061823470
Officer Name	Alice Pyper
Contact Details	01558 825993

Contained within this report:

1. Site Description	
Additional information:	
2. Current Condition	
Management Issues	
3. Map of the Polygon Area Highlighting Management Issues	
4. Management Advice	
Prioritised list of management works:	
4.1 Management Works Methodology	
4.2 Long-term Management Recommendations / Best Practice	
4.3 Opportunities for Public Access and interpretation	
5. Photographs	
6. Definitive Map of the HEF Polygon Area	
7. Contractual Requirements	
7.1 Glastir - Whole Farm Code	

1. Site Description

A prehistoric ring barrow consisting of a circular low earthwork bank. A Pyper June 2018

An earth and stone ring, with a bank reaching c.0.5m high and around 10m in circumference. Some loose stone lies in the centre, though a section of the bank displays some built masonry. The monument lies just below and on the southeast side of the ridgetop on a slight slope to the southeast. Extensive views lie to the southeast towards Mynydd Du.

A linear stone and earth field boundary skirt the monument to the northwest, and some of the loose stone may have been built into this later feature. A well-defined section of built masonry/kerbing survives to the north. Lies in permanent pasture. A Pyper 2018.

2. Current Condition

Current condition of the monument is good, it is located in permanent pasture and is stable.

Management Issues

No management issues identified, management should continue with light grazing and no disturbance.

3. Map of the Polygon Area Highlighting Management Issues

N/A

4. Management Advice

Current management regime should continue; providing light grazing no disturbance.

4.1 Management Works Methodology

N/A

4.2 Long-term Management Recommendations / Best Practice

The monument should remain as it is currently; in a lightly grazed management regime, so that scrub does not encroach over it. It should remain undisturbed, with loose stone neither added nor taken away from the monument.

4.3 Opportunities for Public Access and interpretation

N/A

5. Photographs

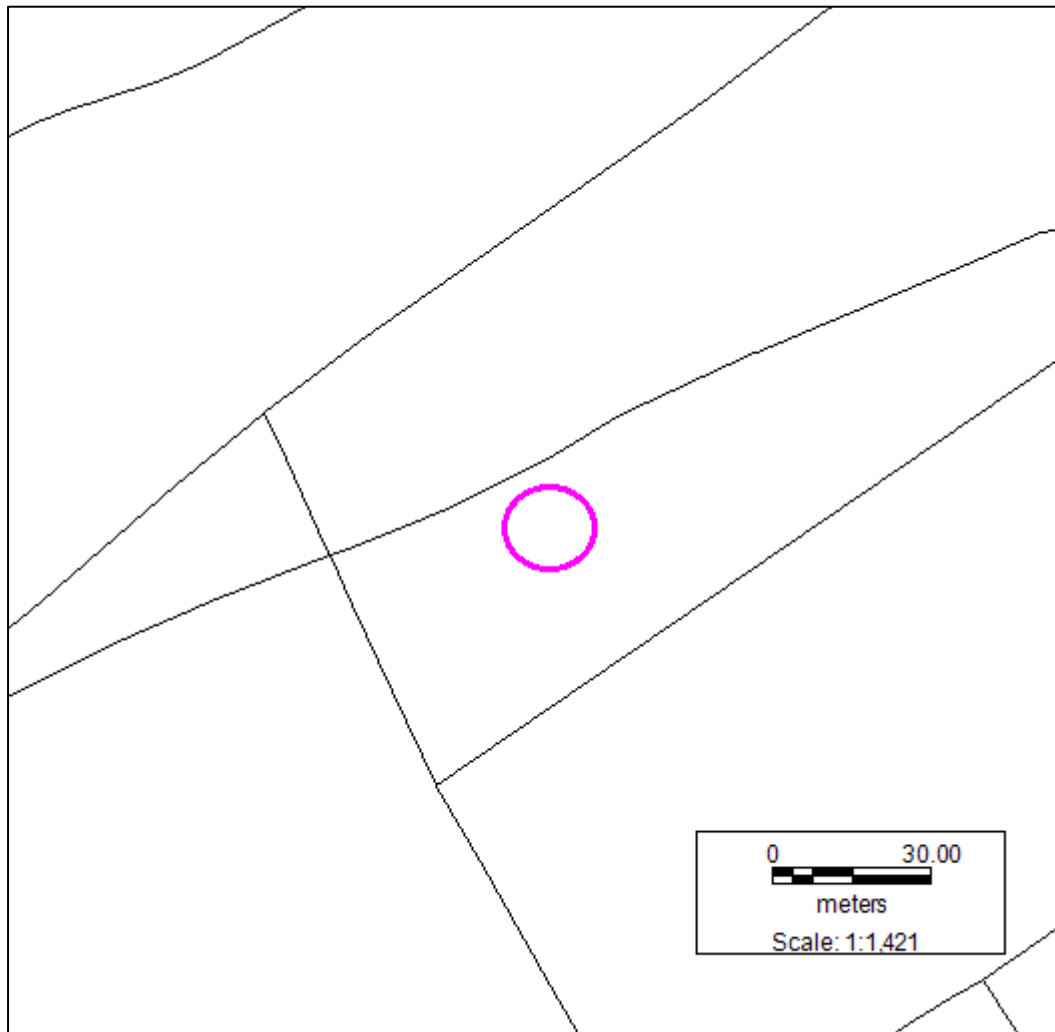

Figure 5. Ring barrow, looking to the southeast



Figure 6. Ring barrow, showing a section of the masonry bank

6. Definitive Map of the HEF Polygon Area



7. Contractual Requirements

Some or all of the requirements detailed in the Management Plan may have been included in the Glastir Advanced contract. It is important that you read your contract before undertaking any work included in this Management Plan.

7.1 Glastir - Whole Farm Code

The Glastir Whole Farm Code states:

You must not damage any historic feature identified on your agreement map
Definitions of damage to a historic feature include ANY of the following:

- Ground disturbance or excavation especially extending beneath topsoil

- Dumping or storage of material, including temporary storage
- Removal of any material, including stones, soil or subsoil
- Visible signs of active erosion (loss and disturbance of topsoil) caused by livestock and vehicles or other agricultural practice
- Planting trees
- Allowing scrub to develop
- Ploughing or reseedling
- Displacing individual stone features

Glastir Advanced Historic Environment Feature (HEF) Management Plan

Date: 1st June 2018

HEF No. 315629 & PRN 112716



Customer Reference Number (CRN): CRN A0022691

Farm/Common name: Cwmcoy

This Management Plan has been produced by Dyfed Archaeological Trust to inform management of the Historic Environment feature (HEF). Some or all of the requirements included in this Management Plan may have been included in the Glastir Advanced contract.

HEF Name and Reference Number	HEF No. 315629 & PRN 112716
Grid Reference	SN7099323420
Officer Name	Alice Pyper
Contact Details	01558 825993

Contained within this report:

1. Site Description	
Additional information:	
2. Current Condition	
Management Issues	
3. Map of the Polygon Area Highlighting Management Issues	
4. Management Advice	
Prioritised list of management works:	
4.1 Management Works Methodology	
4.2 Long-term Management Recommendations / Best Practice	
4.3 Opportunities for Public Access and interpretation	
5. Photographs	
6. Definitive Map of the HEF Polygon Area	
7. Contractual Requirements	
7.1 Glastir - Whole Farm Code	

1. Site Description

An irregular pile of stones covered by turf, which may represent a clearance cairn, or a disturbed feature such as a field corn drying kiln. Lies to the north of a trackway leading towards Cwmcoy Farmstead. A Pyper June 2018.

2. Current Condition

Current condition of the monument is good, it is located in permanent pasture and is stable.

Management Issues

No management issues identified, management should continue with light grazing and no disturbance.

3. Map of the Polygon Area Highlighting Management Issues

N/A

4. Management Advice

Current management regime should continue; providing light grazing and no disturbance.

4.1 Management Works Methodology

N/A

4.2 Long-term Management Recommendations / Best Practice

The feature should remain as it is currently; in a lightly grazed management regime, so that scrub does not encroach over it. It should remain undisturbed.

4.3 Opportunities for Public Access and interpretation

N/A

5. Photographs



Figure 7. Disturbed feature, possible clearance cairn

6. Definitive Map of the HEF Polygon Area

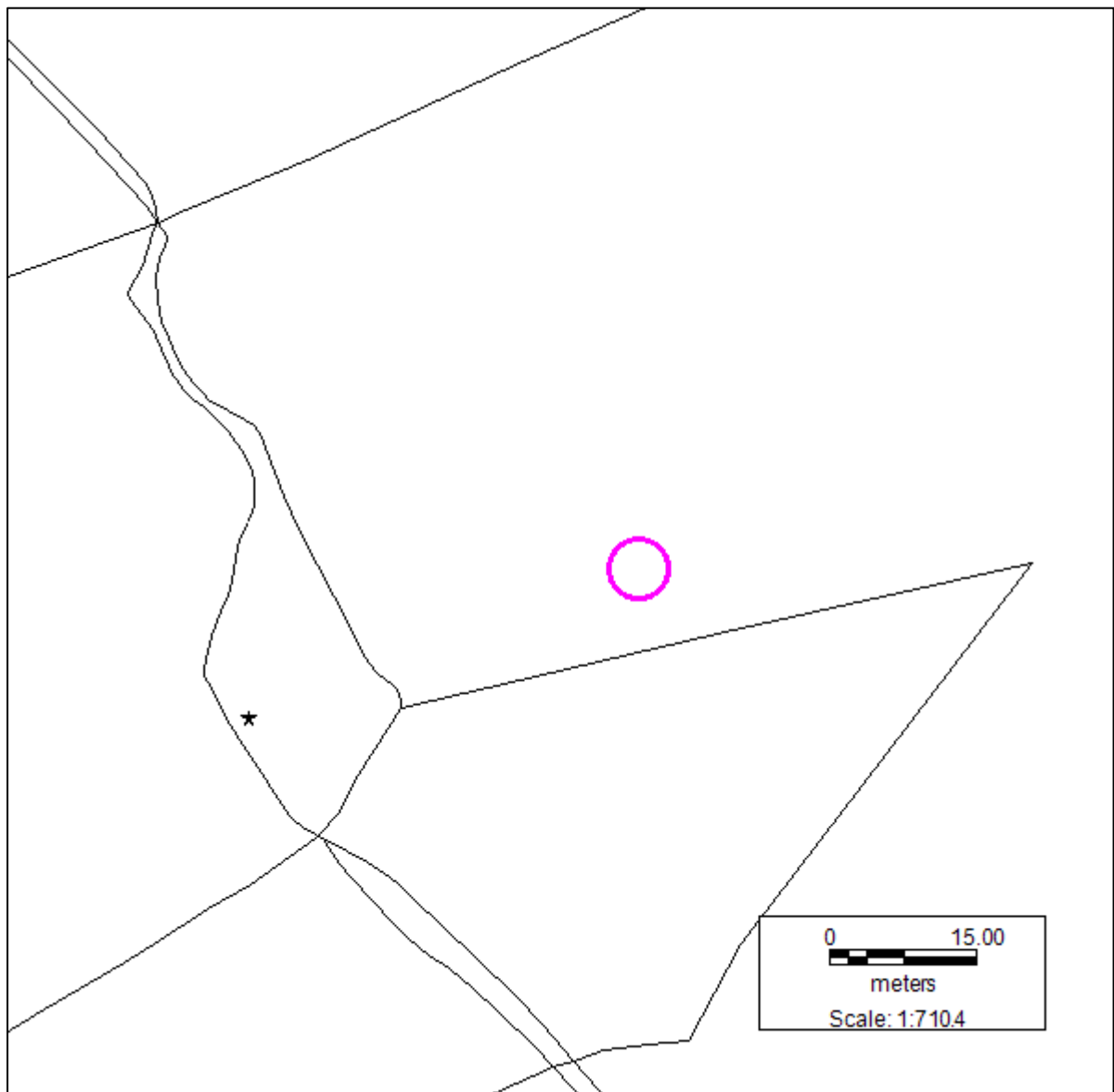

7. Contractual Requirements

Some or all of the requirements detailed in the Management Plan may have been included in the Glastir Advanced contract. It is important that you read your contract before undertaking any work included in this Management Plan.

7.1 Glastir - Whole Farm Code

The Glastir Whole Farm Code states:

You must not damage any historic feature identified on your agreement map

Definitions of damage to a historic feature include ANY of the following:

- Ground disturbance or excavation especially extending beneath topsoil
- Dumping or storage of material, including temporary storage
- Removal of any material, including stones, soil or subsoil
- Visible signs of active erosion (loss and disturbance of topsoil) caused by livestock and vehicles or other agricultural practice
- Planting trees
- Allowing scrub to develop
- Ploughing or reseedling
- Displacing individual stone features

Glastir Advanced Historic Environment Feature (HEF) Management Plan

Date: 1st June 2018

HEF No. 315630 & PRN 112717



Customer Reference Number (CRN): CRN A0022691

Farm/Common name: Cwmcoy

This Management Plan has been produced by Dyfed Archaeological Trust to inform management of the Historic Environment feature (HEF). Some or all of the requirements included in this Management Plan may have been included in the Glastir Advanced contract.

HEF Name and Reference Number	HEF No. 315630 & PRN 112717
Grid Reference	SN7117223120
Officer Name	Alice Pyper
Contact Details	01558 825993

Contained within this report:

1. Site Description	
Additional information:	
2. Current Condition	
Management Issues	
3. Map of the Polygon Area Highlighting Management Issues	
4. Management Advice	
Prioritised list of management works:	
4.1 Management Works Methodology	
4.2 Long-term Management Recommendations / Best Practice	
4.3 Opportunities for Public Access and interpretation	
5. Photographs	
6. Definitive Map of the HEF Polygon Area	
7. Contractual Requirements	
7.1 Glastir - Whole Farm Code	

1. Site Description

A stone building recorded on the tithe map, survives as a roofless ruin. A Pyper June 2018.

The building is positioned down-the-slope, the corners, with well-built stone quoins still survive to roof height, though the downslope gable end has collapsed, and the NE lateral wall has largely collapsed. The southwest facing lateral wall is largely surviving to roof plate height and the upslope gable end also survives although is overgrown.

Above the ruin is a levelled overgrown area which suggests there may have been a further structure at the upper end. No surviving openings are visible except on the north east wall where a door jamb at the upper end survives. When visited it was overgrown and not fully accessible. A Pyper June 2018

2. Current Condition

The building is in a ruinous condition, and very overgrown with trees growing within it and against the external face of the walls.

Management Issues

The masonry is liable to damage from excessive vegetation growth.

3. Map of the Polygon Area Highlighting Management Issues

N/A

4. Management Advice

Where trees or saplings have established themselves in the masonry, they should be cut back and spot treated to prevent regrowth. Any heavy branches which are liable to fall on the masonry should be removed.

4.1 Management Works Methodology

Any vegetation clearance should be done by hand.

4.2 Long-term Management Recommendations / Best Practice

The building should be monitored and regularly cleared of excessive vegetation.

4.3 Opportunities for Public Access and interpretation

N/A

5. Photographs

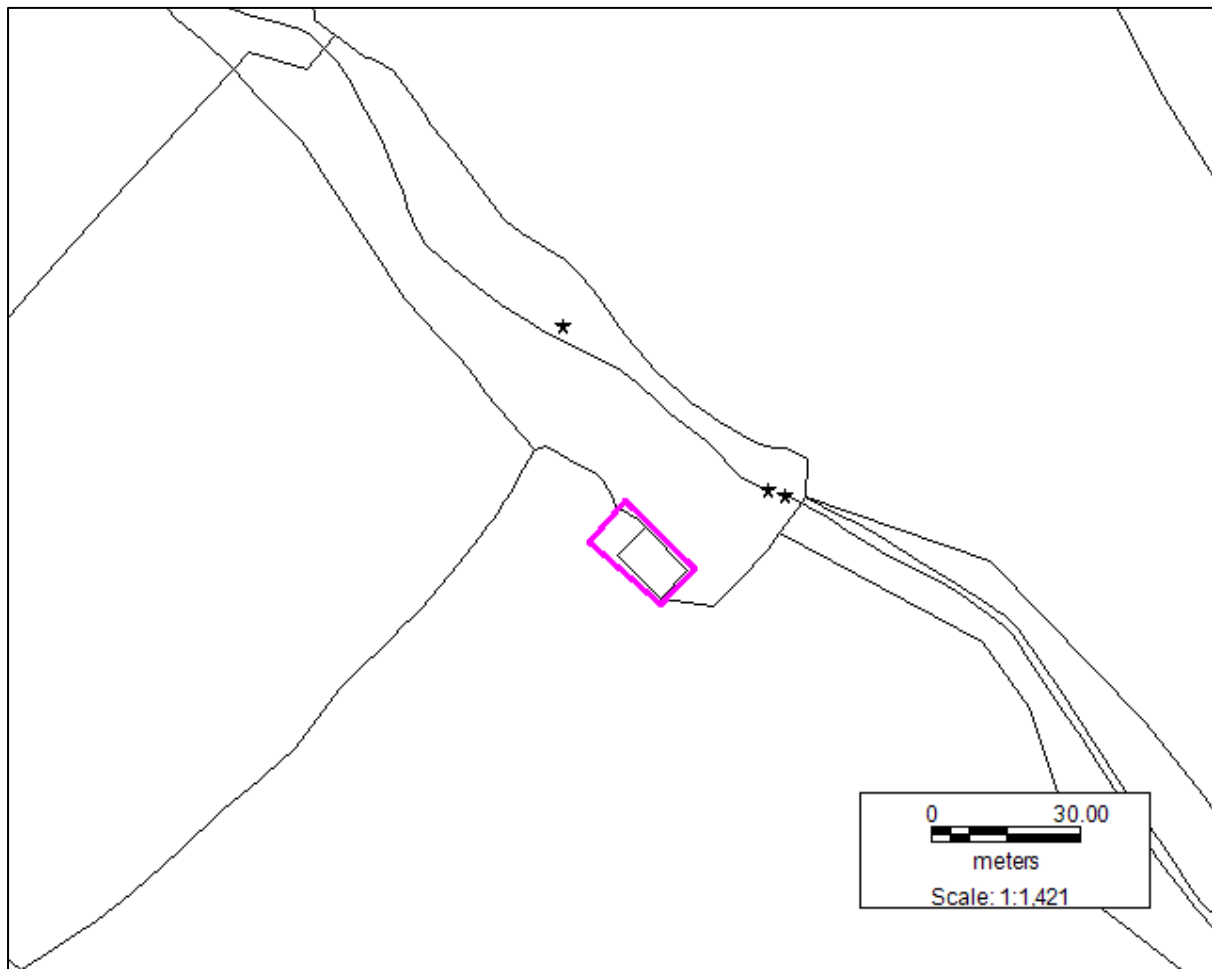

Figure 8. West-facing elevation



Figure 9. East-facing elevation

6. Definitive Map of the HEF Polygon Area



7. Contractual Requirements

Some or all of the requirements detailed in the Management Plan may have been included in the Glastir Advanced contract. It is important that you read your contract before undertaking any work included in this Management Plan.

7.1 Glastir - Whole Farm Code

The Glastir Whole Farm Code states:

You must not damage any historic feature identified on your agreement map
Definitions of damage to a historic feature include ANY of the following:

- Ground disturbance or excavation especially extending beneath topsoil
- Dumping or storage of material, including temporary storage

- Removal of any material, including stones, soil or subsoil
- Visible signs of active erosion (loss and disturbance of topsoil) caused by livestock and vehicles or other agricultural practice
- Planting trees
- Allowing scrub to develop
- Ploughing or reseedling
- Displacing individual stone features

Glastir Advanced Historic Environment Feature (HEF) Management Plan

Date: 1st June 2018

HEF No. 315631 & PRN 112718

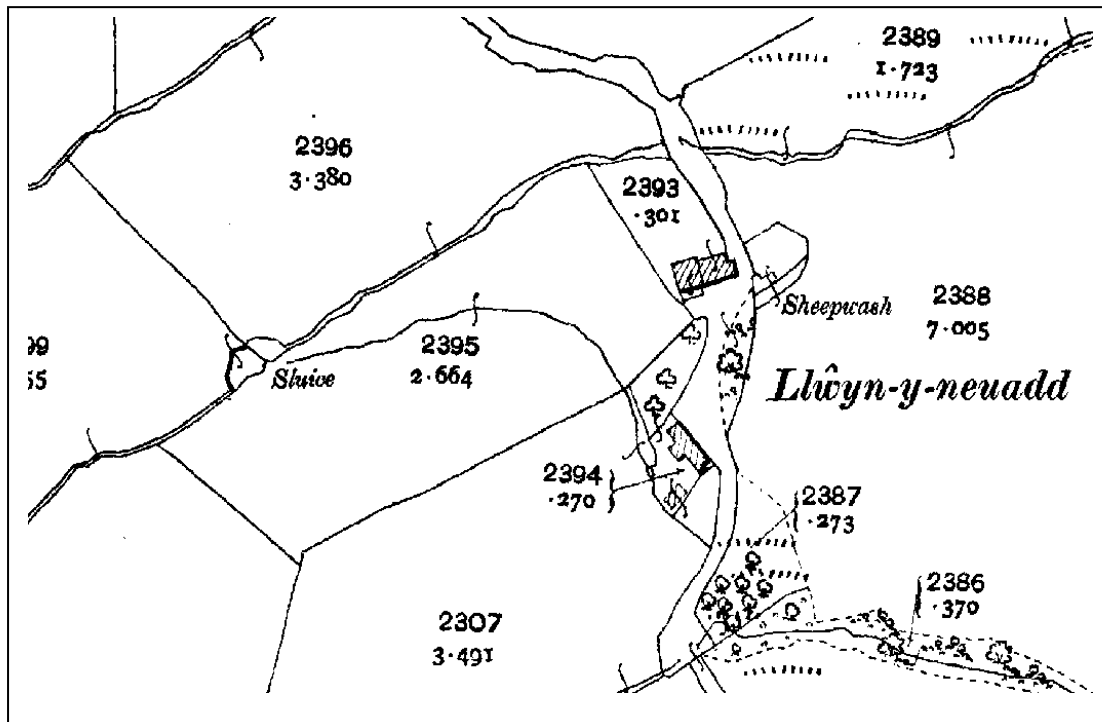

Customer Reference Number (CRN): CRN A0022691

Farm/Common name: Cwmcoy

This Management Plan has been produced by Dyfed Archaeological Trust to inform management of the Historic Environment feature (HEF). Some or all of the requirements included in this Management Plan may have been included in the Glastir Advanced contract.

HEF Name and Reference Number	HEF No. 105631 & PRN 112718
Grid Reference	SN7111822684
Officer Name	Alice Pyper
Contact Details	01558 825993

Contained within this report:

1. Site Description	
Additional information:	
2. Current Condition	
Management Issues	
3. Map of the Polygon Area Highlighting Management Issues	
4. Management Advice	
Prioritised list of management works:	
4.1 Management Works Methodology	
4.2 Long-term Management Recommendations / Best Practice	
4.3 Opportunities for Public Access and interpretation	
5. Photographs	
6. Definitive Map of the HEF Polygon Area	
7. Contractual Requirements	
7.1 Glastir - Whole Farm Code	

1. Site Description

A pond with sluice is marked on the 1st and 2nd edition OS maps (1887; 1906) A Pyper June 2018

A pond with sluice is marked on the 1st and 2nd edition OS maps (1887; 1906) to the west of Llwyn-y-neuadd farmstead, supplying a wheel pit to the west of the barn and fed by a leat which survives as a slight ditch in the field. The pond has a stone revetted dam on the southeast (downslope) side and the remains of an iron sluice, not in situ, lie by the gateway to the east. A Pyper 2018.

2. Current Condition

Whilst in a stable condition the pond no longer holds water. The leat lies in pasture.

Management Issues

None identified, though repairs to enable it to refill and function as a pond would be beneficial.

3. Map of the Polygon Area Highlighting Management Issues

N/A

4. Management Advice

It would be desirable to restore the pond to refill with water. It appears that some of the sluice mechanism survives though not in situ. The sluice should be retained on site, though it is probably not possible to restore.

4.1 Management Works Methodology

Any restoration work must ensure that the historic elements of the pond are retained and protected from damage, including the dam and leat.

4.2 Long-term Management Recommendations / Best Practice

To restore the pond to a stable condition and functioning as a pond.

4.3 Opportunities for Public Access and interpretation

N/A

5. Photographs



Figure 10. Looking south towards the dam.

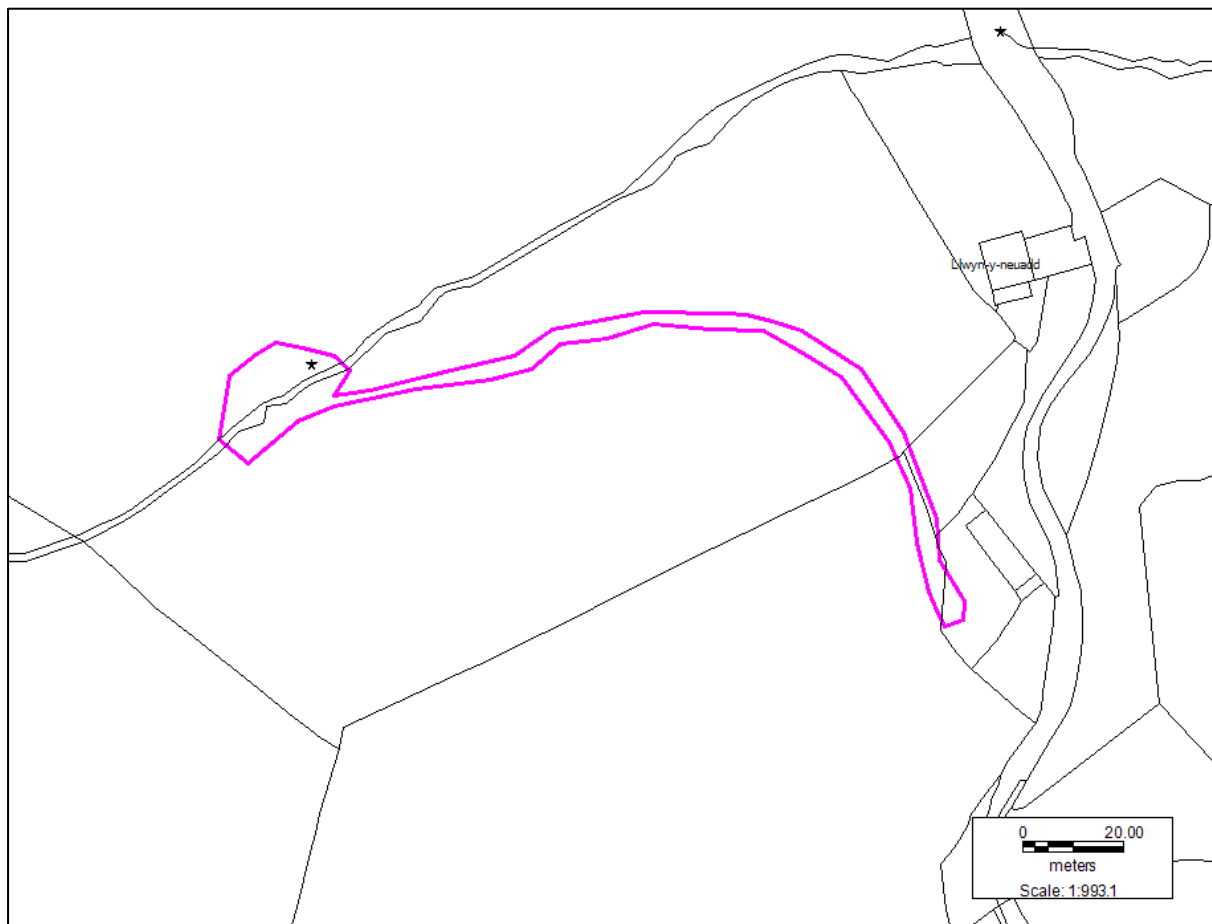

Figure 11. The dam and position of the sluice.



Figure 12. The leat survives as a slight ditch in the field between the pond and farmstead.

6. Definitive Map of the HEF Polygon Area



7. Contractual Requirements

Some or all of the requirements detailed in the Management Plan may have been included in the Glastir Advanced contract. It is important that you read your contract before undertaking any work included in this Management Plan.

7.1 Glastir - Whole Farm Code

The Glastir Whole Farm Code states:

You must not damage any historic feature identified on your agreement map

Definitions of damage to a historic feature include ANY of the following:

- Ground disturbance or excavation especially extending beneath topsoil
- Dumping or storage of material, including temporary storage
- Removal of any material, including stones, soil or subsoil

- Visible signs of active erosion (loss and disturbance of topsoil) caused by livestock and vehicles or other agricultural practice
- Planting trees
- Allowing scrub to develop
- Ploughing or reseedling
- Displacing individual stone features

Glastir Advanced Historic Environment Feature (HEF) Management Plan

Date: 1st June 2018

HEF No. 315632 & PRNs 109593, 109594, 109595, 109596, 109597, 112719

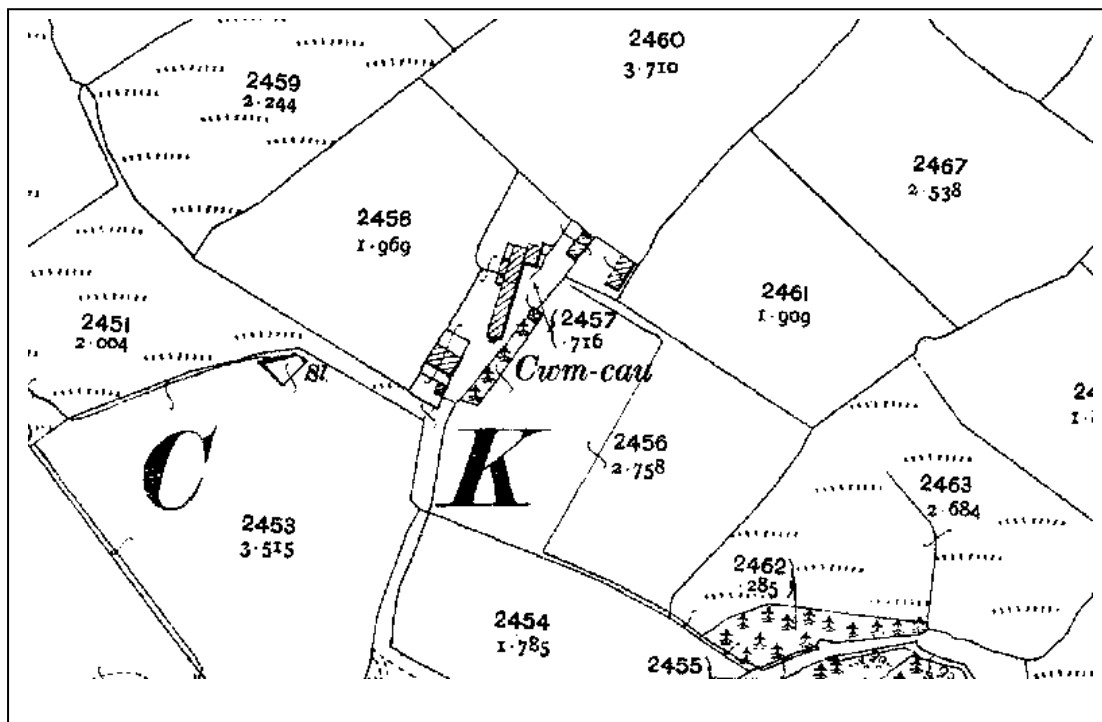

Customer Reference Number (CRN): CRN A0022691

Farm/Common name: Cwmcoy

This Management Plan has been produced by Dyfed Archaeological Trust to inform management of the Historic Environment feature (HEF). Some or all of the requirements included in this Management Plan may have been included in the Glastir Advanced contract.

HEF Name and Reference Number	HEF No. 315632 & PRNs 109593, 109594, 109595, 109596, 109597, 112719
Grid Reference	SN70812313
Officer Name	Alice Pyper
Contact Details	01558 825993

Contained within this report:

1. Site Description	
Additional information:	
2. Current Condition	
Management Issues	
3. Map of the Polygon Area Highlighting Management Issues	
4. Management Advice	
Prioritised list of management works:	
4.1 Management Works Methodology	
4.2 Long-term Management Recommendations / Best Practice	
4.3 Opportunities for Public Access and interpretation	
5. Photographs	
6. Definitive Map of the HEF Polygon Area	
7. Contractual Requirements	
7.1 Glastir - Whole Farm Code	

1. Site Description

The farmstead of Cwmcoy has an historic core including the farmhouse (PRN 109593), a small outside kitchen (PRN 109594), a long farm building (PRN 109595/109596), an adjoining modified building (PRN 109597) and a detached carhouse and stable (112719). All the buildings are represented on the 1st and 2nd edition Ordnance Survey maps of 1887 and 1906 and still survive, though some have been clad in corrugated iron.

2. Current Condition

The historic farmstead buildings are all in use and are weatherproof.

Management Issues

No management issues have been identified.

3. Map of the Polygon Area Highlighting Management Issues

N/A

4. Management Advice

N/A

4.1 Management Works Methodology

4.2 Long-term Management Recommendations / Best Practice

To retain the buildings in a weathertight condition using traditional materials where possible.

4.3 Opportunities for Public Access and interpretation

N/A

5. Photographs



Figure 13. A small outside kitchen adjacent to the farmhouse (PRN 109594)

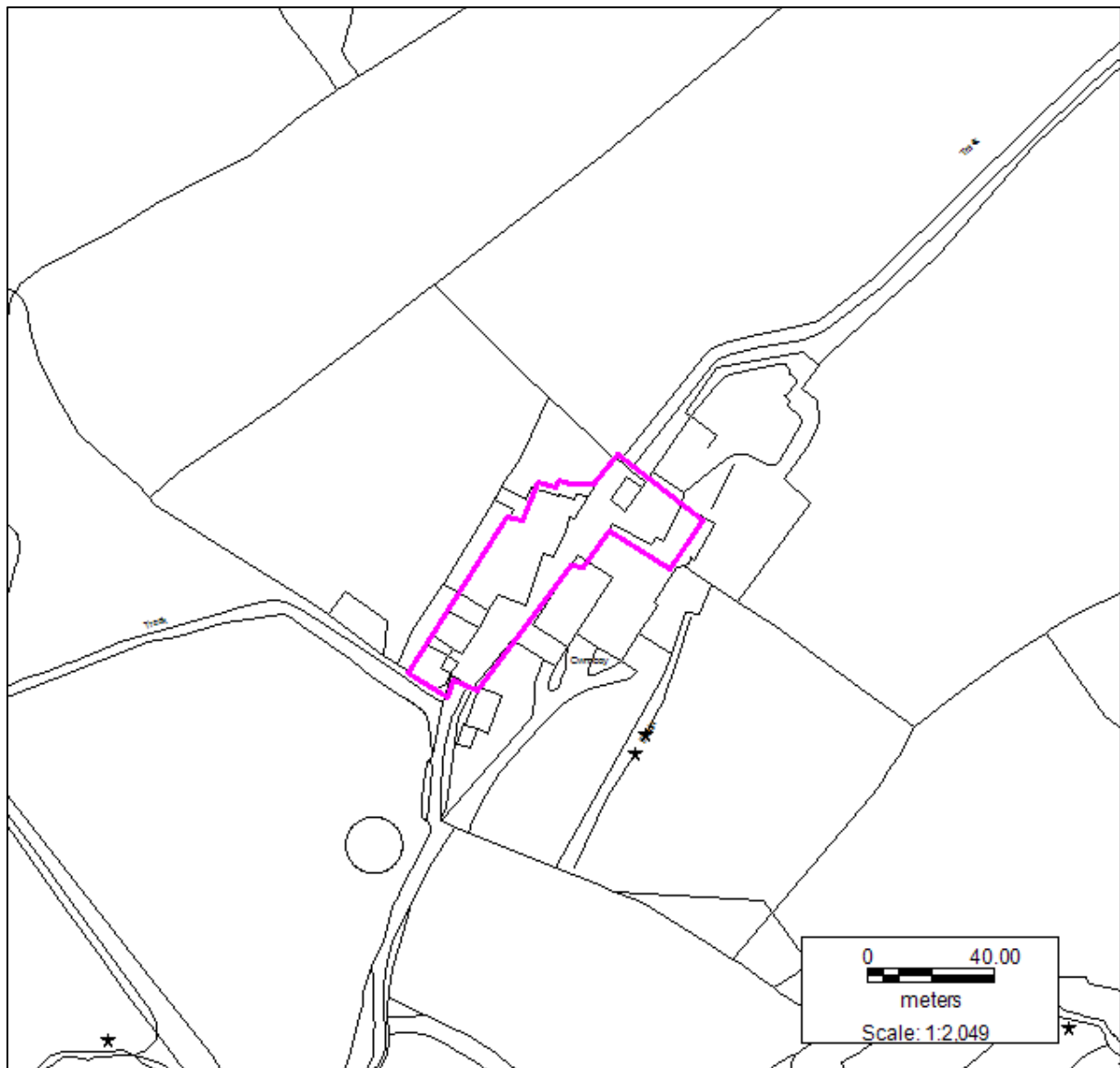

Figure 14. A long farm building, at the southwest end is probably a former cowhouse, (PRN 109595)



Figure 15. A carthouse and stable, (PRN 112719)

6. Definitive Map of the HEF Polygon Area



7. Contractual Requirements

Some or all of the requirements detailed in the Management Plan may have been included in the Glastir Advanced contract. It is important that you read your contract before undertaking any work included in this Management Plan.

7.1 Glastir - Whole Farm Code

The Glastir Whole Farm Code states:

You must not damage any historic feature identified on your agreement map

Definitions of damage to a historic feature include ANY of the following:

- Ground disturbance or excavation especially extending beneath topsoil
- Dumping or storage of material, including temporary storage
- Removal of any material, including stones, soil or subsoil
- Visible signs of active erosion (loss and disturbance of topsoil) caused by livestock and vehicles or other agricultural practice
- Planting trees
- Allowing scrub to develop
- Ploughing or reseedling
- Displacing individual stone features

Glastir Advanced Historic Environment Feature (HEF) Management Plan

Date: 1st June 2018

HEF No. 315499 & PRN 64699

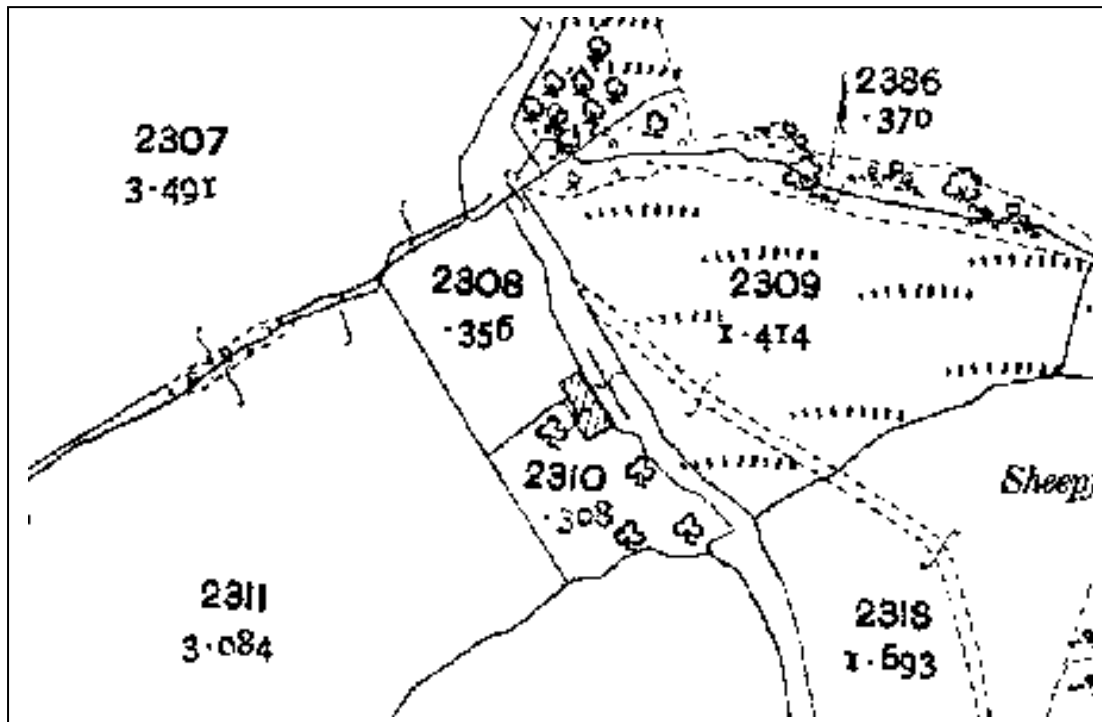

Customer Reference Number (CRN): CRN A0022691

Farm/Common name: Cwmcoy

This Management Plan has been produced by Dyfed Archaeological Trust to inform management of the Historic Environment feature (HEF). Some or all of the requirements included in this Management Plan may have been included in the Glastir Advanced contract.

HEF Name and Reference Number	HEF No. 315499 & PRN 64699
Grid Reference	SN71282254
Officer Name	Alice Pyper
Contact Details	01558 825993

Contained within this report:

1. Site Description	
Additional information:	
2. Current Condition	
Management Issues	
3. Map of the Polygon Area Highlighting Management Issues	
4. Management Advice	
Prioritised list of management works:	
4.1 Management Works Methodology	
4.2 Long-term Management Recommendations / Best Practice	
4.3 Opportunities for Public Access and interpretation	
5. Photographs	
6. Definitive Map of the HEF Polygon Area	
7. Contractual Requirements	
7.1 Glastir - Whole Farm Code	

1. Site Description

A house is shown on the tithe map and 1st and 2nd edition OS maps, though unnamed. A Pyper June 2018 Duplicate record with 105480.

The 2nd edition OS shows an orchard to the south side. The house is ruinous though the southeast facing gable wall survives to roof level with a substantial chimney breast and bread oven surviving on the interior. The house was substantial, built to two storeys. A Pyper June 2018

2. Current Condition

The building is in a ruinous condition and a number of mature trees are growing in close proximity to the upstanding ruined walls and saplings established within the masonry. There is also evidence that the stone quoins have been removed from the ruin.

Management Issues

The masonry remains are threatened by the trees either falling and uprooting or falling on masonry, or from the wind-rock of trees established within the walls.

3. Map of the Polygon Area Highlighting Management Issues

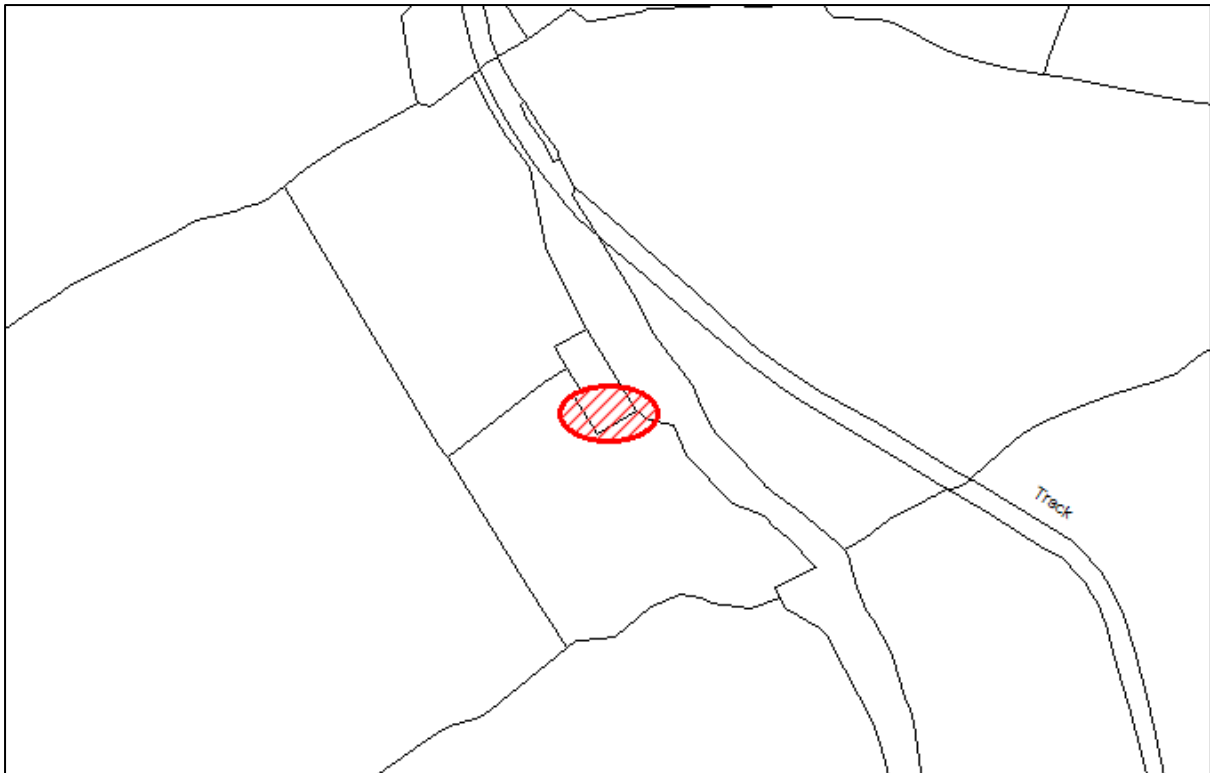

Areas of tree growth.

4. Management Advice

To remove invasive tree growth and branches, where safe to do so. Ivy also is established on the walls, however this should not be removed as it may well be supporting areas of masonry.

4.1 Management Works Methodology

Removal of saplings and large tree limbs which threaten the ruin.

4.2 Long-term Management Recommendations / Best Practice

To monitor the ruin and remove tree growth where it threatens the stability of the masonry.

4.3 Opportunities for Public Access and interpretation

N/A

5. Photographs

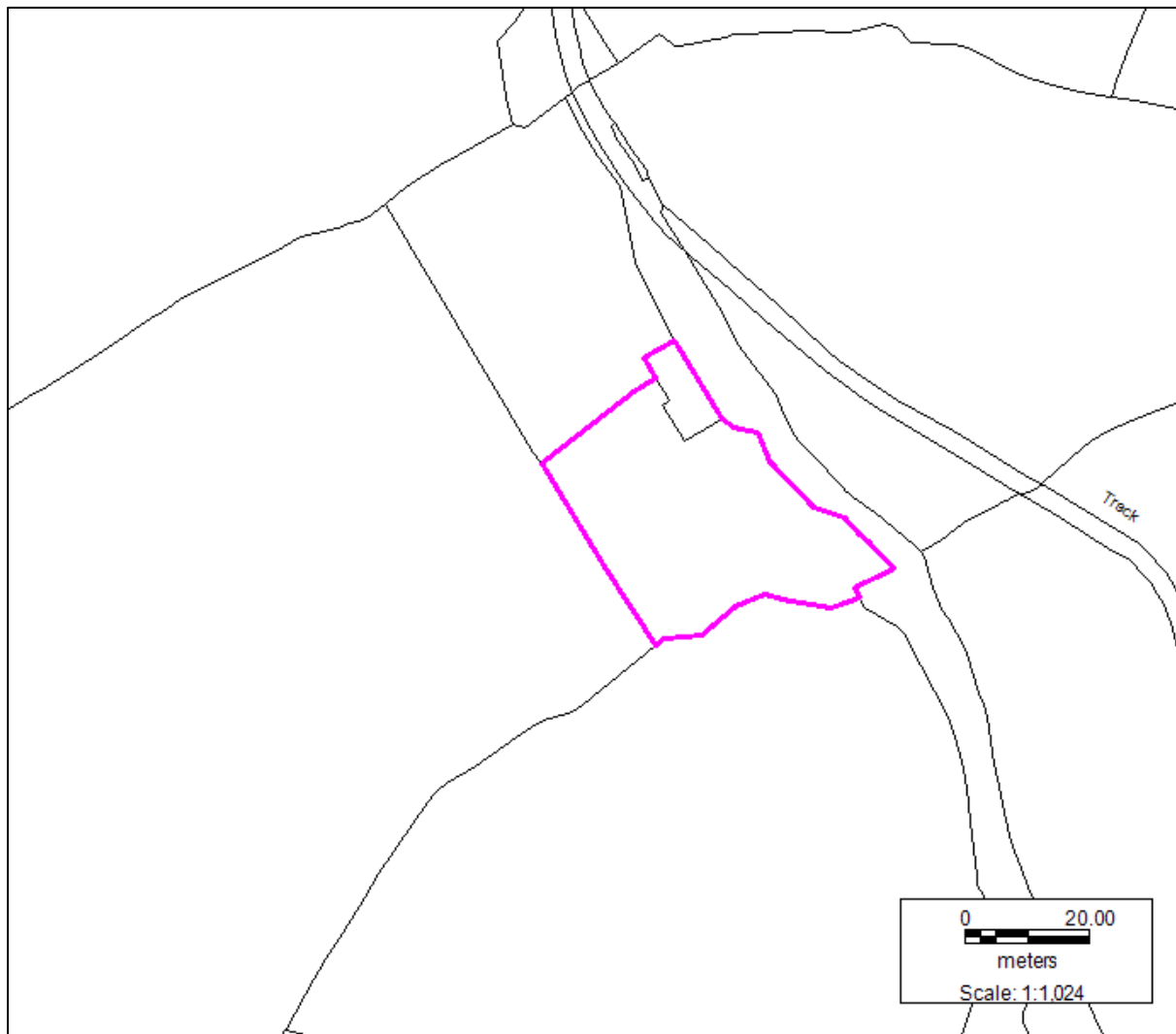

Figure 16. The gable wall of the farmhouse



Figure 17. The gable wall of the farmhouse.

6. Definitive Map of the HEF Polygon Area



7. Contractual Requirements

Some or all of the requirements detailed in the Management Plan may have been included in the Glastir Advanced contract. It is important that you read your contract before undertaking any work included in this Management Plan.

7.1 Glastir - Whole Farm Code

The Glastir Whole Farm Code states:

You must not damage any historic feature identified on your agreement map

Definitions of damage to a historic feature include ANY of the following:

- Ground disturbance or excavation especially extending beneath topsoil
- Dumping or storage of material, including temporary storage
- Removal of any material, including stones, soil or subsoil
- Visible signs of active erosion (loss and disturbance of topsoil) caused by livestock and vehicles or other agricultural practice
- Planting trees
- Allowing scrub to develop
- Ploughing or reseedling
- Displacing individual stone features

Glastir Advanced Historic Environment Feature (HEF) Management Plan

Date: 1st June 2018

HEF No. 308619 & PRN 64180

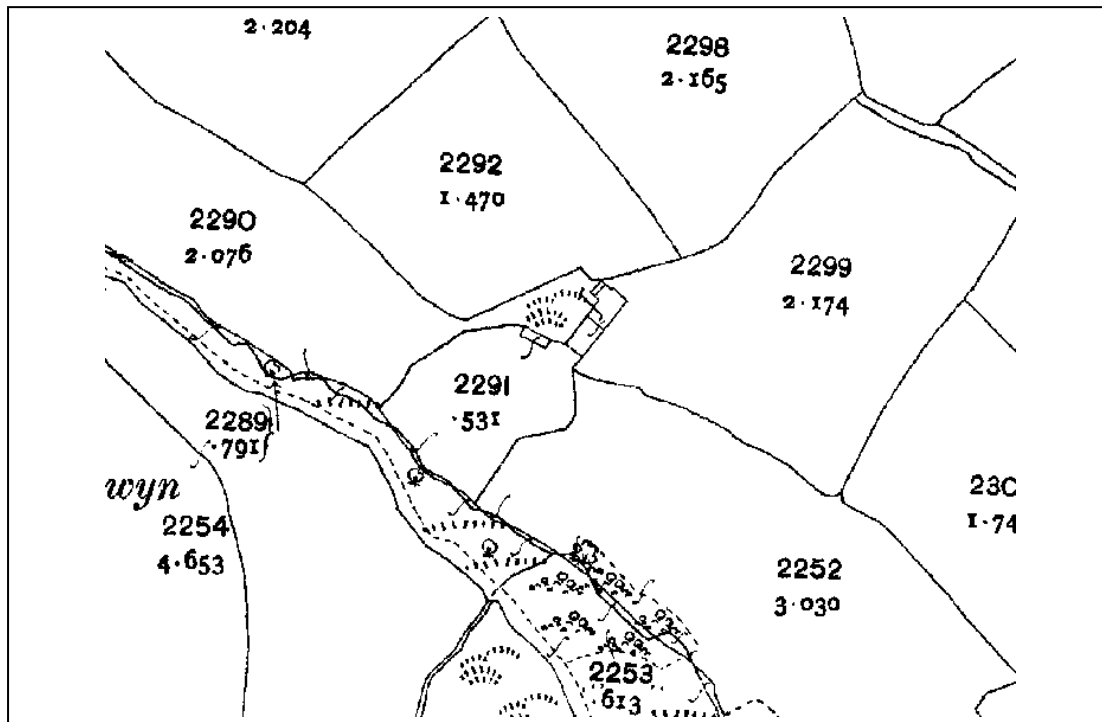

Customer Reference Number (CRN): CRN A0022691

Farm/Common name: Cwmcoy

This Management Plan has been produced by Dyfed Archaeological Trust to inform management of the Historic Environment feature (HEF). Some or all of the requirements included in this Management Plan may have been included in the Glastir Advanced contract.

HEF Name and Reference Number	HEF No. 308619 & PRN 64180
Grid Reference	SN7085222343
Officer Name	Alice Pyper
Contact Details	01558 825993

Contained within this report:

1. Site Description	
Additional information:	
2. Current Condition	
Management Issues	
3. Map of the Polygon Area Highlighting Management Issues	
4. Management Advice	
Prioritised list of management works:	
4.1 Management Works Methodology	
4.2 Long-term Management Recommendations / Best Practice	
4.3 Opportunities for Public Access and interpretation	
5. Photographs	
6. Definitive Map of the HEF Polygon Area	
7. Contractual Requirements	
7.1 Glastir - Whole Farm Code	

1. Site Description

Ruined farmstead shown on 1st edition OS map. The map shows a rectangular N-S aligned two cell structure presumed to be the farmhouse with attached agricultural building. There is a second building at right angles to this. The whole sits within an enclosed yard/garden plot. The footprint of the buildings are shown on modern mapping (Mastermap 2011) indicating that some remains survive. Recent aerial photographs (Next perspectives, 2009) show the area to be shrouded with mature trees. (H.Pritchard,2015)

2. Current Condition

The farmstead of Cwm-gwyn bach survives as ruined stone walls, standing to a height of between 1 - 1.5metres. The layout of the buildings and the associated trackway are clear. It stands within mature trees. A Pyper June 2018.

Management Issues

The masonry remains are threatened by the trees either falling and uprooting or falling on masonry, or from the wind-rock of trees established within the walls.

3. Map of the Polygon Area Highlighting Management Issues

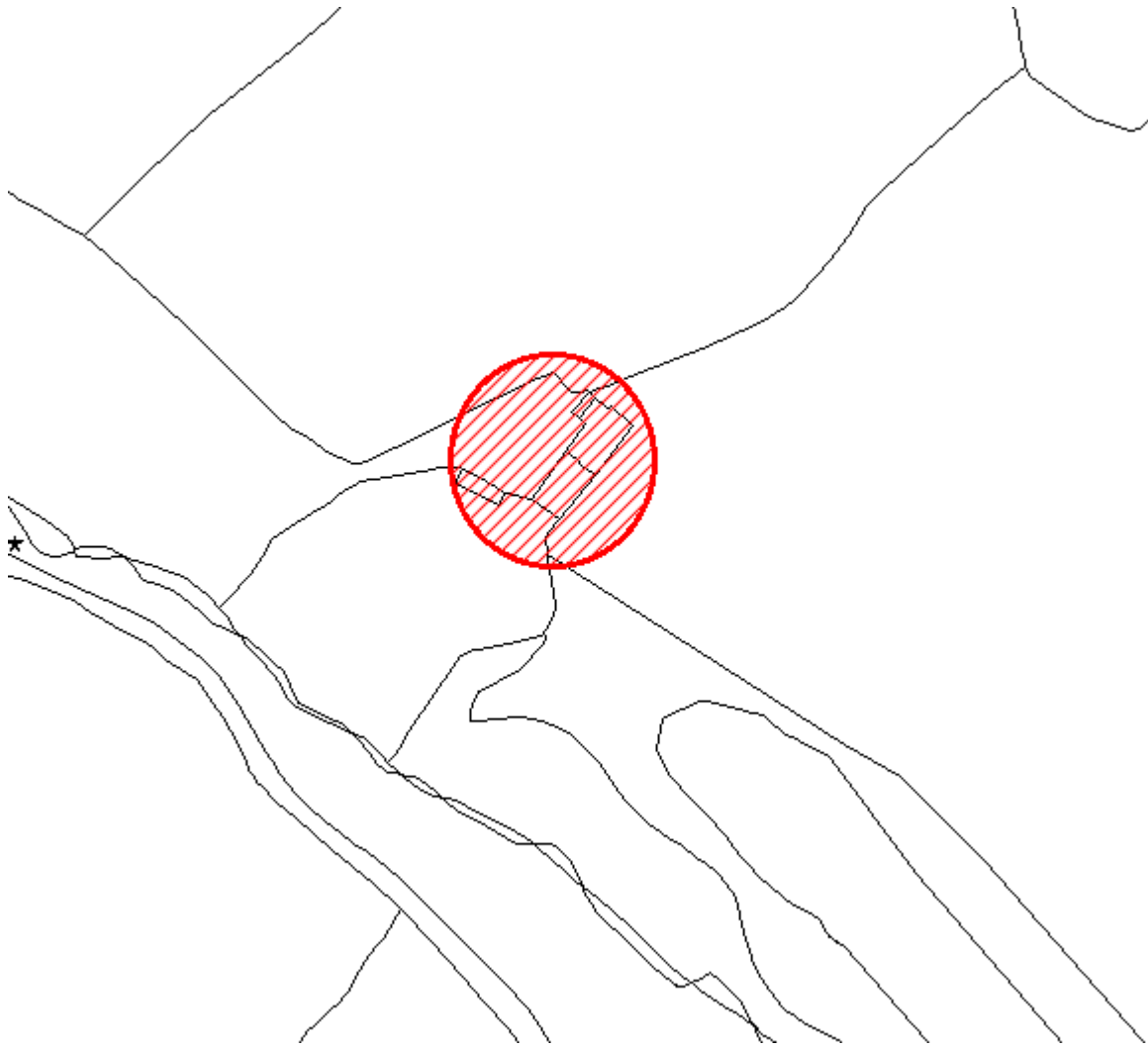

Areas of tree growth.

4. Management Advice

To remove selected trees where growing directly within masonry or very close to masonry, and where safe to do so. Very substantial trees which are less likely to uproot maybe left to provide a canopy to shade out further scrub growth.

4.1 Management Works Methodology

Careful removal of saplings and tree limbs which threaten the ruin where possible, and without causing further damage to the masonry.

4.2 Long-term Management Recommendations / Best Practice

To monitor the ruin and remove tree growth where it threatens the stability of the masonry. The aim should be to establish a stable tree canopy to shade out further scrub growth.

4.3 Opportunities for Public Access and interpretation

N/A

5. Photographs

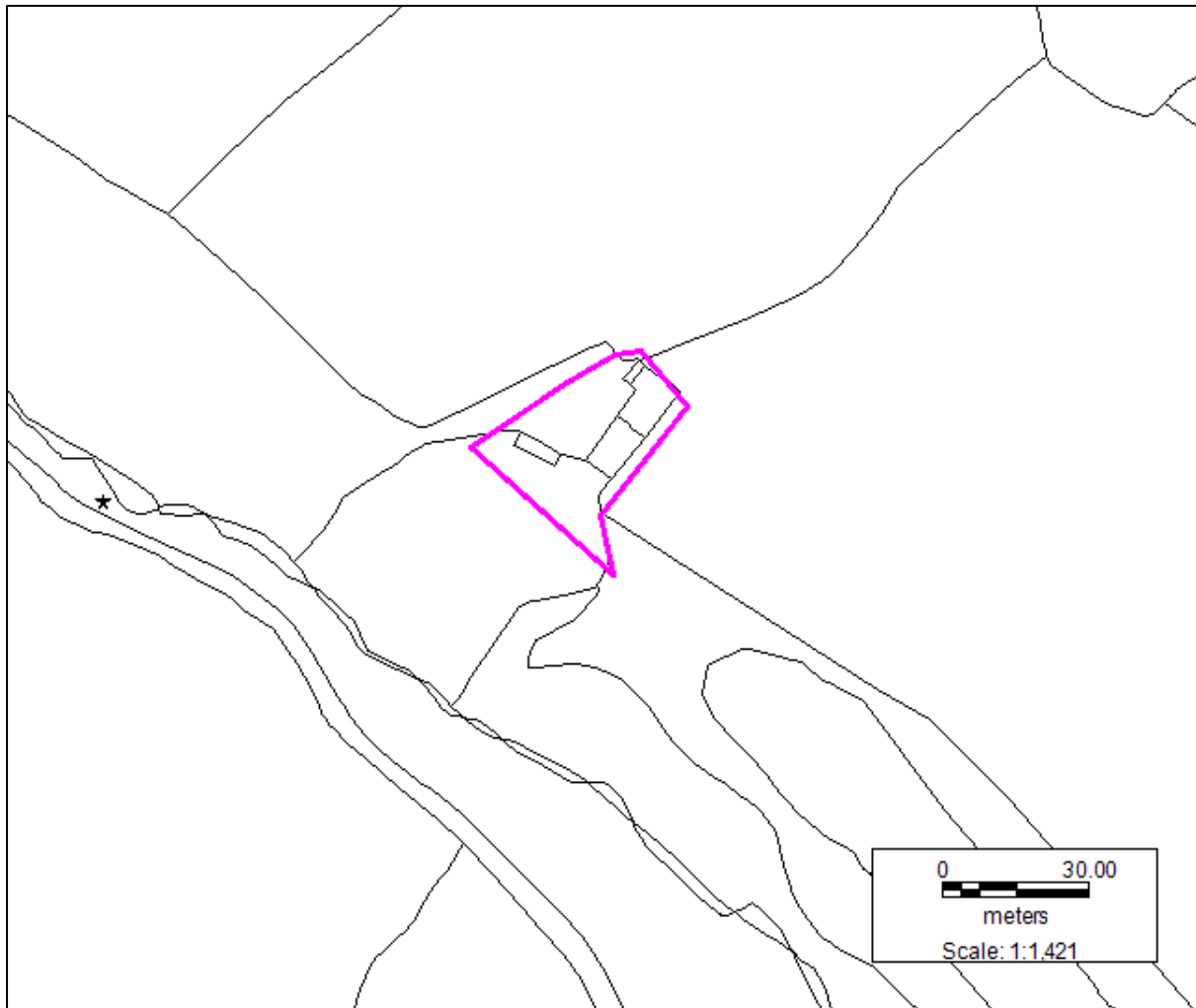

Figure 18. Trees growing within and around the ruin.



Figure 19. Trees growing within the masonry.

6. Definitive Map of the HEF Polygon Area



7. Contractual Requirements

Some or all of the requirements detailed in the Management Plan may have been included in the Glastir Advanced contract. It is important that you read your contract before undertaking any work included in this Management Plan.

7.1 Glastir - Whole Farm Code

The Glastir Whole Farm Code states:

You must not damage any historic feature identified on your agreement map

Definitions of damage to a historic feature include ANY of the following:

- Ground disturbance or excavation especially extending beneath topsoil

- Dumping or storage of material, including temporary storage
- Removal of any material, including stones, soil or subsoil
- Visible signs of active erosion (loss and disturbance of topsoil) caused by livestock and vehicles or other agricultural practice
- Planting trees
- Allowing scrub to develop
- Ploughing or reseedling
- Displacing individual stone features