

Historic Environment Feature Management Report:

Tricock House, Ruined Cottage

Customer Reference Number: A0023363

UID: 309, 645

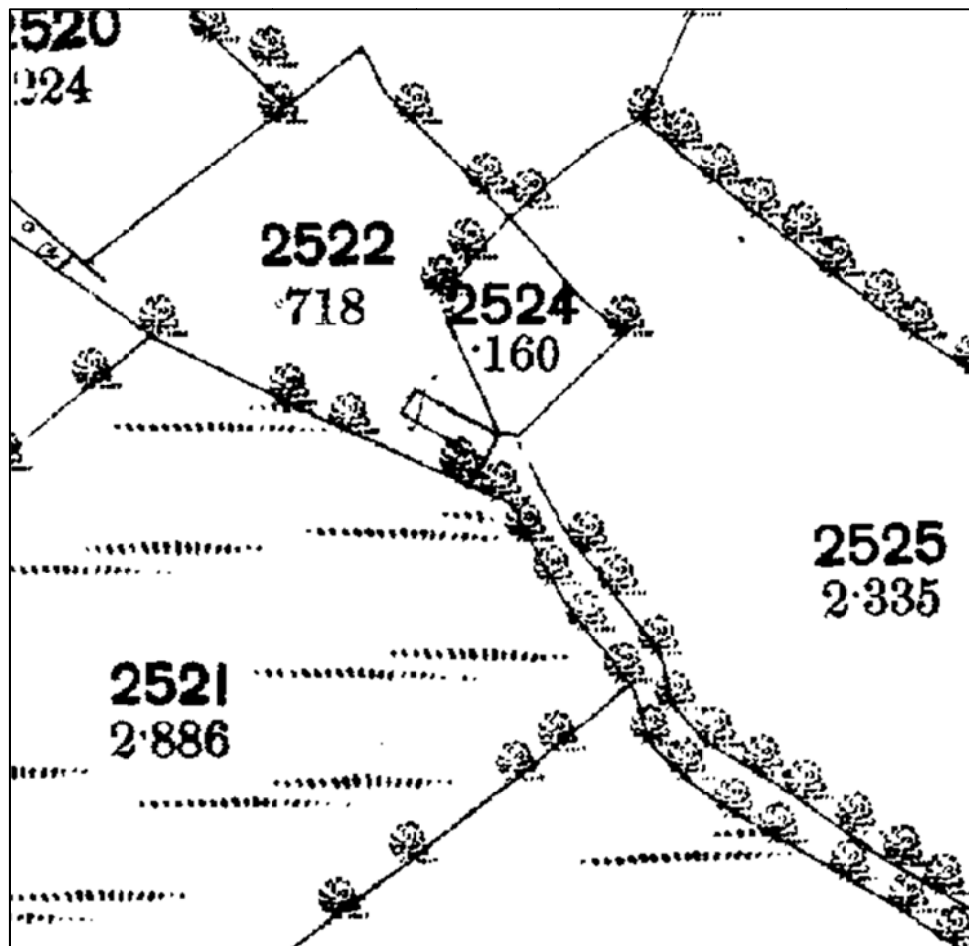

Detail from the Ordnance Survey 1st edition map (1889) © and database right Crown copyright and
Landmark Information Group Ltd (All rights reserved 08/05/2012)

This management plan has been produced by Dyfed Archaeological Trust Heritage Management to inform the positive management of the identified Priority Historic Environment Feature. The identified management outcome will meet the objective for the Historic Environment Feature Targeted Layer as part of the Glastir Land Management Scheme.

PRN 8318 Name TRICOCK HOUSE
Period Post-medieval **Site Type** COTTAGE
NGR SN5928047100

Site Description

A ruined cottage and associated enclosure walls marked on the Pencarreg Tithe Map of 1839. It is shown on Ordnance Survey 1st edition map (1889) as a rectangular structure. By the 2nd edition Ordnance Survey map it covers the same footprint but with the SE end being open sided; presumably representing a barn or cart house or some such agricultural building. This configuration is continued up to the most recent Ordnance Survey mapping (Mastermap 2011), indicating survival in a ruined form. A field visit in 1984 declared that only an "earthen banked enclosure" survived but it is unclear whether this refers to the buildings wall bases or an associated paddock or garden plot. Recent aerial photographs (Ordnance Survey Next Perspectives 2009) show the area surrounded by trees under a thick canopy.

Management Issues

The main management issue for this site is the control of tree and scrub vegetation which has the potential to damage buried archaeological remains through the disruptive activity of root development, and built structural remains by the prising apart of masonry bonds. Thick vegetation also obscures the remains from view and diminishes the understanding of the site.

Desired Management Outcome

The desired management outcome is to reduce further degradation of the built structural remains, including the enclosure walls, and to keep them in a stable and visible condition free from invasive vegetation.

Management Actions

The following management actions are required in order to keep the structures in a stable and visible condition:

- Remove mature trees which are at risk of wind throw and could threaten the structure through uprooting (root plate damage) or falling limbs.
- Remove any young trees growing on the top of structural remains by cutting by hand. Do not pull-up by the roots as this is potentially destabilising to masonry bonds.
- Cut any scrub back by hand in order to retain the visibility of the structure.
- Spot treat to prevent regrowth.
- Maintain a canopy of mature trees over the remains. This will prevent light entering the ground, inhibiting scrubby vegetation growth.

Glastir Whole Farm Code

Please also remember that, unless we have indicated otherwise, the Glastir Whole Farm Code should be observed for all historic features on your farm. The Whole Farm Code states that you must not damage any historic feature identified on your agreement map.

Definitions of damage to a historic feature include ANY of the following:

- Ground disturbance or excavation especially extending beneath topsoil.
- Dumping or storage of material, including temporary storage.
- Removal of any material, including stones, soil or subsoil.
- Visible signs of active erosion (loss and disturbance of topsoil) caused by livestock and vehicles or other agricultural practice.
- Planting trees.
- Allowing scrub to develop.
- Ploughing or reseeded.
- Displacing individual stone features.

Location Map



Historic Environment Feature UID 309 645

Aerial Photograph



Historic Environment Feature UID 309 645

Maps based upon Ordnance Survey material with the permission of Ordnance Survey on behalf of the Controller of Her Majesty's Stationery Office Crown copyright. Unauthorised reproduction infringes Crown copyright and may lead to prosecution or civil proceedings'. Welsh Assembly Government 100017916.
[03.13.13](#)

Archaeological data, from the Regional Sites and Monuments Record, supplied by The Dyfed Archaeological Trust in partnership with Local Authorities, Cadw and the partners of ENDEX DAT, 2011 (and in part Crown, 2011).

[13.03.13](#) - HTML file produced for Glastir management report, DAT file number [388](#).
Dyfed Archaeological Trust, Heritage Management, The Shire Hall, 8 Carmarthen Street, Llandeilo,
Carmarthenshire SA19 6AF.
tel (01558) 823131 , fax (01558) 823133, email info@dyfedarchaeology.org.uk , website
www.dyfedarchaeology.org.uk